



HARVEY RT-S Router Table Stand Instruction Manual

[Home](#) » [HARVEY](#) » HARVEY RT-S Router Table Stand Instruction Manual 

Contents

- [1 HARVEY RT-S Router Table Stand](#)
- [2 Product Information](#)
- [3 Product Usage Instructions](#)
- [4 Features](#)
- [5 Introduction](#)
- [6 Warranty Information](#)
- [7 Specifications](#)
- [8 General Safety Guidelines](#)
- [9 Unpacking and Installing](#)
- [10 Operation](#)
- [11 Maintenance and Service](#)
- [12 Exploded View and Parts List](#)
- [13 Documents / Resources](#)



HARVEY RT-S Router Table Stand



Product Information

- **Parallel Lifting:** The stand utilizes a cyclic lifting mechanism located underneath the base platform. To lift the stand, simply press down on the pedal of the lifting mechanism. The three rollers will simultaneously raise the support and lock it into place.
- Lowering the stand is achieved by pressing the pedal again, retracting the rollers and allowing the feet to make contact with the ground, providing stable support.
- **Ball Head Foot:** The ball head foot allows for easy table height adjustment and adapts to uneven ground surfaces.
- **Handle Bracket:** The handle bracket can be adjusted at any angle, providing convenience for placing and using your router crank handle.
- **Power Switch:** The power switch controls the start and stop of the cutter and provides overload protection.
- **Leg:** The aluminum profile legs feature a T-slot design, making it convenient to install homemade tools.

Product Usage Instructions

1. Unpacking and Installing:

1. Carefully unpack the Router Table Stand and ensure that all parts and components are included as listed in the parts list below. Refer to Fig 3 for an exploded diagram of all components.

2. General Safety Guidelines:

- When using the router table, it is important to follow safety guidelines for universal electric tools.
- Always use a guard and fabricate additional guards or jigs for specific circumstances. Consider using an overhead guard if the fence is removed.
- Store the router power cord safely to prevent tripping hazards during operation.

Specifications

- **Stand Dimension:** 26-9/64 x 17-61/64 x 33-35/64 (664x456x852mm)
- **Input Power:** 120v 15A
- **Net weight/Gross weight:** 43lbs (19.5kg)/48.5lbs (22kg)
- **Package Size:** 32-23/64 x 24-13/32 x 9-1/16 (822x620x230mm)
- **Max. load-bearing:** 330lbs (150kg)
- **Note:** The specifications mentioned above are subject to change without prior notice.
- Please refer to the product documentation for the most up-to-date specifications.

Features

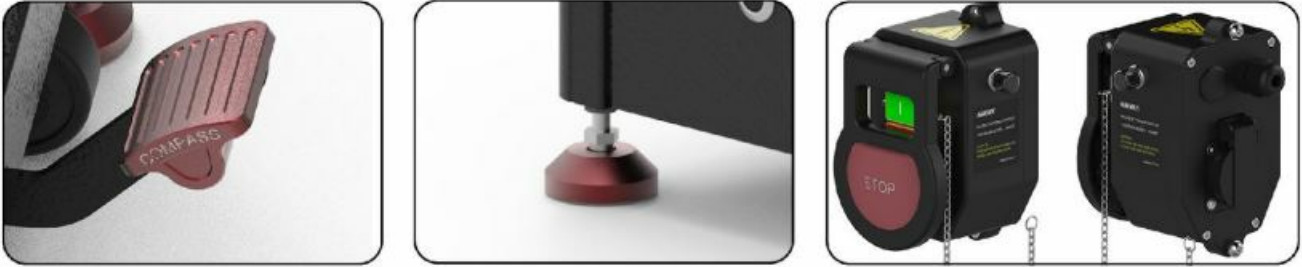

Introduction

- Thank you for purchasing Harvey's products. We are confident that you will be satisfied with the quality and performance of our products.
- The Harvey RT-S Router Table Stand is a universal product that can be installed with RT-685, RT-800, or even custom router tables.
- The RT-S Router Table Stand is also designed to be universally compatible with a majority of aftermarket router table systems.
- Please refer to your router table to ensure proper fitment. In some cases, some modifications may be necessary.
- The Harvey RT-S Router Table Stand features parallel lifting, start-stop switch control, overload protection, and height adjustment functions.
- Its high-strength aluminum alloy construction provides both enhanced functionality and an appealing visual design.
- We hope this user manual provides you with the necessary guidance to install, operate, and maintain the Router Table Stand effectively.
- If you require any further assistance or inquiries, please reach out to our customer service center.

Parallel Lifting

- The stand utilizes a cyclic lifting mechanism located underneath the base platform.
- To lift the stand, simply press down on the pedal of the lifting mechanism.
- The three rollers will simultaneously raise the support and lock it into place.
- Lowering the stand is achieved by pressing the pedal again, retracting the rollers, and allowing the feet to make contact with the ground, providing stable support.

Ball head foot

- The ball head foot allows for easy table height adjustment and adapts to uneven ground surfaces.

Handle bracket

- The handle bracket can be adjusted at any angle, providing convenience for placing and using your router crank handle.

Power switch

- The power switch controls the start and stop of the cutter and provides overload protection.

Leg

- The aluminum profile legs feature a T-slot design, making it convenient to install homemade tools.

Warranty Information

Limited Tool Warranty:

- We make every effort to ensure that this product meets the highest quality and durability standards. We offer a limited warranty for our products.
- This warranty covers manufacturing defects for one year from the date of retail purchase.
- It does not apply to defects caused by misuse, abuse, normal wear and tear, negligence or accidents, unauthorized repairs, modifications, or lack of maintenance.
- We are not liable for any injuries, property damage, or consequential damages resulting from product use.
- Please contact our customer service center for warranty claims and further assistance. We will repair or replace the product or any part(s) covered under this warranty due to defective workmanship or materials during this warranty period.

Specifications

Stand Dimension:

- 26-9/64" x 17-61/64" x 33-35/64" (664x456x852mm)

Input Power:

- 120v 15A

Net weight/Gross weight:

- 43lbs (19.5kg)/48.5lbs (22kg)

Package Size:

- 32-23/64" x 24-13/32" x 9-1/16"

(822x620x230mm)

Max. load-bearing:

- 330lbs (150kg)
- **Note:** The specifications mentioned above are subject to change without prior notice.
- Please refer to the product documentation for the most up-to-date specifications.
- **Fig.1** shows the dimensions of mounting holes for the upper brackets.
- **Fig.2** shows the size of the legs' T-slot.

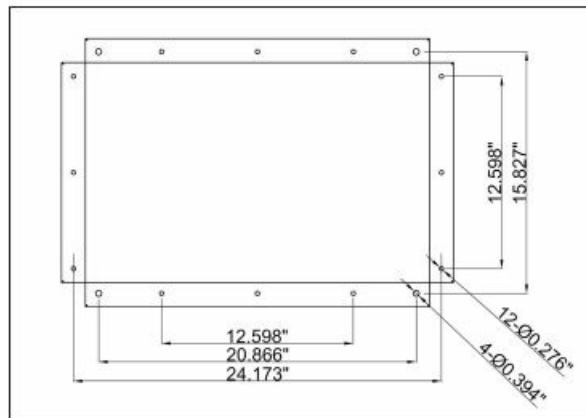

Fig.1

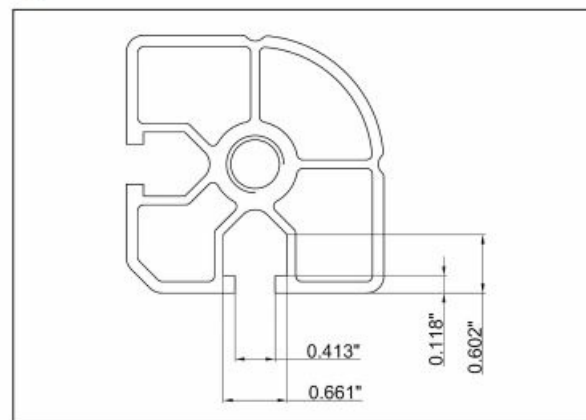

Fig.2

General Safety Guidelines

When using the router table, it is important to follow safety guidelines for universal electric tools. Additionally, pay attention to the following precautions:

1. Before moving the support, always unplug the router from the power source.
2. While the RT-S Router Table Stand can accommodate uneven surfaces, it is recommended to place the router table stand on a flat and stable surface to prevent tilt or sliding.
3. Avoid using the product in damp, messy, or dark environments, or in areas with flammable or explosive materials.
4. When not in use, insert the safety pin into the green start button to ensure it is deactivated to prevent any

accidental startup.

5. Never place your hands directly over or in front of the spinning cutter. Maintain a minimum distance of six (6) inches from the cutter at all times.
6. Ensure all lock levers, knobs, fence hardware, and guide rails are securely tightened before operating the router table. Failure to do so can cause the workpiece to slip out of alignment while cutting and cause injury from kickback.
7. Let the cutter do the work; avoid applying excessive force, as it may lead to poor cutting results or kickback.
8. Exercise caution when working with workpieces containing knots, holes, or foreign objects, as they can increase the risk of kickback and injury. Warped stock should be run through a jointer before you run it through the router table.
9. Keep the cutter on the underside of the workpiece when making blind cuts. This will decrease the risk of accidental contact with the cutter.
10. Always feed the workpiece against the rotation direction of the cutter. Otherwise, the workpiece could be aggressively pulled from your hands, drawing them into the spinning cutter.
11. When setting up the cutter, disconnect the router from power and rotate the router spindle to ensure proper cutter clearance before starting the router.
12. Always use a fence, jig, or miter gauge when cutting workpieces, and never operate the router table without them.
13. Never use a workpiece shorter than six inches without special fixtures or jigs. Otherwise, the workpiece can become trapped between the fence and the cutter, which could draw your hands into the spinning cutter.
14. Keep any unused portion of the cutter below the table surface to minimize the risk of accidental contact.
15. Always use a guard and fabricate additional guards or jigs for specific circumstances. Consider using an overhead guard if the fence is removed.
16. Store the router power cord safely to prevent tripping hazards during operation.

WARNING

- Like all machinery, there is a potential danger when operating this tool. Accidents are frequently caused by a lack of familiarity or failure to pay attention.
- Use this tool with respect and caution to decrease the risk of operator injury.
- If normal safety precautions are overlooked or ignored, serious personal injury may occur.

Unpacking and Installing

Unpacking

- Carefully unpack the Router Table Stand and ensure that all parts and components are included as listed in the parts list below. Refer to Fig 3 for an exploded diagram of all components.

REF	DESCRIPTION	QTY
A	Base Platform	1
B	Switch	1
C	Pedal assembly	1
D	Supporting foot	4
E	Handle bracket	1
F	10mm ratchet wrench	1
G	Wrench 8-10	1
H	Wrench 13-16	1
I	Hex wrench 1.5-8	1
J	Leg	4
K	Top bracket long	2
L	Top bracket short	2
3	Hexagon bolt M6x16	32
4	Spring washer 6	36
5	Flat washer 6	42
6	Square nut M6	32
7	Flat washer 8	4
8	Spring washer 8	4
9	Cap screw M8x25	4
21	T-bolt M5X16	4
22	Flat washer 5	4
23	Spring washer 5	4
24	Cap nut M5	4
34	Nut M6	4
39	Button head screw M6X16	2
48	Cap screw M6x20	4

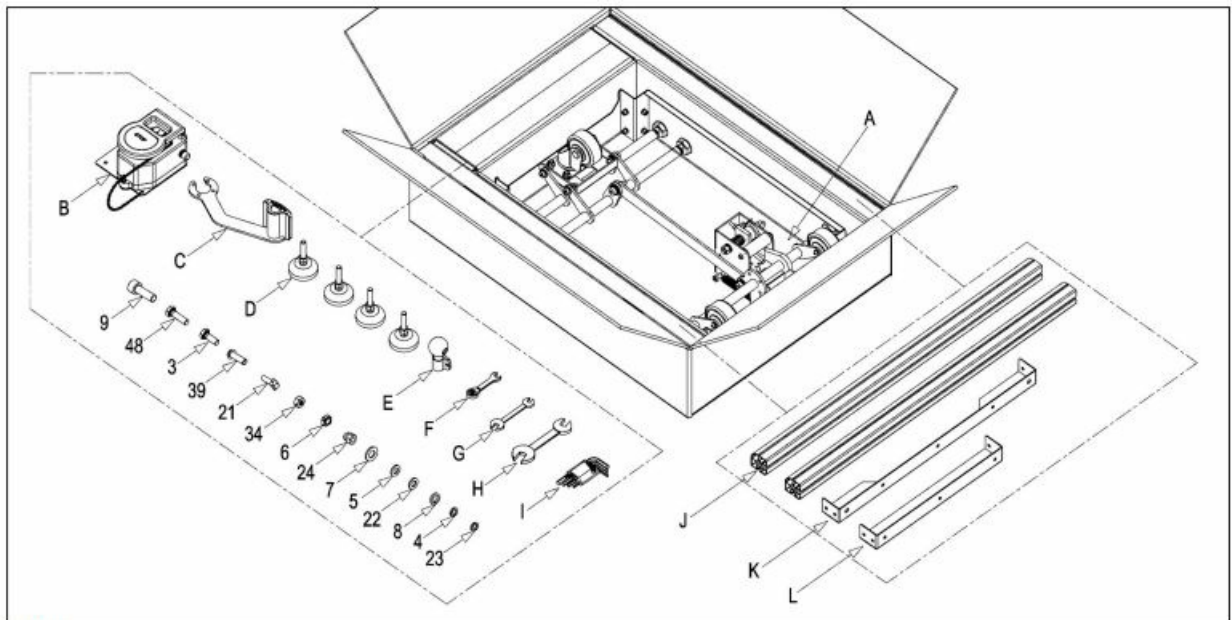

Fig.3

Installation

- Follow these steps to install your RT-S Router Table Stand:
- **a.** Place the base platform (A) upside down on a sturdy surface. Attach the foot pedal assembly (C) to the base platform (A) as shown in Fig.4.

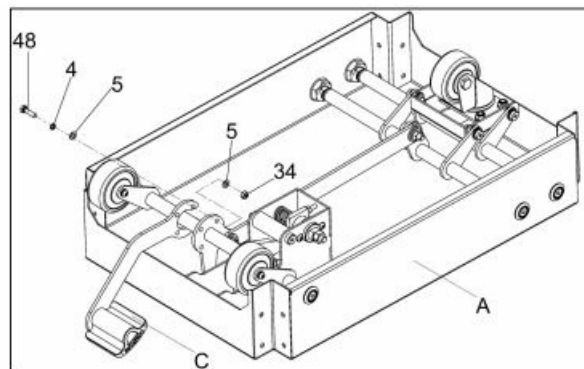

Fig.4

- **b.** Pull the foot pedal (C) to change it from state (I) to state (II) as seen in Fig.5.
- To install the legs (J), preinstall the fasteners (#3, #4, #5, and #6) into the sixteen holes of the base platform (A) as shown in Fig.5.
- Each corner will require 4 sets of fasteners (16 in total). Square nut (#6) will be exposed to accept the legs (J).

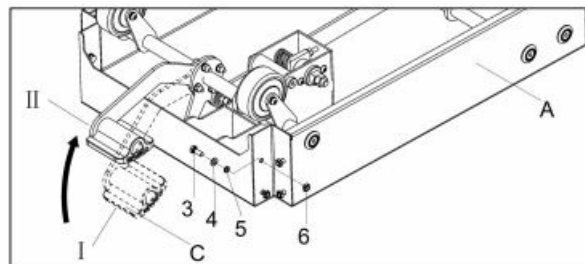

Fig.5

- **c.** Insert the threaded end of the leg (J) under the base platform (A). Until the end is flush with the base platform (A) and hand tighten the bolts (#3) in advance to hold the leg into place.
- Use the provided wrenches to securely tighten it with a tool. Repeat this step to install the remaining three legs (J) as shown in Fig.6 for each corner of the base.

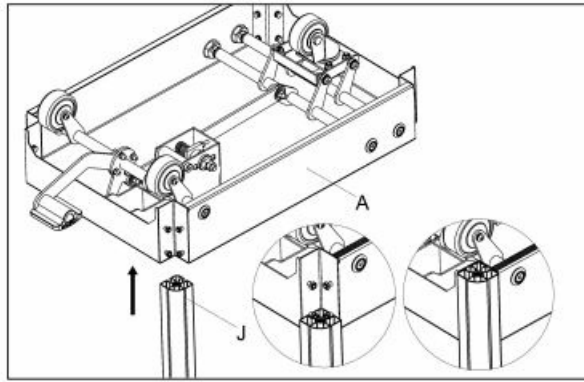

Fig.6

- **d.** Install the foot (D) on the leg (J) and rotate to the minimum or lowest height (h) as indicated in Fig.7. Repeat this step to install the remaining three (D) as shown in Fig.7.

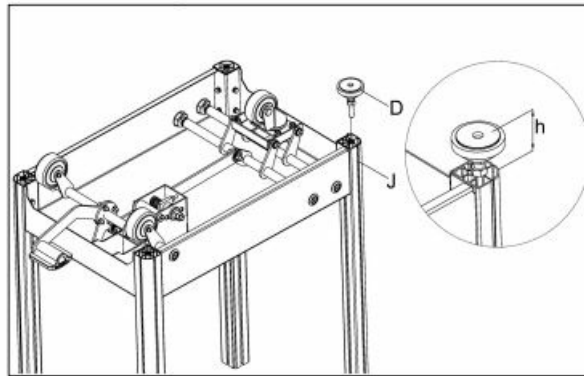

Fig.7

- **e.** Flip your RT-S over (right-side up) on the ground then press down on the foot pedal (C) gently. Slowly depress (lift) the foot pedal to change from state (II) to state (I).
- Next, preinstall the fasteners (#3, #4, #5, and #6) onto the sixteen holes located on the top brackets of (K) and (L).
- Finally, insert the top bracket (K) from the top of the leg (J), so that the square nuts are mated with the slots on the leg (J).
- Align the top bracket (K) to be flushed with the leg, and hand tighten the bolt to temporarily hold the bracket in place.
- Using the provided wrenches, tighten the bolt to secure the bracket. Repeat this step to install the remaining brackets (K) and (L) as shown in Fig.8.

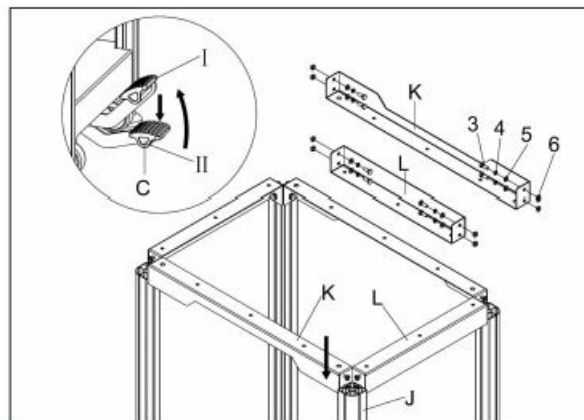

Fig.8

- **f.** Install the handle bracket (E) at the appropriate position and height as to your preference. Use the provided fasteners (#21, #22, #23, and #24) to secure the bracket onto the support leg (J) as shown in Fig.9.

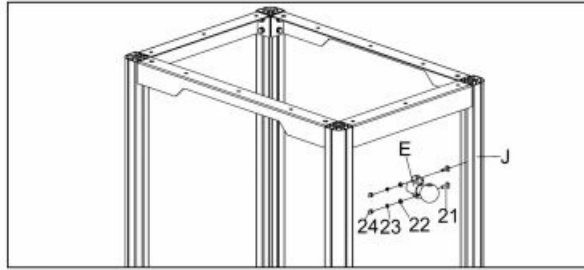

Fig.9

- **g.** To mount the power switch (B), install the switch at the appropriate position of the leg (J). The switch should be mounted near the foot pedal side with the provided fasteners (#21, #22, #23, and #24) as shown in Fig.10.

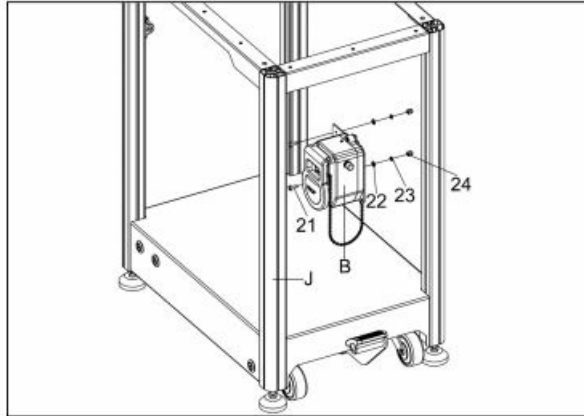

Fig.10

- **h.** After assembling the legs and top brackets to the base platform, now it is time to attach your router table. Set the router table on to the top bracket (K) and use the provided fasteners (#7, #8, and #9) to secure the router table as shown in Fig.11.

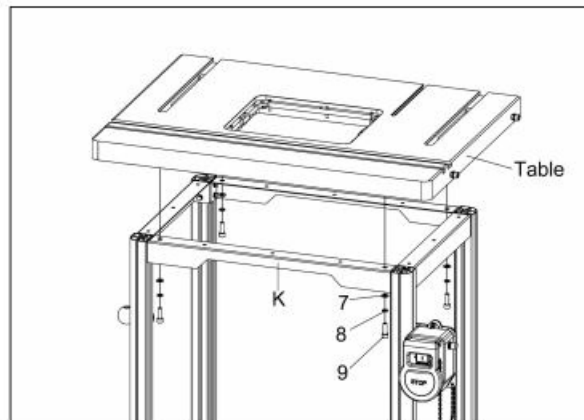

Fig.11

Note:

- If you are using the Harvey RT-685/800 router tables, then it can be directly mounted using the holes on both sides of the top bracket (K).
- If you are constructing a customized router table, you can mount the table with any of the available holes located on the top bracket as indicated in Fig.1 of the Specification section.
- **i.** To evenly set the height of the support feet, rotate each of the four feet (D) **CLOCKWISE** by the same number of turns (rotation) until the rollers are slightly lifted up above the ground surface. It is recommended that the rollers be at least 0-2 mm, higher than the ground surface.
- If the ground surface is uneven, then you may need to fine-tune the feet (D) so that the table is leveled accordingly. You may need a leveler to ensure that the table is properly leveled. Once the height is properly

set, tighten the nut on the feet (D) up against the legs as shown in Fig.12 to ensure the height is fixed at a set height.

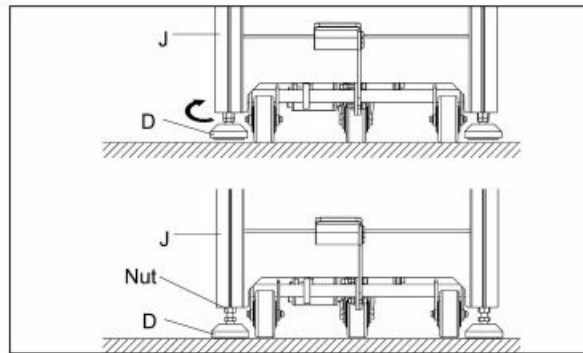

Fig.12

- **NOTE:** To mount the router and/or lift system to the router table, please refer to the product's owner manual for more details.

Operation

- To use the router table stand, we must provide power to our router tool. Start by connecting the router to the switch box assembly by connecting the router tool plug into the socket located on the power switch (B).
- Next, connect the power switch (B) cord to the appropriate power source (receptacle).
- While the power switch (B) is in the OFF position, double-check to ensure that your router tool is in the ON position as you will no longer utilize the ON/OFF switch located on the router tool.
- The router tool will now be controlled by the power switch located on the router table stand.
- To start the router tool using the power switch (B), pull out the safety pin and press the (green) Start button to turn ON the router tool.

IMPORTANT NOTE:

- When moving the stand around, always make sure to disconnect the main power cord first. Step on the foot pedal to engage the rollers.
- Move the router table stand to the desired location, and then step on the foot pedal again to disengage the roller. If needed, adjust the support feet to ensure that the router table is leveled before using the router table!

Maintenance and Service

- The RT-S Router Table Stand does not require any special maintenance. However, it is recommended to regularly inspect, clean, and avoid prolonged use in humid environments that can extend the service life of your router table system.
- For cleaning, use a clean cloth or brush to remove dust and debris from the stand's surface and components. Apply a suitable lubricant to prolong the life of any moving components.
- Periodically inspect all components for signs of wear, damage, or loose connections. Replace any worn or damaged parts with genuine replacement parts from the manufacturer.
- Please contact our customer service center for warranty claims and further assistance.

Exploded View and Parts List

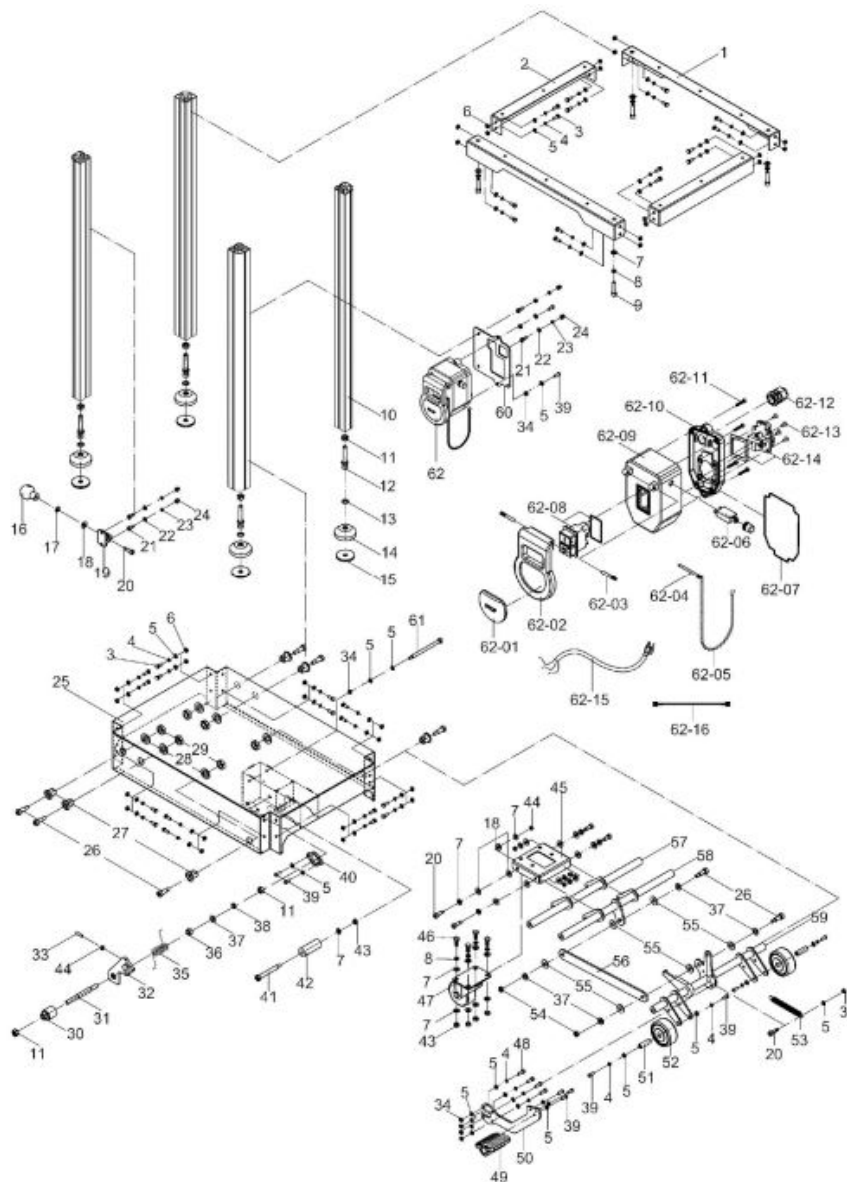

Router Table Stand parts

Router Table Stand parts list					
REF	DESCRIPTION	QTY	REF	DESCRIPTION	QTY
1	Top bracket (long)	2	40	Swing shaft locking block	1
2	Top bracket (short)	2	41	Shoulder Bolt $\phi 10 \times 70$	1
3	Hexagon bolt M6x16	32	42	Buffer block	1
4	Spring washer 6	40	43	Nut M8	5
5	Flat washer 6	54	44	Lock nut M6	5
6	Square nut M6	32	45	Universal wheel mounting bracket	1

7	Flat washer 8	21	46	Hexagon bolt M8X20	4
8	Spring washer 8	8	47	Universal wheel	1
9	Cap screw M8x25	4	48	Cap screw M6x20	4
10	Leg	4	49	Foot Pedal	1
11	Nut M10	6	50	Pedal arm	1
12	Ball head screw	4	51	Roller shaft	2
13	O-Ring 2.65×14	4	52	Wheel	2
14	Supporting foot	4	53	Tension spring	1
15	Rubber mat	4	54	Lock nut M8	2
16	Handle bracket	1	55	Nylon washer $\phi 25 \times \phi 10 \times 2$	6
17	Disc spring 16	1	56	Connecting link	1
18	Nylon washer $\phi 19 \times \phi 8 \times 2$	13	57	Driven shaft	1
19	Handle bracket fixing block	1	58	Connecting link shaft	1
20	Shoulder Bolt $\phi 8 \times 16$	7	59	Driveshaft	1
21	T-bolt M5X16	4	60	Switch bracket	1
22	Flat washer 5	4	61	Shoulder Bolt $\phi 8 \times 90$	1
23	Spring washer 5	4	62	Switch	1
24	Cap nut M5	4	62-01	Plastic panel	1
25	Base Platform	1	62-02	Switch panel	1
26	Shoulder Bolt $\phi 10 \times 20$	8	62-03	Knurling pin $\phi 5 \times 25$	2
27	Shaft bushing	6	62-04	Pin with hole	1
28	Flat washer 20	6	62-05	Chain	1
29	Thin nut 20	6	62-06	Overload protection switch	1
30	Adjusting pad	1	62-07	Silicone foam round strip	1

31	Swing shaft	1	62-08	Electromagnetic switch	1
32	Swing tongue	1	62-09	Switch box	1
33	Set screw M6X25	1	62-10	Switch box rear cover	1
34	Nut M6	8	62-11	Cap screw M4x20	4
35	Torsional spring	1	62-12	Water joint PG13.5	1
36	Lock pad	1	62-13	Flat HD screw M4x12	4
37	Flat washer 10	5	62-14	Socket	1
38	Spring washer 10	1	62-15	Power line 14AWGX3C 5-15P	1
39	Button HD screw M6X16	11	62-16	Single core wire 2.5 X16cm	3

- Harvey Industries Co., Ltd 68-10 Suyuan Avenue, Jiangning District, Nanjing 211100,
- China www.harveywoodworking.com
- Harvey Industries International Inc.
- 10830 Ada Ave. Montclair, CA. 91763
- TEL: 1-800-211-0397
- E-mail: info@harveywoodworking.com

Documents / Resources

 <p>RT-S Router Table Stand</p> <p>Revision A 02/03/04/05</p>	<p>HARVEY RT-S Router Table Stand [pdf] Instruction Manual</p> <p>RT-S, RT-S Router Table Stand, Router Table Stand, Table Stand, Stand</p>
--	---