



[Home](#) » [Harmony Twenty Two](#) » **Harmony Twenty Two HTT-17 True Wireless Stereo Earbuds User Manual** 

Contents [[hide](#)]

- [1 Harmony Twenty Two HTT-17 True Wireless Stereo Earbuds](#)
- [2 Package Contents](#)
- [3 Product Overview](#)
- [4 Touch Control Diagram](#)
- [5 Power ON/ OFF](#)
- [6 Pairing](#)
- [7 Reset](#)
- [8 Touch Operation](#)
- [9 Product Parameter](#)
- [10 Earbuds Warning](#)
- [11 Battery Warning](#)
- [12 FCC Statement](#)
- [13 Frequently Asked Questions](#)
- [14 Documents / Resources](#)
 - [14.1 References](#)



Harmony Twenty Two HTT-17 True Wireless Stereo Earbuds



Package Contents



Charging Case × 1PC

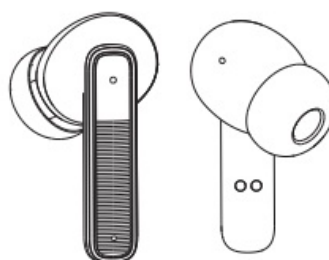

Earbuds × 3 Pair

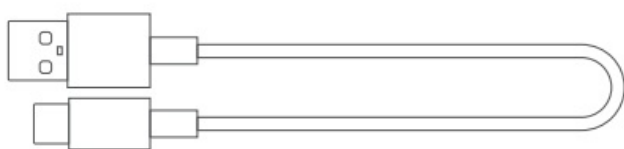

Type- C Charging Cable × 1PC

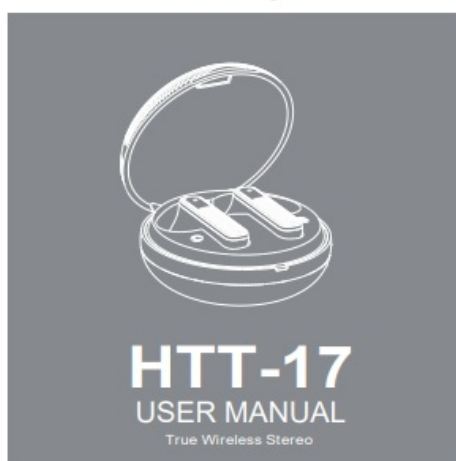

User Manual × 1 PC

Product Overview

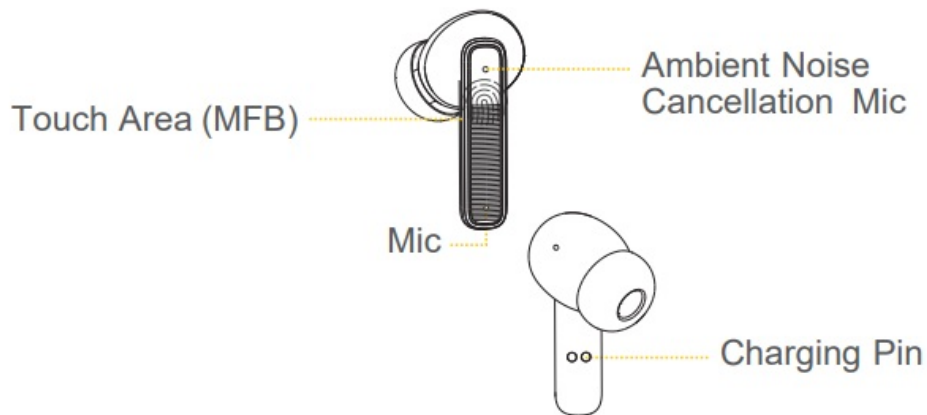
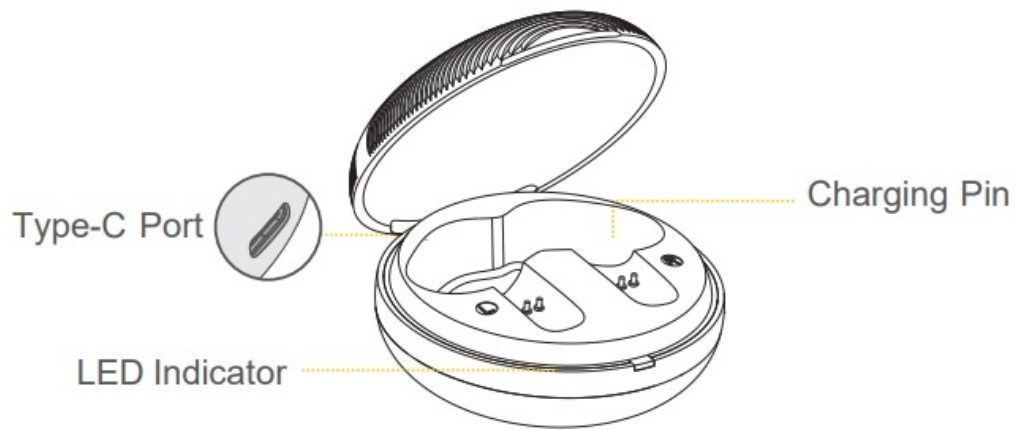

Touch Control Diagram

The touch area (MFB Touch Panel) is located in the upper part of earbuds handle.

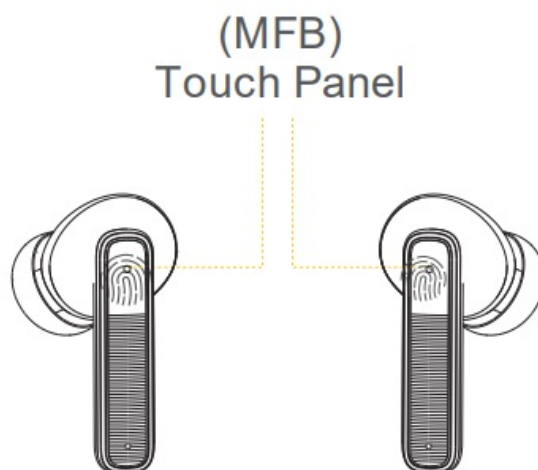

Wearing Earbuds Note:

The left earbud marked with L is worn in the left ear, and the right earbud marked with R is worn in the right ear.

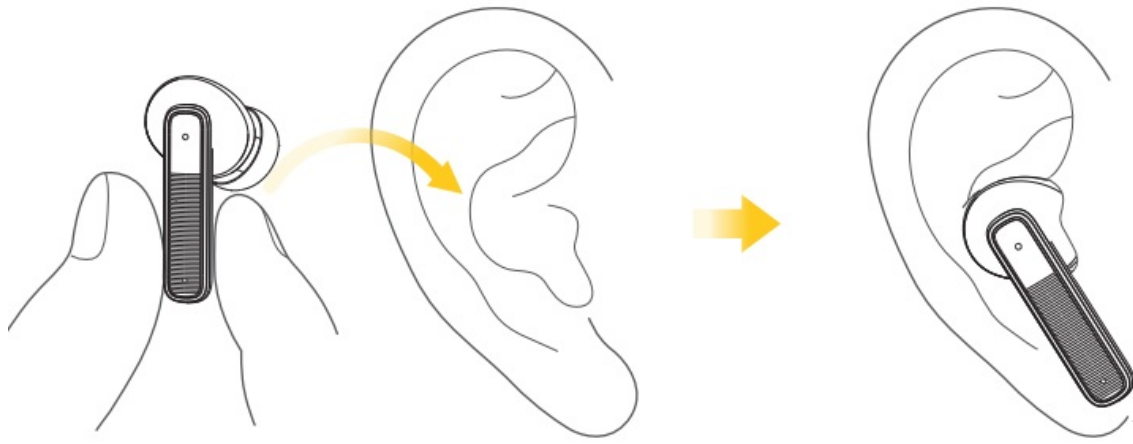

Power ON/ OFF

Power on

Auto: Open the charging case and take out the earbuds to power on
Manually: Press and hold the MFB for 3s.

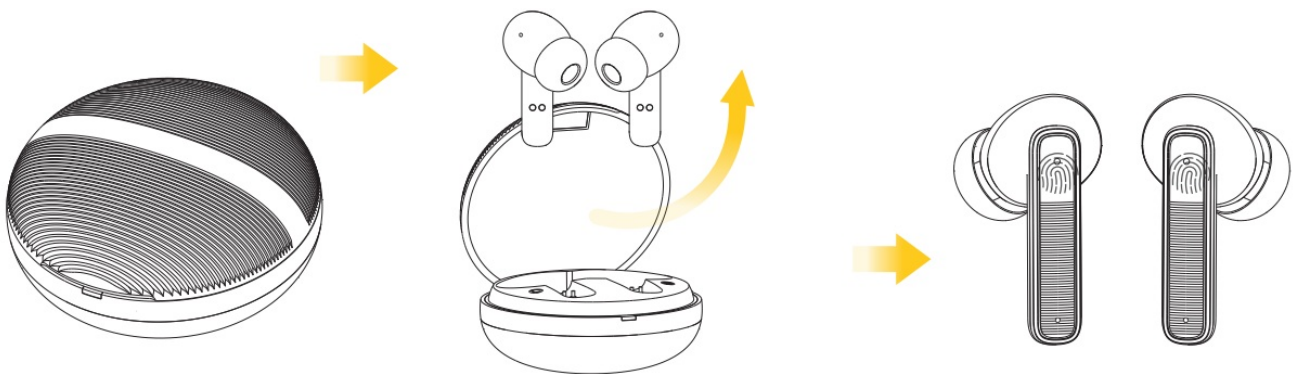

Open cover and take out the earbuds to power on

Touch to turn on

Power oFF

Auto: Place both Earbud in your charging case, Close the lid.
Manually: Press and hold the MFB for 5s.

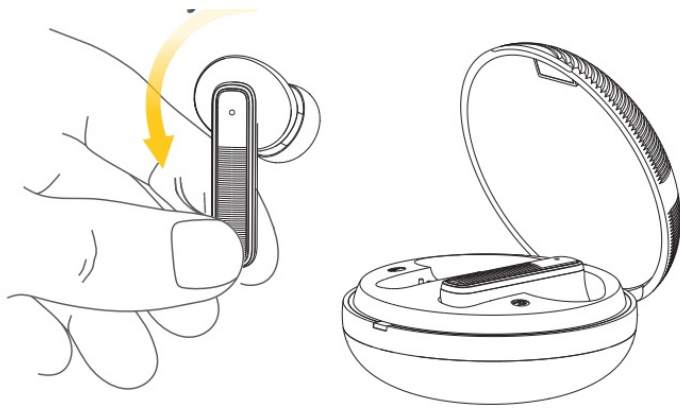

Put earbuds in to power off

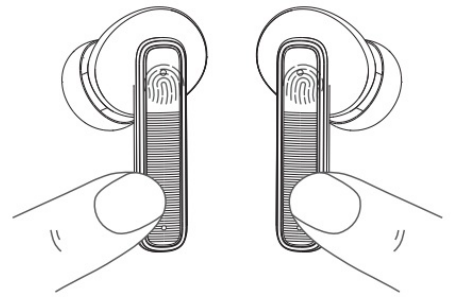

Touch to turn off

Pairing

1. Open the charging case and take out the earbuds. The earbud will pair automatically. One of the earbuds flashes blue and red, the other earbud's light goes out.
2. Activate Bluetooth on the device, turn on Bluetooth, search for the pairing name "HTT-17" and click on it.

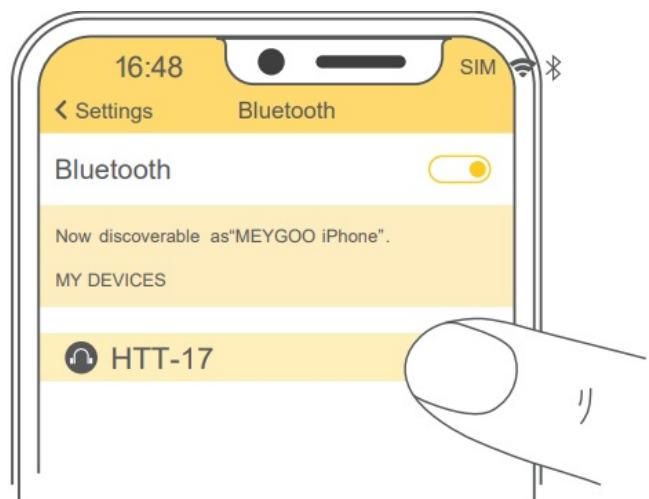
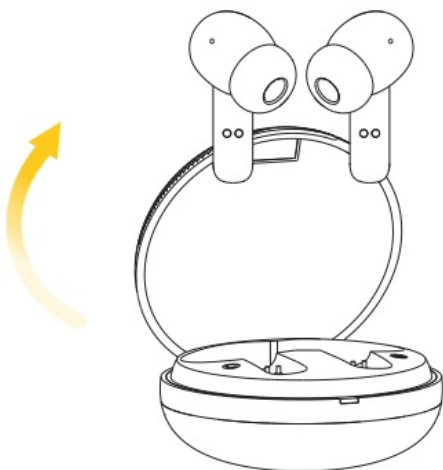

Tips: Next use, Open the charging case, earbuds auto connect phone.

Single Mode

When on dual mode, put one earbud into the charging case. Only take one earbud out of the charging case and connect it.

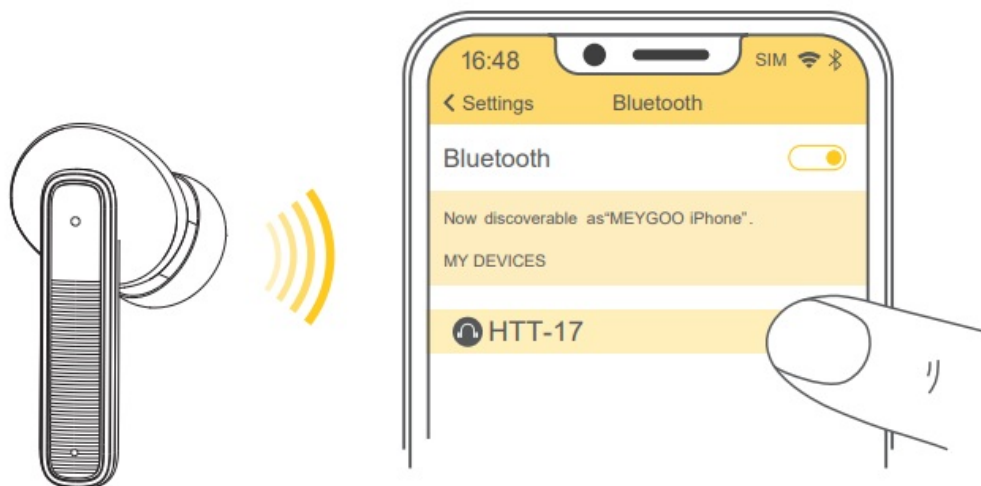

Bluetooth Lost

1. Turn off the mobile phone's Bluetooth, earbuds will enter the pairing mode and can pair with other devices.
2. If the connection range is exceeded, the earbuds will enter the back connection mode.
No connection within 5 minutes, the earbuds will turn off

Notes For Signal Transmission Distance (as illustrated)

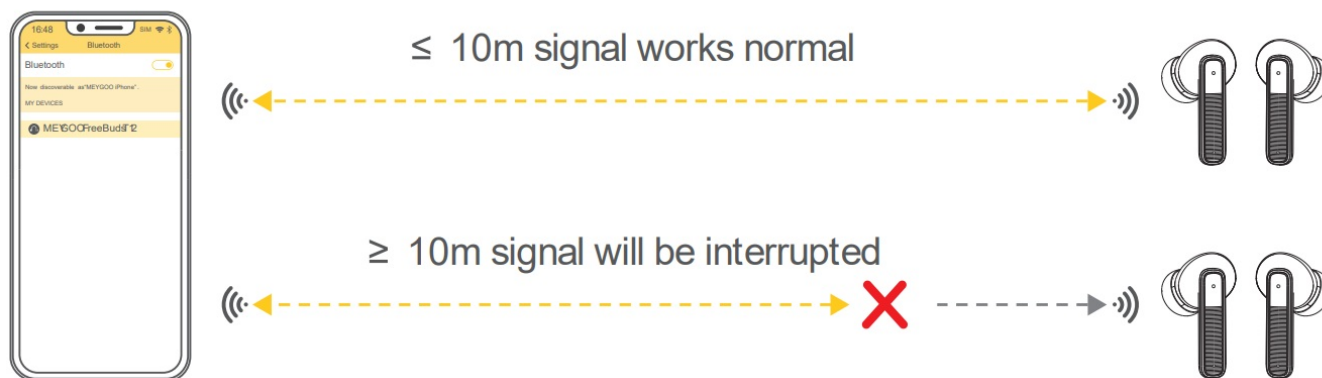

Reset

If your earbuds accidentally only get one earbud to work, or fail to pair, please reset the earphone.

1. Delete all "HTT-17" Bluetooth records on the phone, and turn off Bluetooth
2. Put earbuds into charging case, and then take out to pairing modes, tap L & R MFB 5 times simultaneously, hear "DU" prompt voice to clear all pairing.

3. Put earbuds into charging case

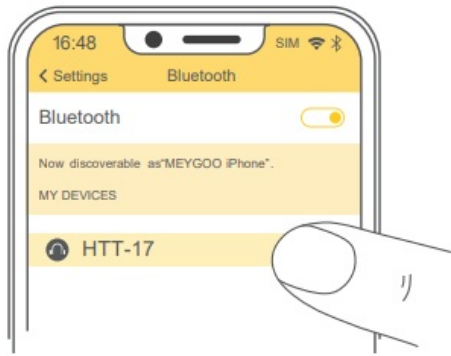

Remove HTT-17 records

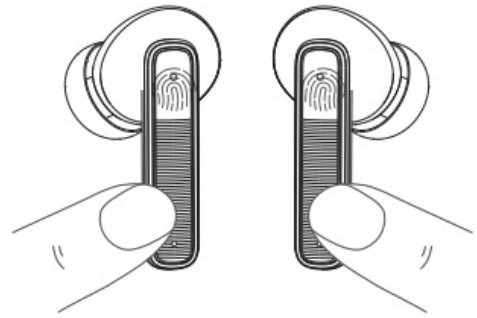

Tap L&R 5 times
simultaneously

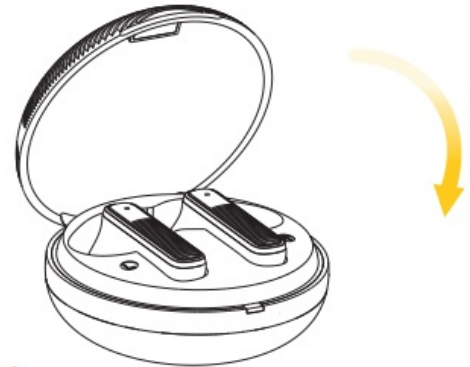
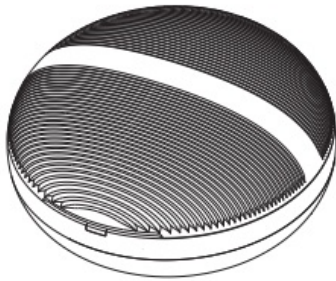





Put earbuds into charging case

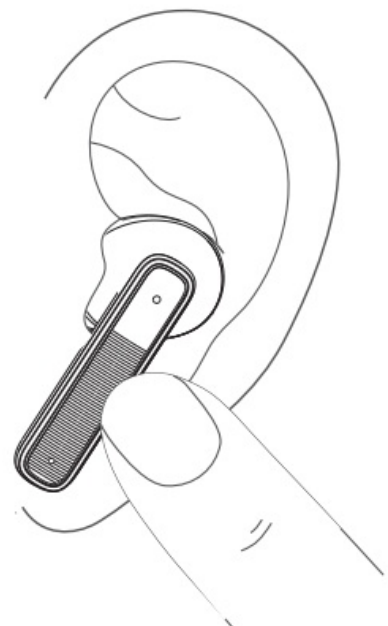

Touch Operation



Left Earbud







 1 x Play / Pause
 Tap the MFB once



 1 x Answer the call
 Tap the MFB once

 2 x Previous Track
 Double tap the left MFB

 2 x End Call /Reject call
 Double tap the MFB



 3 x Volume -
 Triple tap the left MFB



 4 x Game mode
 Four tap the MFB

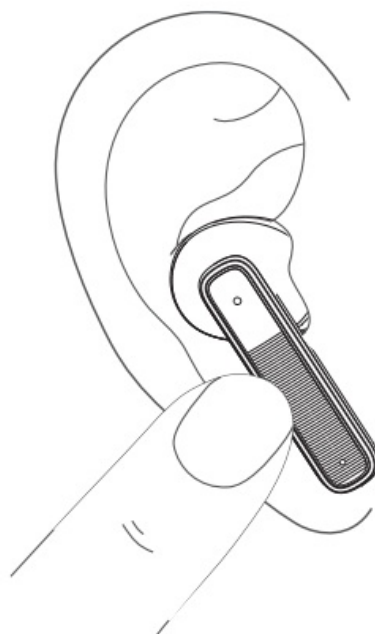

 1.5s Voice assistant
 Press and hold the MFB for 1.5s



Right Earbud







 1x Play / Pause
 Tap the MFB once



 1x Answer the call
 Tap the MFB once

 2x Next Track
 Double tap the right MFB

 2x End Call /Reject call
 Double tap the MFB

 3x Volume +
 Triple tap the right MFB

 4x Game mode
 Four tap the MFB

 1.5s Voice assistant
 Press and hold the MFB for 1.5s

Earbuds low battery alarm

When the battery power is low, every 1 minute voice reminder “Lower battery” and Red light double flashing, until the battery power is run out and turn off.

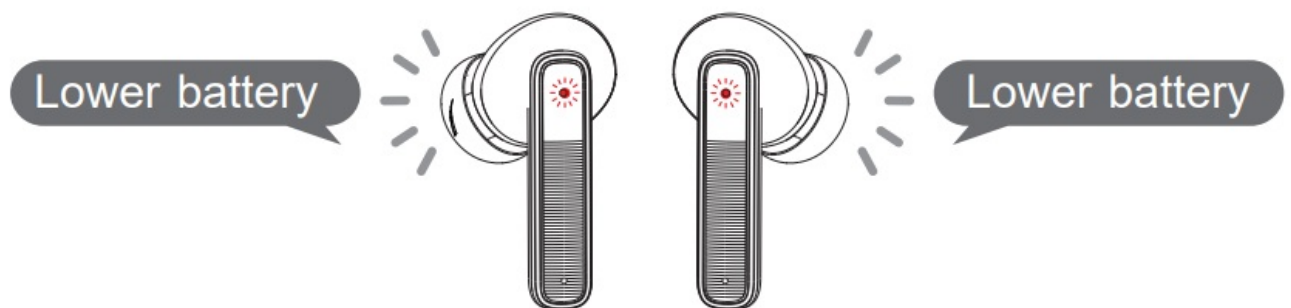

Charge your earbuds

Place your earbuds the charging case and close the lid, earbuds will automatically complete charging.

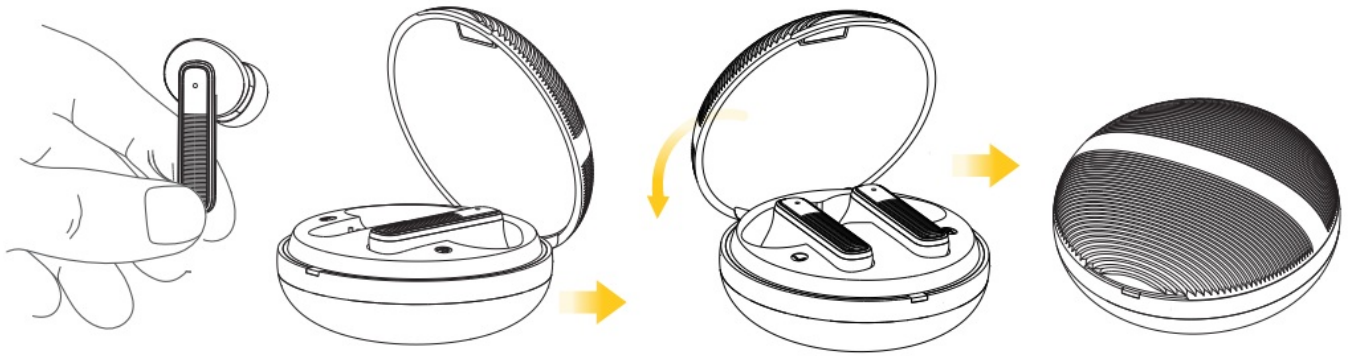

Product Parameter

Earbud(each)

- **Model Name:** HTT-17
- **Bluetooth Version:** V5.4
- **Speaker:** Φ 13mm
- **Bluetooth Range:** 10m/ 33ft(with out obstacles)
- **Technology:** HSP/ HFP/ A2DP/ AVRCP
- **Frequency Range:** 20Hz~20KHz
- **Weight:** 4.38g
- **Size:** 37.4*22.2*25.2mm
- **Charging Time:** 0.5H
- **Battery Capacity:** 40mAh
- **Play Music Time:** 6H
- **Input:** DC 5V \equiv 0.08A

Charging Case

- **Weight:** 41.88g
- **Size:** 56.5*31.3mm
- **Charging Time:** 2H
- **Battery Capacity:** 400mAh
- **Input:** DC 5V \equiv 0.3A

Earbuds Warning

1. Please do not place the product in an environment where the temperature is too

low(below 45°C or below 0°C).

2. Do not dismantle or repair the earbuds under any circumstances. if necessary, please send the product to the seller for repair.
3. Do not throw or drop the earbuds to avoid damage.
4. The earbuds and the BT devices will be disconnected if the distance between them is more than 10 meters.
5. Keep the device and accessories away from children and pets.
6. Do not put the earbuds into the washing machine

Battery Warning

1. The battery in the product may cause a fire disaster or a risk of chemical burning if mishandled.
2. Please charge with a rated voltage charger.
3. The disposal of batteries should obey local law, if possible, please recycle it. Do not dispose it as household garbage, because it may cause an explosion.
4. Users are not allowed to take out or replace the battery in the product unless there is a stipulation in the user manual. It is very hazardous to do this; it may cause damage to the product.

FCC Statement

NOTE: This equipment has been tested and found to comply with the limits for a Class B digital device, pursuant to part 15 of the FCC Rules. These limits are designed to provide reasonable protection against harmful interference in a residential installation. This equipment generates, uses and can radiate radio frequency energy and, if not installed and used in accordance with the instructions, may cause harmful interference to radio communications. However, there is no guarantee that interference will not occur in a particular installation. If this equipment does cause harmful interference to radio or television reception, which can be determined by turning the equipment off and on, the user is encouraged to try to correct the interference by one or more of the following measures:

- Reorient or relocate the receiving antenna.
- Increase the separation between the equipment and receiver.

- Connect the equipment into an outlet on a circuit different from that to which the receiver is connected.
- Consult the dealer or an experienced radio/TV technician for help.

Changes or modifications not expressly approved by the party responsible for compliance could void the user’s authority to operate the equipment.

This device complies with Part 15 of the FCC Rules. Operation is subject to the following two conditions:

1. this device may not cause harmful interference, and
2. this device must accept any interference received, including interference that may cause undesired operation.

Frequently Asked Questions

- **Q: How to reset the earbuds?**
 - A: Follow the reset instructions mentioned in the user manual. Delete Bluetooth records, tap L & R MFB simultaneously, and put the earbuds back in the charging case.

Documents / Resources

| | |
|---|--|
|  | Harmony Twenty Two HTT-17 True Wireless Stereo Earbuds [pdf] User Manual 2BONF-HTT-17, 2BONFH17, HTT-17 True Wireless Stereo Earbuds, H17, True Wireless Stereo Earbuds, Wireless Stereo Earbuds, Stereo Earbuds, Earbuds |
|---|--|

References

- [User Manual](#)

2BONF-HTT-17, 2BONFHTT17, earbuds, Harmony Twenty Two, HTT-17, HTT-17 True Wireless Stereo Earbuds, Stereo Earbuds, True Wireless Stereo Earbuds, Wireless Stereo Earbuds

Leave a comment

Your email address will not be published. Required fields are marked *

Comment *

Name

Email

Website

☐ Save my name, email, and website in this browser for the next time I comment.

Post Comment

Search:

e.g. whirlpool wrf535swhz

Search

[Manuals+](#) | [Upload](#) | [Deep Search](#) | [Privacy Policy](#) | [@manuals.plus](#) | [YouTube](#)

This website is an independent publication and is neither affiliated with nor endorsed by any of the trademark owners. The "Bluetooth®" word mark and logos are registered trademarks owned by Bluetooth SIG, Inc. The "Wi-Fi®" word mark and logos are registered trademarks owned by the Wi-Fi Alliance. Any use of these marks on this website does not imply any affiliation with or endorsement.