

# Hard Head 006402 Cycle Storage System Instruction Manual

[Home](#) » [Hard Head](#) » Hard Head 006402 Cycle Storage System Instruction Manual 

## Contents

- [1 Hard Head 006402 Cycle Storage System Instruction](#)
- [2 SAFETY INSTRUCTIONS](#)
- [3 SYMBOLS](#)
- [4 TECHNICAL DATA](#)
- [5 DESCRIPTION](#)
- [6 TOOLS NEEDED FOR CORRECT INSTALLATION](#)
- [7 ACCESSORIES FOR ATTACHMENT/INSTALLATION](#)
- [8 WORKTOPS](#)
- [9 END FASTENER/INTERMEDIATE FASTENER FOR TOOL PANEL](#)
- [10 MAX LOAD](#)
- [11 INSTALLATION](#)
- [12 INSTALLATION WITH INTERMEDIATE FASTENER 006406](#)
- [13 Documents / Resources](#)
- [14 Related Posts](#)



Hard Head 006402 Cycle Storage System Instruction



Jula AB reserves the right to make changes to the product. Jula AB Claims copyright on this documentation. It is not allowed to modify or alter this documentation in any way and the manual shall be printed and used as it is in relation to the product. For the latest version of operating instructions, refer to the Jula website.

## SAFETY INSTRUCTIONS

### IMPORTANT:

Read these instructions carefully before installation and save them for future reference.

### WARNING!

- The product is heavy!
- At least two persons are needed to lift and install the product, otherwise there is a risk of back injury or other personal injury.
- Never leave children unattended near the product.

## SYMBOLS

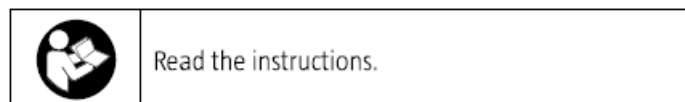

## TECHNICAL DATA

### External dimension

- Storage cabinet with double door: W91.5 x H200 x D46 cm
- Storage cabinet with single door: W60 x H200 x D46 Cm
- Wall cabinet: W68 x H35 X D28 cm
- Wall cabinet 2 doors: W68 x H68 x D30 cm
- Wall cabinet for corner cupboard: W86.4 x H35 x D86.4 cm
- Tool cabinet with 2 doors : W68 x H91x D46 cm

- Tool cabinet with drawers: W68 x H91 x D46 cm
- Waste cabinet (part no. 006413): W68 x H91x D45.8 cm
- Corner cupboard: W86.4 x H91x D86.4 cm

## DESCRIPTION

### HARD HEAD'S FLEXIBLE STORAGE RANGE

The series consists of different modules that can be bought separately and built together to suit your needs.

- Storage cabinet with double door (part no. 006412)
- Storage cabinet with single door (part no. 006411)
- Wall cabinet (part no. 006410)
- Wall cabinet, 2 doors (part no. 006409)
- Wall cabinet for corner cupboard (part no. 022782)
- Tool panel (part no. 022781)
- Tool panel for corner cupboard (part no. 022781)
- Tool cabinet with 2 doors (part no. 006414)
- Tool cabinet 5 drawers (part no. 006415)
- Tool cabinet 7 drawers (part no. 006416)
- Tool cabinet 9 drawers (part no. 006417)
- Waste cabinet (part no. 006413)
- Corner cupboard (part no. 022779)
- End fastener for tool panel (part no. 006406)
- Intermediate fastener for tool panel with corner position (part no. 022804)
- Intermediate fastener for tool panel (part no. 006407, to be withdrawn)
- Worktop 68 cm. Fits over cupboard. (part no. 006402)
- Worktop 136 cm. Fits over two cupboards. (part no. 006403)
- Worktop 204 cm. Fits over three cupboards. (part no. 006404)
- Corner worktop (part no. 022783)

### TOOLS NEEDED FOR CORRECT INSTALLATION

- Adjustable spanner
- Combination spanner
- Cross-head bit
- Spirit level with magnetic mount
- Sleeve
- Set square
- Phillips screwdriver
- Cordless drill
- Tape measure
- Pen
- Concrete drill

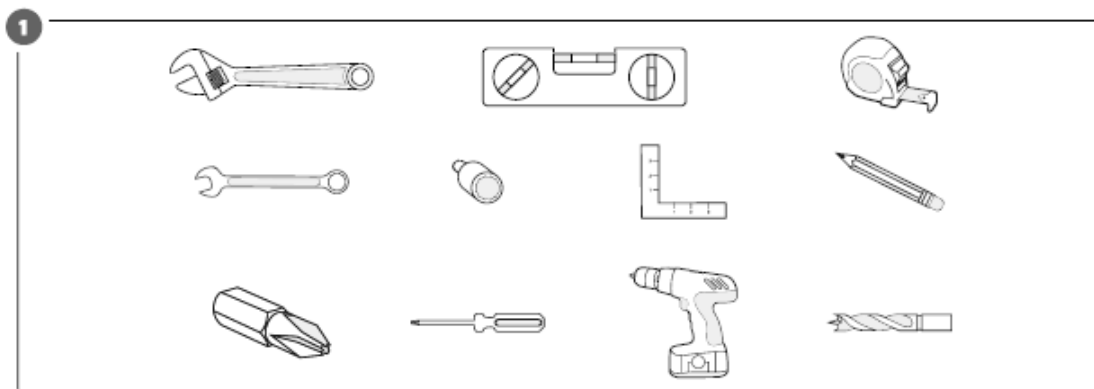

## ACCESSORIES FOR ATTACHMENT/INSTALLATION

1. Hex screw M6 x 16
2. NutM6
3. Plastic plug
4. Hex screw MB x 16
5. Flat washer $\varnothing$  8
6. Spring washer $\varnothing$  8
7. Wood screw ST6 x 16
8. Countersunk screw M6 x 16

FIG. 2

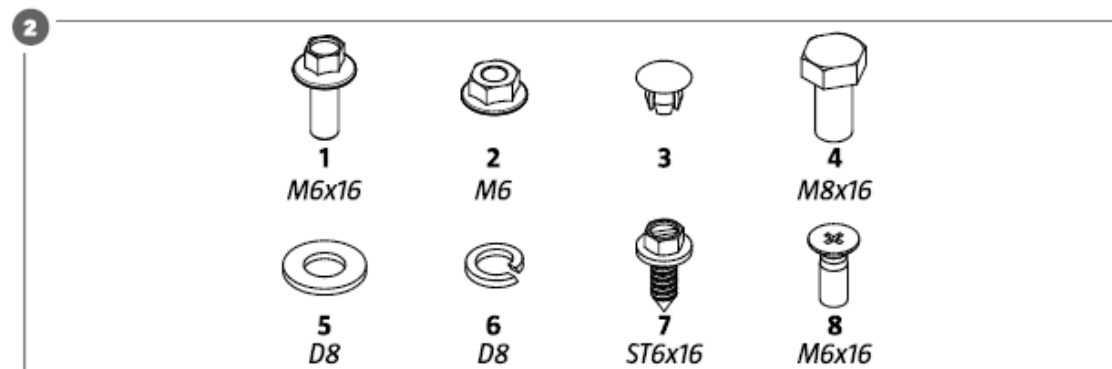

## WORKTOPS

1. Worktop 68 cm. Fits over cupboard. (part no. 006402)
2. Worktop 136 cm. Fits over two cupboards. (part no. 006403)
3. Worktop 204 cm. Fits over three cupboards. (part no. 006404)
4. Corner worktop (part no. 022783)

FIG. 3

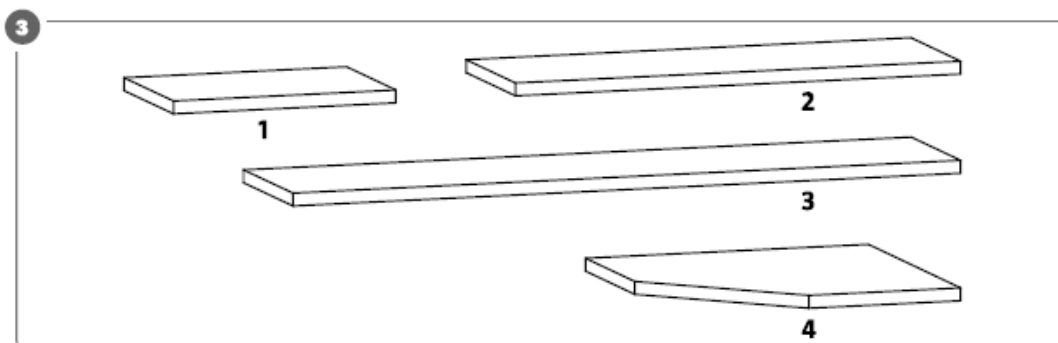

## END FASTENER/INTERMEDIATE FASTENER FOR TOOL PANEL

1. End fastener for tool panel (part no. 006406)
2. Intermediate fastener for tool panel with corner position (part no. 022804)
3. Intermediate fastener for tool panel (part no. 006401, to be withdrawn)

FIG. 4

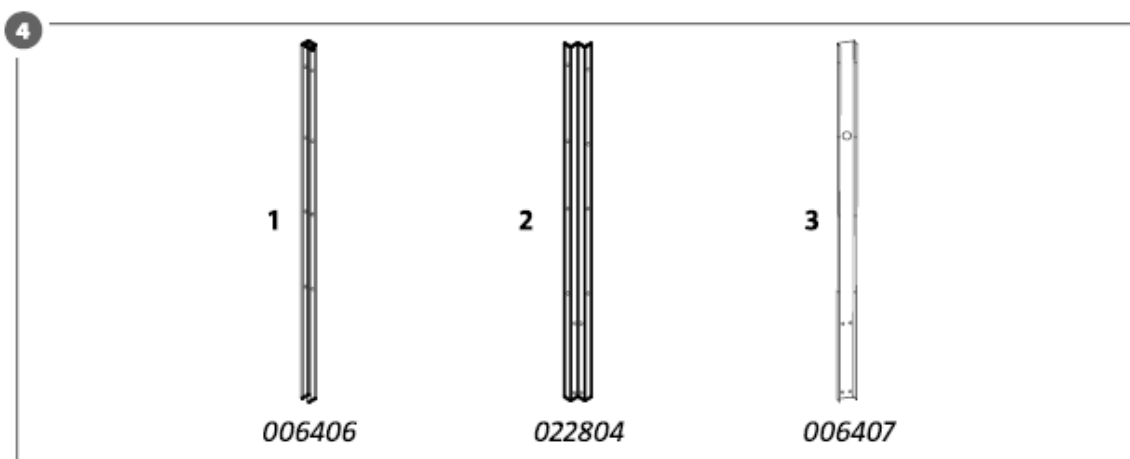

## MAX LOAD

1. Storage cabinet with double door, 300 kg
2. Storage cabinet with single door, 180 kg
3. Wall cabinet, 15 kg
4. Tool panel, 10 kg
5. Wall cabinet for corner cupboard, 25 kg
6. Tool panel for corner cupboard, 10 kg
7. Tool cabinet with 2 doors, 60 kg
8. Waste cabinet, 90 kg
9. Wall cabinet 2 doors, 30 kg
10. Corner cupboard, 60 kg
11. Tool cabinet 5 drawers, 150 kg
12. Tool cabinet 7 drawers, 210 kg
13. Tool cabinet 9 drawers, 270 kg

FIG. 5

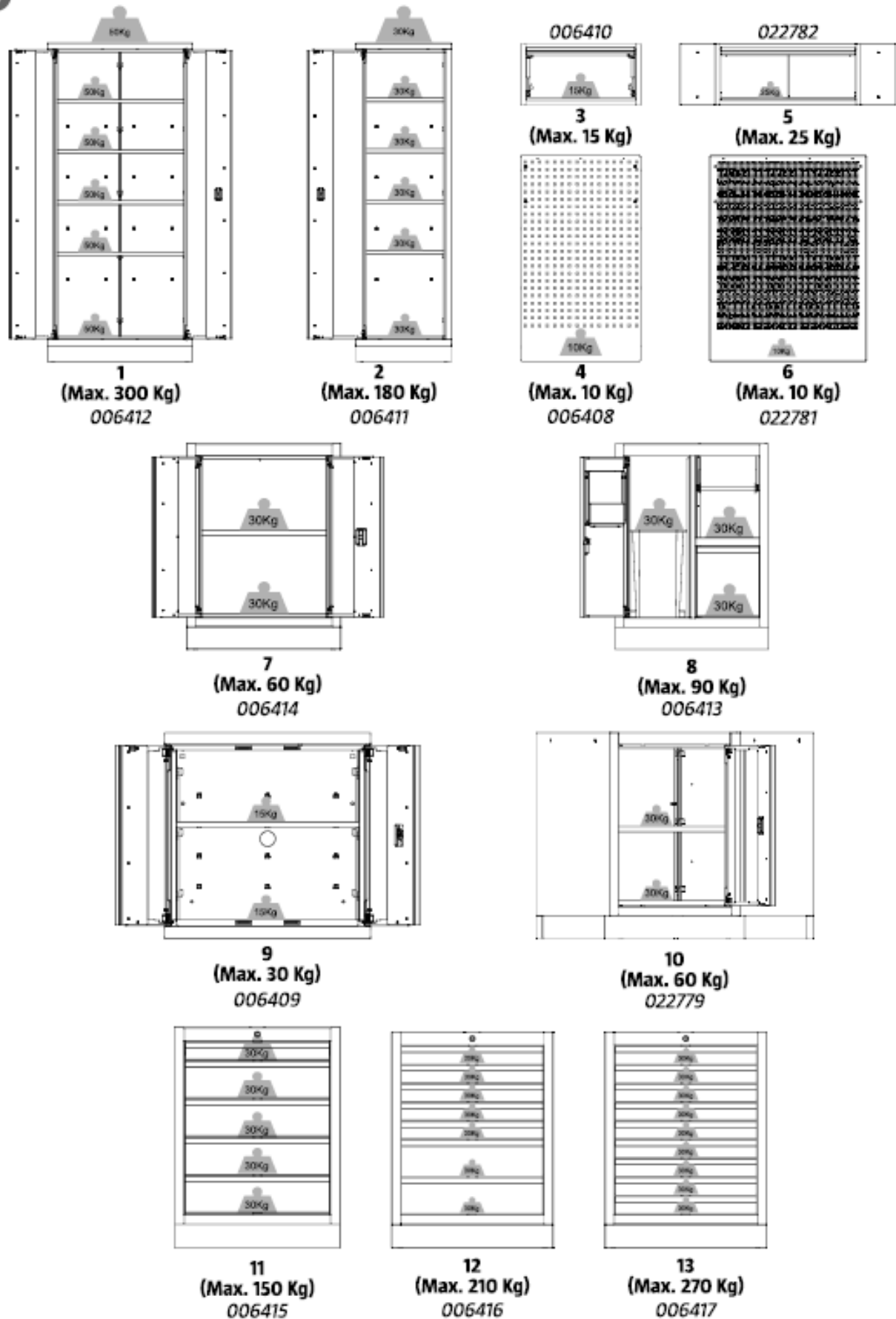

## INSTALLATION

**Note** where wall sockets are located in the room when planning the configuration and installation.

## INSTALLATION WITH INTERMEDIATE FASTENER 006406

### Fitting the levelling feet

Optional to fit levelling feet (part no. 017409). Use a spirit level to ensure that the product is upright. FIG. 6

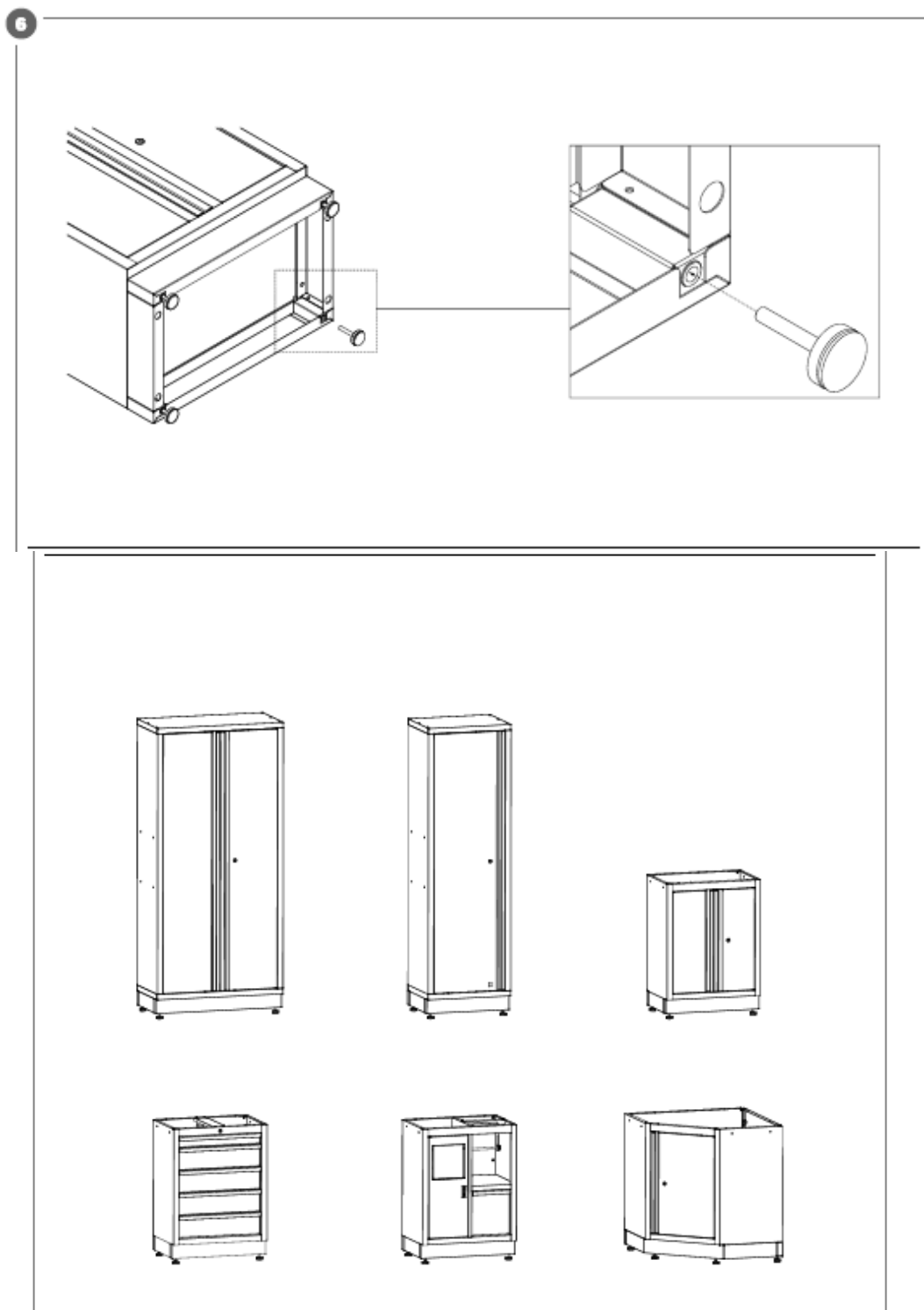

### NOTE:

Levelling feet do not work when using intermediate fastener O06407.

Mounting the intermediate fastener FIG. 7

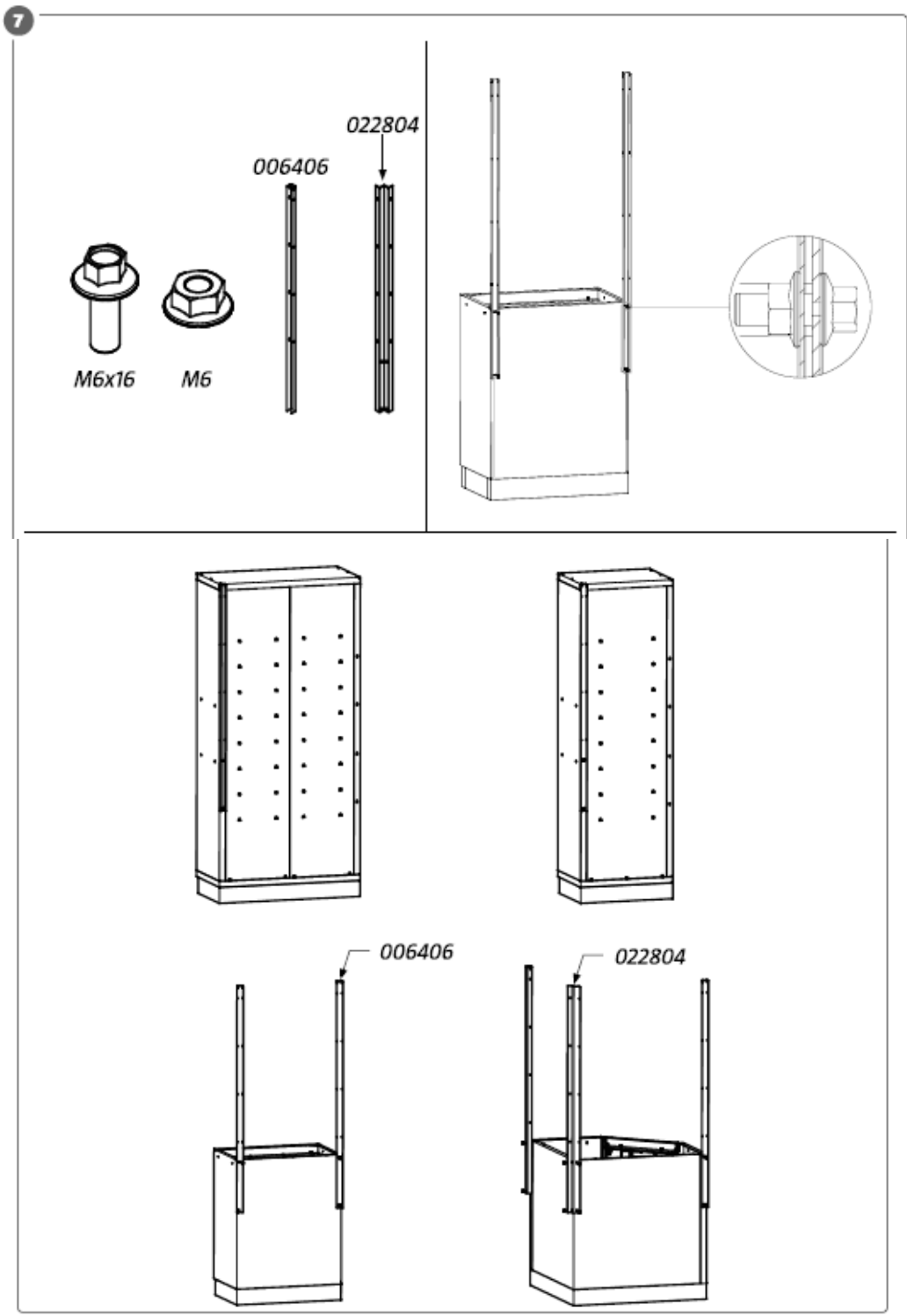

Installing the tool panel FIG. 8



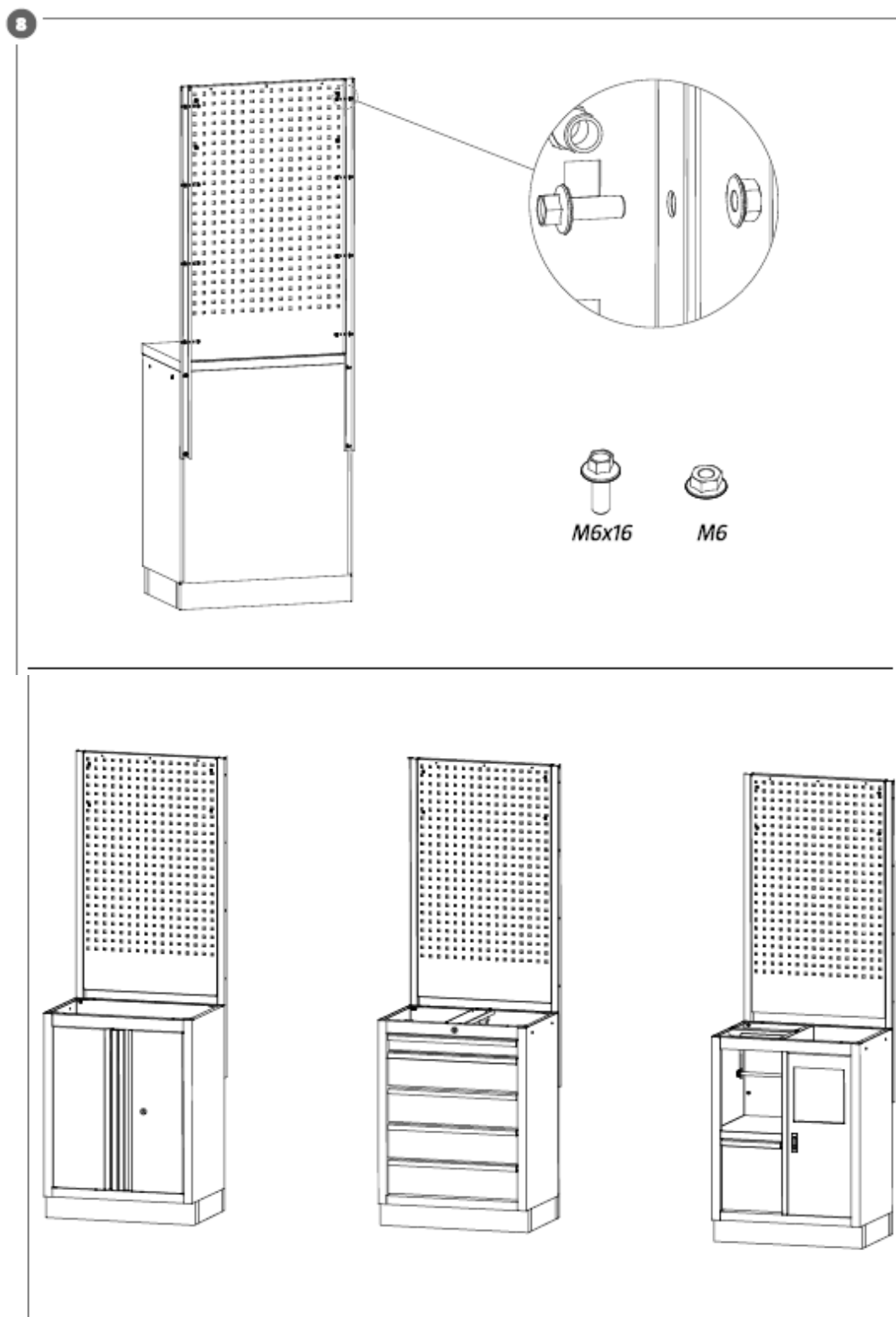

Connecting the storage cabinet, tool cabinet/ waste cabinet/corner cupboard FIG. 9

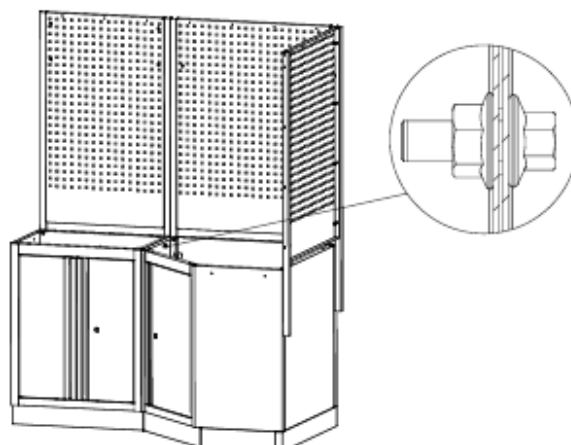
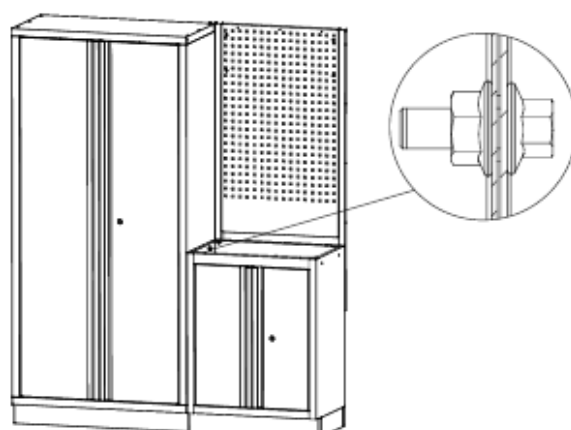

Installing the worktop FIG. 10

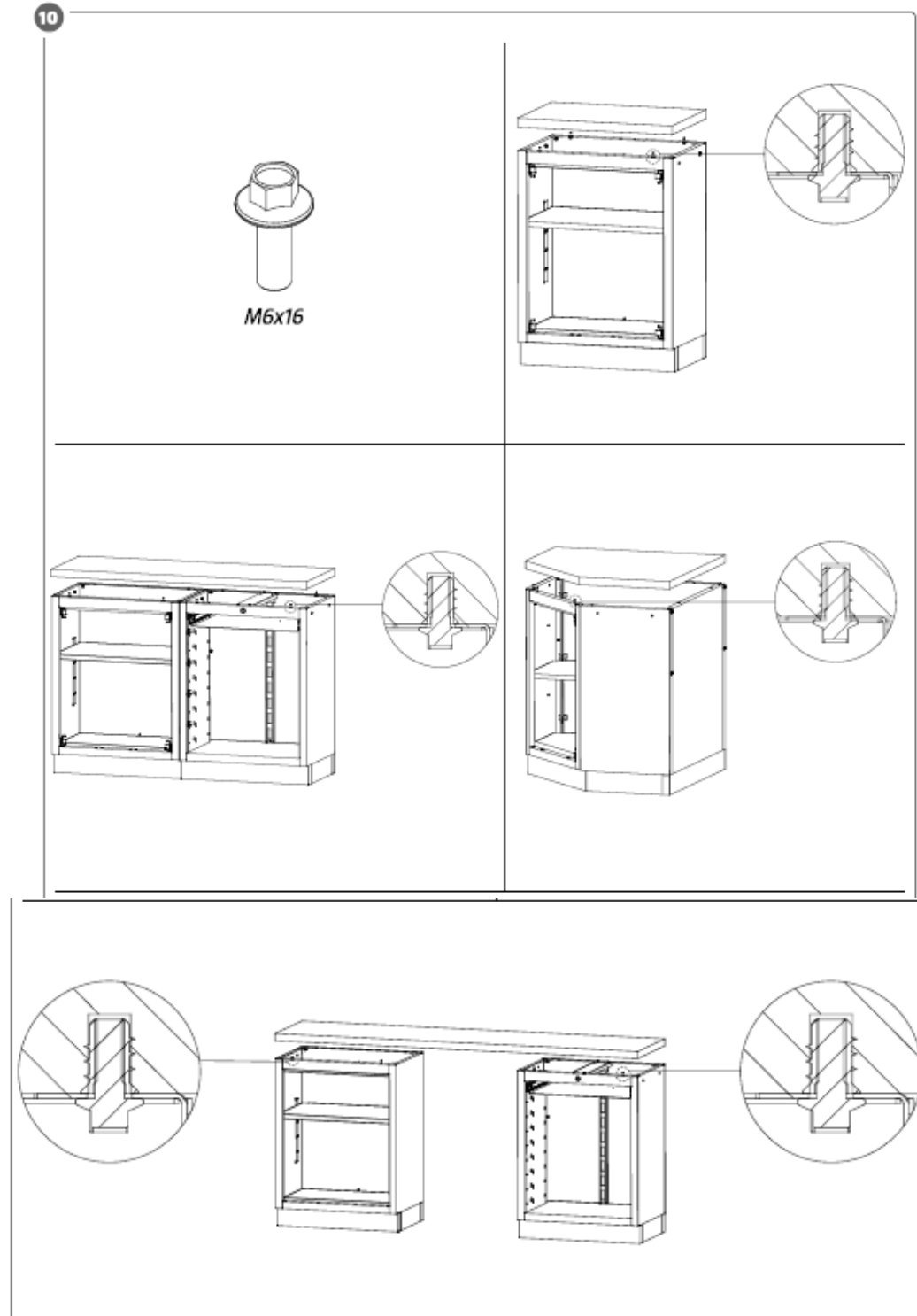

Installing the corner lower cupboard, tool panel, top cupboard FIG. 11

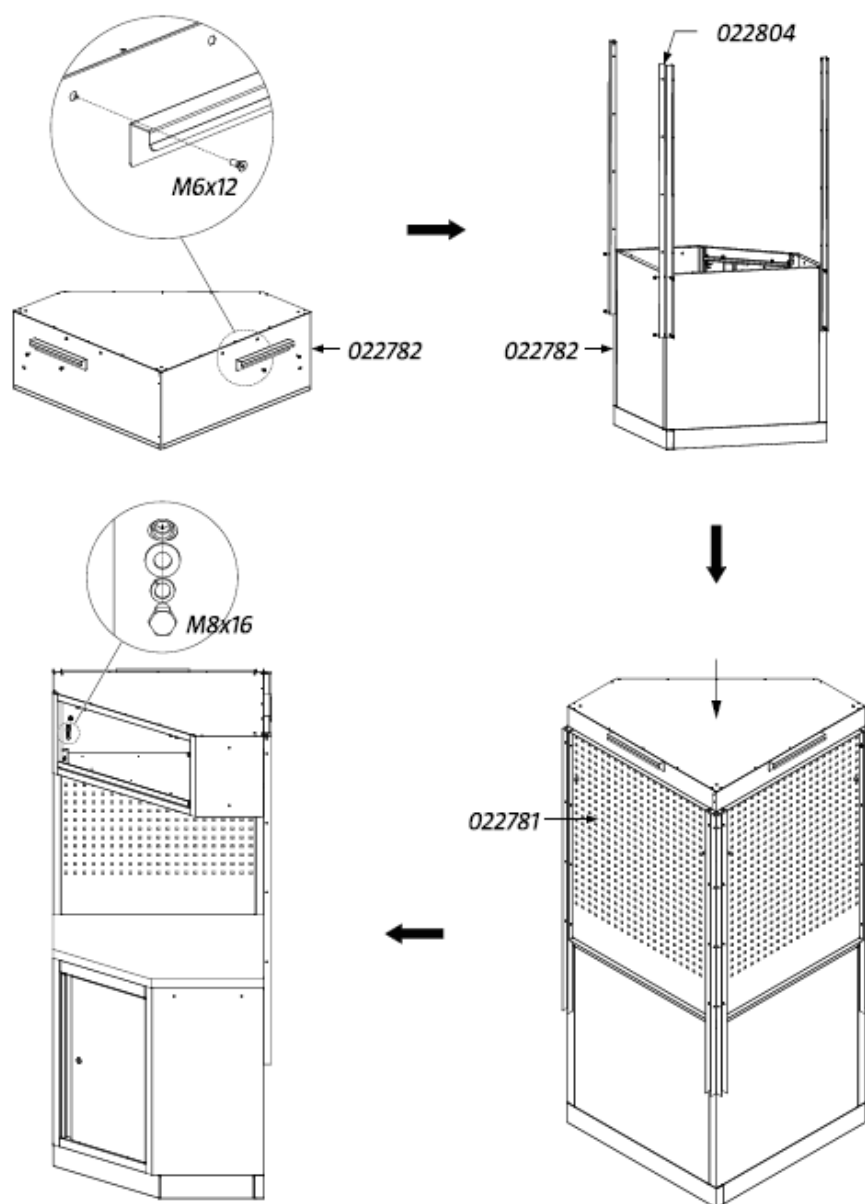

### Interconnection of middle and end fasteners

1. Fastening in corner not necessary. FIG. 12



M6x16



M6

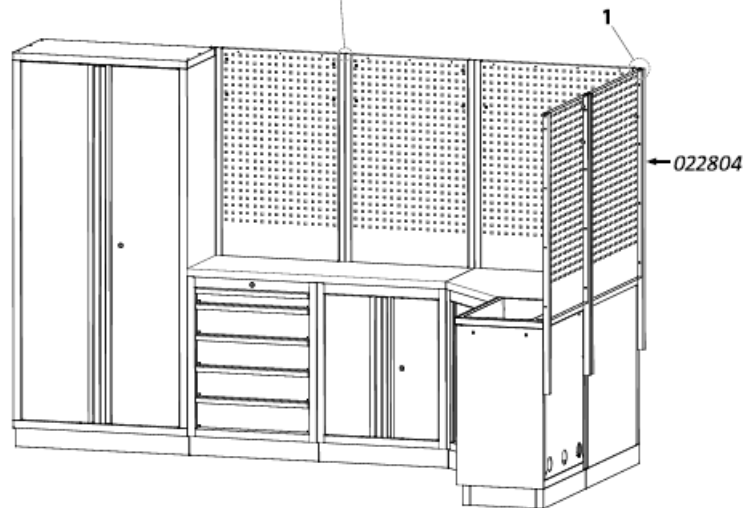
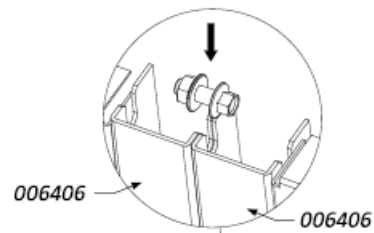

### Installing the top cupboard

1. Prefit screws and washers on hanger panel.
2. Hang up the top cupboard and tighten the screws. FIG. 13

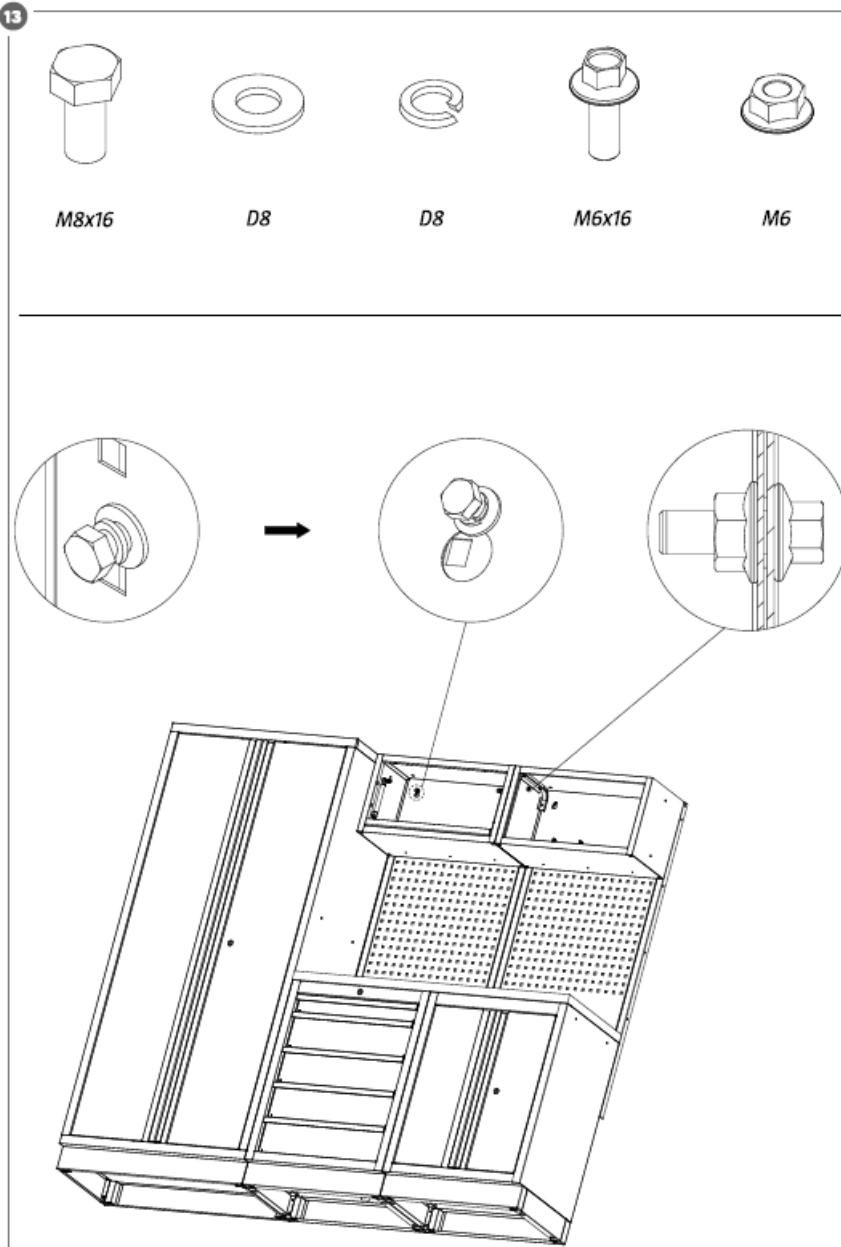

**NOTE:** Julia sells two different types of wall cabinet (006410, 006409)

#### **INSTALLATION WITH INTERMEDIATE FASTENER 006407**

Connecting the storage cabinet, tool cabinet/ waste cabinet/corner cupboard FIG. 14

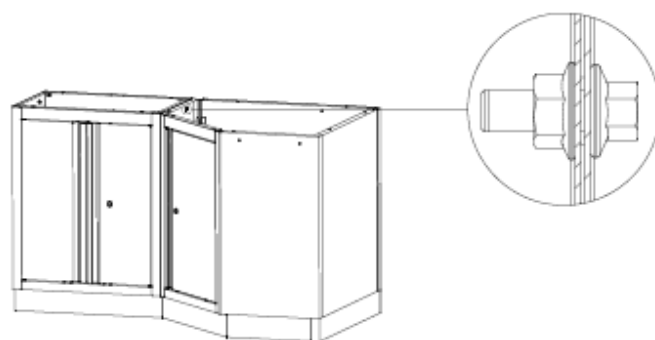
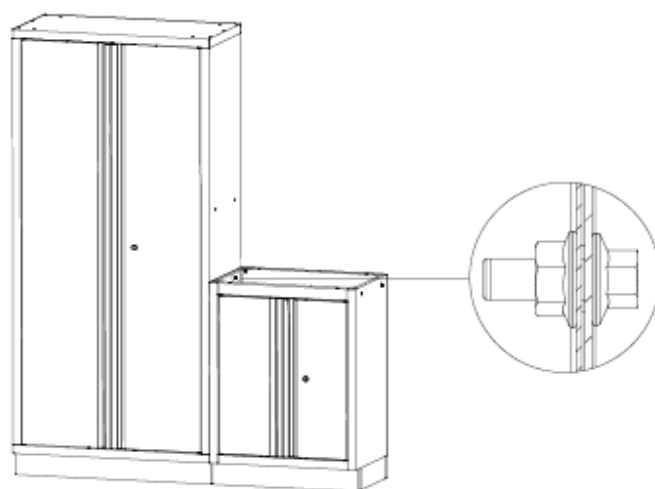

Installing the worktop FIG. 15

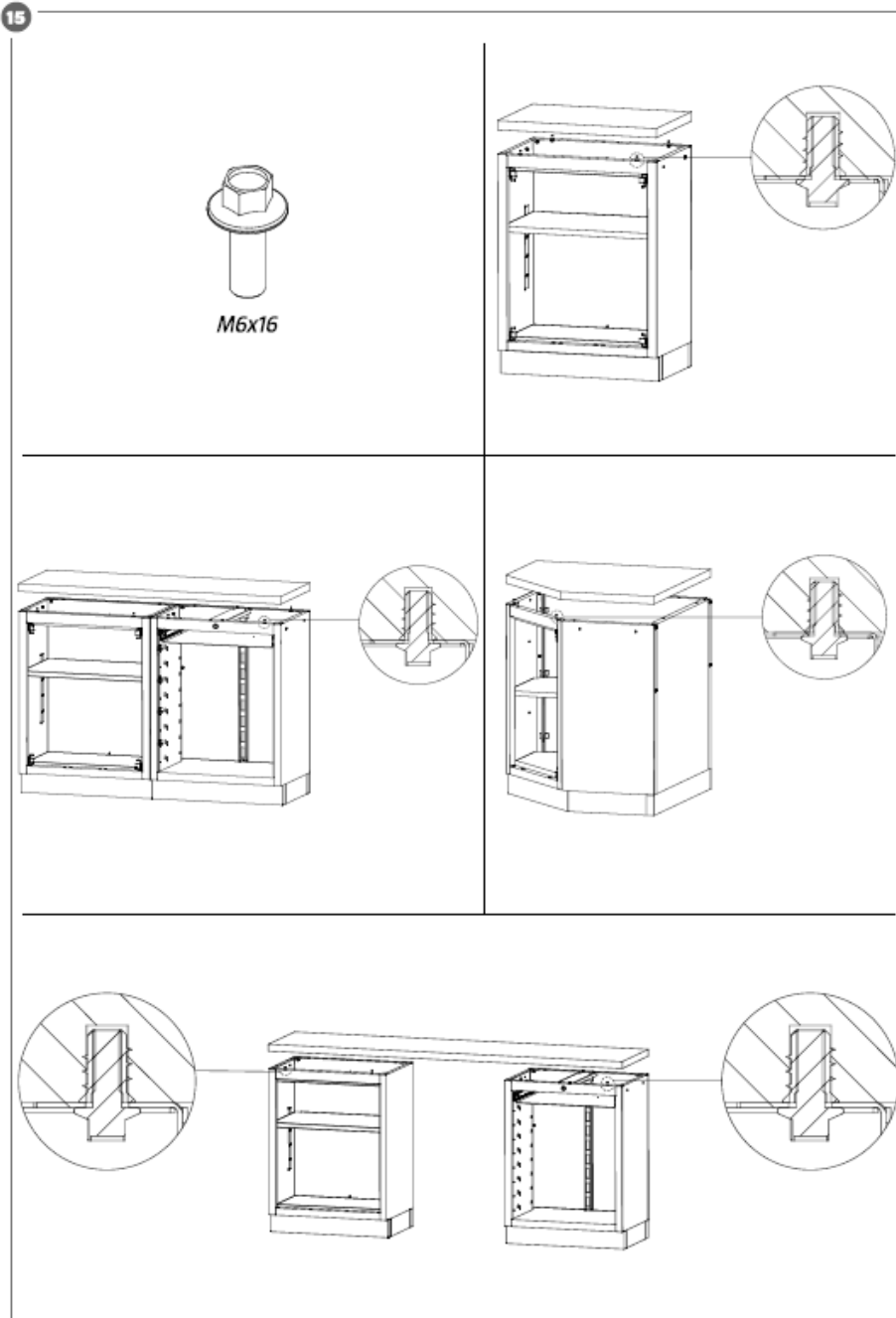

Mounting the intermediate fastener 006407 FIG. 16



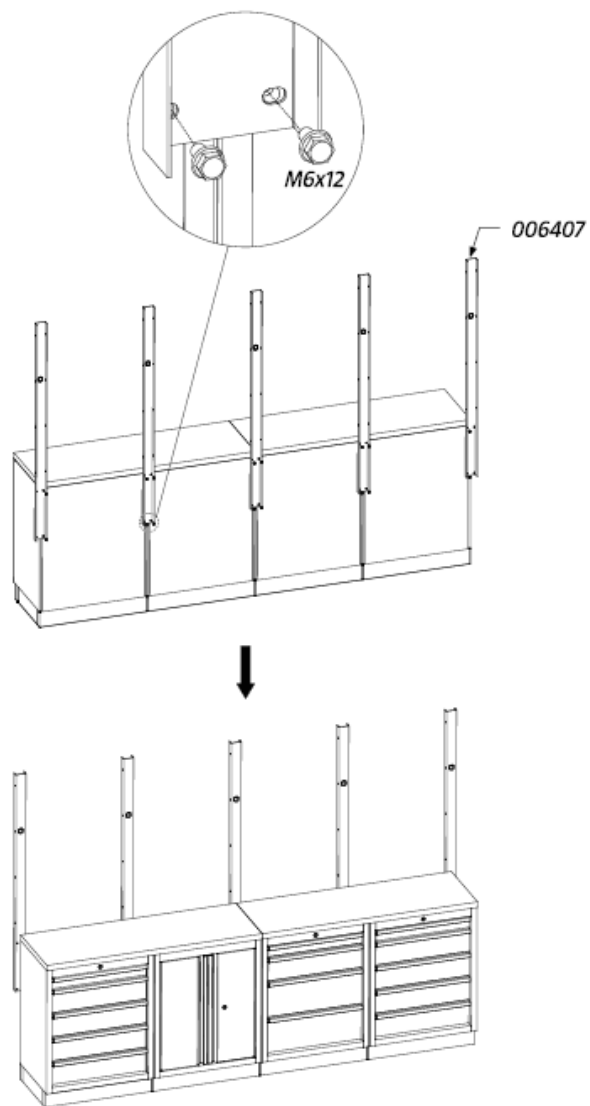

Installing the tool panel FIG. 17

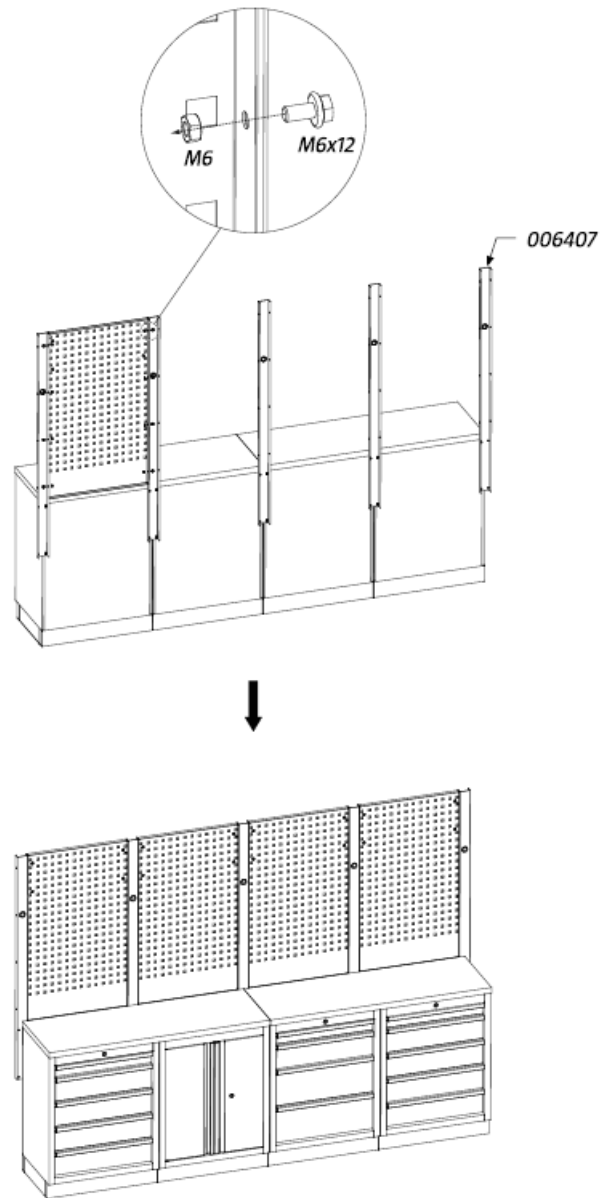

### Installing the top cupboard

1. Prefit screws and washers on hanger panel.
2. Hang up the top cupboard and tighten the screws. FIG. 18

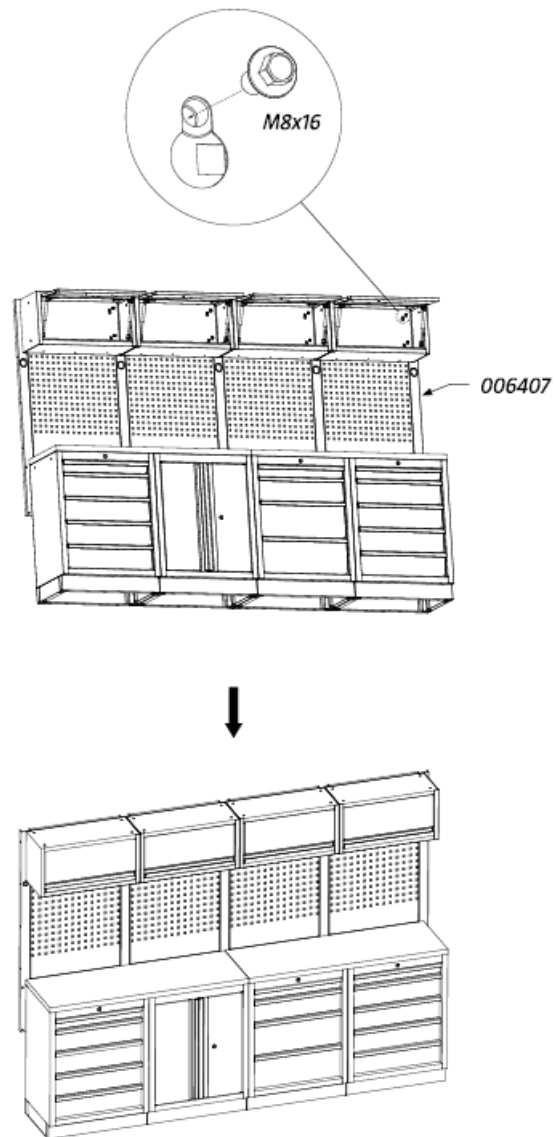

**NOTE:** Julia sells two different types of wall cabinet (006410, 006409)  
Connecting the storage cabinet with tool cabinet/waste cabinet/corner cupboard FIG. 19

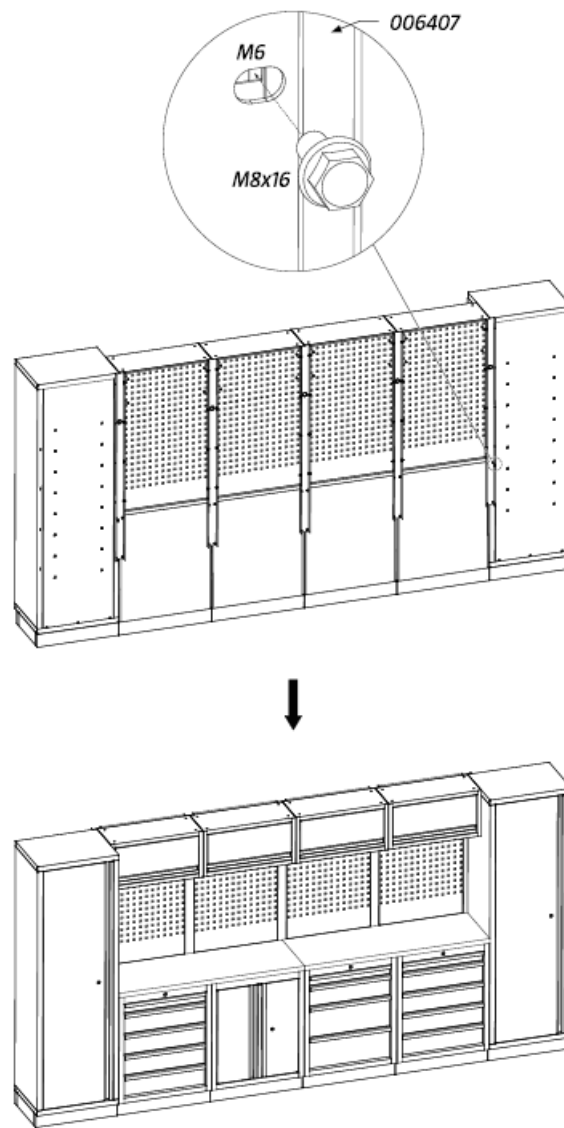

REMOVAL OF DRAWERS Release and take out the drawer by pressing the catches on the sides of the drawer as illustrated. FIG. 20

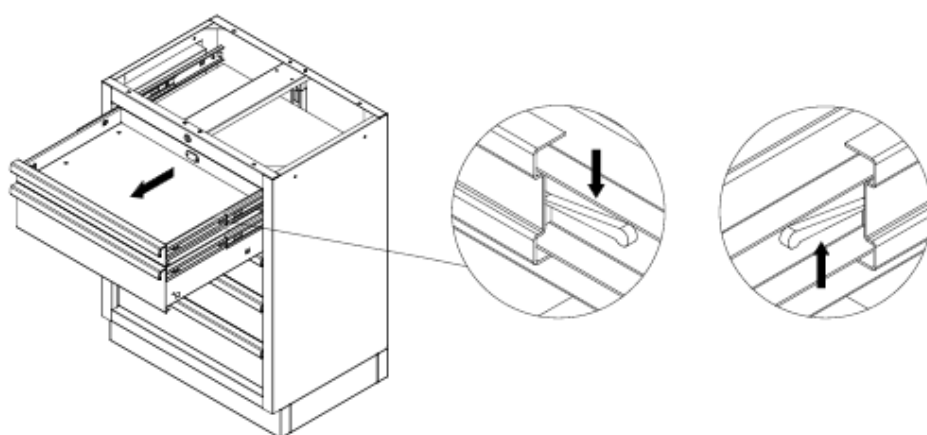

## Documents / Resources



[Hard Head 006402 Cycle Storage System](#) [pdf] Instruction Manual  
006402, Cycle Storage System, Storage System, Cycle Storage, Storage