



# Hanwha Vision TNM Series Network Camera User Guide

[Home](#) » [Hanwha Vision](#) » Hanwha Vision TNM Series Network Camera User Guide 

## Contents

- 1 [Hanwha Vision TNM Series Network Camera](#)
- 2 [Product Information](#)
- 3 [Product Usage Instructions](#)
- 4 [FAQ](#)
- 5 [Warranty](#)
- 6 [SAFETY INFORMATION](#)
- 7 [COMPONENT](#)
- 8 [Installation Instructions](#)
- 9 [CONNECTING TO WIFI](#)
- 10 [CONTACT](#)
- 11 [Documents / Resources](#)
  - 11.1 [References](#)
- 12 [Related Posts](#)



**Hanwha Vision TNM Series Network Camera**



## Product Information

### Specifications

- Models: TNM-C4940TD, TNM-C4950TD, TNM-C4960TD, TNM-C4940TDR, TNM-C4942TDR
- Manufacturer: Hanwha Vision
- Environmentally friendly product with eco-mark
- LEDs with Risk Group 1
- EU RoHS Directive compliant
- Power: DC 12V
- Protection Rating: IP66
- Not Included: Stainless steel mount strap, Micro SD Card, Wi-Fi dongle, OTG adapter

### Product Usage Instructions

1. Connect the OTG adapter (5-pin) and Wi-Fi dongle to the micro USB terminal.
2. Password Requirements:
  - 8-9 digits: Use at least 3 uppercase/lowercase letters, numbers, and special characters.
  - 10-15 digits: Use at least 2 types of the mentioned characters.
  - Avoid repeating characters or consecutive keyboard inputs for higher security.
3. If you lose your password, press the [RESET] button to initialize the product.
4. Install the Wisenet Installation application.
5. Select the camera SSID after turning on the WiFi.
6. Run the Wisenet Installation application to log in to the camera and view the video.
7. You can adjust the angle of view while watching the video through your smartphone.

### FAQ

- **Q:** What should I do if I forget my password?
- **A:** You can press the [RESET] button to initialize the product if you forget your password. Avoid using a memo pad or memorizing it to prevent loss.

- **Q:** What are the password requirements for connecting to WiFi?
- **A:** For a new password with 8 to 9 digits, you must use at least 3 uppercase/lowercase letters, numbers, and special characters. For a password with 10 to 15 digits, you must use at least 2 types of those mentioned. Avoid repeating characters or consecutive keyboard inputs for higher security.

### Important

Please check 'Manuals' from our website, before connecting to the Supply,

<https://www.hanwhavision.com/en/download-data/>.

### Warranty

- Please check "Product warranty information" on our website.  
<https://www.hanwhavision.com/en/support/warranty/>
- We recommend using the officially compatible VMS version or the latest Hanwha NVR version when integrating with VMS or Hanwha NVR.
- The Risk Group 1 of LEDs is included in the equipment, so should be attached RG1 warning label at the end-product.



- Hanwha Vision cares for the environment at all product manufacturing stages and is taking measures to provide customers with more environmentally friendly products.
- The Eco mark represents Hanwha Vision's devotion to creating environmentally friendly products and indicates that the product satisfies the EU RoHS Directive.

### Correct Disposal of This Product (Waste Electrical & Electronic Equipment)

- (Applicable in the European Union and other European countries with separate collection systems) This marking on the product, accessories or literature indicates that the product and its electronic accessories (e.g. charger, headset, USB cable) should not be disposed of with other household waste at the end of their working life. To prevent possible harm to the environment or human health from uncontrolled waste disposal, please separate these items from other types of waste and recycle them responsibly to promote the sustainable reuse of material resources.
- Household users should contact either the retailer where they purchased this product, or their local government office, for details of where and how they can take these items for environmentally safe recycling.
- Business users should contact their supplier and check the terms and conditions of the purchase contract.
- This product and its electronic accessories should not be mixed with other commercial wastes for disposal.



### Correct disposal of batteries in this product

(Applicable in the European Union and other European countries with separate battery return systems.)

- This marking on the battery, manual or packaging indicates that the batteries in this product should not be disposed of with other household waste at the end of their working life. Where marked, the chemical symbols Hg, Cd or Pb indicate that the battery contains mercury, cadmium or lead above the reference levels in EC Directive 2006/66. If batteries are not properly disposed of, these substances can cause harm to human health or the environment.
- To protect natural resources and to promote material reuse, please separate batteries from other types of waste and recycle them through your local, free battery return system.



## SAFETY INFORMATION

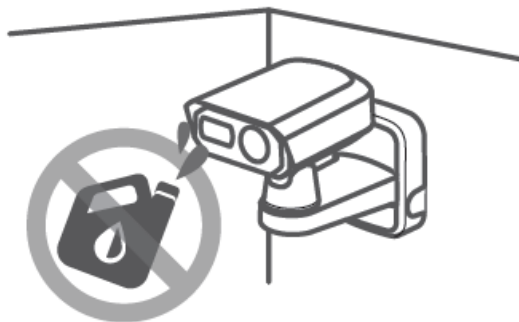
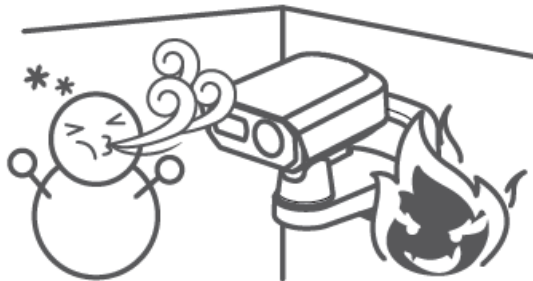
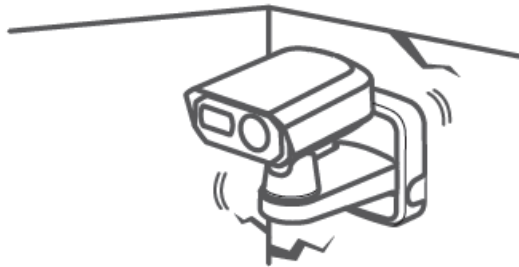

## COMPONENT

- As for each sales country, accessories are not the same.

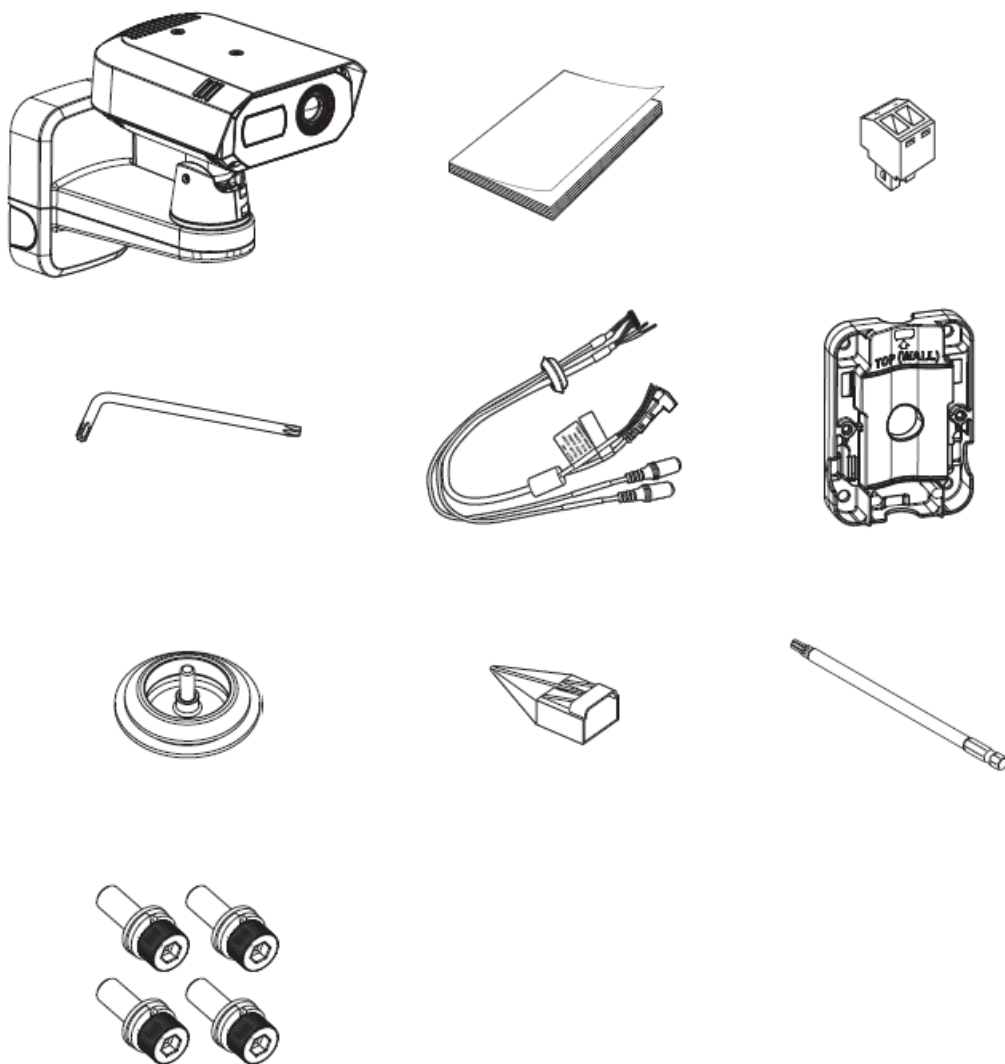

## Installation Instructions

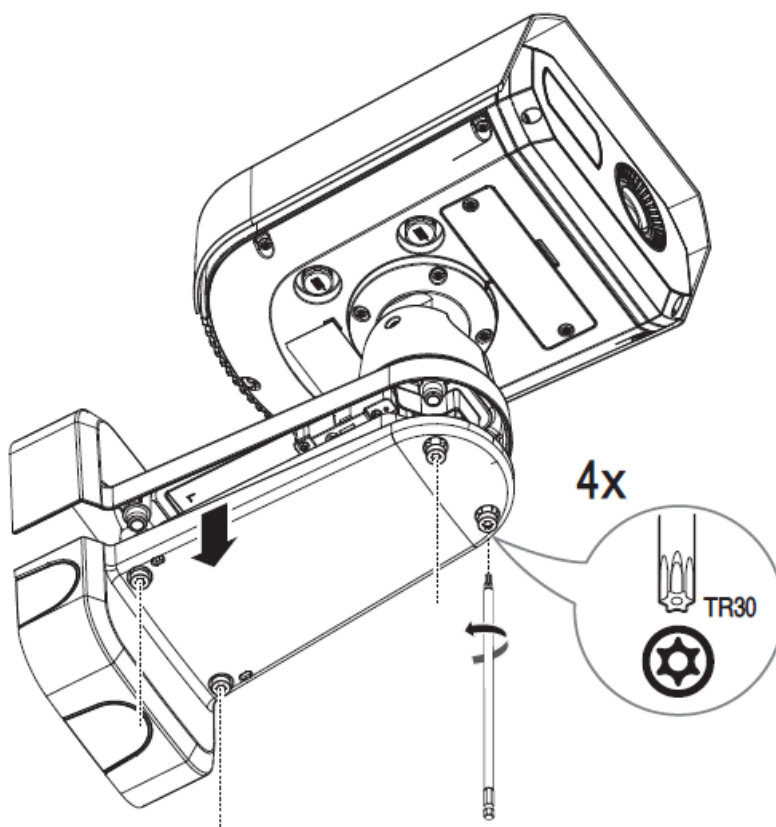

- When installing on a wall

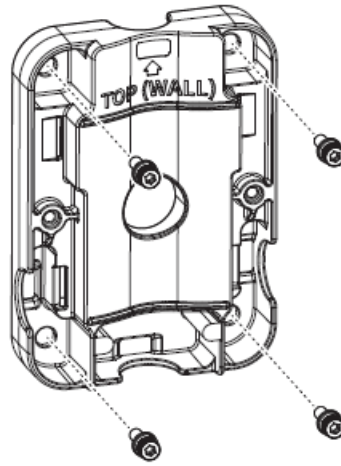

- When installing on a pole (Not Included Stainless steel mount strap)

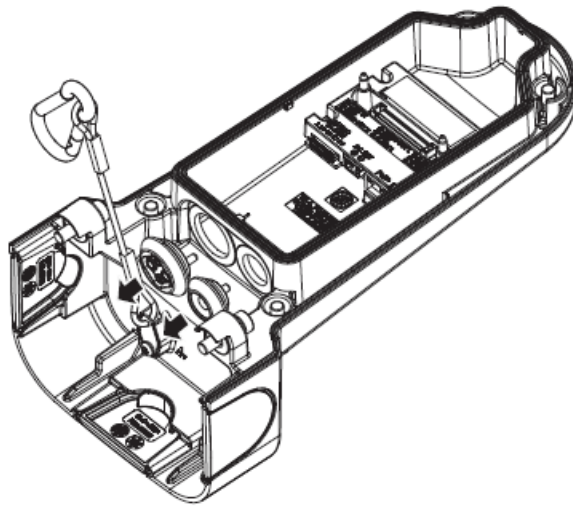
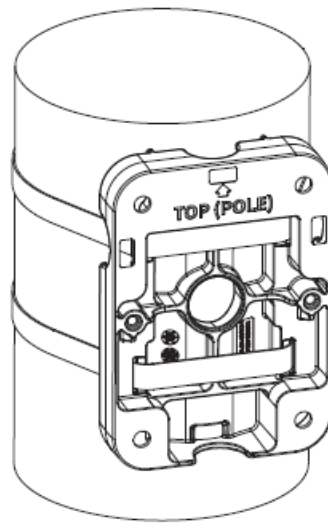

- Installing network cable (IP66)

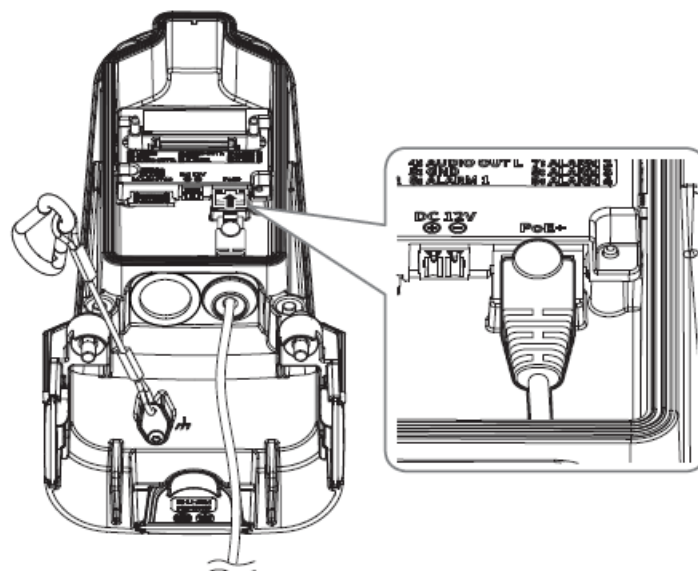
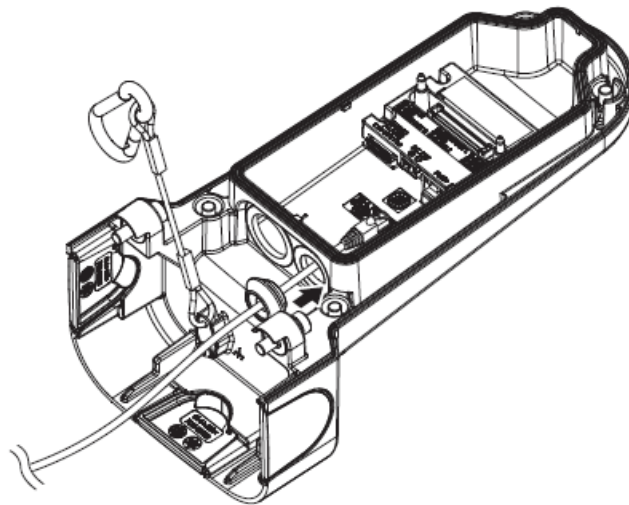
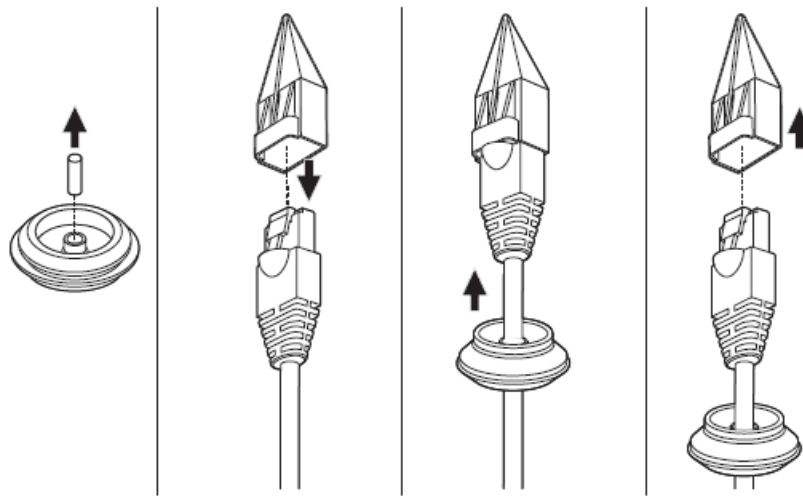

- Installing audio/alarm cables



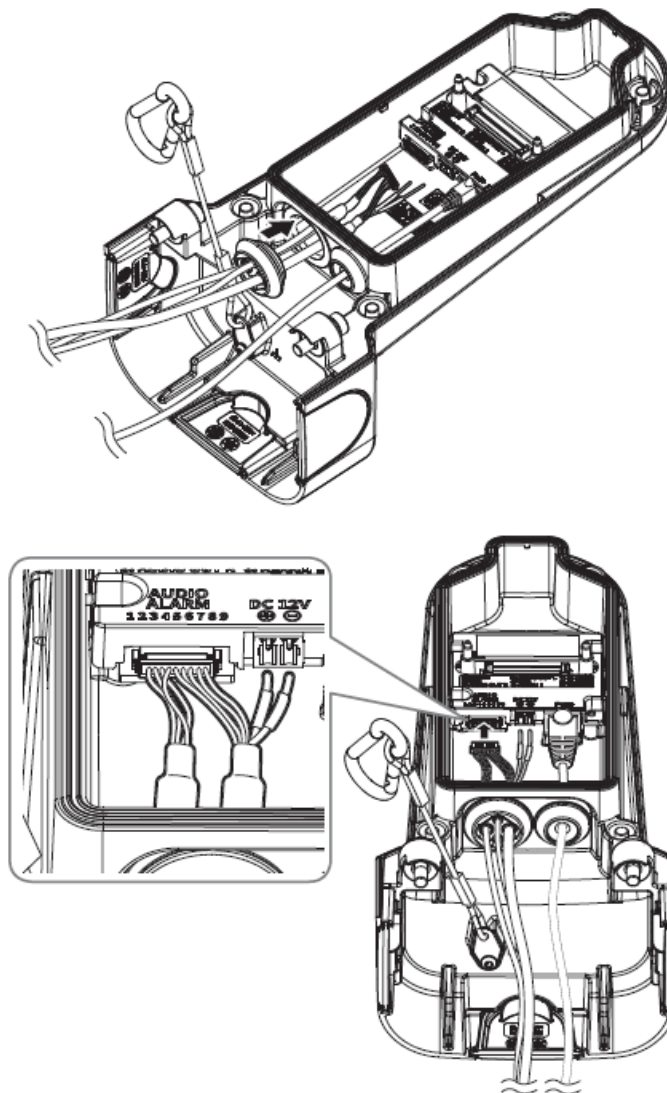

- When connecting DC 12V Power cables

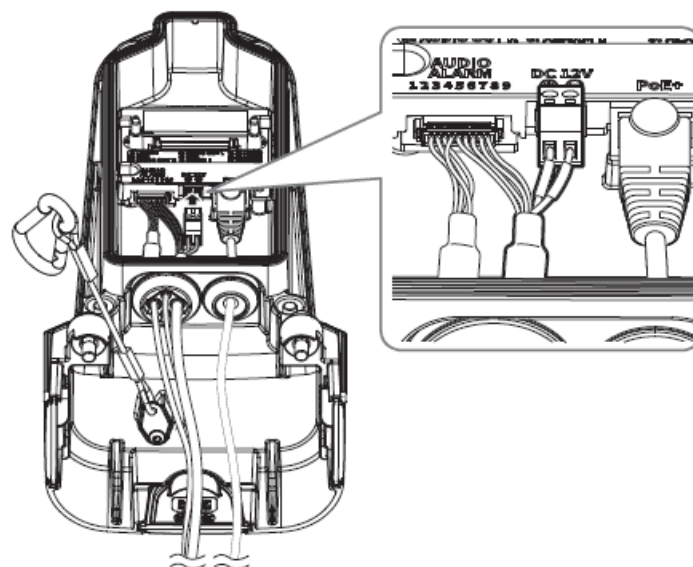

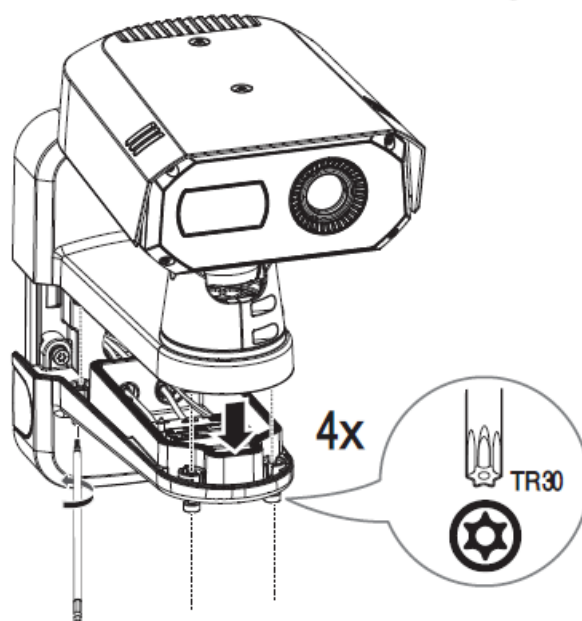
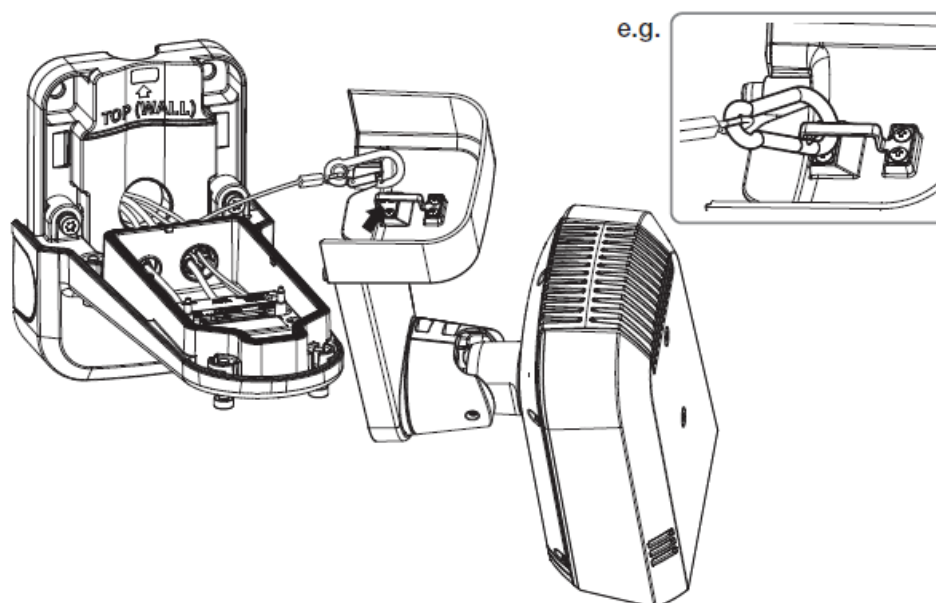
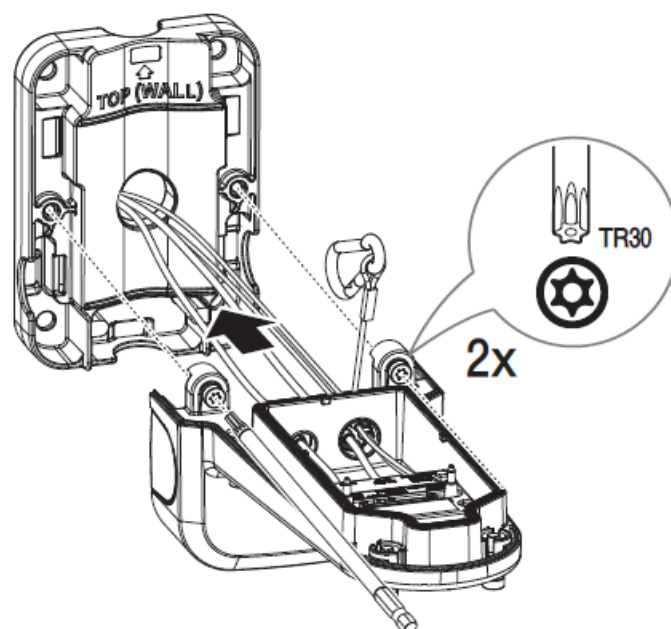

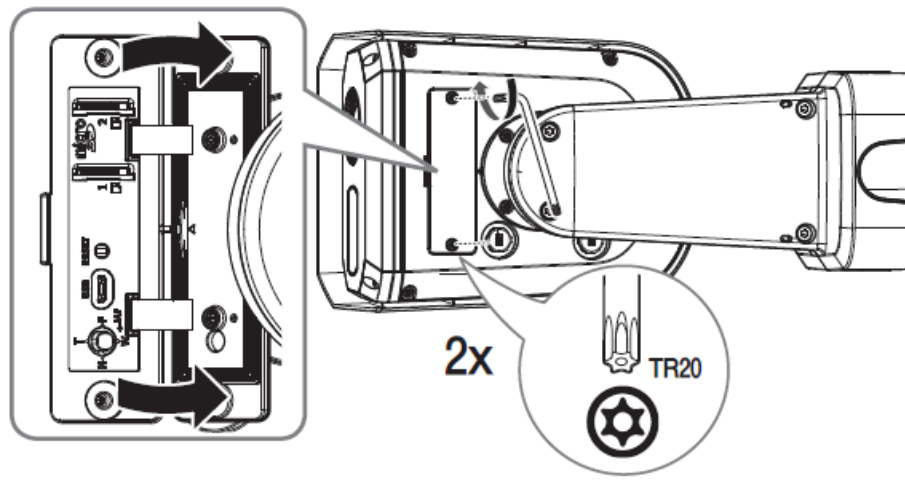

**Not Included: Micro SD Card**

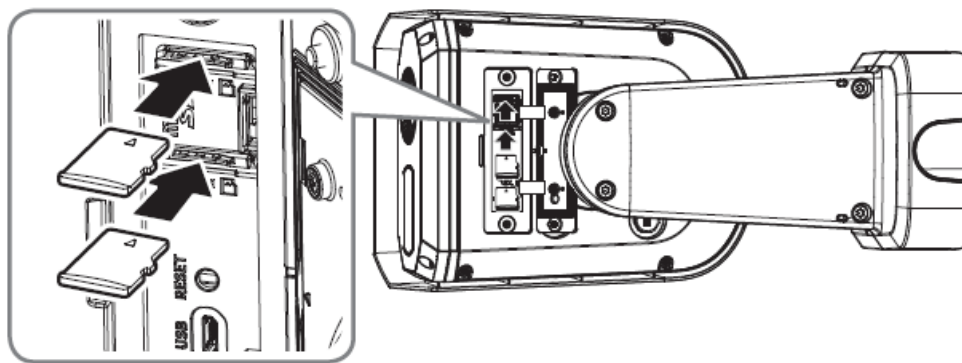

- Not Included: Wi-Fi dongle, OTG adapter

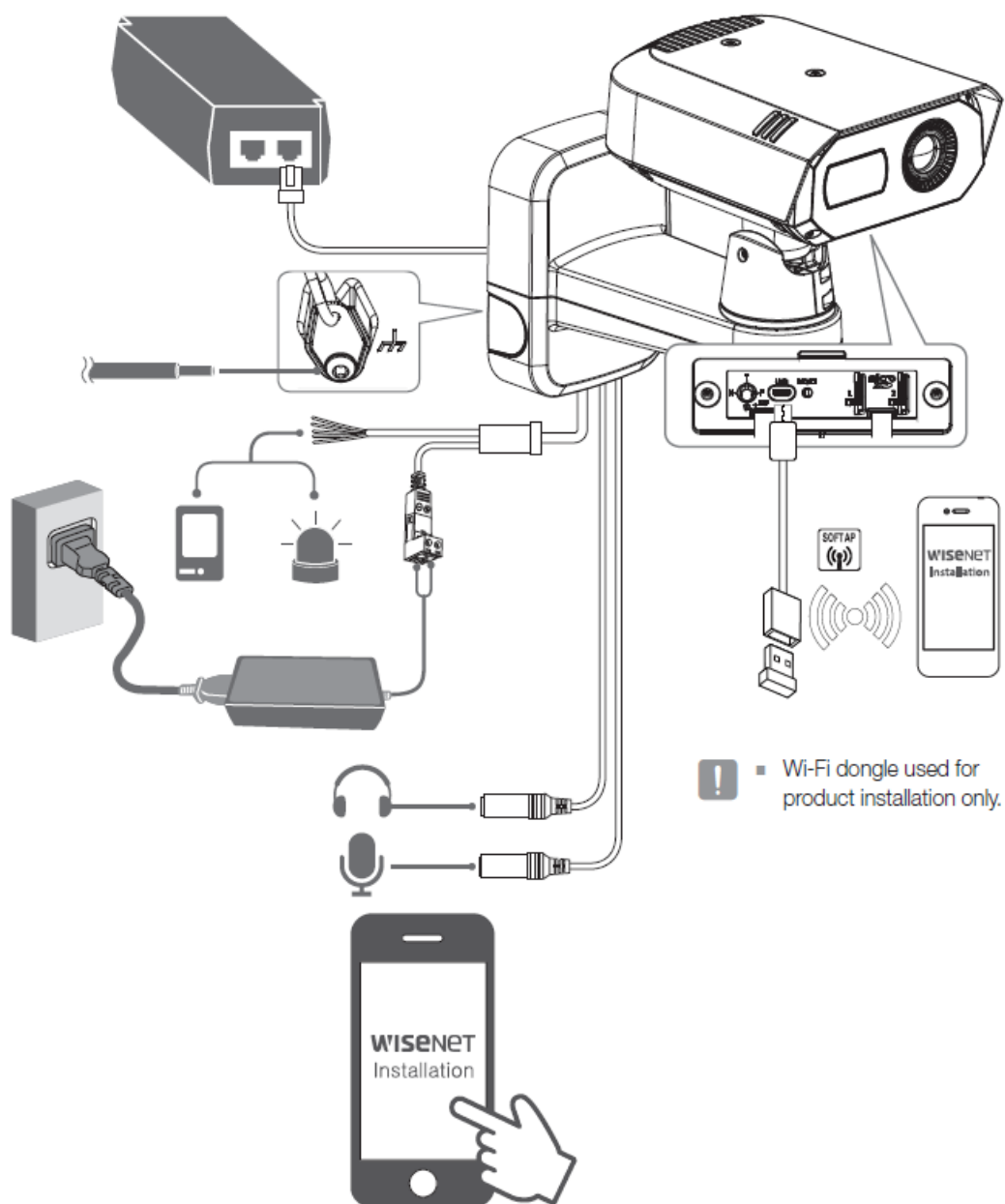

## PASSWORD SETTING

When you access the product for the first time, you must register the login password.

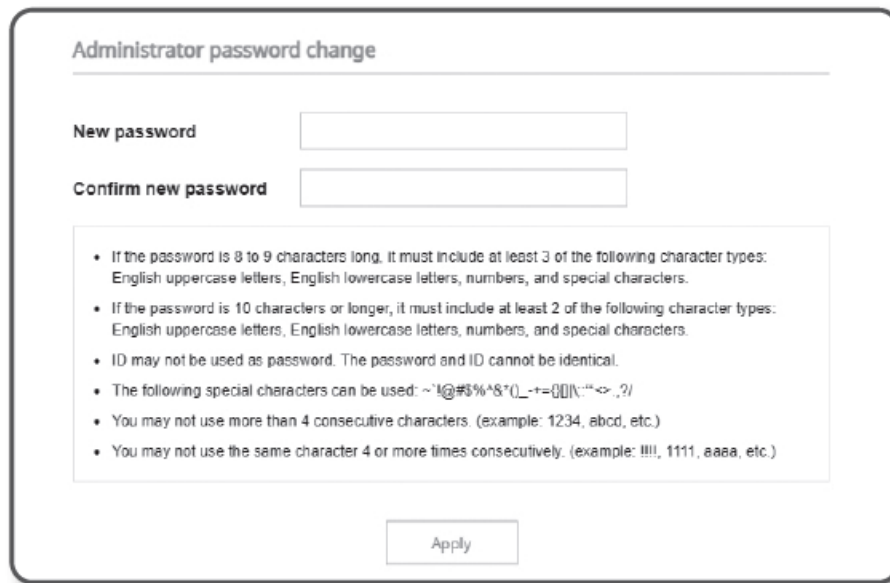

The image shows a web interface for changing the administrator password. It has a title 'Administrator password change'. Below the title are two input fields: 'New password' and 'Confirm new password'. Below these fields is a list of password requirements. At the bottom right is an 'Apply' button.

**Administrator password change**

New password

Confirm new password

- If the password is 8 to 9 characters long, it must include at least 3 of the following character types: English uppercase letters, English lowercase letters, numbers, and special characters.
- If the password is 10 characters or longer, it must include at least 2 of the following character types: English uppercase letters, English lowercase letters, numbers, and special characters.
- ID may not be used as password. The password and ID cannot be identical.
- The following special characters can be used: ~!@#\$%^&\*()\_-=+{}[]\|;:“”<>.,?/
- You may not use more than 4 consecutive characters. (example: 1234, abcd, etc.)
- You may not use the same character 4 or more times consecutively. (example: !!!!, 1111, aaaa, etc.)

Apply

- For a new password with 8 to 9 digits, you must use at least 3 of the following: uppercase/ lowercase letters, numbers, and special characters. For a password with 10 to 15 digits, you must use at least 2 types of those mentioned.
- Special characters are allowed. :  
~!@#\$%^&\*()\_-=+{}[]\|;:“”<>.,?/
- Space is not allowed for passwords.
- For higher security, you are not recommended to repeat the same characters or consecutive keyboard inputs for your passwords.
- If you lost your password, you can press the [RESET] button to initialize the product. So, don't lose your password by using a memo pad or memorizing it.

## LOGIN

Whenever you access the camera, the login window appears.

Enter the User ID and password to access the camera.

1. Enter “admin” in the <User Name> input box.
2. Enter the password in the <Password> input field.
3. Click [Sign in].

## CONNECTING TO WiFi

### Camera setting

- Connect OTG adapter (5-pin) and Wi-Fi dongle to the micro USB terminal.



### Smartphone setting

1. Install the Wisenet Installation application.

2. Select the camera SSID after turning on the WiFi.
3. Run the Wisenet Installation application.
4. When you log in to the camera, the video will be connected.
  - The video will be played without being logged in during the initial connection.
5. You can adjust the angle of view while watching the video through a smartphone.

Covered by patents at [patentlist.accessadvance.com](http://patentlist.accessadvance.com)



-    microSD, microSDHC, and microSDXC Logos are trademarks of SD-3C LLC. microSD, microSDHC, and microSDXC are trademarks or registered trademarks of SD-3C, LLC in the United States, other countries or both.

## CONTACT

### EDS Elektronik Destek Sanayi ve Ticaret Ltd. Şti.

- Meclis Mah. Teraziler Cad. Hayran Sk. (Eskisi Kılıç Sk.) No: 4 Sancaktepe / İstanbul / Türkiye
- Tel +90.216.313.25.15

### ENTES ELEKTRONİK CİHAZLAR İMALAT VE TİC. A.Ş.

- Dudullu Org.San.Bölg. 1. Cad. No:23 34776 Ümraniye / İstanbul / Türkiye
- Tel +90.216.313.01.10

### TEKNOMAKS TEKNOLOJİ / TEKNOMAKS BİLİSİM

- MERDİVENKÖY MAH.DİKYOL SOK. BUSINESS İSTANBUL No:2, Kat:7, D:B67, 34732 Kadıköy / İstanbul / Türkiye
- Tel +90.212.217.54.22

## Documents / Resources

	<a href="#">Hanwha Vision TNM Series Network Camera</a> [pdf] User Guide TNM-C4940TD, TNM-C4950TD, TNM-C4960TD, TNM-C4940TDR, TNM-C4942TDR, TNM Series Network Camera, TNM Series, TNM Series Camera, Network Camera, Camera
---	---

## References

-  [\*\*Warranty : Hanwha Vision - Global Vision Solution Provider\*\*](#)
- [\*\*User Manual\*\*](#)

[Manuals+](#), [Privacy Policy](#)

This website is an independent publication and is neither affiliated with nor endorsed by any of the trademark owners. The "Bluetooth®" word mark and logos are registered trademarks owned by Bluetooth SIG, Inc. The "Wi-Fi®" word mark and logos are registered trademarks owned by the Wi-Fi Alliance. Any use of these marks on this website does not imply any affiliation with or endorsement.