

Hanwha Vision QNV-C6083R Global Vision Solution Web Camera



Hanwha Vision QNV-C6083R Global Vision Solution Web Camera User Guide

[Home](#) » [Hanwha Vision](#) » Hanwha Vision QNV-C6083R Global Vision Solution Web Camera User Guide 

Contents

- 1 Hanwha Vision QNV-C6083R Global Vision Solution Web Camera
- 2 Product Information
- 3 Product Usage Instructions
- 4 Frequently Asked Questions
- 5 Warranty
- 6 SAFETY INFORMATION
- 7 Models
- 8 QNV-C6083R
 - 8.1 COMPONENT
 - 8.2 INSTALLATION
- 9 QNO-C6083R
 - 9.1 COMPONENT
 - 9.2 INSTALLATION
- 10 Password Setting
- 11 Documents / Resources
 - 11.1 References



Hanwha Vision QNV-C6083R Global Vision Solution Web Camera



Product Information

Specifications

- **Model:** QNV-C6083R, QNO-C6083R
- Environmentally friendly product with eco-mark
- **Compliance:** EU RoHS Directive
- **IP Rating:** IP66
- Micro SD compatibility
- WiFi OTG support

Product Usage Instructions

Installation

1. Mount the camera using the provided components.
2. Insert a compatible Micro SD card (microSD, microSDHC, or microSDXC).
3. Ensure proper placement in an IP66-rated environment.
4. Connect to a compatible VMS or Hanwha NVR using the recommended versions.
5. Set up WiFi OTG for wireless connectivity.

Frequently Asked Questions

Q: Where can I find the official compatible VMS version or the latest Hanwha NVR version?

A: You can download the official compatible versions from the Hanwha Vision website under the

'Manuals' section.

Q: How do I correctly dispose of waste electrical & electronic equipment?

A: For correct disposal, follow the guidelines applicable in the European Union and other European countries with separate battery return systems. Contact local authorities for proper disposal methods.

Q: What does the Eco mark on the product signify?

A: The Eco mark represents Hanwha Vision's commitment to creating environmentally friendly products in compliance with the EU RoHS Directive.

Important

Please check 'Manuals' from our website, before connecting to the Supply,
<https://www.hanwhavision.com/en/download-data/>.

Warranty

Please check "Product warranty information" on our website.
<https://www.hanwhavision.com/en/support/warranty/>.

We recommend using the officially compatible VMS version or the latest Hanwha NVR version when integrating with VMS or Hanwha NVR.

- Hanwha Vision cares for the environment at all product manufacturing stages and is taking measures to provide customers with more environmentally friendly products.
- The Eco mark represents Hanwha Vision's devotion to creating environmentally friendly products and indicates that the product satisfies the EU RoHS Directive.



Correct Disposal of This Product (Waste Electrical & Electronic Equipment)

- (Applicable in the European Union and other European countries with separate collection systems)
- This marking on the product, accessories or literature indicates that the product and its electronic accessories (e.g. charger, headset, USB cable) should not be disposed of with other household waste at the end of their working life. To prevent possible harm to the environment or human health from uncontrolled waste disposal, please separate these items from other types of waste and recycle them responsibly to promote the

sustainable reuse of material resources.

- Household users should contact either the retailer where they purchased this product, or their local government office, for details of where and how they can take these items for environmentally safe recycling.
- Business users should contact their supplier and check the terms and conditions of the purchase contract. This product and its electronic accessories should not be mixed with other commercial wastes for disposal.



Correct disposal of batteries in this product

(Applicable in the European Union and other European countries with separate battery return systems.)

This marking on the battery, manual or packaging indicates that the batteries in this product should not be disposed of with other household waste at the end of their working life. Where marked, the chemical symbols Hg, Cd or Pb indicate that the battery contains mercury, cadmium or lead above the reference levels in EC Directive 2006/66. If batteries are not properly disposed of, these substances can cause harm to human health or the environment. To protect natural resources and to promote material reuse, please separate batteries from other types of waste and recycle them through your local, free battery return system.



SAFETY INFORMATION



Models

- QNV-C6083R
- QNO-C6083R

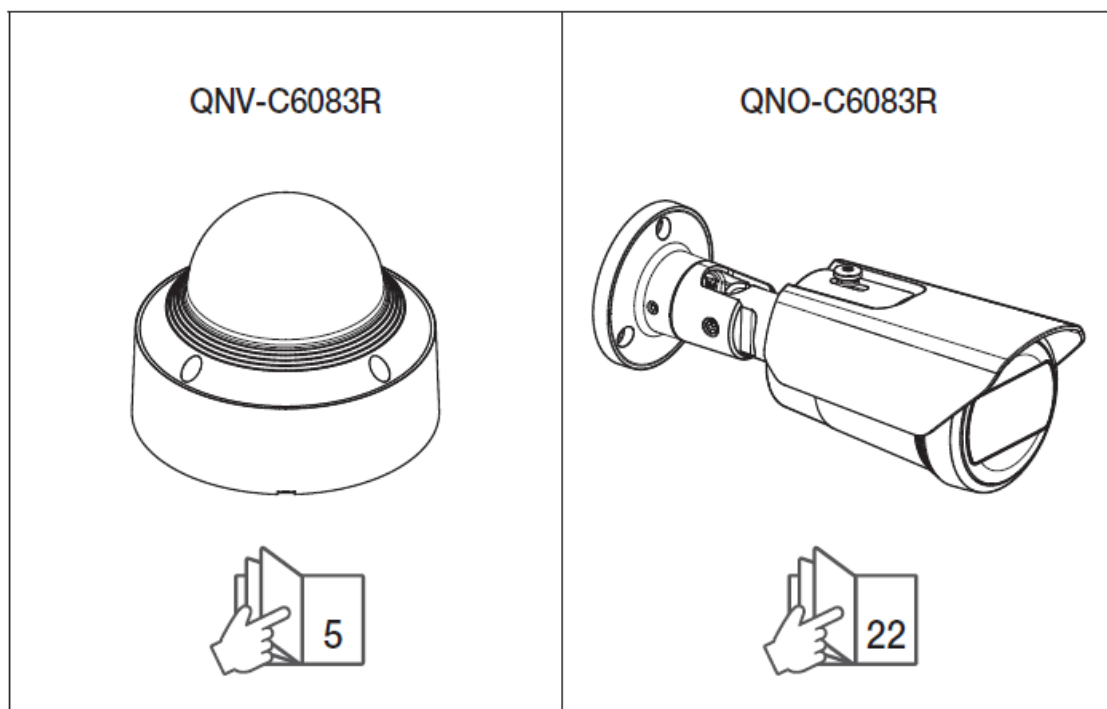

QNV-C6083R

COMPONENT

- QNV-C6083R

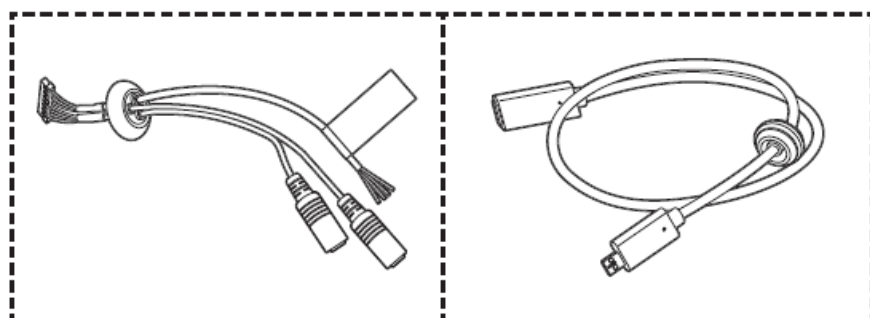
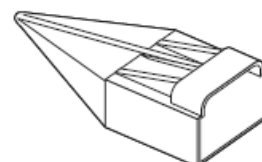
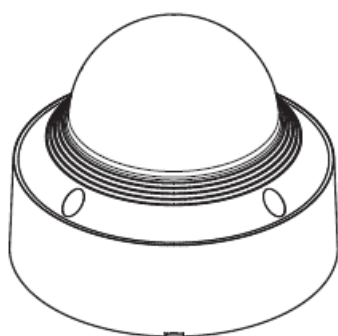

SPP-C7400

SPP-C1900

INSTALLATION

1

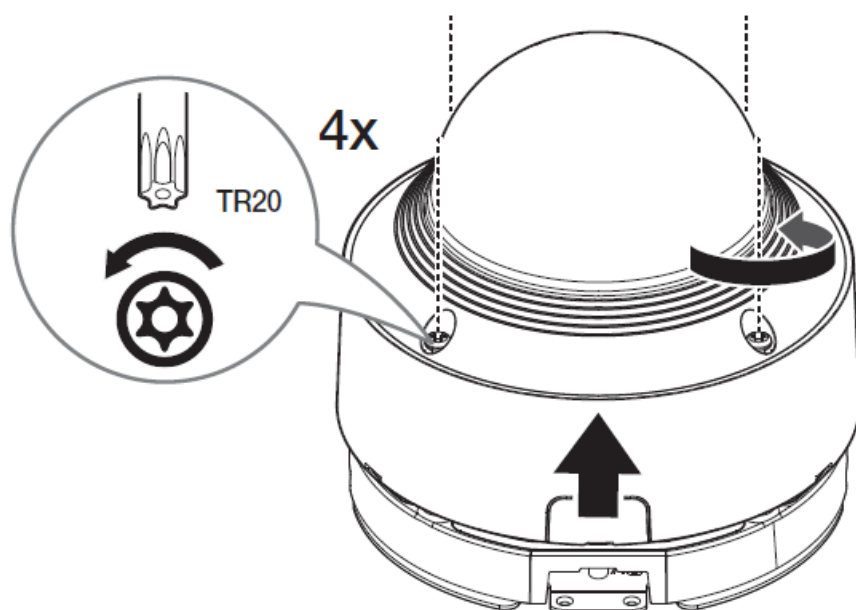

2

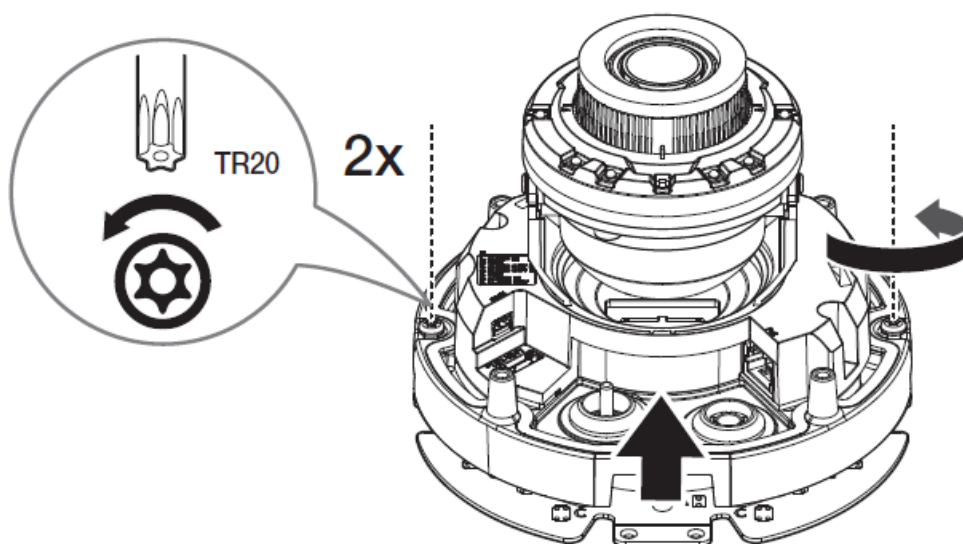

3

• Micro SD

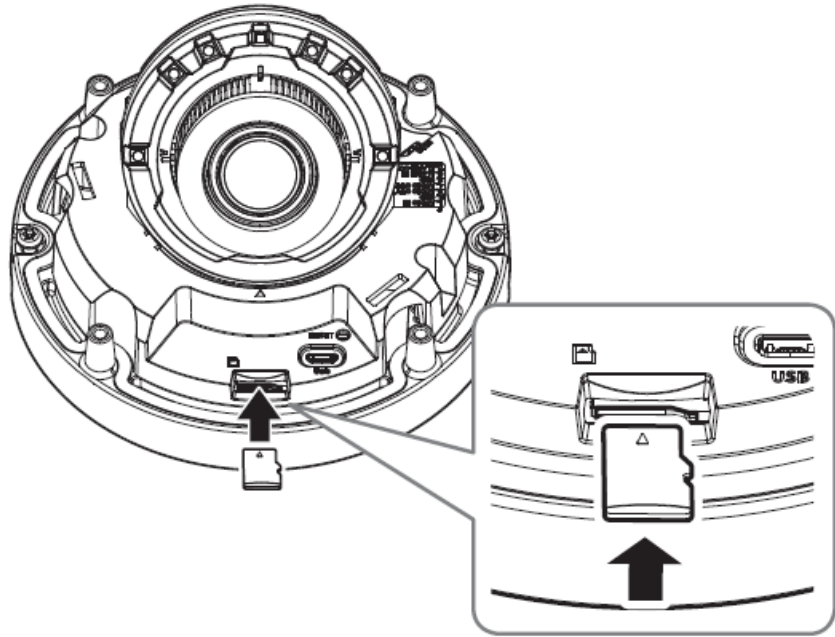

4

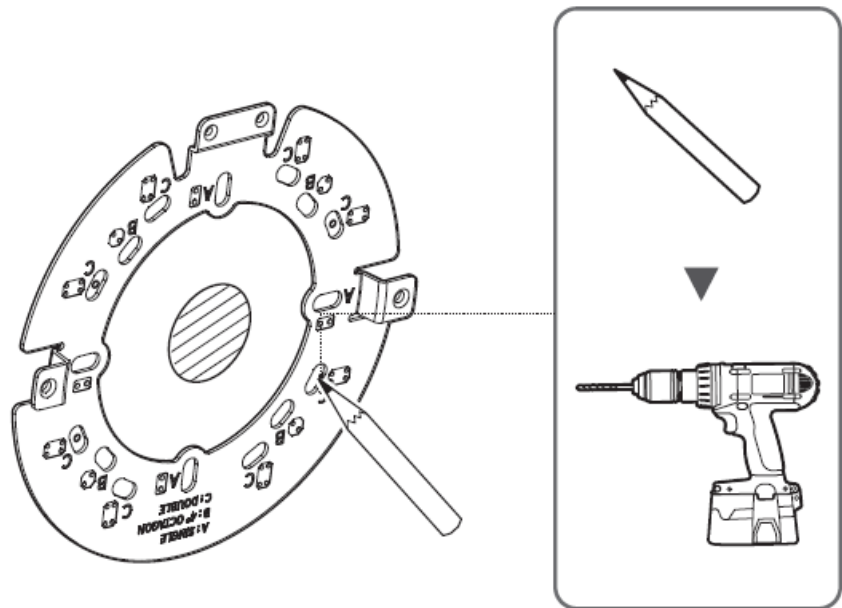

5

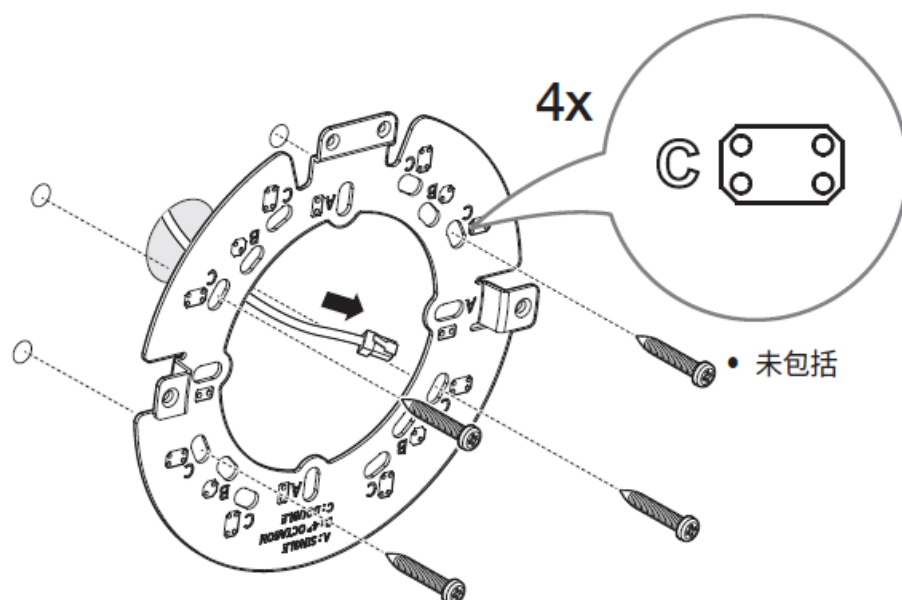

6

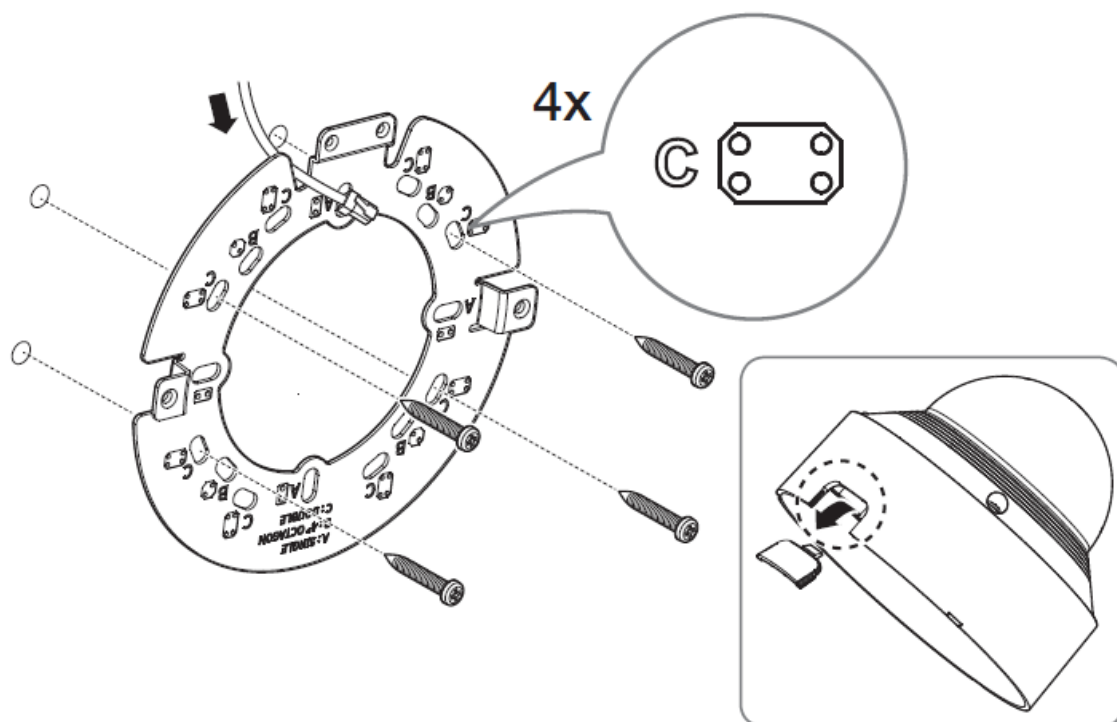

7

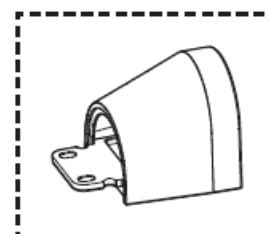
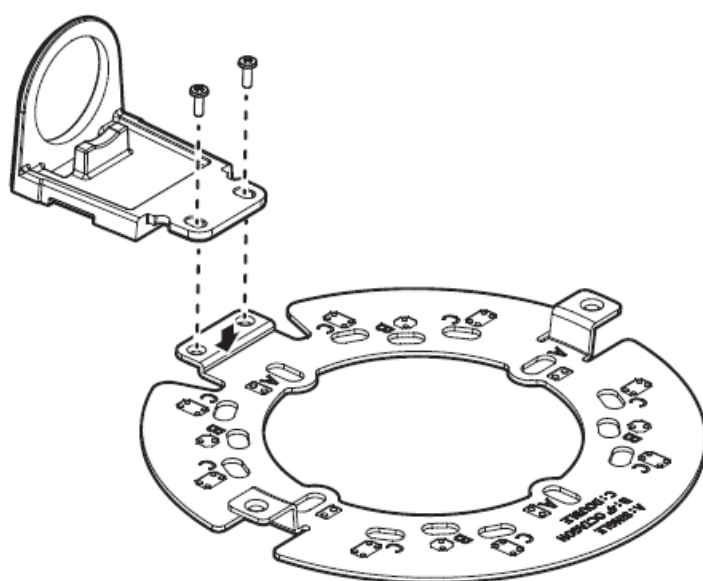

SBP-060BA

8

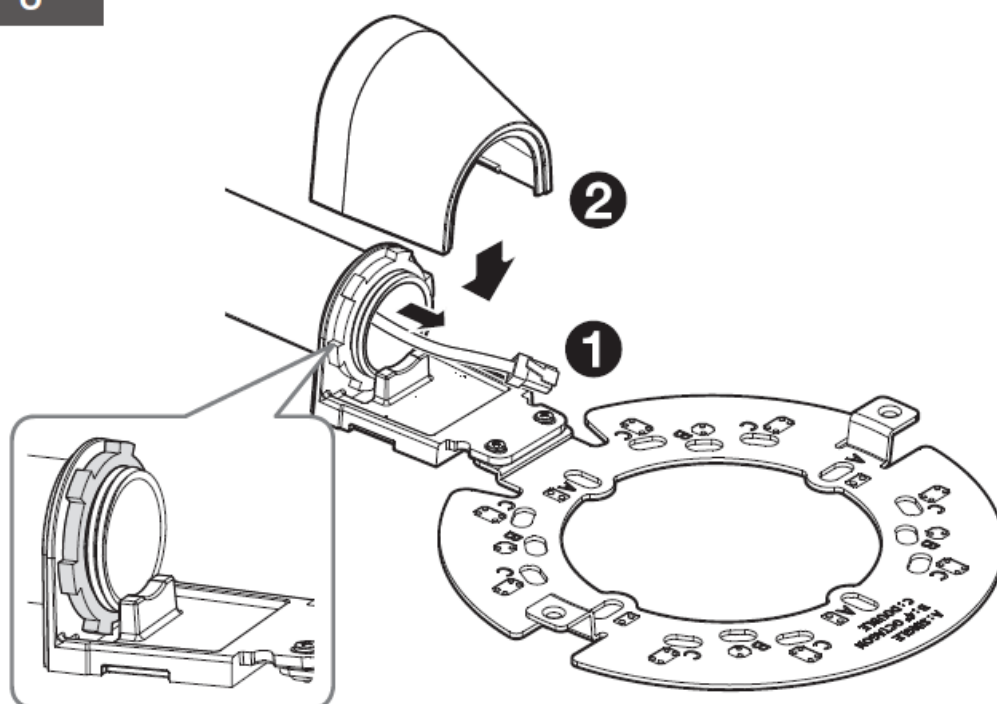

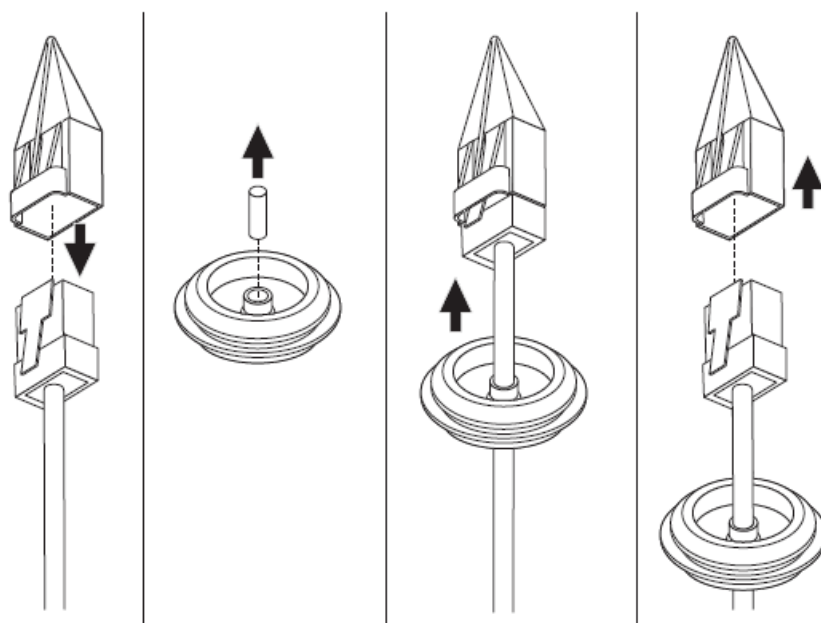
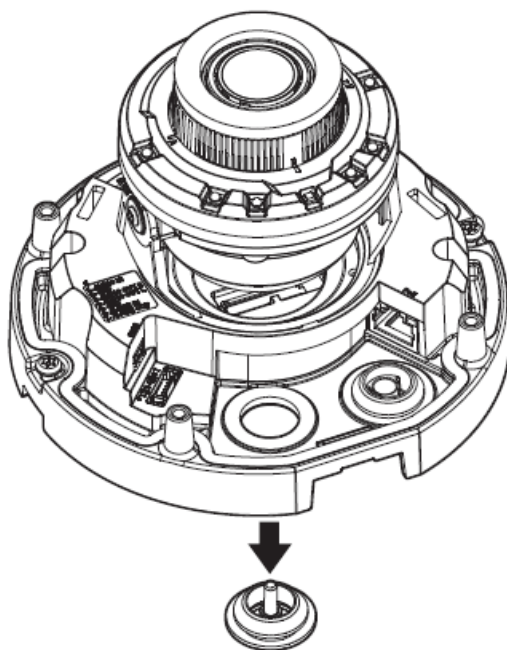

11

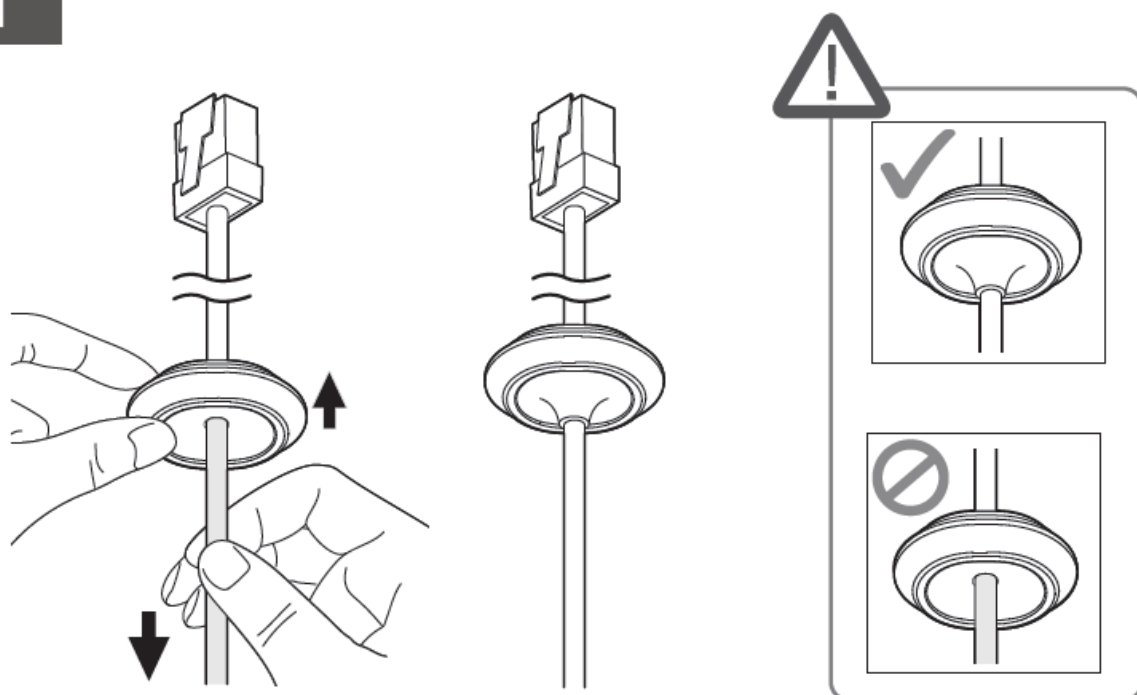

12

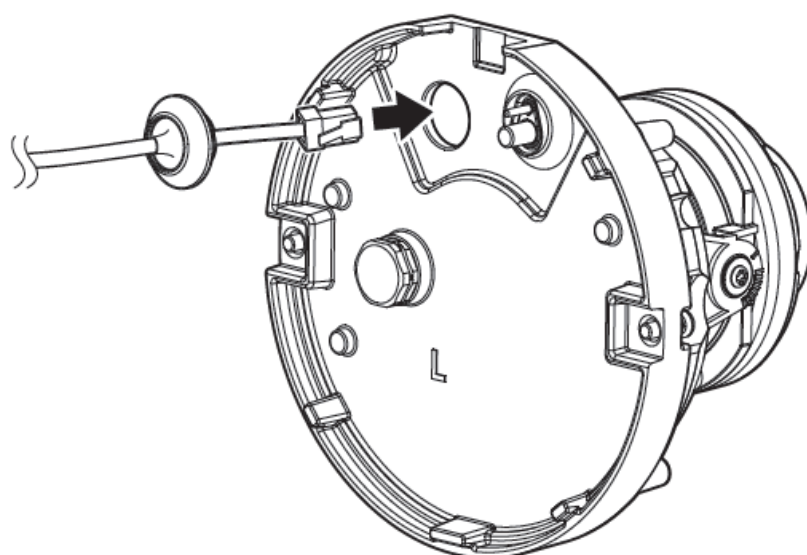

13

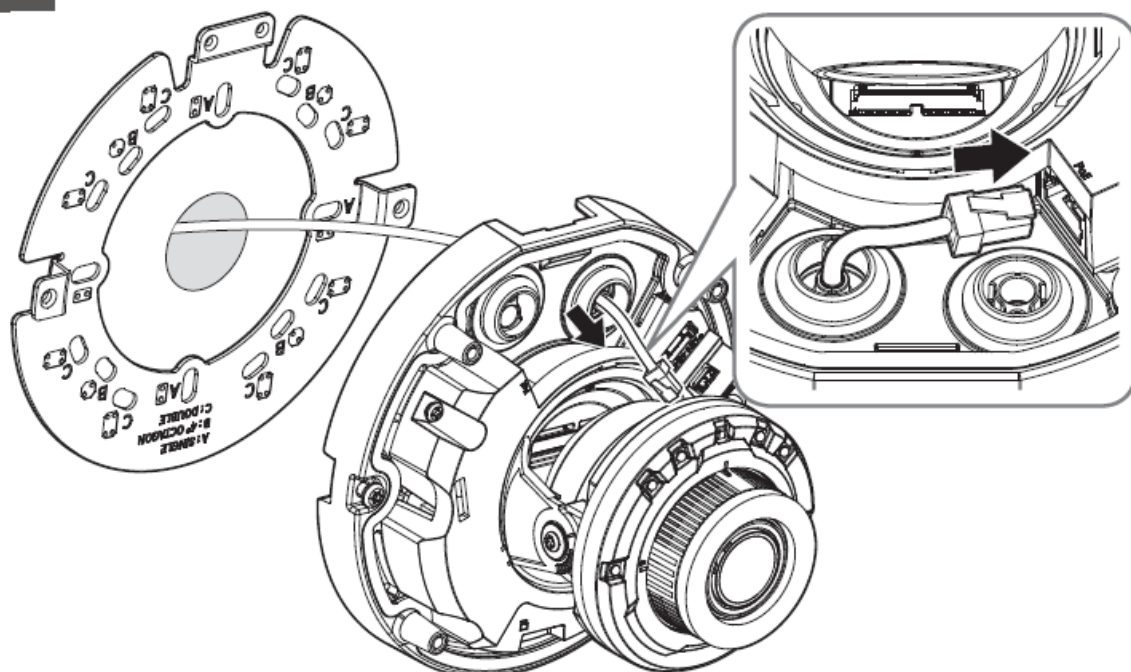

14-1 • Micro HDMI

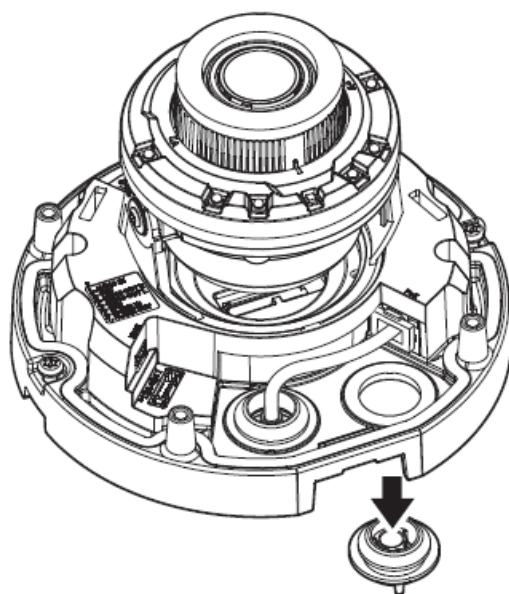

14-2

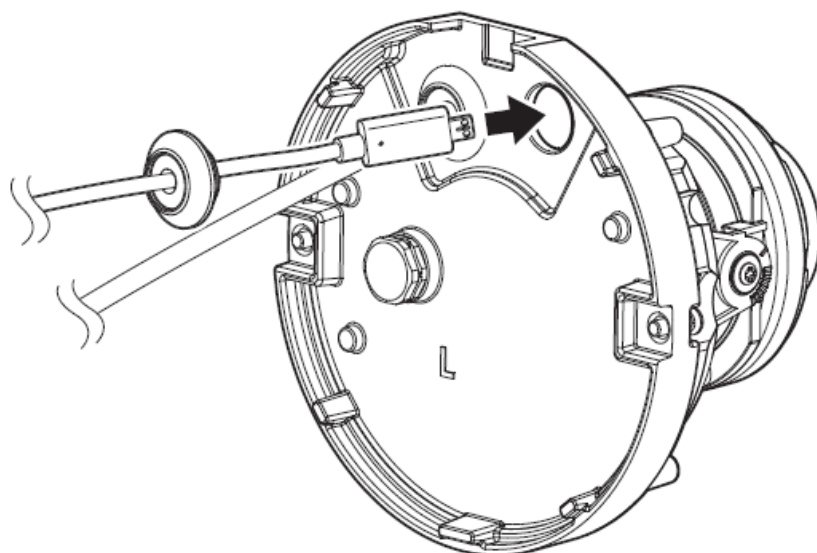

14-3

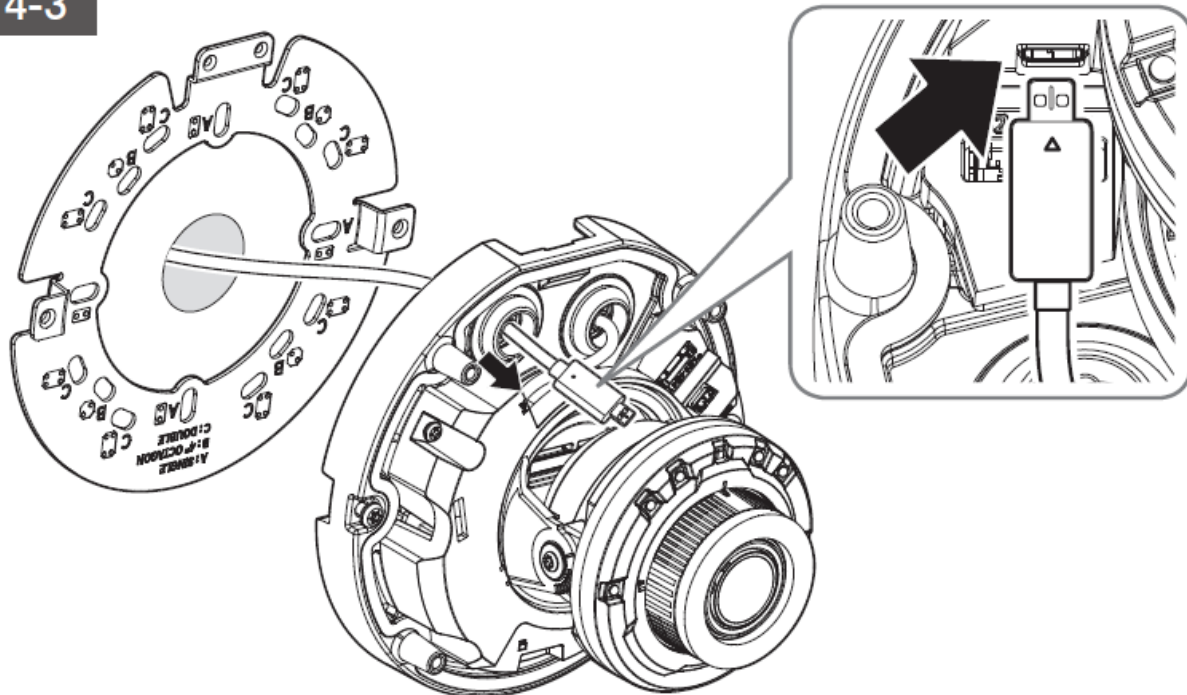

15-1

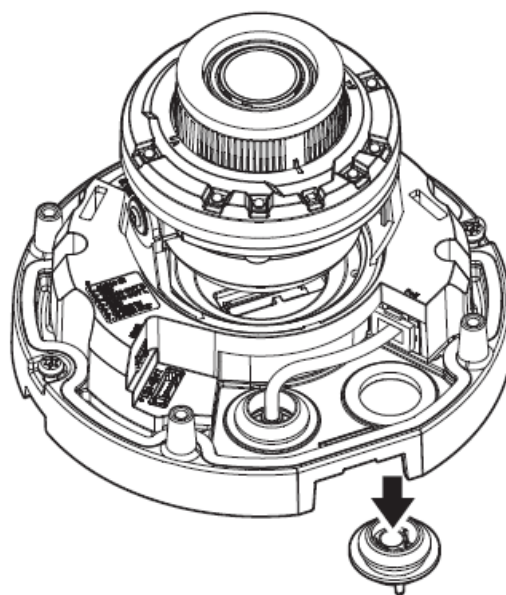

15-2

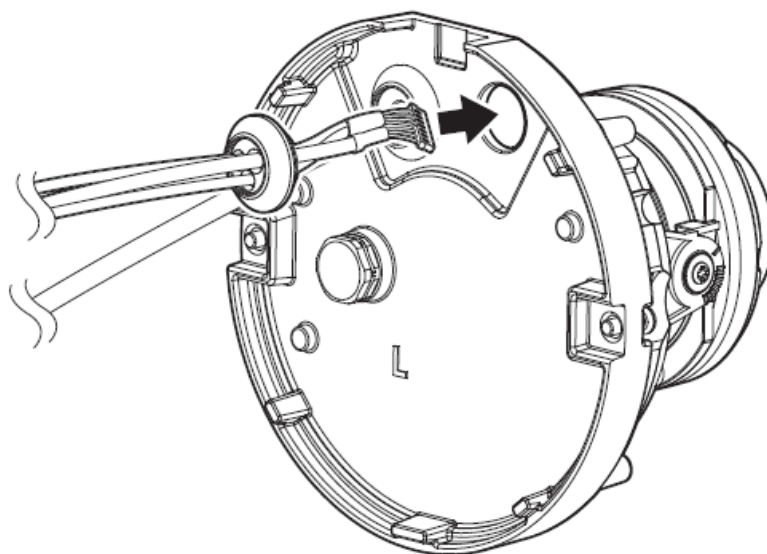

15-3

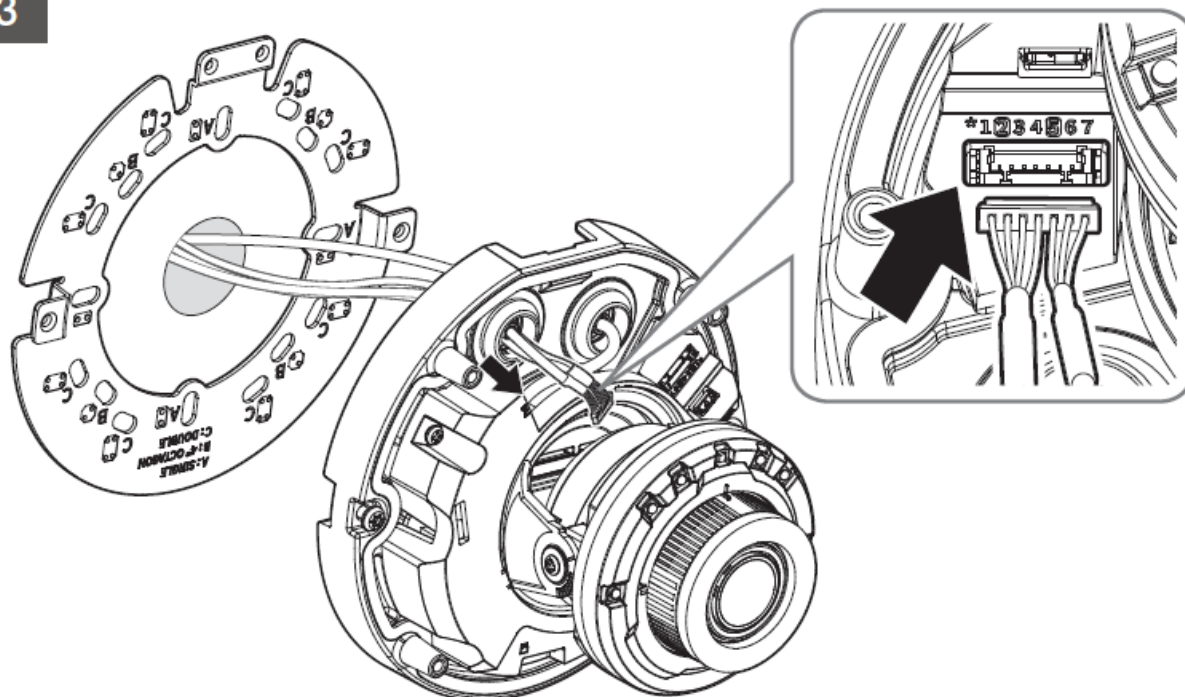

16

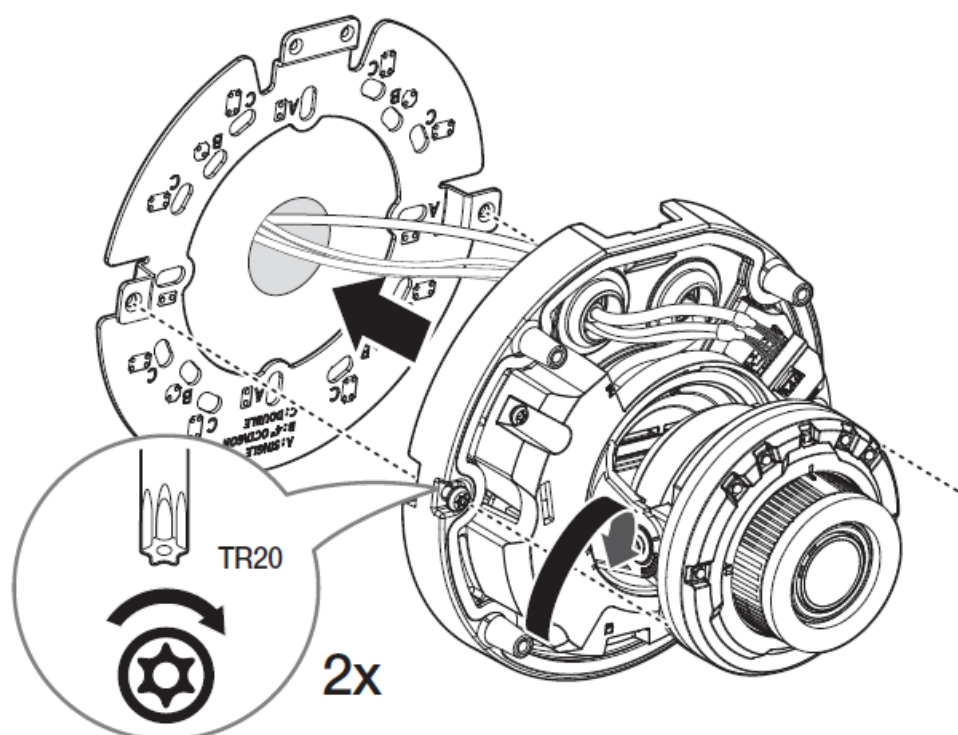

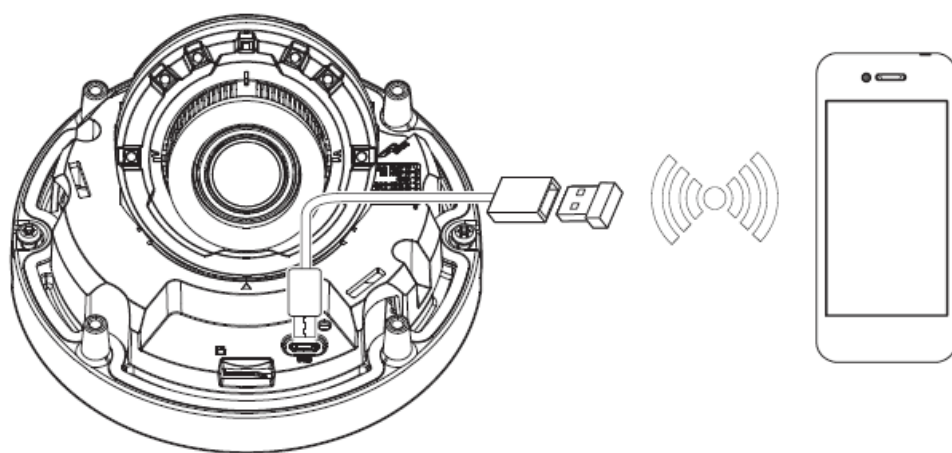



19

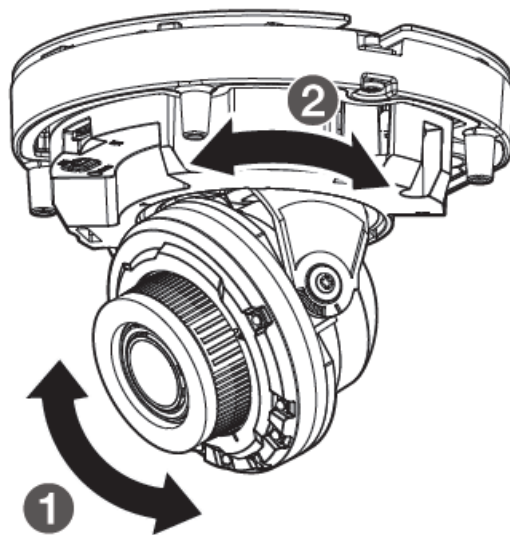

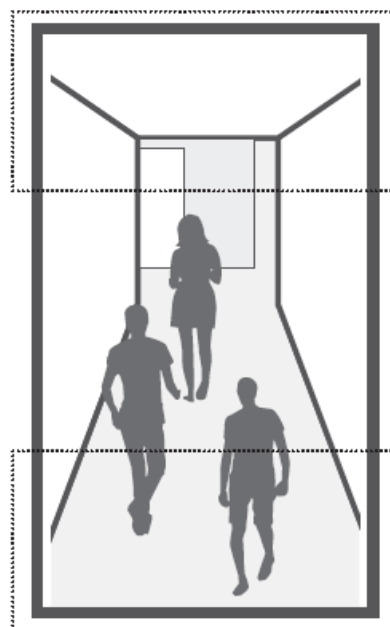
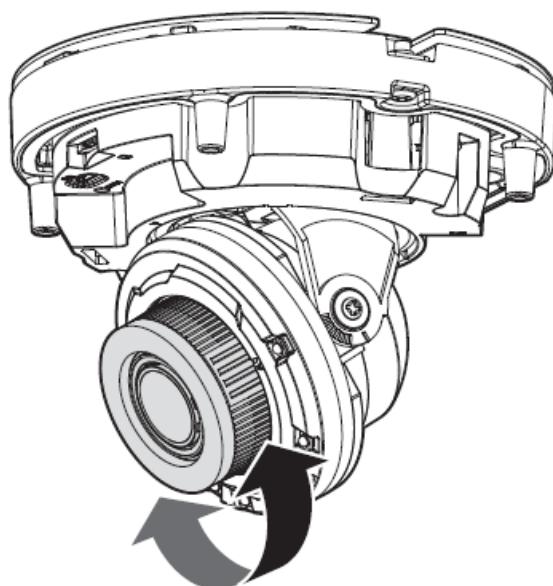

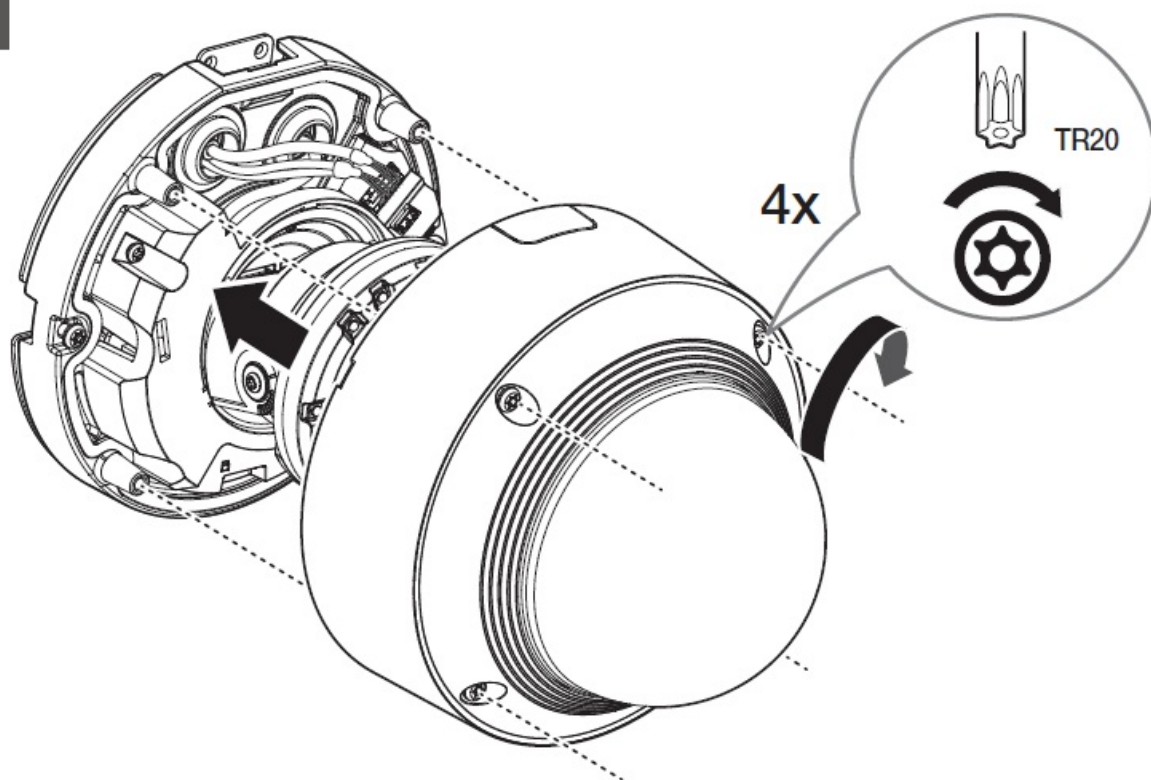

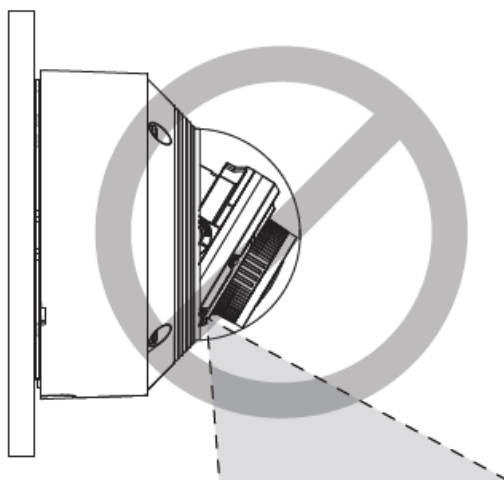
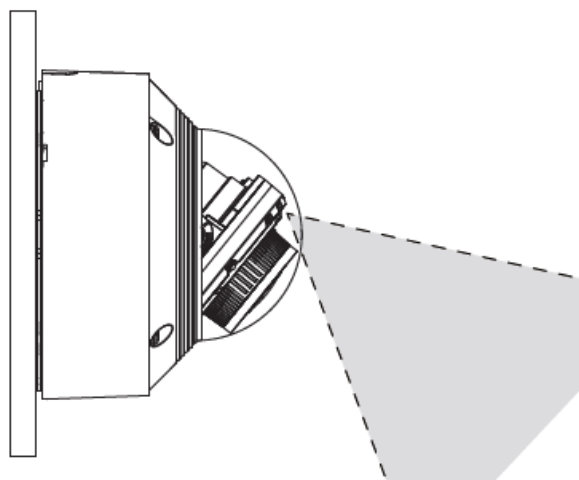
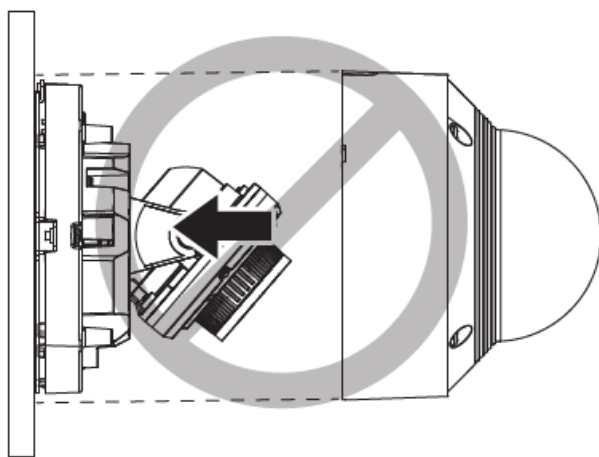
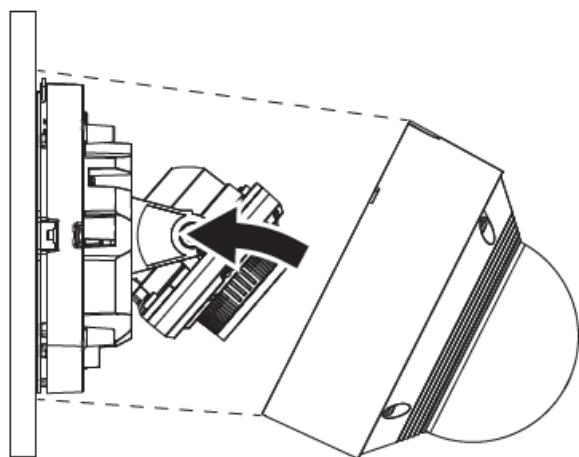

22

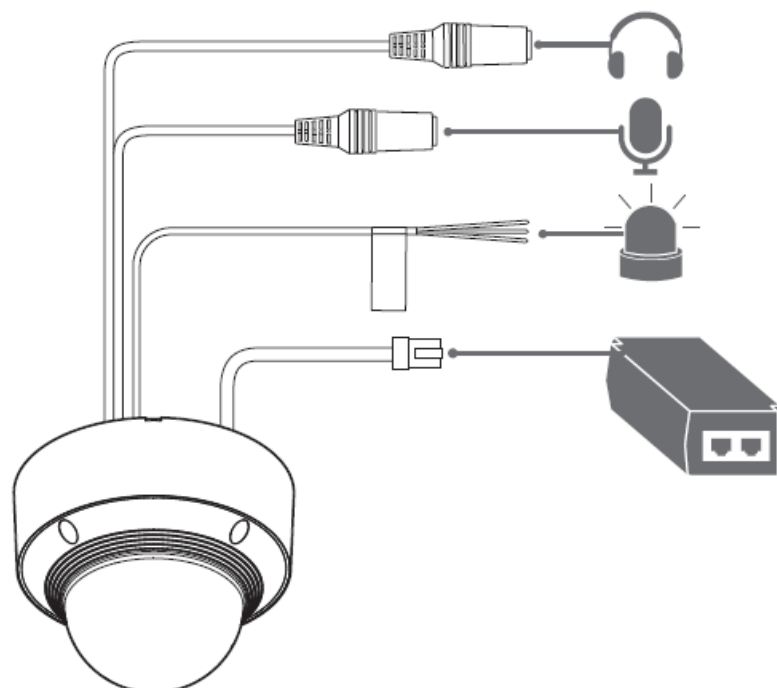

23



QNO-C6083R

COMPONENT

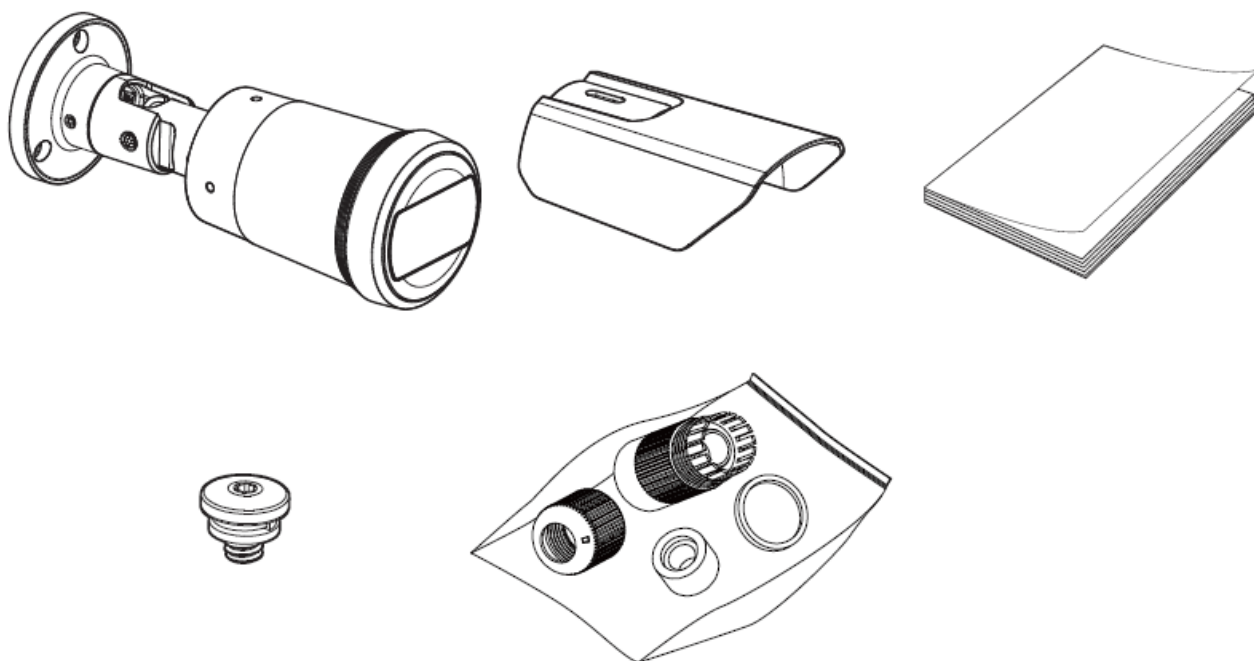

INSTALLATION

1

• Micro SD

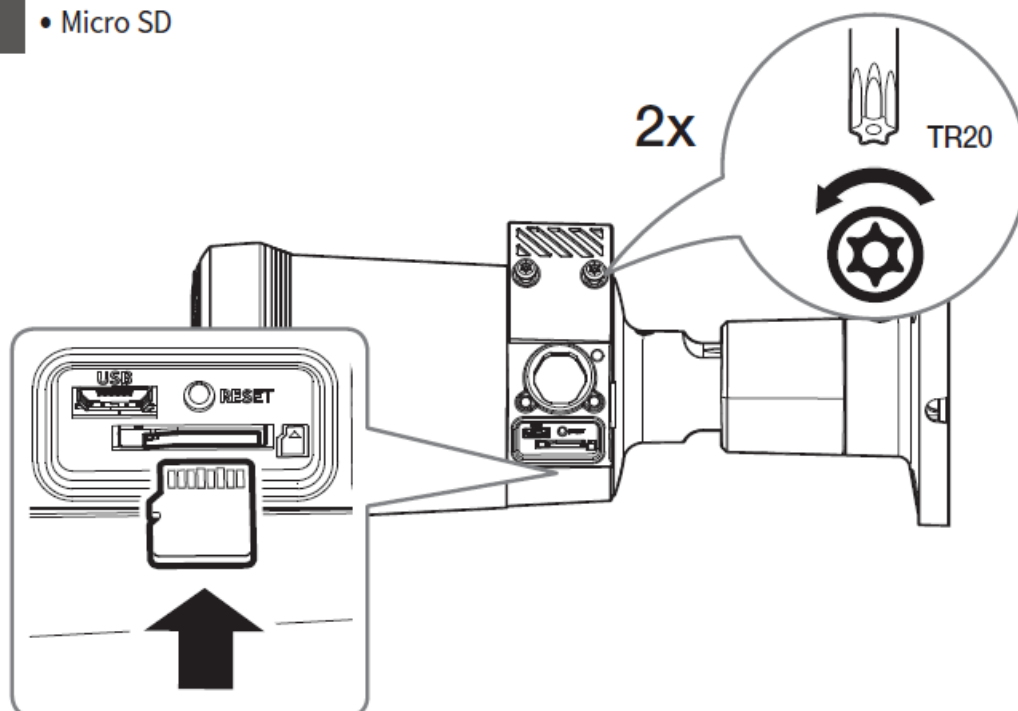

2

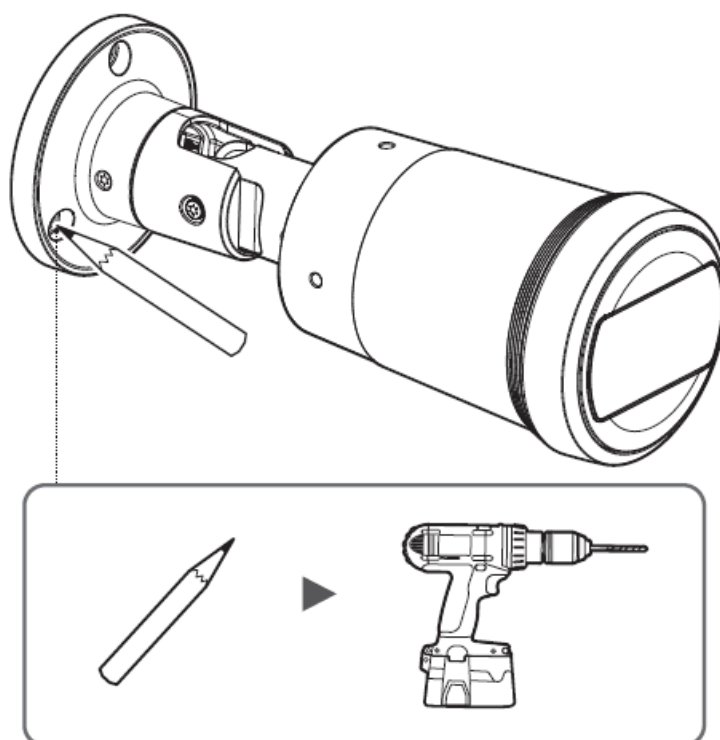

3

• (IP66)

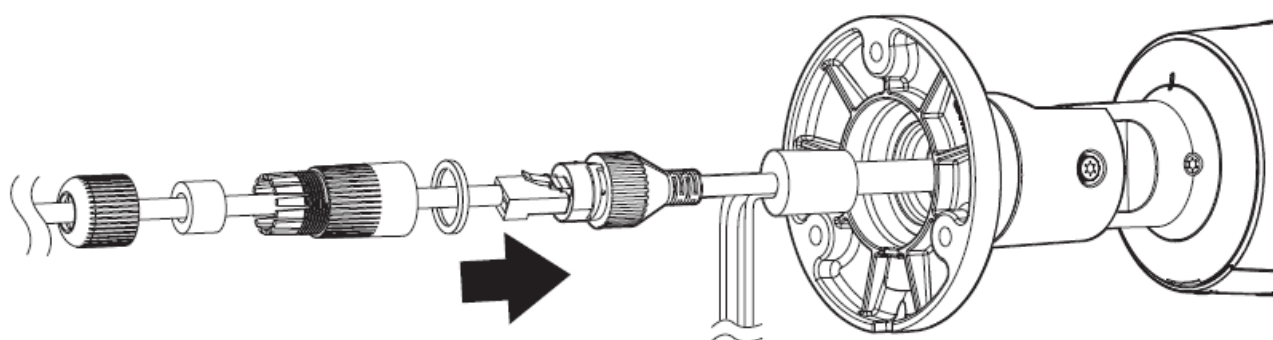

4

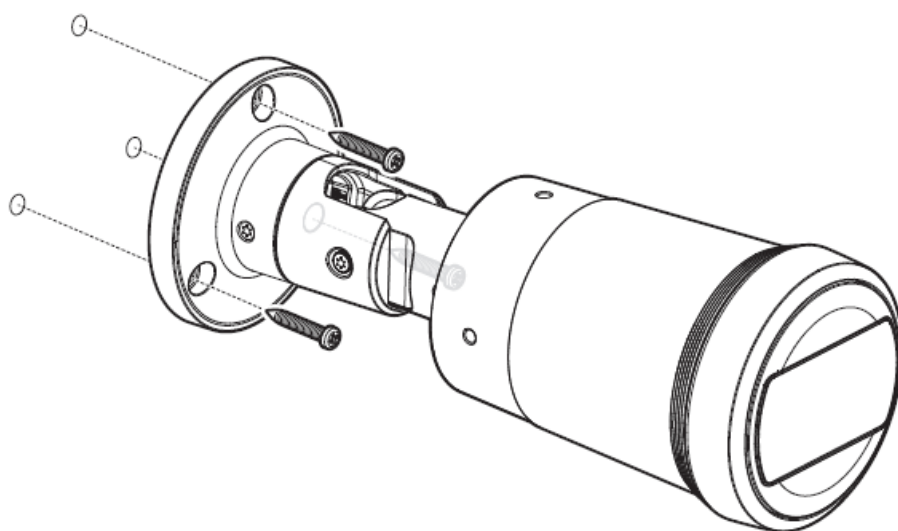

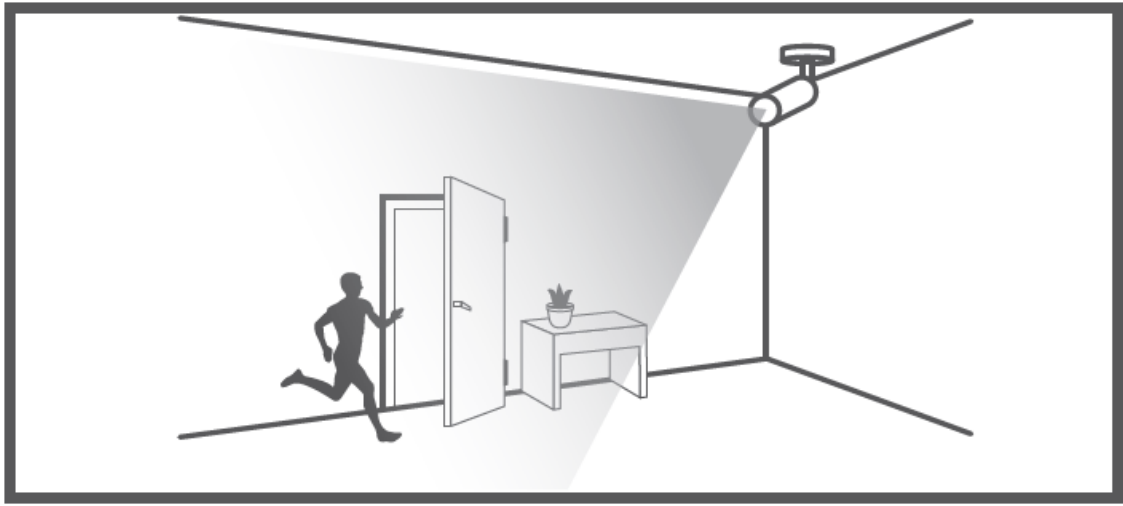

5

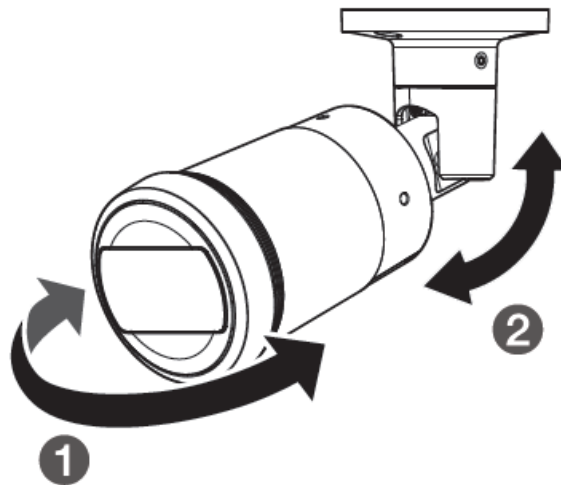

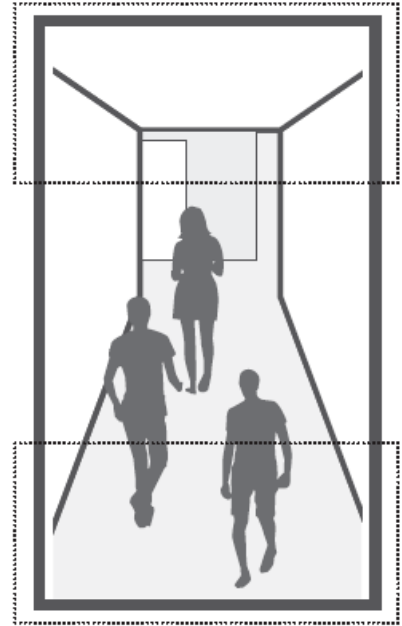
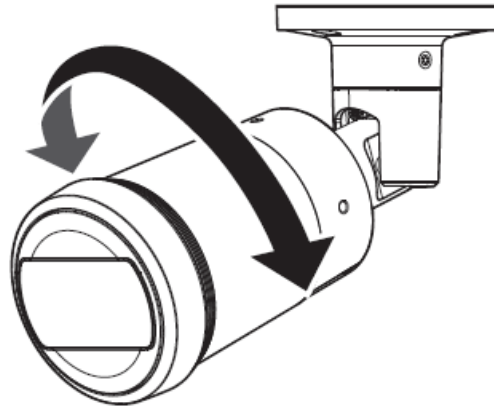

7

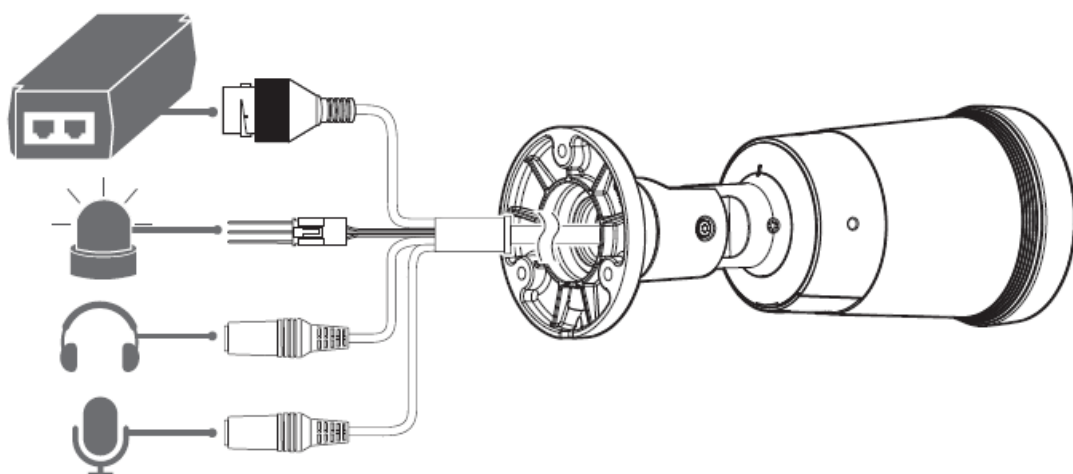

8

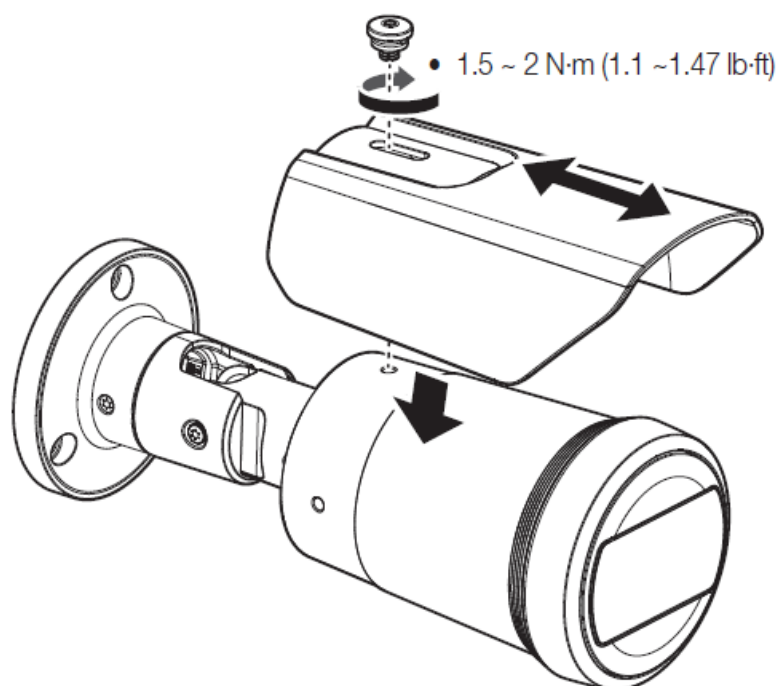



Password Setting

Administrator password change

New password

Confirm new password

- If the password is 8 to 9 characters long, it must include at least 3 of the following character types: English uppercase letters, English lowercase letters, numbers, and special characters. (support up to 64 characters)
- If the password is 10 characters or longer, it must include at least 2 of the following character types: English uppercase letters, English lowercase letters, numbers, and special characters.
- ID may not be used as password. The password and ID cannot be identical.
- The following special characters can be used: ~`!@#\$%^&*()_-=[]\;:'"{}<>.,?/
- You may not use more than 4 consecutive characters. (example: 1234, abcd, etc.)
- You may not use the same character 4 or more times consecutively. (example: !!!!, 1111, aaaa, etc.)

Apply



microSD, microSDHC, and microSDXC Logos are trademarks of SD-3C LLC. microSD, microSDHC, and microSDXC are trademarks or registered trademarks of SD-3C, LLC in the United States, other countries or both.

Documents / Resources

	<p>Hanwha Vision QNV-C6083R Global Vision Solution Web Camera [pdf] User Guide QNV-C6083R, QNV-C6083R Global Vision Solution Web Camera, Global Vision Solution Web Camera, Solution Web Camera, Web Camera, Camera</p>
---	---

References

- [Warranty : Hanwha Vision - Global Vision Solution Provider](#)
- [User Manual](#)

Manuals+, Privacy Policy

This website is an independent publication and is neither affiliated with nor endorsed by any of the trademark owners. The "Bluetooth®" word mark and logos are registered trademarks owned by Bluetooth SIG, Inc. The "Wi-Fi®" word mark and logos are registered trademarks owned by the Wi-Fi Alliance. Any use of these marks on this website does not imply any affiliation with or endorsement.