



Hanwha Vision PNM-C16013RVQ Global Solution Provider Camera Instruction Manual

[Home](#) » [Hanwha Vision](#) » Hanwha Vision PNM-C16013RVQ Global Solution Provider Camera Instruction Manual



Hanwha Vision PNM-C16013RVQ Global Solution Provider Camera

Contents

- [1 Important](#)
- [2 Warranty](#)
- [3 SAFETY INFORMATION](#)
- [4 COMPONENT](#)
- [5 INSTALLATION](#)
- [6 WiFi](#)
- [7 Customer Support](#)
- [8 Documents / Resources](#)
 - [8.1 References](#)
- [9 Related Posts](#)



Important

Please check 'Manuals' from our website, before connecting to the Supply,
<https://www.hanwhavision.com/en/download-data/>

Warranty

Please check "Product warranty information" from our website.
<https://www.hanwhavision.com/en/support/warranty>

We recommend to use the officially compatible VMS version or latest Hanwha NVR version when integrating with VMS or Hanwha NVR.



Hanwha Vision cares for the environment at all product manufacturing stages, and is taking measures to provide customers with more environmentally friendly products.

The Eco mark represents Hanwha Vision's devotion to creating environmentally friendly products, and indicates that the product satisfies the EU RoHS Directive.



Correct Disposal of This Product (Waste Electrical & Electronic Equipment)
(Applicable in the European Union and other European countries with separate collection systems)

This marking on the product, accessories or literature indicates that the product and its electronic accessories (e.g. charger, headset, USB cable) should not be disposed of with other household waste at the end of their working life. To prevent possible harm to the environment or human health from uncontrolled waste disposal, please separate these items from other types of waste and recycle them responsibly to promote the sustainable reuse of material resources.

Household users should contact either the retailer where they purchased this product, or their local government office, for details of where and how they can take these items for environmentally safe recycling. Business users should contact their supplier and check the terms and conditions of the purchase contract. This product and its electronic accessories should not be mixed with other commercial wastes for disposal.

Correct disposal of batteries in this product



(Applicable in the European Union and other European countries with separate battery return systems.)

This marking on the battery, manual or packaging indicates that the batteries in this product should not be disposed of with other household waste at the end of their working life. Where marked, the chemical symbols Hg, Cd or Pb indicate that the battery contains mercury, cadmium or lead above the reference levels in EC Directive 2006/66. If batteries are not properly disposed of, these substances can cause harm to human health or the environment.

To protect natural resources and to promote material reuse, please separate batteries from other types of waste and recycle them through your local, free battery return system.

SAFETY INFORMATION

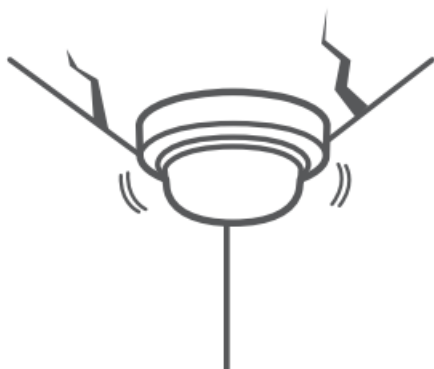

COMPONENT

Supplied accessories may vary depending on the country of sale.

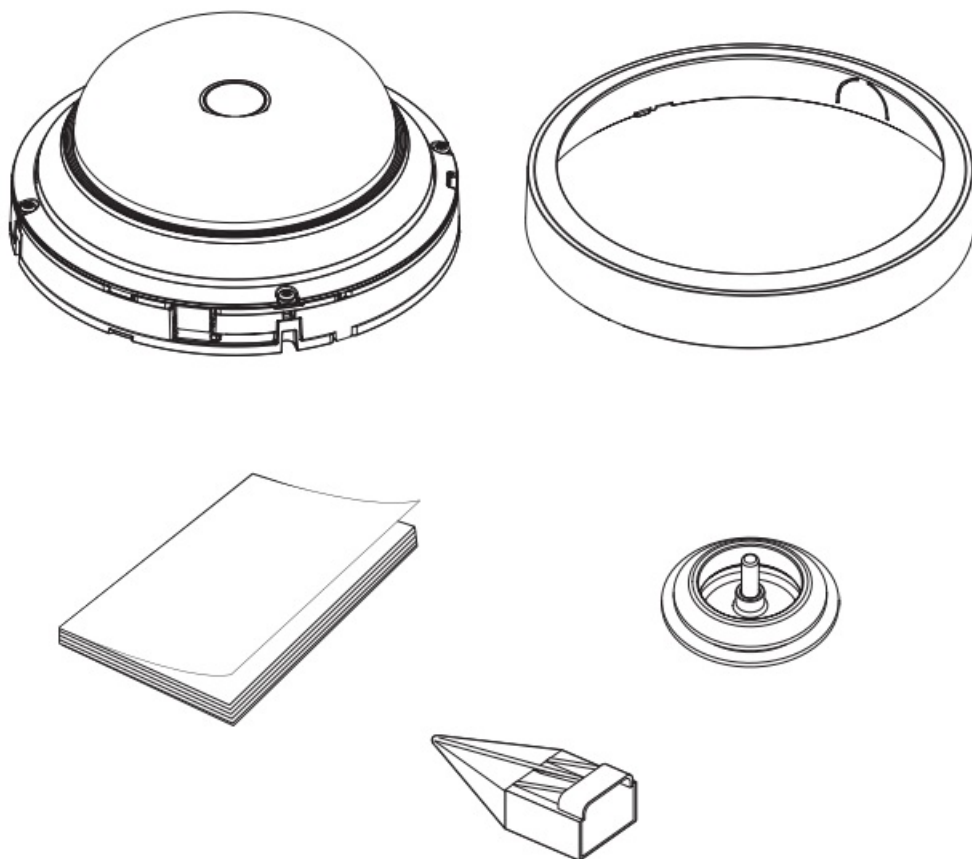

INSTALLATION

1

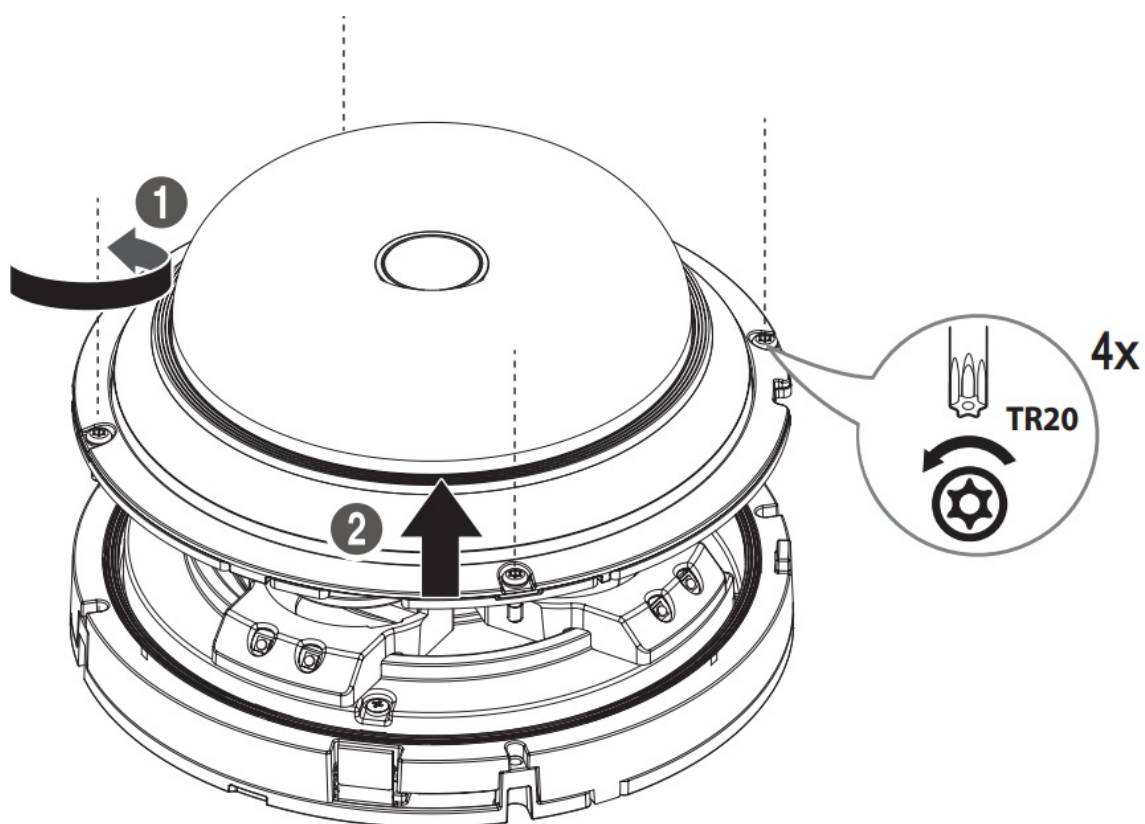

Not included: Micro SD card

2

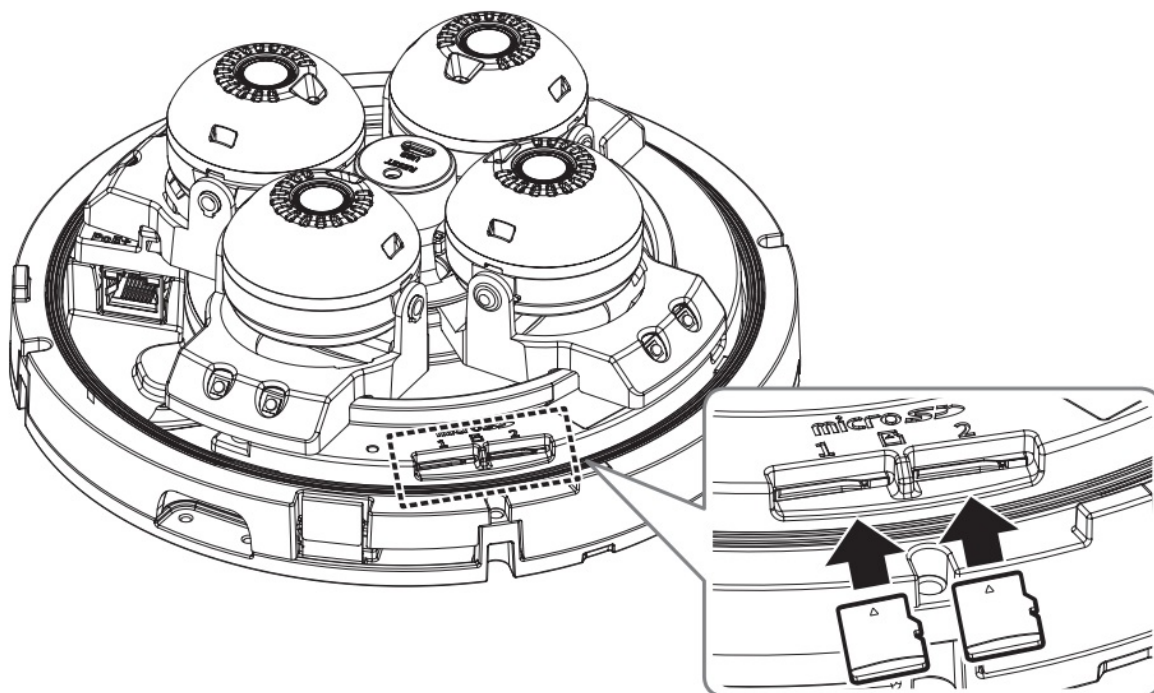

3

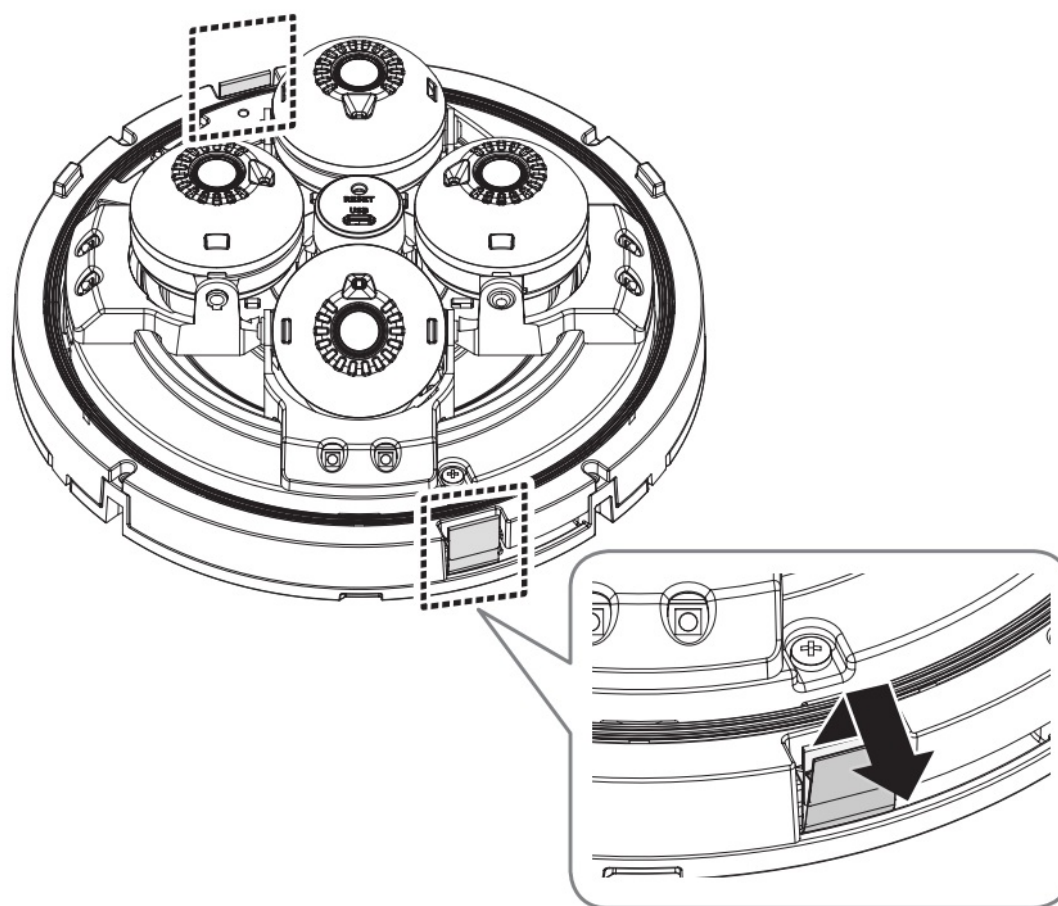

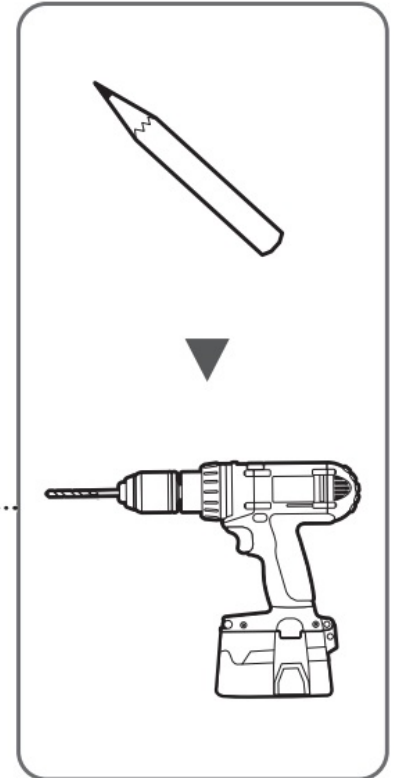
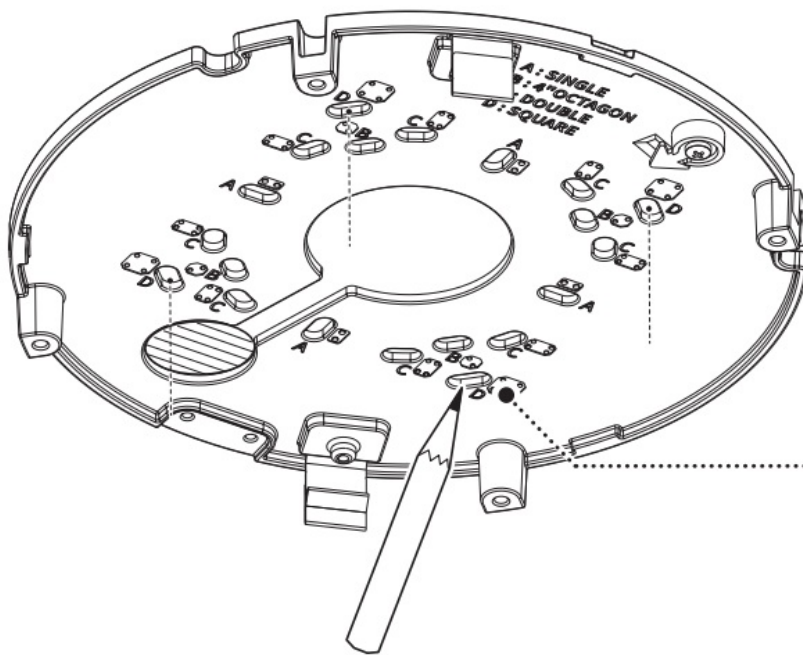

Direct installation on wall/ceiling

5-1

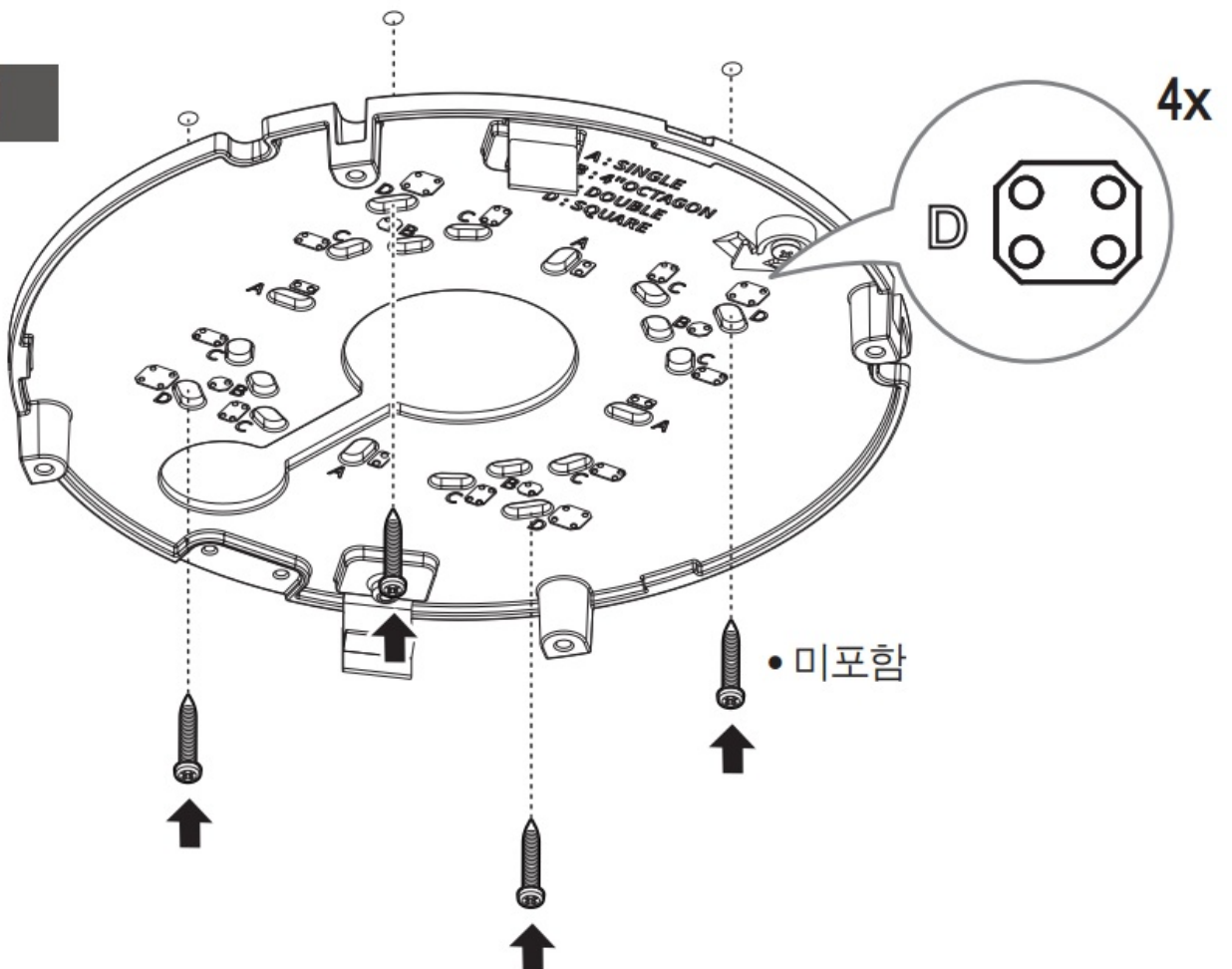

5-2

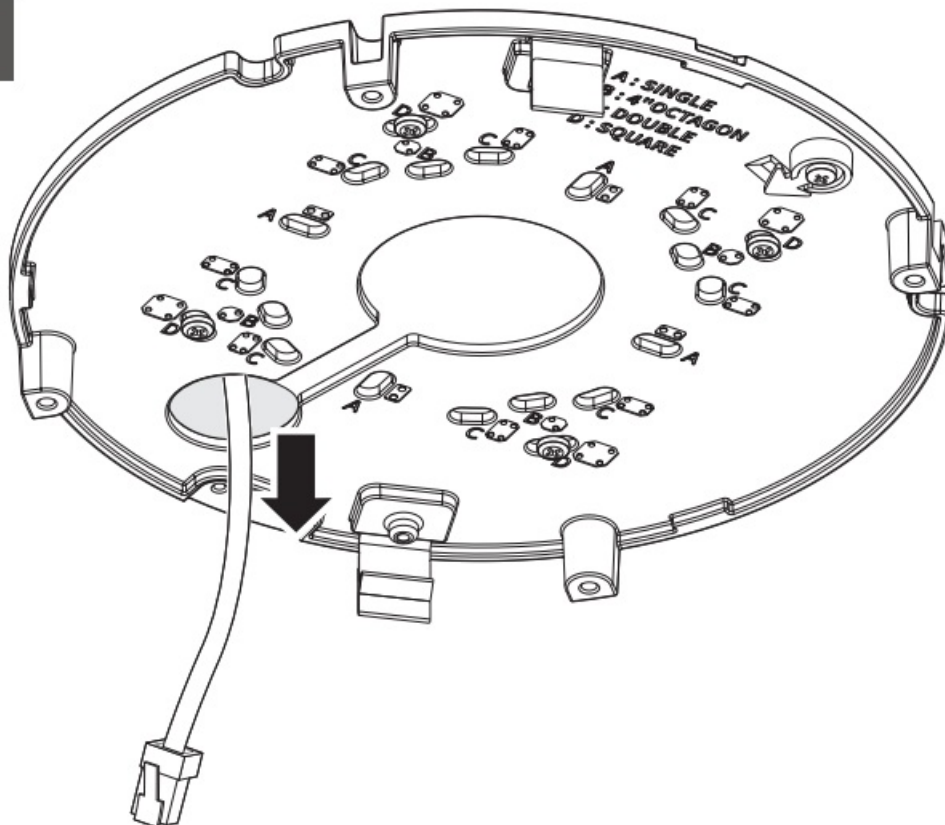

When connecting the cable to the side.

6-1

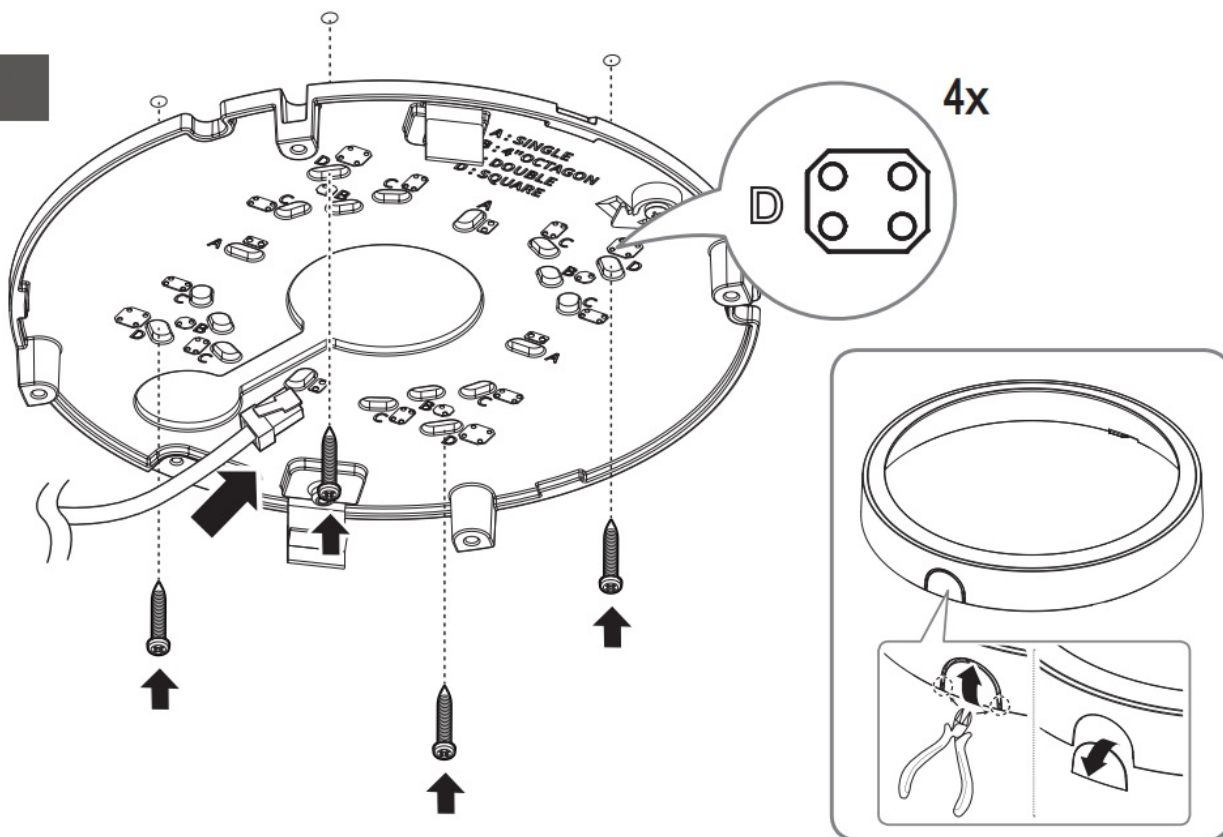

Installation by connecting pipes

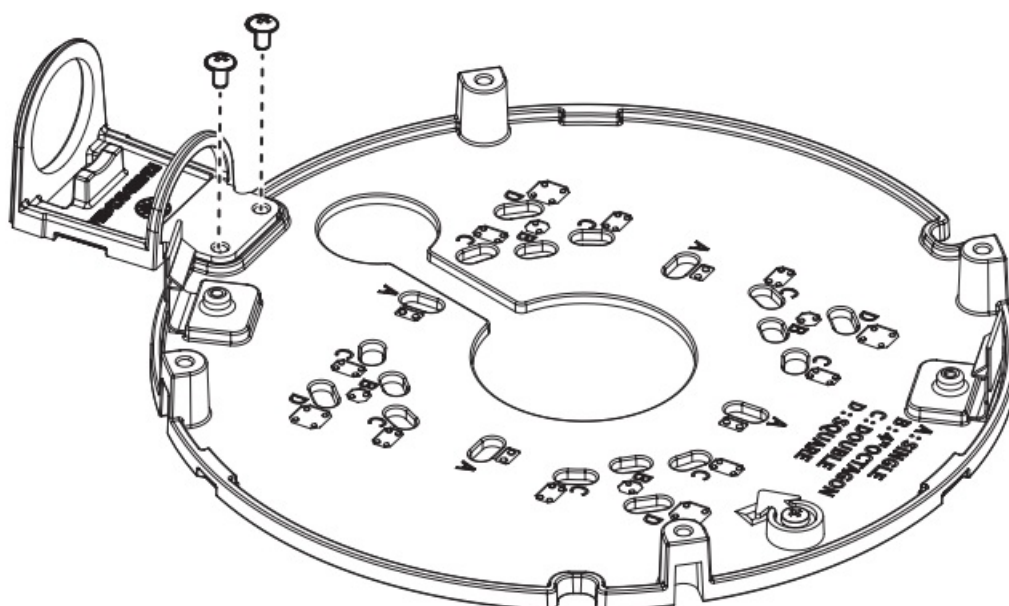

Option (not included)

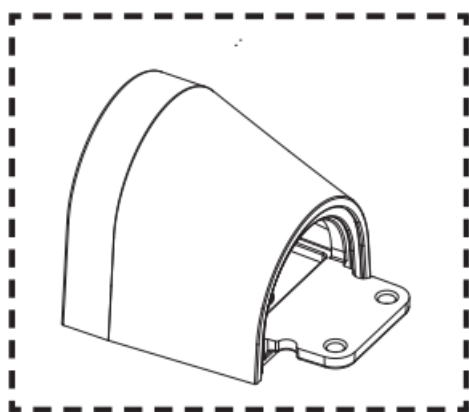

SBP-060BA

7-2

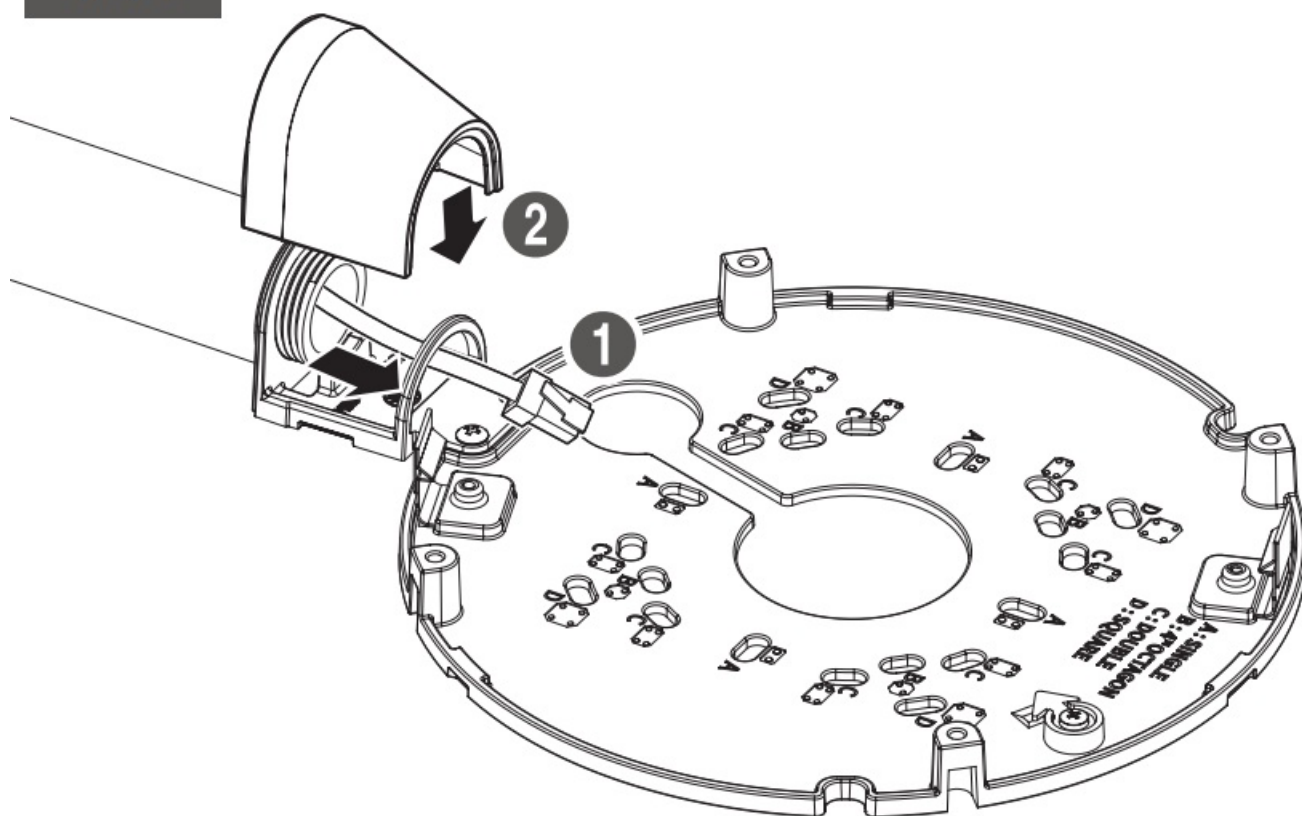

8

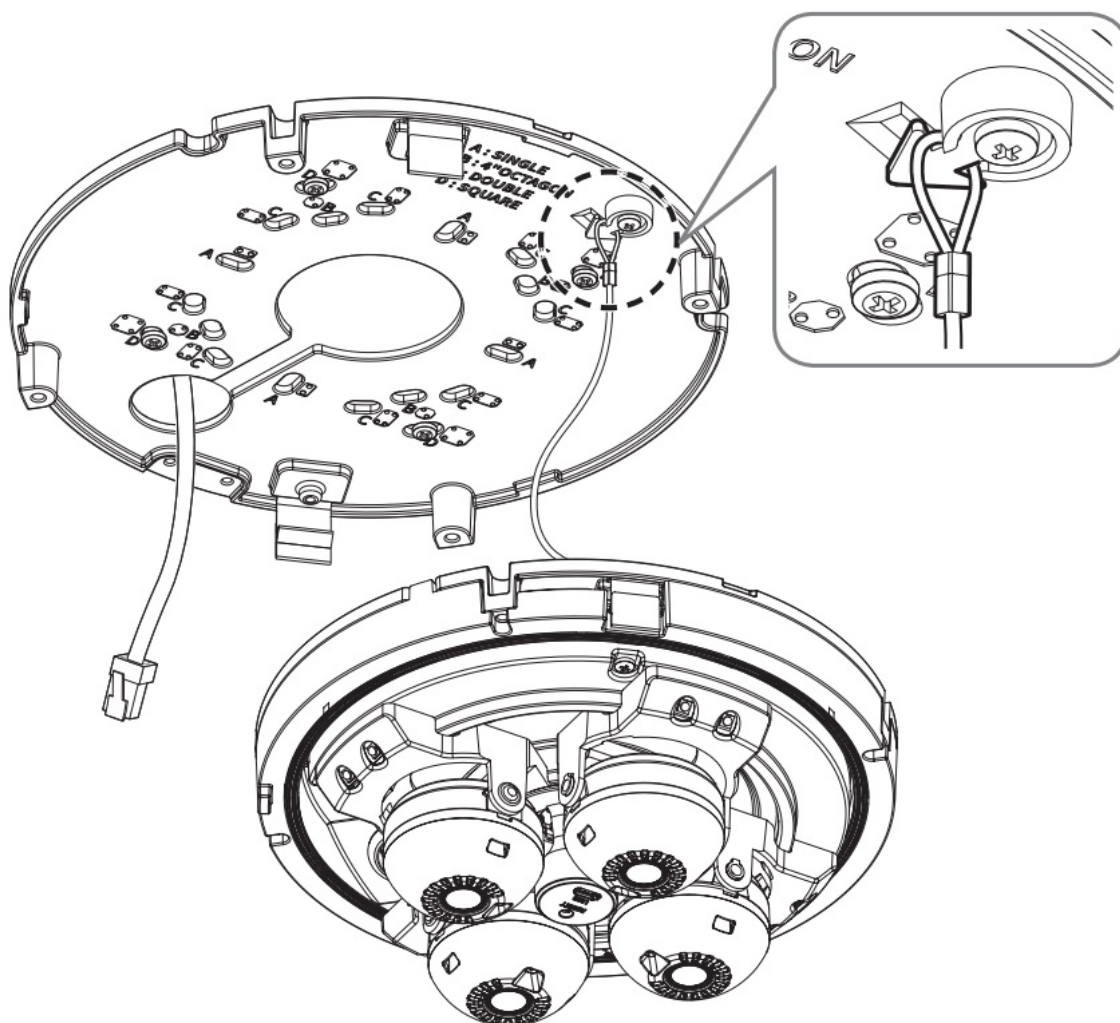

9

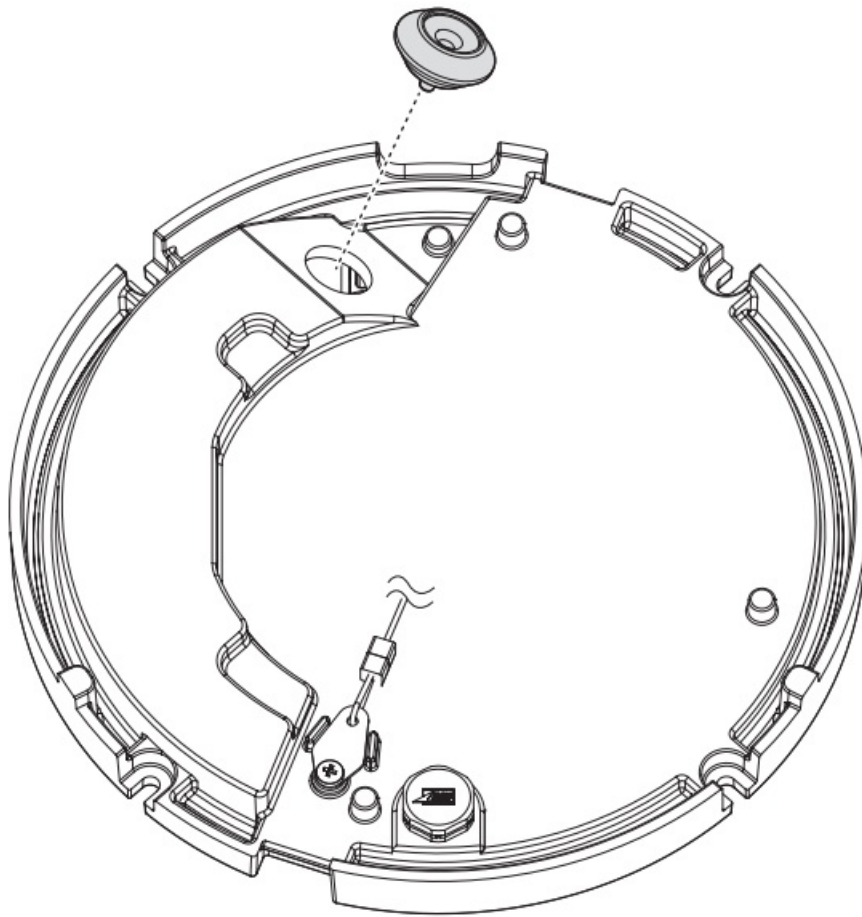

Network cable installation (IP66)

10

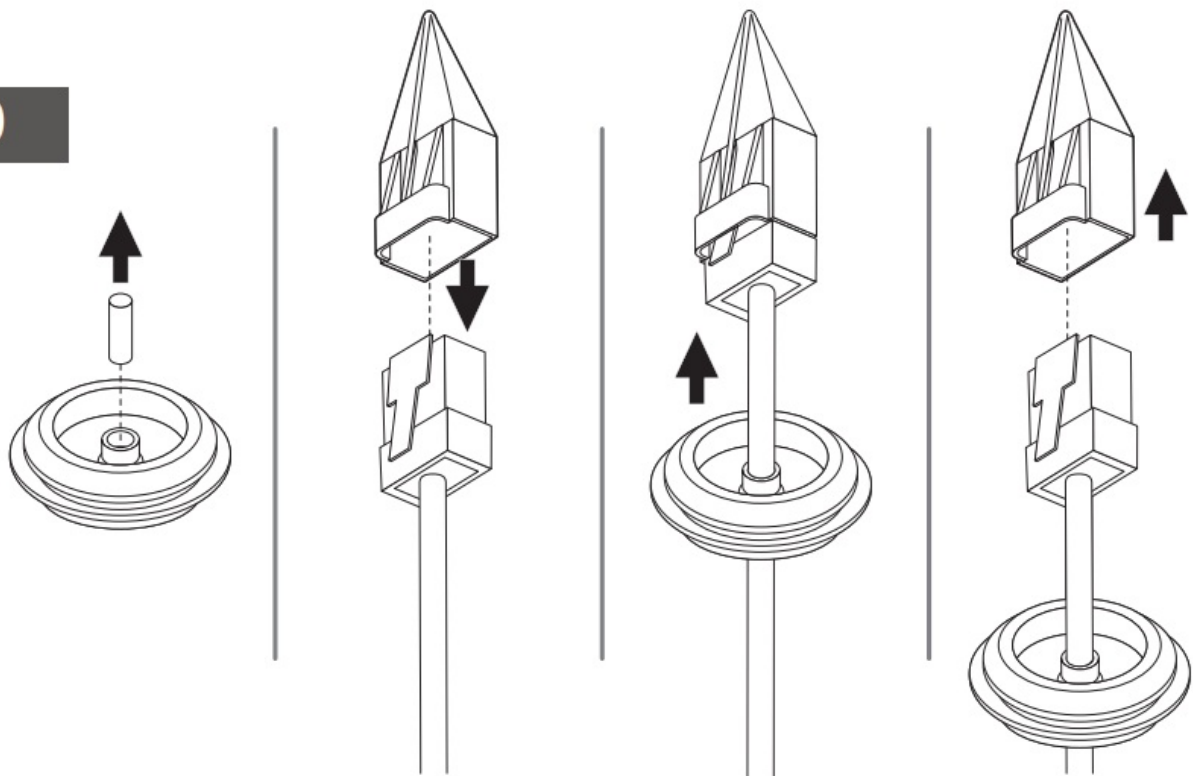

11

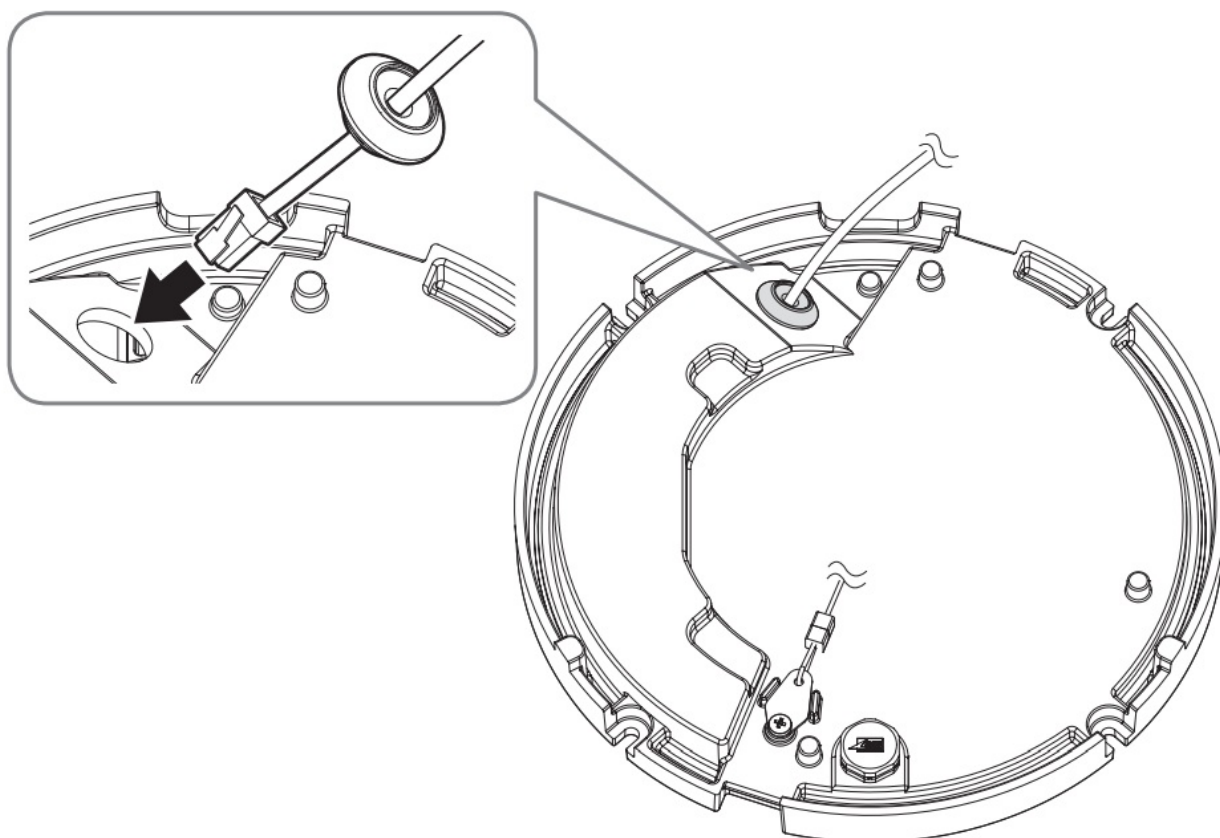

12

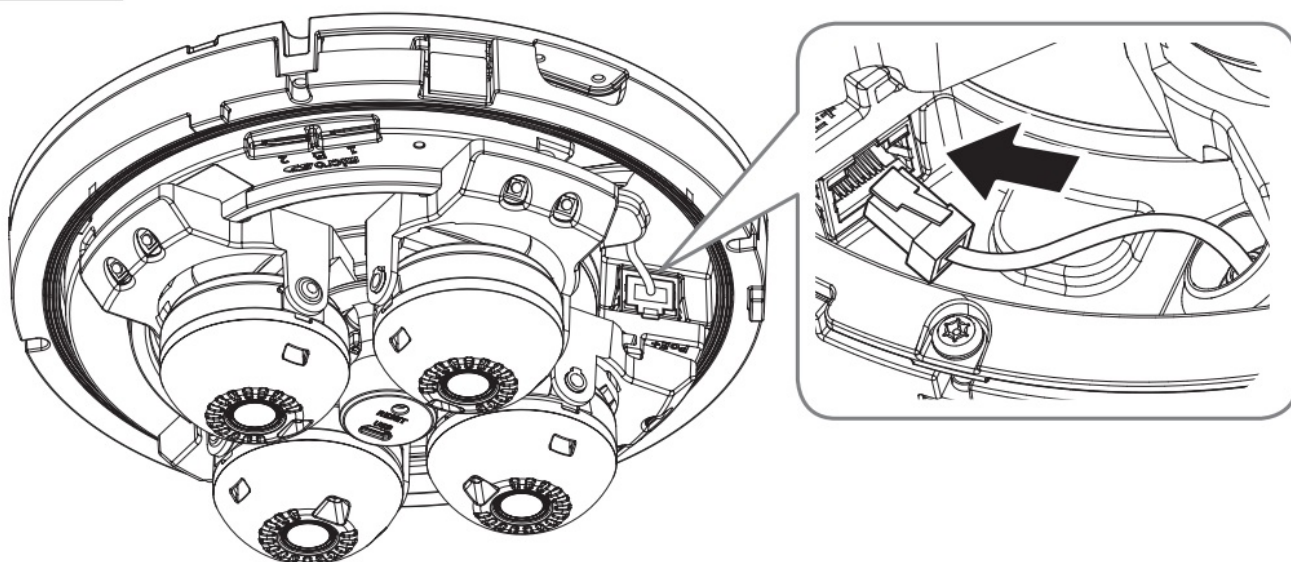

13

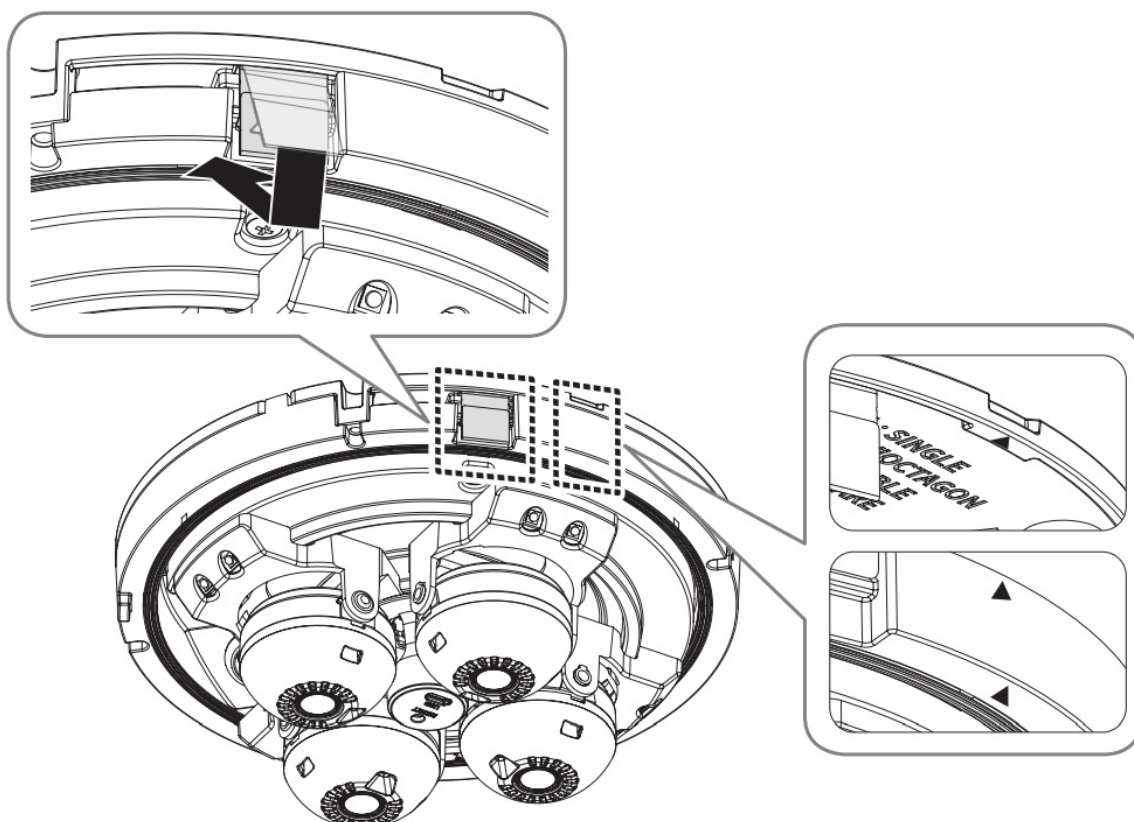

Separately purchased items: WiFi dongle, OTG adapter

14

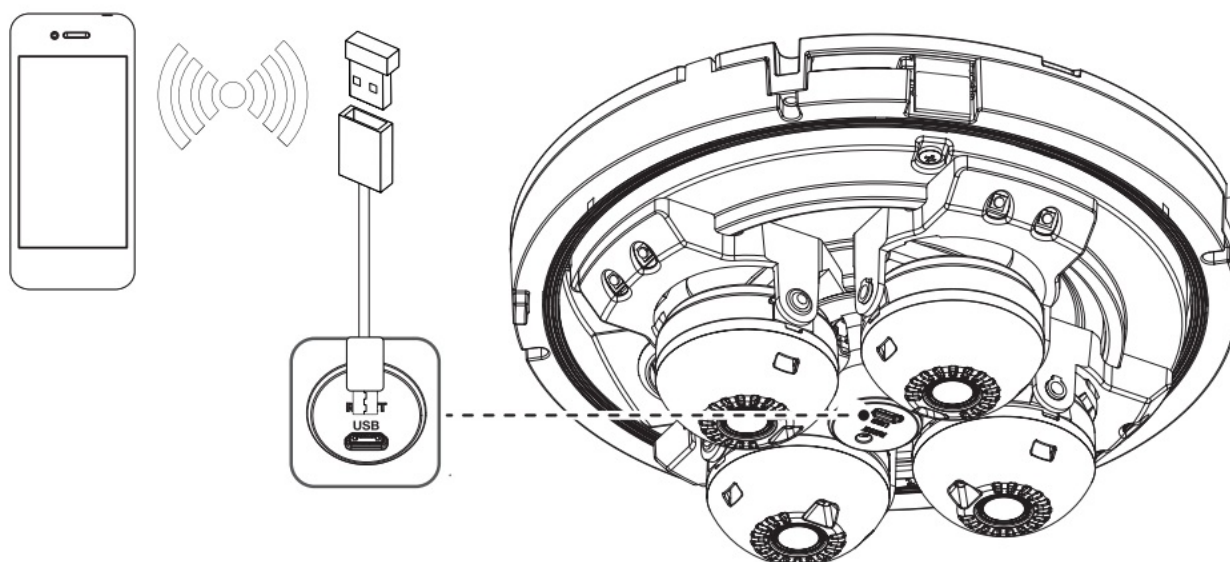

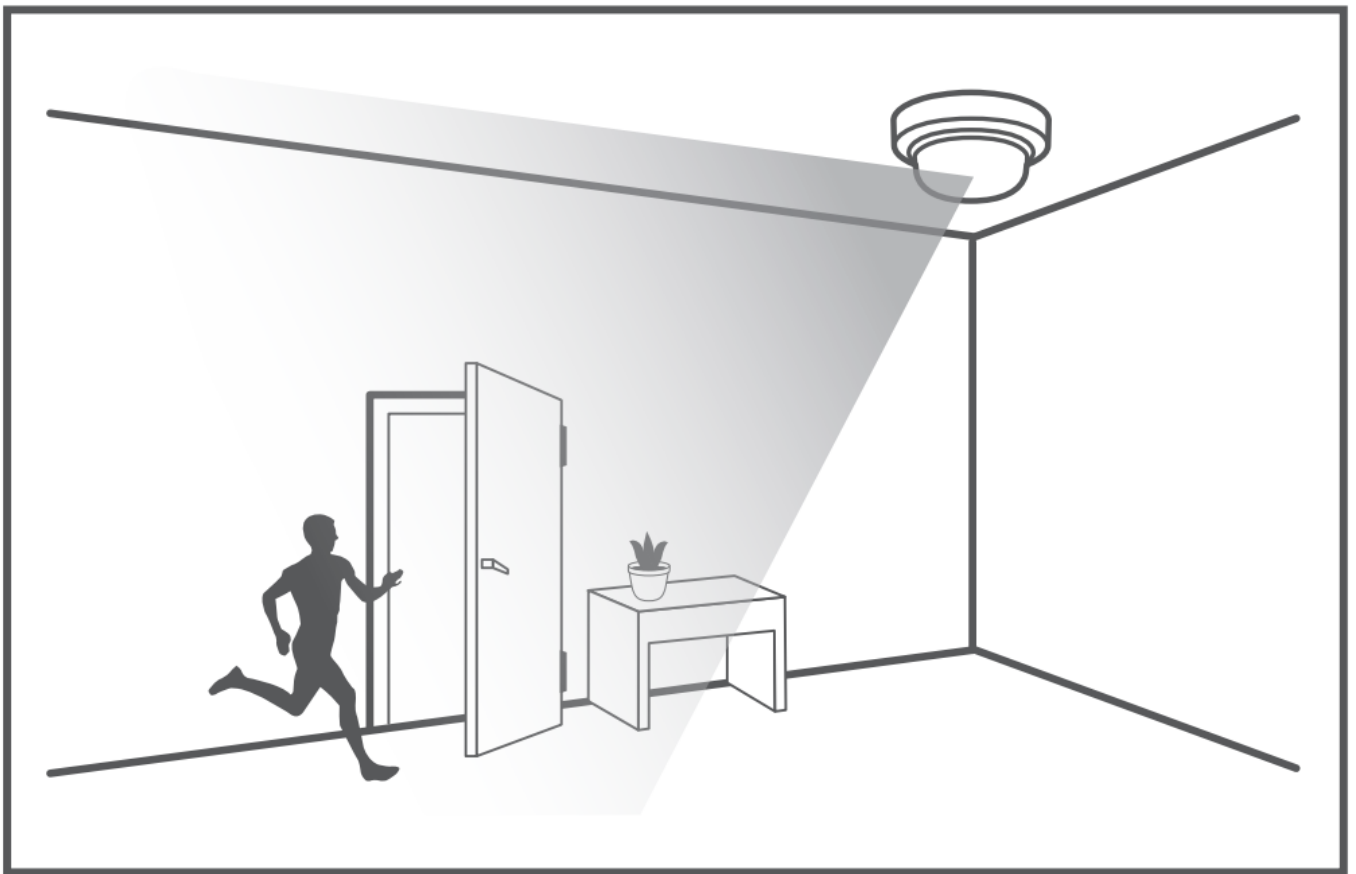

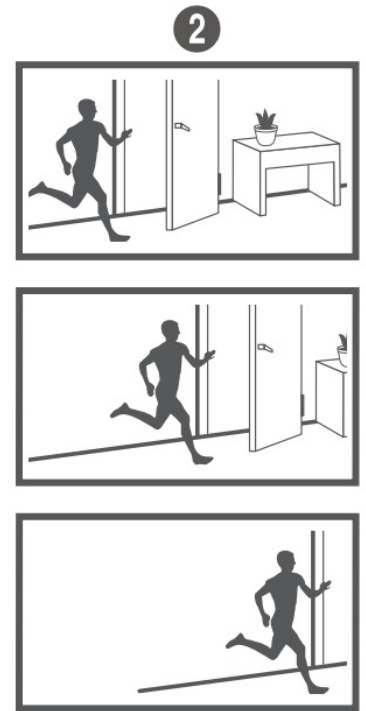
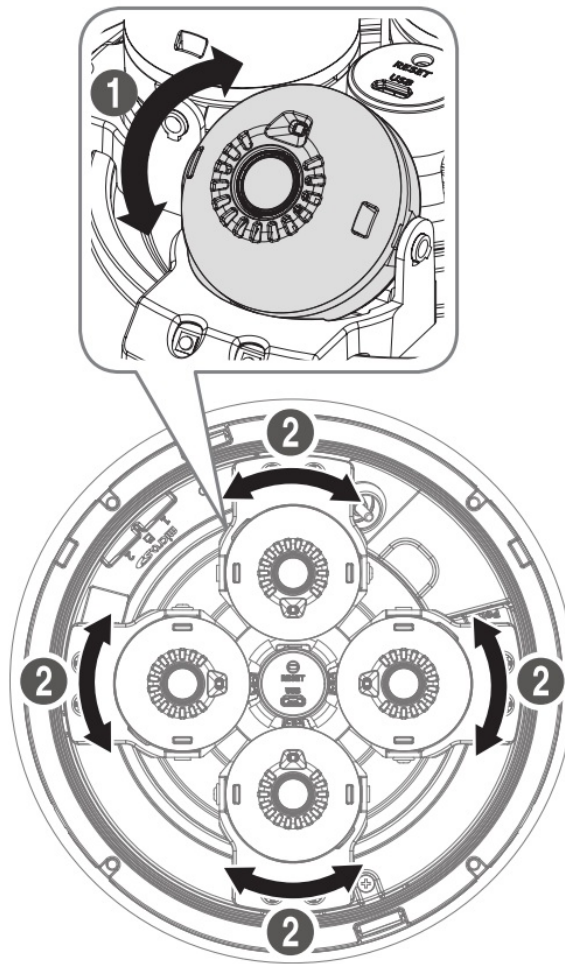
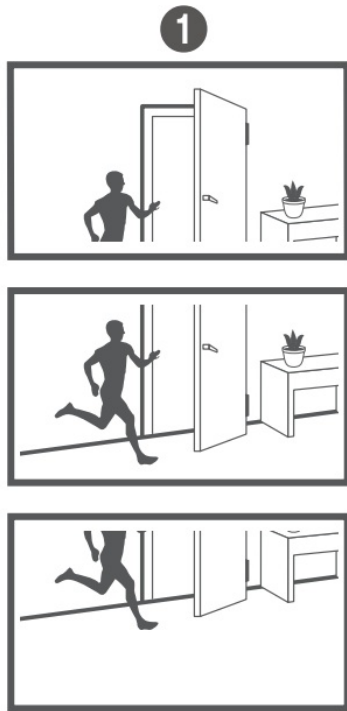

17

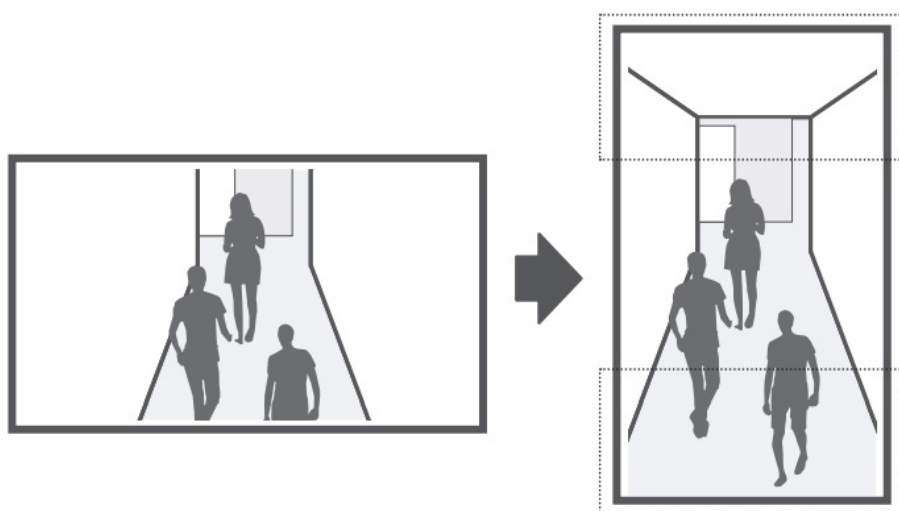
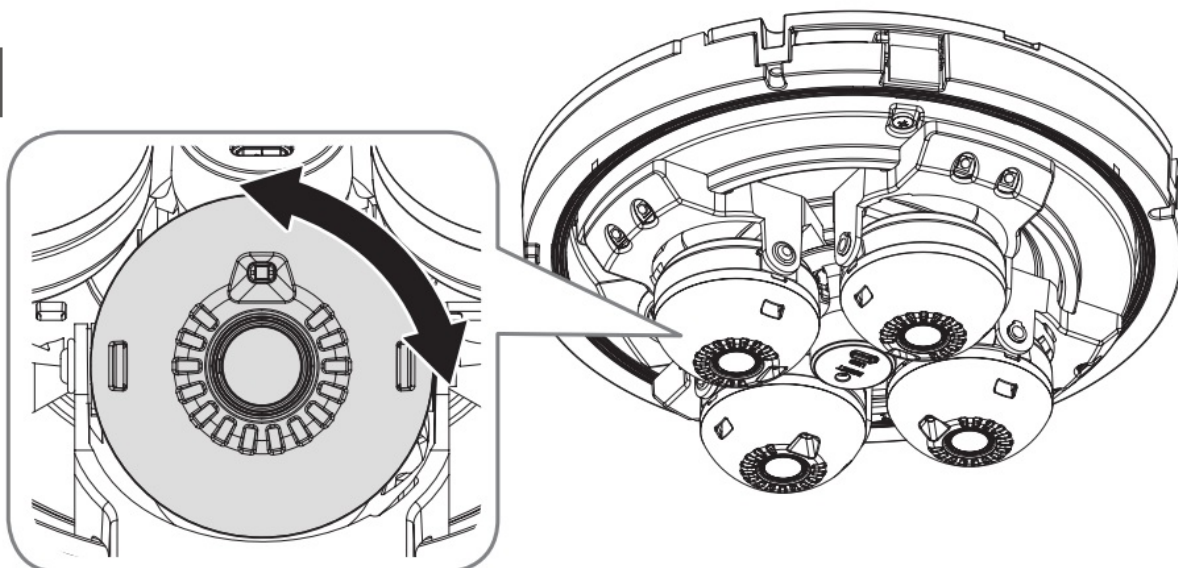

18

4x

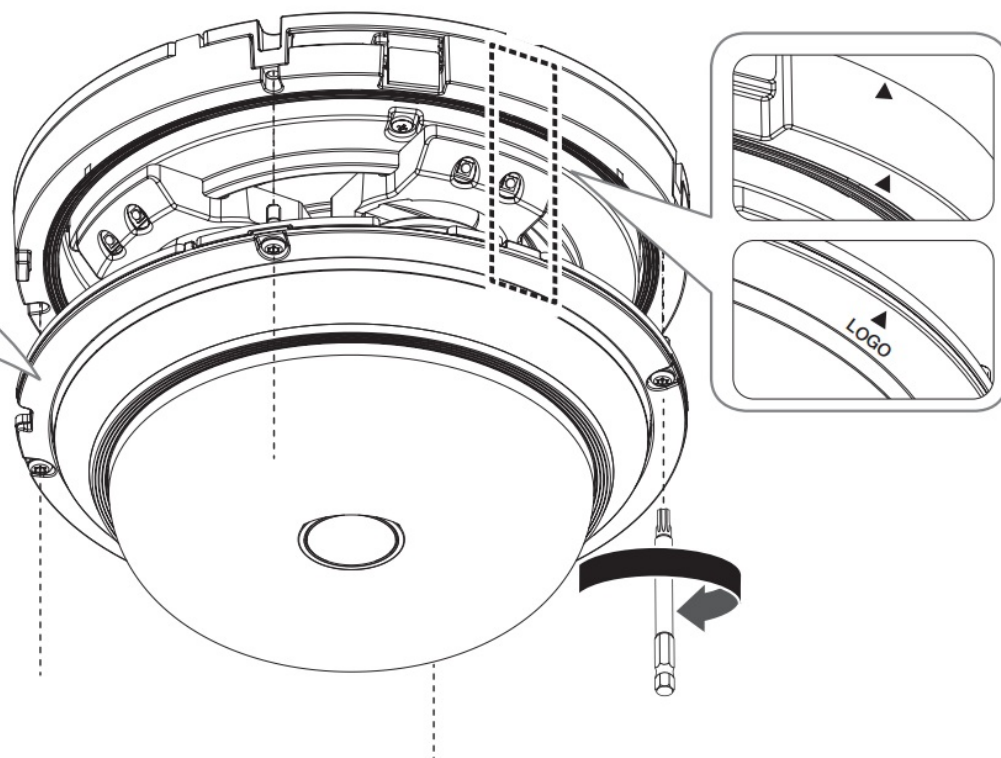
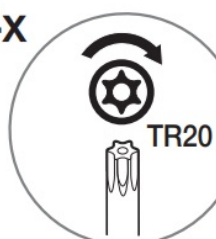

19

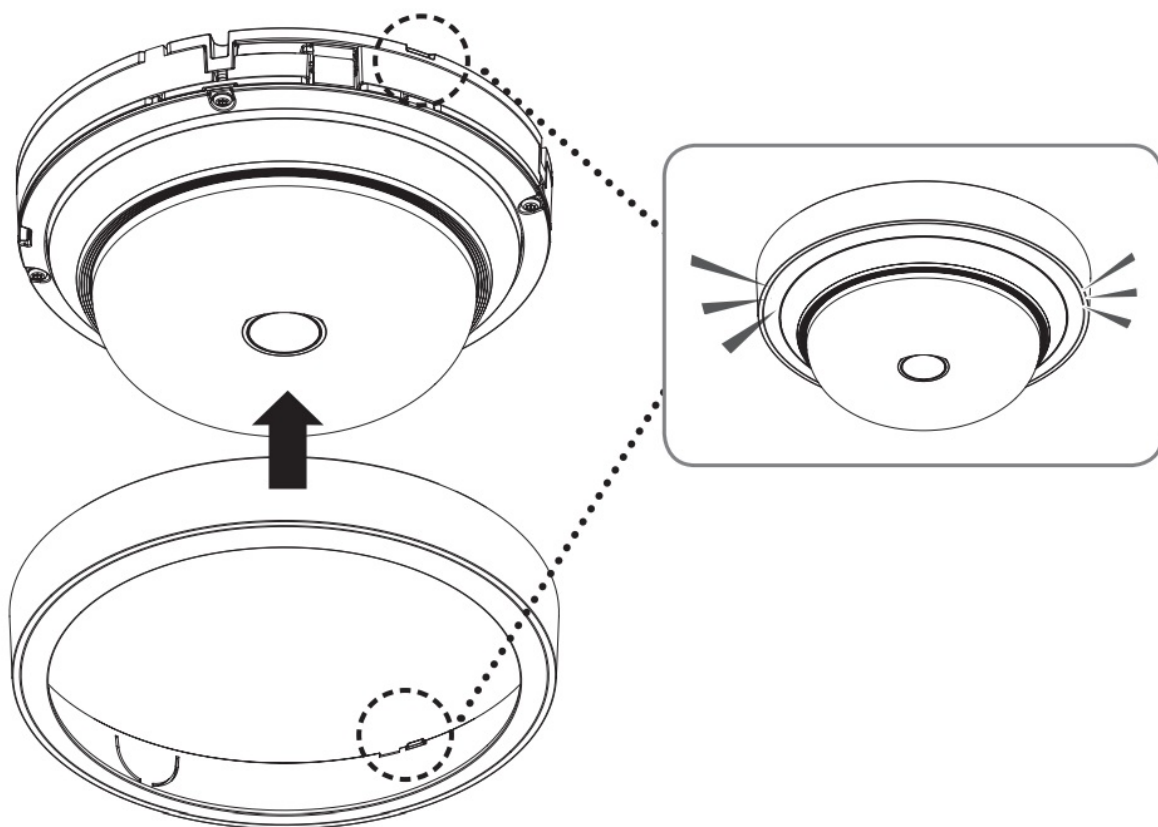

Removing the top case

20

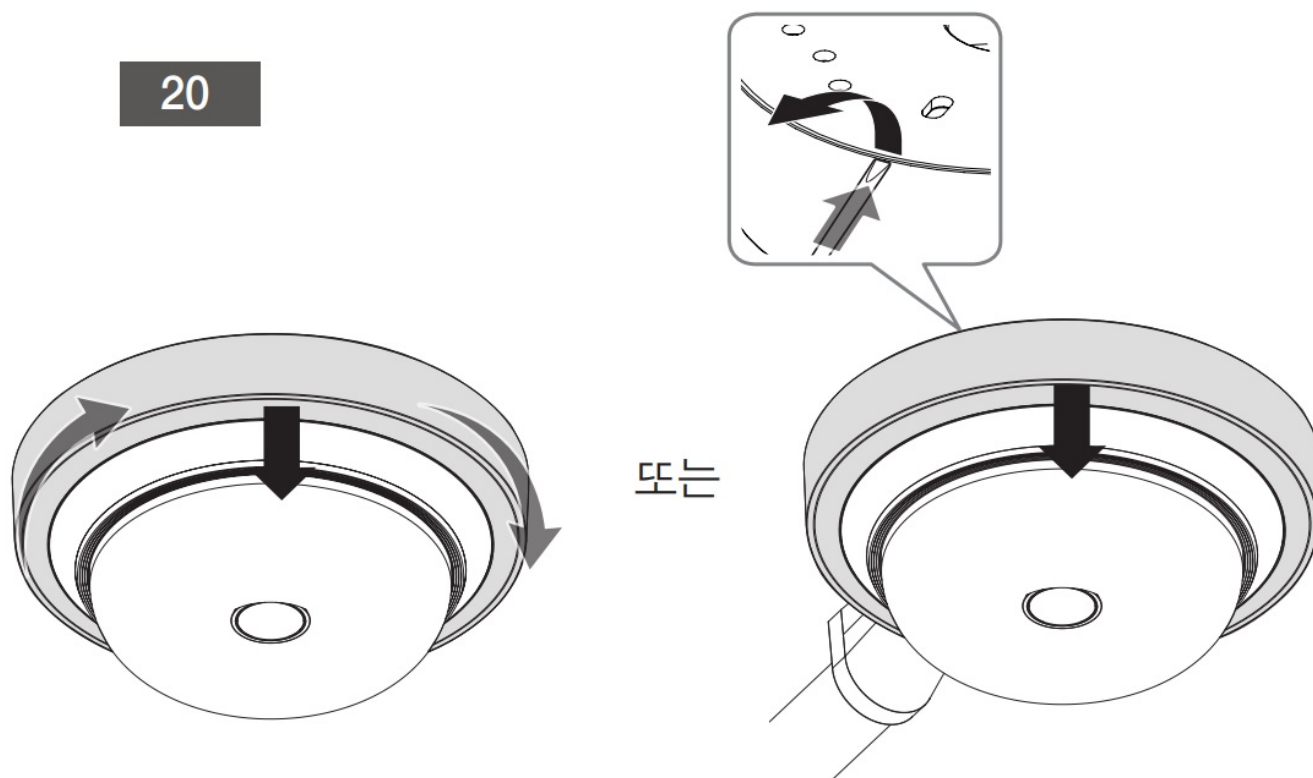

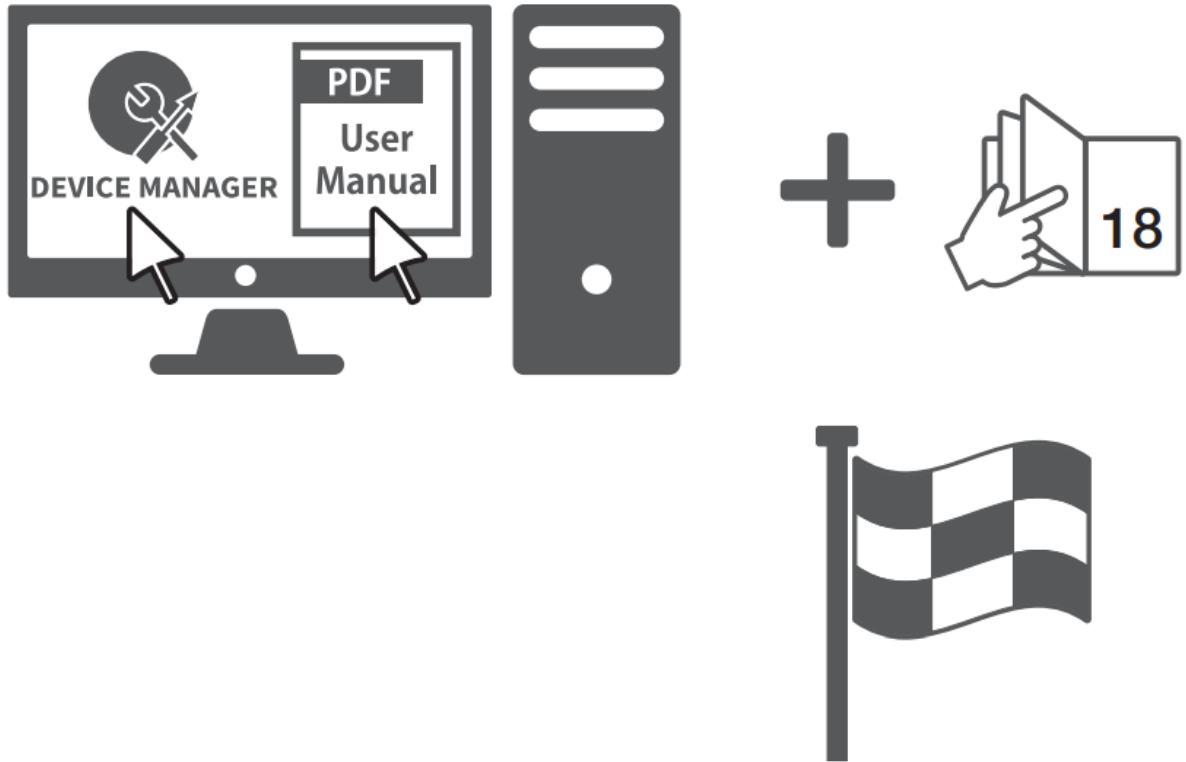

WiFi

Camera settings

1. OTG adapter (5 pin) and WiFi to Micro USB terminal Connect the dongle.

Smartphone settings

1. Wisenet Installation application Install it.
2. After turning on WiFi, select the camera's SSID.
3. Wisenet Installation application Run it.
4. When you log in to the camera, the video will be connected.
 - When you first connect, the video will run without logging in.
5. While watching a video on a smartphone, adjust the camera's angle of view can be adjusted.

Customer Support

Class A equipment (business broadcasting and communication equipment)

This device is an electromagnetic wave compatibility device for business use (Class A), so sellers or users should be aware of this.

It is intended for use in areas other than home. <https://www.HanwhaVision.com>

This product is intended for use only in Korea, and its quality is not guaranteed overseas.

FOR KOREA UNIT STANDARD ONLY

Documents / Resources

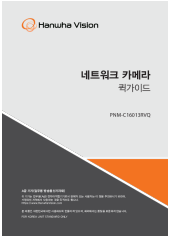
	<p>Hanwha Vision PNM-C16013RVQ Global Solution Provider Camera [pdf] Instruction Manual PNM-C16013RVQ Global Solution Provider Camera, PNM-C16013RVQ, Global Solution Provider Camera, Solution Provider Camera, Provider Camera, Camera</p>
---	--

References

- [W Hanwha Vision - Global Vision Solution Provider](#)
- [W Hanwha Vision - Global Vision Solution Provider](#)
- [User Manual](#)