



Hanwha Vision PNB-A9001 Network Camera User Guide

[Home](#) » [Hanwha Vision](#) » Hanwha Vision PNB-A9001 Network Camera User Guide 

Contents

- [1 Hanwha Vision PNB-A9001 Network Camera](#)
- [2 Product Information](#)
- [3 Product Usage Instructions](#)
- [4 NETWORK CAMERA Quick Guide](#)
- [5 COMPONENT](#)
- [6 INSTALLATION](#)
- [7 PASSWORD SETTING](#)
- [8 LOGIN](#)
- [9 CONNECTING TO WiFi](#)
- [10 Documents / Resources](#)
 - [10.1 References](#)
- [11 Related Posts](#)



Hanwha Vision PNB-A9001 Network Camera



Product Information

The Network Camera is a high-quality outdoor bullet camera (PNO-A9081R) and box camera (PNB-A9001) designed for surveillance purposes. It offers advanced features and functionalities to ensure reliable and efficient monitoring.

Specifications

- **Model:** PNO-A9081R (Outdoor Bullet Camera), PNB-A9001 (Box Camera)
- **Installation:** Outdoor
- **Resolution:** High Definition
- **Connectivity:** Network
- **Power:** PoE+ or DC 12V
- **Audio:** In/Out
- **Video:** Network/USB
- **Alarm:** Input/Output
- **Dimensions:** Varies based on model

Product Usage Instructions

Installation

1. Choose a suitable location for the camera installation, ensuring it is placed securely.
2. Refer to the provided diagram for component identification.
3. Follow the step-by-step installation instructions provided in the manual.
4. Make necessary connections, including power supply, audio in/out, video network, and USB focus.
5. If using PoE+, connect the camera to a PoE+ power source. If using DC 12V, connect the camera to a DC 12V power source.
6. Configure the camera settings according to your requirements.
7. If desired, connect additional options such as a CS lens.

8. Ensure all connections are secure and properly tightened.
9. Test the camera functionality to ensure it is working correctly.

Password Setting

When accessing the product for the first time, you need to register a login password. Follow these steps:

1. Enter “admin” in the User ID input box.
2. Enter your desired password in the password input field.
3. Click the “OK” button to confirm.

Connecting to WiFi

To connect the camera to WiFi, follow these steps:

1. Connect an OTG adapter (5-pin) and WiFi dongle to the micro USB terminal of the camera.
2. Install the Wisenet Installation application on your smartphone.
3. Turn on the WiFi and select the camera SSID on your smartphone.
4. Launch the Wisenet Installation application on your smartphone.
5. Login to the camera using your credentials. The video feed will be connected.
6. You can adjust the angle of view while watching the video through your smartphone.

FAQ

- **Q: What is the power source for the camera?**

A: The camera can be powered using PoE+ or DC 12V.

- **Q: Can I connect additional options to the camera?**

A: Yes, you can connect options such as a CS lens for enhanced functionality.

- **Q: How do I set a password for the camera?**

A: When accessing the camera for the first time, enter “admin” as the User ID and choose your desired password. Click “OK” to confirm.

- **Q: How do I connect the camera to WiFi?**

A: To connect the camera to WiFi, connect an OTG adapter and WiFi dongle to the micro USB terminal of the camera. Install the Wisenet Installation application on your smartphone, turn on WiFi, select the camera SSID, and launch the application to login and establish a video feed.

NETWORK CAMERA Quick Guide

Outdoor Bullet Camera
PNO-A9081R

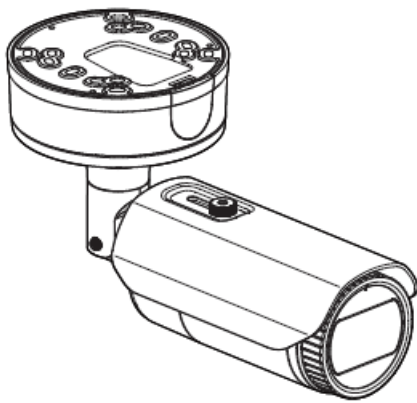

Box Camera
PNB-A9001

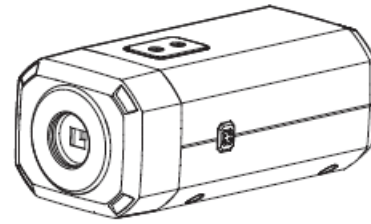

COMPONENT

As for each sales country, accessories are not the same.

- PNO-A9081R

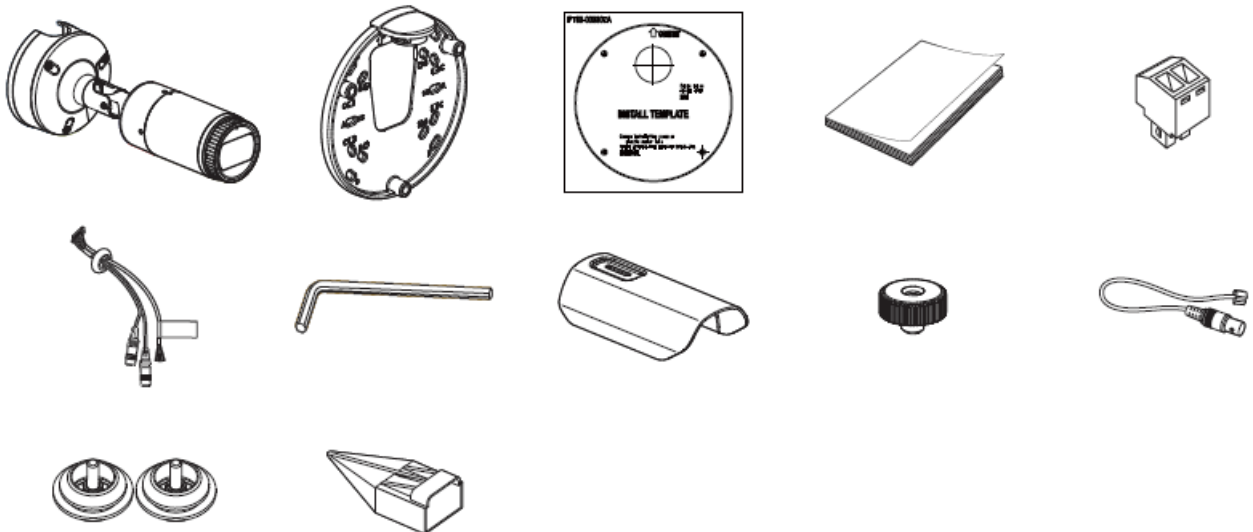

INSTALLATION

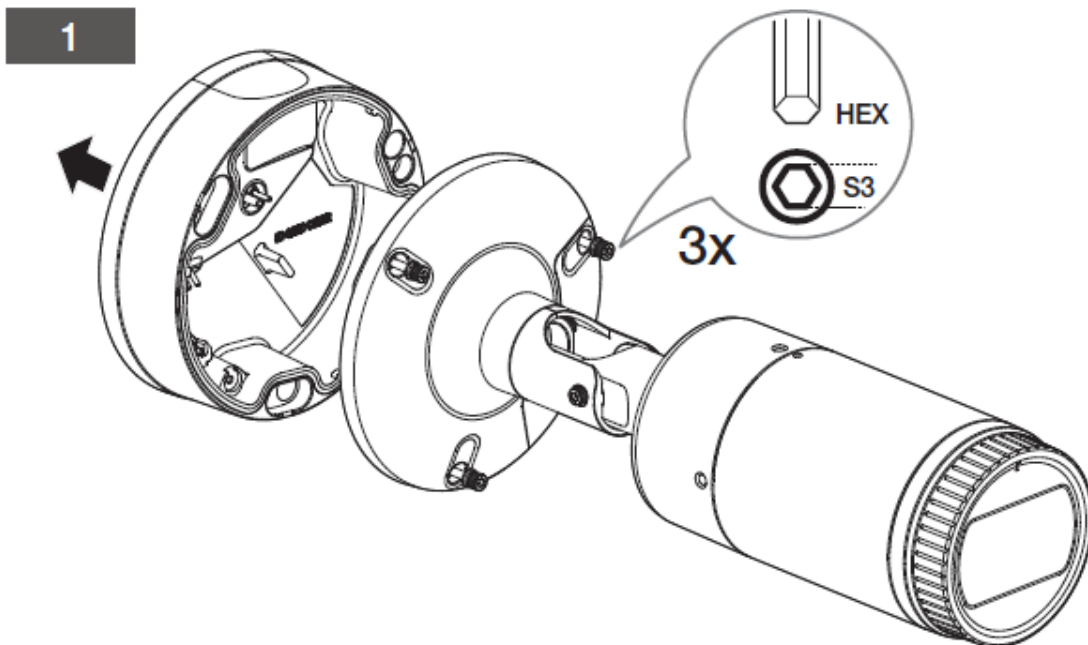

Not Included : Micro SD Card

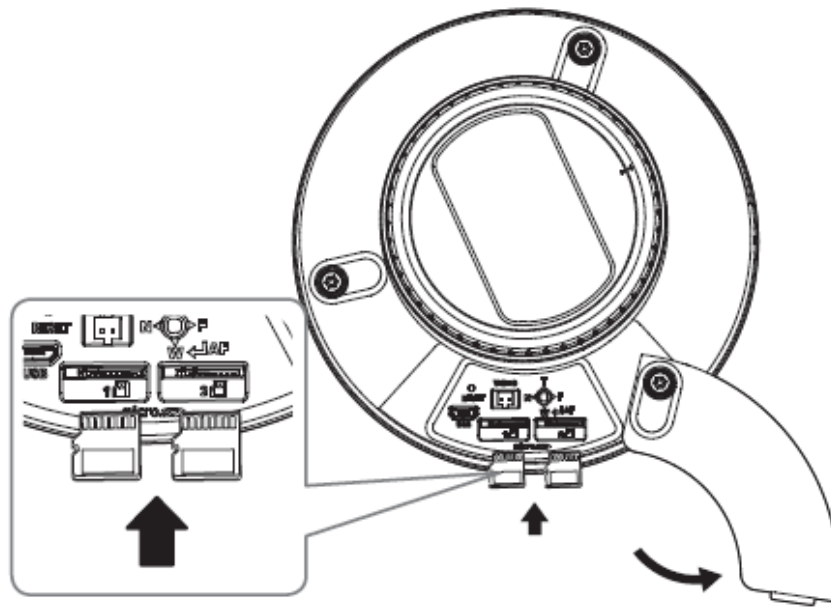

3

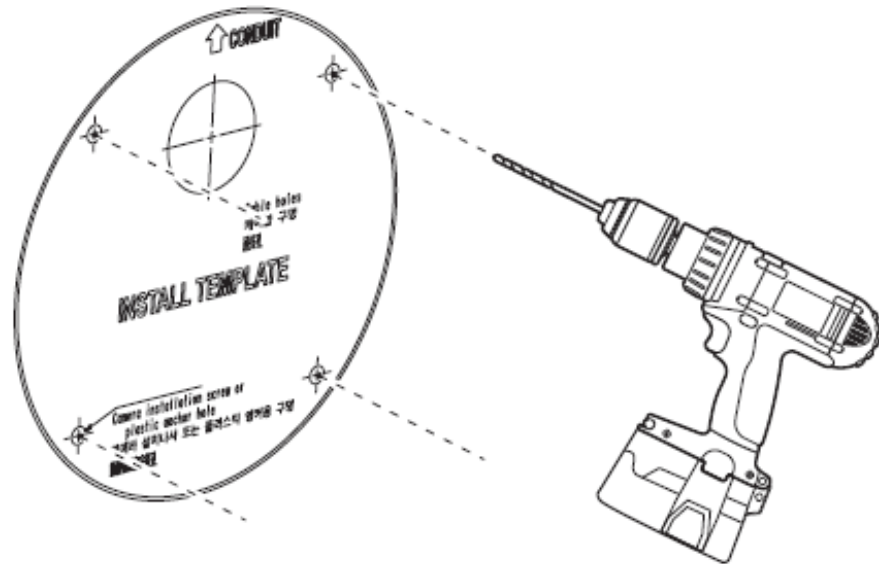

Directly installing on wall/ceiling

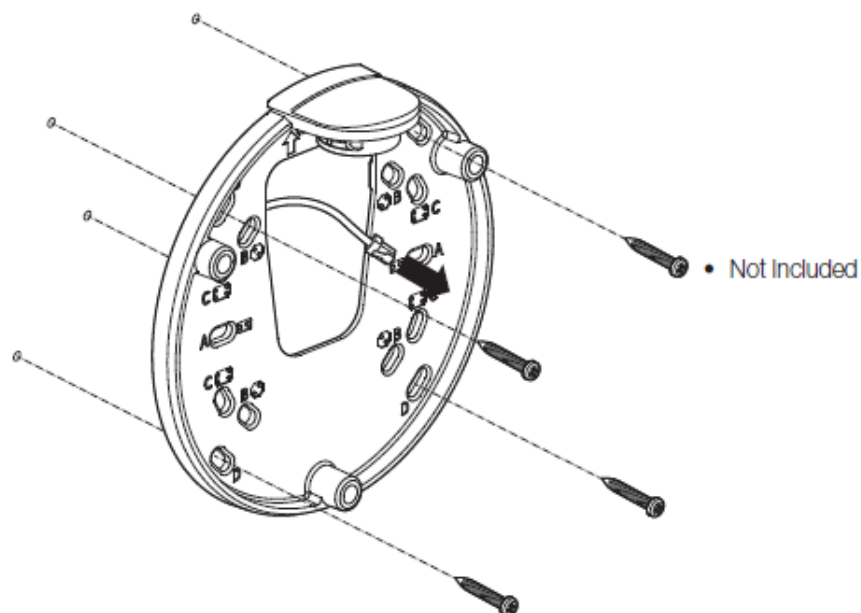

Installing using pipe

5-1

• Installing using pipe

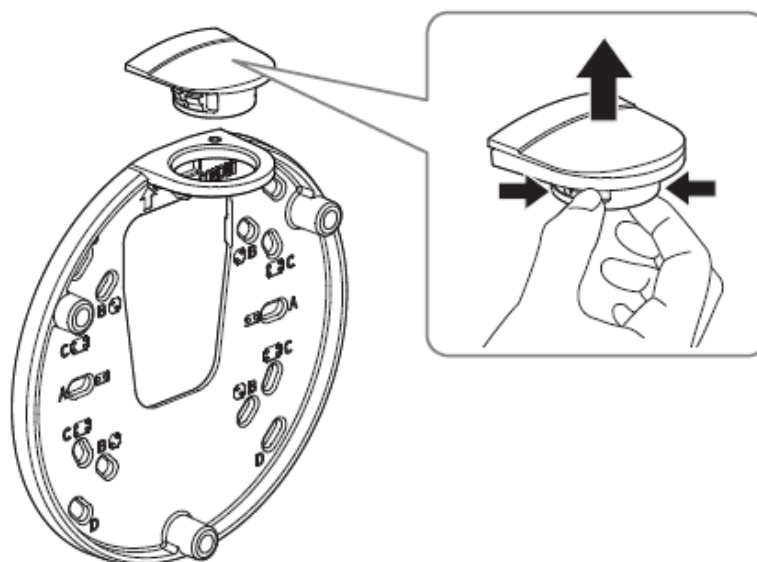

5-2

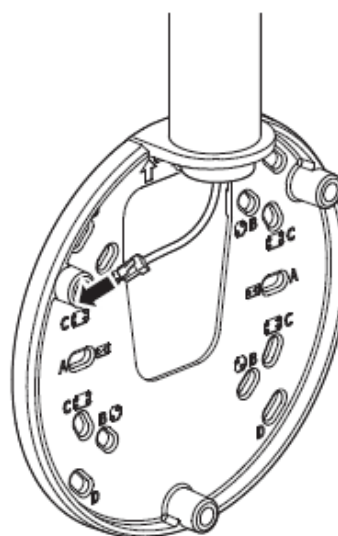

Installing LAN/power cables

6-1 • Installing LAN/power cables

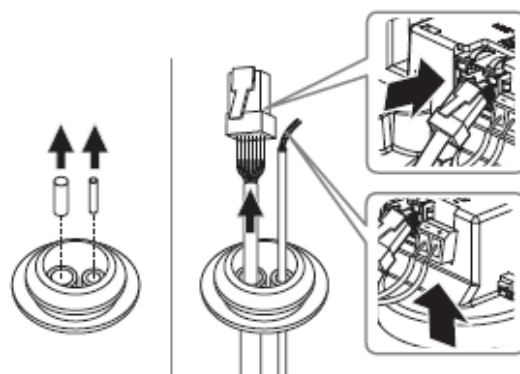

6-2

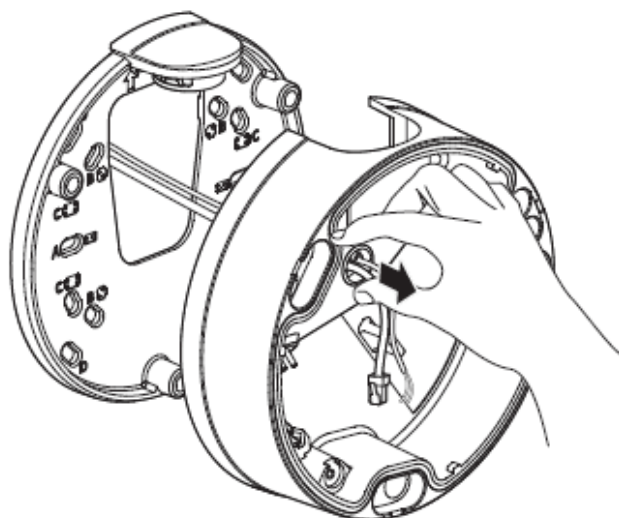

7-1

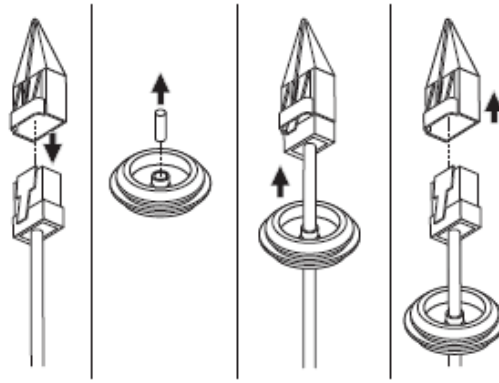

7-2

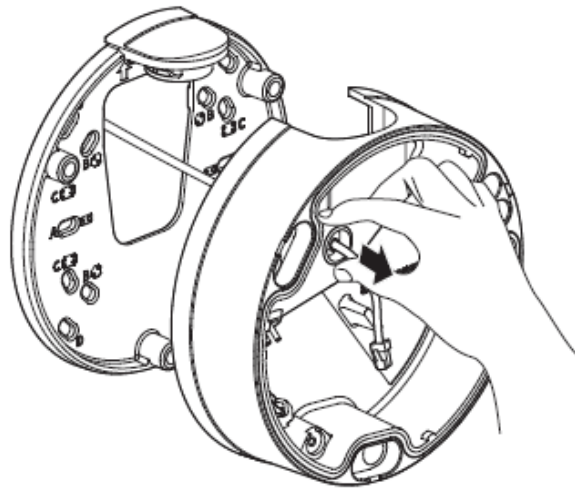

8

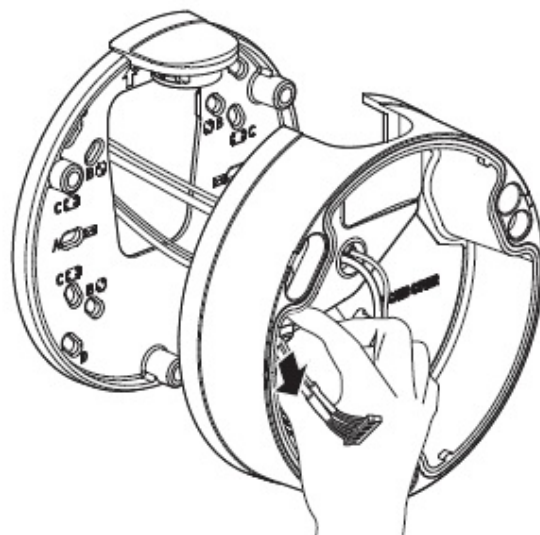

9

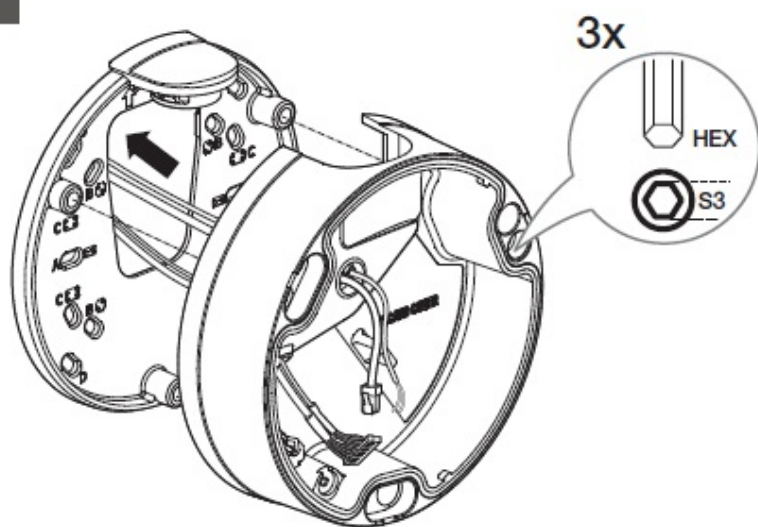

10

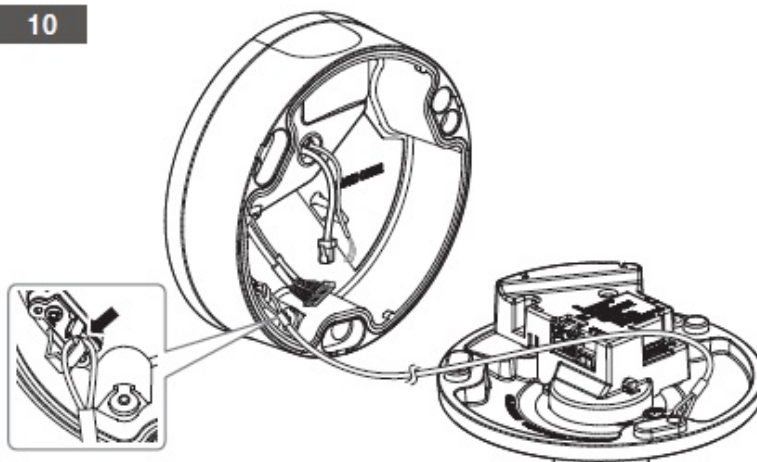

11

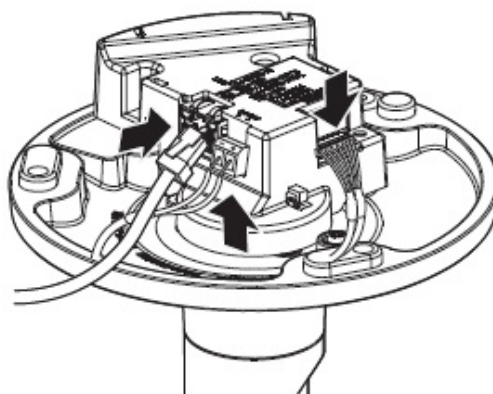

Not Included : WiFi dongle, OTG adapter

12

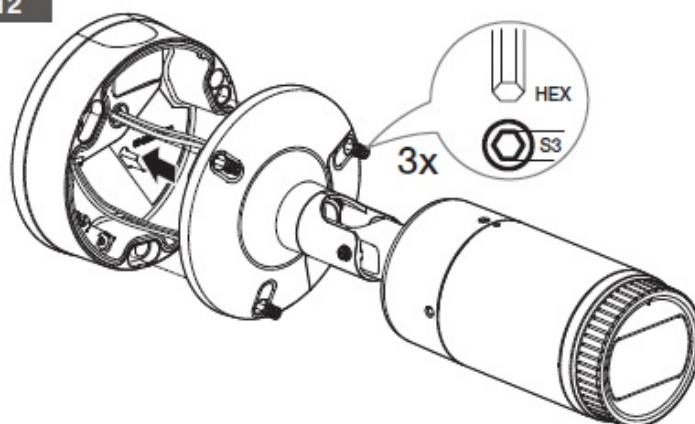

13

• Not included : WiFi dongle, OTG adapter

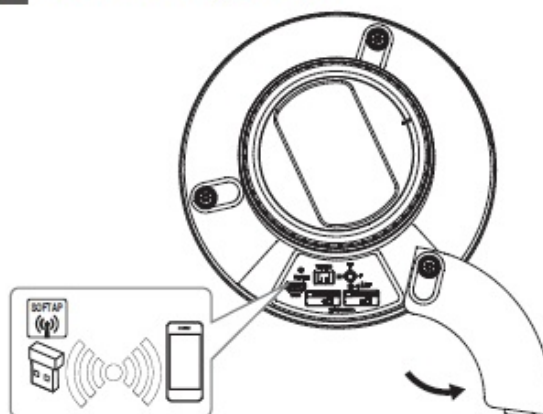

14



15

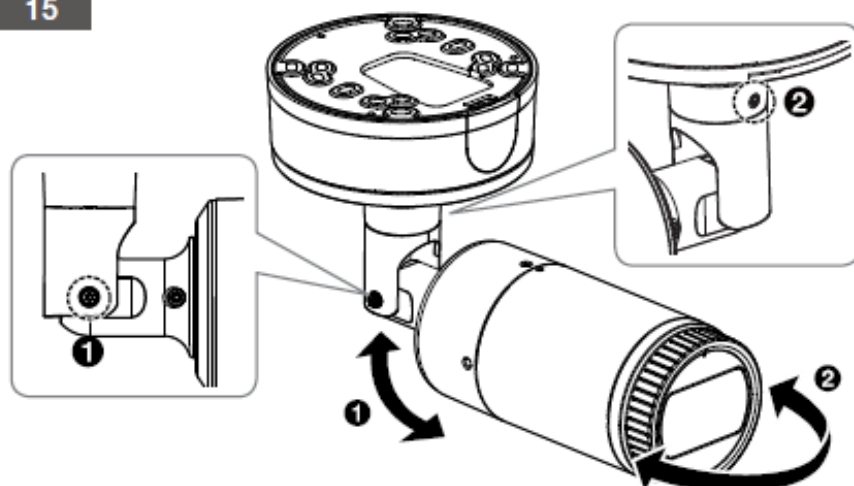

16

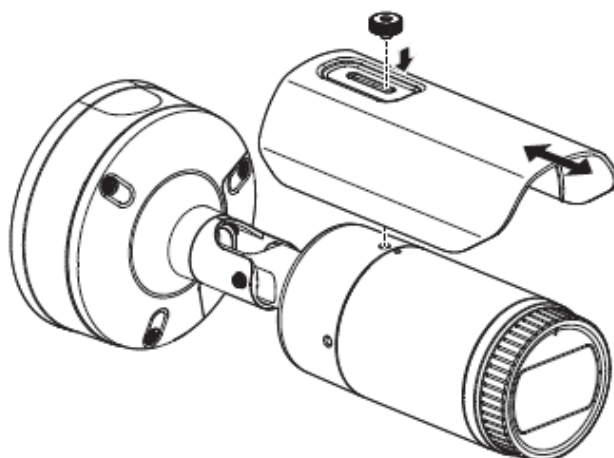

17



COMPONENT

As for each sales country, accessories are not the same.

~ PNB-A9001

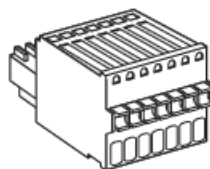
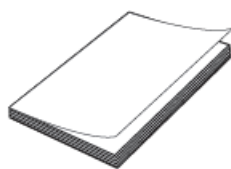
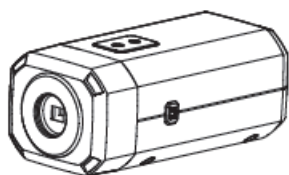

Options (not included)

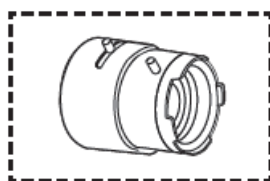

CS Lens

1

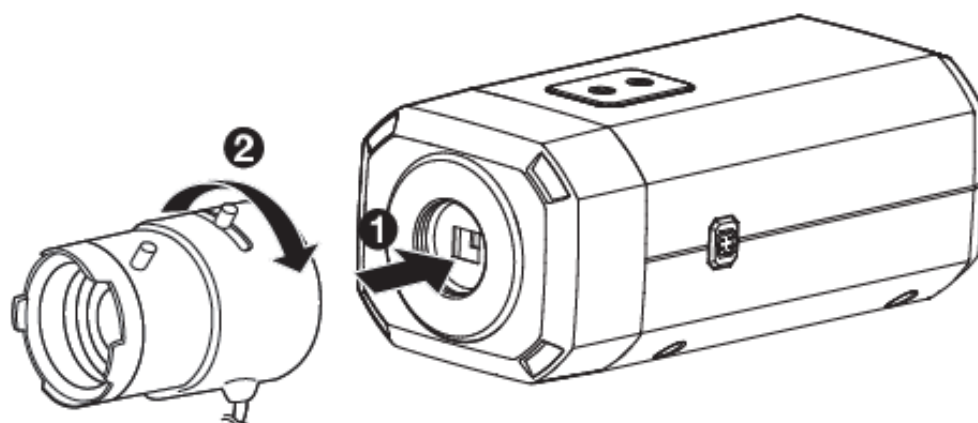

2

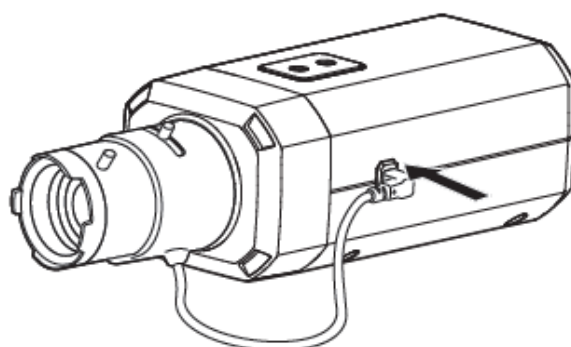

3

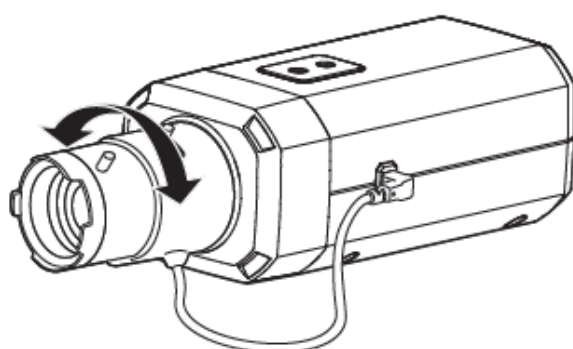

4

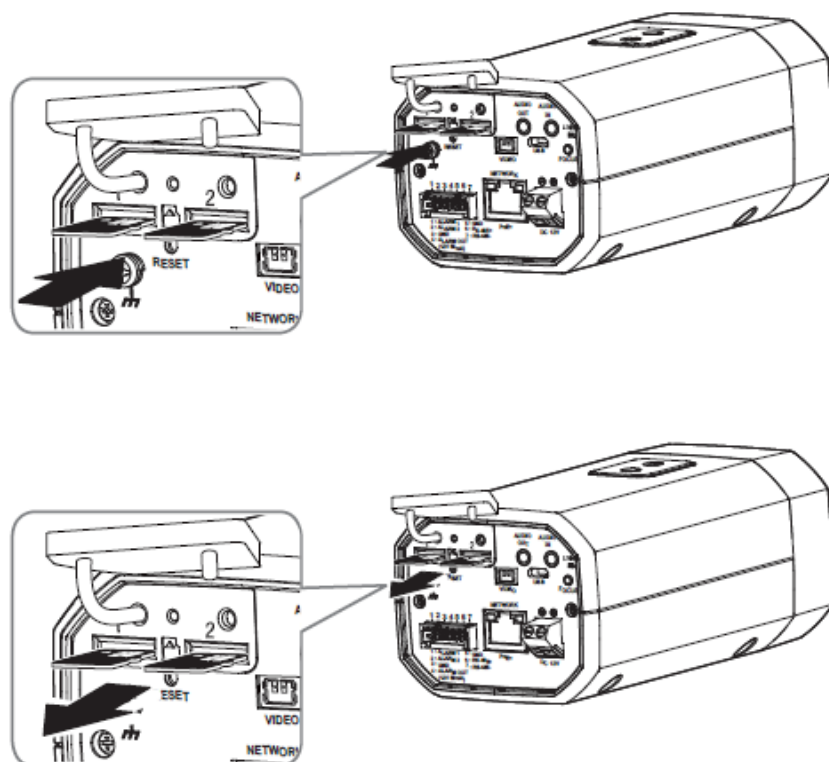

Not included: WiFi dongle, OTG adapter

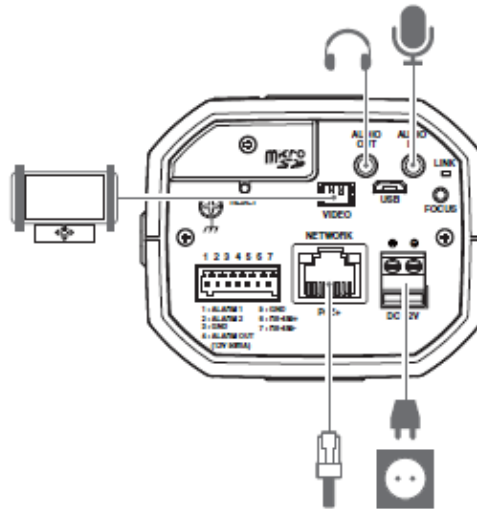

- Not included: WiFi dongle, OTG adapter

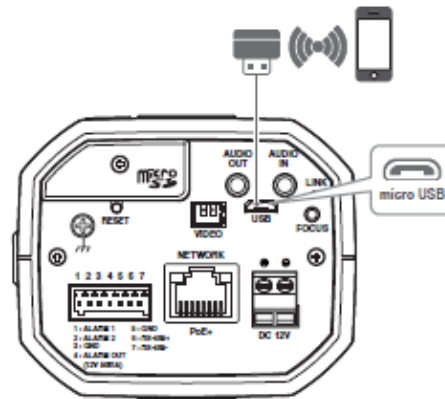

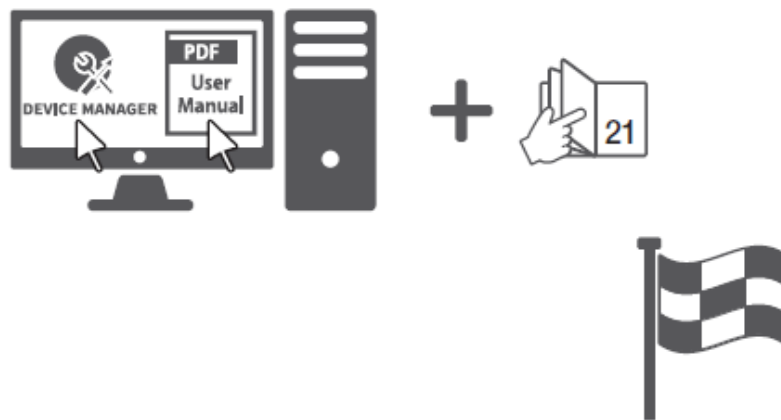

PASSWORD SETTING

When you access the product for the first time, you must register the login password.

Administrator password change

New password

Confirm new password

. If the password is 8 to 9 letters long, then it should be a combination of at least three types upper/lower case alphabets, numbers and special characters.
 . If the password is 10 to 15 letters long, then it should be a combination of at least two types upper/lower case alphabets, numbers and special characters.
 . User name should be different from password.
 . The following special characters are available for use. ~`!@#\$\$%^*()_-=|{}[].?/
 . Don't use 4 or more characters consecutive together. (examples : 1234, abcd)
 . Don't use 4 or more characters repeated. (examples : !!!!, 1111, aaaa)

- For a new password with 8 to 9 digits, you must use at least 3 of the following: uppercase/lowercase letters, numbers and special characters. For a password with 10 to 15 digits, you must use at least 2 types of those mentioned.
- Special characters that are allowed. : ~`!@#\$\$%^*()_-=|{}[].?/
- For higher security, you are not recommended to repeat the same characters or consecutive keyboard inputs

for your passwords.

- If you lost your password, you can press the [RESET] button to initialize the product. So, don't lose your password by using a memo pad or memorizing it.

LOGIN

Whenever you access the camera, the login window appears.
Enter the User ID and password to access the camera.

1. Enter "admin" in the <User Name> input box.
2. Enter the password in the <Password> input field.
3. Click [OK].

CONNECTING TO WiFi

Camera setting

Connect OTG adapter (5-pin) and WiFi dongle to the micro USB terminal.

Smartphone setting

1. Install the Wisenet Installation application.
2. Select the camera SSID after turning on the WiFi.
3. Run the Wisenet Installation application.
4. When you log in to the camera, the video will be connected.
 1. The video will be played without being logged in during the initial connection.
5. You can adjust angle of view while watching the video through smartphone.



Hanwha Vision cares for the environment at all product manufacturing stages, and is taking measures to provide customers with more environmentally friendly products.
The Eco mark represents Hanwha Vision's devotion to creating environmentally friendly products, and indicates that the product satisfies the EU RoHS Directive.



Correct Disposal of This Product (Waste Electrical & Electronic Equipment)

- (Applicable in the European Union and other European countries with separate collection systems)
- This marking on the product, accessories or literature indicates that the product and its electronic accessories (e.g. charger, headset, USB cable) should not be disposed of with other household waste at the end of their

working life. To prevent possible harm to the environment or human health from uncontrolled waste disposal, please separate these items from other types of waste and recycle them responsibly to promote the sustainable reuse of material resources.

- Household users should contact either the retailer where they purchased this product, or their local government office, for details of where and how they can take these items for environmentally safe recycling.
- Business users should contact their supplier and check the terms and conditions of the purchase contract. This product and its electronic accessories should not be mixed with other commercial wastes for disposal.

Correct disposal of batteries in this product

- (Applicable in the European Union and other European countries with separate battery return systems.)
 - This marking on the battery, manual or packaging indicates that the batteries in this product should not be disposed of with other household waste at the end of their working life.
 - Where marked, the chemical symbols Hg, Cd or Pb indicate that the battery contains mercury, cadmium or lead above the reference levels in EC Directive 2006/66. If batteries are not properly disposed of, these substances can cause harm to human health or the environment.
 - To protect natural resources and to promote material reuse, please separate batteries from other types of waste and recycle them through your local, free battery return system.
-

Documents / Resources

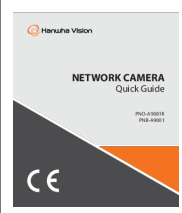
	<p>Hanwha Vision PNB-A9001 Network Camera [pdf] User Guide PNO-A9081R, PNB-A9001, PNB-A9001 Network Camera, PNB-A9001, Network Camera, Camera</p>
---	---

References

- [User Manual](#)