



# Hanwha Vision ANE-L7012L Network Camera User Guide

[Home](#) » [Hanwha Vision](#) » Hanwha Vision ANE-L7012L Network Camera User Guide 

## Contents

- 1 Hanwha Vision ANE-L7012L Network Camera
- 2 Product Information
- 3 Product Usage Instructions
- 4 Warranty
- 5 Disposal
- 6 SAFETY INFORMATION
- 7 COMPONENT
- 8 INSTALLATION
- 9 PASSWORD SETTING
- 10 Contacts
- 11 Documents / Resources
  - 11.1 References



**Hanwha Vision ANE-L7012L Network Camera**



## Product Information

The ANE-L7012L is a network camera manufactured by Hanwha Vision. This camera is designed to provide high-quality video surveillance for various applications. It is equipped with advanced features and technology to ensure reliable performance and ease of use.

The camera is compatible with Hanwha's officially compatible VMS version or the latest Hanwha NVR version for seamless integration. It also meets the EU RoHS Directive, demonstrating Hanwha Vision's commitment to creating environmentally friendly products. Please note that accessories may vary depending on the sales country.

## Product Usage Instructions

### Checking Manuals and Warranty Information

Before connecting the camera to the power supply, it is recommended to check the user manuals and warranty information on Hanwha Vision's website. Visit <https://hanwhavisionamerica.com/product/ane-l7012l/> for manuals and <https://hanwhavisionamerica.com/sales/warranty/> for warranty details.

## Installation

Follow the installation steps below:

1. Refer to the provided installation guide for specific instructions based on your requirements.
2. Ensure you have the necessary accessories for installation (varies by sales country).
3. If using a Micro SD card, make sure it is not included with the camera.
4. If installing on a wall or ceiling, directly mount the camera using appropriate screws.
5. If required, refer to additional installation steps provided in the manual or guide.

## Password Setting

When accessing the camera for the first time, you need to set a login password. Follow the steps below:

1. Open the login window by accessing the camera.
2. Enter “admin” in the User ID input box.
3. Enter the desired password in the password input field.
4. Click on the “Sign in” button to complete the password setting.

## Camera Access

Whenever you want to access the camera, follow these steps:

1. Open the login window by accessing the camera.
2. Enter your User ID and password.
3. Click on the “Sign in” button to access the camera.

**Note:** Ensure that screws are not installed at an angle during installation.

**Important:** Please check ‘Manuals’ from our website, before connecting to the Supply,  
<https://hanwhavisionamerica.com/product/ane-l7012/>

## Warranty

- Please check “Product warranty information” from our website.
- <https://hanwhavisionamerica.com/sales/warranty/>

We recommend to use the officially compatible VMS version or latest Hanwha NVR version when integrating with VMS or Hanwha NVR.

## Disposal



Hanwha Vision cares for the environment at all product manufacturing stages, and is taking measures to provide customers with more environmentally friendly products. The Eco mark represents Hanwha Vision’s devotion to creating environmentally friendly products, and indicates that the product satisfies the EU RoHS Directive.

## Correct Disposal of This Product (Waste Electrical & Electronic Equipment)



■■■■■ (Applicable in the European Union and other European countries with separate collection systems)

This marking on the product, accessories or literature indicates that the product and its electronic accessories

(e.g. charger, headset, USB cable) should not be disposed of with other household waste at the end of their working life. To prevent possible harm to the environment or human health from uncontrolled waste disposal, please separate these items from other types of waste and recycle them responsibly to promote the sustainable reuse of material resources.

Household users should contact either the retailer where they purchased this product, or their local government office, for details of where and how they can take these items for environmentally safe recycling. Business users should contact their supplier and check the terms and conditions of the purchase contract. This product and its electronic accessories should not be mixed with other commercial wastes for disposal.

### Correct disposal of batteries in this product



(Applicable in the European Union and other European countries with separate battery return systems.)

This marking on the battery, manual or packaging indicates that the batteries in this product should not be disposed of with other household waste at the end of their working life. Where marked, the chemical symbols Hg, Cd or Pb indicate that the battery contains mercury, cadmium or lead above the reference levels in EC Directive 2006/66. If batteries are not properly disposed of, these substances can cause harm to human health or the environment. To protect natural resources and to promote material reuse, please separate batteries from other types of waste and recycle them through your local, free battery return system.

### SAFETY INFORMATION

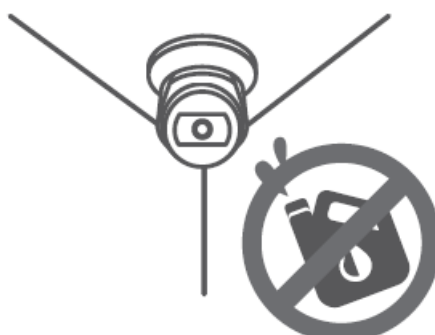

## COMPONENT

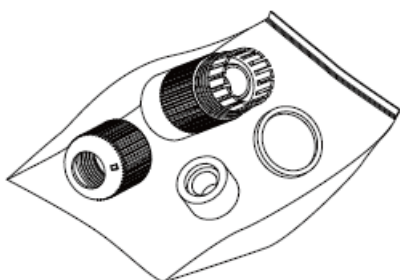
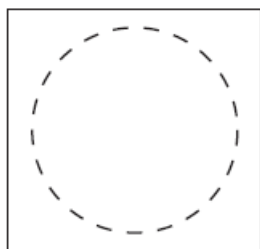
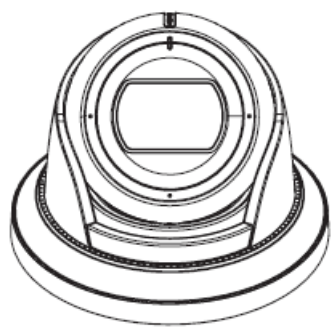

- As for each sales country, accessories are not the same.

## INSTALLATION

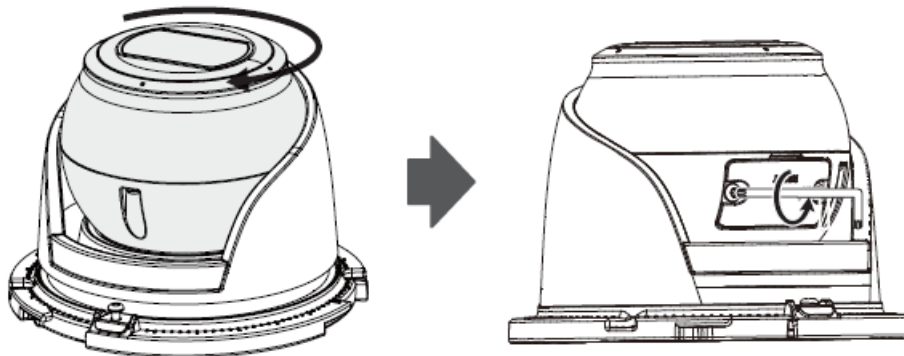
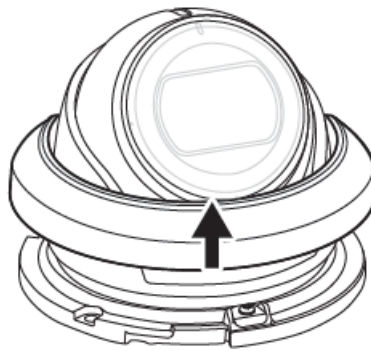
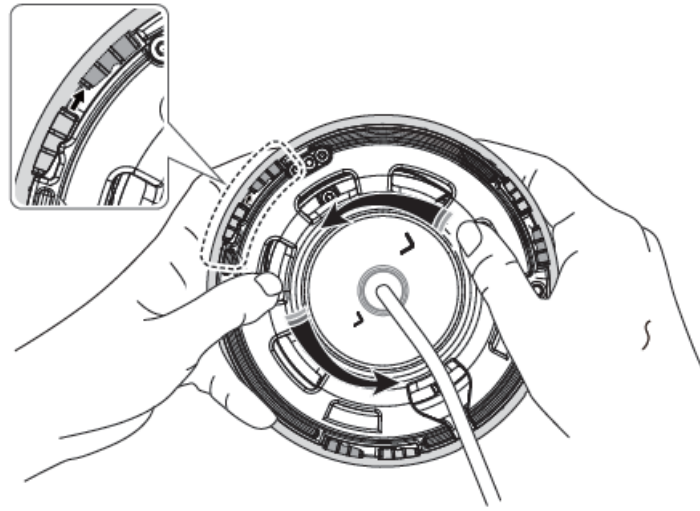

**Not Included:** Micro SD Card

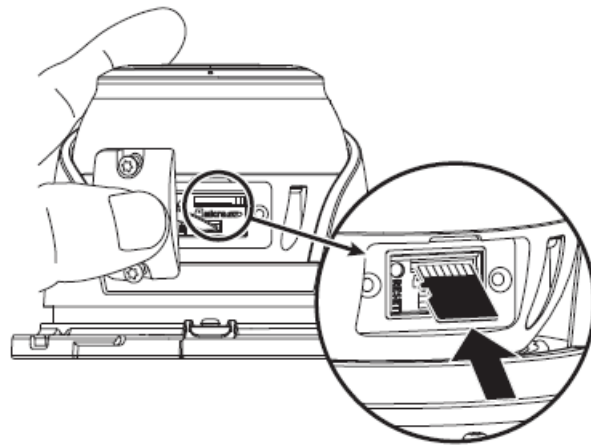

**Directly installing on wall/ceiling**

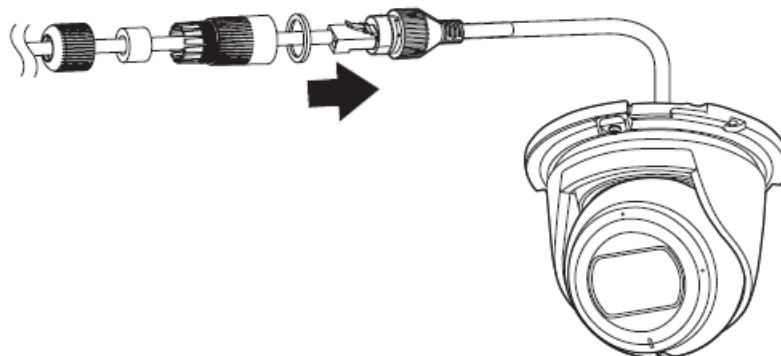
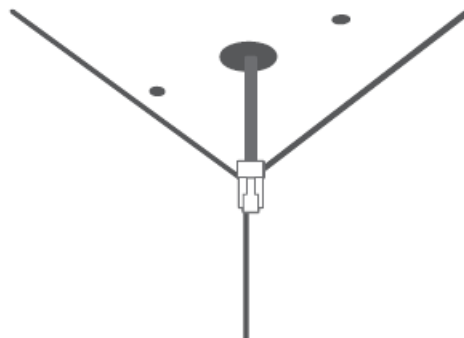
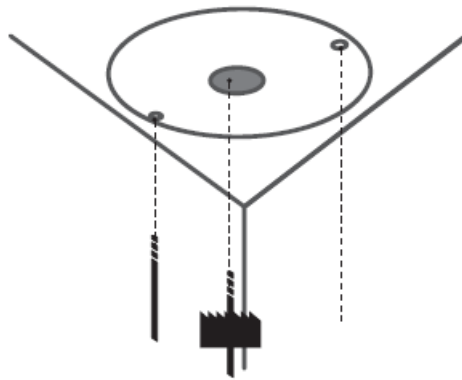

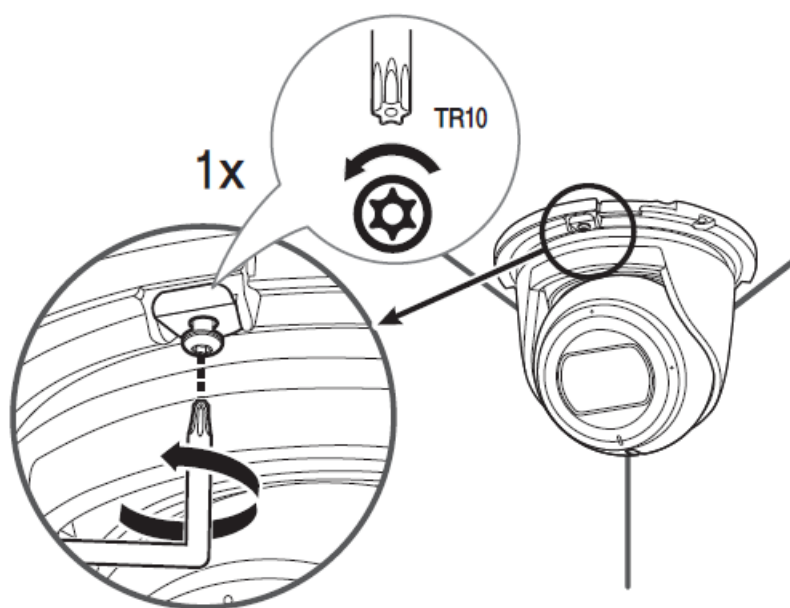
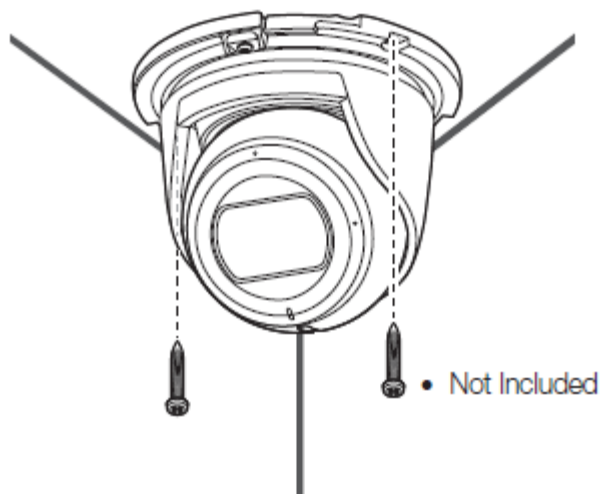

## Info



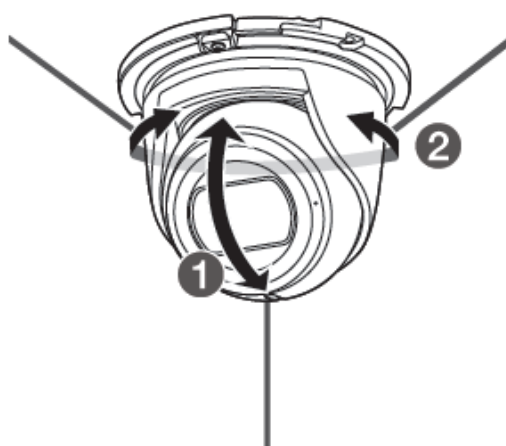

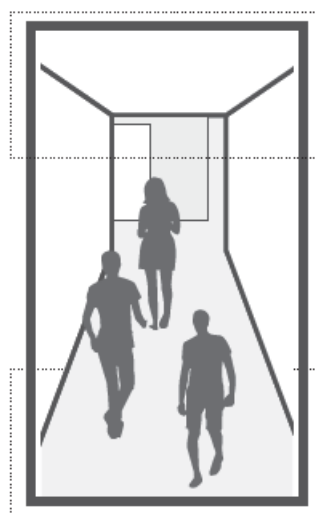
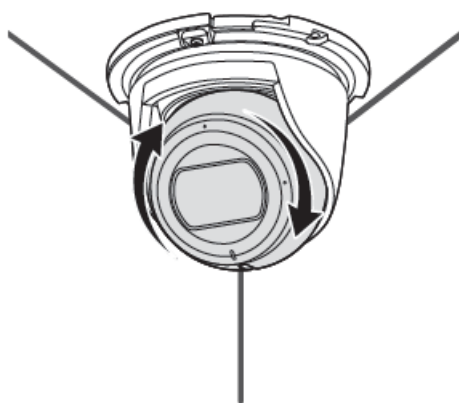

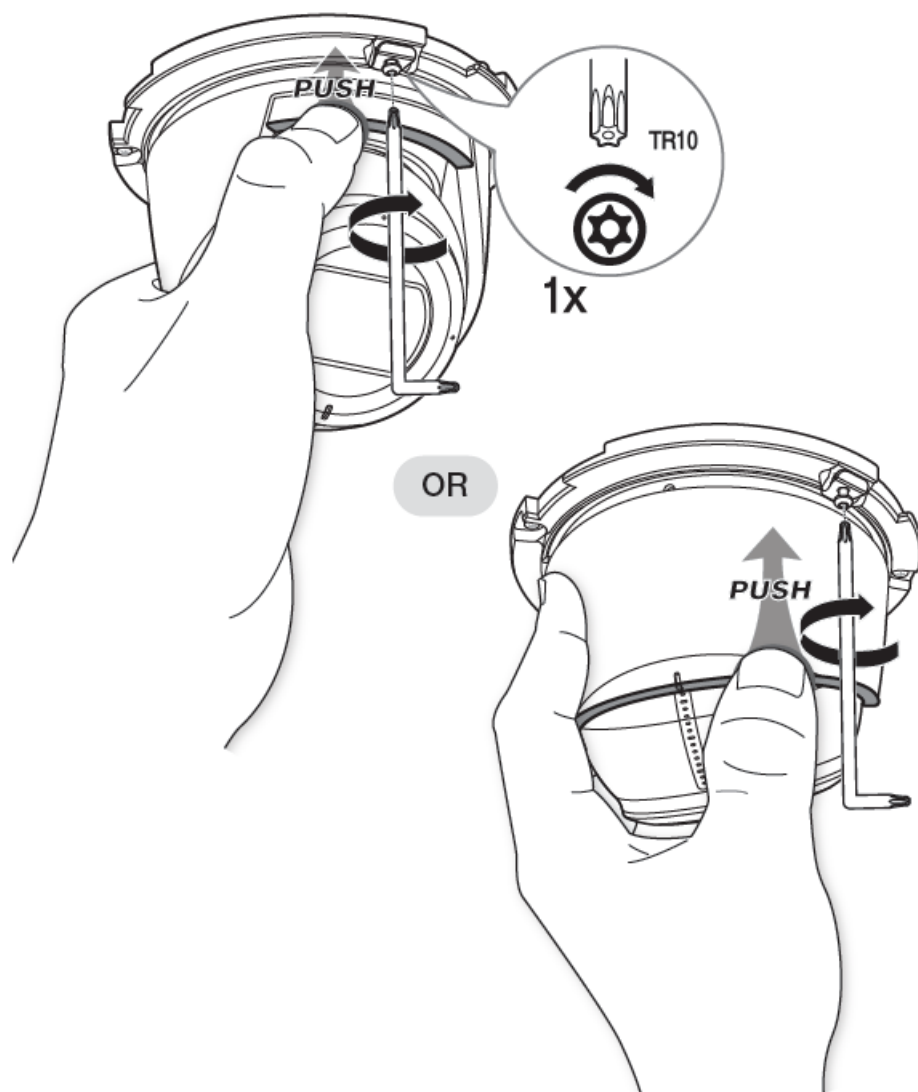

### Warning

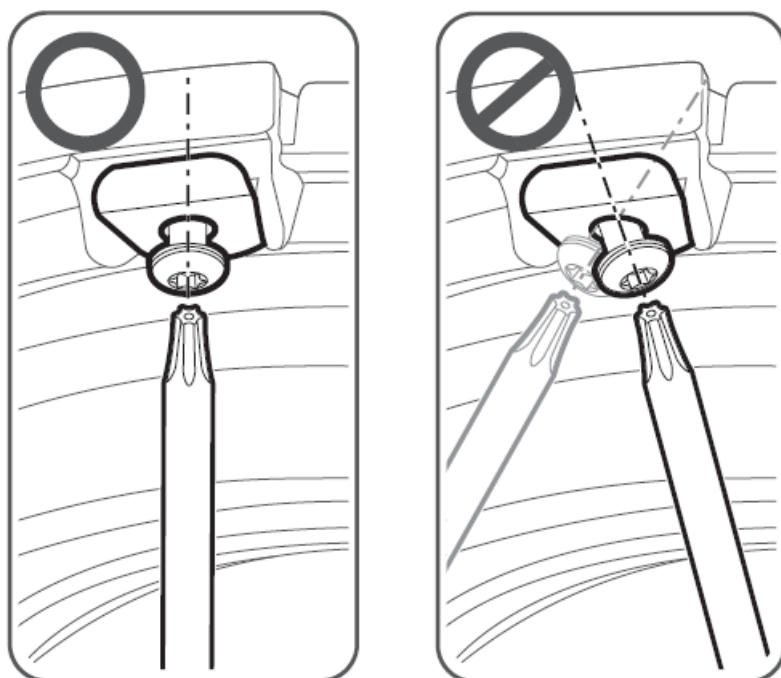

- Don't install the screws at an angle.

## Finish

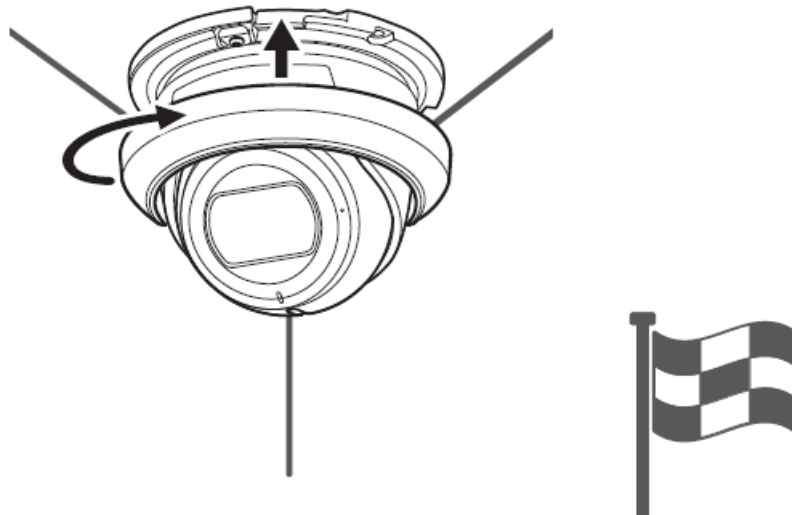

## PASSWORD SETTING

When you access the product for the first time, you must register the login password.

### Administrator password change

---

**New password**

**Confirm new password**

- If the password is 8 to 9 characters long, it must include at least 3 of the following character types: English uppercase letters, English lowercase letters, numbers, and special characters.
- If the password is 10 characters or longer, it must include at least 2 of the following character types: English uppercase letters, English lowercase letters, numbers, and special characters.
- ID may not be used as password. The password and ID cannot be identical.
- The following special characters can be used: `!@#\$%^&\*()\_-=+{ }[ ]\|;:'"<>.,?/
- You may not use more than 4 consecutive characters. (example: 1234, abcd, etc.)
- You may not use the same character 4 or more times consecutively. (example: IIII, 1111, aaaa, etc.)

Apply

- For a new password with 8 to 9 characters, you must use at least 3 of the following: uppercase/lowercase letters, numbers and special characters. For a password with 10 characters or longer, you must use at least 2 types of those mentioned.
  - Special characters that are allowed: `!@#\$%^&\*()\_-=+{ }[ ]\|;:'"<>.,?/
- Space is not allowed for password.
- For higher security, you are not recommended to repeat the same characters or consecutive keyboard inputs for your passwords.
- If you lost your password, you can press the [RESET] button to initialize the product. So, don't lose your password by using a memo pad or memorizing it.

## **LOGIN**

Whenever you access the camera, the login window appears.  
Enter the User ID and password to access the camera.

- Enter “admin” in the <User Name> input box.
- Enter the password in the <Password> input field.
- Click [Sign in].

## **Contacts**

### **Türkiye Distributor**

#### **EDS Electronic Support Industry and Trade Ltd. Ltd.**

- Majlis Mah. Teraziler Cad. Fan Sk. (Old one is Kılıç Sk.) No: 4 Sancaktepe / İstanbul / Turkey
- **Tel:** +90.216.313.25.15
- **Fax:** +90.216.528.45.98

#### **Koyuncu Electronic Information Technology Systems Industry. and External. Tic. Inc.**

- Emek Mah. Ordu Cad. No:18 Sancaktepe / İstanbul / Türkiye
- **Tel:** +90.216.528.88.88
- **Fax:** +90.216.313.18.18

#### **NFS Technology and Automation Systems Industry. And Trade. Ltd. Sty.**

- Cumhuriyet Mah Şair M.Akif Ersoy Sk. No:36 Üsküdar / İstanbul / Türkiye
- **Tel:** +90.216.505.82.28
- **Fax:** +90.216.505.82.29

#### **Sensonet Technology Elect. and Cognition. Speed. Singing. and Tic. Ltd. Ltd.**

- Ramazanoğlu Mah. Transtek Cad. No: 2 Pendik / İstanbul / Türkiye
- **Tel:** +90.216.999.49.49
- **Fax:** +90.212.381.61.02

#### **ENTES ELECTRONIC DEVICES MANUFACTURING AND TRADE. Inc.**

- Dudullu Org.San.Reg. 1st Street No:23 34776 Ümraniye – İstanbul / Türkiye
- **Tel:** +90.216.313.01.10
- **Fax:** +90.216.314.16.15

Average life of the device recommended by the Ministry of Commerce  
Similar declaration that the device complies with EEE regulations

## Documents / Resources

	<p><a href="#">Hanwha Vision ANE-L7012L Network Camera</a> [pdf] User Guide ANE-L7012L Network Camera, ANE-L7012L, Network Camera, Camera</p>
---	---

## References

-  [ANE-L7012L - Hanwha Vision](#)
-  [Warranty - Hanwha Vision](#)