

Hanvon GO GO Bird GGB1020 Bionic Flapping-Wing Aircraft User Manual

[Home](#) » [Hanvon](#) » Hanvon GO GO Bird GGB1020 Bionic Flapping-Wing Aircraft User Manual 

Hanvon GO GO Bird GGB1020 Bionic Flapping-Wing Aircraft

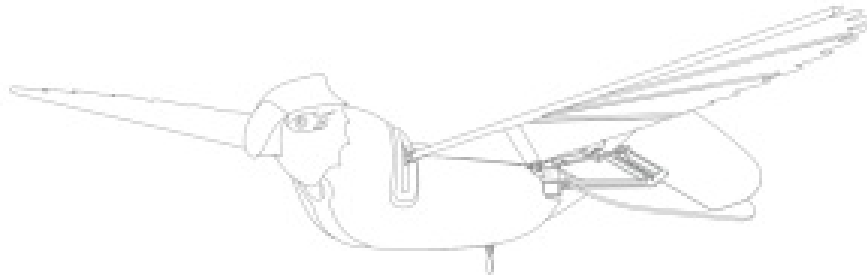

Please keep this user manual for further reference since it contains important information.

Contents

- [1 Go Go Bird](#)
- [2 Product Installation Instruction](#)
- [3 Product Flight Operation](#)
- [4 Battery Operation Instruction](#)
- [5 Go Go Bird Configuration](#)
- [6 Troubleshooting](#)
- [7 Additional Information](#)
- [8 FCC Regulatory Compliance](#)
- [9 ISED Regulatory Compliance](#)
- [10 Wireless Control Information](#)
- [11 Documents / Resources](#)
- [12 Related Posts](#)

Product Model: Go Go Bird 1020

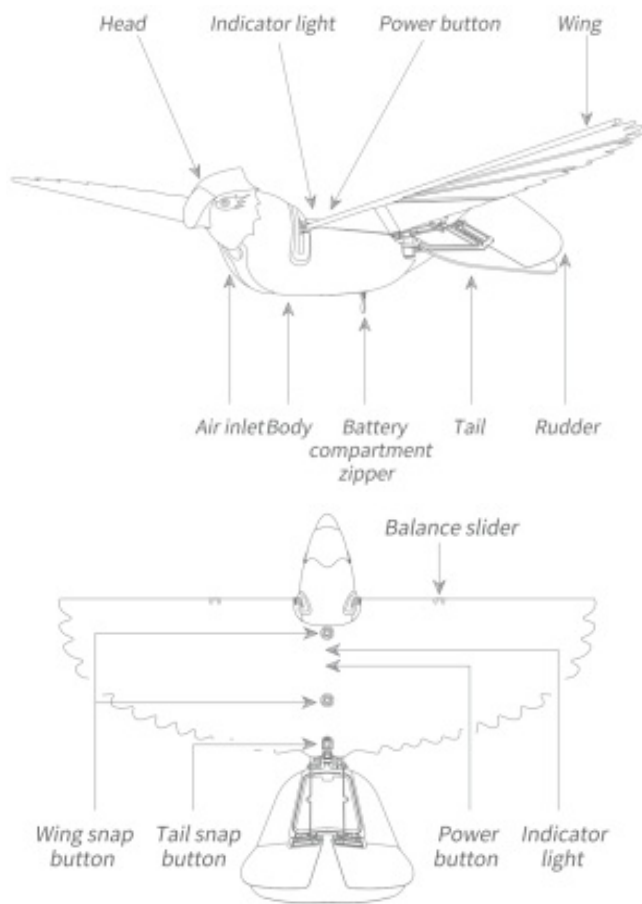

Figure - 1 Go Go Bird

Remote Model: FYC 1010

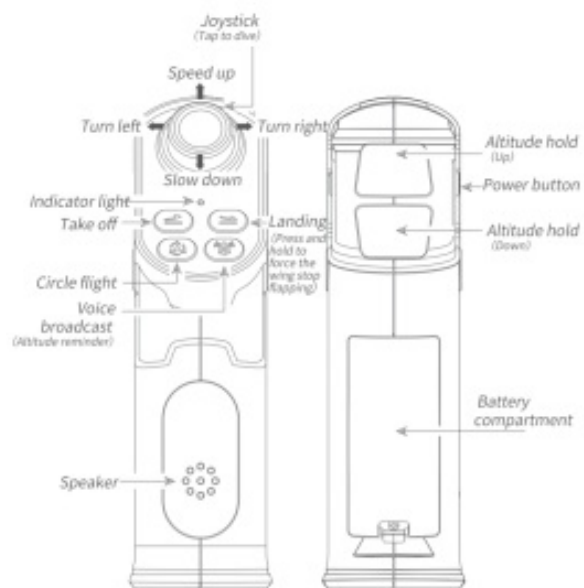

Figure - 2 Remote Control

Charger Model: FYCC 1010

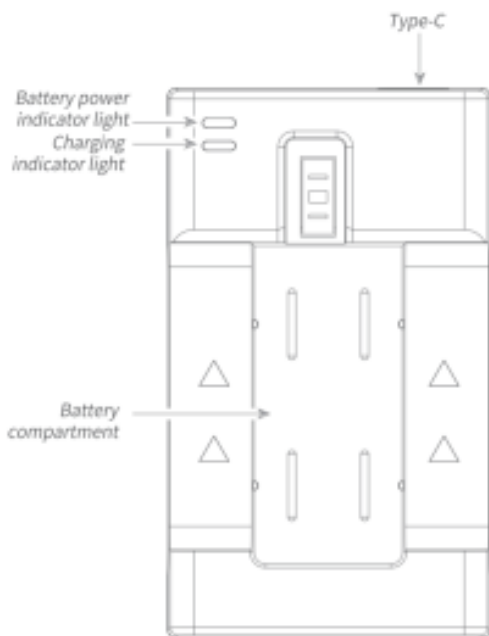

Figure - 3 Battery Charger

Product Installation Instruction

A.Go Go Bird Aircraft Installation

(Please refer to the quick start guide for detailed installation steps)

1. How to install the wing

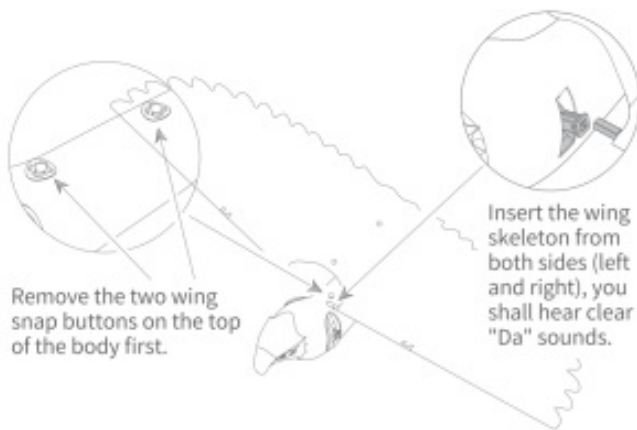
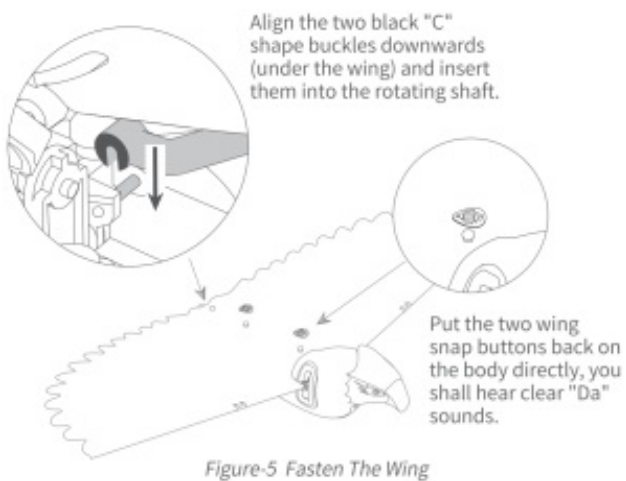
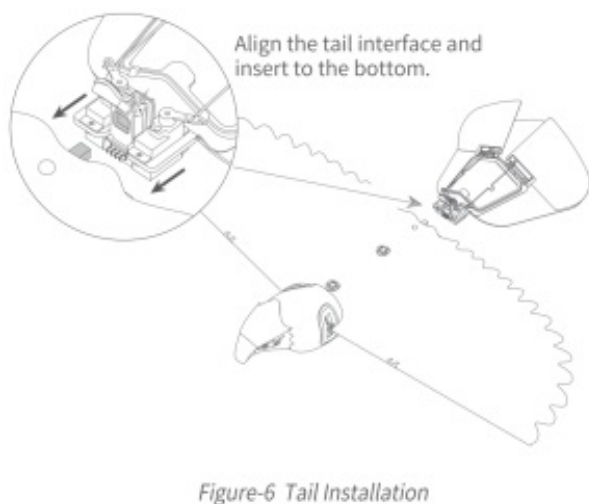

Figure - 4 Wing Installation

2. How to fasten the wing



3. How to install the tail



4. How to fasten the tail

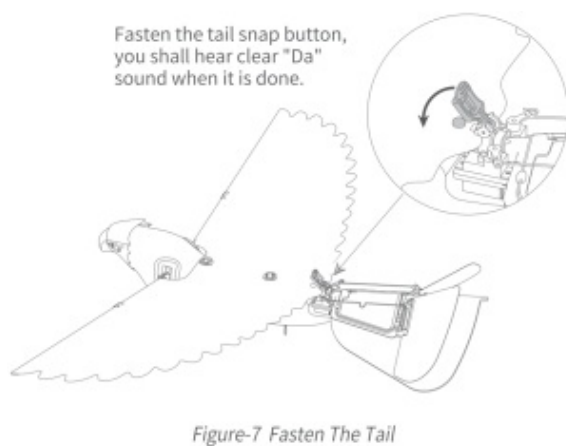

B. Remote Control Instruction

1. Use the screwdriver to remove the battery compartment cover and install 2 AAA batteries (NOT INCLUDED) based on battery polarity indication, replace the cover and tighten the screw afterwards

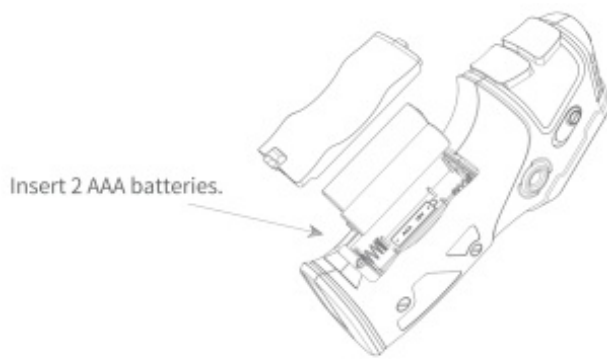

Figure - 8 AAA Batteries Installation

2. Push the power button forward slightly to turn the remote on. The signal light illuminating indicates that the remote is on, the signal light off indicates that the remote is off.

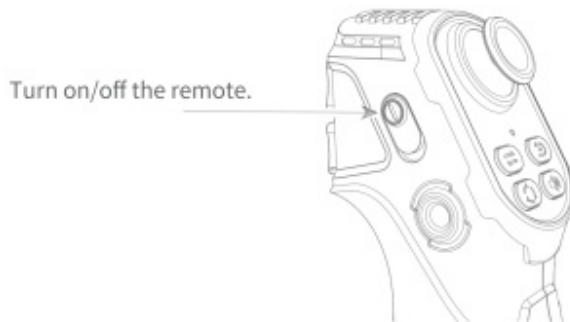

Figure - 9 Remote Control Power Button

3. When not connecting with aircraft, the remote control will turn off automatically if there is no input for 10 minutes. Press any button to wake it up.
4. When blue signal light of remote control is flashing, the battery power is running low. Please land it before replacing AAA batteries, otherwise aircraft will lose control.

C. Pairing Aircraft with the Remote Control

Your aircraft should already be paired with the remote control, but if you are experiencing connectivity issues, please refer to the steps below.

1. Press the power button of aircraft to turn it on and check to see that its blue indicator light is on.
2. Start with remote control off and place the remote next to the aircraft, then hold the Altitude Hold (up) and Altitude Hold (down) buttons at the same time, push the power button forward slightly to turn the remote control on. The blue signal light of remote should begin flashing indicating that the pairing is in progress.

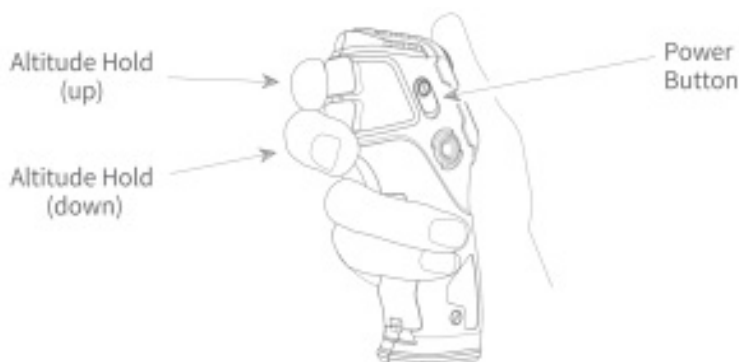

Figure - 10 Buttons for Pairing Step

3. The signal light of remote stops flashing, and its voice broadcast would inform you that "Remote control

connected successfully.”

Product Flight Operation

A. Remote Control Operation

1. Press the power button to turn the aircraft on and its signal light would be blue.

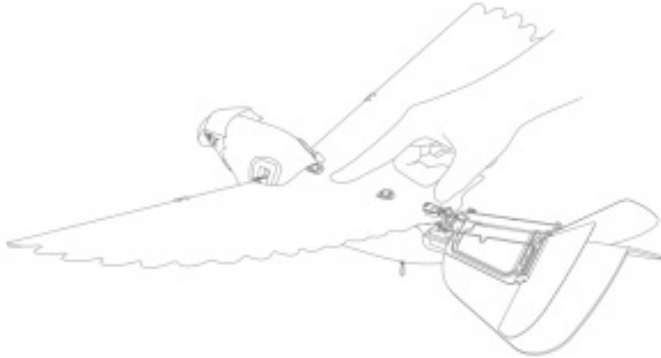

Figure - 11 Power Button of Aircraft

2. Push the power button forward slightly to turn the remote on. Hold aircraft horizontally and press the take off button of the remote to make the wing begin to flap. Gently toss aircraft forward to begin flight.

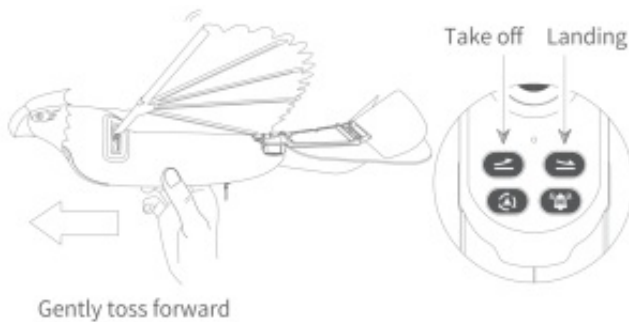

Figure - 12 Trigger Buttons of Aircraft

3. Press the landing button and aircraft would land gradually with the landing altitude until its wing stop flapping.

B. Aircraft Indicator Signal Light

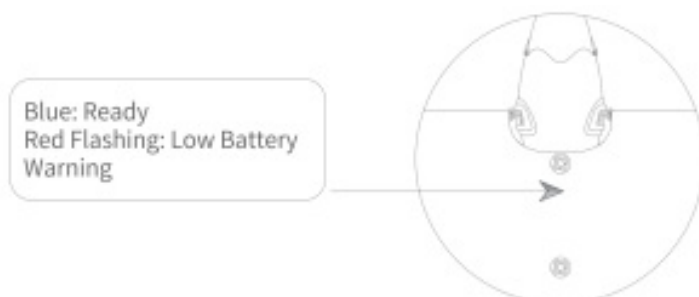

Figure - 13 Aircraft Indicator Light

C. Remote Indicator Signal Light



Figure - 14 Remote Indicator Light

Battery Operation Instruction

1. The lithium battery for aircraft is pluggable and rechargeable, and there is one inside the aircraft battery compartment. Press the power button to turn aircraft on directly for playing.
2. When the lithium battery is running low, please land it first, remove the exhausted lithium then replace it as soon as possible. Plug the exhausted lithium battery directly into the charger.

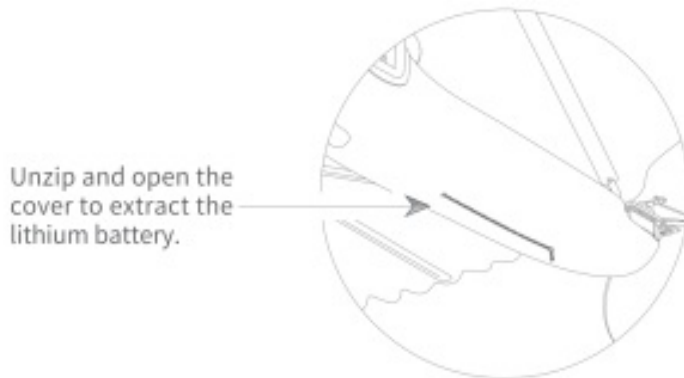

Figure - 15 The Zip on Aircraft Body

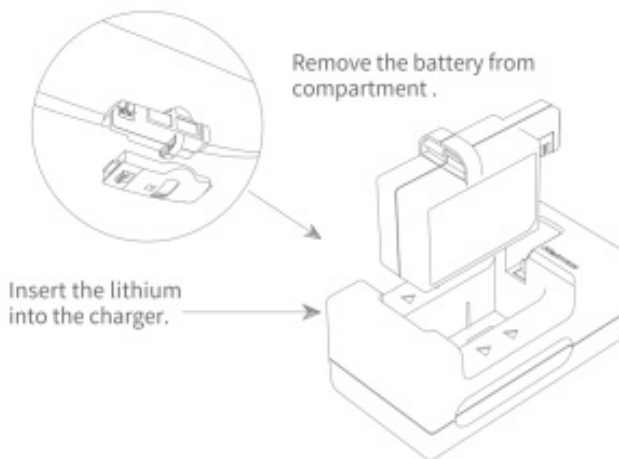

Figure - 16 Charge Lithium Battery

3. Connect the charger with TYPE-C port, recommend to use DC 5.0V 2A adaptor.
4. The green signal light of the charger indicates that the power source is working and the red light indicates that the battery is charging. When charging is complete, the red light will turn off. When the lithium battery not connecting with charger, the signal light would keep flashing. (charging time is around 20-30 mins, flight duration is around 12-15 mins)

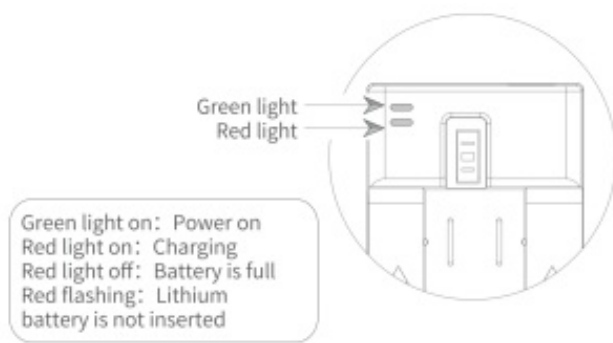
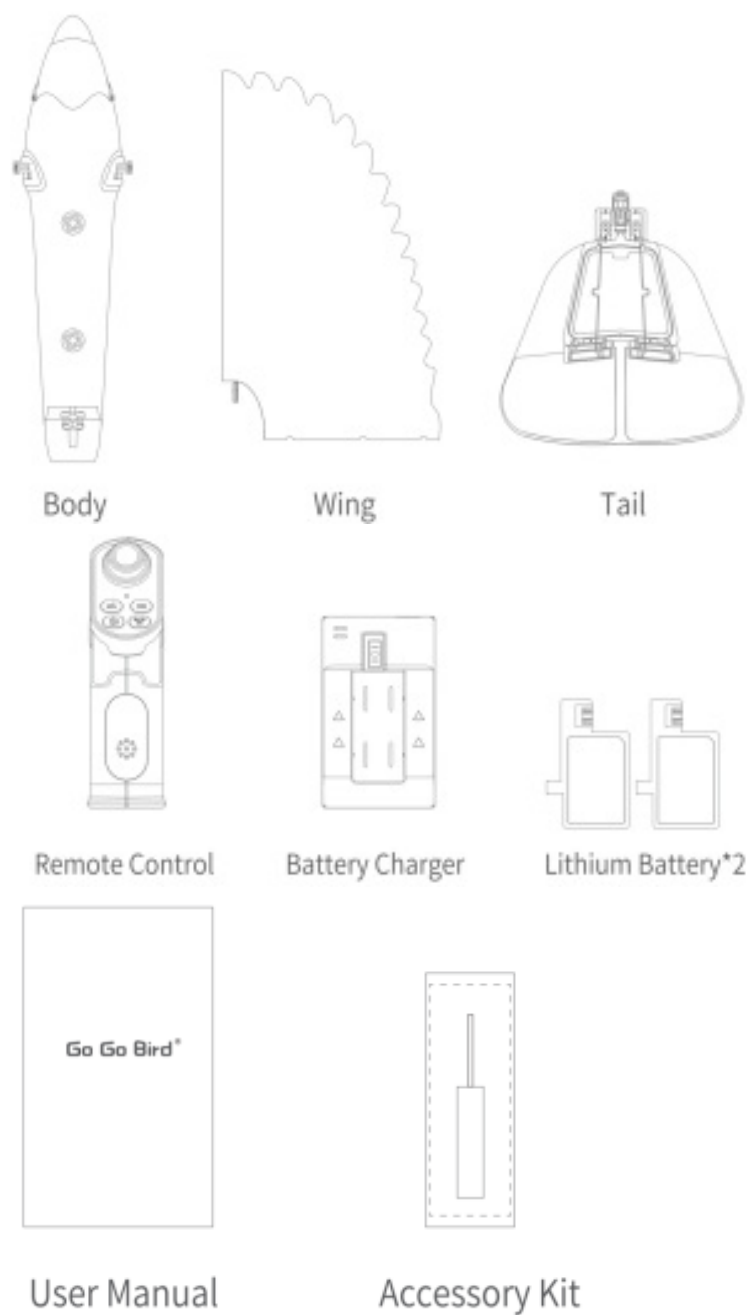

Figure - 17 Battery Charger Indicator Light

5. Plug the fully charged lithium battery into the battery compartment at the bottom of the aircraft body. Make sure the lithium battery is completely connected to the electric socket.

Go Go Bird Configuration



Troubleshooting

- No response or weak performance when turning on aircraft
Make sure the lithium battery is installed correctly and fully charged.
- No response when turning on remote control
Double check whether AAA batteries are installed correctly with the polarity or replace them with new batteries.
- Remote control fails to control aircraft
Turn aircraft and remote control off and repeat the pairing steps.

Additional Information

1. Be careful when flying at high altitudes. Aircraft may get stuck on roofs, ledges and trees. Avoid water, forests, power lines, etc.
2. Please stay away from roads, steps or other places with uneven surface when using this product in case of falling down.
3. When using a screwdriver, do not open the PCB board of the machine to avoid burns caused by a short circuit.
4. Make sure that the aircraft is in sight when flying . Recommend flight altitude should within 40 meters.
5. Press the power button in an emergency to make aircraft stop flying and land immediately.
6. Check the wires, battery, shell, and other parts regularly. If there is damage, do not use it until it is repaired.
7. Please use the customized 7.4V rechargeable lithium batteries that come with aircraft only. Do not match with other lithium batteries. Rechargeable batteries are only to be charged under adult supervision. Recharge able batteries are to be removed from the product before being charged.
8. Please use two I.SV AAA batteries for the remote control. AAA batteries are to be inserted into remote control with the correct polarity. Non-chargeable batteries are not to be charged. Different types of batteries or new and used batteries are not to be mixed. Exhausted batteries are to be removed from the product.
The supply terminals are not to be short-circuited. Do not mix old and new batteries. Do not mix alkaline, standard (carbon-zinc), or rechargeable batteries.
9. This product is not suitable for children under 3 years old. Please keep the user manual and package as they contain information.
10. For lithium battery, kindly pay attention to below
 - Keep small cells and batteries which are considered swallowable out of reach of children.
 - Swallowing may lead to burns, perforation of soft tissue and death. Severe burns can occur 2h of ingestion.
 - In case of ingestion of a cell or battery, seek medical assistance promptly.
 - Do not disassemble. Do not short circuit. Do not dis pose of in fire.
 - Do not expose to high temperature (60°C / 140°F)
 - Do not open. Do not crush.
11. For battery charger, kindly pay attention to below
 - Only allow children at least 8 years old to use the battery charger. This battery charger is not a toy and must not be played with. Please refer to the user manual for detailed instruction.
 - Rechargeable lithium batteries are only to be charged under adult supervision. Do not try and recharge non-rechargeable batteries because of the danger of eruption.
 - Please examine the battery charger regularly for damage, especially the cord, plug and enclosure. If the battery charger is damaged, it must not be used until it has been repaired.

- For class III battery charger, it must be supplied from a transformer for toys.

FCC Regulatory Compliance

This device complies with Part 15 of the FCC Rules.

Operation is subject to the following two conditions:

- (1) this device may not cause harmful interference, and
- (2) this device must accept any interference received, including interference that may cause undesired operation.

Caution: changes or modifications not expressly approved by the party responsible for compliance could void the user's authority to operate the equipment.

Note: This equipment has been tested and found to comply with the limits for a Class B digital device, pursuant to Part 15 of the FCC Rules. These limits are designed to provide reasonable protection against harmful interference in a residential installation. This equipment generates, uses and can radiate radio frequency energy and, if not installed and used in accordance with the instructions, may cause harmful interference to radio communications. However, there is no guarantee that interference will not occur in a particular installation.

If this equipment does cause harmful interference to radio or television reception, which can be determined by turning the equipment off and on, the user is encouraged to try to correct the interference by one or more of the following measures:

- Reorient or relocate the receiving antenna.
- Increase the separation between the equipment and receiver.
- Connect the equipment into an outlet on a circuit different from that to which the receiver is connected.
- Consult the dealer or an experienced radio/TV technician for help.

ISED Regulatory Compliance

CAN ICES-003 (B) / NMB-003 (B)

This device contains licence-exempt transmitter(s)/ receiver(s) that comply with Innovation, Science and Economic Development Canada's licence-exempt RSS(s).

Operation is subject to the following two conditions:

- (1) This device may not cause interference.
- (2) This device must accept any interference, including interference that may cause undesired operation of the device.

This equipment complies with IC RSS-102 radiation exposure limits set forth for an uncontrolled environment. This equipment should be installed and operated with minimum distance 20cm between the radiator and your body.

Wireless Control Information

Remote model: FYC 1010

Operation Frequency: 2410.95 MHz to 2468.95M Hz

Max. Transmission power(Only for Europe): 8.9ldBm (Eagle) 9.09dBm (Remote)

Hereby, Bioniwings (Shenzhen) Technology Co., Ltd. declares that the radio equipment type [Go Go Bird 1020, FYC 1010] is in compliance with Directive 2014/ 53/ EU. The full text of the EU declaration of conformity is available at the following internet address: <http://www.gogobird.com>

Hanvon

Documents / Resources

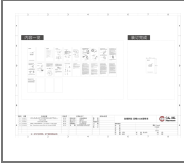

[Hanvon GO GO Bird GGB1020 Bionic Flapping-Wing Aircraft](#) [pdf] User Manual
GGB1020, 2AZKSGGB1020, FYC1010, 2AZKSFYC1010, GO GO Bird GGB1020 Bionic flapping-wing Aircraft, GGB1020 Bionic flapping-wing Aircraft, flapping-wing Aircraft

[Manuals+](#)