

Handy Low Frequency Wave Oscillator



Handy Low Frequency Wave Oscillator Instruction Manual

[Home](#) » [Handy](#) » Handy Low Frequency Wave Oscillator Instruction Manual 

Contents

- [1 Handy Low Frequency Wave Oscillator](#)
- [2 Safety Precaution](#)
- [3 Introduction](#)
- [4 Specification](#)
- [5 Name and Description of Each Part](#)
- [6 Procedure of operation](#)
- [7 Documents / Resources](#)
 - [7.1 References](#)



Handy Low Frequency Wave Oscillator



Safety Precaution

- Do not disassemble, repair and remodel this product. This product might stop working and the warranty will be void.
- Do not splash it with water and protect it against getting wet. It is possible for it to get damaged, or short-circuited, or you might get even an electric shock.
- Teachers or trainers must instruct students about the safe ways of conducting experiments with this product before actually conducting experiments.
- When you find that something is broken, please do not repair the product by yourself and contact your distributor.

Introduction

This device is a more compact oscillator for a sound experiment than any other popular oscillator, and it can be carried with you easily into the classroom. A built-in speaker in the body enables many experiments of sound easily without external speakers. If an external amplifier and speakers are connected to the device, the experimental coverage will get wider. The device has a function of preset sound frequencies in its memory. Additionally, it has a memory function as well.

Specification

- **Oscillating frequency:** 5~200 kHz
- **Speaker:** 40 Hz to 30 kHz (Maximum wattage: 1 W, with 15 steps)
- **Output:** Signal output, speaker output (amplified output), Terminal: 3.5 mm mono jack
- **Feature:** Equipped with a built-in small speaker and a frequency memory
- **Power source:** x3 AA cell batteries or AC adaptor (DC 9 V) (not included)
- **Dimensions and weight:** 76 x 135 x 27mm, 285g

Name and Description of Each Part

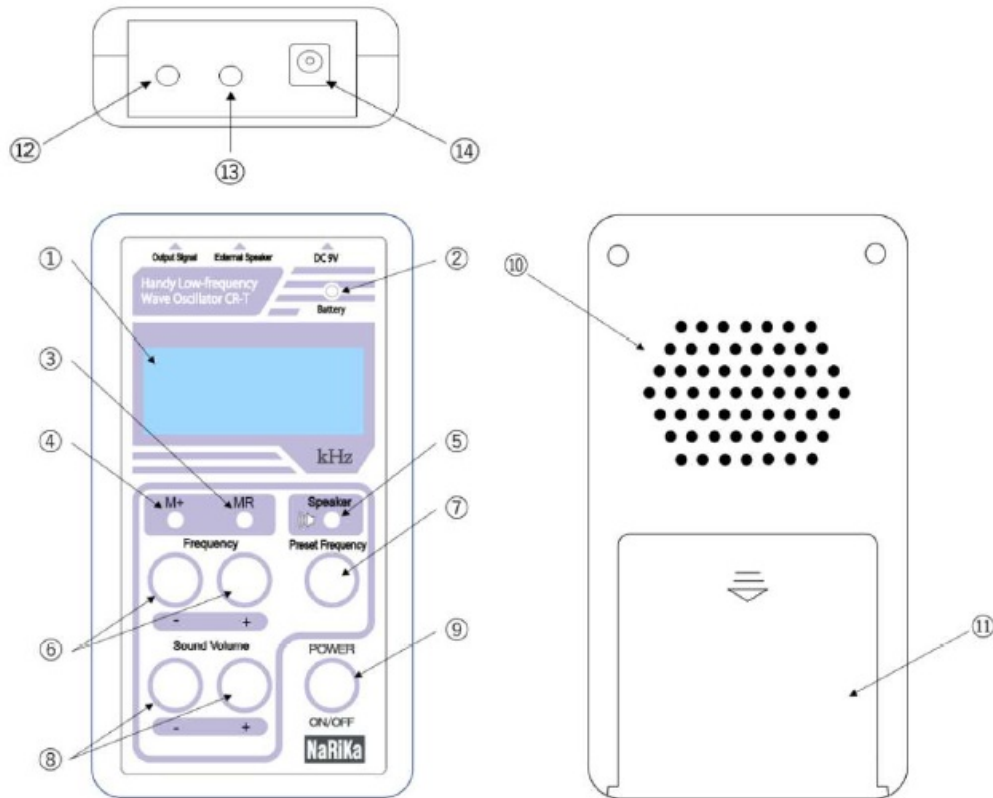

1. Display Screen Display the current frequency (in kHz).
2. Battery This light will go on when the battery level is low. Please change the batteries.
3. MR Recall setting in memory.
4. M+ Store current settings such as a set frequency, an output frequency, and the sound volume. These settings will also be the initial setting when turned on, or these settings in the memory are recalled by pressing "MR" button.
5. Speaker ON / OFF switch for speaker output (internal / external). Set to OFF when power is on.
6. Frequency + / – Short press to change frequency in single digits. Press and hold to change frequency much faster.
7. Preset Frequency Each time you press this button will jump to the preset frequency (0.400, 0.800, 1.600, 10.00, 100.0kHz)

Preset Frequency (kHz)	Division (kHz)	Frequency Range (kHz)
0.400	0.001	0.005 ~ 9.999
0.800		
1.600		
10.00	0.01	1.00 ~ 99.99
100.0	0.1	10.0 ~ 200.0

8. Sound Volume + / – To change the sound volume (1~15 steps). That volume level is temporarily shown on the display. To step the sound volume up, press the "+" button, and to step down it, press the "-" button. Pressing and holding the button, the sound volume will step up and down faster.

Tip: Level seven (7) is recommended when using the internal speaker because distortion of the sound will occur over level eight (8).

Caution: In case of continuous use by connecting with an external speaker, do not set the sound volume over 12 sound levels. Otherwise, its components inside will be heated and be damaged.

9. POWER ON / OFF To turn the power ON / OFF
10. Internal Speaker To use the Internal speaker, press the ⒺSpeaker ON/OFF button. The internal speaker does not work when the terminal for output speaker is connected.
11. Battery Box Please insert 3 pcs of AA batteries.
12. The output of Plug for Output Signal signals 5 – 200 kHz / AC1.0V directly that do not though an internal amplifier.
13. Plug for Output Speaker Output of signal for an external speaker through an internal amplifier. 8 Ohm speaker is recommended.
14. Plug for AC adapter For connection when using AC adapter (sold separately).

Procedure of operation

1. Put three alkaline dry cell batteries in the battery box .
2. Press the power button, the last setting frequency is shown on the display. In the case of using an external speaker, connect its plug with before pressing the power button.
3. Press the speaker button to output sound from an internal speakerⒺ (or an external speaker).
4. Adjust the sound level to a suitable one by pressing the “-” button of the Sound Volume buttonⒺ before the experiment or demonstration. Otherwise, it would output a big sound.
5. Adjust its sound level to the experiment by pressing the “+” or “-” button of the Sound Volume buttonⒺ.
6. Adjust its sound frequency to the experiment by pressing the “+” or “-” button of the Frequency buttonⒺ.
7. In the case of storing the settings of the last sound frequency used, press the button “M+” Ⓔ.
8. At the end of the experiment or demonstration, press the POWER ON/OFFⒺ to turn it down.

Documents / Resources

 <p>Instruction manual Handy Low-Frequency Wave Oscillator</p>	<p>Handy Low Frequency Wave Oscillator [pdf] Instruction Manual Low Frequency Wave Oscillator, Low, Frequency Wave Oscillator, Wave Oscillator, Oscillator</p>
---	--

References

- [User Manual](#)

[Manuals+](#), [Privacy Policy](#)

This website is an independent publication and is neither affiliated with nor endorsed by any of the trademark owners. The "Bluetooth®" word mark and logos are registered trademarks owned by Bluetooth SIG, Inc. The "Wi-Fi®" word mark and logos are registered trademarks owned by the Wi-Fi Alliance. Any use of these marks on this website does not imply any affiliation with or endorsement.