



# HAMRON 010833 Testing Roof Box Instruction Manual

[Home](#) » [HAMRON](#) » HAMRON 010833 Testing Roof Box Instruction Manual 



HAMRON 010833 Testing Roof Box



## Contents

- [1 SAFETY INSTRUCTIONS](#)
- [2 TECHNICAL DATA](#)
- [3 ASSEMBLY](#)
- [4 USE](#)
- [5 OPENING AND CLOSING](#)
- [6 Tip](#)
- [7 MAINTENANCE](#)
- [8 Documents / Resources](#)
- [9 Related Posts](#)

## SAFETY INSTRUCTIONS

- Max load: 50 kg.
- Do not exceed the maximum permitted roof load and total weight of the car, see owner's handbook. The maximum permissible roof load is the total of the weight of the load carriers, the weight of the roof box and the weight of the load.
- Note that the height of the car changes after mounting the roof box.
- Note that roof loads change the driving capability and sensitivity to side-winds of the vehicle.
- Do not put any sharp objects in the box.
- Check before mounting the roof box and at regular intervals afterwards that the load carriers are firmly fastened to the car.
- Check at regular intervals that the roof box is firmly fastened to the load carriers.
- Check before driving off that the box is properly locked and that the key has been removed.
- Remove the load carriers and roof box before using a car wash.
- For safety reasons do not drive the car more than 130 km/h. Adjust your speed to the load being transported and the actual speed limits.
- Drive safely. Avoid sharp accelerations, braking, and turns.
- For the safety of other motorists and to save energy the roof box should be removed when not in use.
- When the roof box is mounted on the roof it can produce wind noise.
- Store this instruction book together with the owner's handbook.
- Failure to follow these instructions can result in damage to the car and the surroundings.

## **TECHNICAL DATA**

- Weight 13 kg
- Volume 390 l
- Max load 50 kg

## **DESCRIPTION**

Aerodynamic and lockable roof box made of heavy-duty, UV resistant plastic. ISO and City Crash approved. The included universal mount is designed for roof rails with a width of 34-66 mm.

## **ASSEMBLY**

- Only use the product together with an approved roof rack.
- Follow all the instructions from the vehicle manufacturer and the manufacturer of the roof rack and roof box to assemble.

1



CityCrash

2

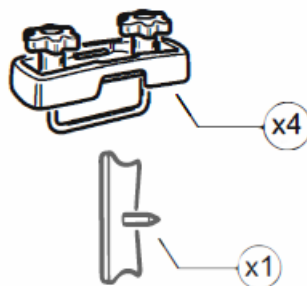

3

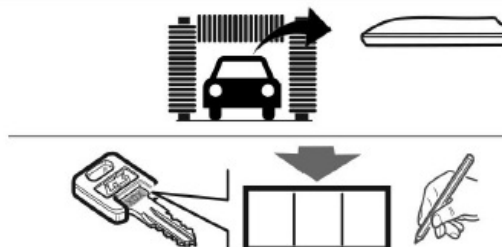
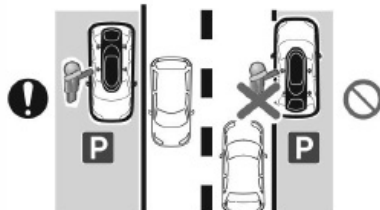
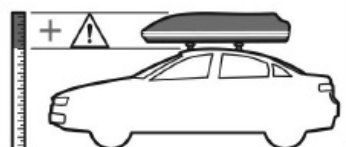

4

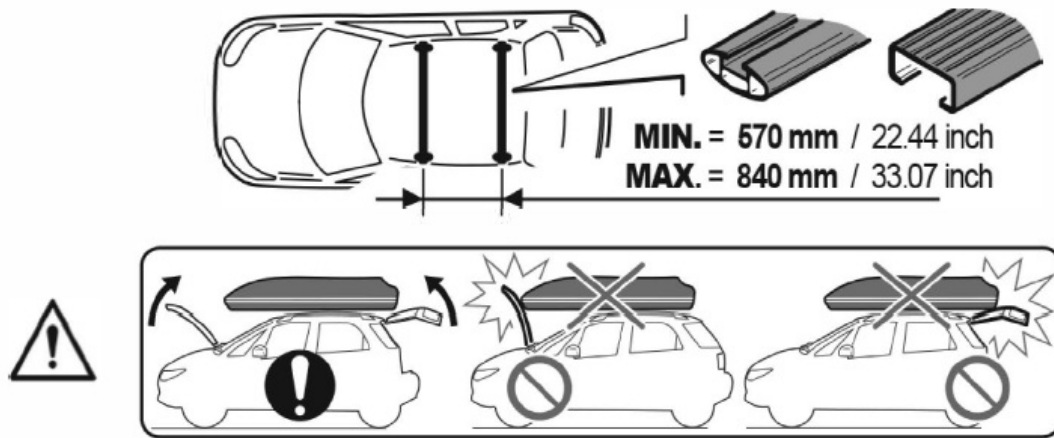

5

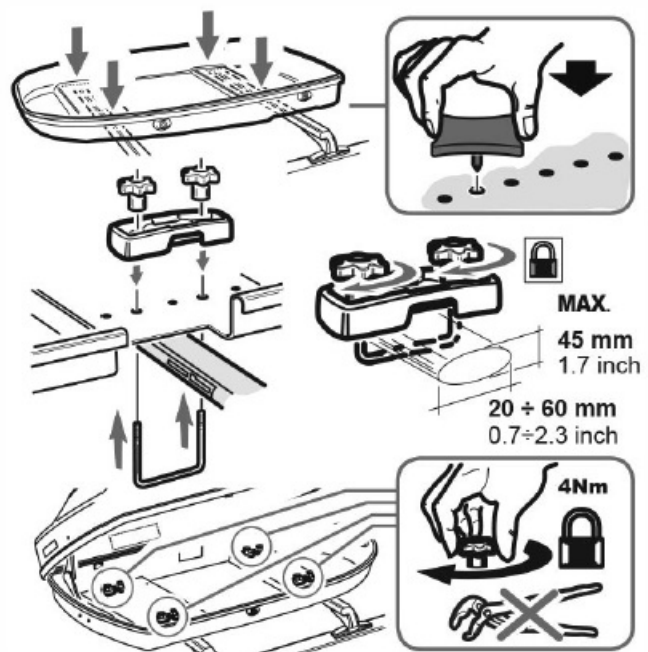

## USE

## LOADING

- Only use the product together with an approved roof rack.
- Follow all the instructions from the vehicle manufacturer and the manufacturer of the roof rack and roof box to assemble.

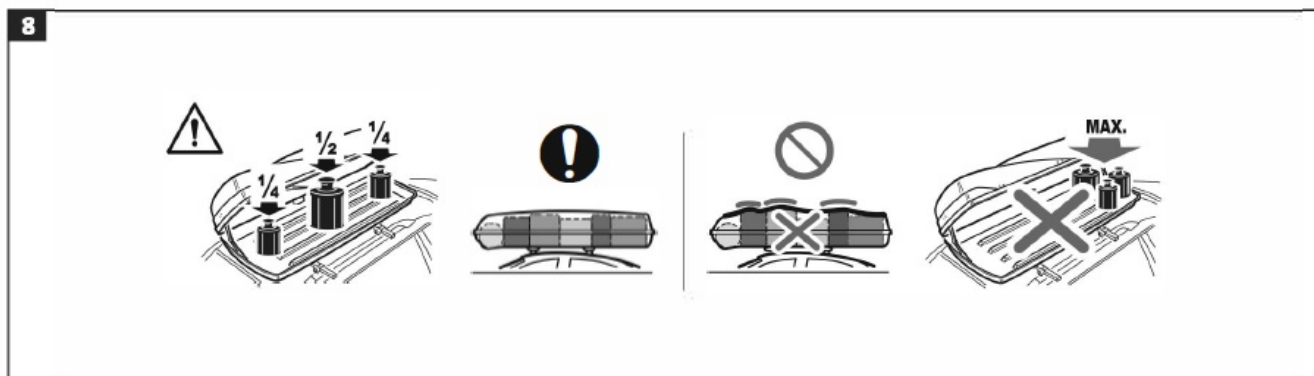
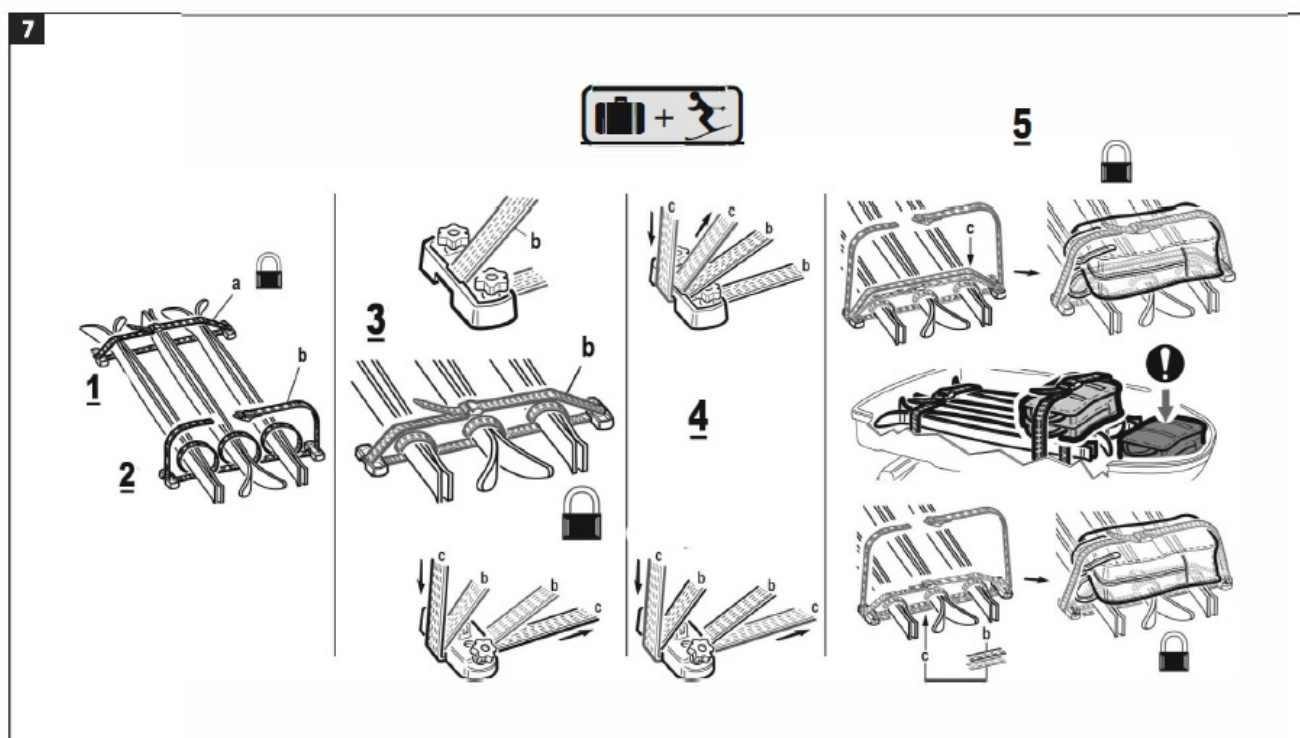
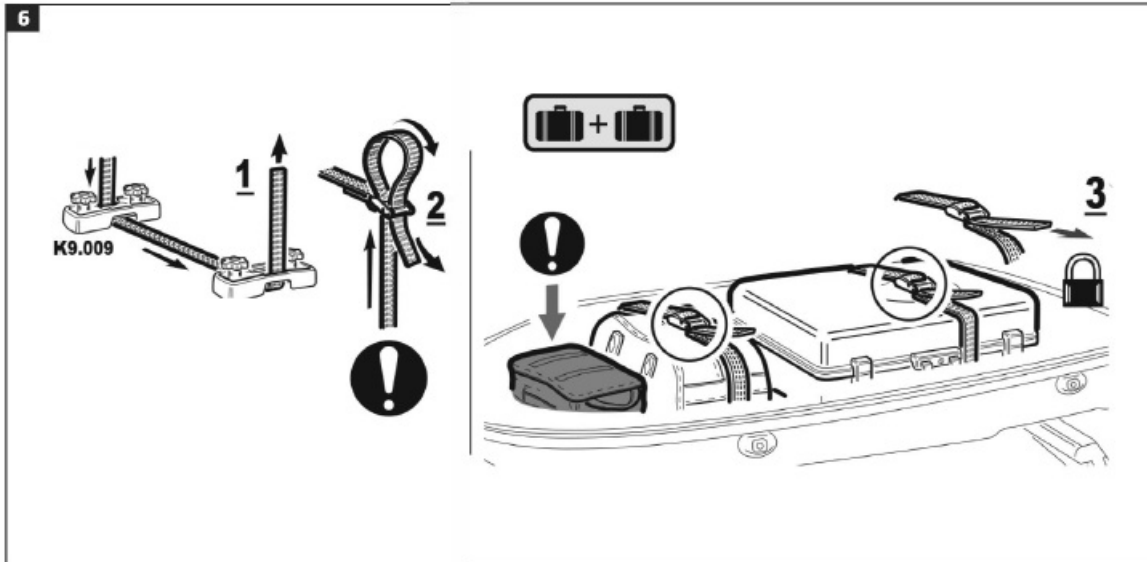

## OPENING AND CLOSING

The lid should close easily. Check before driving that the lid is properly closed. Remove the key after closing the lid. If the key does not come out this means that the lid is not properly closed. The key only comes out when the lid is correctly closed. The roof box should always be closed and locked when not in use.

- Note that the roof box affects the performance and road-holding of the vehicle (wind sensitivity, cornering and braking). Adjust your driving. The maximum recommended speed is 130 km/h.
- Always check before driving that the product is properly closed and locked. On long journeys, check as often as possible that the product is still correctly closed and locked.
- Remove the roof box and roof rack when not in use, to reduce fuel consumption.
- The noise level in the vehicle can increase when the roof box is fitted.

## CLEANING

- Clean the product with fresh water after use, and store in a dry place away from direct sunlight.
- Do not use detergent, abrasive substances, oil, solvent or detergent that contains alcohol, chlorine or ammoniac, they can discolour or ruin the product.
- Prolonged exposure to UV light can affect the colour of the product.
- Never transport loose objects in the roof box. All objects must be packed in suitable cases or bags before being put into the roof box.
- Never transport or store valuables in the roof box.
- Always store the roof box flat when not in use.

## Documents / Resources

