



Hamilton Beach 49901 FlexBrew Single Serve Coffee Maker with Removable Reservoir Instruction Manual

[Home](#) » [Hamilton Beach](#) » Hamilton Beach 49901 FlexBrew Single Serve Coffee Maker with Removable Reservoir Instruction Manual 

Contents

- [1 Hamilton Beach 49901 FlexBrew Single Serve Coffee Maker with Removable Reservoir](#)
- [2 Product Information](#)
- [3 Product Usage Instructions](#)
- [4 IMPORTANT SAFEGUARDS](#)
- [5 Parts and Features](#)
- [6 How to Brew a Pod](#)
- [7 How to Brew Ground Coffee](#)
- [8 Care and Cleaning](#)
- [9 Troubleshooting](#)
- [10 Limited Warranty](#)
- [11 Documents / Resources](#)
 - [11.1 References](#)
- [12 Related Posts](#)

Hamilton Beach®

Hamilton Beach 49901 FlexBrew Single Serve Coffee Maker with Removable Reservoir



Product Information

- Product Name: FlexBrew Single Serve Coffee Maker with Removable Reservoir
- Manufacturer: Hamilton Beach
- Website: hamiltonbeach.com (for recipes, tips, and product information)
- Additional Website: hamiltonbeach.ca (for recipes, tips, and product information)

Product Usage Instructions

1. Read all instructions carefully before using the product.
2. This appliance is not intended for use by persons (including children) with reduced physical, sensory, or mental capabilities, or lack of experience and knowledge, unless they are closely supervised and instructed concerning the use of the appliance by a person responsible for their safety.
3. Close supervision is necessary when using the appliance near children. Cleaning and user maintenance should not be done by children without supervision.
4. Do not touch hot surfaces. Always use handles or knobs to prevent burns from hot parts or spilled hot liquid.
5. To protect against electric shock, avoid placing the cord, plug, or coffee maker in water or any other liquid.
6. Unplug the coffee maker from the outlet when not in use and before cleaning. Allow it to cool before handling or cleaning.
7. Operate the coffee maker on a flat surface, away from the edge of the counter, to prevent accidental tipping.
8. Only use accessory attachments recommended by the manufacturer to prevent injuries.
9. If the supply cord or plug is damaged, do not operate the appliance. Similarly, if the appliance malfunctions, do not continue using it.
10. Do not use the coffee maker outdoors.
11. Ensure that the cord does not hang over the edge of the table or counter or touch hot surfaces, including stoves.
12. Avoid placing the coffee maker on or near a hot gas or electric burner or in a heated oven.
13. To disconnect the coffee maker, turn off the brew cycle and then remove the plug from the wall outlet. When unplugging, always grasp the plug and pull it from the outlet, never pull from the power cord.
14. Do not remove the lid during the heating cycle to prevent scalding.
15. Use the coffee maker only for its intended purpose.

16. During the brew process, do not lift the lid to avoid hot water spraying from the piercing needle.
17. Do not place the coffee maker in a cabinet when in use.
18. Handle the removable coffee pod holder with caution as it contains a sharp needle.
19. Use caution when cleaning the sharp piercing needle.
20. Do not remove the cover of the coffee maker as there are no user-serviceable parts inside.

Any repairs should be conducted by the manufacturer, its service agent, or similarly qualified persons. Please refer to the user manual for complete instructions and safety guidelines.

READ BEFORE USE

For recipes, tips and product information. hamiltonbeach.ca



ENTER TO WIN \$100 TO SPEND ON WEBSITE Scan code or visit: register.hamiltonbeach.com

IMPORTANT SAFEGUARDS

When using electrical appliances, basic safety precautions should always be followed to reduce the risk of fire, electric shock, and/or injury to persons, including the following:

1. Read all instructions.
2. This appliance is not intended for use by persons (including children) with reduced physical, sensory, or mental capabilities, or lack of experience and knowledge, unless they are closely supervised and instructed concerning use of the appliance by a person responsible for their safety.
3. Close supervision is necessary when any appliance is used by or near children. Cleaning and user maintenance shall not be made by children without supervision. Children should be supervised to ensure that they do not play with the appliance.
4. Do not touch hot surfaces. Use handles or knobs. Care must be taken, as burns can occur from touching hot parts or from spilled, hot liquid.
5. To protect against electric shock, do not place cord, plug, or coffee maker in water or other liquid.
6. Unplug from outlet when not in use and before cleaning. Allow to cool before putting on or taking off parts and before cleaning the appliance.
7. Coffee maker must be operated on a flat surface away from the edge of counter to prevent accidental tipping.
8. The use of accessory attachments not recommended by the appliance manufacturer may cause injuries.
9. Do not operate any appliance with a damaged supply cord or plug, or after the appliance malfunctions or has

been dropped or damaged in any manner. Supply cord replacement and repairs must be conducted by the manufacturer, its service agent, or similarly qualified persons in order to avoid a hazard. Contact Customer Service for information on examination, repair, or adjustment as set forth in the Limited Warranty.

10. Do not use outdoors.
11. Do not let cord hang over edge of table or counter or touch hot surfaces, including stove.
12. Do not place coffee maker on or near a hot gas or electric burner or in a heated oven.
13. To disconnect coffee maker, turn brew cycle off and then remove plug from wall outlet. To unplug, grasp the plug and pull from the outlet. Never pull from the power cord.
14. Scalding may occur if the lid is removed during the heating cycle.
15. Do not use appliance for other than intended use.
16. **WARNING!** To avoid hot water spraying from the piercing needle, do not lift the lid during the brew process.
17. Do not place coffee maker in a cabinet when in use.
18. **CAUTION!** Cut Hazard: Removable coffee pod holder contains a sharp needle. Use caution when handling.
19. **CAUTION!** Cut Hazard: Piercing needle is sharp. Use caution when cleaning.
20. **WARNING!** Risk of Fire or Electric shock, do not remove this cover. No user serviceable parts inside. Repair should be done by authorized service personnel only.

SAVE THESE INSTRUCTIONS

Other Consumer Safety Information

This appliance is intended for household use only.

WARNING Electrical Shock Hazard: This appliance is provided with a polarized plug (one wide blade) to reduce the risk of electric shock. The plug fits only one way into a polarized outlet. Do not defeat the safety purpose of the plug by modifying the plug in any way or by using an adapter. If the plug does not fit fully into the outlet, reverse the plug. If it still does not fit, have an electrician replace the outlet.

The length of the cord used on this appliance was selected to reduce the hazards of becoming tangled in or tripping over a longer cord. If a longer cord is necessary, an approved extension cord may be used. The electrical rating of the extension cord must be equal to or greater than the rating of the appliance. Care must be taken to arrange the extension cord so that it will not drape over the countertop or tabletop where it can be pulled on by children or accidentally tripped over.

To avoid an electrical circuit overload, do not use another high-wattage appliance on the same circuit with this appliance.

Parts and Features

Before first use: Wash all removable parts in hot, soapy water. Rinse and dry. Brew one cycle with water and discard water.

1	Gray Removable Pod Holder with Handle
2	Removable Brew Basket for Ground Coffee with Hinged Lid and Handle
3	Lid
4	Gray Removable Needle Holder with Black Seal
5	Black Seal
6	Piercing Needle
7	Funnel
8	Removable Cup Rest/Storage Container
9	Control Panel
10	Removable 50 oz. (1.48 L) Water Reservoir with Removable Lid
11	Lid Latch
12	(8 oz./237 mL) Button
13	(10 oz./296 mL) Button
14	(12 oz./355 mL) Button
15	(14 oz./414 mL) Button
16	Bold () Button
17	Refill Water Light

To order parts, visit:
hamiltonbeach.com/parts

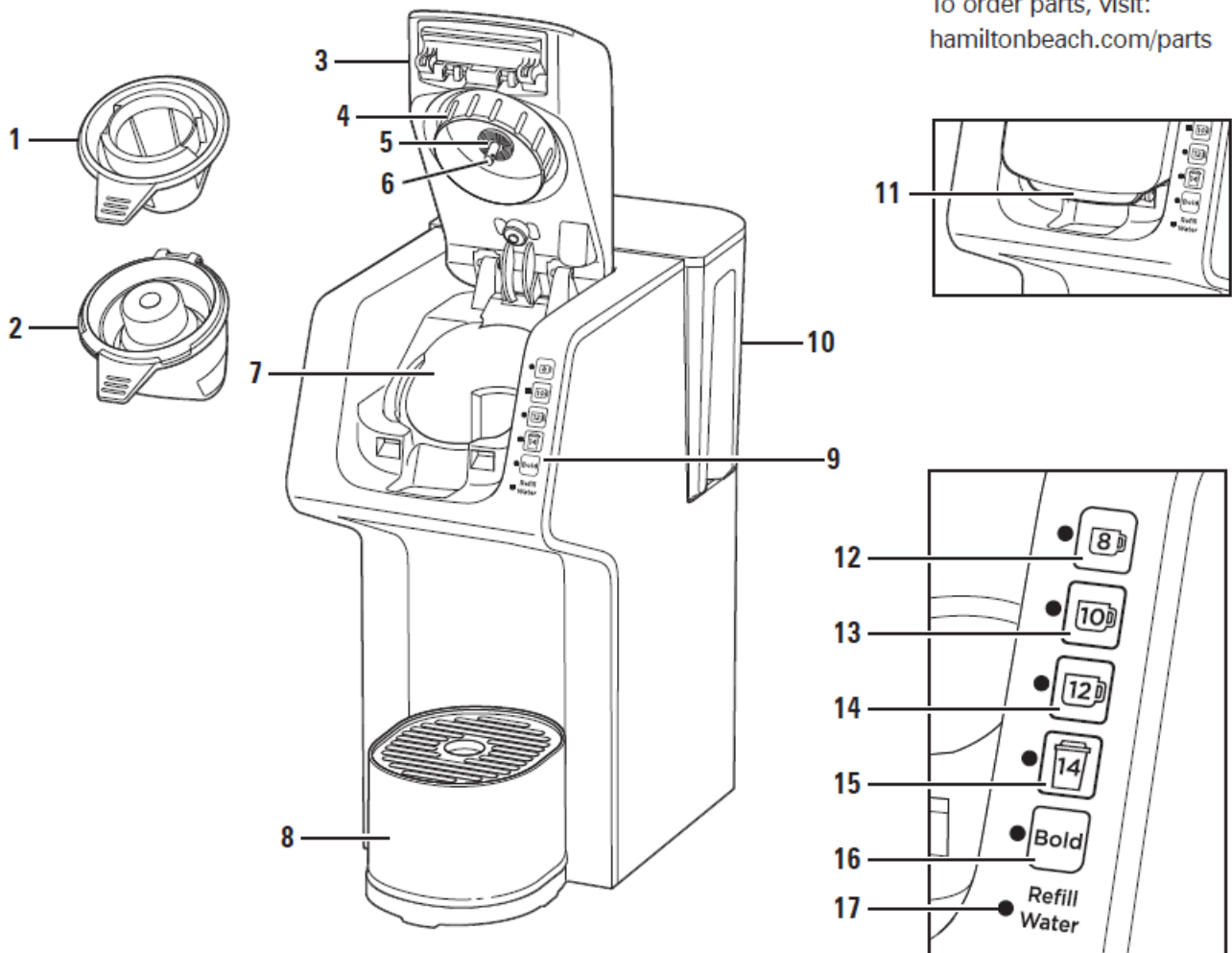

How to Brew a Pod

WARNING Burn Hazard.

If overflow occurs, unplug and allow coffee maker to cool. To avoid hot coffee overflowing:

- Fully insert cup or travel mug on cup rest.
Do not lift lid during the brewing process.
- Use appropriate sized cup or travel mug for your brew size.
- If brew cycle is stopped early, the coffee must be drained. Return cup or travel mug to cup rest. Press desired cup size button. Failure to drain the cup or travel mug can cause the next cup brewed to overflow. Discard coffee.

CAUTION

Cut Hazard. Removable pod holder has a sharp needle. Piercing needle on underside of lid is also sharp. Use caution when handling.

NOTES:

- If Lid is opened or any button was pressed to end brew cycle early, discard contents of cup or travel mug and pod. Press desired cup size button to restart brewing cycle.
- Use only cold water in Reservoir. Do not use hot water.
- Do not reheat coffee in machine.
- Do not use creamer or nondairy creamer in Reservoir.
- After brewing pods, such as hot cocoa, sugar-based or keto, immediately brew a water-only cycle without a pod to avoid possibility of clogging Piercing Needle.

- Press any cup size button to stop brew cycle.
 - All cup size buttons flashing 3 times: Coffee Maker Lid is not closed properly. Push Lid down to lock into place. Press desired cup size button.
 - Do not brew coffee before ensuring Removable Needle Holder arrow icon () is aligned with lock icon () inside FlexBrew Lid.
1. Lift up Water Reservoir and remove Lid. Add water to at least MIN fill line (16 oz. [473 mL]) or MAX fill line (50 oz. [1.48 L]). Replace Lid and place Water Reservoir on to Coffee Maker.
 2. Plug into outlet.
 3. Lift Lid Latch until Lid stays in place.
 4. Place Gray Removable Pod Holder in Funnel.
 5. Place a pod into Pod Holder. Do not remove foil.
 6. Close Lid and snap in place to pierce pod.
 7. Use Cup Rest for a cup/mug, or remove Cup Rest for a travel mug.
 8. For a stronger cup of coffee, press Bold () Button. Light will illuminate if pressed.
 9. Press desired cup size button: (8 oz./237 mL) or (10 oz./ 296 mL). Desired cup size button will illuminate when coffee is brewing.
 10. Coffee Maker will shut off automatically when brewing is complete.
 11. Unplug.
 12. Pod Holder should be rinsed after every use.
- NOTE:** If Refill Water Light and selected cup size light are flashing, refill Water Reservoir, then press flashing cup size button to finish brewing.

How to Brew Ground Coffee

WARNING

Burn Hazard.

If overflow occurs, unplug and allow coffee maker to cool. To avoid hot coffee overflowing:

- Fully insert cup or travel mug on cup rest.
- To avoid overflow, keep ground coffee below MAX fill line.
- Do not lift lid during the brewing process.
- If brew cycle is stopped early, the coffee must be drained. Return cup or travel mug to cup rest. Press desired cup size button. Failure to drain the cup or travel mug can cause the next cup brewed to overflow. Discard coffee.

CAUTION



Cut Hazard.

Piercing needle on underside of lid is sharp. Use caution when handling.

NOTES:

- If Lid is opened or any button was pressed to end brew cycle early, discard contents of cup or travel mug and pod. Press desired cup size button to restart brewing cycle.

- Use only cold water in Reservoir. Do not use hot water.
- Do not reheat coffee in machine.
- Do not use creamer or nondairy creamer in Reservoir.
- Do not use hot cocoa powder or mix in Brew Basket.
- If finer ground coffee is used, coffee may continue to drip after light has gone off.
- Press desired cup size button again to stop brewing midcycle.
- If brew indicator lights flash three times, Lid is not closed. Lower Lid until it clicks to lock. Press desired cup size button.
- Do not brew coffee without Removable Brew Basket in place.
- If you have sediment from coffee, add a #1 paper cone coffee filter to Removable Brew Basket.
- Do not brew coffee before ensuring Removable Needle Holder arrow icon (?) is aligned with lock icon () inside FlexBrew Lid.

1. Lift up Water Reservoir and remove Lid. Add water to at least MIN fill line (16 oz. [473 mL]) or MAX fill line (50 oz.[1.48 L]). Replace Lid and place Water Reservoir on to Coffee Maker.
2. Plug into outlet.
3. Lift Lid Latch until Lid stays in place.
4. Open Brew Basket Lid; then place Removable Brew Basket on countertop.
5. Add ground coffee to Removable Brew Basket: Add maximum 3 tablespoons (15 g) ground coffee to Removable Brew Basket. Do not fill above MAX Fill Line.
6. Close Brew Basket Lid. Place Brew Basket in Funnel.
7. Close Lid and snap in place to latch Lid closed.
8. Use Cup Rest for a cup/mug, or remove Cup Rest for a travel mug.
9. Press Bold (**BOLD**) Button to change strength to Bold, if desired.
10. Press desired cup size button:
 (8 oz./237 mL),  (10 oz./296 mL),
 (12 oz./355 mL), or (14 oz./414 mL).
 Desired cup size button will illuminate when coffee is brewing.
11. Coffee Maker will shut off automatically when brewing is complete.
12. Unplug.
13. Removable Brew Basket should be rinsed after every use.

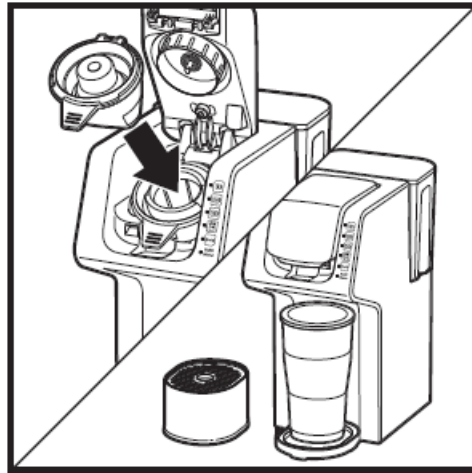
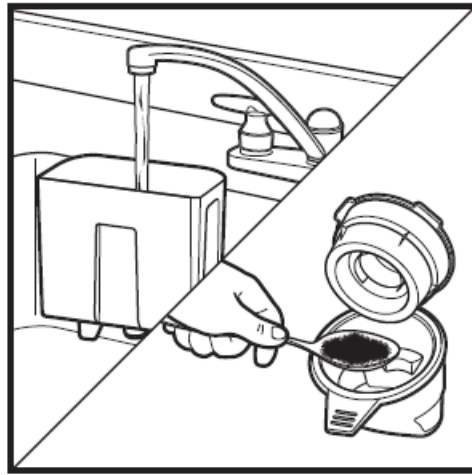

NOTE: If Refill Water Light and selected cup size light are flashing, refill Water Reservoir, then press flashing cup size button to finish brewing.

Care and Cleaning

WARNING

Electrical Shock Hazard.

Do not immerse cord, plug, or coffee maker in any liquid.

WARNING

Burn Hazard.

Failure to allow coffee maker to cool down may cause hot water or coffee to spray from the piercing needle. Use caution when cleaning.

CAUTION

Cut Hazard.





Removable pod holder has a sharp needle. Piercing needle on underside of lid also is sharp. Use caution when handling.

General Cleaning

1. Unplug and allow to cool.
2. Hand wash all removable parts in hot, soapy water. Rinse and dry or wash in top rack only of dishwasher. DO NOT use "SANITIZE" setting when washing in dishwasher. SANITIZE cycle temperatures could damage your product.

3. Wipe outside of Coffee Maker with a soft damp cloth.

Clogged Needle

1. Unplug and allow to cool.
2. Remove Gray Removable Needle Holder in Lid by turning counterclockwise from locked icon () to unlocked icon ().
3. Bend a small paper clip. Insert tip of paper clip through hole of Piercing Needle and up into shaft of Piercing Needle to ensure grounds have been removed.
4. To replace Gray Removable Needle Holder, insert tab between lock icon () and unlock icon () and turn clockwise to lock.



Routine Cleaning

All coffee makers should be cleaned at least once a month (once a week for areas with hard water).

1. Remove Water Reservoir and discard water. Add 1 1/2 cups (355 mL) plain white vinegar to Reservoir and return to place.
2. Plug into outlet.
3. Place a 15 oz. (444 mL) or larger cup or travel mug on Cup Rest to catch vinegar.
4. Press  (10 oz./296 mL) cup size button. When vinegar starts dispensing, press any cup size button again to stop brewing and allow vinegar to clean. After 30 minutes, press any cup size button and allow it to finish brew cycle. Empty Reservoir and fill with cold water; run 2-3 additional cycles with water only. Unit is cleaned and ready to brew coffee.
5. Unplug.

Troubleshooting

Coffee Maker will not brew/coffee not dispensing.

- Piercing Needle may be clogged. Always remove Gray Removable Needle Holder. Clean Piercing Needle in Lid of Coffee Maker as shown on page 7.
- Mineral deposits have formed. Clean Coffee Maker following directions in Care and Cleaning section as shown on page 7.
- Too little water. Need 16 oz. (473 mL) or more.

Coffee tastes bad.

- Too much water was added or too much or too little ground coffee was added. Change ratio of water to coffee grounds or use less water with coffee pods.
- Poor coffee quality and freshness.
- Poor water quality. Use filtered or bottled water.
- Soft water causes poor coffee extraction, which leads to poor tasting coffee. Use filtered, spring, or bottled water.

Coffee sediment in cup.

- Try a coarser grind of coffee, or add a #1 paper cone coffee filter to Removable Brew Basket. Make sure hinged Lid is closed on Removable Brew Basket.

Water on counter under unit.

- Overfilled Water Reservoir. Do not add more than 50 oz.(1.48 L) of water.

Coffee overflows from travel mug or regular mug.

- Press any cup size button to manually stop brew cycle. Do not touch travel mug or regular mug since it will be very hot. Let mug cool before emptying. Press desired cup size button to start a new brewing cycle.

Lights flashing:

- All cup size buttons flashing 3 times: Coffee Maker Lid is not closed properly. Push Lid down to lock into place.
- Refill Water Light and selected cup size light flashing: Refill Water Reservoir, then press flashing cup size button to finish brewing.
- 14 and Bold are flashing: Needle is clogged. Remove Gray Removable Needle Holder and follow "Clogged Needle" instructions on page 7.

Coffee overflows from Brew Basket.

- Rinse funnel area with Basket removed to clean out sugar from previous hot cocoa brew.
- Use Removable Brew Basket with Lid for ground coffee.
- Use a lesser amount of ground coffee. 3 tablespoons (15 g) is maximum amount of grounds to brew.

- When using whole bean coffee, a standard automatic drip coffee grind will yield best results. Be careful not to overgrind, since very finely ground coffee can cause overflow.
- Do not use soft water. Use filtered, spring, or bottled water.

Coffee pod bursts.

- There is variability in pod manufacturing process which causes some types of pods to be weaker at seams so foil seal fails. Try a different brand.
- If you are using softened water or live in an area where your tap water is naturally soft, this can cause coffee pod issues and filter basket overflows. Use filtered, spring, or bottled water.

Limited Warranty

This warranty applies to products purchased and used in the U.S. and Canada. This is the only express warranty for this product and is in lieu of any other warranty or condition.

This product is warranted to be free from defects in material and workmanship for a period of five (5) years from the date of original purchase in Canada and one (1) year from the date of original purchase in the U.S. During this period, your exclusive remedy is repair or replacement of this product or any component found to be defective, at our option; however, you are responsible for all costs associated with returning the product to us and our returning a product or component under this warranty to you. If the product or component is no longer available, we will replace with a similar one of equal or greater value.

This warranty does not cover glass, filters, wear from normal use, use not in conformity with the printed directions, or damage to the product resulting from accident, alteration, abuse, or misuse. This warranty extends only to the original consumer purchaser or gift recipient. Keep the original sales receipt, as proof of purchase is required to make a warranty claim. This warranty is void if the product is used for other than single-family household use or subjected to any voltage and waveform other than as specified on the rating label (e.g., 120V ~ 60 Hz).

We exclude all claims for special, incidental, and consequential damages caused by breach of express or implied warranty. All liability is limited to the amount of the purchase price. Every implied warranty, including any statutory warranty or condition of merchantability or fitness for a particular purpose, is disclaimed except to the extent prohibited by law, in which case such warranty or condition is limited to the duration of this written warranty. This warranty gives you specific legal rights. You may have other legal rights that vary depending on where you live. Some states or provinces do not allow limitations on implied warranties or special, incidental, or consequential damages, so the foregoing limitations may not apply to you.







To make warranty claim, do not return this appliance to the store. Please write Hamilton Beach Brands, Inc., Customer Service Department, 4421 Waterfront Dr., Glen Allen, VA 23060, or visit hamiltonbeach.com/customer-service in the U.S. or hamiltonbeach.ca/customer-service in Canada. For faster service, locate the model, type, and series numbers on your appliance.

Documents / Resources

	<p>Hamilton Beach 49901 FlexBrew Single Serve Coffee Maker with Removable Reservoir [pdf] Instruction Manual</p> <p>49901, 49921, FlexBrew Single Serve Coffee Maker with Removable Reservoir, 49901 FlexBrew Single Serve Coffee Maker with Removable Reservoir, 49901 FlexBrew Single Serve Coffee Maker, FlexBrew Single Serve Coffee Maker, Single Serve Coffee Maker, Coffee Maker</p>
---	---

References

- [HB Home | HamiltonBeach.ca](#)
- [HB Home | HamiltonBeach.ca](#)
- [HB Customer Service | HamiltonBeach.ca](#)

-  [Home | HamiltonBeach.com](#)
-  [Home](#)
-  [Home | HamiltonBeach.com](#)
-  [Customer Service | HamiltonBeach.com](#)
-  [Search Now for Replacement Parts & Accessories | HamiltonBeach.com](#)
-  [Wholesale - Hamilton Beach](#)

Manuals+.