

# hama WK-300 Multi Device Keyboard Instruction Manual

[Home](#) » [Hama](#) » hama WK-300 Multi Device Keyboard Instruction Manual 



Contents

1

hama WK-300 Multi Device Keyboard Instruction Manual

2

Keyboard WK-300

3

Documents / Resources

3.1

References



WK-300

Keyboard WK-300

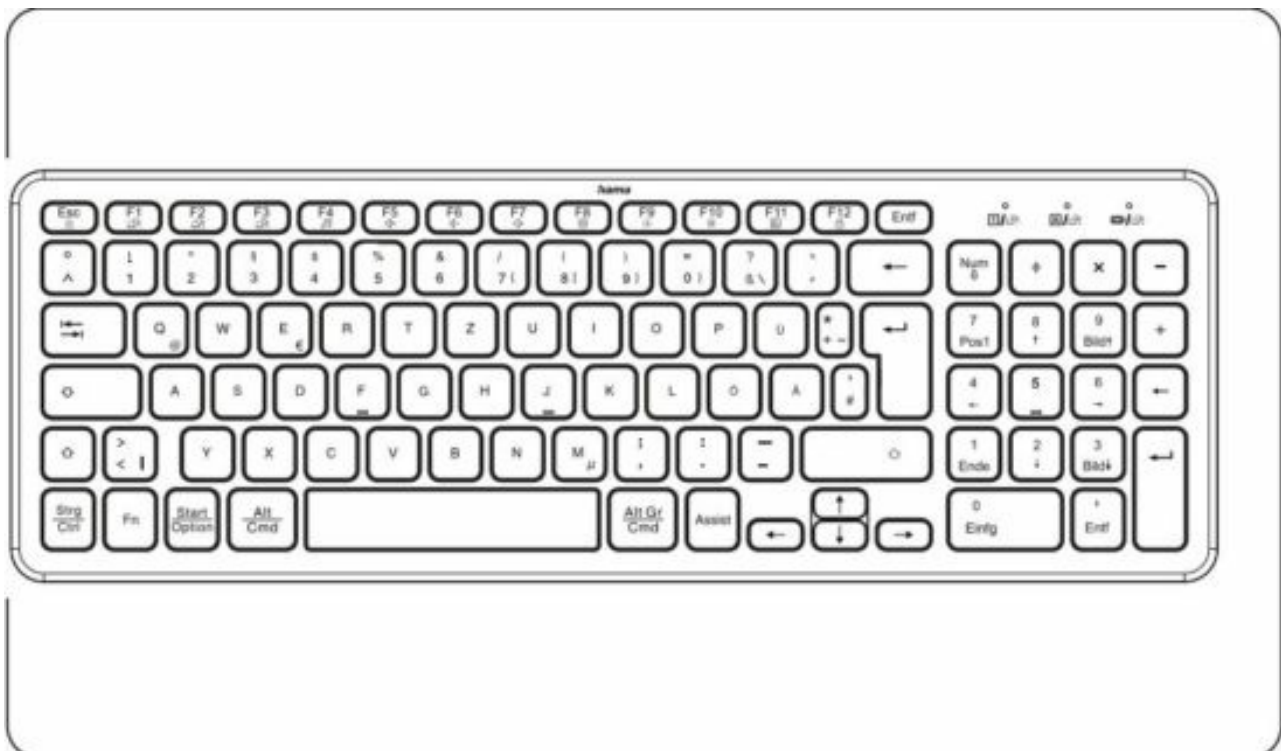

**A**

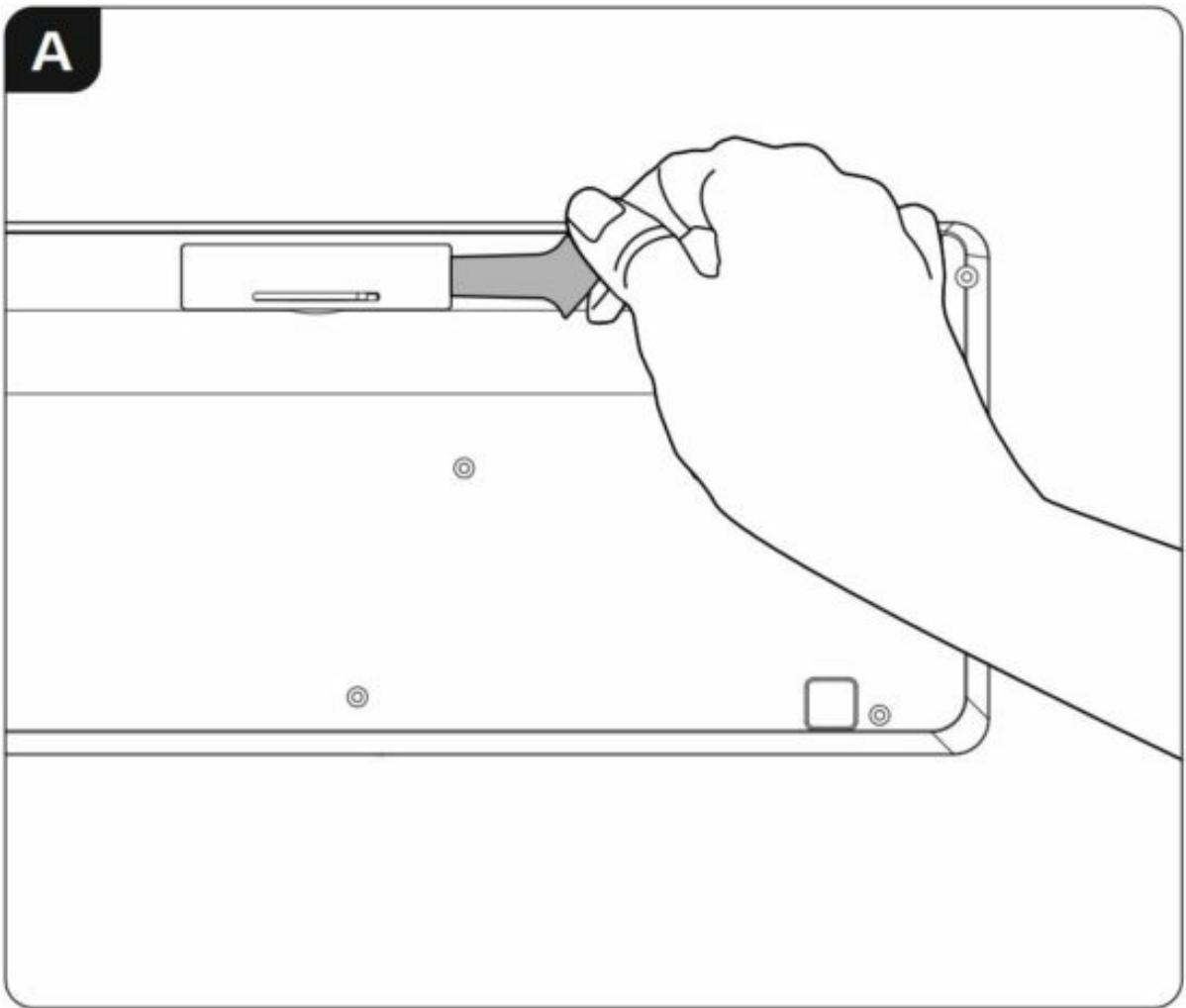

**B Pairing mode 2.4 GHz**

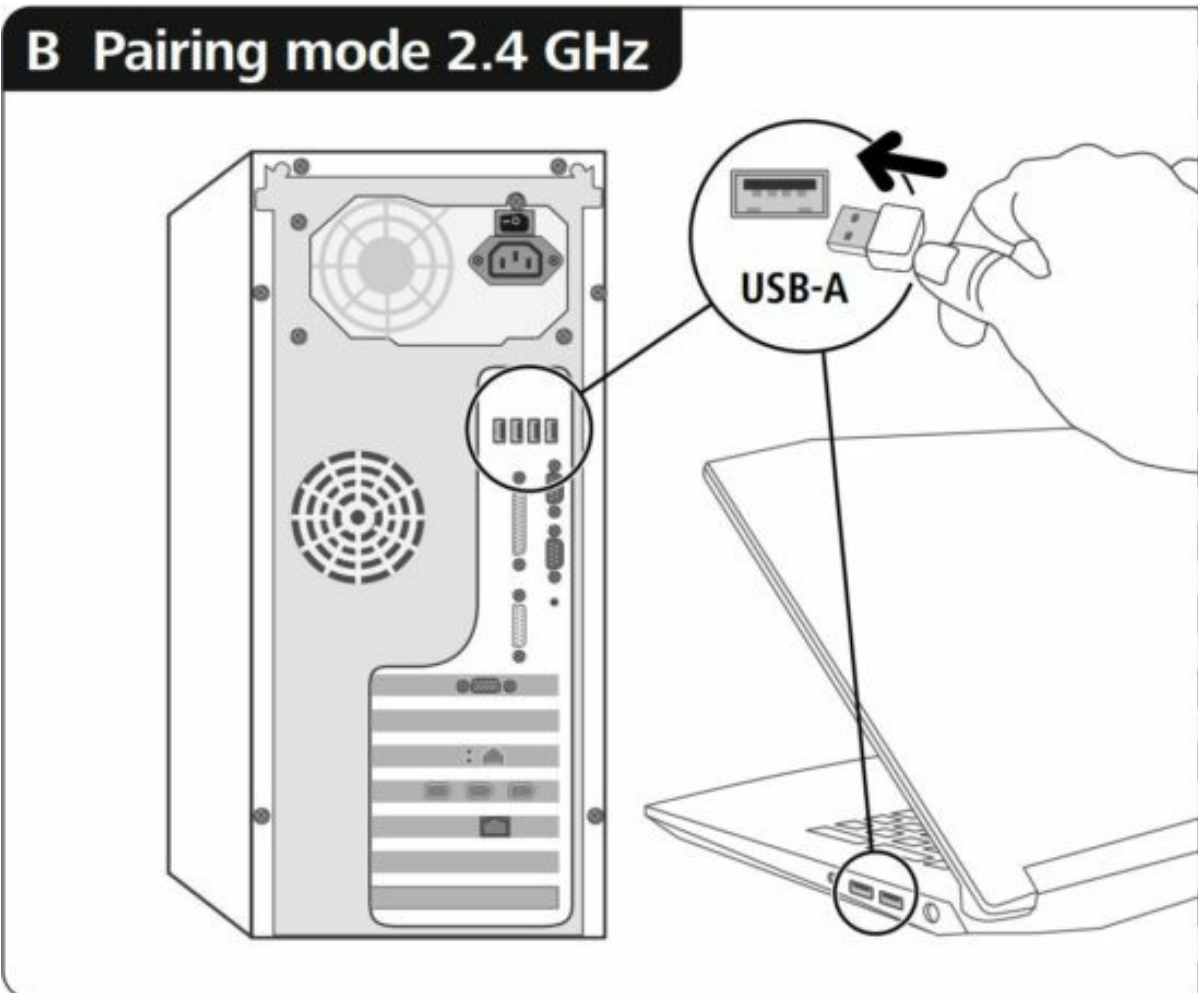

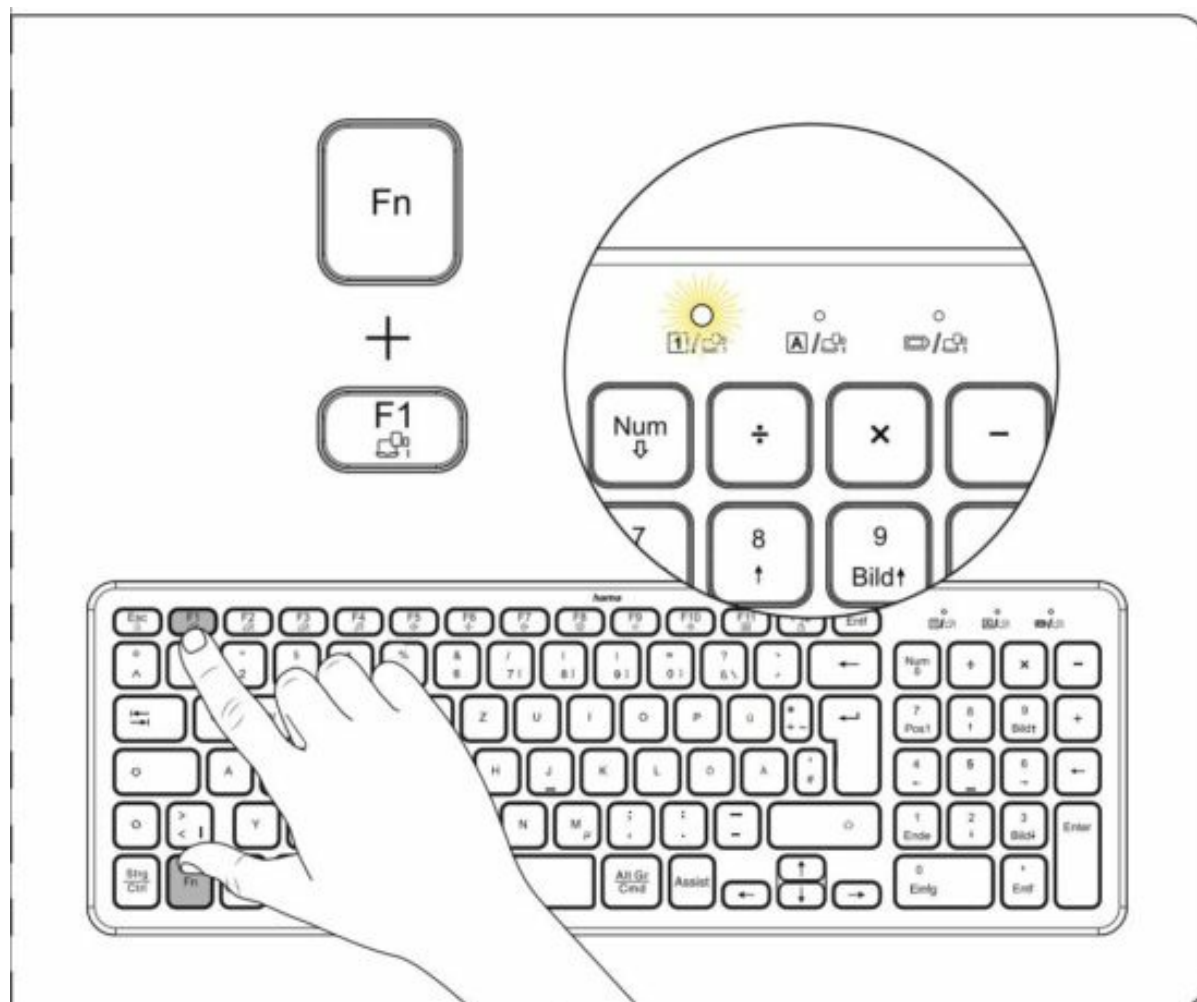

## C Pairing mode Bluetooth

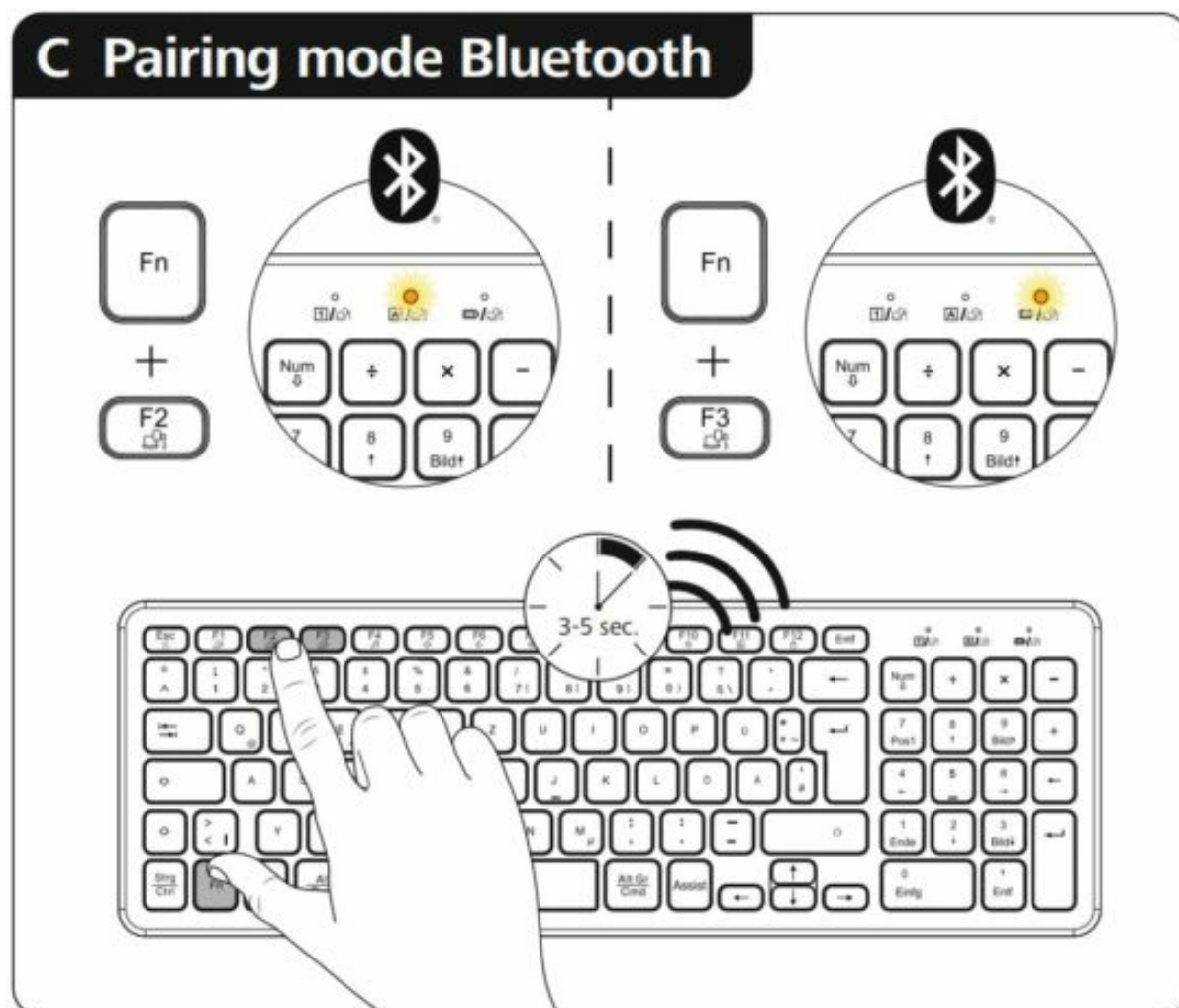

**D**

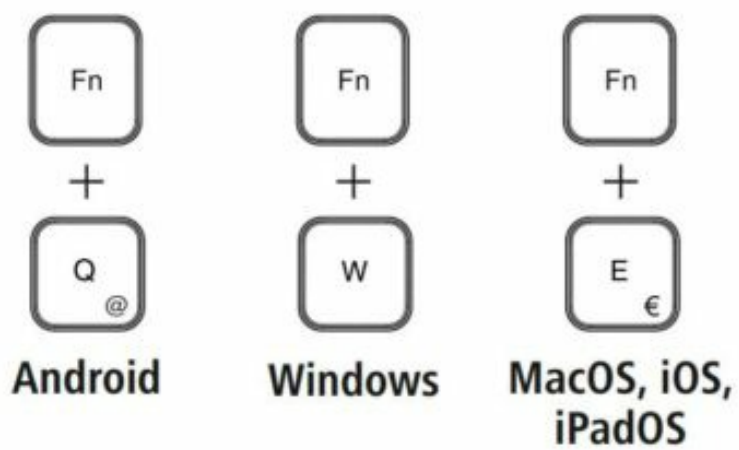

E

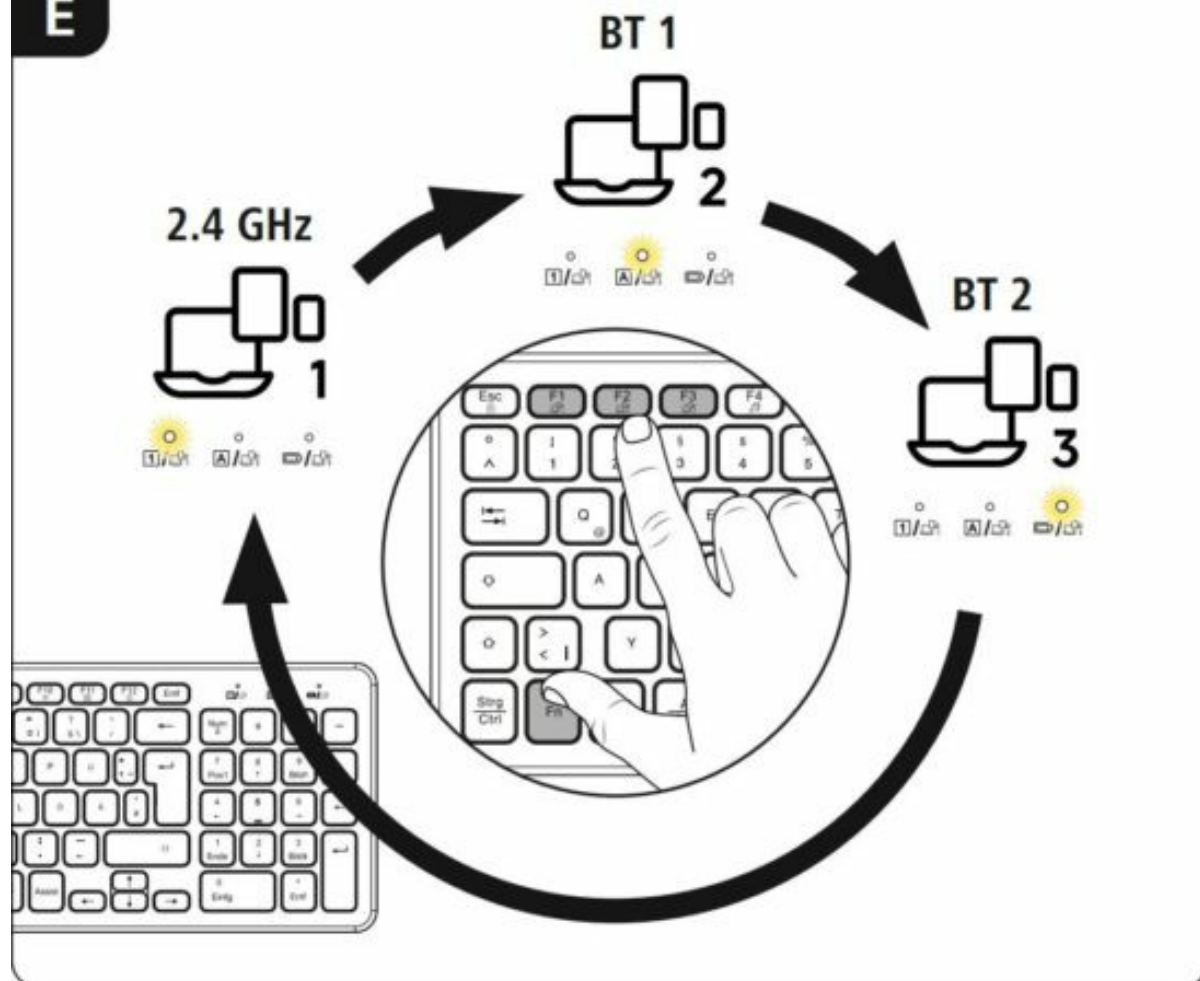

# F

Assist = AI assistant

Fn +

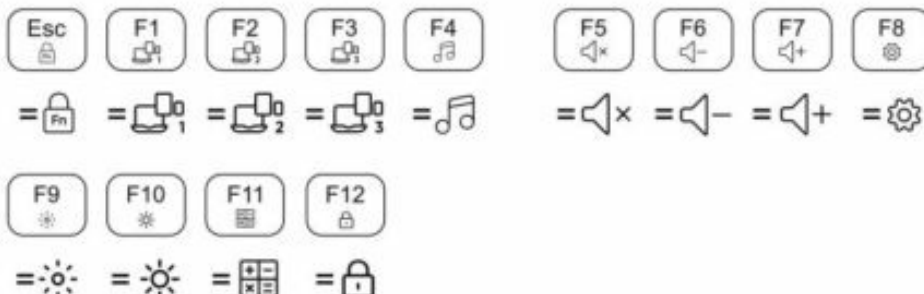

# ***hama***

Hama GmbH & Co KG  
86652 Monheim/Germany  
[www.hama.com](http://www.hama.com)



[www.hama.com/nep](http://www.hama.com/nep)

All listed brands are trademarks of the corresponding companies. Errors and omissions excepted, and subject to technical changes. Our general terms of delivery and payment are applied.



**Read More About This Manual & Download PDF:**

---

## Documents / Resources

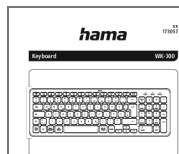

[hama WK-300 Multi Device Keyboard](#) [pdf] Instruction Manual  
WK-300 Multi Device Keyboard, WK-300, Multi Device Keyboard, Device Keyboard

## References

- [hama.com](#)
- [Recycling Information hama.com](#)
- [User Manual](#)

### Manuals+. [Privacy Policy](#)

This website is an independent publication and is neither affiliated with nor endorsed by any of the trademark owners. The "Bluetooth®" word mark and logos are registered trademarks owned by Bluetooth SIG, Inc. The "Wi-Fi®" word mark and logos are registered trademarks owned by the Wi-Fi Alliance. Any use of these marks on this website does not imply any affiliation with or endorsement.