



hama KVM-Switch Instructions

[Home](#) » [Hama](#) » hama KVM-Switch Instructions 

Contents

- [1 hama KVM-Switch](#)
- [2 Package Contents](#)
- [3 Safety Notes](#)
- [4 Startup and Operation](#)
- [5 Warranty Disclaimer](#)
- [6 Technical Data](#)
- [7 Documents / Resources](#)
- [8 Related Posts](#)

hama

hama KVM-Switch

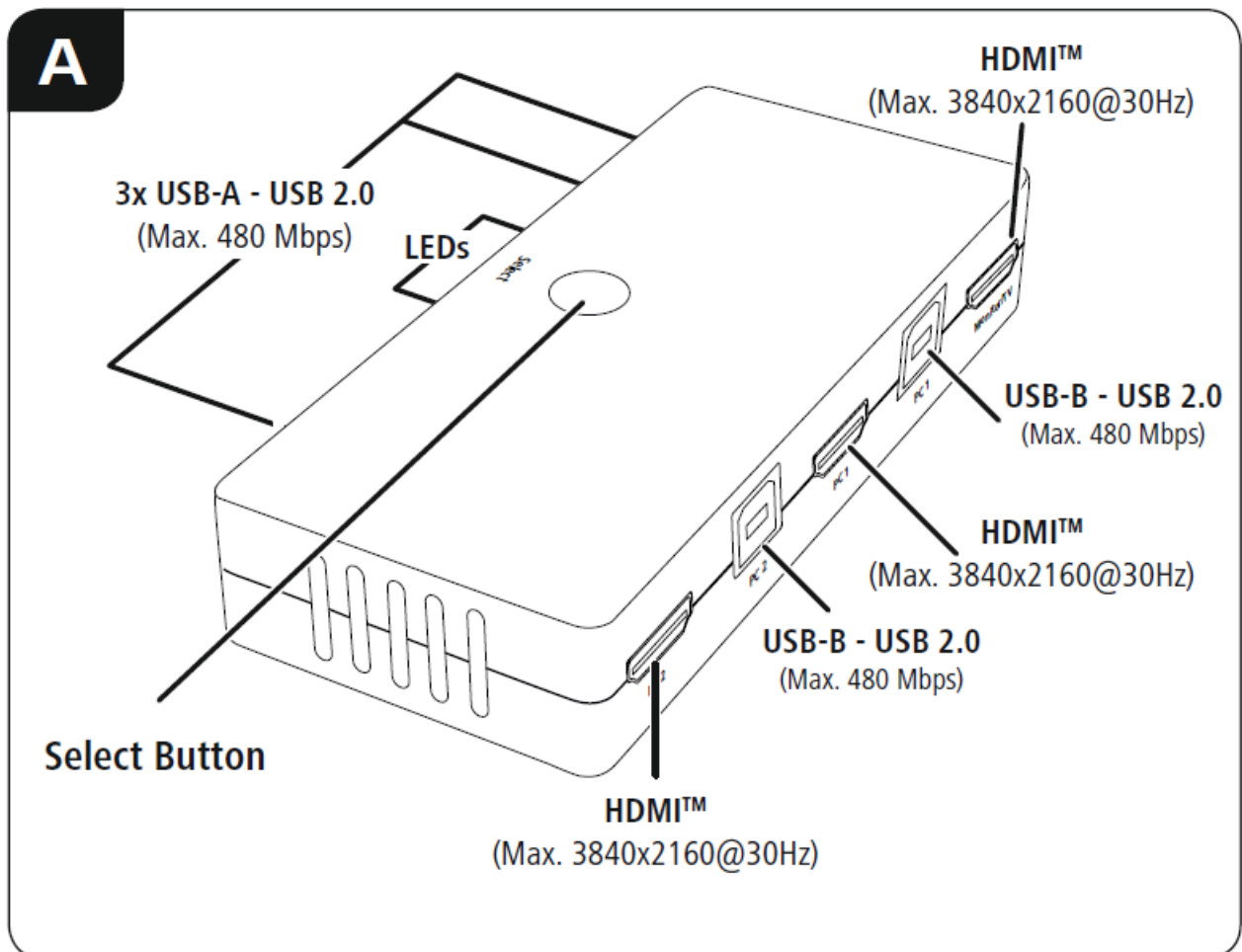

Package Contents

- KVM switch
- 2 HDMI™ cables
- 2 USB cables
- These operating instructions

Safety Notes

- Do not attempt to service or repair the product yourself. Leave any and all service work to qualified experts.
- Do not open the device or continue to operate it if it becomes damaged.
- Do not operate the product outside the power limits given in the specifications.
- Do not modify the product in any way. Doing so voids the warranty.
- Keep this product, as all electrical products, out of the reach of children! Use the product for its intended purpose only.
- Protect the product from dirt, moisture and overheating, and only use it in a dry environment.
- The product is intended for indoor use only.
- Do not use the product in the immediate vicinity of heaters or other heat sources or in direct sunlight.
- Do not use the product in moist environments and avoid splashes.
- Do not use the product in areas where the use of electronic devices is not permitted.
- Do not drop the product and do not expose it to any major shocks.
- Dispose of packaging material immediately according to locally applicable regulations.

Warning

- Find out the maximum output current capacity of the USB port on your device. To do this, consult the operating instructions or ask the manufacturer.
- Common values are 500 mA for USB-A 2.0, 900 mA for USB-A 3.0, and up to 3000 mA for USB-C.

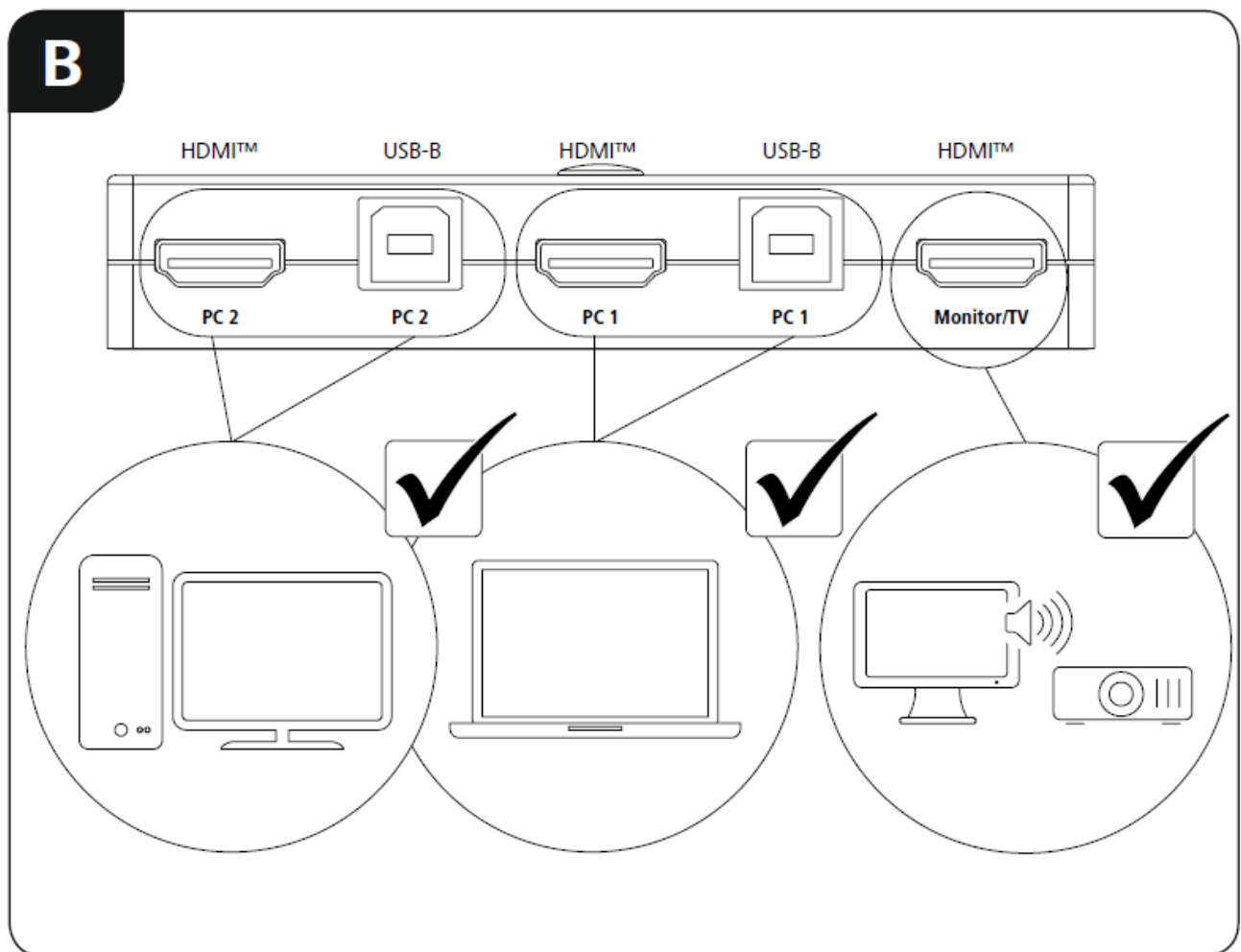

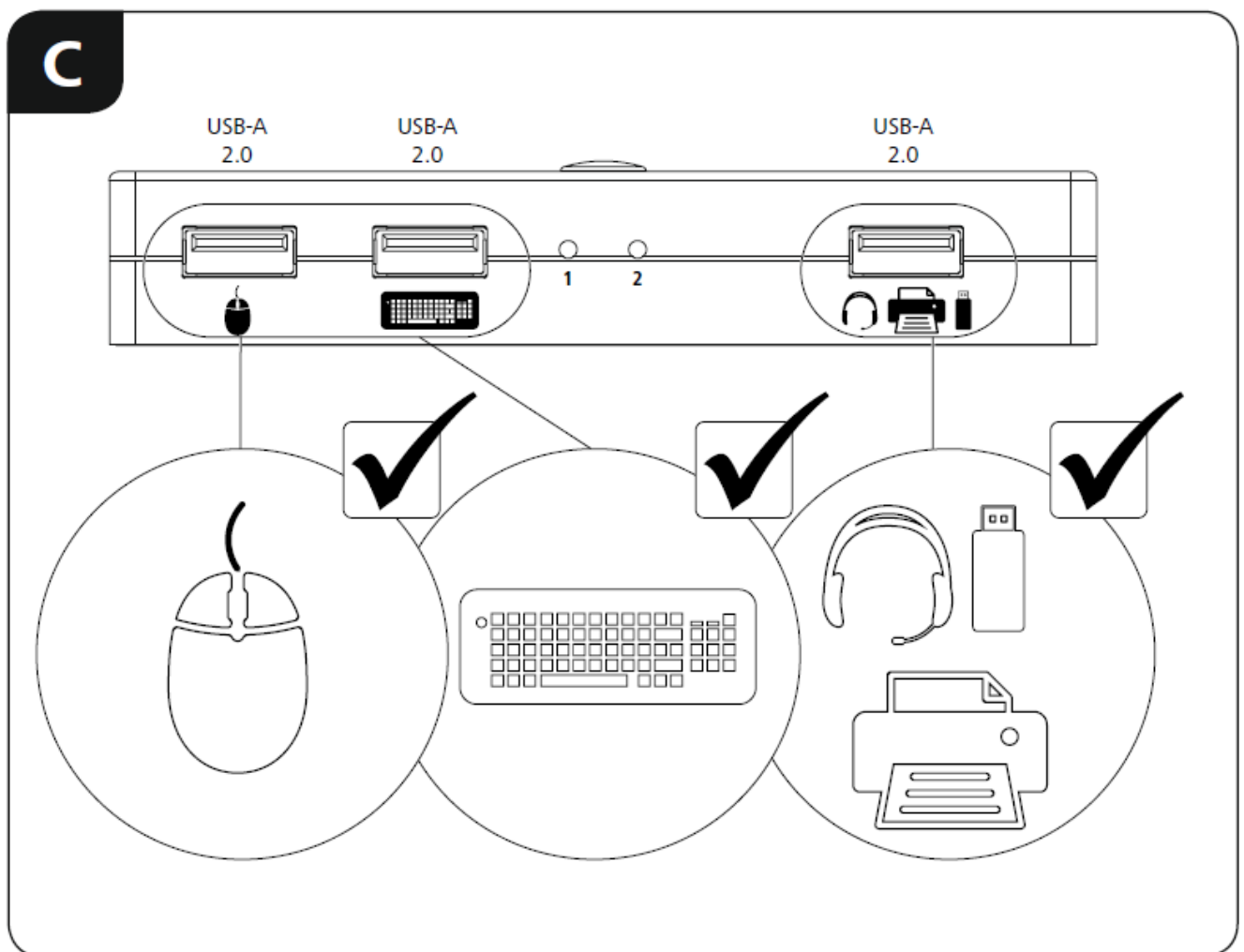

- Ensure that the total power consumption of all USB devices connected to the KVM switch does not exceed the determined value.

Note: For optimised video function, we recommend passive monitor adapters / cables (without chipset / signal converter).

Startup and Operation

- Connect the enclosed HDMI™/USB cable both to the KVM switch and PC/notebook 1 and PC/notebook 2. Now connect the HDMI™ cable on the monitor/TV to the KVM switch connection marked “Monitor/TV”.
- The symbols printed underneath the USB sockets represent connection suggestions. The USB devices can however also be connected to the KVM switch in a different sequence/combination.
- Switch on your computer and boot the system.
- Connect the product to a free HDMI™/USB port on your computer.
- You do not have to install drivers; the computer will automatically recognise the product.
- If necessary, follow the instructions for your operating system.
- In order to use your devices, plug them into the product one after the other.
- The connected devices can be toggled between PC/notebook 1 and PC/ notebook 2 by pressing the “Select” button on the KVM switch.
- The LED on the KVM switch lights up 1 or 2, depending on whether the connected devices are assigned to PC/notebook 1 or PC/notebook 2.

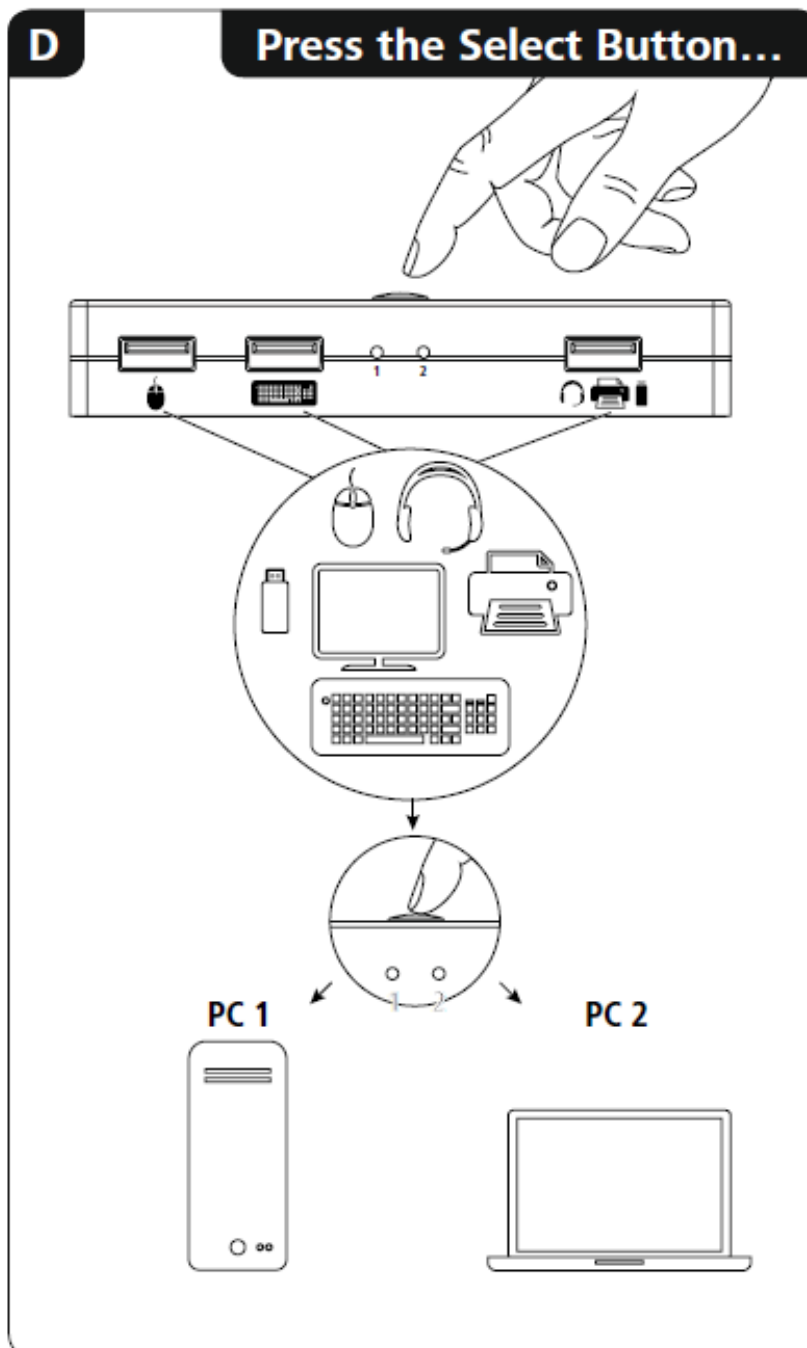

Warranty Disclaimer

Hama GmbH & Co KG assumes no liability and provides no warranty for damage resulting from improper installation/mounting, improper use of the product or from failure to observe the operating instructions and/or safety notes.

Technical Data

Operating voltage / current consumption	5V max. 500 mA
Compatibility	USB-A port HDMI™ port
System requirements	Windows 11 /10/ 8/ 7 Mac OS 10.8 ≥
USB specification	USB 2.0

Note: If there is interference or the product no longer responds, unplug the product, wait a few seconds and then plug it in again.

Documents / Resources

	hama KVM-Switch [pdf] Instructions hama, KVM, Switch
---	---