



## hama 00200136 3.1 Type-C USB Hub Instruction Manual

[Home](#) » [Hama](#) » hama 00200136 3.1 Type-C USB Hub Instruction Manual 

### hama 00200136 3.1 Type-C USB Hub Instruction Manual



#### Contents

- [1 Package Contents](#)
- [2 Instruction](#)
- [3 Safety Notes](#)
- [4 Startup and Operation](#)
- [5 Warranty Disclaimer](#)
- [6 Technical Data](#)
- [7 Support & S Service](#)
- [8 Documents / Resources](#)
- [9 Related Posts](#)

#### Package Contents

- USB-C Hub
- These operating instructions

#### Instruction

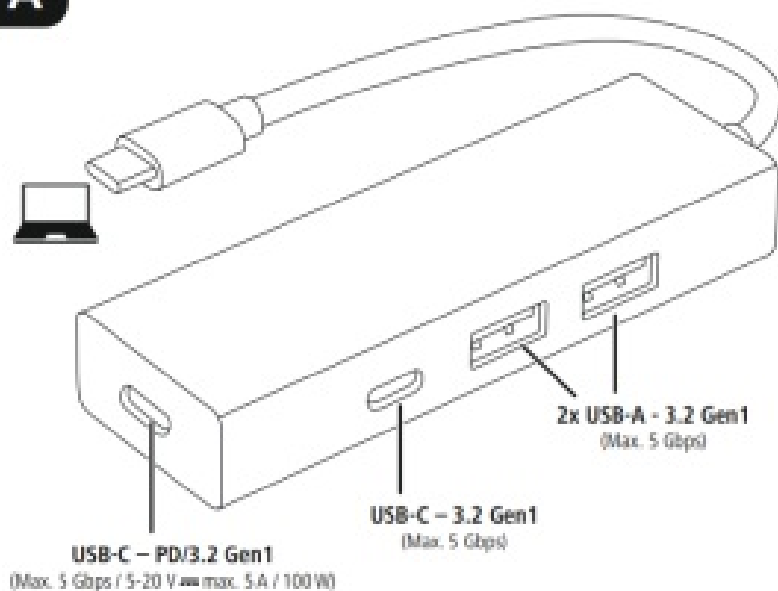
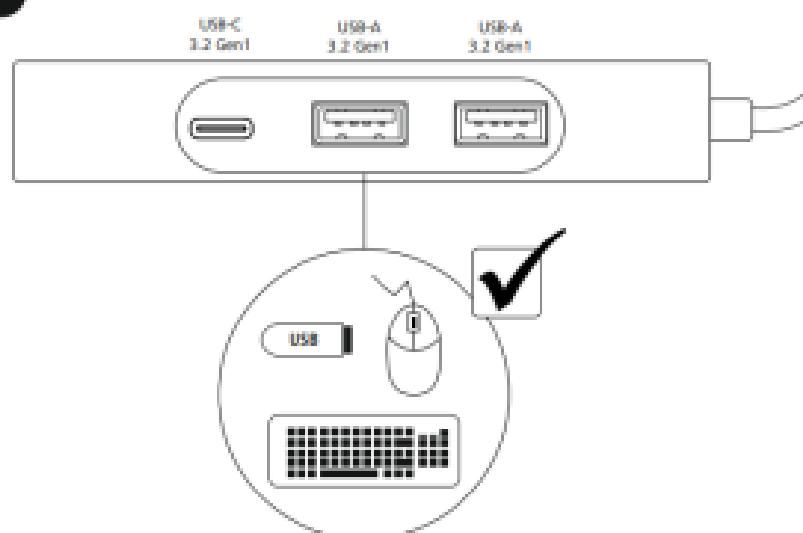
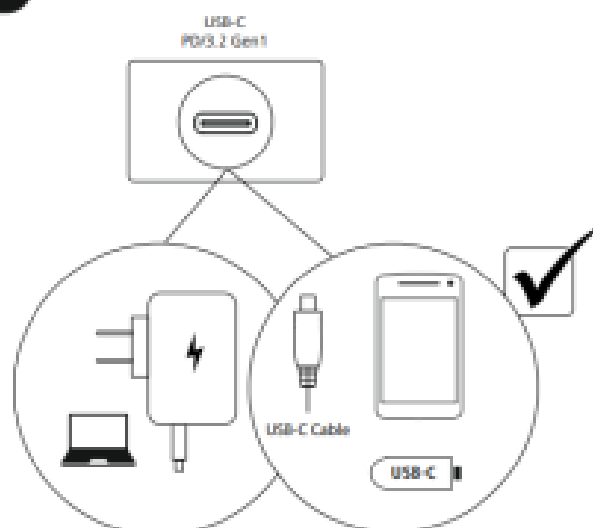
**A****B****C**

## Safety Notes

- Do not attempt to service or repair the product yourself. Leave any and all service work to qualified experts.
- Do not open the device or continue to operate it if it becomes damaged.
- Do not operate the product outside the power limits given in the specifications.
- Do not modify the product in any way. Doing so voids the warranty.
- Keep this product, as all electrical products, out of the reach of children! Use the product for its intended purpose only.
- Protect the product from dirt, moisture and overheating, and only use it in a dry environment.
- The product is intended for indoor use only.
- Do not use the product in the immediate vicinity of heaters or other heat sources or in direct sunlight.
- Do not use the product in moist environments and avoid splashes.
- Do not use the product in areas where the use of electronic devices is not permitted.
- Do not drop the product and do not expose it to any major shocks.
- Dispose of packaging material immediately according to locally applicable regulations.

## Warning

- Find out the maximum output current capacity of the USB port on your device. To do this, consult the operating instructions or ask the manufacturer.
- Common values are 500 mA for USB-A 2.0, 900 mA for USB-A 3.0, and up to 3000 mA for USB-C.
- Ensure that the cumulative current draw of all USB devices connected to the hub/multiport adaptor does not exceed this value.

## Note

- To be able to use the charging function, the device must support Power Delivery (PD) or Thunderbolt-3/4.

## Startup and Operation

- Switch on your computer and boot the system.
- Connect the product to a free USB port on your computer.
- You do not have to install drivers; the computer will automatically recognize the product.
- If necessary, follow the instructions for your operating system.
- In order to use your devices, plug them into the product one after the other

## Warranty Disclaimer

Hama GmbH & Co KG assumes no liability and provides no warranty for damage resulting from improper installation/mounting, improper use of the product or from failure to observe the operating instructions and/ or safety notes.

## Technical Data

- Operating voltage / current consumption 5–20 V max. 5 A

- Compatibility USB-C port
- System requirements Windows 11 / 10 / 8 / 7  
Mac OS 10.8 ≥
- USB specification USB 3.2 Gen1

## Note

- If there is interference or the product no longer responds, unplug the product, wait a few seconds and then plug it in again.

## Support & S Service

[www.hama.com](http://www.hama.com)

Phone: +4990915020

## Documents / Resources



[hama 00200136 3.1 Type-C USB Hub](#) [pdf] Instruction Manual  
00200136, 3.1 Type-C USB Hub