



hama 00176638 Smart WLAN Socket Instruction Manual

[Home](#) » [Hama](#) » hama 00176638 Smart WLAN Socket Instruction Manual 

Contents

- [1 hama 00176638 Smart WLAN Socket](#)
- [2 Product Information](#)
- [3 Product Usage Instructions](#)
- [4 Operating instructions](#)
- [5 Safety instructions](#)
- [6 Technical data](#)
- [7 Maintenance and care](#)
- [8 Documents / Resources](#)
 - [8.1 References](#)
- [9 Related Posts](#)

hama

hama 00176638 Smart WLAN Socket



Product Information

- **Product Name:** Smart Plug
- **Model Number:** 00176638

Intended Use:

The smart socket is suitable for convenient control via app, voice, and automation. It is designed for indoor use only. Unauthorized modifications or conversions are not permitted and will invalidate the warranty.

Package Contents:

- 1xSmart Plug
- 1x Quick

Guide Safety Instructions:

Do not operate the product outside its performance limits specified in the technical data.

- Max. power capacity: 3680 W
- Commissioning: 1.

Installing the Hama Smart Home app:

- To use the unit's functions, you need a smartphone/tablet and the Hama Smart Home app.
 - Make sure you are using the latest version of the app.
 - A detailed description of the app and its functions can be found in the app guide available at [\[link to app guide\]](#)
- Integration into the Hama

Smart Home app:

Follow the instructions provided in the app to integrate the Smart Plug into the Hama Smart Home app.

Technical Data:

- Model Number: 00176638
- Max. Power Capacity: 3680 W – WiFi Power Socket

Maintenance and Care:

Refer to the user manual for maintenance and care instructions.

Disclaimer:

Read and follow all safety instructions and guidelines provided in the user manual before using the product.

Service and Support:

For any service or support-related queries, refer to the user manual or contact customer support.

Declaration of Conformity:

The product complies with all relevant regulations and directives.

Product Usage Instructions

1. Ensure that you have installed the Hama Smart Home app on your smartphone or tablet.
2. Connect the Smart Plug to a power source.
3. Launch the Hama Smart Home app.
4. Follow the instructions provided in the app to integrate the Smart Plug into the app.
5. Once integrated, you can control the Smart Plug using the app, voice commands, or automation.
6. Refer to the app guide for detailed information on using the Hama Smart Home app and its full range of functions.
7. Do not operate the Smart Plug outside its specified performance limits of 3680 W.
8. Follow all safety instructions and guidelines provided in the user manual for safe and proper usage of the Smart Plug.
9. For any maintenance or care requirements, refer to the user manual. 10. In case of any issues or queries, refer to the user manual or contact customer support for assistance.

Operating instructions**Introduction**

Thank you for choosing a Hama product!

- Take your time and read the following instructions and notes completely first.
- Keep these operating instructions in a safe place for future reference. If you sell the unit, pass these operating instructions on to the new owner.

Intended use

The smart socket is suitable for convenient control via app, voice, and automation. The unit is suitable for indoor use only. Any other use is considered improper. Unauthorized modifications or conversions are not permitted and will invalidate the warranty. Do not open your unit yourself under any circumstances and do not attempt to repair it yourself.

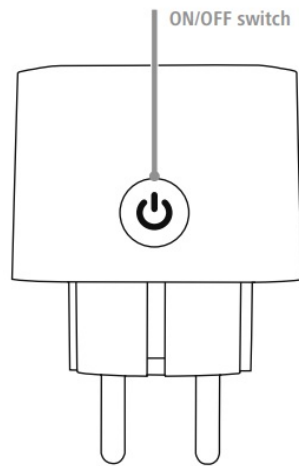

Package contents

Explanation of warning symbols and notices

The danger of electric shock

This symbol indicates a risk of contact with uninsulated parts of the product carrying a dangerous voltage of such magnitude as to constitute a risk of electric shock.

Warning

Used to mark safety instructions or to draw attention to particular hazards and risks.

Note

Used to mark additional information or important notes.

Explanation of product labeling symbols

The product is intended for indoor use only.

Package contents

- 1x Smart Plug
- 1x quick guide

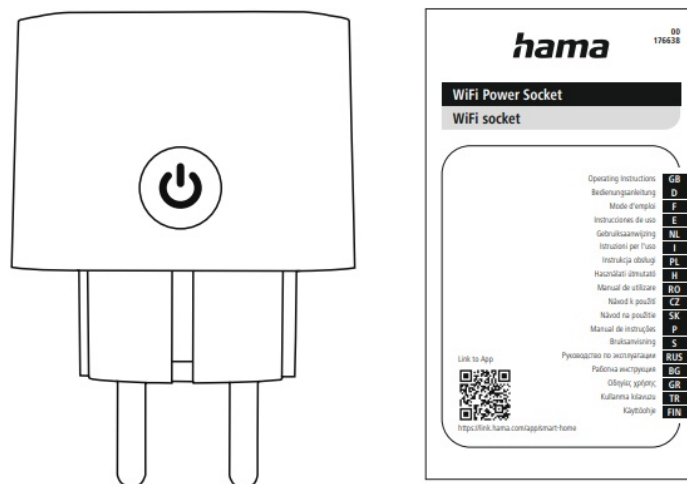

Safety instructions

Warning: Max. 3680 W

Do not operate the product outside its performance limits specified in the technical data.

Danger of electric shock

- Do not open the product or continue to operate it if it is damaged.
- Do not attempt to service or repair the product yourself. Leave any maintenance work to the responsible qualified personnel.
- Do not use the product if the AC adapter, adapter cable, or power cord is damaged.
- Do not operate covered.
- Voltage-free only when the plug is pulled out.
- Only start up or operate with closed safety covers.
- The product is intended for indoor use only.
- Protect the product from dirt, moisture, and overheating, and only use it in dry environments.
- The product is intended for private, non-commercial use.
- Only use the product for its intended purpose.
- Do not operate the product near the heater, other heat sources, or in direct sunlight.
- Use the item only under moderate climatic conditions.
- Do not use the product in areas where electronic products are not allowed.
- Do not use the product in a humid environment and avoid splashing water.
- Do not drop the product or subject it to violent shocks.
- Do not make any changes to the product. This will invalidate any warranty claims.
- Be sure to keep children away from the packaging material, there is a danger of suffocation.
- Dispose of the packaging material immediately by the locally applicable disposal regulations.
- Never plug several copies of this product in a row.
- Do not operate the product outside its performance limits specified in the technical data.
- The product may only be operated on a supply network as described on the type plate.
- This product, like all electrical products, does not belong in children's hands!

Commissioning

The following steps are required to put the unit into operation:

- Connect the unit to a properly installed and easily accessible mains socket.
- Set the unit to pairing mode by holding the button for about 5 seconds. The LED starts flashing quickly.

Installing the Hama Smart Home app

To use the unit's functions, you need a smartphone/tablet and the Hama Smart Home app.

Note

The following operating systems are supported:

- iOS 16.3 or later
- Android 6.0 or later
- Download the Hama Smart Home app from the App Store (iOS) or Google Play (Android) to your smartphone/tablet.
- To install the app, follow the instructions on your smartphone/tablet.

- Open the app on your smartphone/tablet.

Note

- During the setup of the app, queries are made as to whether the app is allowed to access functions of your smartphone/tablet. Allow these queries for the full functionality of the unit.
- Register to create a new account. Alternatively, log in with the access data of your existing account.
- Follow the instructions for setting up the app until you can add a new device, see Chapter 4.2 Integration into the Hama Smart Home app.

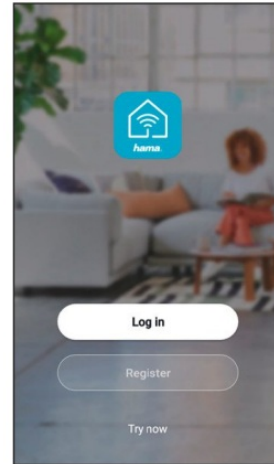

Note

You can find a detailed description of the Hama Smart Home app and the full range of functions in our app guide at: www.hama.com [ðarticle](#) number [ðDownloads](#) [ðApp operating instructions](#)

Note

Make sure that you are using the latest version of the Hama Smart Home app.

Integration into the Hama Smart Home app

After successful installation of the device and app, integrate the device into the app.

- Start the Hama Smart Home app on your smartphone/tablet.
- Tap the [Add Device] button. Or the plus (top right).



- Tap the button  Scan QR Code button (top right).

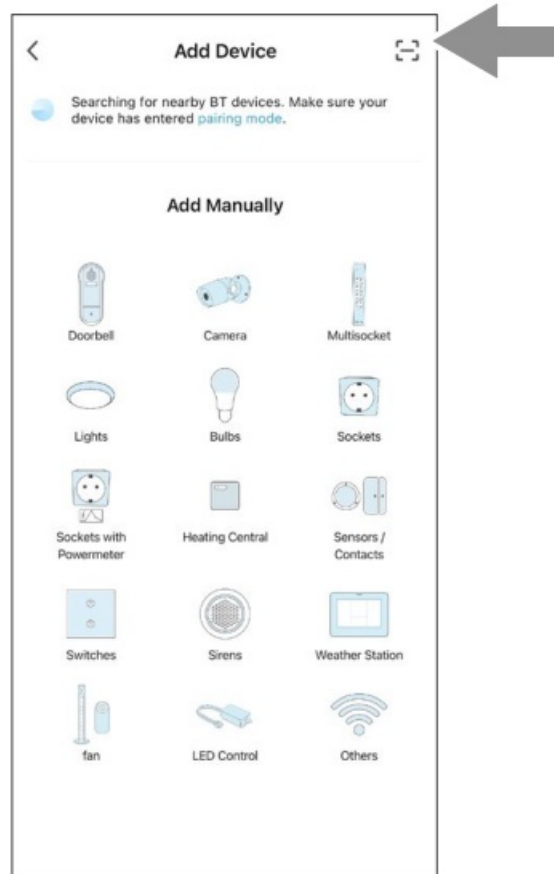

- Scan the QR code on your item:



Once the QR code has been recognized, the setup of your item begins. For this, you must confirm the network data of your 2.4 GHz network. The setup process can take up to 3 minutes. Once setup is complete, you can customize the name of your item or finish the setup process.

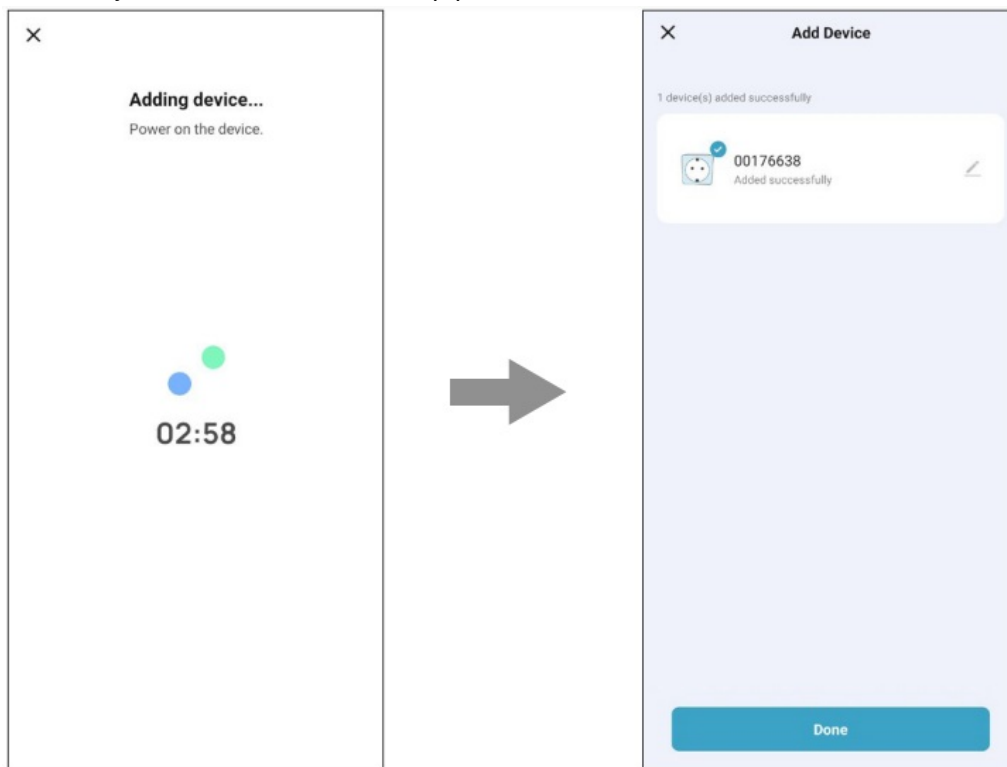

Embedding via a third-party app

Via the Matter radio standard, you can control our item in all compatible third-party apps in addition to our app. Please note, however, that the full range of functions is only available to you when using the Hama Smart Home app.

Share after initial integration in the Hama Smart Home app:

If you have already set up the item in the Hama Smart Home app, but want to share it with a third-party app for control, this is possible via the following steps:

- Open the item and navigate to the item settings via the (pen) icon.

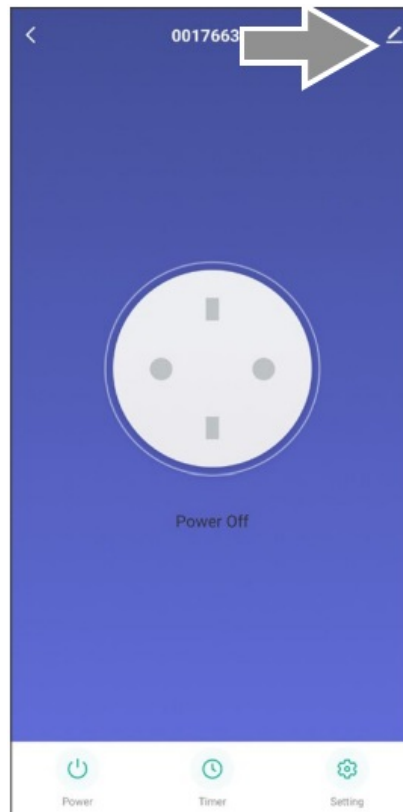

- Then generate an individual QR code and numerical code via the point (share via Matter).

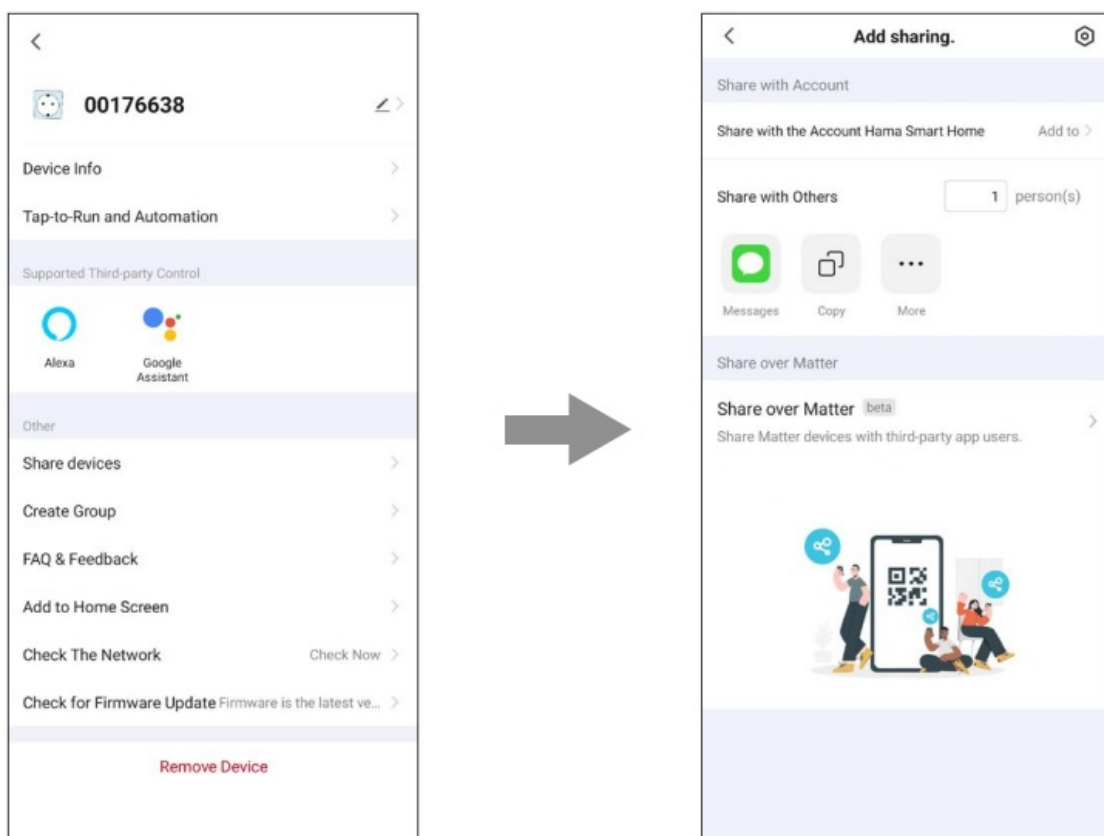

Now follow the steps in your chosen Matter-enabled app to set up the item using the generated number or QR code.

Initial integration via a third-party app

You can also use our items without first connecting them to the Hama Smart Home app. Please follow the steps below to do so:

- Open your chosen Matter-compatible app and start the device integration process.
- Press and hold the button on the socket for approx. 5 seconds until the LED starts flashing.
- Scan the QR code on the side of the socket with the corresponding app.

Note

- Please make sure that the app you choose supports the Matter standard.
- Find out about other requirements of the provider and follow them if necessary.

Setting options in the Hama Smart Home app

The following settings can be made in the app:

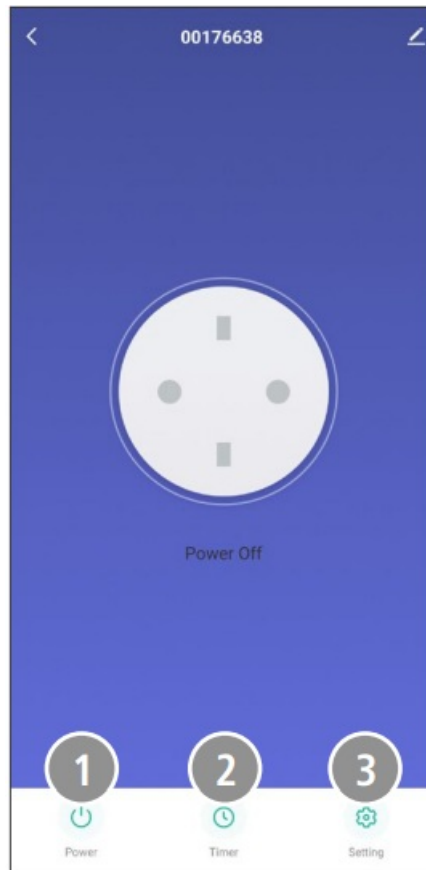

1. Switch On / Off
2. Schedule: Settings for time controls (e.g. timer, schedule, etc.)
3. Function settings: (switching sequence, LED mode, etc.)

Scenes can be created in the app for extended usage options. (See Chapter 6 and App Guide)

Extended usage options through scenes

Through scenes and automation that can be created in the app, there are many possible combinations and uses of these products, depending on the Smart Home products already in your home. Programming is always done via the app (see Chapter 4 of the App Guide) and is offered/suggested to you individually.

Standard usage option

Standard usage option

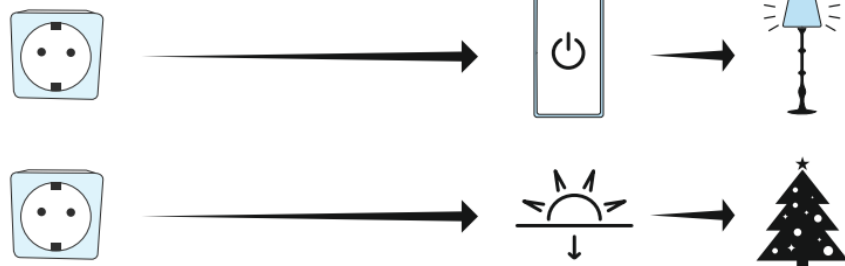

Extended usage option

Extended usage option

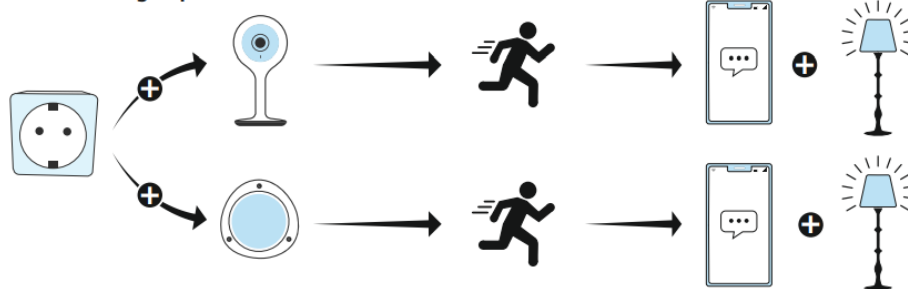

Technical data

Input voltage	220 – 240 V ~, 50 Hz
Maximum connected load	16 A, 3680 W
Frequency band	2.4 GHz
Radiated max. transmitting power	< 100 mW

Maintenance and care

Note

- Disconnect the unit from the mains before cleaning and when not in use for a long time.
- Clean this product with a lint-free, slightly damp cloth, and do not use aggressive cleaners.

Disclaimer

Hama GmbH & Co KG accepts no liability or warranty for damage resulting from improper installation, assembly, and improper use of the product or failure to observe the operating instructions and/or safety instructions.

Service and support

Please contact the Hama product advisory service if you have any questions about the product.

Hotline: +49 9091 502-0 (Deu/Eng)

Further support information can be found here: www.hama.com

To limit exposure to electromagnetic fields

This appliance is intended to be used at a distance of at least 20 cm from the user's body or persons nearby. This unit must not be worn on the body.

Declaration of conformity

Hama GmbH & Co KG hereby declares that the radio equipment type[00176638]complies with Directive 2014/53/EU. The full text of the EU Declaration of Conformity is available at the following internet address:
<https://de.hama.com> 00176638 Downloads

Hama GmbH & Co KG 86652 Monheim / Germany

Service & Support

- www.hama.com
- +49 9091 502-0

The Bluetooth® word mark and logos are registered trademarks owned by Bluetooth SIG, Inc. and any use of such marks by Hama GmbH & Co. KG is under license. Other trademarks and trade names are those of their respective owners.

All listed brands are trademarks of the corresponding companies. Errors and omissions excepted, and subject to technical changes. Our general terms of delivery and payment are applied.

00176638 / 10.23

Documents / Resources

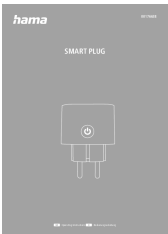
	<p>hama 00176638 Smart WLAN Socket [pdf] Instruction Manual 00176638 Smart WLAN Socket, 00176638, Smart WLAN Socket, WLAN Socket, Socket</p>
---	--

References

- [h Offizieller Hama Onlineshop | Hama DE](#)
- [Smart Home hama.com](#)