



hama 00040070 Nano Streaming Remote Control Instruction Manual

[Home](#) » [Hama](#) » hama 00040070 Nano Streaming Remote Control Instruction Manual 

Contents

- 1 hama 00040070 Nano Streaming Remote Control
- 2 Overview of the function keys
- 3 Package contents
- 4 Safety instructions
- 5 First steps – Inserting the batteries
- 6 Setup
- 7 Control of different devices
- 8 Learning function
 - 8.1 Deleting taught functions
- 9 Restoring factory settings
- 10 Switching illumination on/off
- 11 Maintenance
- 12 Troubleshooting
- 13 Warranty disclaimer
- 14 Documents / Resources
 - 14.1 References
- 15 Related Posts

hama

hama 00040070 Nano Streaming Remote Control



Service & Support

www.hama.com

+49 9091 502-0

Overview of the function keys

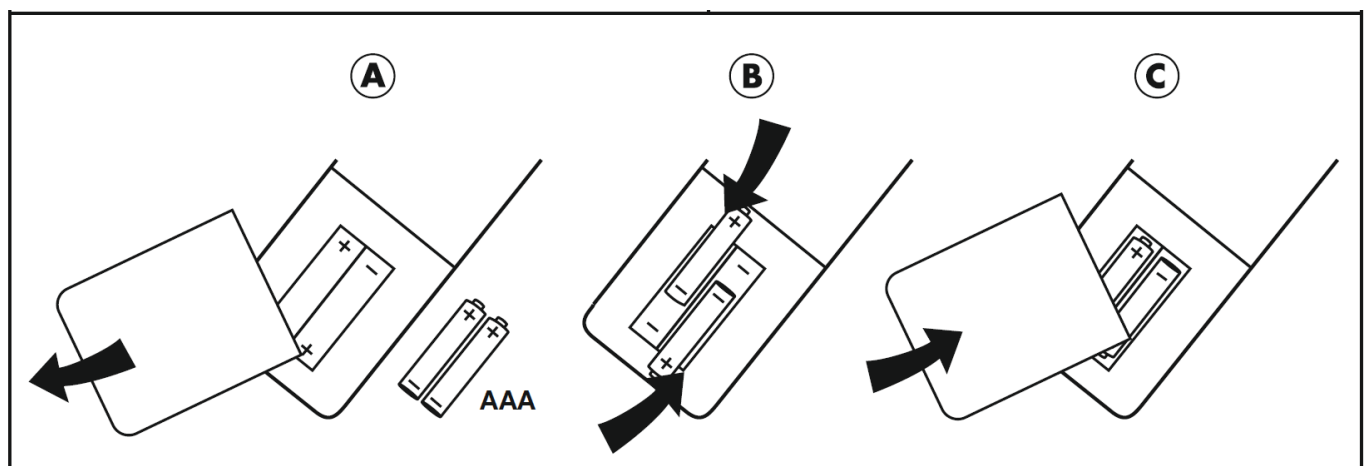
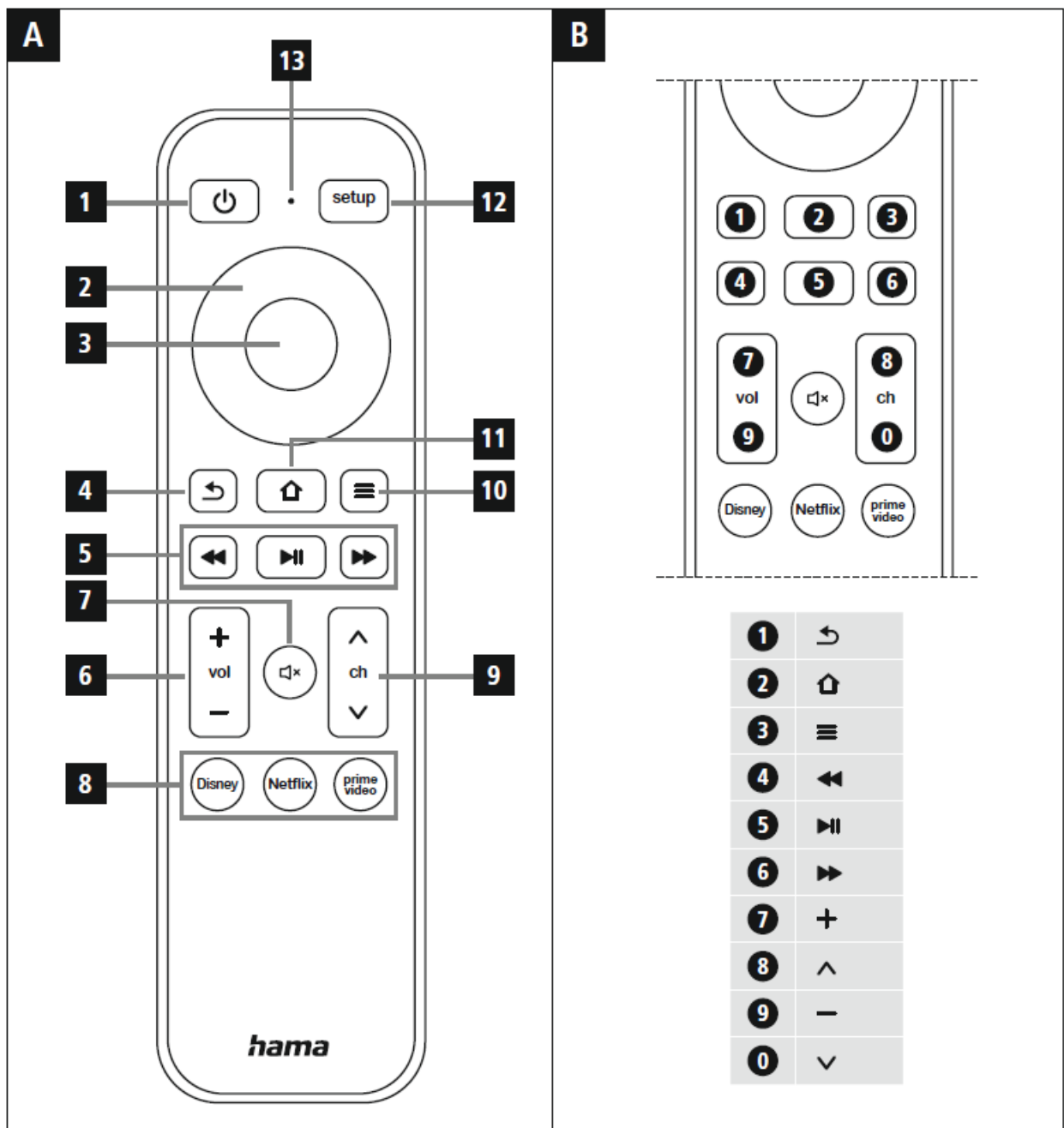

A: Remote control

1		Power On/Off
2		Control menu selection
3		OK button / Confirm menu selection
4		Menu Back / Level up
5		Movie control Previous scene Start/Pause Next scene
6		Volume +/-
7		Mute
8		Direct access to streaming services (if supported by the device)
9		Programme selection +/-
10	—	Home

11		Menu
12		Setup / Learning function / Mode selection TV / STB
13		LED

Thank you for choosing a Hama product.

Take your time and read the following instructions and information completely. Please keep these instructions in a safe place for future reference. If you sell the device, please pass these operating instructions on to the new owner.

Explanation of warning symbols and notes



Warning

This symbol is used to indicate safety instructions or to draw your attention to specific hazards and risks.



Note

This symbol is used to indicate additional information or important notes.

Package contents

- Universal remote control
- List of codes
- These operating instructions
- 2 x AAA batteries

Safety instructions

- Do not use the universal remote control in damp environments and avoid contact with splashing water.
- Keep the universal remote control away from heat sources and do not expose it to direct sunlight.
- As with all electrical products, the universal remote control should be kept out of the reach of children.
- This product is intended for private, non-commercial use only.
- Use the product only for the intended purpose.
- Protect the product from dirt, moisture and overheating and use it in dry rooms only.
- Do not use the product in areas in which electronic products are not permitted.
- Do not drop the product and do not expose it to any major shocks.
- Do not modify the product in any way. Doing so voids the warranty.
- Keep the packaging material out of the reach of children due to the risk of suffocation.
- Dispose of packaging material immediately in accordance with the locally applicable regulations.

- Do not operate the product outside the power limits given in the specifications.
- Do not open the device or continue to operate it if it becomes damaged.
- Do not attempt to service or repair the product yourself.
Leave any and all service work to qualified experts.
- Only use the article under moderate climatic conditions.

Warning – Batteries

- When inserting batteries, note the correct polarity (+ and – markings) and insert the batteries accordingly.
Failure to do so could result in the batteries leaking or exploding.
- Only use batteries (or rechargeable batteries) that match the specified type.
- Before you insert the batteries, clean the battery contacts and the polarity contacts.
- Do not allow children to change batteries without supervision.
- Do not mix old and new batteries, or batteries of different types or from different manufacturers.
- Remove the batteries from products that are not being used for an extended period (unless these are being kept ready for an emergency).
- Do not short-circuit batteries.
- Do not charge batteries.
- Do not burn batteries.
- Keep batteries out of the reach of children.
- Never open, damage or swallow batteries or allow them to enter the environment. They can contain toxic, environmentally harmful heavy metals.
- Remove spent batteries from the product and dispose of them without delay.
- Avoid storing, charging and using in extreme temperatures and at extremely low atmospheric pressures (such as at high altitudes).

First steps – Inserting the batteries

Note

- Alkaline batteries are recommended. Use two batteries of the type “AAA” (LR 03/Micro).
- Remove the battery cover on the back of the universal remote control (A).
- Insert the batteries, observing the “+/-” marks for polarity (B).
- Close the battery compartment (C).

Note: Code memory

Each programmed code or taught-in button is retained even during battery replacement.

Note: Energy saving function

The remote control switches itself off automatically if a button is pressed for longer than 15 seconds. This prolongs the life of the batteries if the remote control is stuck in a place where the buttons are pressed permanently, e.g. between sofa cushions.

Note: Low battery display

- This remote control indicates when the batteries are getting low.
- If the status LED flashes 2 times after a button is pressed, the batteries are weak and should be replaced promptly.

Setup

Note

- For proper infra-red transmission, always hold the remote control in the approximate direction of the device to be operated.
- You cannot operate a device with the universal remote control while it is in Setup mode. Exit Setup mode and select the device to be operated using the device selection buttons.
- Please note that the remote control emits infrared signals. These are not visible to the human eye.

The remote control can control 2 different types of devices, TV and STB. To switch between device types, press the Setup button briefly (<3 seconds).

- TV mode: You can select the green or red LED colour for the TV mode. If you have defined the TV mode with one of the two colours, the status LED lights up in this LED colour every time you press the button again.
- STB mode: You can use the respective other LED colour for STB mode. If you activate the STB mode, the status LED lights up in this LED colour every time you press the button again.

Brand-specific code search

With the brand-specific code search, you can reduce the search to the codes for the brand of your device. The following overview shows you which brand is represented by which button.

For TV sets

Button	Brand
BACK	Panasonic, TV
HOME	Sony, TV
MENU	Grundig, TV
REW	Toshiba, TV
PLAY/PAUSE	Hisense, TV
FF	Telefunken, TV
VOL+	TCL, TV
CH+	Samsung, TV
VOL-	LG, TV
CH-	Philips, TV
DISNEY+	(All TV brands)

For Set Top Boxes (STB)

Button	Brand
PRIME VIDEO	(All STB brands)

1. Switch the device you wish to operate on.
2. Press and hold the Setup button for approx. 3 seconds until the LED lights up.
3. Press the Power button once. Then press the button that stands for the brand of your terminal (e.g. BACK for Panasonic).
4. Point the remote control at the device you wish to control.
5. The remote control now sends a new command to your device every 2 seconds. The LED flashes once for each command and then lights up permanently again.
6. As soon as your device switches off, press the OK button to save the code. The LED goes out.
7. Then test the remote control and check whether the desired functions can be controlled. It is possible that the first code found is not the most suitable, and possibly not all functions are available. In this case, repeat steps 2 – 6.

Note

- If you want to switch to another brand during the search, simply press the key assigned to that brand (e.g. >II for Sony). The code search will then continue for this brand.
- After all codes assigned to a brand have been searched, the LED flashes 6 times and Setup mode is terminated. If no suitable code has been found for your device, start the code search for all brands.
- If no button is pressed for 35 seconds in Setup mode, the LED flashes 6 times and goes out. The remote control exits Setup mode without changing the previous settings.
- Press the Setup button to exit Setup mode.

Direct code entry

A code list is included in the universal remote control's extent of delivery. The code list contains four-digit codes for setting the remote control to work with most AV equipment manufacturers.

For easy orientation, the codes are sorted first by type of device (TV, STB, etc.) and within the type of device alphabetically by brand name.

Note This remote control does not have a separate numeric keypad, so the numbers are assigned to the following keys. (See Fig. 2)

1. Switch the device you wish to operate on.
2. Press and hold the Setup button for approx. 3 seconds until the LED lights up to start Setup mode.
3. Enter one of the 5-digit codes from the enclosed code list. The LED flashes briefly as each number is entered.
4. If a valid code is entered, the LED goes out after the 5th number is entered and the code is automatically saved.
5. Then test the remote control and check whether the desired functions can be controlled. It is possible that the first code found is not the most suitable, and possibly not all functions are available. In this case, repeat steps 2 – 5.

Note

- If an invalid code is entered, the LED flashes 6 times and then lights up permanently again. In this case, repeat entering the code (Step 3).
- If no button is pressed for 35 seconds in Setup mode, the LED flashes 6 times and goes out. The remote control exits Setup mode without changing the previous settings.
- Setup mode can be ended at any time by pressing the Setup button.

Control of different devices

With this remote control you can control not only TV sets but also STB devices (Set Top Boxes – e.g. SAT receivers). In the factory setting, the remote control is preset to control TV sets. To toggle between the various devices, proceed as follows:

1. Briefly press the Setup button. The LED flashes once.
2. The remote control is now in control mode for STB devices. Each time the button is pressed, the LED flashes once.

Return to TV mode:

1. Briefly press the Setup button. The LED flashes 2x.
2. The remote control is now in control mode for TV devices. Each time the button is pressed, the LED flashes once.

Learning function

This remote control is equipped with a learning function. This allows you to transfer functions from your original remote control to this universal remote control.

Before you start the learning function

- Make sure that all batteries used in both remote controls are in perfect condition. Change them if necessary.
- Place your original remote control and the universal remote control next to each other so that the infrared diodes of the remote controls are directly opposite each other.
- If necessary, correct the height of both remote controls to achieve optimal alignment.
- The distance between the two remote controls should be approx. 3 cm.

Nano

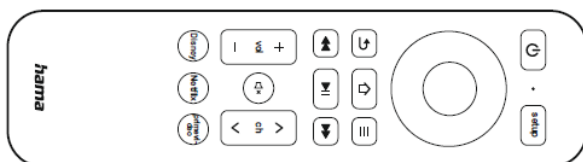

ORIGINAL

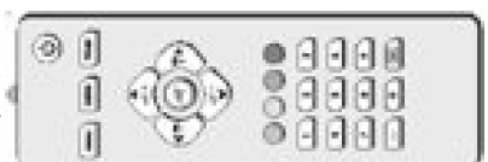

ca. 3 cm

Note

- Do not move the remote controls during the learning process.
- Make sure that the room lighting is not fluorescent tubes or energy-saving lamps, as these could cause interference and thus hinder the learning process.
- The distance between the two remote controls and the nearest light source should be at least 1 metre.
- In learning mode, each button can only be assigned one function. A new function overwrites the function previously taught on this button.
- Press the Setup button to end the learning function.
- Except for the Setup button, all button can be assigned a taught-in function.

Activating the learning function / transferring the button function

1. Press and hold the Setup button for approx. 3 seconds until the LED lights up to start Setup mode.
2. To teach a command in TV mode, enter the code 9 8 0 0 0 or 9 8 0 0 1 for STB mode.
3. Press the key of the NANO FB to which you want to teach a new function. The LED flashes 2x and then lights up permanently. If no button is pressed within 15 seconds, the LED flashes 6 times and the learning function is terminated.
4. Now press the button on the original remote control whose function you want to transfer.
If the LED goes out briefly and then lights up again permanently, the function has been successfully taught. If the LED flashes 6 times quickly, the transfer has failed. Check the position of the two remote controls and make sure the batteries are full. If no command is received within 35 seconds, the LED flashes 6 times and the learning function is terminated.
5. To teach more buttons, repeat steps 3 and 4.
6. After you have transferred all the desired functions, press the SETUP button to save all the taught-in functions and exit Learning mode.

Note

When changing the batteries of the universal remote control, the functions of the taught-in buttons are retained.

Deleting taught functions

Deleting a taught function

1. Press and hold the Setup button for approx. 3 seconds until the LED lights up permanently to start Setup mode.
2. Enter the code 98100 for TV mode or 98101 for STB mode. The LED flashes once.
3. Press the button of the NANO FB whose taught-in function is to be deleted.
4. The LED flashes once, the taught-in function is deleted and has been replaced by the function of the factory setting.
5. To delete more buttons, repeat step 3.
6. To exit the menu, press the Setup button.

Deleting all taught functions

1. Press and hold the Setup button for approx. 3 seconds until the LED lights up permanently to start Setup mode.
2. Enter the code 98200 to delete all taught-in buttons in TV mode or 98201 to delete all taught-in buttons in STB mode.
3. The LED flashes 2 x, all taught-in functions are deleted and are replaced by the functions of the factory setting.

Restoring factory settings

1. Press and hold the Setup button for approx. 3 seconds until the LED lights up permanently to start Setup mode.
2. Enter the number 99999.
3. All settings and taught-in functions are deleted and are replaced by the functions of the factory setting.

Switching illumination on/off

- Press the Power and Mute buttons simultaneously.
- If the LED flashes green once, the illumination of the remote control is switched on.
- If the LED flashes red once, the illumination is switched off.
- When the illumination is switched on, it goes out each time the button is pressed and lights up again for approx. 3 seconds as soon as the button is released.

Maintenance

- Never use old and new batteries in the universal remote control at the same time, as old batteries tend to leak and can lead to a loss of performance.
- Never clean the universal remote control with scouring agents or harsh cleaning agents.
- Keep the universal remote control free of dust by cleaning it with a dry soft cloth.

Troubleshooting

Q. My universal remote control does not work!

- A. Check the AV device. If the main switch on the device is off, the universal remote control cannot operate the device.
- A. Check that the batteries are inserted correctly and that the polarity has been observed.
- A. Check that you have pressed the appropriate device button for the device.
- A. Replace the batteries if the battery level is low.

Q. If there are multiple device codes listed for the brand of my AV device, how do I select the correct device code?

- A. To determine the correct device code for the AV device, test the codes one after the other until most of the buttons work properly.

Q. My AV device only responds to some button commands.

- A. Try other codes until most of the buttons work properly.

Q. The brand of my AV device is not mentioned in the code list.

- A. In this case, use the code search for all brands (Section 5.1)

Q. I have tried all the available codes for the brand of my AV device from the code list, but none of the codes mentioned work.

A. In this case, use the code search for all brands (Section 5.1)

Warranty disclaimer

Hama GmbH & Co KG assumes no liability and provides no warranty for damage resulting from improper installation/mounting, improper use of the product or from failure to observe the operating instructions and/or safety notes.

Documents / Resources

	<p>hama 00040070 Nano Streaming Remote Control [pdf] Instruction Manual 00040070, Nano Streaming Remote Control, Remote Control, Nano Streaming Remote, Remote, Nano Remote</p>
---	---

References

- [hama.com](#)