



[Home](#) » [HALO](#) » **HALO 2A01 Position Sensor User Manual** 

Contents [[hide](#)]

- [1 HALO 2A01 Position Sensor](#)
- [2 Product introduction](#)
- [3 Operation](#)
- [4 Indicator](#)
- [5 Customer service](#)
- [6 Warranty card](#)
- [7 FCC Statement](#)
- [8 Frequently Asked Questions](#)
- [9 Documents / Resources](#)
 - [9.1 References](#)



HALO 2A01 Position Sensor



Warning

- Please keep the device from high temperatures.
- When smoke, smell or noise comes out from the device, shut down the power immediately, and contact your supplier in time.
- Please contact your supplier if the device is not working properly. No warranty will be covered if the damage caused by unauthorized disassembly or repair.
- Please do NOT charge the device at high temperature over 45 degrees Celsius, it could possibly cause the explosion of battery. Please use the certified battery from the original factory ONLY.
- Please read this manual carefully before using the device, and follow the instructions when using the device.
- Please do NOT kick or hit the product to avoid device damage and data missing.
- Keep the device away from high temperatures and high-humidity environments.
- Keep the device away from strong interference source.

Product introduction

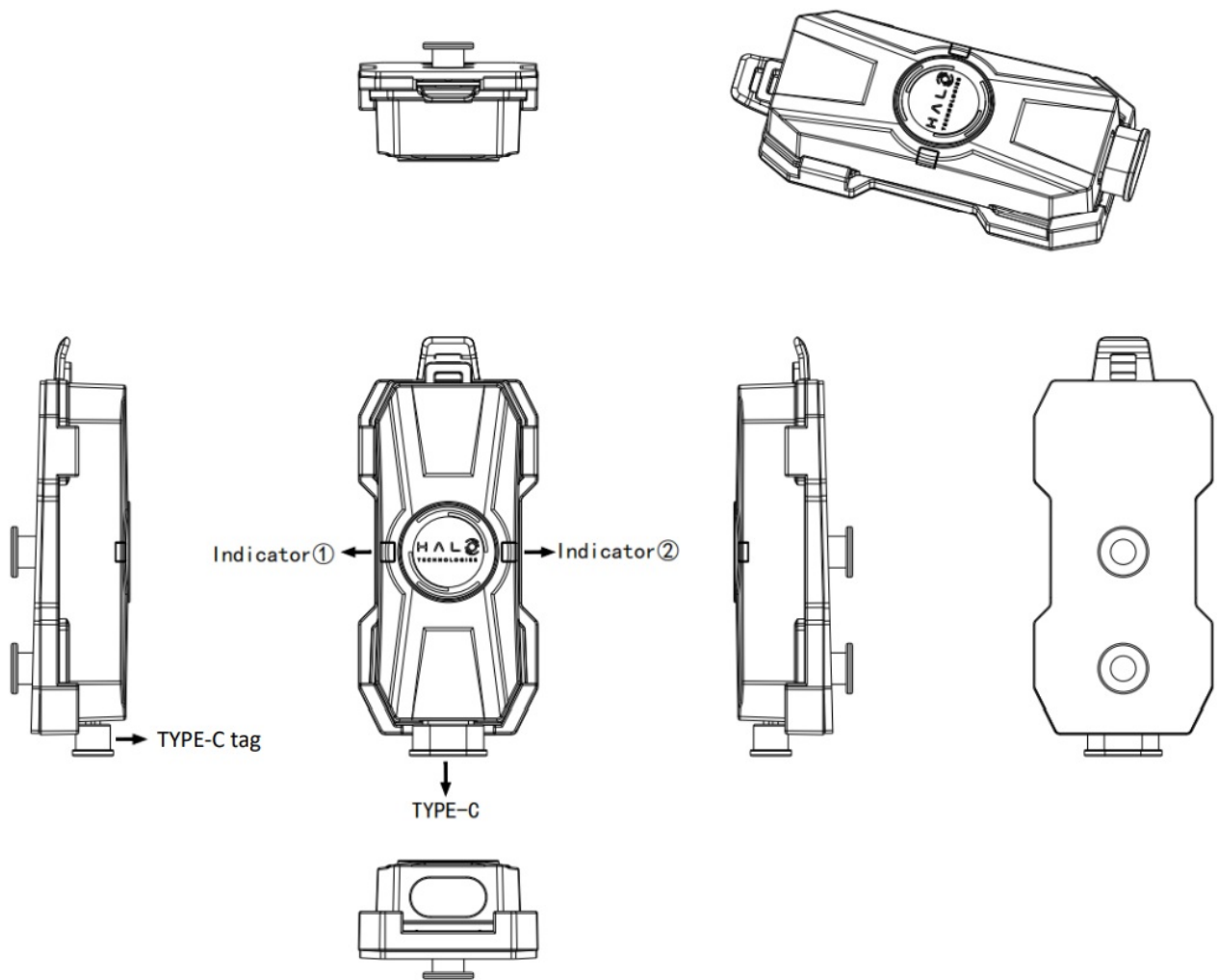

Operation

Power ON/OFF

- Power ON: Remove the Type-c tag and the indicator① shows the red light once then start to flash green/red light.
- Power OFF: Connect the Type-C tag to power off the sensor. Automatically pairing to any HALO Horizon BodyCam within a 30 feet radius. The HALO Aware device activates all connected HALO Horizon Body Cameras within a 30 feet radius into record mode;

Indicator

	Colour	LED status	Description
LED Indicat or①	Green	Flashing	Battery power sufficient

	Red	Flashing	Battery low
LED Indicator②	Red	Solid	Battery charging complete
		Flashing	Battery charging

Customer service

User Notice

A. Warranty

1. This product is warranted for one year;
2. Warranty are not covered in any case of unauthorized modification, repair or damage (such as water, moisture, drop, improper use, etc.)
3. In order to extend the life of the battery, it is recommended to charge once every three months when devices are not used for a long time.

B. Technical support service

If you have any operation or technology problems when you are using product, you can refer to the user manual to find solutions. If that still can't help, try the ways below to find help:

1. Contact your supplier for technical support
2. Regardless of the method of seeking technical services, please be sure to provide the model number, device ID and detailed malfunction of the failed unit, so that our engineers can be more quickly and accurately to help or repair.

C. Precautions before maintenance

1. Do simple troubleshooting before you send device back, if that still can't help you solve problems, please confirm the basic information of the product and

contact the supplier for repair.

2. If the product is out of warranty, make a preliminary quotation for the product repair, and we will provide repair service after receiving your consent.

Note: The service mentioned in this warranty is a standard service. If you have an extra agreement with the company on the service at the time of purchase, the extra service agreement signed will prevail.

Warranty card

User Profile

Name		Company	
Telephone No.		Address	
Dev. Model		Device ID	
Data of sale		Sales Department	
Repair Date	Repair Record	Repair Department	

FCC Statement

FCC WARNING

This device complies with part 15 of the FCC Rules. Operation is subject to the following two conditions:

1. this device may not cause harmful interference, and
2. this device must accept any interference received, including interference that may cause undesired operation.

Any changes or modifications not expressly approved by the party responsible for compliance could void the user's authority to operate the equipment.

NOTE: This equipment has been tested and found to comply with the limits for a Class B digital device, pursuant to Part 15 of the FCC Rules. These limits are designed to provide reasonable protection against harmful interference in a residential installation. This equipment generates, uses and can radiate radio frequency energy and, if not installed and used in accordance with the instructions, may cause harmful interference to radio communications.

However, there is no guarantee that interference will not occur in a particular installation. If this equipment does cause harmful interference to radio or television reception, which can be determined by turning the equipment off and on, the user is encouraged to try to correct the interference by one or more of the following measures:

- Reorient or relocate the receiving antenna.
- Increase the separation between the equipment and receiver.
- Connect the equipment into an outlet on a circuit different from that to which the receiver is connected.
- Consult the dealer or an experienced radio/TV technician for help.

Specific Absorption Rate (SAR) information:

This device meets the government's requirements for exposure to radio waves. The guidelines are based on standards that were developed by independent scientific organizations through periodic and thorough evaluation of scientific studies. The standards include a substantial safety margin designed to assure the safety of all persons regardless of age or health. FCC RF Exposure Information and Statement The SAR limit of USA (FCC) is 1.6 W/kg averaged over one gram of tissue. Device types: Smart phone (FCC ID: 2A9JS-2A01) has also been tested against this SAR limit. This device was tested for

typical body-worn operations with the back of the device kept 0mm from the body. To maintain compliance with FCC RF exposure requirements, use accessories that maintain a 0mm separation distance between the user's body and the back of the phone. The use of belt clips, holsters and similar accessories should not contain metallic components in its assembly. The use of accessories that do not satisfy these requirements may not comply with FCC RF exposure requirements and should be avoided.

ISED Statement

This device contains licence-exempt transmitter(s)/receiver(s) that comply with Innovation, Science and Economic Development Canada's licence-exempt RSS(s). Operation is subject to the following two conditions:

1. This device may not cause interference.
2. This device must accept any interference, including interference that may cause undesired operation of the device.

The digital apparatus complies with Canadian CAN ICES-3 (B)/NMB-3(B).

Specific Absorption Rate (SAR) information

This device meets the government's requirements for Canada radiation exposure limits set forth for an uncontrolled environment. This device was tested for typical body-worn operations with the back of the phone kept 0 mm from the body. To maintain compliance with ISED RF exposure requirements, use accessories that maintain an 0 mm separation distance between the user's body and the back of the Smart phone. The use of belt clips, holsters and similar accessories should not contain metallic components in its assembly. The use of accessories that do not satisfy these requirements may not comply with ISED RF exposure requirements and should be avoided. ISED RF Exposure Information and Statement The SAR limit of ISED is 1.6 W/kg averaged over one gram of tissue.

Frequently Asked Questions

- **Q: What should I do if the device is not functioning properly?**
 - A: If you encounter any issues with the device, please refer to the user manual for troubleshooting steps. If problems persist, contact your supplier for technical support.
- **Q: Can I use any battery with this device?**
 - A: It is recommended to use only certified batteries from the original factory to ensure optimal performance and safety.
- **Q: How often should I charge the device?**
 - A: It is advised to charge the device once every three months if it is not in use for an extended period to maintain battery life.

Documents / Resources

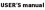
	HALO 2A01 Position Sensor [pdf] User Manual 2A01, 2A01 Position Sensor, Position Sensor, Sensor
---	--

References

- [User Manual](#)

 2A01, 2A01 Position Sensor, HALO, Position Sensor,
 HALO Sensor

Leave a comment

Your email address will not be published. Required fields are marked *

Comment *

Name

Email

Website

☐ Save my name, email, and website in this browser for the next time I comment.

Post Comment

Search:

e.g. whirlpool wrf535swhz

Search

[Manuals+](#) | [Upload](#) | [Deep Search](#) | [Privacy Policy](#) | [@manuals.plus](#) | [YouTube](#)

This website is an independent publication and is neither affiliated with nor endorsed by any of the trademark owners. The "Bluetooth®" word mark and logos are registered trademarks owned by Bluetooth SIG, Inc. The "Wi-Fi®" word mark and logos are registered trademarks owned by the Wi-Fi Alliance. Any use of these marks on this website does not imply any affiliation with or endorsement.