

HALCYON T444 Track 3 Circuit X Connector Instruction Manual

[Home](#) » [HALCYON](#) » HALCYON T444 Track 3 Circuit X Connector Instruction Manual 

Contents

- [1 HALCYON T444 Track 3 Circuit X Connector](#)
- [2 Product Information](#)
- [3 Product Usage Instructions](#)
- [4 INSTALLATION INSTRUCTION](#)
- [5 Documents / Resources](#)
- [6 Related Posts](#)

HALCYON

HALCYON T444 Track 3 Circuit X Connector

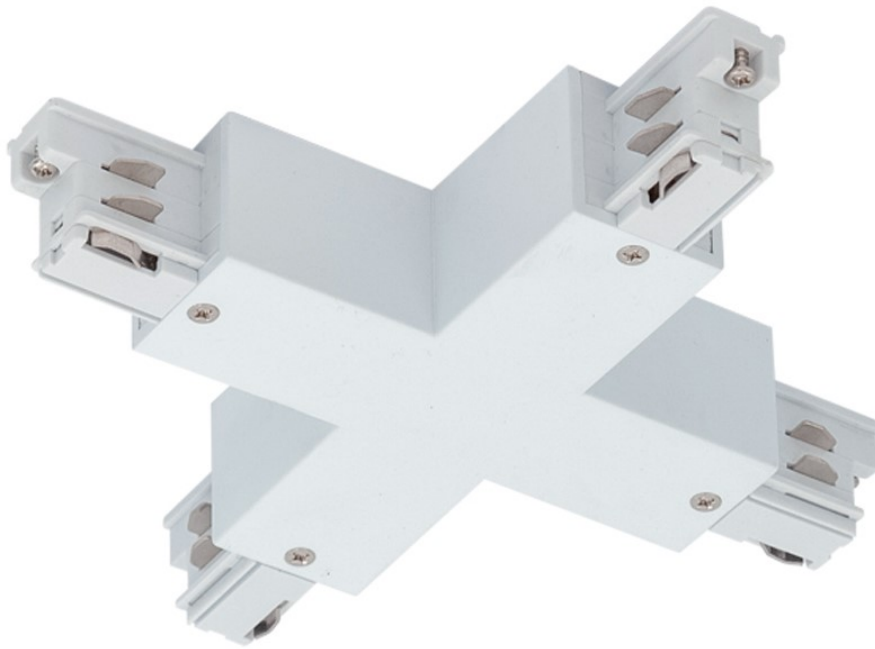

Product Information

- **Product Name:** T444
- **Usage:** For indoor use only
- **Dimensions:** 768MM (Figure 4)
- **Model Numbers & Lengths:**
 - T410(L=1000mm)
 - T420(L=2000mm)
 - T430(L=3000mm)
- **Maximum Load Capacity:** 30N
- **Version:** 1.0

Product Usage Instructions

1. Ensure that the product is for indoor use only.
2. Refer to Figure 1 to locate the ON/OFF switch and turn it ON.
3. Refer to Figure 4 for the dimensions of the product.
4. Refer to Figure 2 and Figure 3 for the model numbers and lengths of the product.
5. Ensure that the maximum load capacity of 30N is not exceeded.

INSTALLATION INSTRUCTION

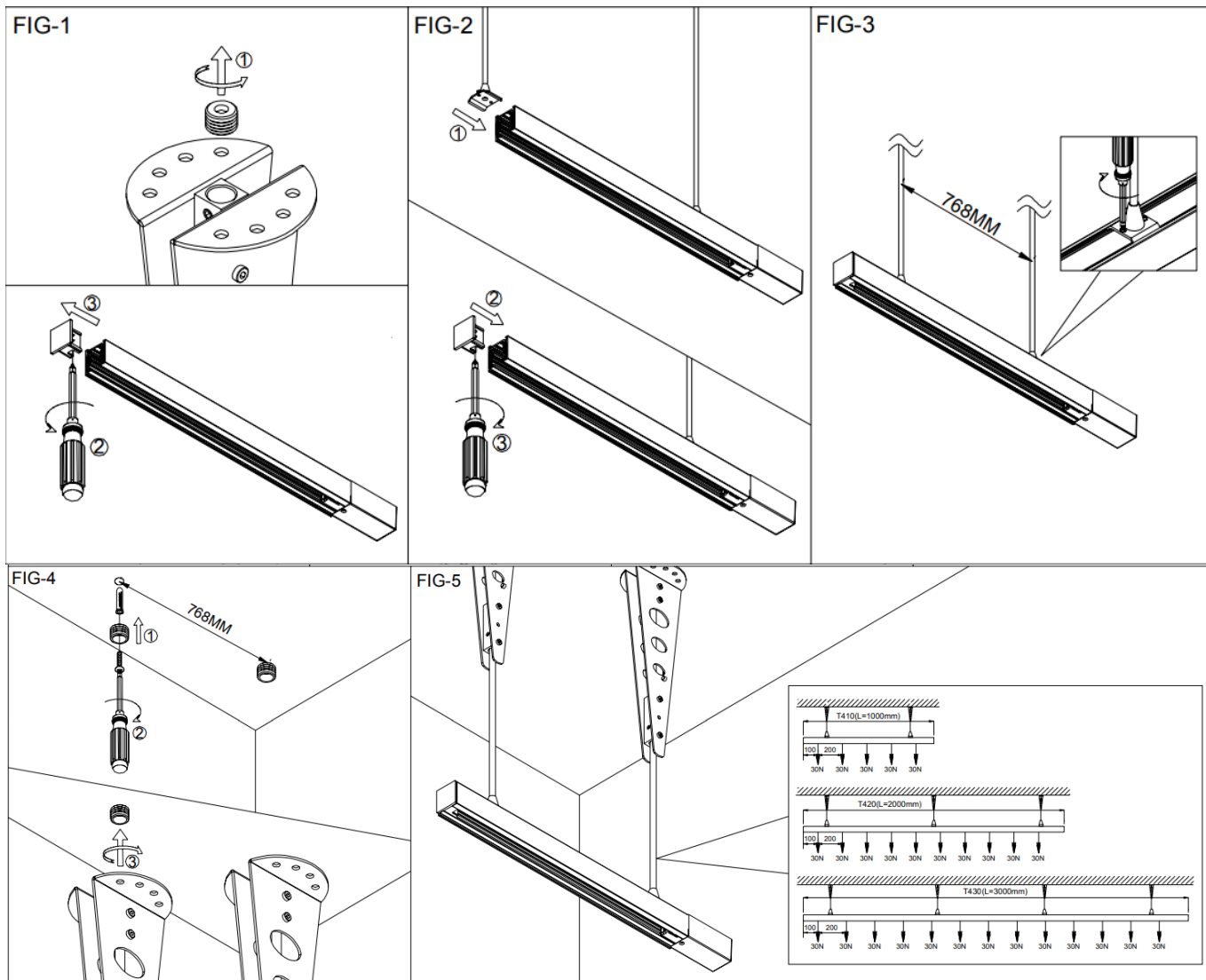

Documents / Resources

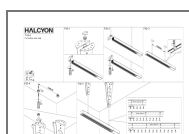

[HALCYON T444 Track 3 Circuit X Connector](#) [pdf] Instruction Manual
T444 Track 3 Circuit X Connector, T444, Track 3 Circuit X Connector, Circuit X Connector