



HALCYON S211 3 Circuit Track Instruction Manual

[Home](#) » [HALCYON](#) » HALCYON S211 3 Circuit Track Instruction Manual 

Contents

- [1 HALCYON S211 3 Circuit Track](#)
- [2 Product Information](#)
- [3 Product Usage Instructions](#)
- [4 SPECIFICATION](#)
- [5 POWER](#)
- [6 INSTALLATION INSTRUCTION](#)
- [7 Documents / Resources](#)
- [8 Related Posts](#)

HALCYON®

HALCYON S211 3 Circuit Track



Product Information

- The S211 Indoor Track Adaptor is designed for indoor use only and is suitable for use with Halcyon 3 Circuit track. It is important to perform testing to ensure compatibility prior to installation if retrofitting an alternative manufacturer track. The track adaptor should be correctly oriented when installing in the track to avoid damage.
- The plastic spot track adaptor has a raised linear lug that should fit on the opposite side of the 3 circuit track raised linear guide. This ensures that the luminaire sits flat and connects to the correct polarity and circuit.
- The S211 Indoor Track Adaptor has a circuit selector with three options (2-1, 2-2, 2-3) and a hot surface caution label.

Product Usage Instructions

1. Ensure that the track adaptor is compatible with your track system before installation.
2. When installing the track adaptor, ensure that it is oriented correctly to avoid damage.
3. Insert the track adaptor into the Halcyon 3 Circuit track.
4. Ensure that the raised linear lug on the plastic spot track adaptor fits on the opposite side of the 3 circuit track raised linear guide to ensure proper connection to the correct polarity and circuit.
5. Select the desired circuit by using the circuit selector switch located on the track adaptor. Choose from options 2-1, 2-2, or 2-3.
6. Turn the luminaire on by using the ON/OFF switch located on the circuit selector.
7. When unlocking or locking the circuit selector, take care as it may be hot to the touch. Refer to the hot surface caution label for guidance.

SPECIFICATION

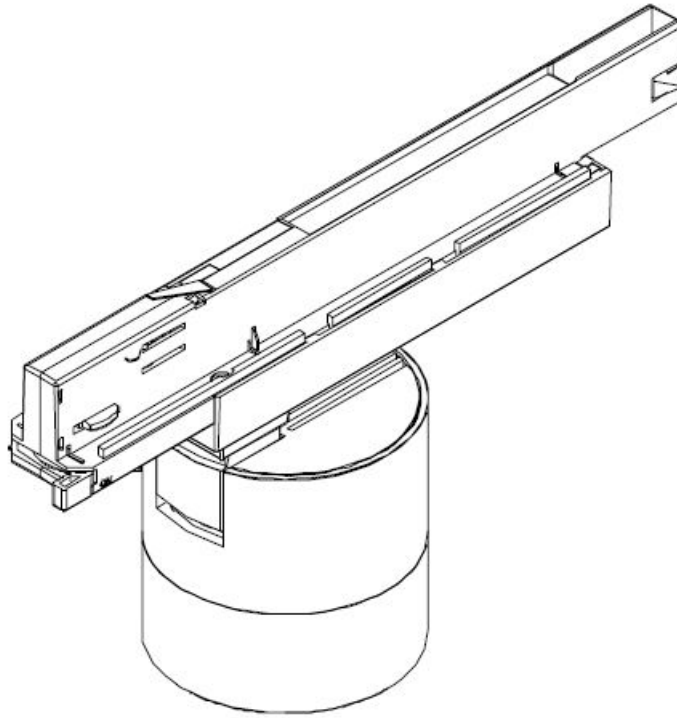

- For indoor use only.
- Suitable for Halcyon 3 Circuit track.
- Testing is recommended to ensure compatibility prior to installation if retrofitting alternative manufacturer track. Take care track adaptor is orientated correctly when installing in track to avoid damage.
- The raised linear lug on the plastic spot track adaptor should fit on the opposite side of the 3 circuit track raised linear guide to ensure the luminaire sits flat and connects to correct polarity and circuit.

POWER

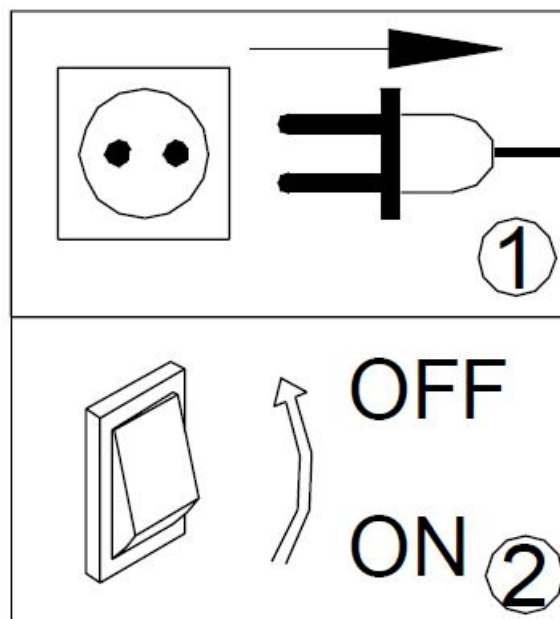

INSTALLATION INSTRUCTION

FIG-1

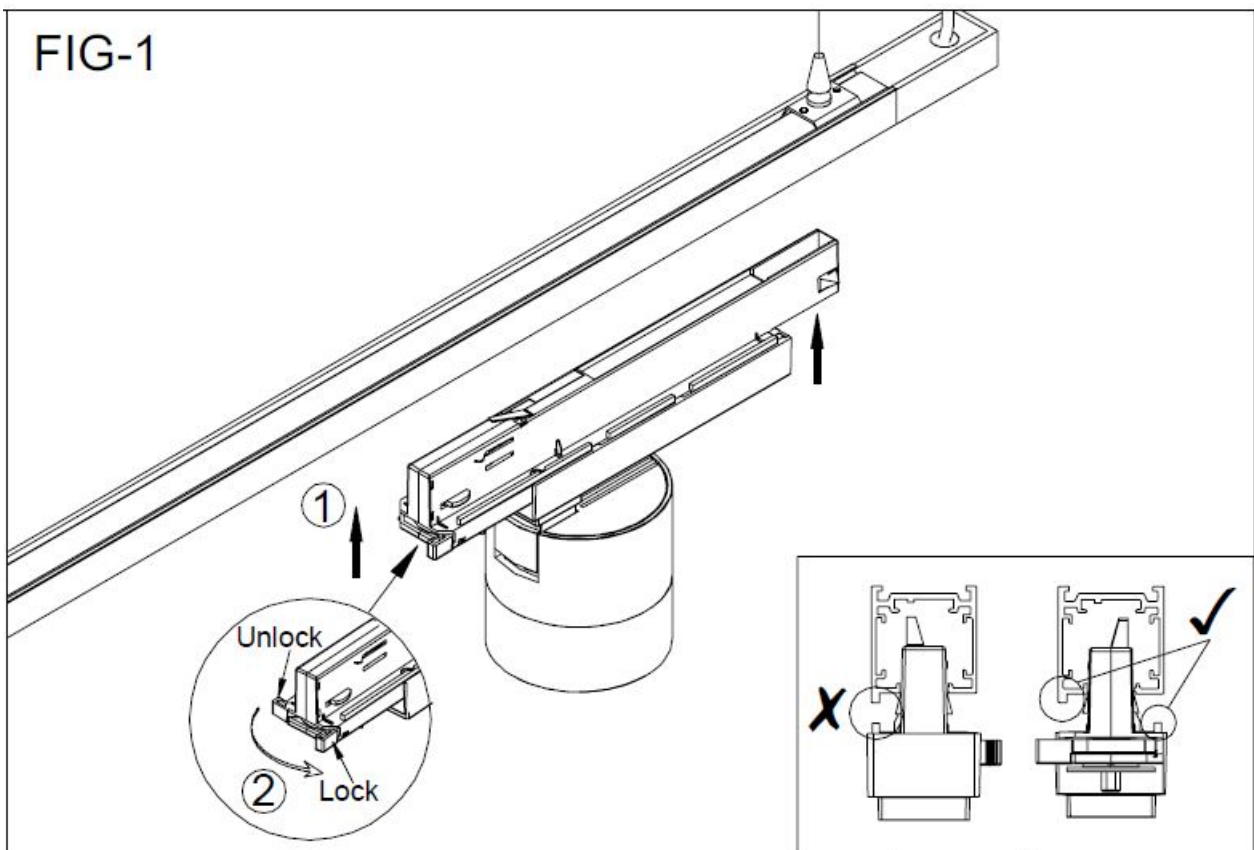

FIG-2 Selecting circuit

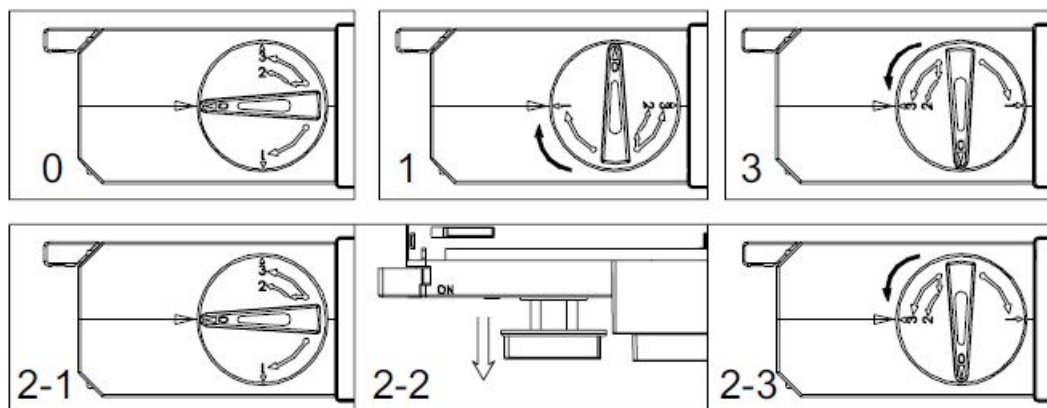
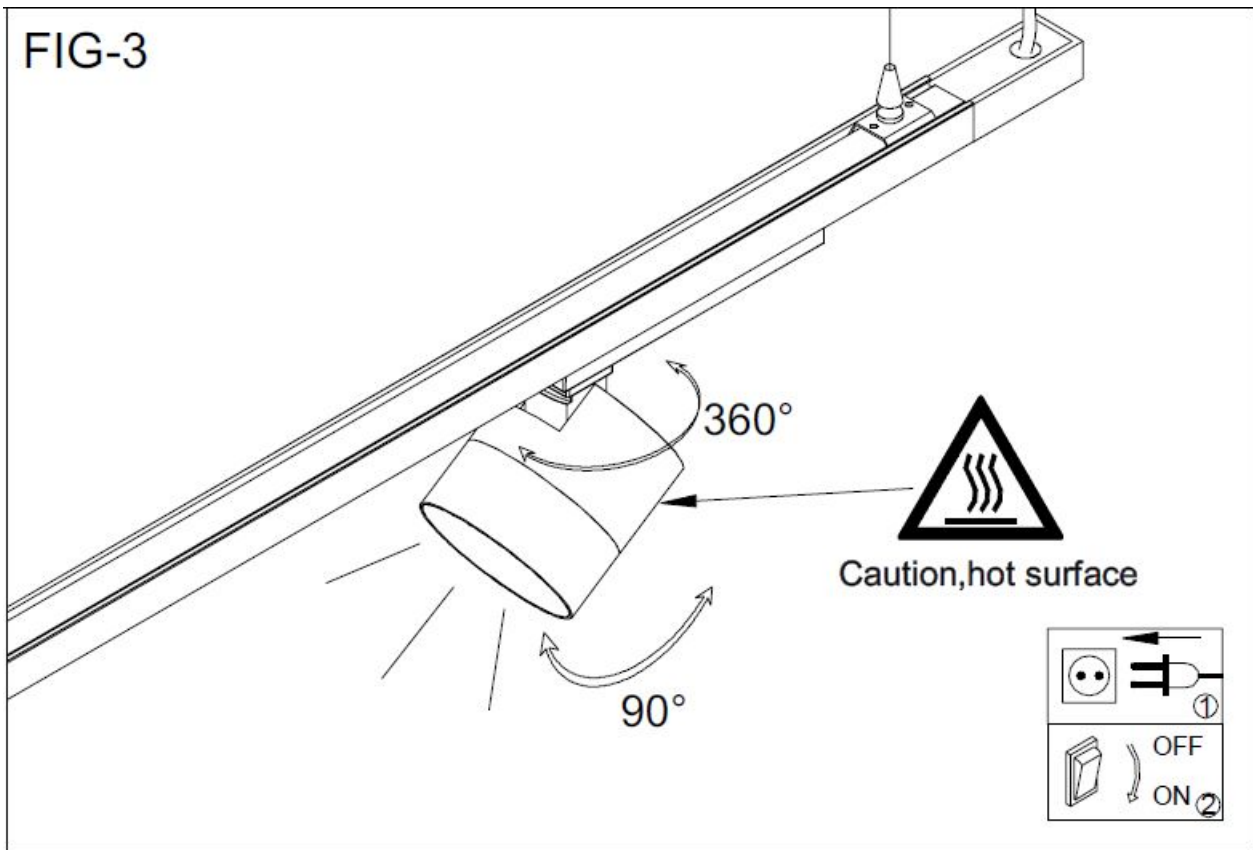
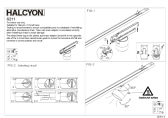

FIG-3



Documents / Resources



[HALCYON S211 3 Circuit Track](#) [pdf] Instruction Manual
S211 3 Circuit Track, S211, 3 Circuit Track, Track