



HALCYON R611 12w Retrospec Design Standard Installation Guide

[Home](#) » [HALCYON](#) » HALCYON R611 12w Retrospec Design Standard Installation Guide 

Contents

- [1 HALCYON R611 12w Retrospec Design Standard](#)
- [2 Installation Directions](#)
- [3 CLASSIFICATION SHEET](#)
- [4 Documents / Resources](#)
- [5 Related Posts](#)

HALCYON

HALCYON R611 12w Retrospec Design Standard



Installation Directions

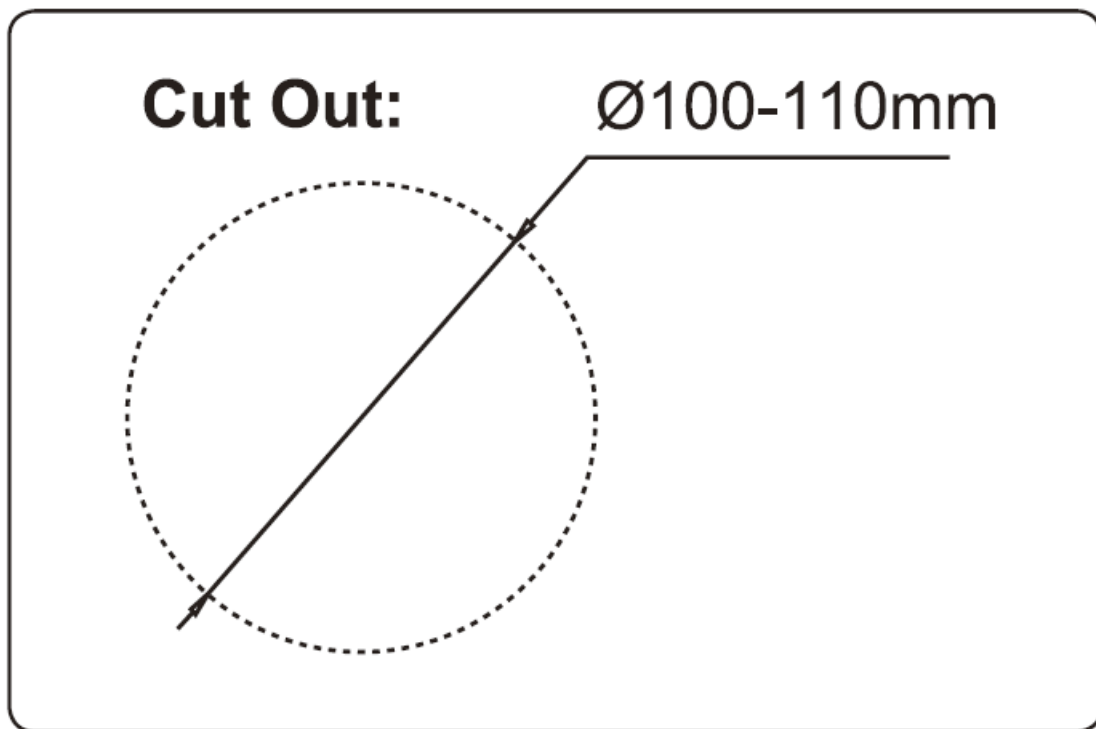

1. Switch off mains power supply
2. Connect Dimmable Driver to mains voltage cable (L, N) Do not connect downlight to driver if driver is live. Inrush current from live driver will cause instant downlight failure. Do not switch secondary side .
3. Carefully install downlight into Precut 100-110mm hole.
4. Turn on mains power and switch on lighting circuit.

Approved Clearances

Note: 0mm required but 25mm always recommended for optimum product lifespan through effective heat dissipation.

Example 1

0mm Approved Height Clearance. Building element abutting rear, insulation abutting sides of fitting.

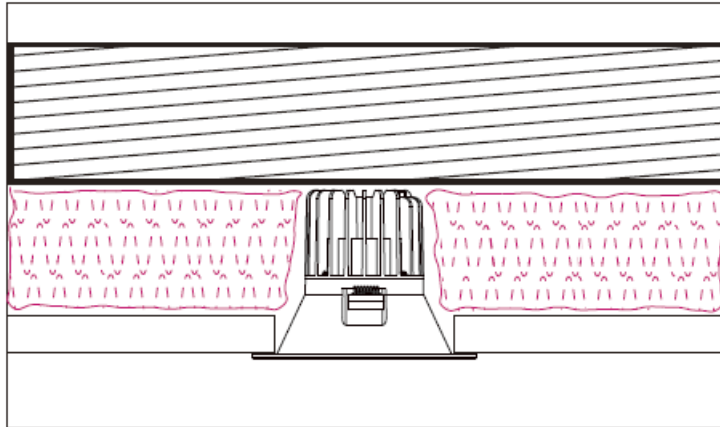

Example 2

0mm Approved Side Clearance. Building element abutting side of fitting, insulation abutting and covering fitting.

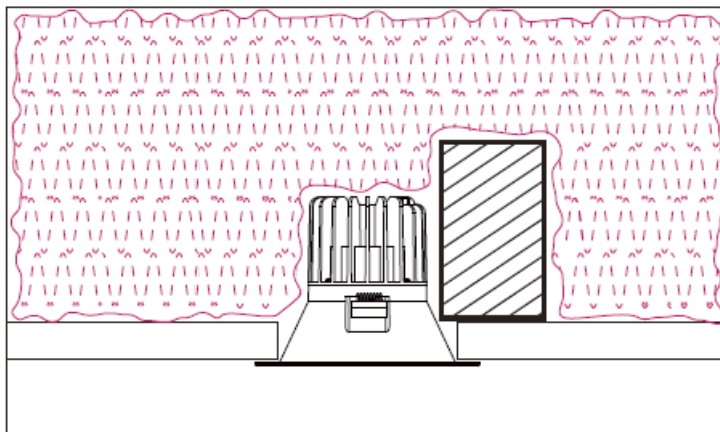

Driver is designed to be covered and abutted with IC / IC-F / IC-4 approved insulation.

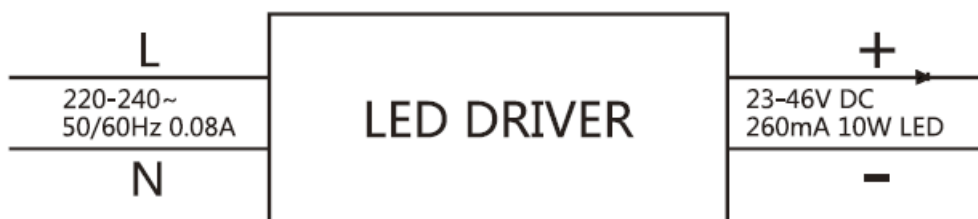

Cutting of holes prior to receiving goods is entirely at the risk of the installer

10 Basalt Place, East Tamaki, Auckland, PO Box 58-501, Botany, Manukau 2163, Auckland, New Zealand Ph (0064 9) 273-9177 Fax (0064 9) 273 9155 Email: sales@halcyon.co.nz Web: www.halcyonlights.co.nz

CLASSIFICATION SHEET

- **Manufacturer/ Supplier:** Halcyon Lighting Ltd
- **Product Code:** R611 W3K / R611 83K

- **Product Type:** LED Recessed Luminaire
- **Primary Voltage:** 220-240V~50/60Hz
- **Secondary Voltage:** 260mA 36VDC Constant Current
- **Wattage:** 12W
- **Ingress Protection Rating:** IP54

Classification



- **IC-F** – building insulation that can safely be continuously exposed to 90°C allowed to abut and cover the luminaire.

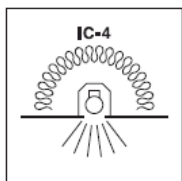

- **IC-4** – building insulation that can safely be continuously exposed to 90°C allowed to abut and cover the luminaire.

In the vicinity of the recessed luminaire, use an insulation product that:

- Maintains its dimensions and structural integrity when exposed to a temperature of 90°C; and
- Withstands a 30-second needle flame test carried out in accordance with AS/NZS 60695.11.5 with the flame applied to all surfaces of the sample.

Rear of fitting may abut structural members and building elements. Do not install through or directly into joist, beam, rafter or ceiling batten.

Side Clearance from heatsink to building element (e.g. timber, joist or batten)	SCB: 0mm
Height Clearance from heatsink to building element (e.g. timber, joist or batten)	HCB: 0mm
Minimum insulation clearance to building element	MIC: 0mm

Recessed luminaires and their associated equipment may pose a risk of fire or damage to property if not installed and maintained correctly. Halcyon recommends a clearance of 25mm to building elements for optimum lifespan.

Halcyon IC-F rated luminaires are completely safe to install in sarked timber ceiling linings.

Halcyon accepts no responsibility if the timber used is not treated correctly and dries out, crack or warps over time due to the constant low heat from the aforementioned “IC-F Rated” LED recessed lighting.

This data sheet contains information necessary to ensure compliance with the New Zealand Electrical Code of Practice for Installation and Maintenance of Recessed Luminaires and Associated Equipment AS/NZS 60598.2.2:2001

Documents / Resources

INSTALLATION
GUIDE

HALCYON



Installation Instructions
1. Remove the mounting bracket from the back of the fixture.
2. Insert the mounting bracket into the hole in the ceiling.
3. Tighten the screws to secure the fixture.
4. Connect the wires to the wiring terminal block.
5. Turn on the power and test the fixture.



Mounting Instructions
1. Mark the location for the fixture on the ceiling.
2. Drill a hole in the ceiling for the mounting bracket.
3. Insert the mounting bracket into the hole.



Wiring Instructions
1. Turn off the power to the fixture.
2. Connect the wires to the wiring terminal block.
3. Turn on the power and test the fixture.



Testing Instructions
1. Turn on the power to the fixture.
2. Test the fixture to ensure it is working properly.

HALCYON R611 12w Retrospec Design Standard [pdf] Installation Guide

R611 12w Retrospec Design Standard, R611, 12w Retrospec Design Standard, Design Standard

Manuals+.com