



# hakeI HLSA6 Module Instruction Manual

[Home](#) » [hakeI](#) » hakeI HLSA6 Module Instruction Manual 

## Contents

- 1 hakeI HLSA6 Module
- 2 INSTALLATION
- 3 REMOTE MONITORING
- 4 CONNECTION COMBINATION
- 5 BACK-UP FUSE
- APPLICATION
- 6 TECHNICAL DATA
- 7 CROSS-SECTION
- 8 WIRING DIAGRAM
- 9 Safety instructions
- 10 Documents / Resources
  - 10.1 References
- 11 Related Posts

# hakeI®

**hakeI HLSA6 Module**



## INSTALLATION

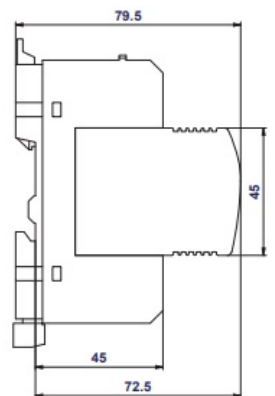
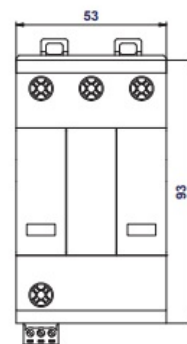
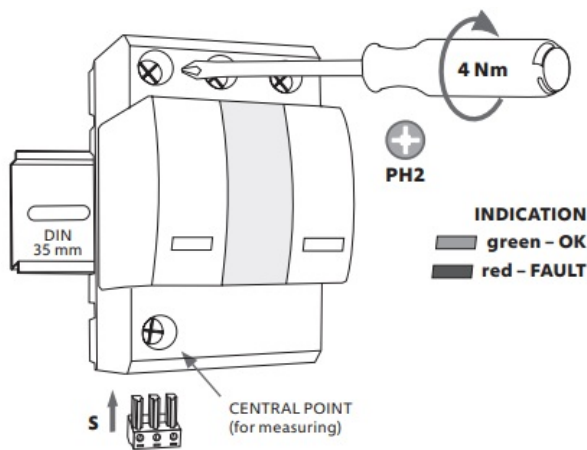

## REMOTE MONITORING

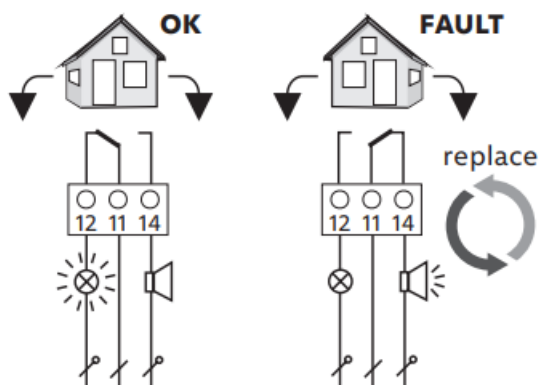

AC: 250 V / 1,5 A

DC: 250 V / 0,1 A

125 V / 0,2 A

75 V / 0,5 A

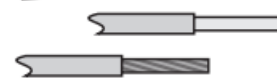

max. 1 mm<sup>2</sup>

## CONNECTION COMBINATION

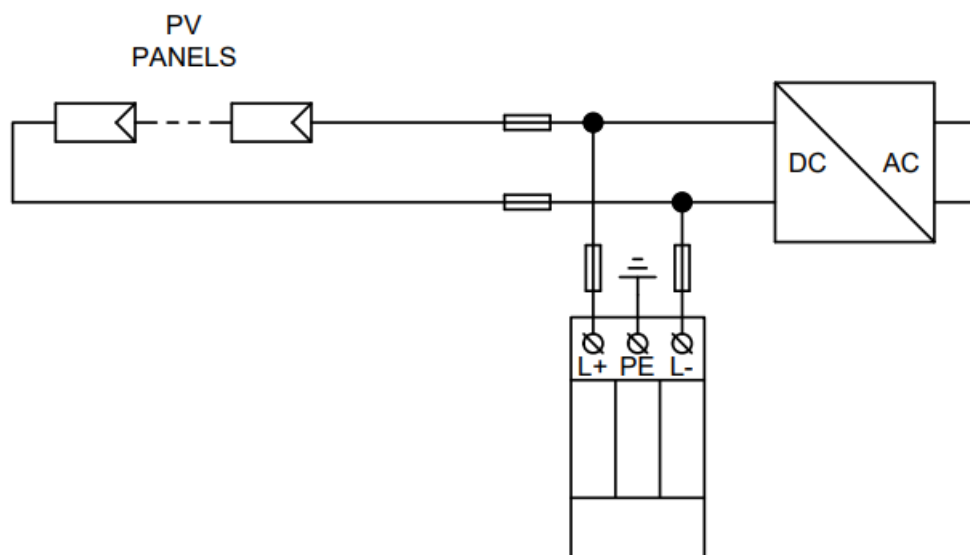

## BACK-UP FUSE APPLICATION



$F1 \leq 160 \text{ A gPV} \rightarrow F2$   
 $F1 > 160 \text{ A gPV} \rightarrow F2 = 160 \text{ A gPV}$

## TEST



Use **GIGATEST PRO** Art. No. 70 002

## TECHNICAL DATA

$I_{\text{Total}}$	12,5 kA (10/350)
$I_{\text{Total}}$	40 kA (8/20)
$I_{\text{imp}}$	6,5 kA (10/350)
$I_n$	20 kA (8/20)
$I_{\text{SCPV}}$	10 kA

Type	1+2
Class	I+II
IP	20
$\vartheta$	-40 ÷ +70 °C

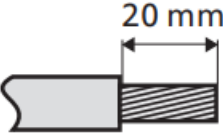
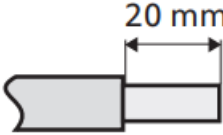
## CROSS-SECTION

		
<b>Clamping range</b>	2,5 ÷ 25 mm <sup>2</sup>	2,5 ÷ 35 mm <sup>2</sup>
<b>min. □</b>	<b>IEC 61643-32:2017</b> <b>ČSN CLC/TS 50539-12</b>	
 □	16 mm <sup>2</sup> Cu  ≥ 15,5 mm	

## WIRING DIAGRAM

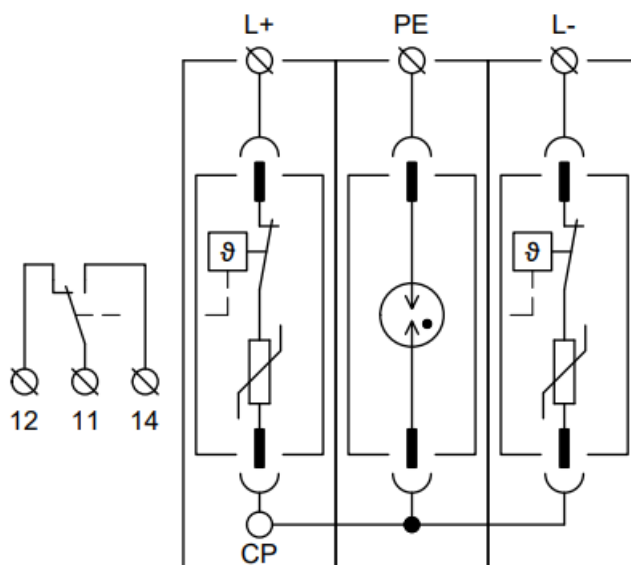

## Safety instructions

The product may only be connected and installed by an electrician. Before installation, the product must be checked for physical damage. If any defect or deficiency is found during this inspection, the product must not be installed. Its permissible use is described in the installation instructions. Follow the installation instructions carefully and connect according to the connection diagram provided. This product and its linked equipment may be damaged by loads which exceed a given value. Interference with the device leads to the loss of the right to claim.

POWER SUPPLY UP TO 1000 V  
SURGE ARRESTER

HLSA6,5 PV \* M (S)  
max. continuous operating voltage:  
UCPV = 600, 800, 1000 V DC S = remote monitoring (optional)

[www.hakel.com](http://www.hakel.com)



HAKEL spol. s r.o. Bratri Stefanu 980 500 03 Hradec Kralove Czech Republic

Phone: +420 494 942 300 [info@hakel.com](mailto:info@hakel.com)  
[www.hakel.com](http://www.hakel.com)

## Documents / Resources

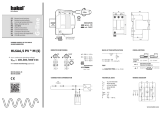
	<a href="#">hakel HLSA6 Module</a> [pdf] Instruction Manual HLSA6 Module, HLSA6, Module
---	--

## References

- [www.Hakel](#)

Manuals+.