

:hager

ADC932R
Residual Current
Operated Circuit
Breaker



hager ADC932R Residual Current Operated Circuit Breaker Owner's Manual

[Home](#) » [hager](#) » hager ADC932R Residual Current Operated Circuit Breaker Owner's Manual 

Contents

- [1 hager ADC932R Residual Current Operated Circuit Breaker](#)
- [2 Electrical connection](#)
- [3 Easy dismounting with the plastic DIN rail clip](#)
- [4 Locking device for handle MZN175](#)
- [5 Information](#)
- [6 FAQ](#)
- [7 Documents / Resources](#)
 - [7.1 References](#)
- [8 Related Posts](#)

:hager

hager ADC932R Residual Current Operated Circuit Breaker



Specifications

- Product Name: Residual current operated circuit-breaker RCBO with switched neutral
- Current Range: 6 to 32 A
- Electrical Connection: Top or bottom, bi-directional device
- Mounting: DIN rail mount & Invicta panel board (excluding UK market)

This device is to be installed only by a professional electrician fitter according to local applicable installation standards. Do not plug in or unplug this product when it is live.

Residual current operated circuit-breaker RCBO with switched neutral 6 to 32 A

Electrical connection

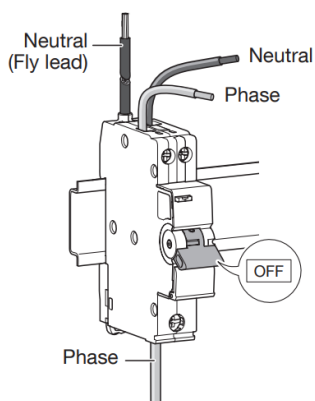

This device can be supplied either from the top or bottom without any alteration of its functions (bi-directional device).

230/240V~50Hz

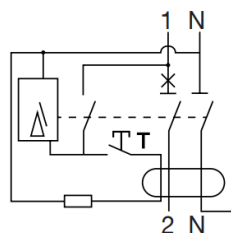

	BOTTOM	TOP
(mm ²)	1 to 16 2 x 10	1 to 16 2 x 6
	12 mm	10 mm
	⊕ PZ2	⊕ PZ2
	2,1 Nm	1,9 Nm

Easy dismounting with the plastic DIN rail clip

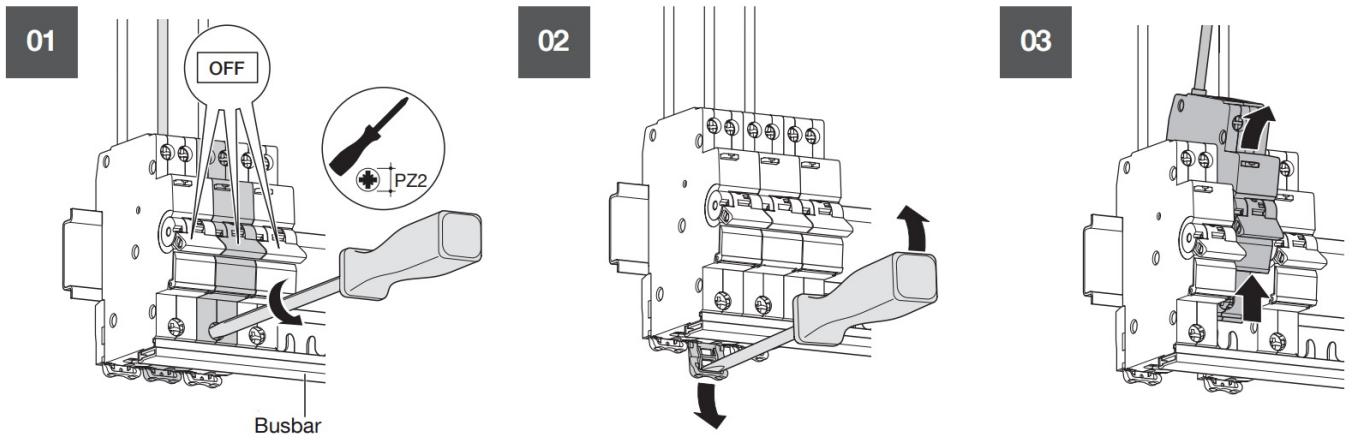

Locking device for handle MZN175

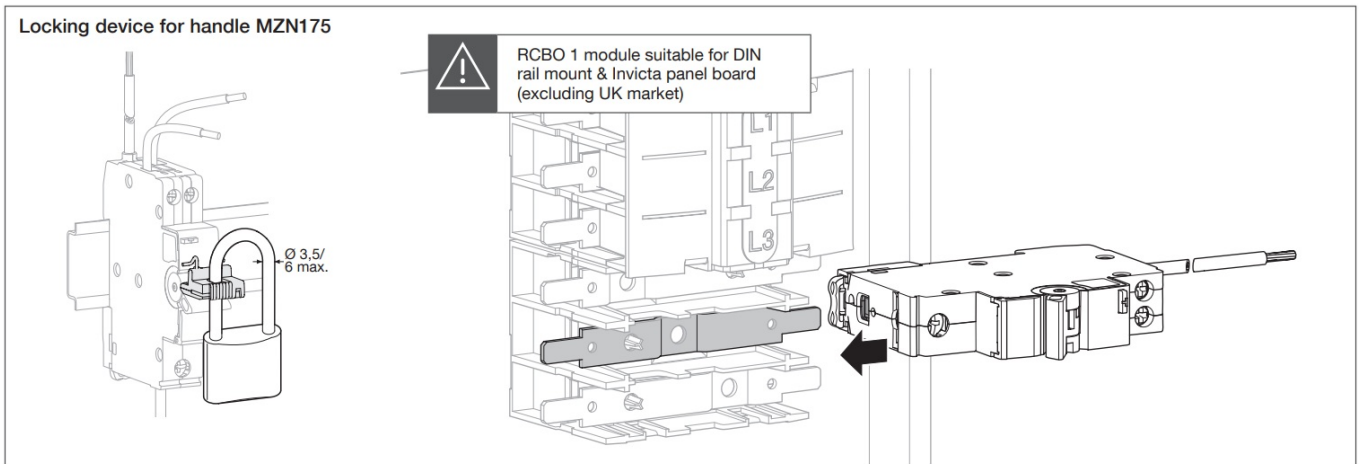

TEST

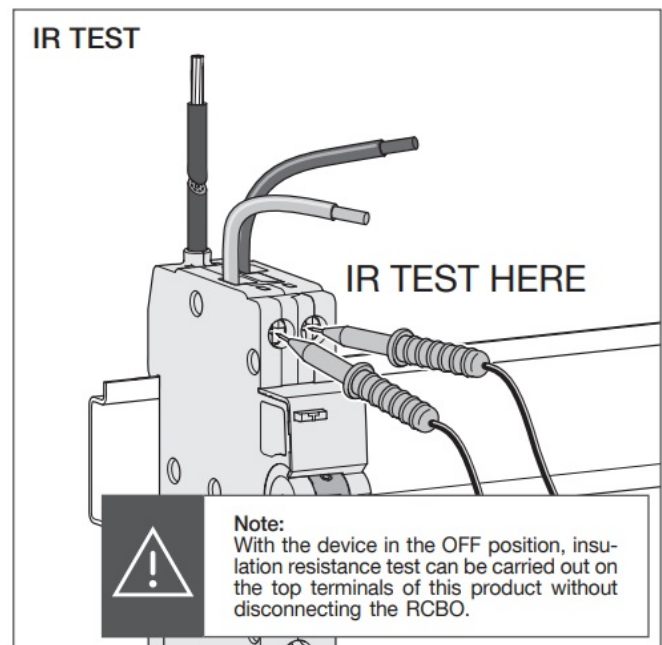
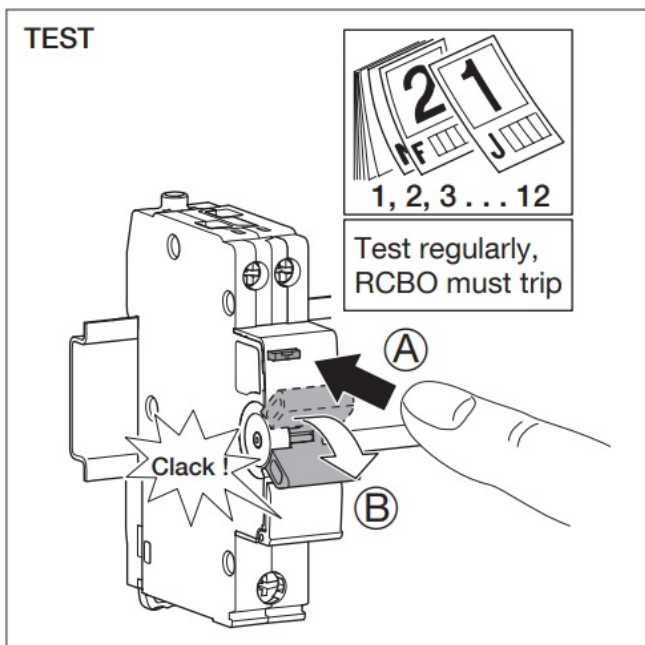

Information

EVCS Guidance notes ADC932R 32 A RCBO

- Where a ADC932R RCBO is used to supply a 7.5 Kwh car charger 10 mm² cable must be used from the RCBO

to the installed vehicle charge point.

- Can only be used in a 6 way or larger enclosure for this application.
- Guidance Notes for All 100 A Dual RCCB Flush Consumer Units
- ADC932R 32 A RCBO is not verified in any Flush 100 A Dual RCCB consumer units for the continuous loading of a 7.5 Kwh car charger and MUST not be used.

T +33 (0)3 88 49 50 50 info@hager.com
hager.com – 2023.11.27

FAQ

- **Q: Can this RCBO be used to supply power to a car charger?**

A: Yes, when supplying power to a 7.5 Kwh car charger, ensure to use a 10 mm² cable from the RCBO to the charge point. The RCBO must be installed in a 6-way or larger enclosure for this application.

- **Q: Can the RCBO be used in a Flush 100 A Dual RCCB consumer unit for a car charger?**

A: No, the ADC932R 32 A RCBO is not verified for use in Flush 100 A Dual RCCB consumer units for continuous loading of a 7.5 Kwh car charger and must not be used for this purpose.

Documents / Resources

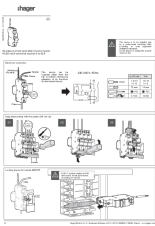
	hager ADC932R Residual Current Operated Circuit Breaker [pdf] Owner's Manual ADC932R, ADC932R Residual Current Operated Circuit Breaker, ADC932R, Residual Current Operated Circuit Breaker, Operated Circuit Breaker, Circuit Breaker, Breaker
---	--

References

-  [Hager worldwide](#)
- [User Manual](#)

[Manuals+](#), [Privacy Policy](#)

This website is an independent publication and is neither affiliated with nor endorsed by any of the trademark owners. The "Bluetooth®" word mark and logos are registered trademarks owned by Bluetooth SIG, Inc. The "Wi-Fi®" word mark and logos are registered trademarks owned by the Wi-Fi Alliance. Any use of these marks on this website does not imply any affiliation with or endorsement.