

**:hager**

ADC925R Residual  
Current Operated  
Circuit Breaker



# hager ADC925R Residual Current Operated Circuit Breaker Installation Guide

[Home](#) » [hager](#) » hager ADC925R Residual Current Operated Circuit Breaker Installation Guide 

## Contents

- [1 hager ADC925R Residual Current Operated Circuit Breaker](#)
- [2 Product Usage Instructions](#)
- [3 Electrical Connection](#)
- [4 Information](#)
- [5 FAQ](#)
- [6 Documents / Resources](#)
  - [6.1 References](#)
- [7 Related Posts](#)

**:hager**

**hager ADC925R Residual Current Operated Circuit Breaker**



### Specifications:

- Product: Residual current operated circuit-breaker RCBO with switched neutral
- Current Range: 6 to 32 A
- Electrical Connection: Top or bottom supply without alteration of functions
- Mounting: DIN rail mount & Invicta panel board (excluding UK market)

This device is to be installed only by a professional electrician fitter according to local applicable installation standards. Do not plug in or unplug this product when it is live.

### Product Usage Instructions

#### Installation:

This device is to be installed only by a professional electrician according to local applicable installation standards. Do not plug in or unplug this product when it is live.

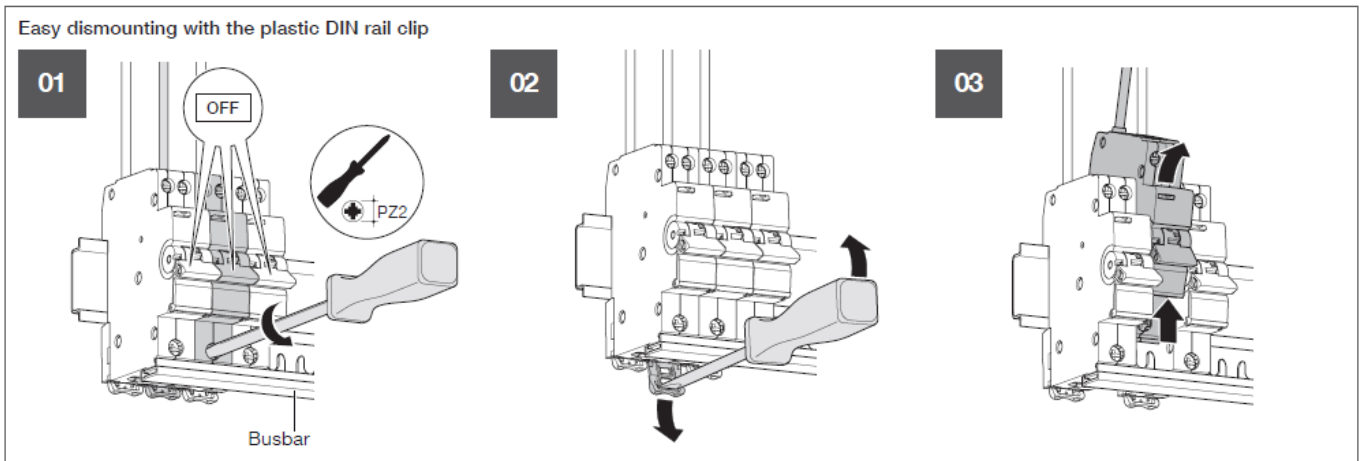

### Locking device for handle MZN175

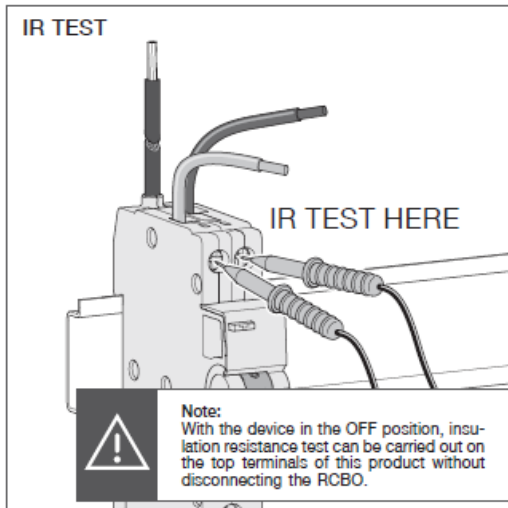
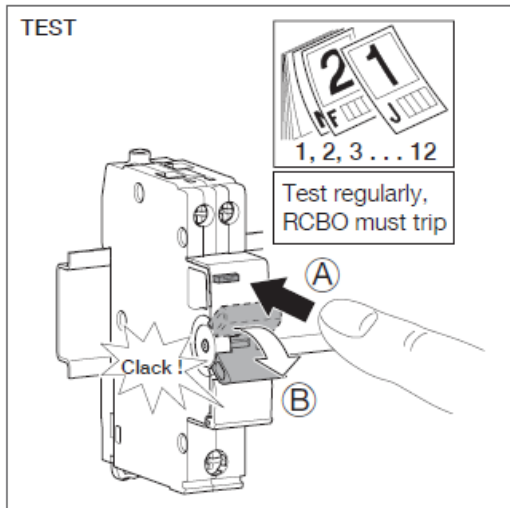
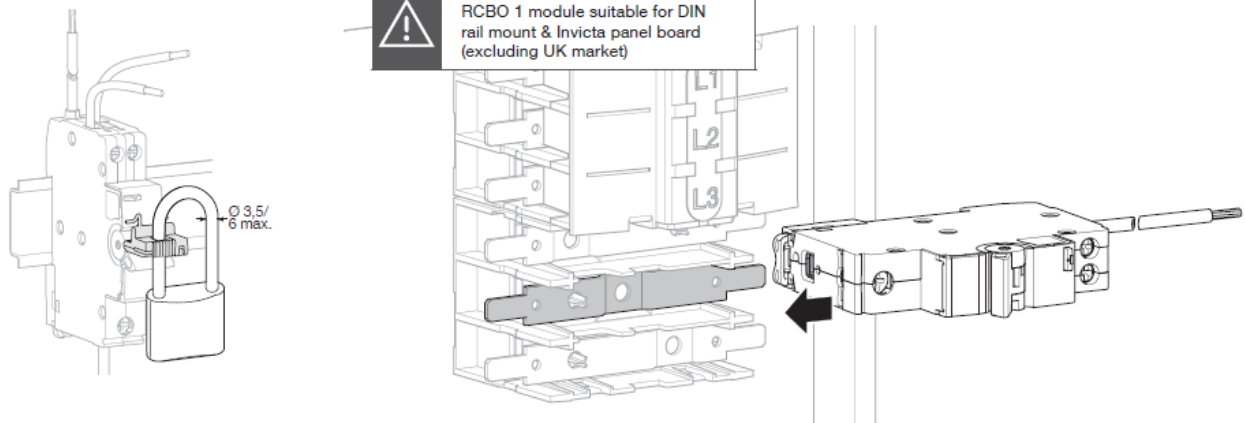

## Electrical Connection

The device can be supplied either from the top or bottom without any alteration of its functions, as it is a bidirectional device.

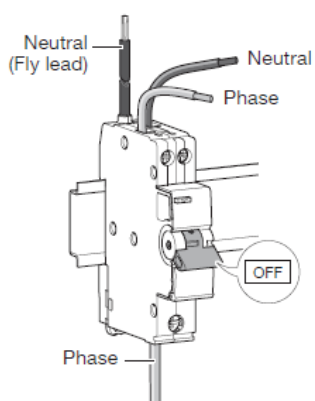

This device can be supplied either from the top or bottom without any alteration of its functions (bi-directional device).

230/240V~50Hz

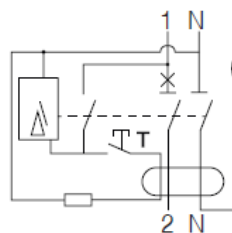

	BOTTOM	TOP
(mm <sup>2</sup> )	1 to 16 2 x 10	1 to 16 2 x 6
	12 mm	10 mm
	PZ2	PZ2
	2,1 Nm	1,9 Nm

### Dismounting:

Easy dismounting with the plastic DIN rail clip provided.

### Locking Device:

Use the locking device for the handle MZN175 for secure operation.

## Information

## EVCS Guidance notes

ADC932R 32 A RCBO Where a ADC932R RCBO is used to supply a 7.5 Kwh car charger 10 mm<sup>2</sup> cable must be used from the RCBO to the installed vehicle charge point. Can only be used in a 6 way or larger enclosure for this application.

## Guidance Notes for All 100 A Dual RCCB Flush Consumer Units

ADC932R 32 A RCBO is not verified in any Flush 100 A Dual RCCB consumer units for the continuous loading of a 7.5 Kwh car charger and MUST not be used.

## Contact Information:

Hager Electro S.A.S., Boulevard d'Europe, B.P. 3, 67215 OBERNAI CEDEX, France

- Website: [www.hager.com](http://www.hager.com)
- Email: [info@hager.com](mailto:info@hager.com)
- Phone: +33 (0)3 88 49 50 50

## FAQ

- **Q: Can I install this device myself?**

A: No, this device should only be installed by a professional electrician according to local standards.

- **Q: Can the RCBO be used with a car charger?**

A: Yes, follow the EVCS Guidance notes and use a suitable cable for the application.

## Documents / Resources

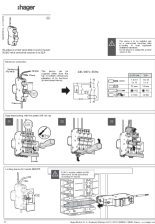
	<p><a href="#">hager ADC925R Residual Current Operated Circuit Breaker</a> [pdf] Installation Guide ADC925R Residual Current Operated Circuit Breaker, ADC925R, Residual Current Operated Circuit Breaker, Current Operated Circuit Breaker, Operated Circuit Breaker, Circuit Breaker</p>
---	--

## References

-  [Hager worldwide](#)
- [User Manual](#)

[Manuals+](#), [Privacy Policy](#)

This website is an independent publication and is neither affiliated with nor endorsed by any of the trademark owners. The "Bluetooth®" word mark and logos are registered trademarks owned by Bluetooth SIG, Inc. The "Wi-Fi®" word mark and logos are registered trademarks owned by the Wi-Fi Alliance. Any use of these marks on this website does not imply any affiliation with or endorsement.