

HACKMOTION

Sensor II Wrist Sensors



HACKMOTION Sensor II Wrist Sensors User Guide

[Home](#) » [HACKMOTION](#) » HACKMOTION Sensor II Wrist Sensors User Guide 

Contents

- [1 HACKMOTION Sensor II Wrist Sensors](#)
- [2 Specifications](#)
- [3 Product Usage Instructions](#)
- [4 FAQs](#)
- [5 General information](#)
- [6 Wearing the hand unit](#)
- [7 FCC](#)
- [8 Documents / Resources](#)
 - [8.1 References](#)
- [9 Related Posts](#)

HACKMOTION

HACKMOTION Sensor II Wrist Sensors



Specifications

- **Status Indicator:**
 - **pulsating glow** – the sensor is ready to connect
 - **steady glow** – the sensor is connected
 - **red** – charging, off when fully charged
 - **red blinking** – battery is very low
- **Power Button:**
 - Press once to switch the sensor on
 - Hold (3 seconds) to switch the sensor off
- **Battery Life:**
 - Up to 7 hours

Product Usage Instructions

- **Charging the Sensor:**
 - Connect the USB Type-C cable to the port on the sensor.
 - Connect the other end of the cable to a power source, such as a computer.
 - The status indicator will show a red light when charging and turn off when fully charged.
- **Powering On/Off:**
 - To turn on the sensor, press the power button once.
 - To turn off the sensor, hold the power button for 3 seconds.
- **Wearing the Hand Unit:**
 - Secure the hand unit with the palm strap or attach it to a glove Velcro using the clip (included with Golf models only).
 - The hand unit self-fixates when stretched horizontally.
 - Avoid using magnetic strap gloves with the sensor.

FAQs

- **Q: How can I check the battery level of the sensor?**
 - **A:** You can always check the battery level in the app provided with the sensor.
- **Q: What should I do if the sensor does not connect?**
 - **A:** Visit our support page for troubleshooting tips and contact support if needed.
- **Q: Can I charge the sensor with any USB-C cable?**
 - **A:** Yes, you can use any USB-C cable to charge the sensor from a compatible power source.

General information

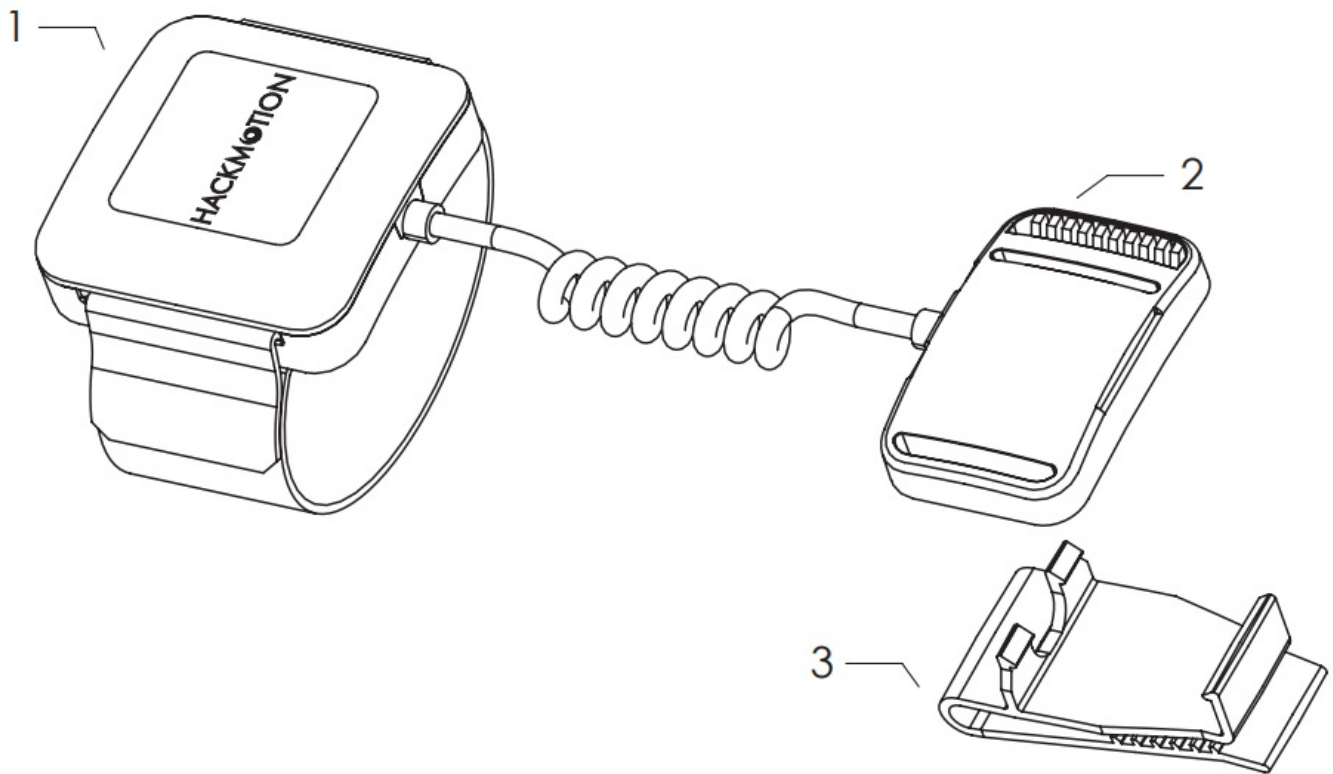

1. Hand unit
2. Wrist unit
3. Glove attachment (Golf models only)
4. USB Type-C port for charging the battery
5. Status indicator
 - **pulsating glow** – the sensor is ready to connect
 - **steady glow** – the sensor is connected
 - **red** – charging, off when fully charged
 - **red blinking** – battery is very low

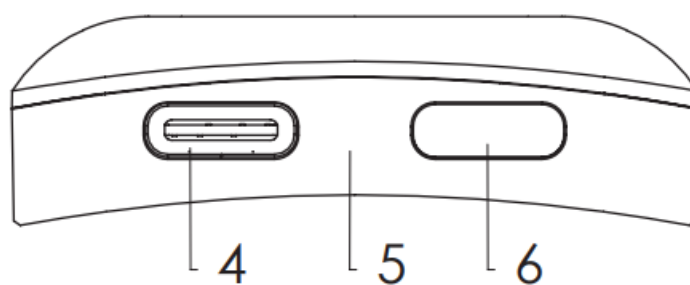

- **Important!** When fully charged, the red light will be off when the charging cable is connected. You can always check the battery level in the app.

6. Power Button

- Press once to switch the sensor on
- hold (3 seconds) to switch the sensor off
 - **Note:** The sensor has a 5-minute auto shutdown when not in use to preserve the battery.

7. Battery

- Lasts up to 7 hours. Use any USB-C cable to charge it from your computer.

Wearing the hand unit

- **A.** With the palm strap.

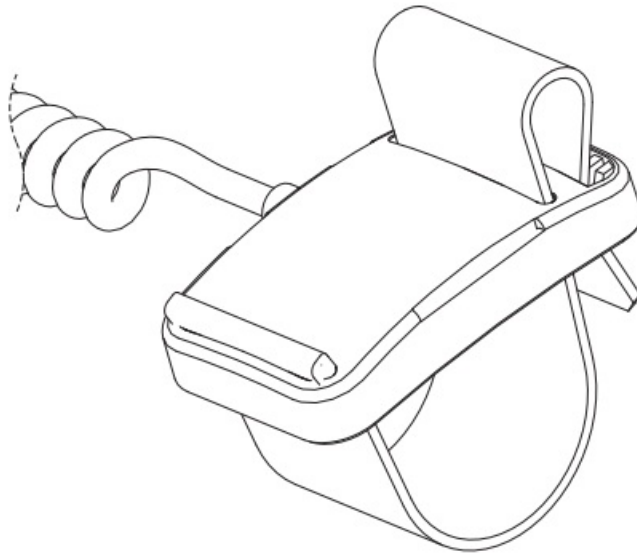

- **Important!** It self-fixates when stretched horizontally
- **B.** By attaching it to the glove Velcro with the clip (included only with the Golf sensor).

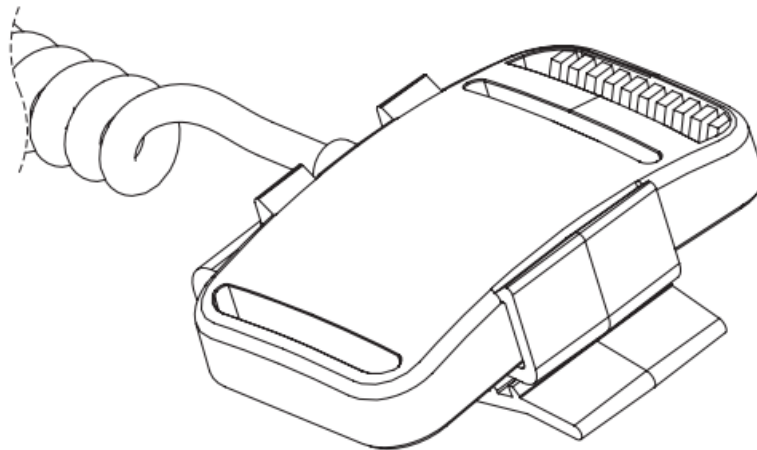

- **Important!** Do not use a sensor with magnetic strap gloves.

Visit our webpage for troubleshooting tips, how-to guides, and software download links:
hackmotion.com/support-page.



(Scan with your camera app)

FCC

This device complies with Part 15 of the FCC Results.

Operation is subject to the following two conditions:

1. This Device may not cause harmful interface, and
2. This Device must accept any interference received, including interference that may cause undesired operation.

Note: This equipment has been tested and found to comply with the limits for CLASS B digital devices, under Part 15 FCC Rules. These limits are designed to provide reasonable protection against harmful interference when the equipment is operated in a commercial environment. This equipment generates, uses, and can radiate radio frequency energy and, if not installed and used by the instructions, may cause harmful interference to radio communications. However, there is no guarantee that interference will not occur in a particular installation. If this equipment does cause harmful interference to radio or television reception, which can be determined by turning the equipment off and on, the user is encouraged to try correct the interference by one or more of the following measures;

- Reorient or relocate the receiving antenna.
- Increase the separation between the equipment and receiver.
- Connect the equipment to an outlet on a circuit different from that to which the receiver is connected.
- Consult the dealer or experienced radio/TV technician for help.

Warning: Changes or modifications not expressly approved by the manufacturer could void the user's authority to operate the equipment.

FCC SAR Compliance Statement

Your wireless wearable device is a radio transmitter and receiver. It is designed and manufactured not to exceed the emission limits for exposure to radio frequency (RF) energy set by the Federal Communications Commission of the U.S. Government. These limits are part of comprehensive guidelines and establish permitted levels of RF energy for the general population. The guidelines are based on safety standards previously set by both U.S. and international standards bodies:

- American National Standards Institute (ANSI) IEEE. C95.1-1992.
- National Council on Radiation Protection and Measurement (NCRP). Report 86.1986.
- International Commission on Non-Ionizing Radiation Protection (ICNIRP) 1996.
- Ministry of Health(Canada). Safety Code 6.

The standards include a substantial safety margin designed to assure the safety of all persons, regardless of age and health. The exposure standard for wireless wearable devices employs a unit of measurement known as the Specific Absorption Rate or SAR. The SAR limit set by the FCC is 1.6W/kg.

- **Detailed user manual:** hackmotion.com/support-page.
- **Support:** support@hackmotion.com.
- © 2023 HackMotion, Kronvalda bulvāris 4, Rīga, LV-1010, Latvia, European Union

Documents / Resources

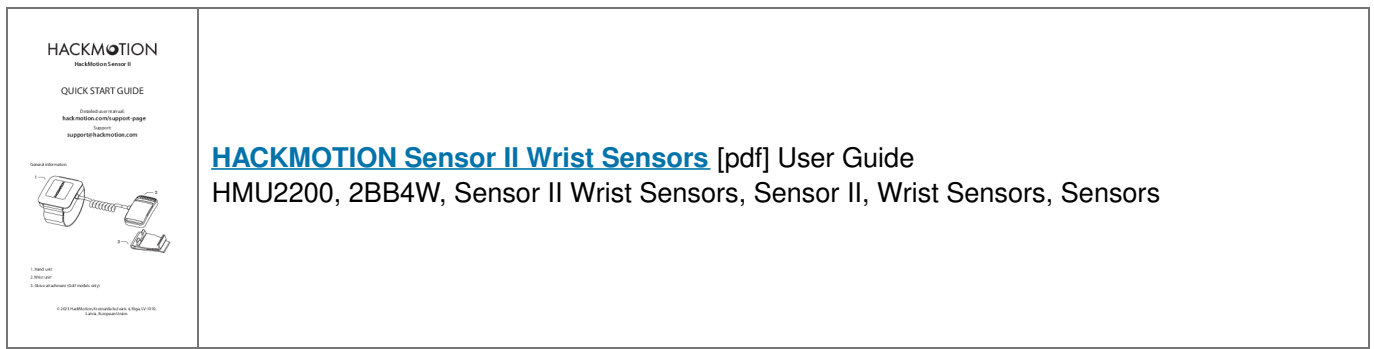

References

- [H Support | HackMotion](#)
- [User Manual](#)

[Manuals+](#), [Privacy Policy](#)

This website is an independent publication and is neither affiliated with nor endorsed by any of the trademark owners. The "Bluetooth®" word mark and logos are registered trademarks owned by Bluetooth SIG, Inc. The "Wi-Fi®" word mark and logos are registered trademarks owned by the Wi-Fi Alliance. Any use of these marks on this website does not imply any affiliation with or endorsement.