

## H3TM JRMEEW Running Man Exit Sign



# H3TM JRMEEW Running Man Exit Sign User Manual

[Home](#) » [H3TM](#) » H3TM JRMEEW Running Man Exit Sign User Manual 

### Contents

- 1 H3TM JRMEEW Running Man Exit Sign
- 2 Product Information
- 3 Product Usage Instructions
- 4 Product Features
- 5 Specifications
- 6 Dimensions
- 7 Installation
  - 7.1 IMPORTANT SAFEGUARDS
- 8 PACKAGE
- 9 Application Picture
- 10 Warranty
- 11 Documents / Resources
  - 11.1 References

# H3<sup>TM</sup>

H3TM JRMEEW Running Man Exit Sign



## Product Information

### Specifications:

Parameter	Description	Value
Model	Mode of operation	JRMEEW Maintained
Supply Voltage	Power supply voltage	120/347V/60Hz
Power Consumption	Power consumed by the device	4.5W
Output Voltage	Voltage output of the device	4.5VDC
Output Power	Power output of the device	3.5W
Colour Temperature	Color temperature of the light emitted	6000K – 7000K
Battery	Type and capacity of the battery	3.6V 200mAh Ni-Cd Battery
Max Charge Current (mA)	Maximum charging current	AC:85mA/DC:95mA
Max Discharge Current (mA)	Maximum discharge current	185mA
Charging Time	Time required for full charge	24H
Discharge Time	Duration of discharge	90Min
LED	Number of LEDs used	14 LEDs
Net Weight	Weight of the product	2.58LBS
Gross Weight	Total weight including packaging	2.64LBS
IP Rating	Ingress Protection rating	IP20
Safety Classification	Safety classification of the device	UL Listed
Certification	Certification received by the product	UL Listed
Picture Warranty	Warranty for the product	Five years warranty for the electrical parts and housing; Three years warranty for battery.

## Product Usage Instructions

### Installation Instructions:

1. Turn off AC power.
2. Using a flathead screwdriver, insert the blade into the two slots and pry off the front cover (see Figure 4).
3. Follow the proper mounting procedure below:
  - **Wall mount:**
    1. Remove the back plate from the packaging.
    2. Knock out the proper hole pattern on the back plate, including the centre hole, to mount to a standard junction box by supporting the area around the knockouts with two blocks of wood.

3. Remove the rear cover and diffuser.
4. Install the back plate onto the unit.
5. Feed the AC supply leads out through the centre hole and make the proper connections (See Step 4 and Fig.6).

- **Ceiling or End Mount:**

1. Attach the crossbar to the junction box, and set the longer blade of the crossbar to touch the junction box.
4. Remove the front cover from the unit by loosening the two screws at each end of the unit (see Figure 5).
5. Remove the two screws from the top of the unit (see Figure 5).
6. Remove the bottom cover from the unit by loosening the two screws at the bottom of the unit (see Figure 5).
7. Feed the AC supply leads through the hole in the centre of the crossbar and make the proper connections (See Step 4 and Fig.6).
8. Align the keyholes on top of the unit with the screws on the crossbar (see Figure 5) and slide the unit onto the crossbar.
9. Tighten the two screws on top of the unit (see Figure 5).
10. Attach the diffuser to the front cover by sliding it into place and tightening the two screws at each end of the unit (see Figure 5).
11. Attach the front cover to the unit by sliding it into place and tightening the two screws at each end of the unit (see Figure 5).

### **Important Safety Instructions:**

- When using electrical equipment, basic safety precautions should always be followed including the following:
  1. All servicing should be performed by qualified service personnel.
  2. Disconnect power at fuse or circuit breaker before installing or servicing.
  3. All electrical connections must be by local codes, ordinances, and the National Electric Code.
  4. Do not use outdoors.
  5. Do not let power supply cords touch hot surfaces.
  6. Do not mount near gas or electric heaters.
  7. Equipment should be mounted in locations and at heights where it will not readily be subjected to tampering by unauthorized personnel.
  8. The use of accessory equipment not recommended by the manufacturer may cause an unsafe condition.
  9. Do not use this equipment for other than intended use.
  10. Use caution when handling batteries. Battery acid can cause burns to the skin and eyes. If acid is spilled on the skin or eyes, flush the acid with fresh water and contact a physician immediately. Avoid possible shorting.
  11. Allow the battery to charge for 24 hours before first use.
- Save these instructions.

### **FAQ:**

- **Q: What is the warranty period for this product?**

A: The warranty period for the electrical parts and housing is five years, and for the battery, it is three years.

- **Q: What is the IP rating of this product?**

A: The IP rating of this product is IP20.

## Product Features

- SKU # 155392
- **Output power:** 3.5W
- **CCT:** 6000K-7000K
- Injection-molded thermoplastic ABS housing
- **Charging Time:** 24H
- **Discharging Time:** 90 MIN
- **Input Volt:** 120/347V/60Hz
- **Battery:** 3.6V 2000mAh Ni-Cd Battery
- **IP Rating:** IP20
- **LED:** 14 LEDS
- **Certifications:** UL Listed
- **Warranty:** (5 years warranty for the electrical parts and housing; 3 years warranty for battery)"

## Specifications

Parameter	Description	Value
General Performance	Model	JRMEEW
	Mode of operation	Maintained
	Supply Voltage	120/347V/60Hz
	Power Consumption	4.5W
	Output Voltage	4.5VDC
	Output Power	3.5W
	Colour Temperature	6000K -7000K
	Battery	3.6V 200mAh Ni-Cd Battery
	Max Charge Current (mA)	AC:85mA/DC:95mA
	Max Discharge Current (mA)	185mA
	Charging Time	24H
	Discharge Time	90Min
	LED	14 LEDS
	Net Weight	2.58LBS
	Gross Weight	2.64LBS
	IP Rating	IP20
	Safety Classification	
	Certification	UL Listed
	Picture	
	Warranty	Five years warranty for the electrical parts and housing; Three years warranty for battery.



## Dimensions

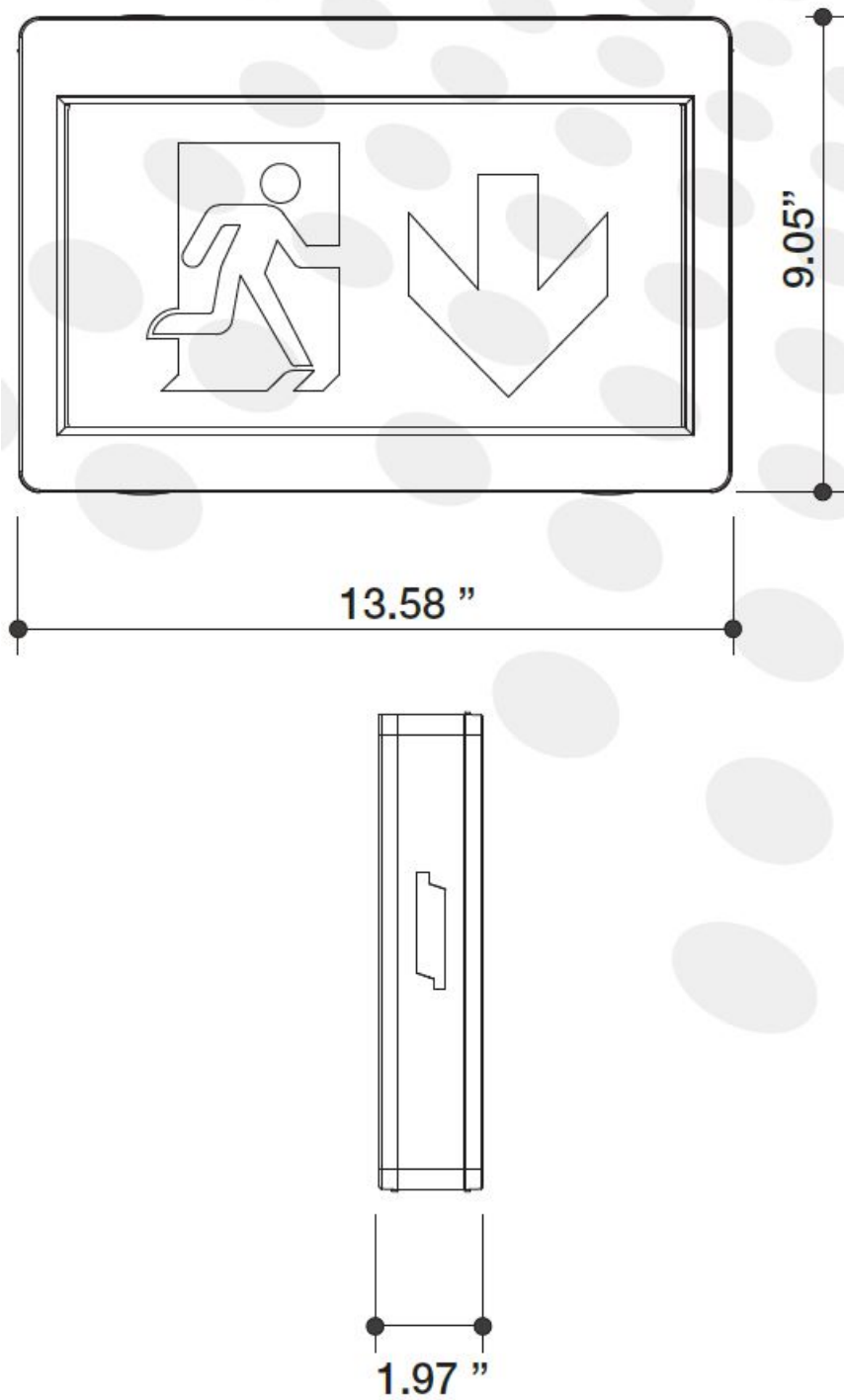

## Installation

### LED Pictogram Sign

#### WARNING:

- Risk of Shock.
- Disconnect Power before Installation.

#### IMPORTANT SAFEGUARDS

When using electrical equipment, basic safety precautions should always be followed including the following:

#### READ AND FOLLOW ALL SAFETY INSTRUCTIONS

1. All servicing should be performed by qualified service personnel.
2. Disconnect power at fuse or circuit breaker before installing or servicing.
3. All electrical connections must be in accordance with local codes, ordinances and the National Electric Code.
4. Do not use outdoors.
5. Do not let power supply cords touch hot surfaces.
6. Do not mount near gas or electric heaters.
7. Equipment should be mounted in locations and at heights where it will not readily be subjected to tampering by unauthorized personnel.
8. The use of accessory equipment not recommended by the manufacturer may cause an unsafe condition.
9. Do not use this equipment for other than intended use.
10. Use caution when handling batteries. Battery acid can cause burns to the skin and eyes. If acid is spilled on the skin or eyes, flush the acid with fresh water and contact a physician immediately. Avoid possible shorting.
11. Allow the battery to charge for 24 hours before first use.

## SAVE THESE INSTRUCTIONS

### Installation Instructions

1. Turn off AC power.
2. Using a flathead screwdriver, insert the blade into the two slots and pry off the front cover (see Figure 4).

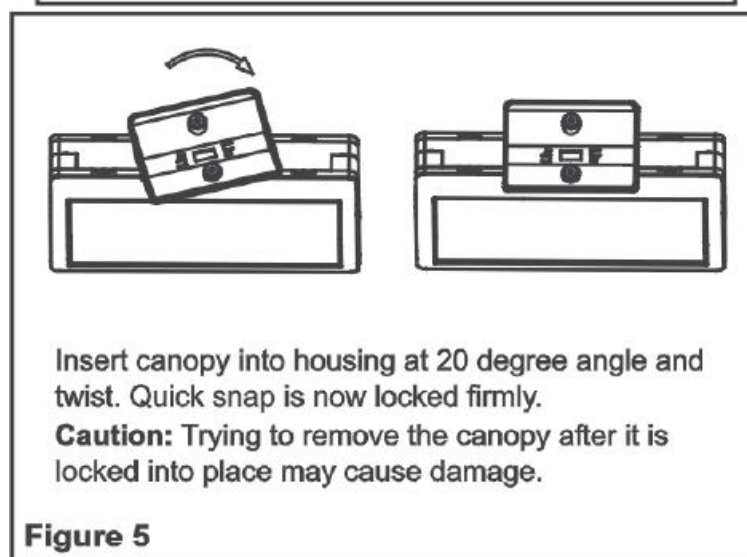
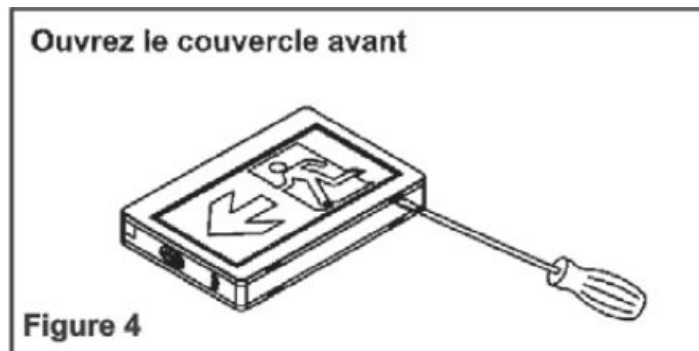

3. Follow the proper mounting procedure below.

#### Wall mount

- Remove the back plate from the packaging.
- Knock out the proper hole pattern on the back plate, including the centre hole, to mount to a standard junction box by supporting the area around the knockouts with two blocks of wood.



- Remove the rear cover and diffuser.
- Install the back plate onto the unit.
- Feed the AC supply leads out through the centre hole and make the proper connections (See Step 4 and Fig.6).

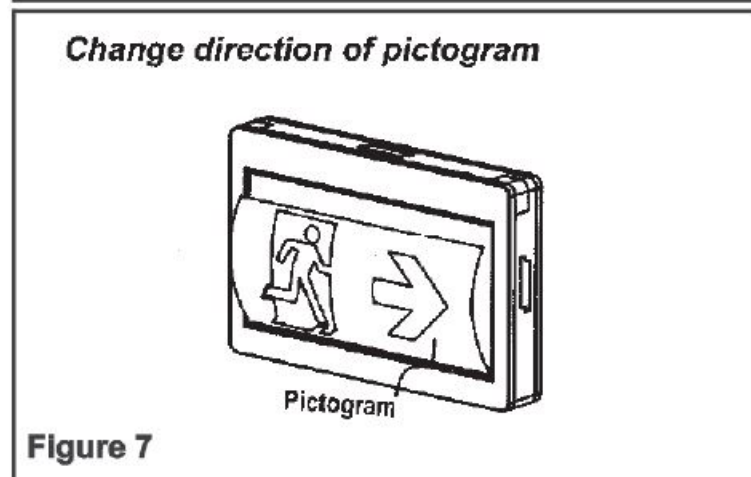
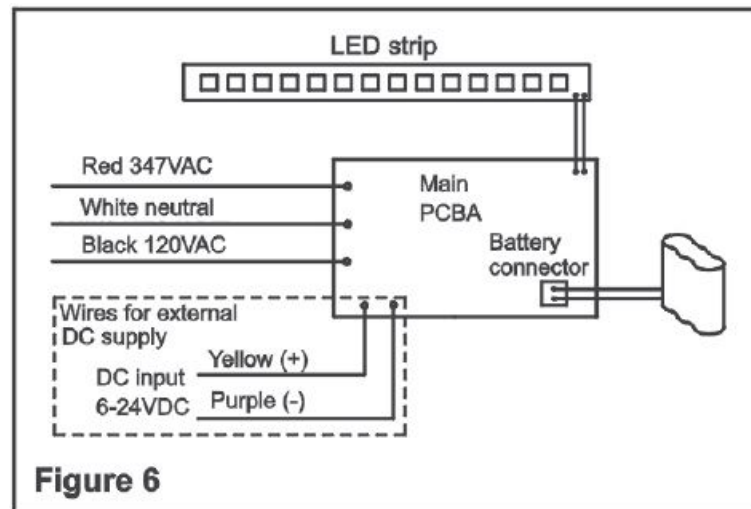

#### Ceiling or End Mount

- Attach the crossbar to the junction box, and set the longer blade of the crossbar to touch the junction box.
- Remove the mounting hole cover from the top or side of the unit depending on your mounting configuration (see Figures 2 or 3).

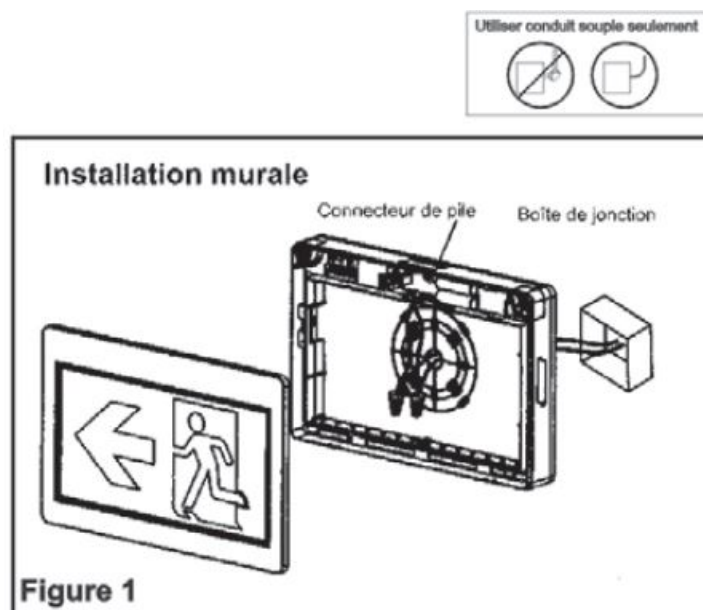

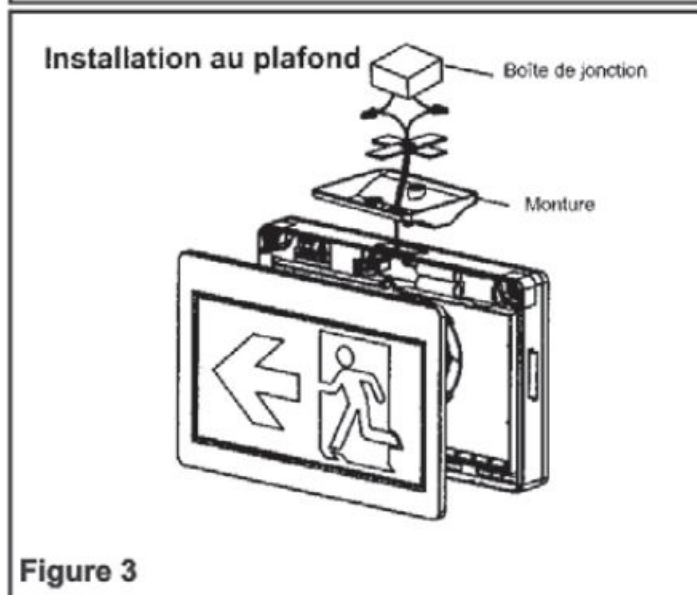
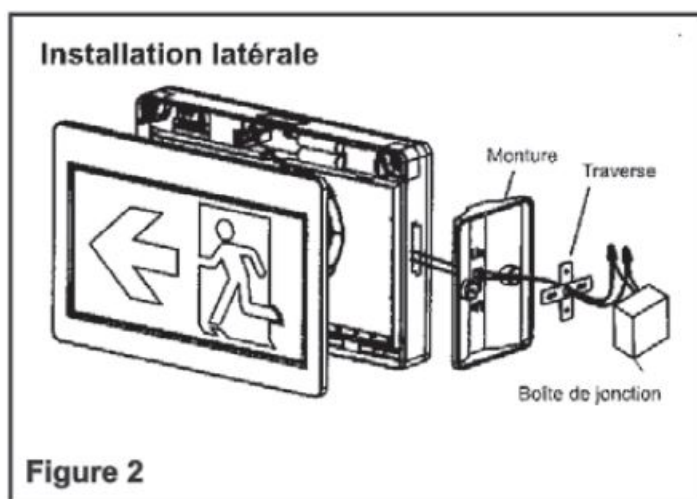

- Install the canopy according to the mounting configuration (see Figure 6).
- Feed the unit wires through canopy hole and make the proper connections (See Step 4 and Fig.6).

4. Make the proper connections (see Figure 6):

- For 120VAC, connect the black wire (120VAC) and white wire (neutral) to the building utility.
- For 347VAC, connect the red wire (347VAC) and white wire (neutral) to the building utility.
- Feed wires back into the junction box.

**CAUTION!**

Risk of electrical shock. Cap unused wires. In all cases, use suitable wire nuts rated for the applicable voltage to connect to wires.

5. For universal AC/DC models: connect wires for external DC supply (see figure 6)

- Wire the Yellow lead to the positive(+)
- Wire the Purple to the Negative(-)

**IMPORTANT!**

Electrical connections for AC and DC wires must be isolated from each other.

**PACKAGE**

Carton (Inch)	Qty/Carton	Net Weight/Carton	Gross Weight/Carton
14.37×9.76×6.14	2PC	5.07LBS	6.17LBS

## Application Picture



## Warranty

Five years warranty for the electrical parts and housing; Three three-year warranty for battery.

(866) 786-1117 | [www.BeyondLEDTechnology.com](http://www.BeyondLEDTechnology.com)

Due to continuous product improvement, information in this document is subject to change.

---

## Documents / Resources

	<p><a href="#">H3TM JRMEEW Running Man Exit Sign</a> [pdf] User Manual JRMEEW Running Man Exit Sign, JRMEEW, Running Man Exit Sign, Man Exit Sign, Exit Sign</p>
---	--

## References

- [Wholesale Lighting Distributors & LED Lighting Solutions – Beyond LED Technology](#)
- [User Manual](#)

## **Manuals+. Privacy Policy**

This website is an independent publication and is neither affiliated with nor endorsed by any of the trademark owners. The "Bluetooth®" word mark and logos are registered trademarks owned by Bluetooth SIG, Inc. The "Wi-Fi®" word mark and logos are registered trademarks owned by the Wi-Fi Alliance. Any use of these marks on this website does not imply any affiliation with or endorsement.