



GVM-Y30D160 Bi-Color Edge Video LED Soft Light User Manual

[Home](#) » [GVM](#) » GVM-Y30D160 Bi-Color Edge Video LED Soft Light User Manual 

Contents

- 1 GVM-Y30D160 Bi-Color Edge Video LED Soft Light
- 2 GVM GREAT VIDEO MAKER
 - 2.1 PRODUCT INTRODUCTION
 - 2.2 DISCLAIMERS
 - 2.3 GVM-Y30D160 PRODUCT PARAMETER
 - 2.4 GVM-Y60D256 PRODUCT PARAMETER
 - 2.5 PRODUCT STRUCTURE ICON
 - 2.6 INSTALLATION METHOD
 - 2.7 DESCRIPTION OF PRODUCT CONTROL KEYS
 - 2.8 FUNCTION INSTRUCTION & INSTRUCTION FOR USE
 - 2.9 APP CONNECTION AND APP CONTROL
 - 2.10 SIMPIE FAULTS AND TROUBLESHOOTING
 - 2.11 PRECAUTIONS
 - 2.12 USE AND PRESERVATION
 - 2.13 PACKING LIST
- 3 Documents / Resources
- 4 Related Posts

GVM-Y30D160 Bi-Color Edge Video LED Soft Light

GVM
GREAT VIDEO MAKER



GVM Official
website



Facebook



Download APP
IOS



Download APP
Android

Web: www.gvmled.com

B&H Email: bh@gvmled.com

GVM Email: support@gvmled.com

Amazon Email: amazonsupport@gvmled.com

Warehouse Add: 4301 N Delaware ave, unit D. PHILADELPHIA, PA19137, USA

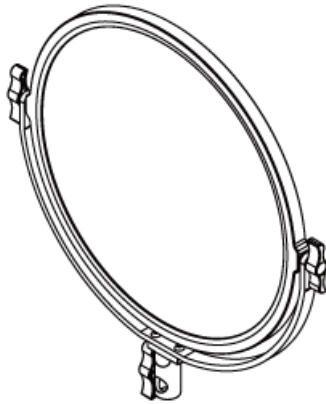

GVM
GREAT VIDEO MAKER
GVM-Y30D160 / GVM-Y60D256

PRODUCT INTRODUCTION

Welcome to “GVM-Y30D160 / GVM-Y60D256”. This product is specially designed for senior photography enthusiasts. The product is suitable for live / outdoor / studio photography, and also for YouTube video shooting.

The main features of the product are:

① Step-less adjustable dual color temperature feature, color range 3200K ~ 5600k, Using LED bulbs, which is helpful to restore and enrich the color of objects and provide you with natural and vivid shooting effect.

② APP intelligent control system, which can be controlled by your smart mobile devices.

③ With digital screen display and stable system, which can support 360 ° rotation and effectively control the light Line. You can customize the control of fill light, so that you can easily shoot the desired results.

We firmly believe that the correct use of this product will definitely help your shooting work. Before using the product, we strongly recommend that you carefully read the following user guide.

DISCLAIMERS

1. Before using this product, please read the instructions carefully and make sure use the product correctly. If you don't obey the instructions and warnings, you maybe cause harm to yourself and the people around, or even damage the product and other things around.
2. Once you use this product, you are deemed to have read the disclaimer and warning carefully, understand and acknowledge all the terms and contents of this statement,

and promise to take full responsibility for the use of this product and possible consequences.

GVM-Y30D160

PRODUCT PARAMETER

- Brand : GVM
- Product Model : GVM-Y30D160
- Product Type : Photography Fill Light
- Product Name : Photography lights
- Function / Feature: APP, Joint control, LED digital display
High color rendering index light beads
- Color Rendering Index : ≥ 97
- Color Temperature : 3200K-5600K
- Brightness: 2300lux/0.5m ; 800lux/1m
- Light Adjustment Method : Stepless adjustment
- Lamp Beads Quantity : 160
- Product Weight : 2KG
- Power : 30W
- Product Size(mm) : 328*328*40
- Cooling : Natural heat dissipation
- Product Material : Aluminum alloy
- Voltage : DC15V
- Power Supply : DC15V/3A
- Power Supply Mode : DC input & Battery
- Battery Capacity : NF series battery * 2 (sold separately)
- Commodity Origin : Huizhou. China

GVM-Y60D256

PRODUCT PARAMETER

- Brand : GVM
- Product Model : GVM-Y60D256
- Product Type : Photography Fill Light
- Product Name : Photography lights
- Function / Feature: APP, Joint control, LED digital display
High color rendering index light beads
- Color Rendering Index : ≥ 97
- Color Temperature : 3200K-5600K
- Brightness: 5100lux/0.5m ; 1750lux/1m
- Light Adjustment Method : Stepless adjustment
- Lamp Beads Quantity : 256
- Product Weight : 2.7KG
- Power : 60W

- Product Size(mm) : 430*418*40
- Cooling : Natural heat dissipation
- Product Material : Aluminum alloy
- Voltage : DC15V
- Power Supply : DC15V/4A
- Power Supply Mode : DC input & Battery
- Battery Capacity : NF series battery * 2 (sold separately)
- Commodity Origin : Huizhou. China

PRODUCT STRUCTURE ICON

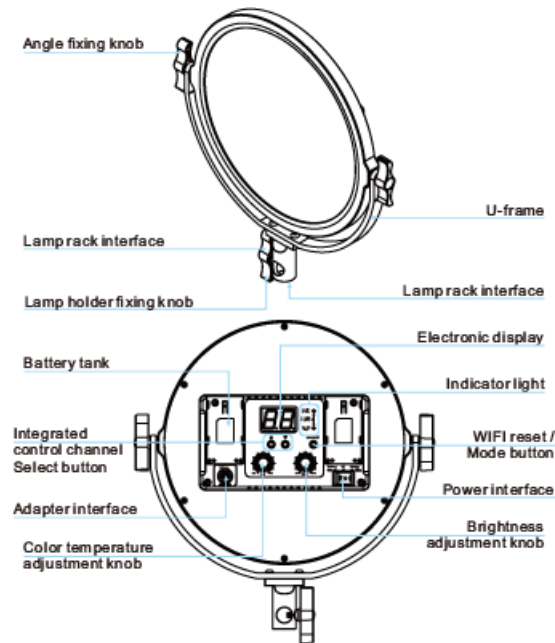

INSTALLATION METHOD

1. The lamp can be installed and fixed on the bracket by rotating the knob clockwise, and unloaded by rotating in the counterclockwise direction.

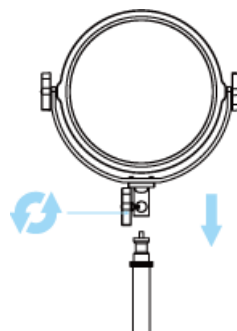

3. Loosen the adjustment knobs on both sides of the U-bracket, adjust the angle of the panel you need, and then tighten the adjustment knobs on both sides of the U-bracket.

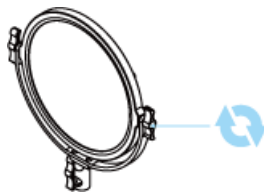

There are two power supply modes to choose.

- ① connect the power cord and adapter for power supply.
- ② purchase two other suitable lithium batteries and use them for power supply. (both battery cells must be plugged in to power)

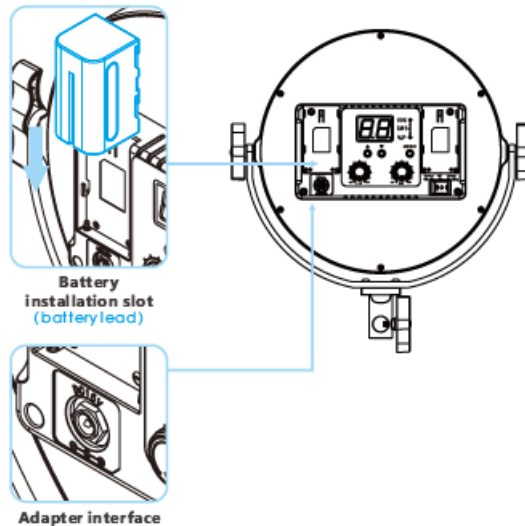

DESCRIPTION OF PRODUCT CONTROL KEYS

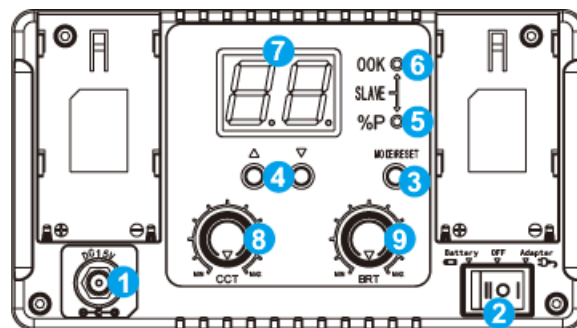

1. DC15V power input interface
2. Power switch
3. Mode button/WIFI reset button: Modes include master mode and slave mode; WIFI username and password reset button
4. Channel addition and subtraction key: adjust channel 0~11
5. Brightness indicator: when adjust the brightness knob, the indicator is on
6. Color temperature indicator: when adjust the color temperature knob, the indicator is on **Note:** indicator ⑤ and indicator ⑥ will be on simultaneously when in slave mode
7. Nixie tube: show value including lightness, color temperature and channel
8. Color temperature adjustment button: adjust the color (3200K~5600K)
9. Brightness adjustment button: adjust the brightness 10%~99%)

FUNCTION INSTRUCTION & INSTRUCTION FOR USE

① Mode selection The mode is divided into master mode and slave mode. Tap the mode key to switch (default master mode for startup).

MODE: Master: Adjust brightness, color temperature and channel through knobs and buttons, and can also connect APP. These parameters of lamp can be controlled through APP, and slave computers of the same channel can also be adjusted synchronously.

MODE: Slave: Brightness and color temperature cannot be adjusted, only channel values can be set.

② Regulation channel : range 0~11
Set channel value using channel addition and subtraction key.

③ Adjust brightness (BRG): range 10%~99%
In the master mode, brightness can be adjusted by rotating brightness level knob or APP.

④ **Adjust color temperature (CCT):** range 3200K~5600K
In the master mode, color temperature can be adjusted by rotating brightness level knob or APP.

⑤ **Indicator light Master mode:** when the brightness is adjusted by brightness level knob or APP, the brightness indicator light is on, and the color temperature indicator light is off; When the color temperature is adjusted by the color temperature adjusting knob or APP, the color temperature indicator will be on, and the brightness indicator will be off.

Slave mode: color temperature indicator and brightness indicator are always on.

⑥ **On-line control (Joint control between lamps and lanterns):**
Prepare more than two photographing lights, set one to the master mode, set the rest to the slave mode, and set the channel of the master / slave through the add / subtract key. When the channels of the master and the slave are the same, the brightness and color temperature of the slave in the same channel can be controlled synchronously by adjusting the brightness and color temperature knobs of the master. You can also use the APP to connect to the master and use the APP to control the master and all slaves.

APP CONNECTION AND APP CONTROL

Scan the QR code on the back of the manual to download the APP

Set master mode for the photography light (automatically as a master mode when switching on the machine), open "GVM Easily" APP on the mobile phone (meanwhile turn on WIFI on the phone), register the APP account (as long as the email format is correct, the email account password can be entered at will, because the next time you open the APP, you will automatically login), in the main menu in the APP—switch the devices—select "Single/Double color temperature light", then in the main menu in APP—set—select "switch WIFI", and connect photography light (WIFI initial username: GVM_LED, password: gvm_admin), once it shows "Device connection GVM_LED", return back to the main interface, after it shows "Connected" in the main interface, it

is allowed to control the lightness, color temperature, channel value or switch on and off through the control key in APP, and also the slave machines.



If there is a slave, the slave and the master are controlled by the APP at the same time. The master/slave connection mode is the same as “9 pages, ⑥ online control (link control between lamps and lamps).”

WIFI username and password resetting

It is able to reset the WIFI username and password if long press the WIFI reset button for over 5 seconds. After resetting, the username and the password will return to the initial (WIFI username: GVM_LED, WIFI password: gvm admin).

SIMPIE FAULTS AND TROUBLESHOOTING

Phenomenon	Check the product	Troubleshooting
The switch indicator does not light up	1. Check the matching power adapter indicator light up or not.	Make sure the adapter is well contacted with the power plug.
	2. When using lithium battery, make sure there's no “low power” protection.	Charge the battery before using it.

The brightness/ color temperature knob is out of control	Check if the mode were set as slave mode, lightness and color temperature of the products cannot be controlled in slave mode.	Press the “MODE” button for once, switch the mode from slave mode to master mode.
The product is in the “ON” state, the display and lights are not on	Check if the product is “OFF” because of the APP of the mobile phone.	Press the “ON/OFF” button once again.
APP can't connect / can't control	Check whether the WiFi is connected in WiFi mode , whether the WiFi is successfully connected, and whether “Connected” is displayed on the APP.	Normal steps: ① Switch to WiFi mode after booting; ② Successfully connect to WiFi; ③ Open the APP and the connection will be successful.
WiFi is successfully connected, but the device cannot connect to the APP	Check if the “Switch Device” type in the APP main menu is switched to “Single/Double color temperature light”.	Click APP main menu → Switch device → Single/Double color temperature light

PRECAUTIONS

① Please use the matching power adapter or lithium battery with the same specification to power the product. Do not use power adapter with different output voltage parameters.

② The product is not waterproof, please use it in rainproof environment.

③ The product is not anti-corrosion, therefore do not let the product touch any corrosive liquid.

④ When using the product, make sure the product is put firmly and prevent from falling and damage.

⑤ If the product will not be used for a long time, please switch off the power to reduce energy loss.

USE AND PRESERVATION

Do not put the product in a highly humid, strong electromagnetic field, direct sunlight, high-temperature environment. If not use the product for a long time, disconnect the power and take out the battery.

Clean: Before clean, disconnect the power plug. And use wet cloth rather than any detergent or soluble liquid, avoiding damaging the surface layer.

Power: Make sure the power is in the demanded range, not too high or too low. Correctly load the battery, in order not the damage to machine.

Repairing: If there is fault or performance degradation, do not unpack the shell by yourself, avoiding damage the machine and lose the right of maintenance. When there is a fault, do not hesitate to contact us, and we will do our best to deal with the problem.

Accessories: Please use the accessories provided by manufacturer and approved ones, in order to maximize the performance.

Guarantee: Do does not modify the product, or you will lose the right of maintenance.

PACKING LIST

N a m e	Q u a n t i t y	N o t e s
Main Machine	1	
Power Cord	1	
Adapter	1	
Carrying Case	1	
User Manual	1	

Documents / Resources

	GVM GVM-Y30D160 Bi-Color Edge Video LED Soft Light [pdf] User Manual GVM-Y30D160, Bi-Color Edge Video LED Soft Light, Video LED Soft Light, Bi-Color Soft Light, Soft Light, Light
---	---