

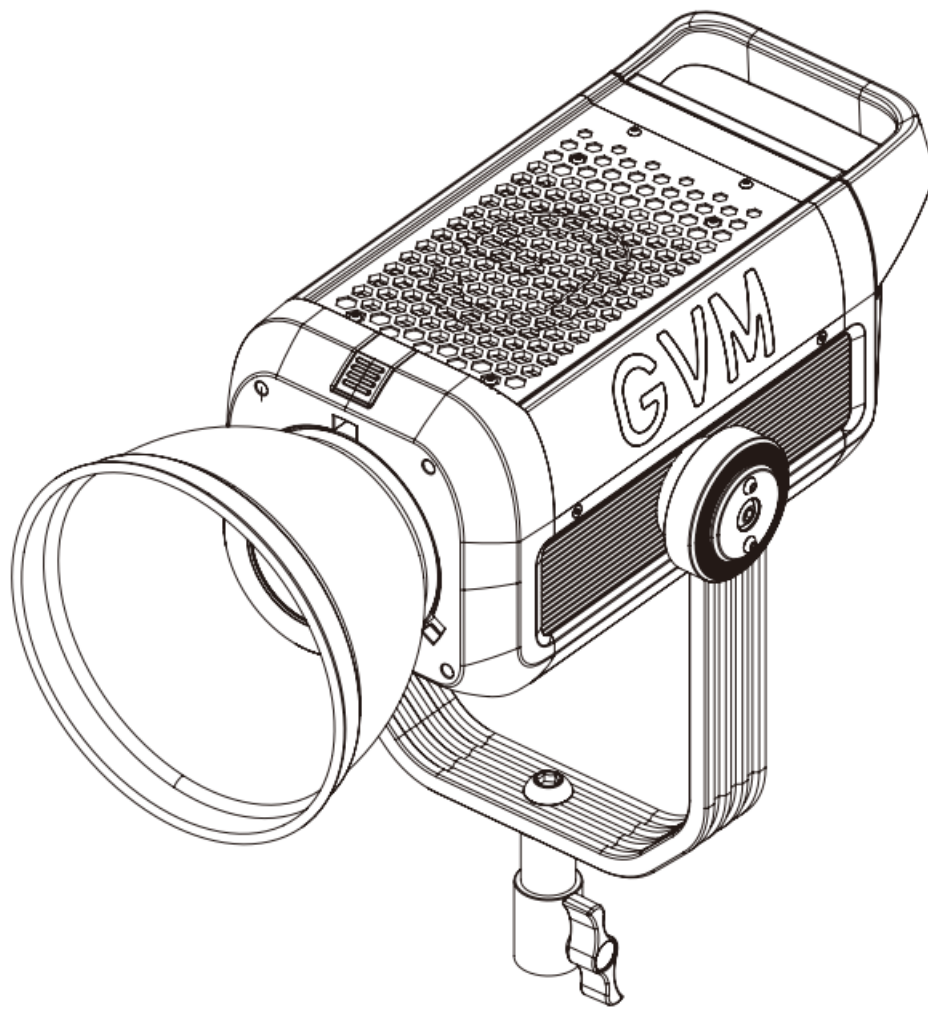

## GVM-PRO-SD400B Greal Video Maker Instruction Manual

[Home](#) » [GVM](#) » GVM-PRO-SD400B Greal Video Maker Instruction Manual 

GVM-PRO-SD400B Greal Video Maker



## Contents

- [1 PRODUCT INTRODUCTION](#)
- [2 DISCLAIMERS](#)
- [3 GVM-PRO-SD400B PRODUCT PARAMETER](#)
- [4 GVM-PRO-SD500B PRODUCT PARAMETER](#)
- [5 PRODUCT STRUCTURE DIAGRAM](#)
- [6 INSTALLATION METHOD](#)
- [7 DESCRIPTION OF PRODUCT CONTROL KEYS](#)
- [8 FUNCTION INTRODUCTION & INSTRUCTIONS FOR USE](#)
- [9 APP CONTROL](#)
- [10 USE AND SAVE](#)
- [11 SIMPIE FAULTS AND TROUBLESHOOTING](#)
- [12 PACKING LIST](#)
- [13 PRECAUTIONS](#)
- [14 Customer Support](#)
- [15 Documents / Resources](#)
  - [15.1 References](#)
- [16 Related Posts](#)

## PRODUCT INTRODUCTION

Welcome to use " GVM-PRO-SD400B/GVM-PRO-SD500B", this product is designed for senior photography enthusiasts, The product is suitable for live broadcast / outdoor / film shooting / studio photography It can also be used for YouTube video shooting.

- ① It has high-definition COB beads, which help to restore and enrich the color of objects, providing you with natural and vivid shooting effects.
- ② APP control, can be controlled through your iOS and Android smart mobile device connection; support Bluetooth Mesh networking, you can group control with GVM brand devices that support Mesh networking.
- ③ With standard DMX interface, DMX control mode of low precision 8bit and high precision 16bit can be realized.
- ④ 3 lighting modes, CCT mode, light source matching mode, light effect Mode.

We firmly believe that the correct use of this product, for your shooting work will certainly have a great help, Before using the product, we strongly recommend that you read the following user guide carefully.

## **DISCLAIMERS**

1. Before using this product, please read the text carefully to ensure that the correct operation of the product has been carried out. Failure to follow and not following the instructions and warnings in this document may cause harm to you and others around you, or even damage the product or other surrounding items.
2. By using this product, you are deemed to have carefully read the disclaimer and warning, understand and acknowledge all the terms and contents of this statement, and promise to take full responsibility for the use of this product and the possible consequences.
3. Design and specifications are subject to change without notice.

## **GVM-PRO-SD400B PRODUCT PARAMETER**

- Brand: GVM
- Product Name: Photography light
- Product type: photography fill light
- Function control: multiple light effect modes, high display index lamp beads
- Control mode: DMX, wireless remote control, light body control, APP Bluetooth MESH network control
- Lumen: Bare light ——lux/1m;  
Plus standard cover ——lux/1m
- Number of lamp beads: 1 (COB lamp beads)
- Color rendering index :  $\geq 97$
- Color temperature: 2700K~6800K
- Light adjustment method: Stepless adjustment
- Product net weight: 5KG
- Maximum power: 400W
- Power supply mode: AC&Battery (V-mount battery)
- AC input: 100V~240V
- DC input: 24V~36V
- Product Size (mm): 436×150×265
- Controller size (mm): 136×133×335
- Controller net weight: 2.6KG
- Product material: Aluminum alloy
- Heat dissipation: Heat sink + fan
- Commodity origin: Huizhou, China

## **GVM-PRO-SD500B PRODUCT PARAMETER**

- Brand: GVM
- Product Name: Photography light
- Product type: photography fill light
- Function control: multiple light effect modes, high display index lamp beads
- Control mode: DMX, wireless remote control, light body control, APP Bluetooth MESH network control
- Lumen: Bare light ——lux/1m;  
Plus standard cover ——lux/1m
- Number of lamp beads: 1 (COB lamp beads)
- Color rendering index :  $\geq 97$
- Color temperature: 2700K~6800K
- Light adjustment method: Stepless adjustment
- Product net weight: 5KG
- Maximum power: 500W
- Power supply mode: AC&Battery (V-mount battery)
- AC input: 100V~240V
- DC input: 24V~36V
- Product Size (mm): 436×150×265
- Controller size (mm): 136×133×335
- Controller net weight: 2.6KG
- Product material: Aluminum alloy
- Heat dissipation: Heat sink + fan
- Commodity origin: Huizhou, China

## PRODUCT STRUCTURE DIAGRAM

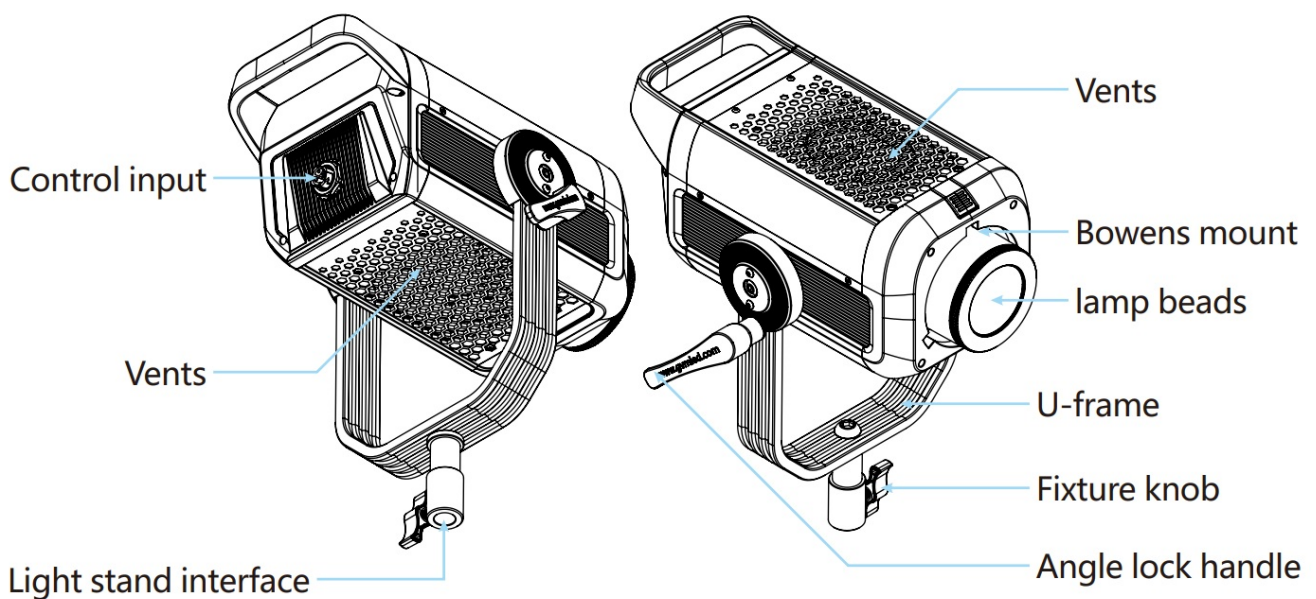

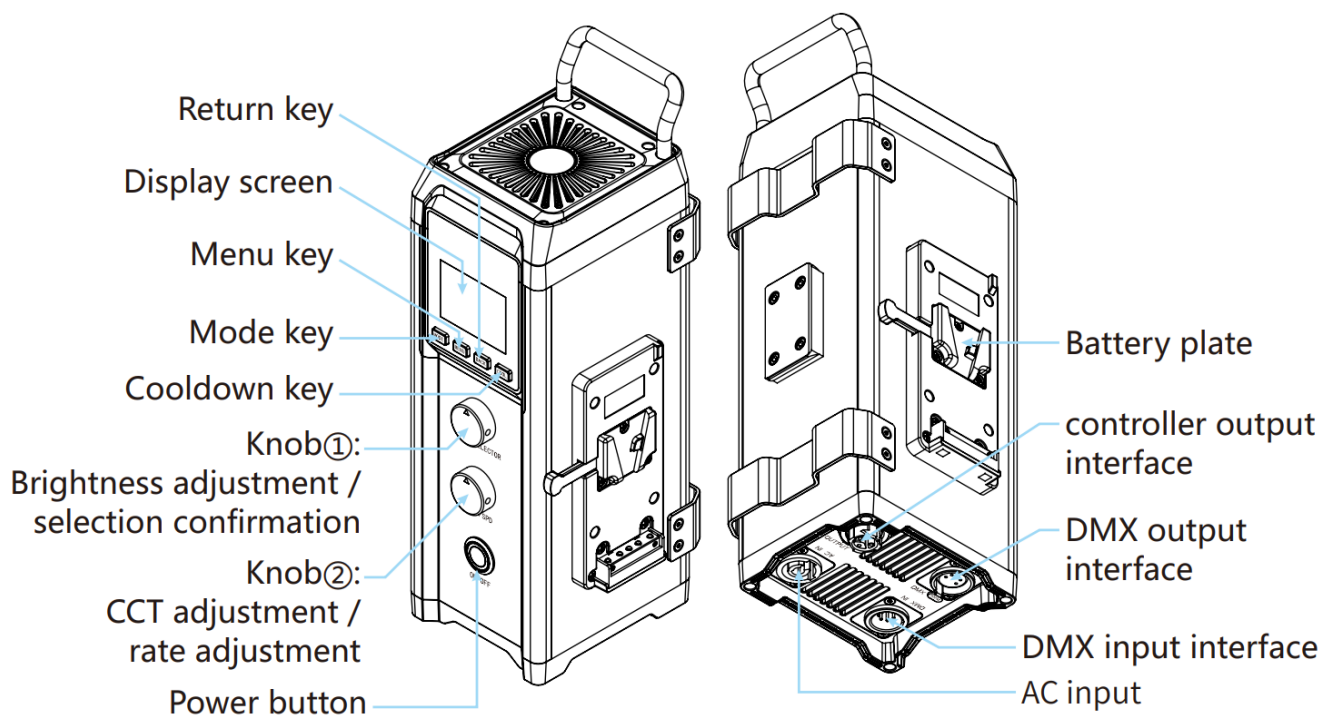

## INSTALLATION METHOD

1. Loosen the light stand fixing knob, install the light to the light stand as shown below, then tighten the light stand fixing knob.

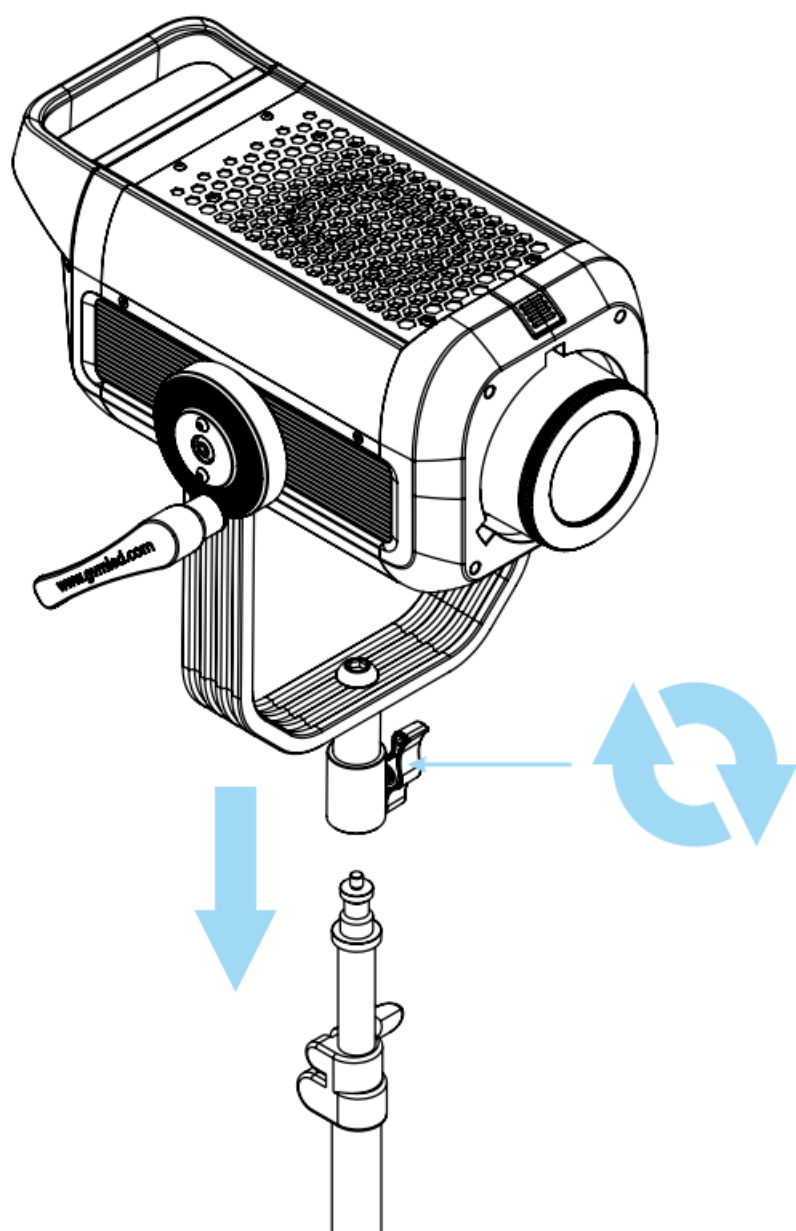

2. Loosen the angle locking handle, adjust the angle of the spotlight, z then turn the angle locking handle tightly.

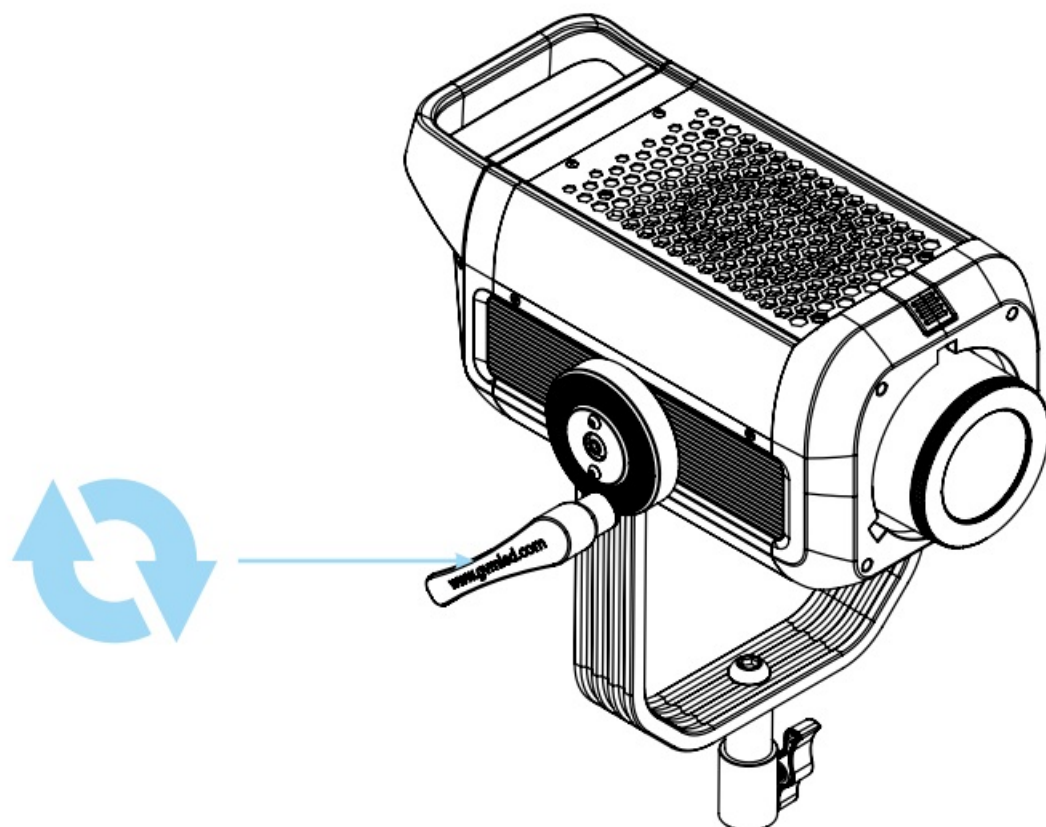

3. Insert the Bowens bayonet of the standard cover into the Bowens bayonet of the lamp correspondingly, and then turn it clockwise lightly. you can install the standard cover to the light. Push the Bowens removal catch upward to the right while rotating the standard cover counter clockwise to remove the standard cover.

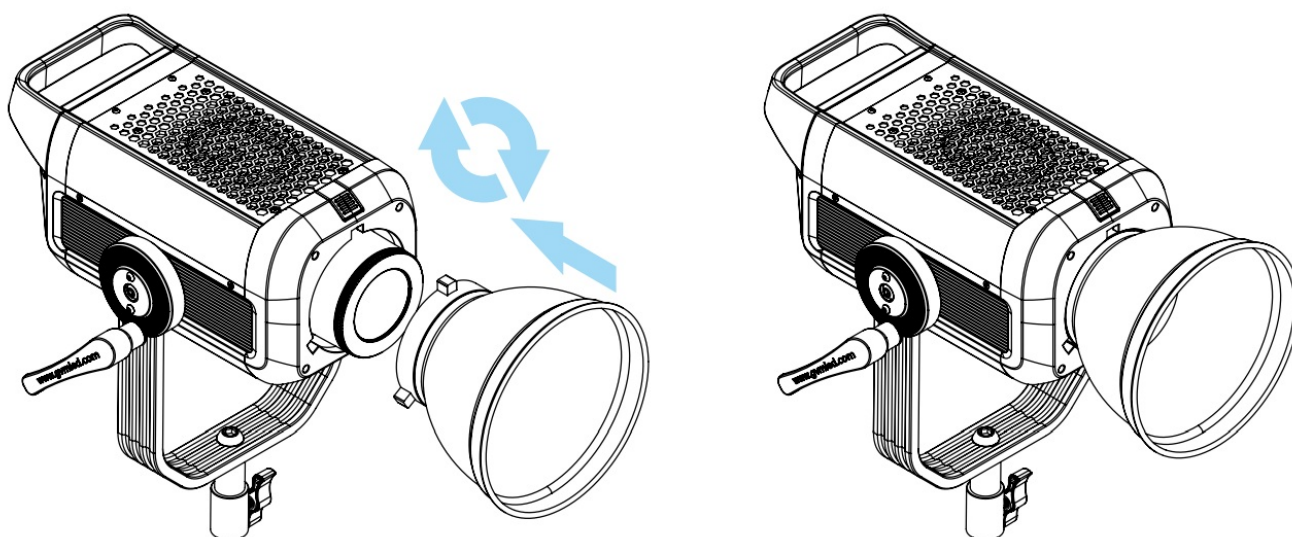

4. Install the controller fixing clip on the light stand as shown in the figure below.



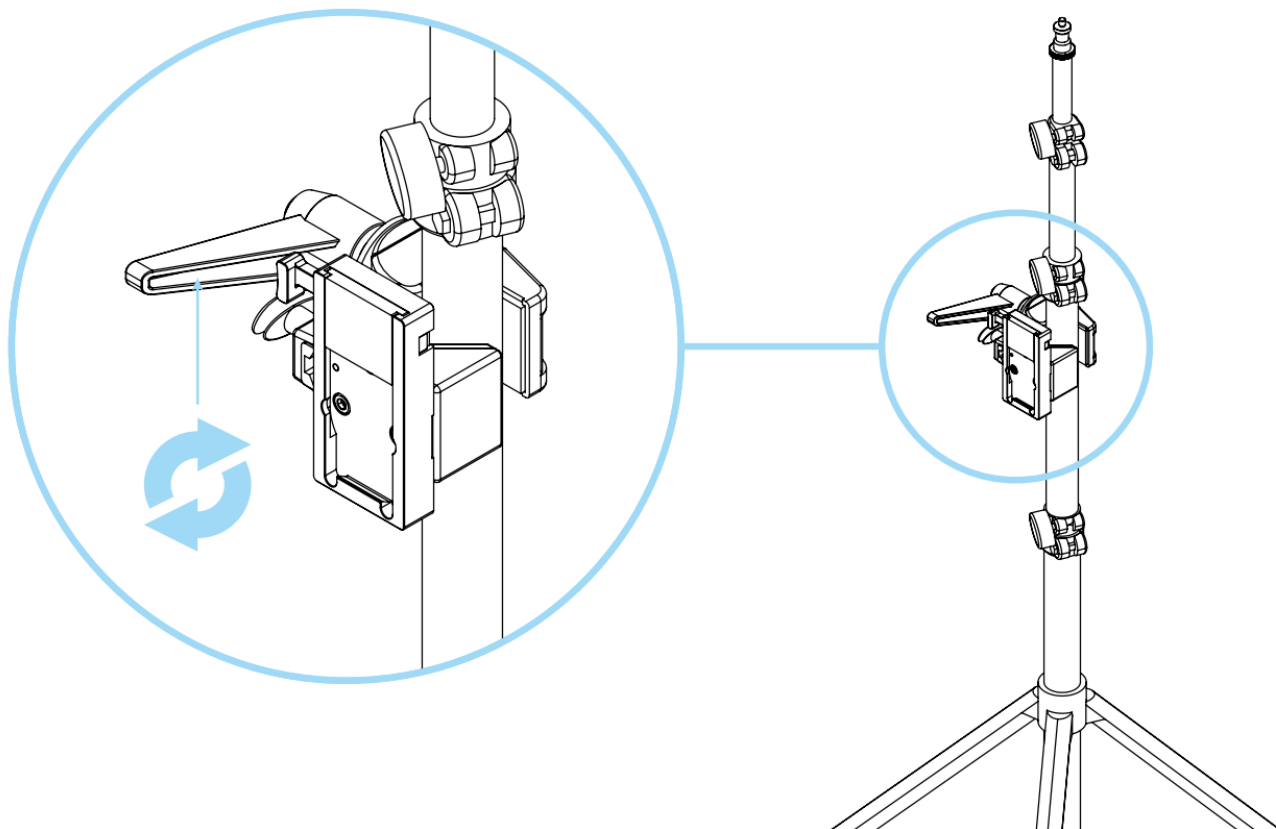

5. Follow the steps shown in the figure below to install the controller on the controller fixing clip first.



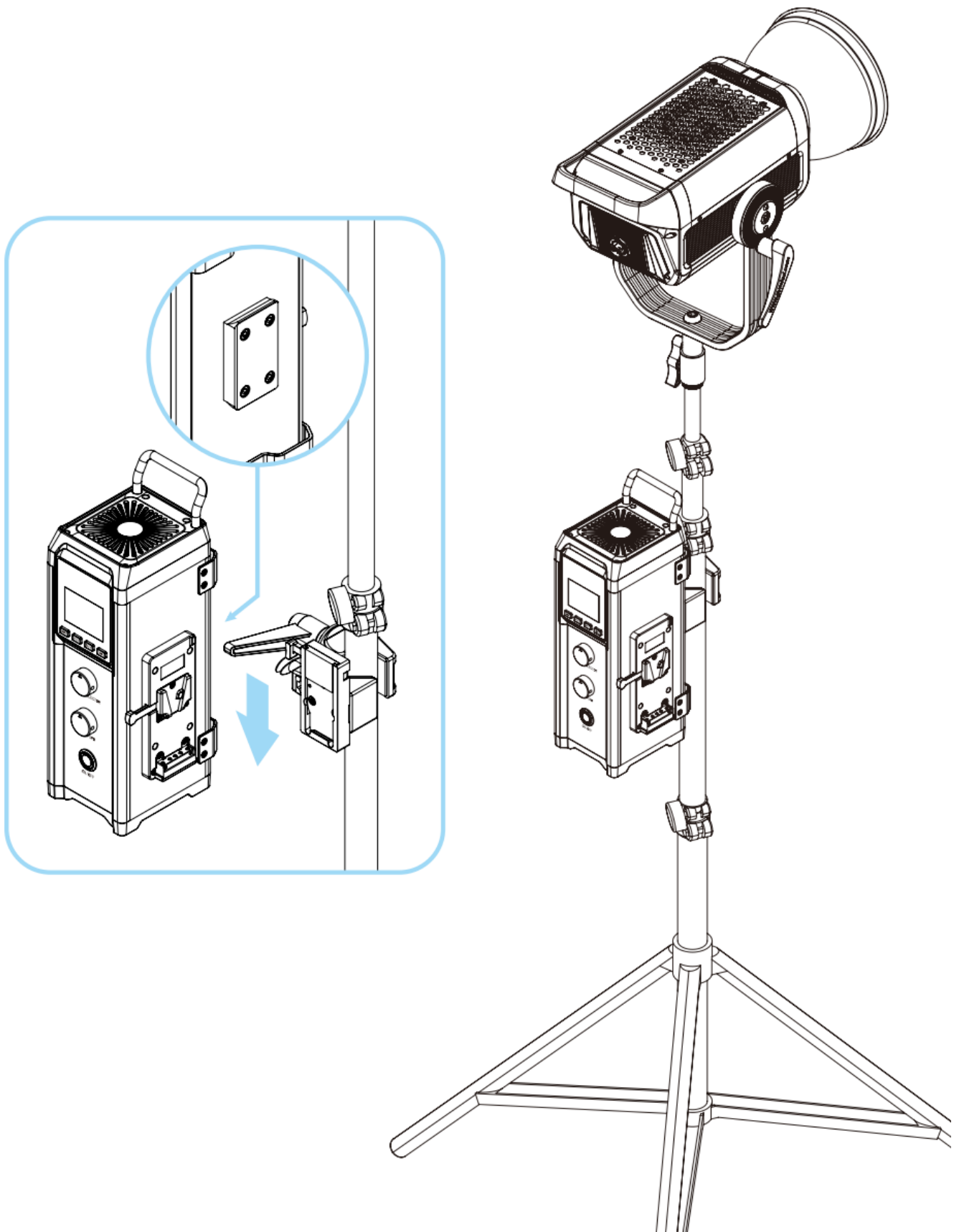

6. As shown in the figure below, use the control wire to connect the light and the controller.

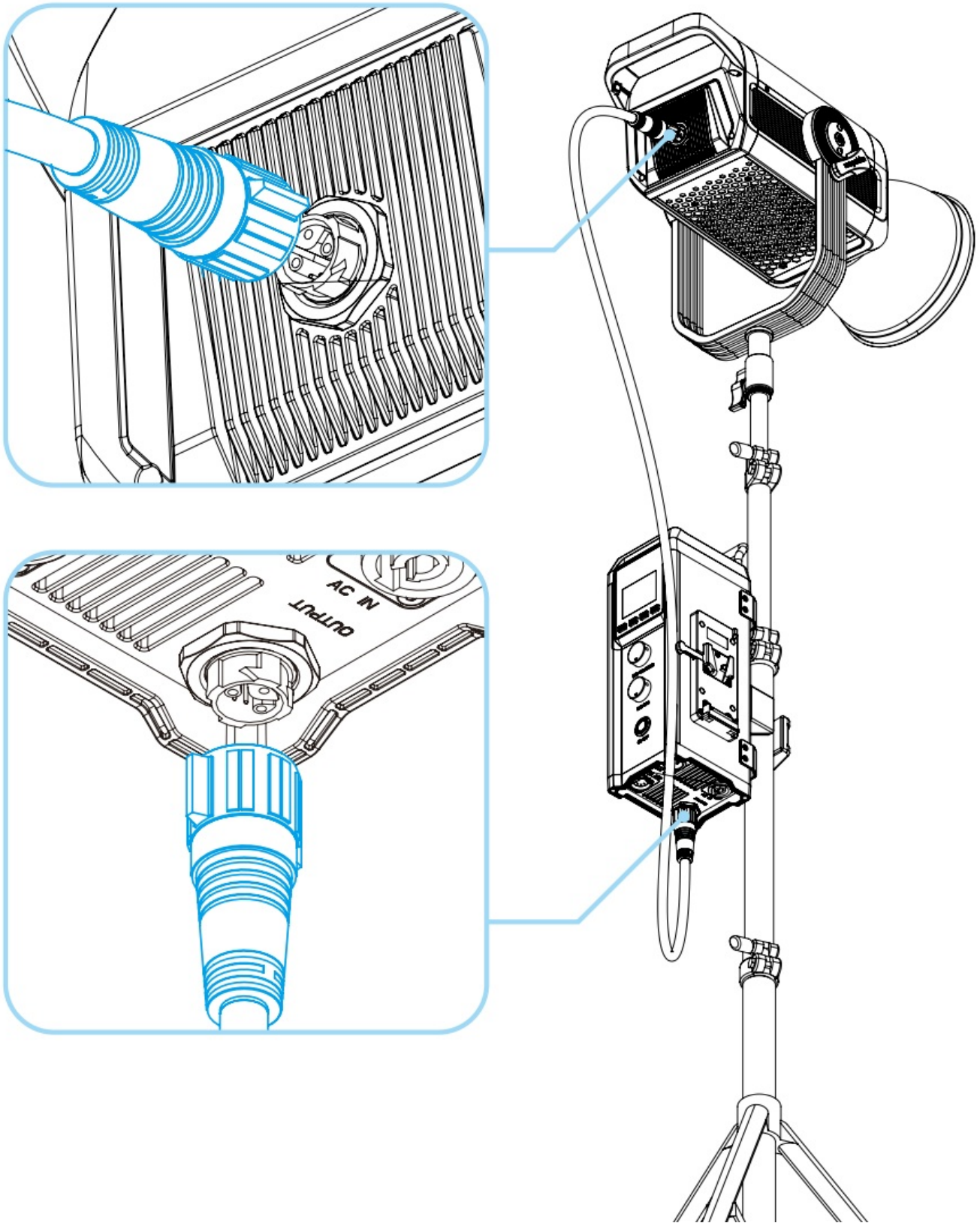

7. There are two power supply modes to choose from:

① Use the AC power cord for power supply.

② Use two V button batteries for power supply.

(Batteries must be inserted into both battery slots to provide power, and the power is halved when using batteries.)

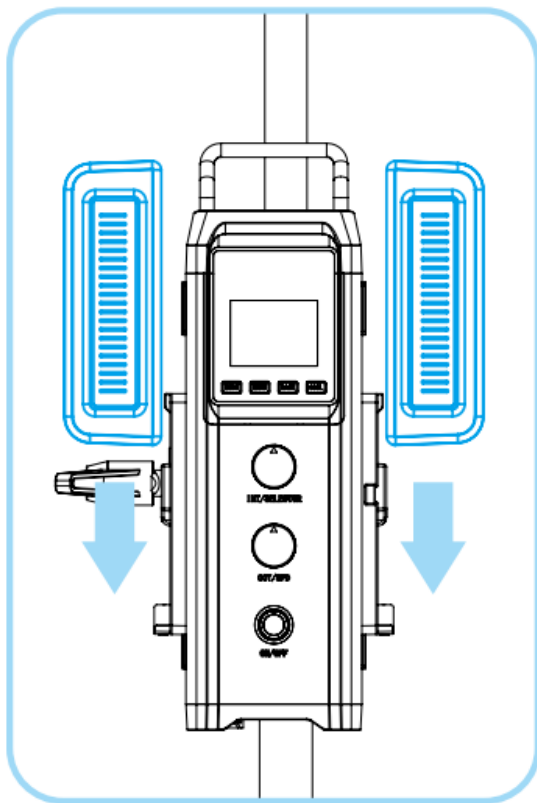

### Battery slot

(Battery needs to be purchased separately)

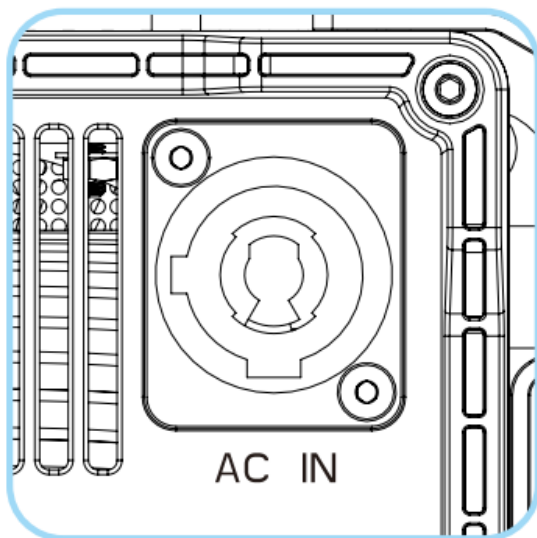

### Power input interface

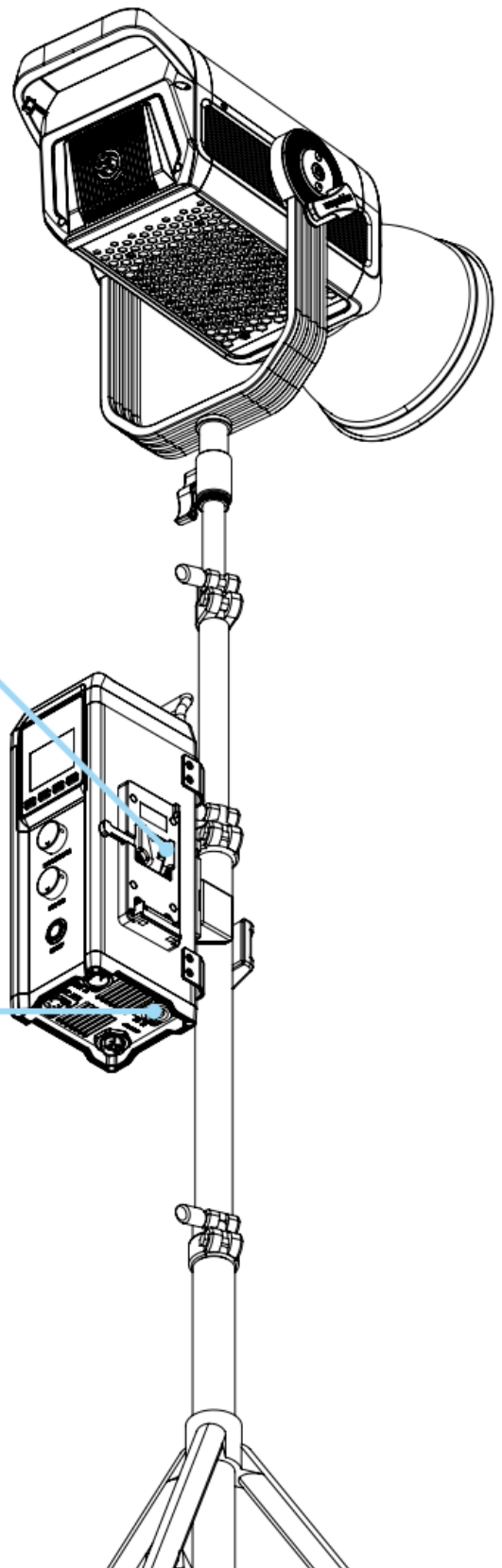

## DESCRIPTION OF PRODUCT CONTROL KEYS

1. Display: Display current settings, modes and parameters.
2. Mode key: light mode switch button.
3. Menu key: press this key to enter the settings menu.
4. Return key: Press this key to return to the previous level menu.
5. Cooling key: start a large air volume cooling until the temperature is reduced to a touchable temperature.

6. Knob ①: INT/SELECTOR multi-functional coding knob, by pressing or rotating can be" Select/Brightness" adjustment.
7. Knob ②: CCT/SPEED adjustment, by rotating it, you can make the adjustment of color temperature and light effect change rate.
8. Power ON/OFF button.

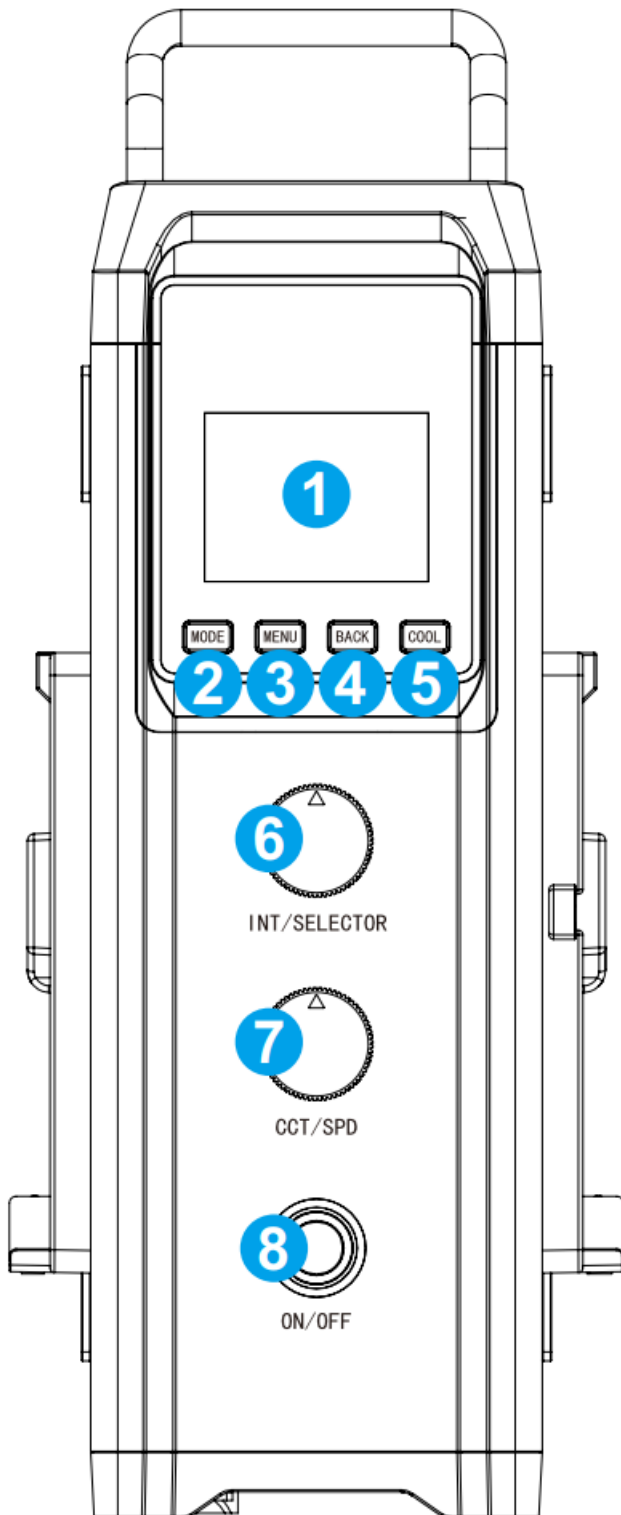

## FUNCTION INTRODUCTION & INSTRUCTIONS FOR USE

### MENU

- DMX SETTINGS (Figure 1):

Set the DMX parameters, [address (001-512)] and configure the mo mode [(8bit/16bit)].

Figure 1

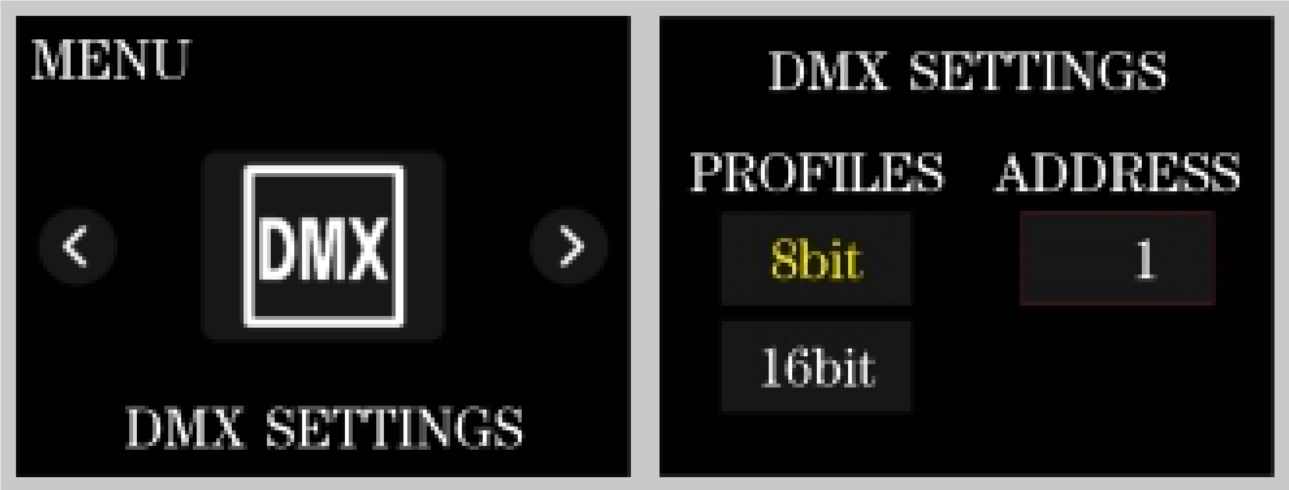

- DIM CURVE (Figure 2):  
Set the dimming curve, [linear / logarithmic / exponential / S curve].

Figure 2

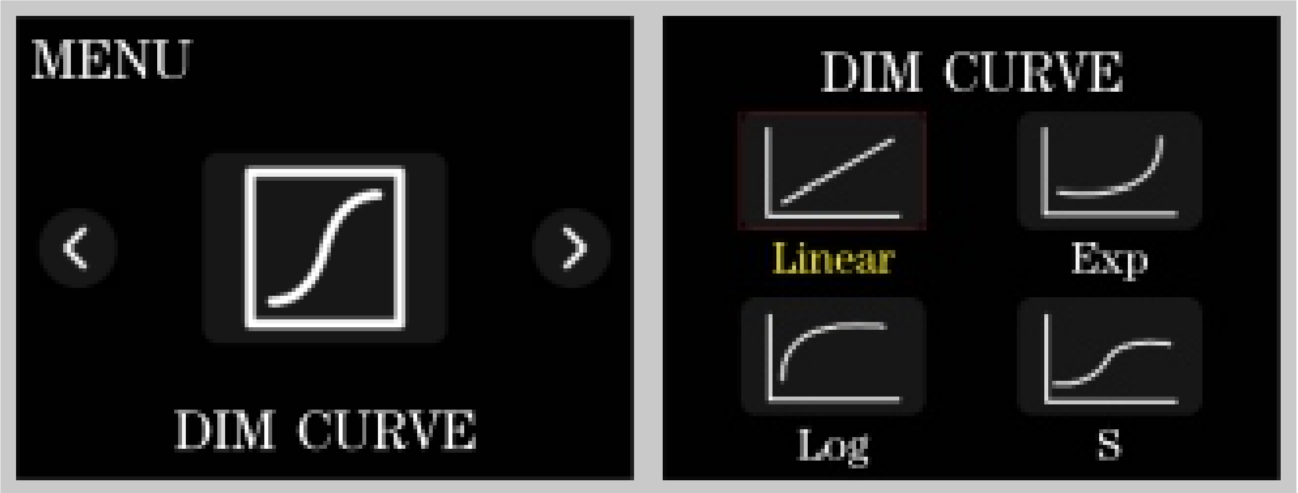

- WL SETTINGS (Figure 3):  
RF channel settings, RF switch, Bluetooth switch, Bluetooth reset.

Figure 3



- STUDIO (Figure 4):

Set the studio mode and non-studio mode.

Studio mode: power off and turn the light back on, restore the memory brightness value before the power failure.

Non-Studio mode: turn on the light again after power failure, restore the default brightness value of factory settings.

Figure 4

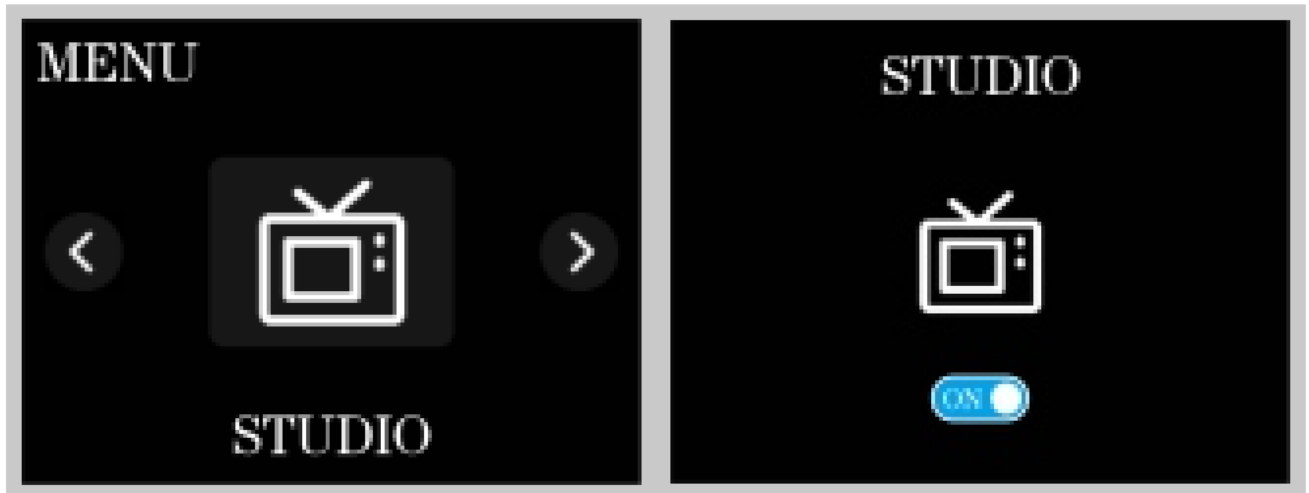

- FREQUENCY SETTINGS (Figure 5):

Set the dimming frequency.

Figure 5

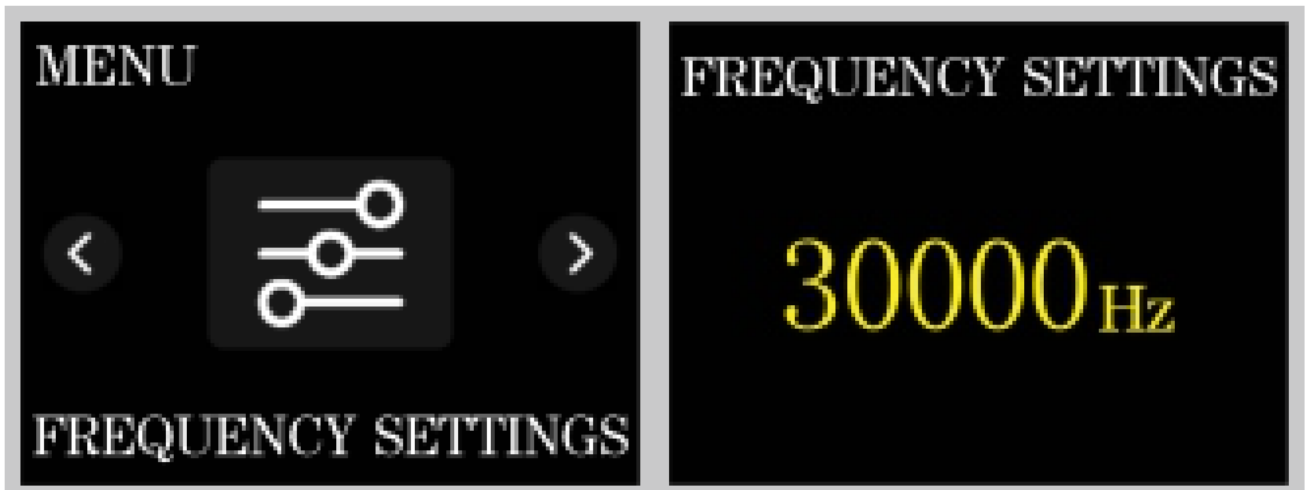

- FAN SETTINGS (Figure 6):

set the cooling fan mode.

Figure 6



- LANGUAGE (Figure 7):  
Set the system language.

Figure 7



- SYSTEM SETTINGS (Figure 8):  
View x system information and restore Factory Settings.

Figure 8



## MODE

- Press MODE button ,enter the main page of mode selection (Figure 9) → rotate [knob ①] to select the mode → press [knob ①] to enter the corresponding mode interface → set the parameter of the item by pressing or rotating [knob ①] → press [BACK] to go up one level.



## Figure 9

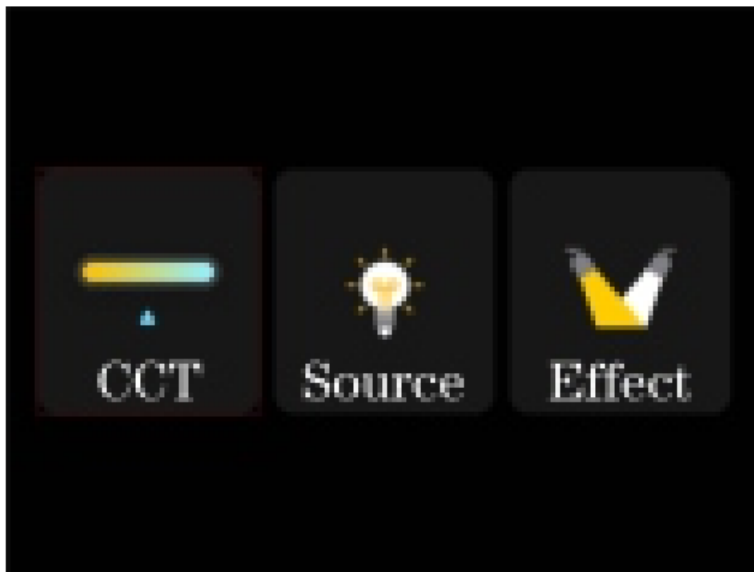

- CCT mode (Figure 10):

White light mode, adjustable light intensity and color temperature. [Knob 1] can be provided to adjust the brightness, and [Knob 2] can be used to adjust the color temperature.

## Figure 10

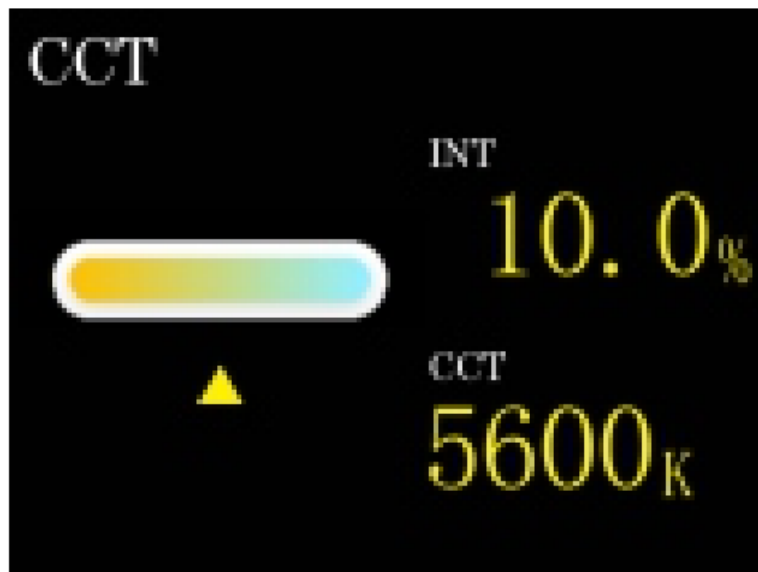

- Light source mode (Figure 11):

This mode provides 12 different types of light source types to choose from, which can save a lot of adjustment time when you need a specific light source.

Rotate and short press the [SELECTOR] key to select Source mode to select the desired light source effect.

## Figure 11



- Light Effect Mode (Figure 12):

This mode provides 12 light effects: lightning, CCT cycle, candle, bad bulb, TV, paparazzi, explosion, breathing light, strobe, flame, firework, welding.

Rotate and short press the [SELECTOR] button to select FX mode, you can choose a variety of light effect.

## Figure 12

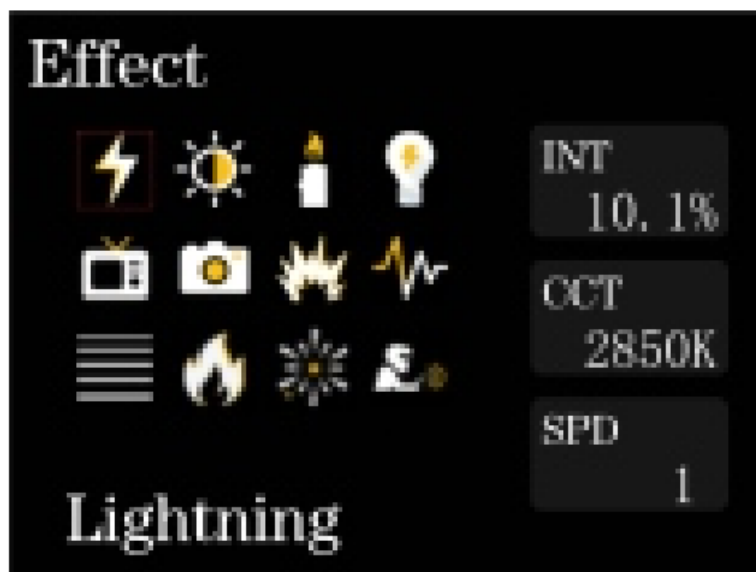

### APP CONTROL

#### APP download method

(Scan the QR code on the back of the manual to download the APP)

Android version : Official website QR code, Google Play, Huawei Store, etc.

iOS version : App Store

#### Register Account

Register and sign in with your email address; (Figure 1)

There may be a delay in sending the verification code, and the delivery speed depends on the email server you are using. the email server used;

Some email servers may recognize our verification emails as advertising Please check your blocked email inbox.

Figure 1

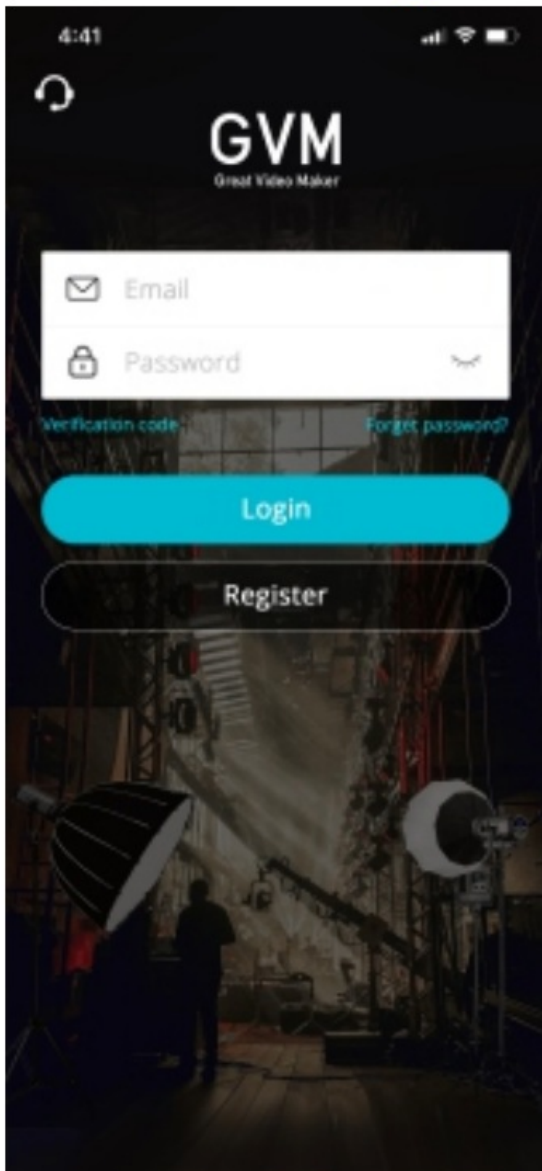

## Adding Devices

① Before adding devices, please make sure you have turned on the Bluetooth and network data function of your phone, and reset the Bluetooth of your lighting device.

② Click the “Add Device” button on the “My Devices” page to find the nearby Bluetooth lighting devices that have been opened, and select the device to be connected to the network connection. (Figure 2)

Figure 2

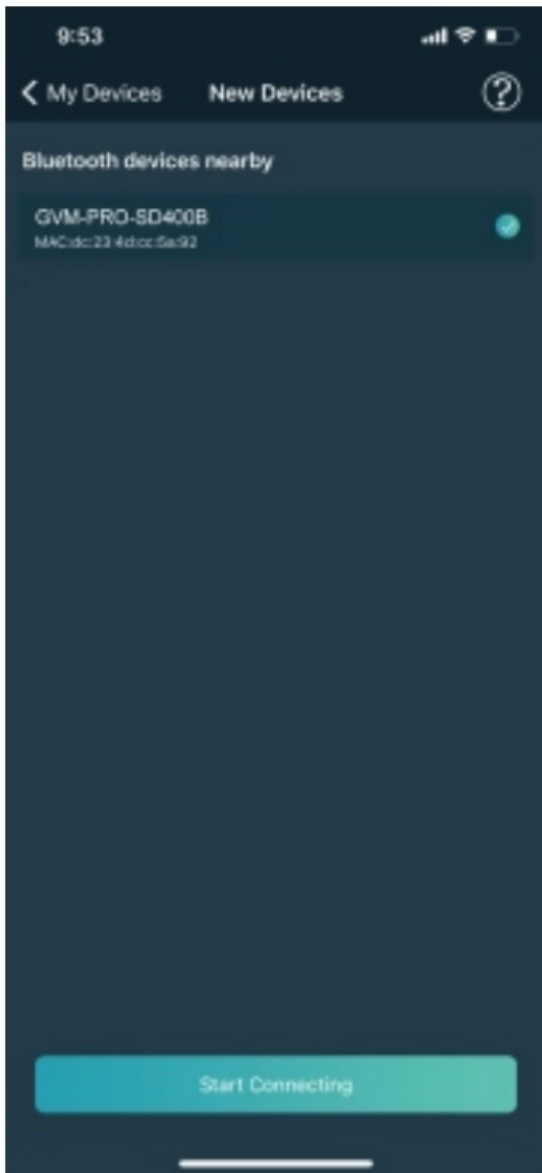

\* Android system needs to open the location permission to connect the device with Mesh technology, we will not collect any of your location information in this process.

### Equipment management

① After successfully adding your lighting device, your device will be displayed in the “My Devices” list; (Figure 3)

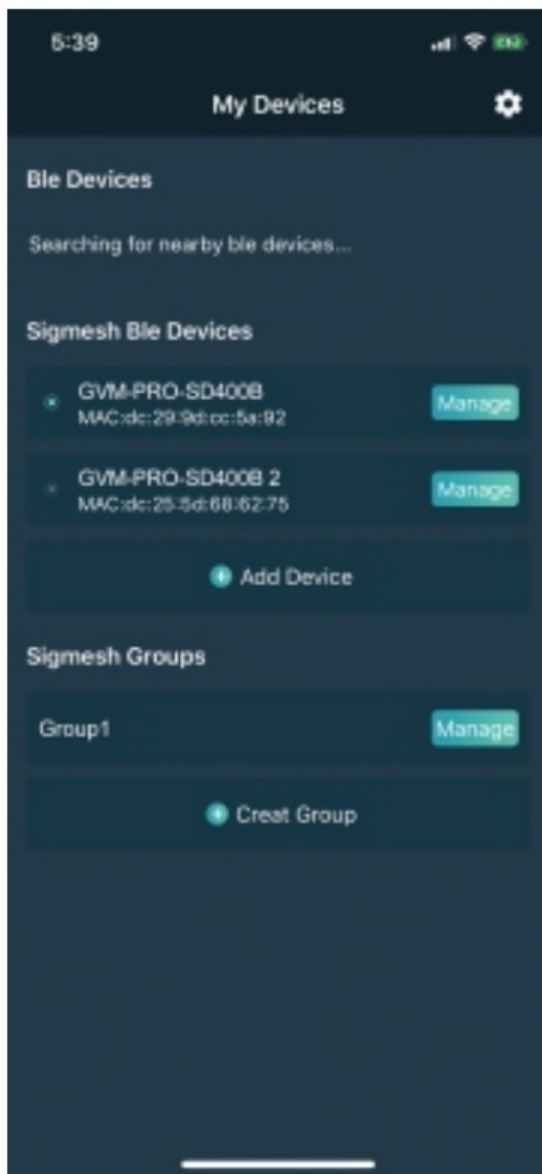

Figure 3

② Click the device bar to enter the device control. (Figure 4)

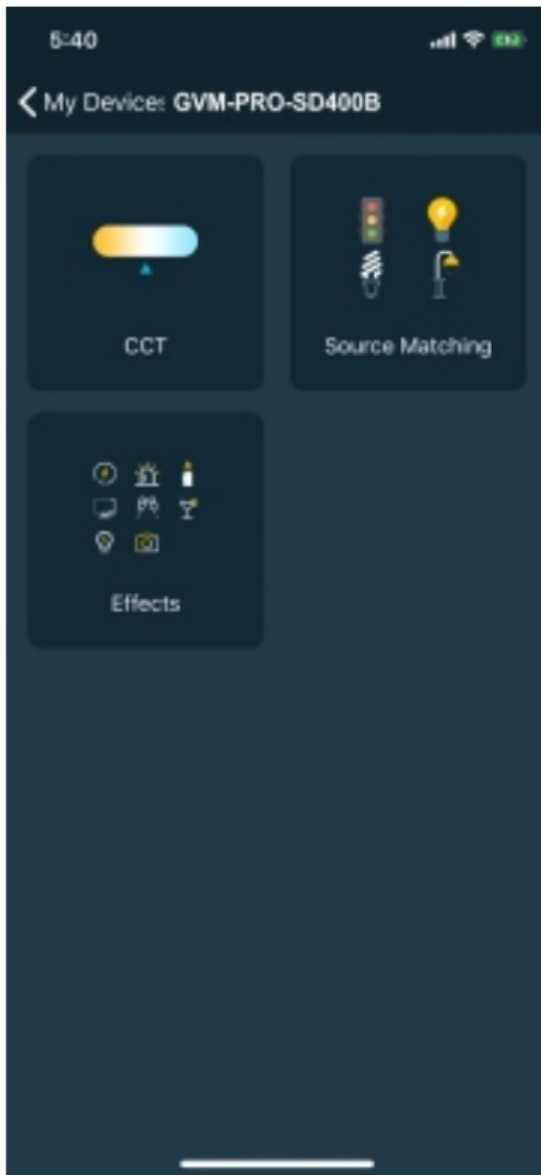

Figure 4

## USE AND SAVE

Do not place the product in high humidity, strong electromagnetic field, direct sunlight, high temperature environment. If the product is not to be used for a long time, disconnect the power supply.

**Clean:** Please unplug the power plug before cleaning. And use a damp cloth instead of any detergent or soluble liquid, so as not to damage the surface layer.

**Power supply:** Ensure that the power supply is within the scope of use, too high or too low will affect the work.

**Maintenance:** If there is a malfunction or performance degradation, please do not open the shell package by yourself, so as not to damage the machine and lose the right of maintenance. In the event of a malfunction, please feel free to contact us, and we will do our best to solve the problem.

**Accessories:** Please use the accessories provided by the manufacturer or approved accessory products in order to give full play to the best performance.

**Warranty:** Do not modify the product, otherwise the right to repair will be lost.

## SIMPIE FAULTS AND TROUBLESHOOTING

Phenomenon	Check the product	Troubleshooting
The switch indicator does not light up.	① Whether the connection between the lamp and the power supply is normal.	Make sure the adapter is well contacted with the power plug.
	② When using a lithium battery to supply power, make sure that the battery does not have "low battery" protection.	Use the product after charging the battery.
After the APP enters to add a device, the Bluetooth of the device cannot be searched.	Check whether the device is normally turned on and whether it has been bound by another person's connection.	Normal steps: ① The mobile phone turns on the Bluetooth and network data functions, and the Android system needs to turn on the location permission; ② Reset the device Bluetooth.
The APP fails to connect to the network configuration of the device.	Check whether the device is turned on normally and whether it has been bound by another person's connection; Check whether the Bluetooth and network conditions of the mobile phone are good.	After resetting the device's Bluetooth and restarting the App, try to connect again.
The device cannot be searched after being removed from the APP.	Whether the device is offline or in network status. Remove the device if it is not in good condition.	After resetting the Bluetooth of the device, search and add the device again.
Clicking on the device in the APP cannot enter the control.	Check whether the device is online (a small green dot is displayed); If it is offline, you can check according to the steps of the distribution network connection failure.	Restart the device, wait for 5 seconds, and then control it when it is displayed as online; reset the Bluetooth of the device, and re-add the device to the device list.

## PACKING LIST

Name	Quantity					Notes
Photography lights	1					
AC Power Cable	1					
Controller cable	1					
Controller	1					
Controller clip	1					
Standard cover	1					
Spotlight protective cover	1					
Magic cable tie	4					
Carrying case	1					
Manual	1					

## PRECAUTIONS



- ① When using DC/battery power supply, ensure that the DC/battery power supply voltage is 24-36V/180W range to achieve maximum brightness;
- ② The product is not waterproof, please use it in a rain-proof environment;
- ③ The product is not anti-corrosion, do not let the product come into contact with any corrosive liquid;
- ④ When the product is in use, ensure that the product is placed firmly to prevent the product from falling and being damaged;
- ⑤ When the product is not used for a long time, please turn off the power of the product to save energy consumption;

GVM Official website



Facebook



Download APP



## Customer Support

Web: [www.gvmled.com](http://www.gvmled.com)  
B&H Email: [bh@gvmled.com](mailto:bh@gvmled.com)  
GVM Email: [support@gvmled.com](mailto:support@gvmled.com)  
Amazon Email: [amazonsupport@gvmled.com](mailto:amazonsupport@gvmled.com)  
Warehouse Add: 4301 N Delaware ave, unit D. PHILADELPHIA, PA19137, USA

# GVM

## Documents / Resources

	<p><a href="#">GVM GVM-PRO-SD400B Greal Video Maker</a> [pdf] Instruction Manual GVM-PRO-SD400B Greal Video Maker, GVM-PRO-SD400B, Greal Video Maker, Video Maker, Maker</p>
---	--

## References

- [GVM GVM Lights Official Store - Great Video Maker - Video Lights](#)