

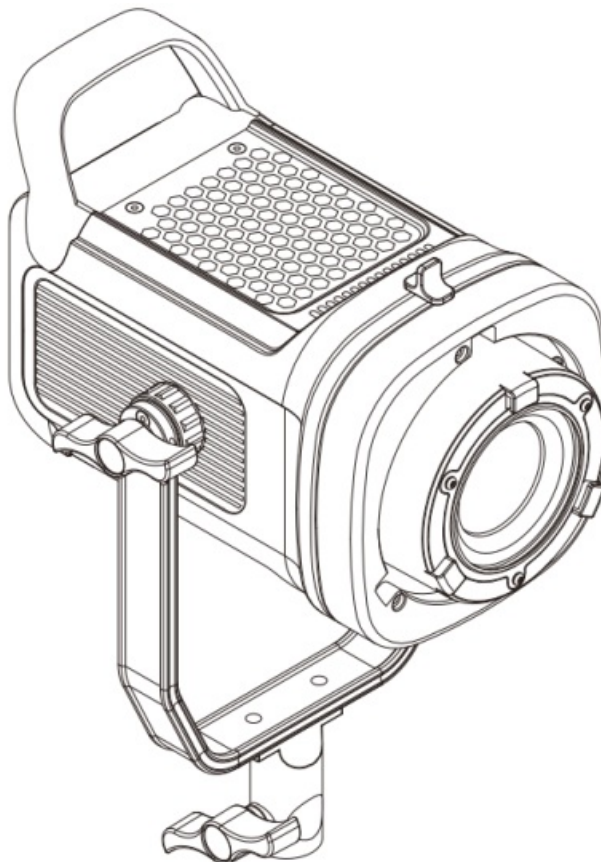

GVM-PR160D Professional Lighting Fixture User Manual

[Home](#) » [GVM](#) » GVM-PR160D Professional Lighting Fixture User Manual 

GVM[®]
Great Video Maker



GVM-PR160D

Contents

- 1 IMPORTANT SAFETY INSTRUCTIONS
- 2 PRODUCT INTRODUCTION
- 3 DISCLAIMERS
- 4 PRODUCT PARAMETER
- 5 PRECAUTIONS
- 6 PRODUCT STRUCTURE DIAGRAM
- 7 INSTALLATION METHOD
- 8 DESCRIPTION OF PRODUCT CONTROL KEYS
- 9 FUNCTION INTRODUCTION & INSTRUCTIONS FOR USE
- 10 APP CONTROL
- 11 QUICK TROUBLESHOOTING
- 12 USE AND PRESERVATION
- 13 PACKING LIST
- 14 PRODUCT WARRANTY
- 15 Documents / Resources
 - 15.1 References

IMPORTANT SAFETY INSTRUCTIONS

First and foremost: this product is professional lighting and staging equipment and should be used by a professional lighting technician or under the guidance of a professional. When using this product, you must always follow the cautions below:

1. Read the product manual carefully before use.
2. This product is only suitable to use in a temperature range of -20°C to 45°C.
3. Do not place the equipment near flammable and volatile solvents such as alcohol and gasoline.
4. Before storing the device, make sure it has cooled down completely. When being stored, unplug the power cord from the device. The equipment should be stored in its carrying case or a well-ventilated and dry place.
5. This lighting fixture is not for general illumination and should not be used as such. Individuals with eye injuries or sensitivity should avoid using this lighting fixture.
6. This is a professional light and children are prohibited from using it. Parents or guardians must closely supervise children when they are near the equipment to prevent personal injury caused by colliding with or misusing the equipment.
7. Before using the equipment, please remove the protective cover.
8. When the lighting fixture is on, it is forbidden to stare directly at the light source under any circumstances. High-intensity lighting should only be used under the guidance of a professional lighting technician. Avoid staying in a high-intensity light environment for a long time. If feeling any discomfort, please immediately turn off the lighting fixture, and seek medical attention.
9. When the lighting fixture is on, use it carefully and avoid contacting high-temperature components such as LED light sources to prevent being burnt.
10. Do not use damaged equipment or accessories. Wait for a professional repairman to inspect and repair it before it is confirmed that the equipment can function normally.
11. If the light source is damaged or deformed due to heat, please stop using it and contact the manufacturer, service agents, or qualified repairman promptly to replace the light source to avoid accidents.
12. If the product is cracked due to falling, squeezing, or strong impact during use, please stop use it to avoid being electrically shocked by touching internal electronic components.

13. Do not disassemble the product by yourself. If the product malfunctions, it must be checked and repaired by the manufacturer or authorized repair personnel.
14. Before cleaning and maintenance, be sure to unplug the power supply. To unplug never pull on the cable but always pull the plug itself. This device shall only operate with earthed power outlets or emergency power generators.
15. When cleaning the device, do not wipe it with a wet cloth. Use a dry and soft cloth to wipe off the dirt.
16. If an extension cord is required, it needs to have the necessary capacity to power the respective unit. Using an extension cord with a lower current capacity than the devices need may cause overheating.
17. For some products with long power cords, please place the power cords properly and avoid contact with overheated surfaces that may damage or trip personnel. Please use the original power cords of our manufactory. The damage caused by using non- original power cords is not covered by our repair service.
18. Do not use product accessories that are not recommended by our brand to avoid fire, electric shock, or personal injury.
19. Some products use batteries for power supply. Do not use any batteries, power sources, or accessories that are not specified in the user manual. Please keep batteries and other accessories out of reach of children and infants. If a child or infant swallows a battery or accessory, seek medical attention immediately. If the battery leaks, changes color, deforms, smokes, or emits an odor, remove it immediately. Be careful not to get burned during the removal. Continued use of such batteries may cause a fire, lectric shock, or skin burns. Do not use any deformed or modified batteries. Do not disassemble or modify this product or the battery. Do not heat the battery or solder it. Do not let the battery come into contact with fire or water, or subject it to strong external force. Do not insert the battery's positive and negative ends incorrectly, or mix and use old and new batteries or different types of batteries.
20. For some products with built-in lithium batteries, please use a dedicated charger for charging, and following the correct operating instructions within the prescribed voltage and temperature range.
21. The warranty last for one year. Consumables like batteries, adapters, power cords, and other accessories are not covered by the warranty.
22. The one-year warranty will be invalidated if the equipment is found to have been repaired privately. The related repair costs will be charged.
23. Equipment malfunctions caused by non-standard operations are not covered by the warranty.
24. The safety instructions are based on our factory's strict testing. If there are any changes in the equipment's design and specifications, we reserve the right not to notify you. Customers can visit our official website to check the latest digital version of the instructions and learn about the newest product information.

Keep these instructions!



WARNING:



High-power LED lights are strictly prohibited from being directly viewed or shining into other people's eyes.



Do not unplug the power cord or connecting wires while the light is on to avoid personal injury.



Do not cover the heat dissipation port when the lamp is in operation.



Keep children away from touching or using this light.



As professional lighting equipment, please make sure to operate it correctly according to the user manual.

PRODUCT INTRODUCTION

Thank you for purchasing our “GVM-PR160D”. This product is specially designed for photographers and Videographers. The product usage scenarios are suitable for live broadcast / outdoor / studio photography, etc., and can also be used for YouTube video shooting.

The main features of the product are:

1. Step-less adjustability of the lighting effects and the brightness level. This is a daylight balanced LED fixture with color temperature set at 5600K and a high accuracy color render index rating of 97+. Which helps to restore subjects to its true color. Providing you with natural and accurate looking images.
2. APP based intelligent control system, which can be accessed with your smart devices.
3. Built in LCD display and a stable operating system. The fixture also supports 360° rotation and can change its position angel effortlessly. Light also feature a standard Bowen’s mount. When the included standard reflector attached can drastically improve its output brightness. The unit is also widely compatible with different bowers mount light modifiers.
4. 12 built-in special effects: Lightning, Intensity Loop, Candle, Bad Bulb, TV, Paparazzi, Explosion, Pulsing, Strobe, Fire, Fireworks, Welding.

We firmly believe that the correct use of this product will be of great help to your workflow. It is strongly recommended that you read the following user guide carefully before using the product.

DISCLAIMERS

1. Before using this product, please read the text carefully to ensure that the correct operation of the product has been carried out. Failure to follow and not following the instructions and warnings in this document may cause harm to you and others around you, or even damage the product or other surrounding items.
2. By using this product, you are deemed to have carefully read the disclaimer and warning, understand and acknowledge all the terms and contents of this statement, and promise to take full responsibility for the use of this product and the possible consequences.
3. Design and specifications are subject to change without notice.

PRODUCT PARAMETER

- Brand : GVM
- Product Model : GVM-PR160D
- Product Name : Professional Video Light
- Product Type : LED COB Light
- Features : A Variety Of Light Effects, Modes, High Bright LED Light Beads
- Control Methods : On Body Manipulation And Control, APP based Bluetooth
- Mesh Network Control, Wireless Master-Slave Mode(Remote Control)
- APP Control Distance : ≤50M
- Remote Control Distance : ≤50M
- Light Adjustment Method : Stepless Adjustment
- Color Rendering Index : ≥97
- Color Temperature : 5600K
- Illuminance : 8690 lux@1m 27100 lux@0.5
- Input Power : 160W

- Product Weight : 1.4KG
- Product Size (mm) : 220×160×290
- LED Beads Quantity : COB×1
- Power Supply Method : DC Input
- Power Output : DC 30V/5A
- Voltage : AC 100~240V
- Cooling : Fan Forced Cooling
- Product Material : Aluminum Alloy + Plastic
- Commodity Origin : Huizhou, China

PRECAUTIONS

1. Please use the matching power adapter the same specification to power the product. Do not use power adapter with different output voltage parameters.
2. The product is not waterproof, please use it in a rainproof environment.
3. The product is not anti-corrosion, therefore do not let the product touch any corrosive liquid.
4. When using the product, make sure the product is put firmly and prevents falling and damage.
5. If the product will not be used for a long time, please switch off the power to reduce energy loss.

PRODUCT STRUCTURE DIAGRAM

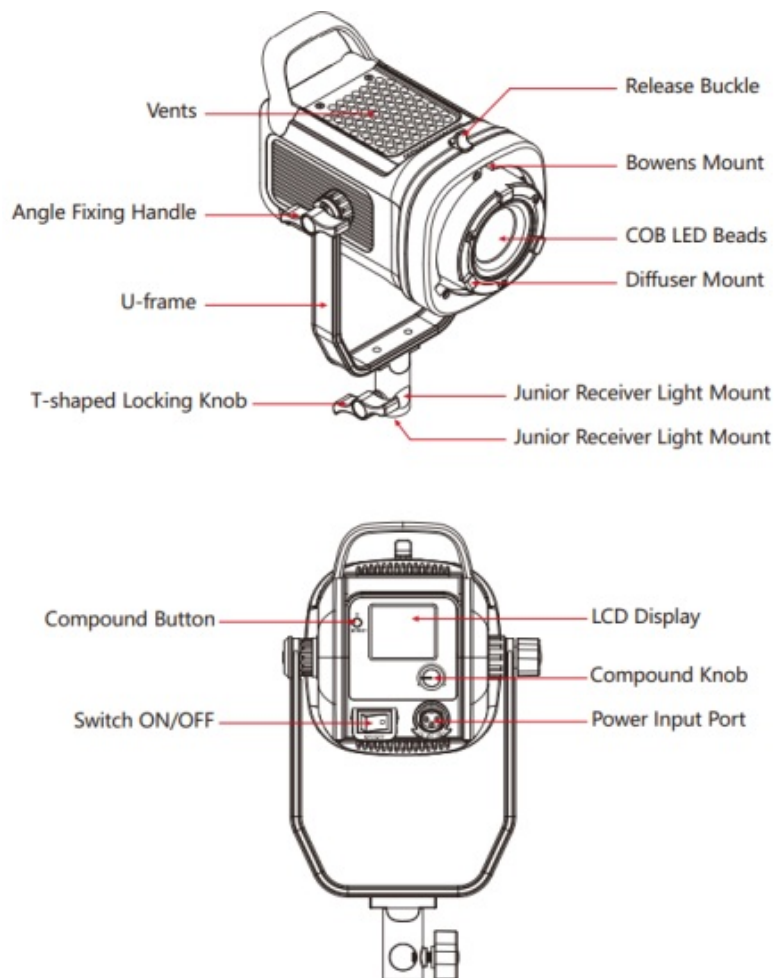

INSTALLATION METHOD

1. The light can be attached and fixed on the bracket by rotating the knob clockwise, and can be detached by rotating in the counterclockwise direction.

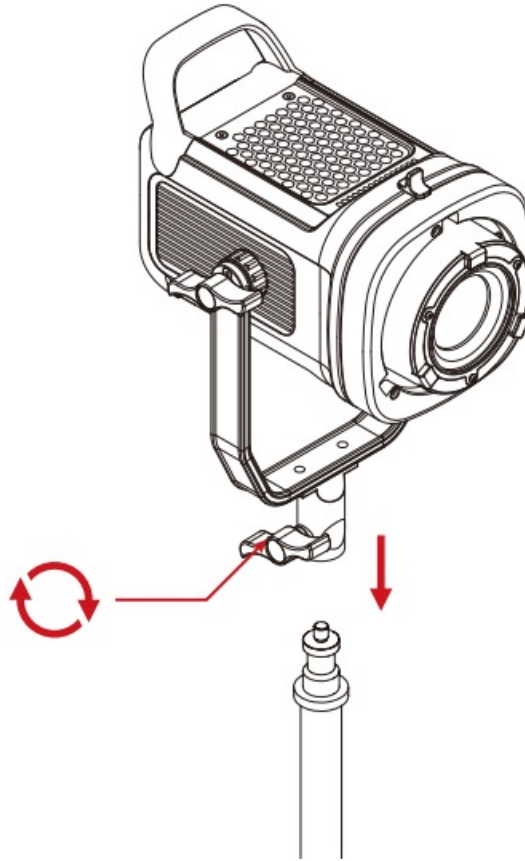

2. Loosen the angle fixing handle, adjust the angle of the spotlight to your needs, and then tighten the angle fixing handle firmly.

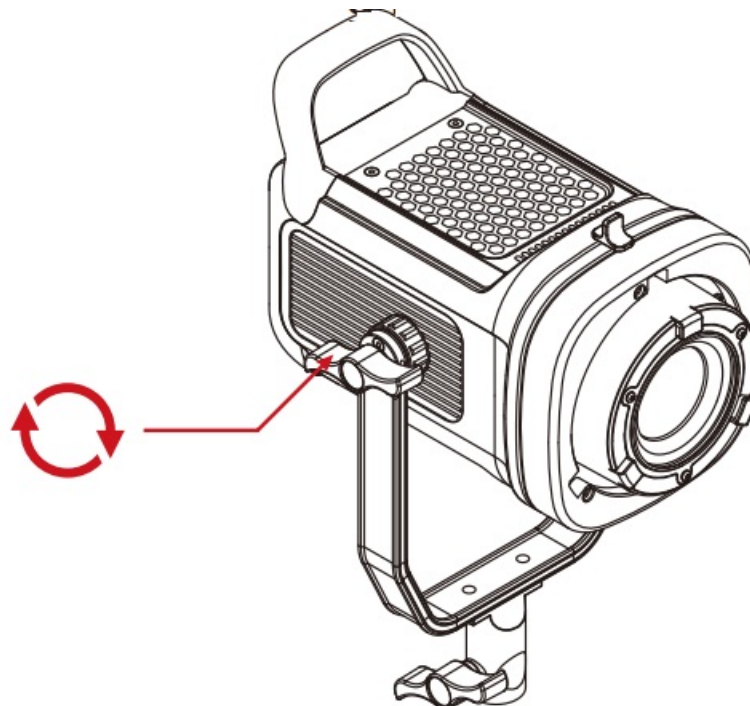

3. Insert the bayonet of the diffuser into the bowens mount of the light, and then turn it clockwise.

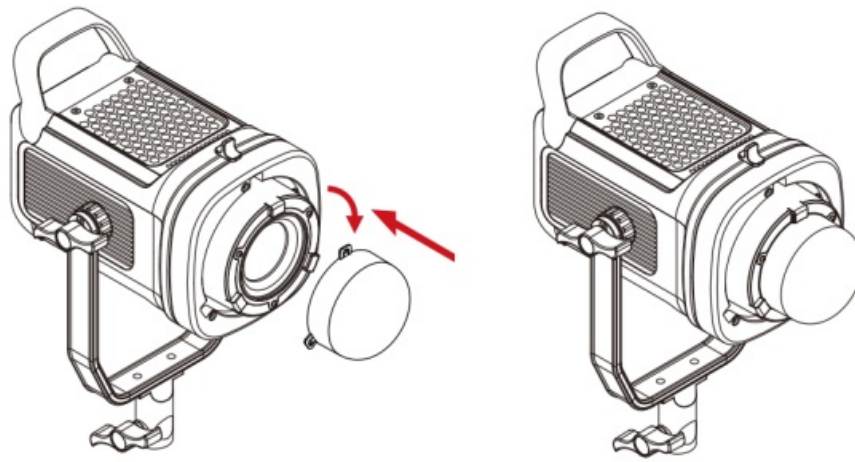

4. Install and uninstall of standard bowens reflector.

Install: Insert the standard Bowens Reflector into the corresponding Bowens mount socket of the light, then turn it clockwise gently.

Uninstall: To remove the reflector from the light, pull back the retaining clip and rotate the reflector counterclockwise.

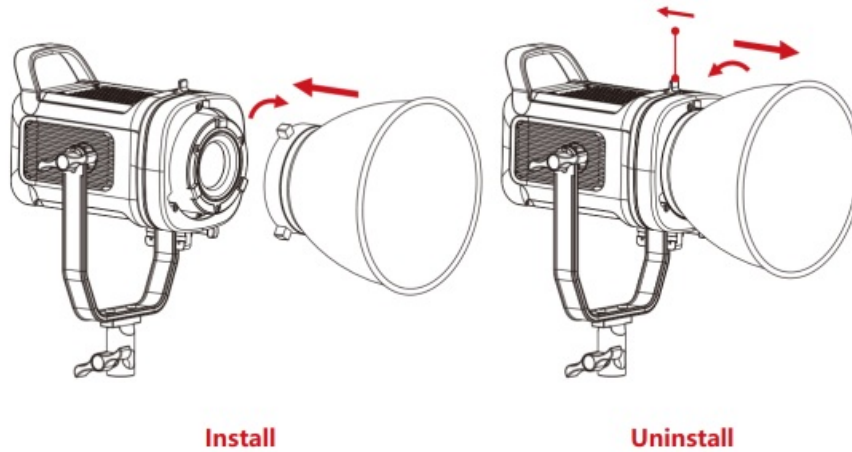

5. Connect the power cord to supply power.

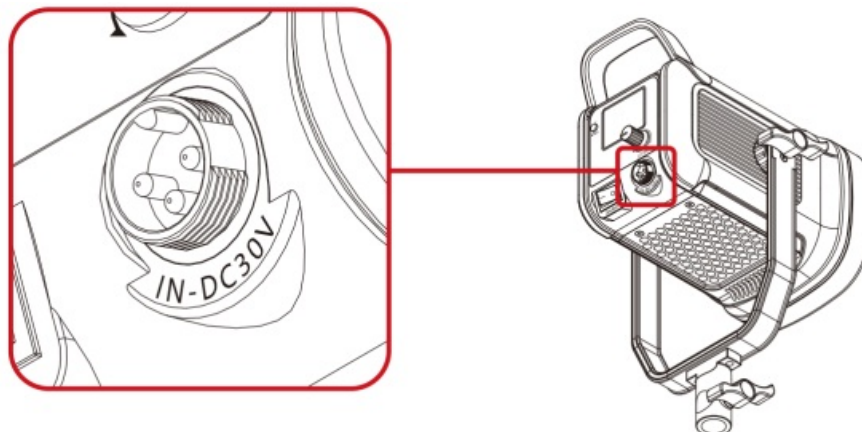

DESCRIPTION OF PRODUCT CONTROL KEYS

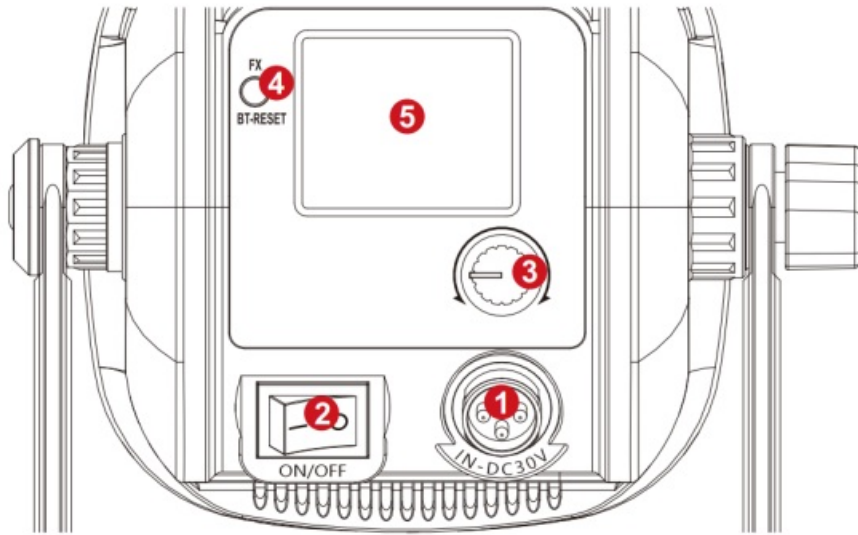

1. Power input interface.
2. ON/OFF Switch.
3. Composite knob:
 1. Short press the knob to switch to the parameter to be adjusted;
 2. Press and hold the knob for 2 seconds to enter the wireless channel adjustment;
 3. Turn the knob to adjust the current parameter.
4. Composite key:
 1. Press the button to switch between daylight mode/light effect mode;
 2. Press and hold the button for 2 seconds to reset Bluetooth.
5. LCD display: Displays the current mode and parameters of the light.

FUNCTION INTRODUCTION & INSTRUCTIONS FOR USE

1. LCD Screen

- Display the current brightness, TIM, scene number, and channel value of the light.

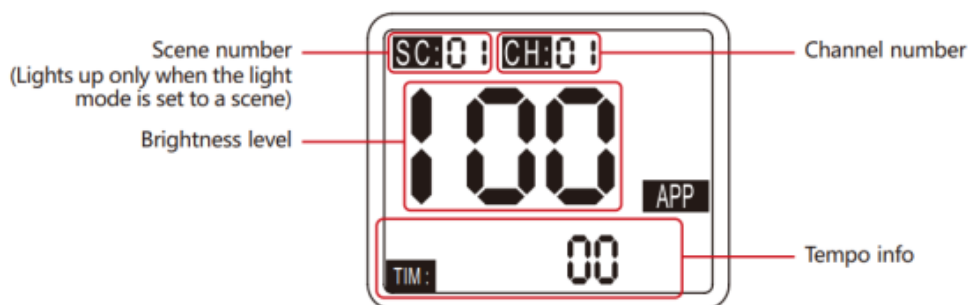

2. Day Light Mode:

- Press the compound button once to switch the light mode to daylight → Rotate the compound knob to adjust the brightness.
- Connect to the APP and adjust the brightness of daylight mode through the APP.

3. Adjust Wireless Channel:

Prepare two or more camera lights, and set the channel value of all units to the same through the composite knob. Then you can use other GVM lights with “master mode” or the GVM-YK22 remote control, that are also adjusted to the same channel value, you can synchronously control all the lights with the same channel value.

- Press and hold the composite knob for 2 seconds. When the word CH blinks, rotate the composite knob to

adjust between channels 1 to 12.

(When CH=0, the CH indicator on the screen will go away, and press and hold again for 2 seconds to display CH:01)

4. Effects Mode (SC):

Can simulate 12 kinds of scene lighting: Lightning, Intensity Loop, Candle, Bad Bulb, TV, Paparazzi, Explosion, Pulsing, Strobe, Fire, Fireworks, Welding.

- Press the composite button once to switch the light mode to SC → Press the composite knob to switch the options: Brightness, scene, speed (INT/SC/TIM) → Rotate the knob again to adjust the current settings.
- Connect to the APP and adjust the scene light effect through the APP.

APP CONTROL

APP Download Method

(Scan the QR code on the back of the manual to download the APP) Android Device Official website QR code, Google Play, Huawei Store, etc. iOS Device App Store

Device-adding

1. Before adding a device, please make sure you have turned on your phone's Bluetooth and network data, accessibility to Bluetooth and network data, then reset the lighting device's Bluetooth.
2. Click the "Add Device" button on the "My Devices" page to find the Bluetooth light devices that have been turned on nearby. (Figure 1)

Figure 1

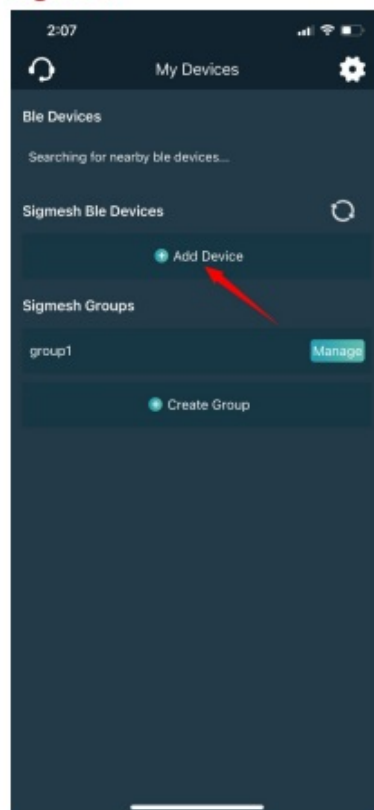

Figure 2



3. Select the device to be connected for pairing. (Figure 2)

* Android requires location permissions to be turned on in order to connect your device using mesh technology, and we do not collect any of your location information during this process.

Device Management

1. After successfully adding your lighting device, your device will be displayed in the “My Devices” list. (Figure 3)

Figure 3



Figure 4

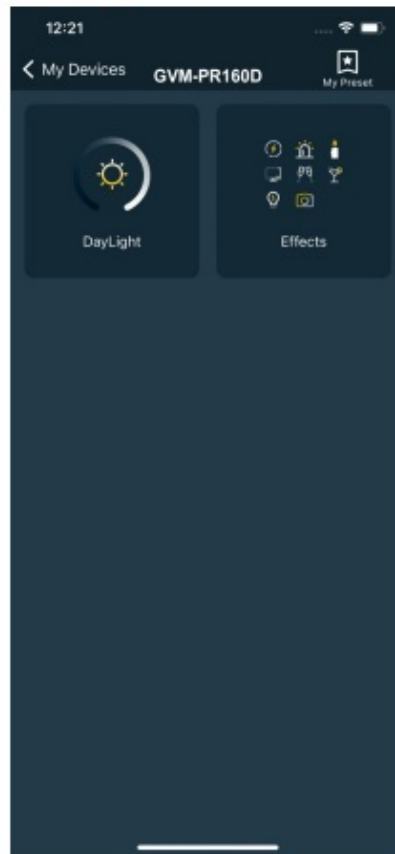

2. Click on the Device to access the device control. (Figure 4)

Account Login

- Use e-mail to get the verification code to log in (the first login automatically registers the account). (Figure 5)

Figure 5

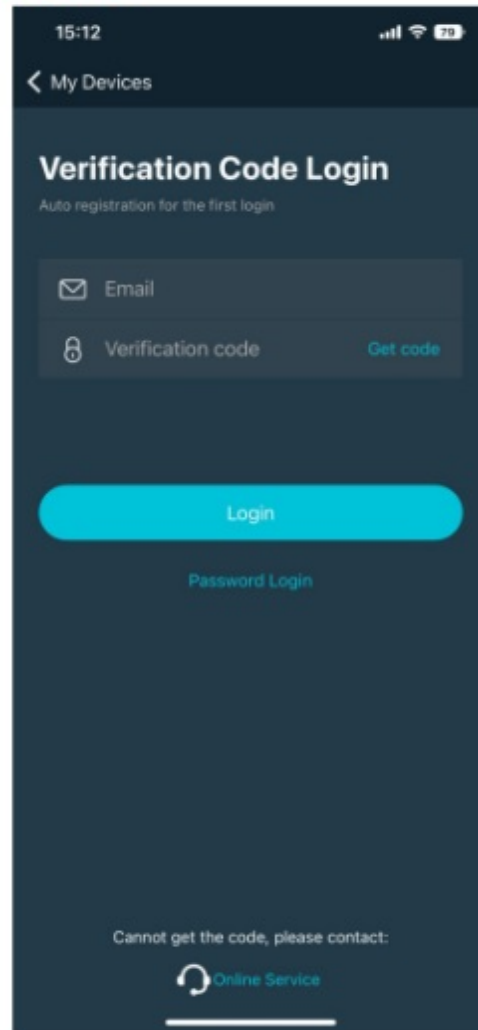

- There may be a delay in sending the verification code, and the speed of delivery depends on the e-mail server you are using.
- Some email servers may recognize our verification emails as advertising promotions, please check your spam folder/inbox.
- After logging in, you can synchronize the Mesh Bluetooth devices bound to the current account to other smart devices.

QUICK TROUBLESHOOTING

Issues	Check List	Troubleshooting
The screen does not light up.	Whether the connection between the light and the power supply is secure.	Make sure the adapter is well connected with the power plug.
Unit cannot be found while attempt to connecting to the wireless APP.	Check if the device is turned on properly with and that has not been paired with other device.	Follow these steps: 1. Turn on phone's Bluetooth and network data function, android devices need to on the GPS positioning. 2. Allow access to Bluetooth and network data, GPS positioning. 3. Reset the device Bluetooth according to the user manual.
The APP failed to pair to a device.	Check if the device is turned on properly and has not been connected or paired by others; Check if the Bluetooth and network conditions of the cell phone are good.	Reset the device Bluetooth and restart the app then try to connect again.
The device is no longer searchable after removing it from the APP.	Check if the device have been removed while it is off-lined or in poor network conditions.	Reset the device Bluetooth and then search again to add the device.
In -app device controls can not be accessed.	Check if the device is online (small green light displayed); If its off-line, please advice to the Distribution Network Connection Failure steps.	Reboot the device, wait for 5 seconds, wait till it shows as online status. To control it; Reset the device Bluetooth and then add the device back to the device list

USE AND PRESERVATION

Do not place the product in a high humidity, strong electromagnetic field, direct sunlight, or high-temperature environment. If the product will not be used for a long time, please disconnect its power .

Clean: Before cleaning, disconnect the power plug. And use a damp cloth instead of any detergent or soluble liquids to avoid damaging the surface layer.

Power: Make sure the power is within the demanded range, not too high or too low.

Repairing: If there is a fault or performance degradation, do not unpack the shell by yourself, avoiding damage to the machine and losing the right of maintenance.

When there is a fault, do not hesitate to contact us, and we will do our best to deal with the problem.

Accessories: Please use the accessories provided by the manufacturer and approved ones, to maximize the performance.

Warranty: Do not modify the product, or you will lose the right to maintenance.

PACKING LIST

Name	Quantity	Notes
COB Light	1	
Power Cord	1	
Adapter	1	
Lamp bead protective cover	1	
Standard Cover	1	

PRODUCT WARRANTY

Dear user, this warranty card is important proof for applying for warranty service. Please cooperate with the salesperson to fill it out and keep it properly. Thank you!

Product Information	Model Number	Product Barcode
User Information	Name	Contact Number
	Mailing Address	
Seller Information	Name	
	Contact Number	
	Mailing Address	
	Sales Date	
Remarks		

Note: this form should be confirmed by the salesperson's stamp.

Applicable Products

This document applies to the products listed in the relevant "Product Warranty Information" (see instructions below). Other products or components that do not fall within this scope (such as promotional products, gift items, and other components added after the factory) are not covered by this warranty promise.

Warranty Period

The corresponding warranty period for products and components shall be executed according to the relevant "Product Warranty Information". The warranty period starts from the first day of purchase of the product, and the date of registration on the warranty card at the time of purchase shall prevail.

How to Obtain Warranty Service

You can directly contact the product salesperson or authorized service agency, or call GVM's aftersales service hotline to contact us and have our service personnel arrange service for you. When applying for warranty service, you should provide a valid warranty card as a warranty certificate to be eligible for warranty service. If you cannot provide a valid warranty card, we may also provide you with warranty service under the circumstance that our products or components are confirmed to be within the warranty scope, but this is not our obligation.

Cases where warranty does not apply:

If the product meets the following conditions, the warranty and service under this document will not apply:

1. The product or parts have exceeded the corresponding warranty period.
2. Malfunctions or damages caused by incorrect or improper use, maintenance, or storage, such as improper handling, use for purposes other than the reasonable expectations of the product, incorrect insertion or removal of external devices, falling or crushing due to external force, or exposure to inappropriate temperature, solvents, acids, alkalis, water immersion, or damp environments.
3. Malfunctions or damages caused by unauthorized installation, repair, modification, addition, or disassembly by institutions or personnel not authorized by GVM.
4. Modifications, changes, or removals of the original identification information of the product or its parts.
5. Lack of valid warranty card.
6. Malfunctions or damages caused by the use of unauthorized, non-standard or non-publicly released software.
7. Malfunctions or damages caused by force majeure or accidents.
8. Other malfunctions or damages not caused by quality issues of the product itself. In such cases, you should seek solutions from the relevant responsible parties, and GVM will not be held liable. Malfunctions or damages

caused by components, accessories, or software not covered by the warranty or beyond the warranty scope that renders the product unable to function properly are not covered by the warranty. Fading, wear, and consumption that is normal during the product usage process are not covered by the warranty.

Product Warranty and Service Support Information

The product warranty period and service types are implemented according to the following “Product Warranty Information” for each product category, component, and optional equipment:

Product Category	Accessories Name	Warranty Period(Month)	Warranty Service Type
Component	Circuit Board.	12 Month	Customer service repair
Other	Spotlight mount, softbox, adapter, Standard reflector, power cord, battery Handle, light stand, TYPE-C cable, battery slot, battery, Fresnel lens, grid, carrying bag and all other accessories, etc. Consumable or electrically sensitive parts are not covered by the warranty.	None	No Warranty



GVM Official website	Facebook	
		
https://gvmled.com/	https://www.facebook.com/GVMLED/	https://gvmled.com/

GVM[®]

Great Video Maker

Huizhou Latu Film Equipment Co., Ltd.

Web: www.gvmled.com

B&H Email: bh@gvmled.com

GVM Email: support@gvmled.com

Amazon Email: amazonsupport@gvmled.com

Warehouse Address: 12285 MCNULTY RD, STE
105 PHILADELPHIA, Pennsylvania 19154, USA

Documents / Resources

 <p>The image shows a professional lighting fixture, specifically the GVM-PR160D model. It is a compact, cylindrical device with a handle on top and a mounting bracket. The GVM logo is visible at the bottom of the image.</p>	<p>GVM GVM-PR160D Professional Lighting Fixture [pdf] User Manual</p> <p>GVM-PR160D, GVM-PR150D, GVM-PR160D Professional Lighting Fixture, Professional Lighting Fixture, Lighting Fixture, Fixture</p>
---	---

References

-  [GVM Lights Official Store - Great Video Maker - Video Lights](#)
- [User Manual](#)

[Manuals+.](#) [Privacy Policy](#)

This website is an independent publication and is neither affiliated with nor endorsed by any of the trademark owners. The "Bluetooth®" word mark and logos are registered trademarks owned by Bluetooth SIG, Inc. The "Wi-Fi®" word mark and logos are registered trademarks owned by the Wi-Fi Alliance. Any use of these marks on this website does not imply any affiliation with or endorsement.