

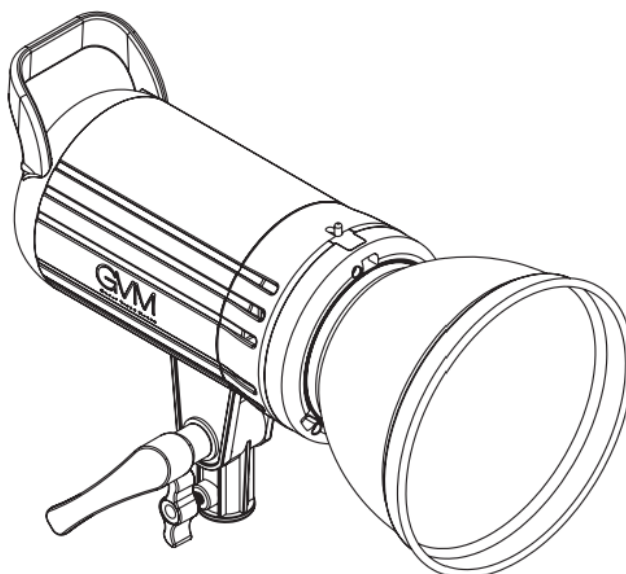

## GVM-G100W Bi-Color LED Video Light User Manual

[Home](#) » [GVM](#) » GVM-G100W Bi-Color LED Video Light User Manual 



**GVM**  
GREAT VIDEO MAKER

## Contents

### 1 GVM-G100W

#### 1.1 PRODUCT INTRODUCTION

#### 1.2 PRODUCT PARAMETER

#### 1.3 DISCLAIMERS

#### 1.4 PRECAUTIONS

#### 1.5 PRODUCT STRUCTURE ICON

#### 1.6 INSTALLATION METHOD

#### 1.7 DESCRIPTION OF PRODUCT CONTROL KEYS

#### 1.8 FUNCTION INSTRUCTION & INSTRUCTION FOR USE

#### 1.9 APP CONNECTION AND APP CONTROL

#### 1.10 USE AND PRESERVATION

#### 1.11 SIMPLE FAULTS AND TROUBLESHOOTING

#### 1.12 PACKING LIST

### 2 Documents / Resources

### 3 Related Posts

## GVM-G100W

### PRODUCT INTRODUCTION

Welcome to use “GVM-G100W”, this product is specially designed for the senior photography enthusiasts. Product usage scenarios are available for live broadcast / outdoor / studio photography, etc., and can also be used for YouTube video capture. The main features of the product are:

- (1) Dual color temperature feature with stepless adjustment, color range 3200K~5600K, with 1 cob lamp bead, helping to restore and enrich the color of the object, and providing you with natural and vivid shooting effect.
- (2) APP intelligent control system, which can be controlled by your smart mobile device.
- (3) With OLED screen display and stable system, supporting 180 ° rotation, it can effectively control the light. It is also equipped with the standard cover, which can avoid redundant light and make the light more concentrated. Custom control fill light, allowing you to easily shoot the desired results.

We believe that once using our product correctly, you can make huge progress when shooting. Before using the product, you are strongly recommended to read the instructions below carefully.

### PRODUCT PARAMETER

- Brand : GVM
- Product model : GVM-G100W
- Product Type : Photography Fill Light
- Product Name : 90W double color temperature spotlight
- Function / Feature : APP, Joint control, High display, Stepless light control
- Color rendering index : 97
- Lamp beads quantity : COB\*1
- Color temperature : 3200K~5600K
- Brightness : Bare light:11500lux/0.5m; 3500lux/1m Plus standard cover:320001ux/0.5m; 73001ux/1 m
- Light adjustment method : Stepless adjustment
- Product Weight : 1.7KG
- Product Size(mm) : 266x225x124

- Cooling : Heat sink+fan
- Power : 90W
- Input :AC:100-240V
- Product material :Aluminum alloy +ABS plastic
- Commodity origin : China. Huizhou

#### **DISCLAIMERS**

1. Before using this product, please read the instructions carefully and make sure use the product correctly. If you don't obey the instructions and warnings, you maybe cause harm to yourself and the people around, or even damage the product and other things around.
2. Once you use this product, you are deemed to have read the disclaimer and warning carefully, understand and acknowledge all the terms and contents of this statement, and promise to take full responsibility for the use of this product and possible consequences.

#### **PRECAUTIONS**

- 1 The product is not waterproof, please use it in rainproof environment.
- 2 The product is not anti-corrosion, therefore do not let the product touch any corrosive liquid.
- 3 When using the product, make sure the product is put firmly and prevent from falling and damage.
- 4 If the product will not be used for a long time, please switch off the power to reduce energy loss.

#### **PRODUCT STRUCTURE ICON**

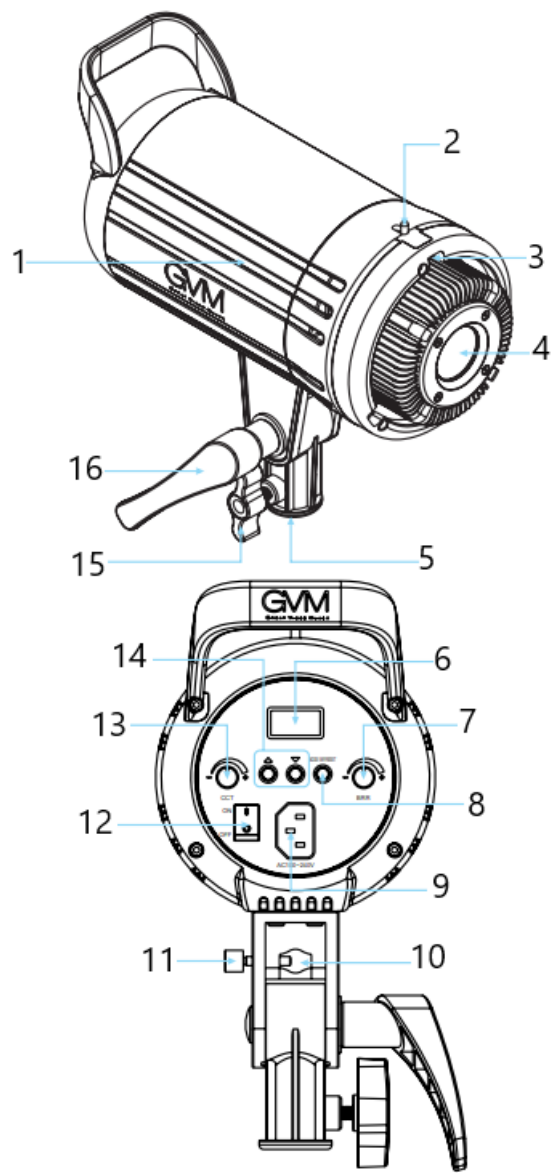

1. Vents
2. Bowens dismantling buckle
3. Bowens Mount
4. COB lamp beads
5. Light frame interface
6. OLED display screen
7. Brightness adjustment knob
8. Mode / WIFI reset button
9. Adapter interface
10. Mounting hole of soft light umbrella
11. Soft light umbrella lock knob
12. Power switch
13. Color temperature adjusting knob
14. Channel selection button
15. Lamp holder fixing knob
16. Angle fixing handle

## INSTALLATION METHOD

**1** The lamp can be installed and fixed on the bracket by rotating the knob clockwise, and unloaded by rotating in the counterclockwise direction.

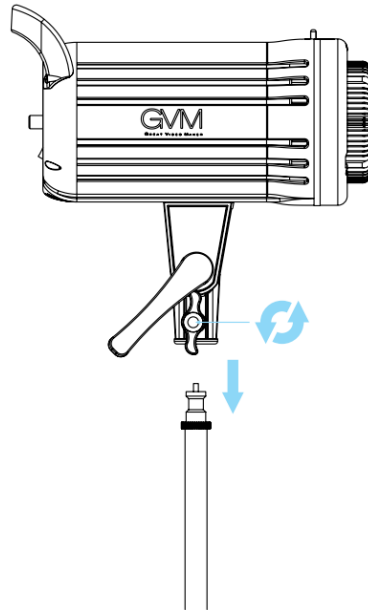

**2** Insert the protective bayonet of the lampshade into the protective bayonet of the lamp, and then turn it slightly clockwise.

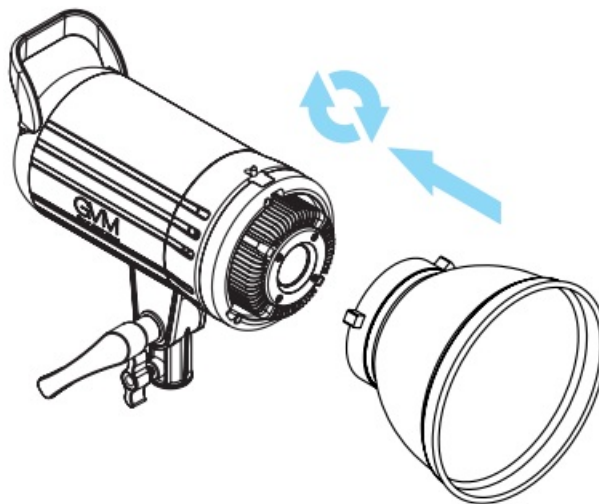

**3** Push the baorong disassembly buckle back, and turn the lamp cover anticlockwise at the same time. Then, the lamp cover can be removed.

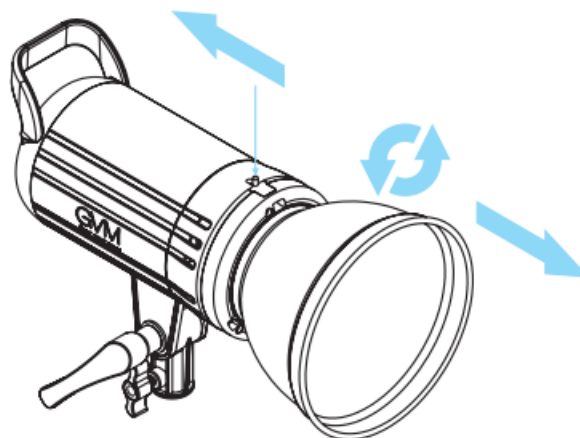

**4** Loosen the angle fixing handle, adjust the angle of spotlight you need, and then turn the angle fixing handle tight.

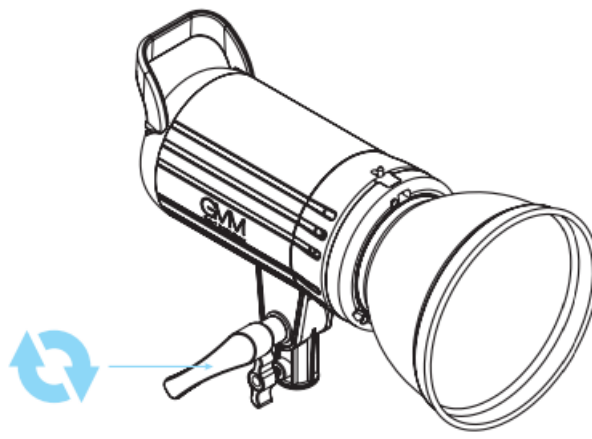

5 Connect the power cord for power supply.

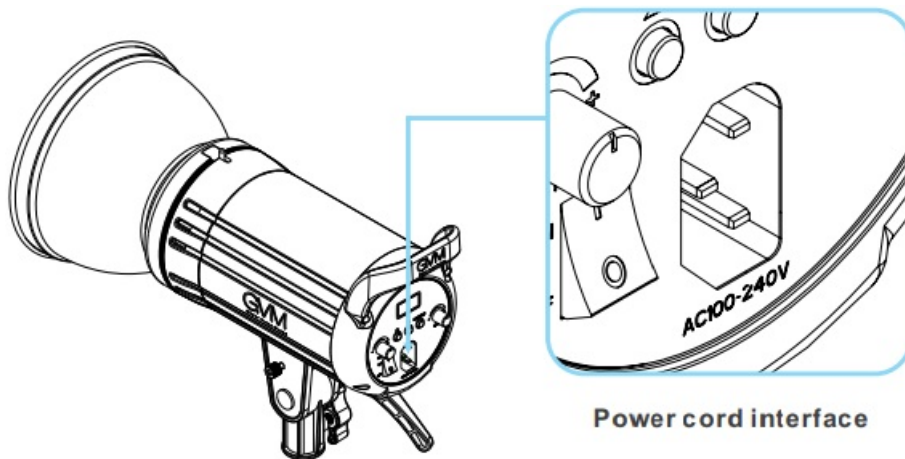

#### DESCRIPTION OF PRODUCT CONTROL KEYS

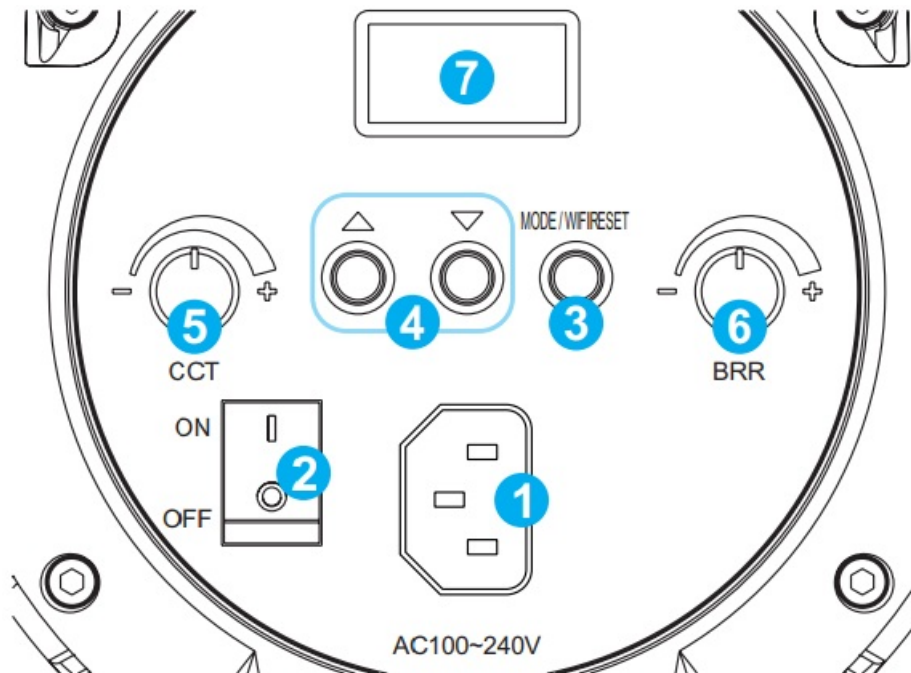

1 AC power input interface

2 Power switch

3 Mode button / WIFI reset button: Short press to switch mode, long press for 5 seconds to reset WIFI username and password.

4 Channel addition and subtraction key: Adjust channel

**5** Color temperature adjustment button: Adjust the color

**6** Brightness adjustment button: Adjust the brightness

**7** LCD screen: Display brightness, color temperature, mode, channel value and other data

## **FUNCTION INSTRUCTION & INSTRUCTION FOR USE**

### **1 Mode selection :**

There are two kinds of mode which are master mode and slave mode, switching through mode button (automatically as master mode when switch on the machine). In master mode, it is able to adjust lightness, color temperature and channel value, and it is also able to connect APP, and control the parameters through APP. While in the slave mode, it is only able to set channel value, rather than lightness and color temperature.

### **2 Channel adjustment(CH): range 0~11**

Set channel value using channel addition and subtraction key, ranging from 0 to 11.

### **3 Adjust brightness (BRG): range 0%~100%**

In the master mode, adjust lightness through the knob or APP, ranging from 10% to 99%.

### **4 Adjust color temperature (CCT): range 3200K~5600K**

In the master mode, adjust color temperature through the knob or APP, ranging from 3200K to 5600K.

### **5 On-line control (between photography lights) :**

Prepare two or more photography lights, set one as master mode and the other as slave mode, and set the same channel value, in this way, it is able to control the lightness and color temperature of slave machine through adjusting the knob of the master machine. Moreover, it is also able to connect the master machine and APP, and then use the APP to control the slave machines.

## **APP CONNECTION AND APP CONTROL**

### **Scan the QR code on the back of the manual to download the APP**

Set master mode for the photography light (automatically as a master mode when switching on the machine), open "GVM Easily" APP on the mobile phone (meanwhile turn on WIFI on the phone), register the APP account (as long as the email format is correct, the email account password can be entered at will, because the next time you open the APP, you will automatically login), in the main menu in the APP—switch the devices—select "Single/Double color temperature light", then in the main menu in APP set—select "switch WIFI", and connect photography light (WIFI initial username: GVM\_LED, password: gvm\_admin), once it shows "Device connection GVM\_LED", return back to the main interface, after it shows "Connected" in the main interface, it is allowed to control the lightness, color temperature, channel value or switch on and off through the control key in APP, and also the slave machines.

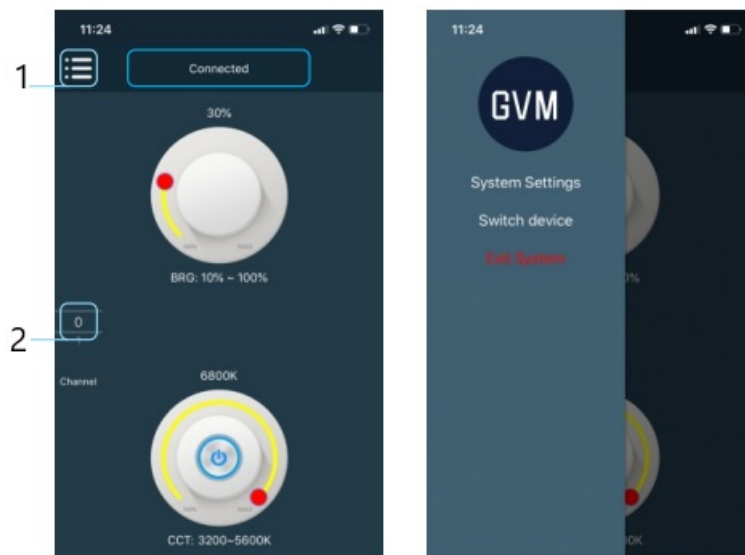

1. main menu
2. Current channel value

If there is a slave, the slave and the master are controlled by the APP at the same time. The master/slave connection mode is the same as “9 pages, (5; online control (link control between lamps and lamps)).”

### WIFI username and password resetting

It is able to reset the WIFI username and password if long press the WIFI reset button for over 5 seconds. After resetting, the username and the password will return to the initial ( WIFI username: GVM LED, WIFI password: gvm\_admin ).

### USE AND PRESERVATION

Do not put the product in a highly humid, strong electromagnetic field, direct sunlight, high-temperature environment. If not use the product for a long time, disconnect the power.

**Clean:** Before clean, disconnect the power plug. And use wet cloth rather than any detergent or soluble liquid, avoiding damaging the surface layer.

**Power:** Make sure the power is in the demanded range, not too high or too low.

**Repairing:** If there is fault or performance degradation, do not unpack the shell by yourself, avoiding damage the machine and lose the right of maintenance. When there is a fault, do not hesitate to contact us, and we will do our best to deal with the problem.

**Accessories:** Please use the accessories provided by manufacturer and approved ones, in order to maximize the performance.

**Guarantee:** Do does not modify the product. or you will lose the right of maintenance.

### SIMPLE FAULTS AND TROUBLESHOOTING



Phenomenon	Check the product	Troubleshooting
The switch indicator does not light up	Check the matching power adapter indicator light up or not.	Make sure the adapter is well contacted with the power plug.
The brightness/ color temperature knob is out of control	Check if the mode were set as slave mode, lightness and color temperature of the products cannot be controlled in slave mode.	Press the "MODE" button for once, switch the mode from slave mode to master mode.
The product is in the "ON" state, the display and lights are not on	Check if the product is "OFF" because of the APP of the mobile phone.	Press the "ON/OFF" button once again.
APP can't connect/ can't control	Check whether the WiFi is connected in WiFi mode, whether the WiFi is successfully connected, and whether "Connected" is displayed on the APP.	Normal steps: (1) Switch to WiFi mode after booting; (2) Successfully connect to WiFi; (3) Open the APP and the connection will be successful.
WiFi is successfully connected, but the device cannot connect to the APP	Check if the "Switch Device" type in the APP main menu is switched to "Single/Double color temperature light".	Click APP main menu → Switch device → Single/Double color temperature light

#### PACKING LIST

Name	Quantity	Notes
Main Machine	1	
Power Cord	1	
Lampshade	1	
Carrying Case	1	
User Manual	1	





GVM Official website



Facebook



Download APP IOS



Download APP Android

Web: [www.gvmled.com](http://www.gvmled.com)

B&H Email: [bh@gvmled.com](mailto:bh@gvmled.com)

GVM Email: [support@gvmled.com](mailto:support@gvmled.com)

Amazon Email: [amazonsupport@gvmled.com](mailto:amazonsupport@gvmled.com)

Warehouse Add: 4301 N Delaware ave, unit D. PHILADELPHIA, PA 19137, USA

## Documents / Resources



[GVM GVM-G100W Bi-Color LED Video Light](#) [pdf] User Manual  
GVM-G100W, Bi-Color LED Video Light, GVM-G100W Bi-Color LED Video Light

[Manuals+.](#)