



Gude P 1600 Chainsaw Sharpener Instruction Manual

[Home](#) » [Gude](#) » Gude P 1600 Chainsaw Sharpener Instruction Manual 



Contents

- [1 Gude P 1600 Chainsaw Sharpener Instruction Manual](#)
- [2 DELIVERED ITEMS](#)
- [3 Assembly](#)
- [4 Starting-up the machine](#)
- [5 Operation](#)
- [6 Grinding Depth Delimiter](#)
- [7 Technical Data](#)
- [8 Maintenance](#)
- [9 Guarantee](#)
- [10 Service](#)
- [11 Instructions](#)
- [12 Symbols](#)
- [13 Documents / Resources](#)
 - [13.1 References](#)
- [14 Related Posts](#)

Gude P 1600 Chainsaw Sharpener Instruction Manual



P 1600

Please read the instructions carefully before starting the machine.

DELIVERED ITEMS



Assembly

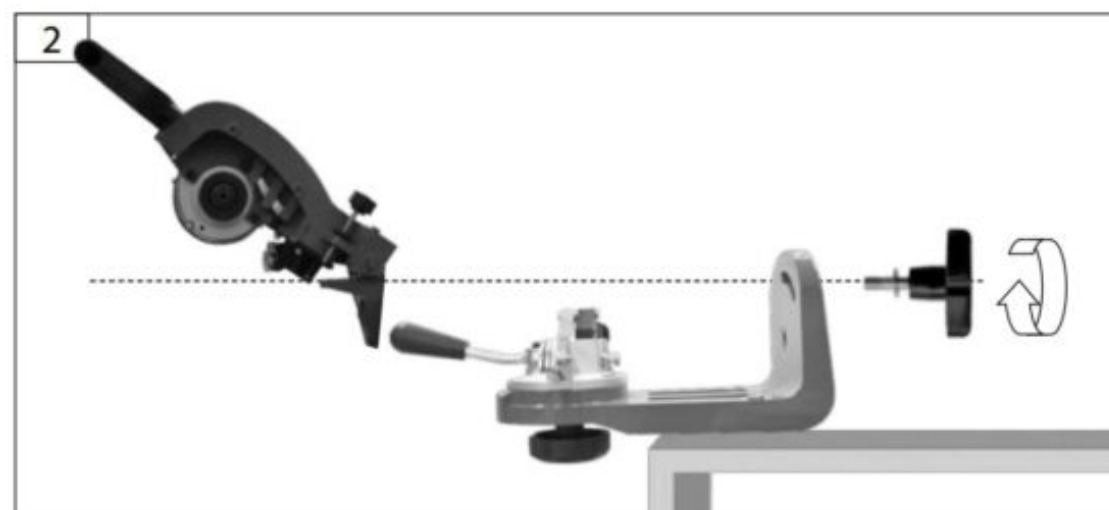
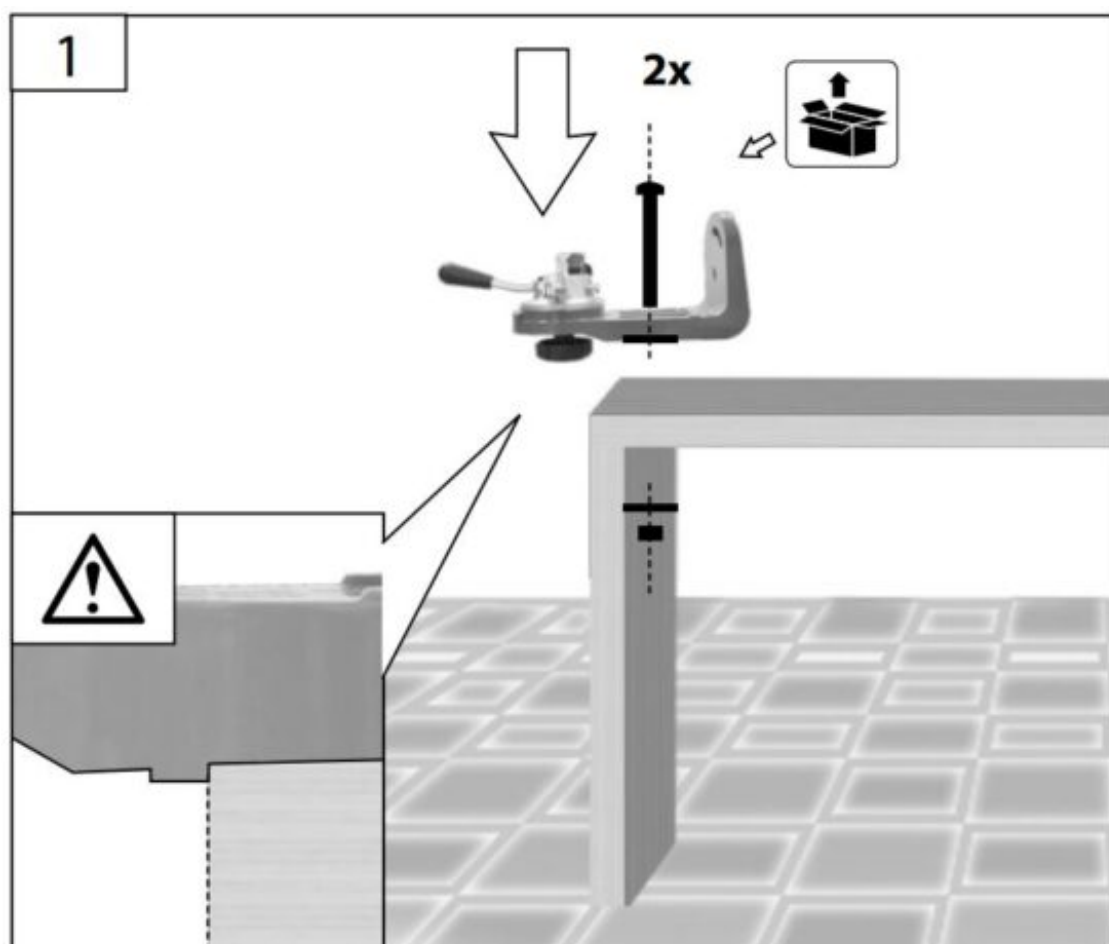

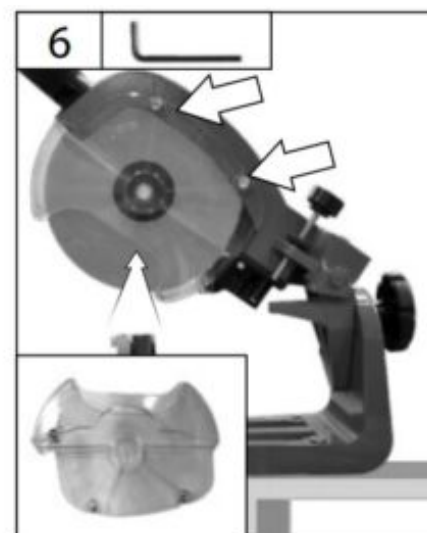
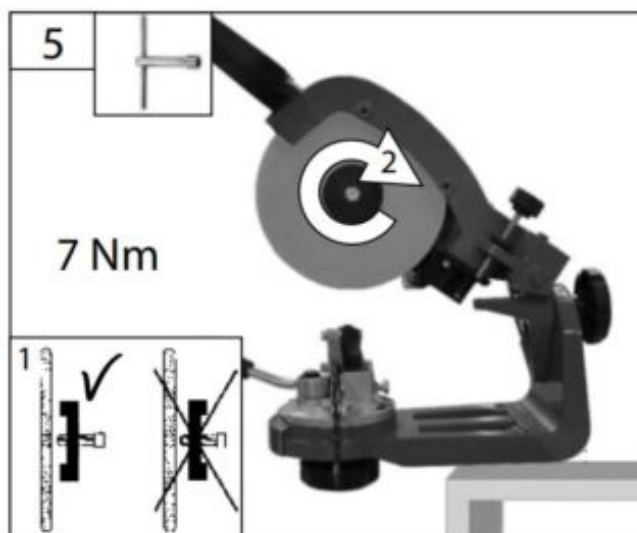
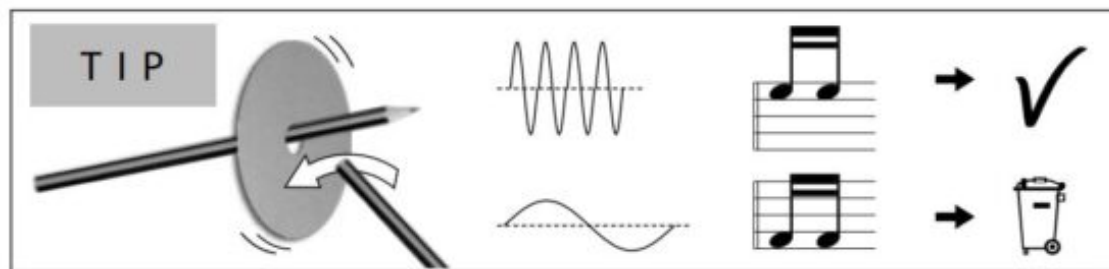
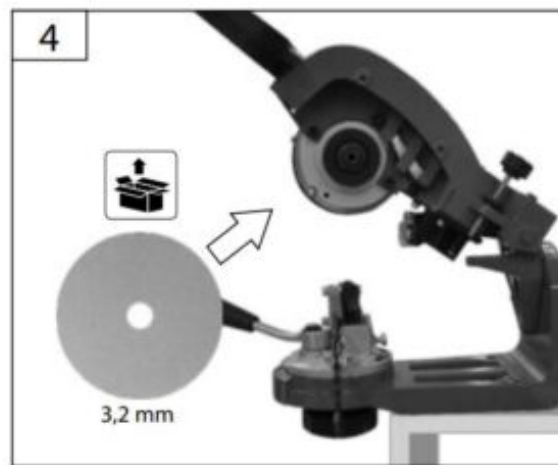

Starting-up the machine

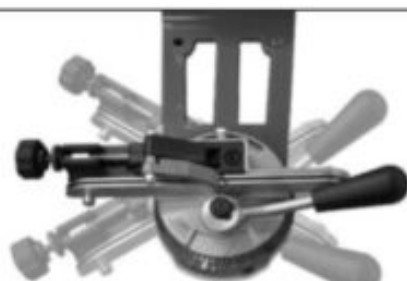
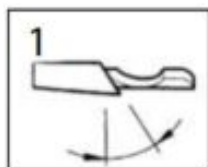

30° - 0° - 30°



11

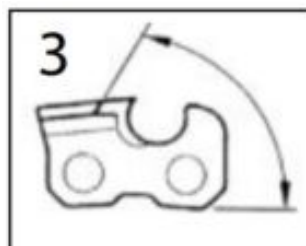

90°

40°

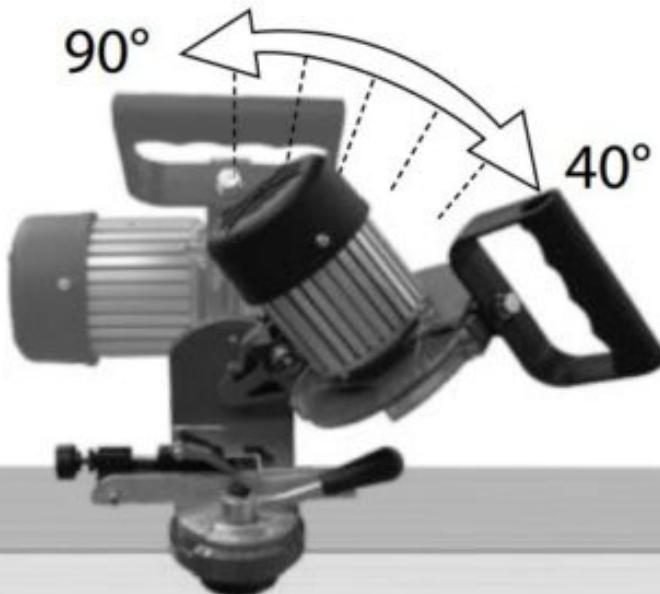

4

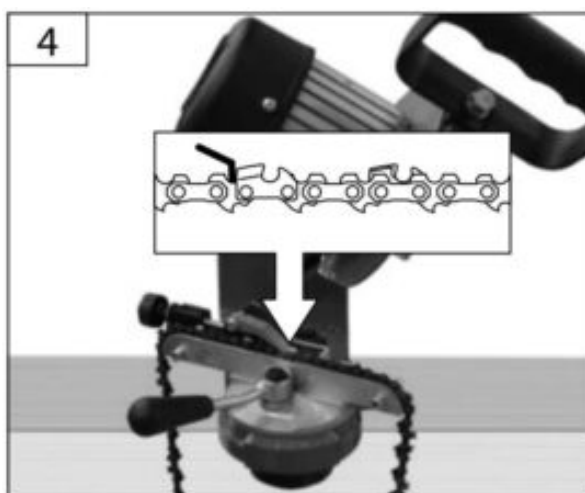

5

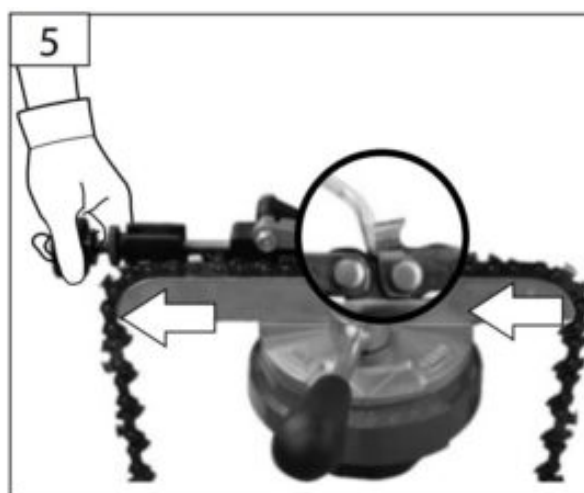

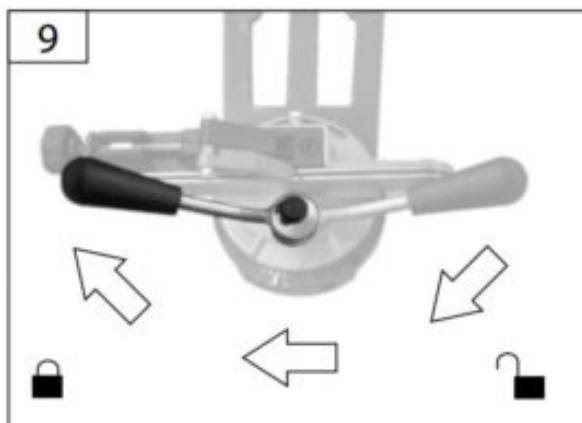
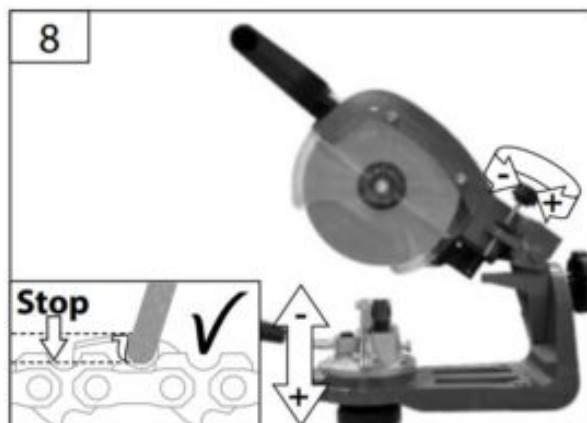
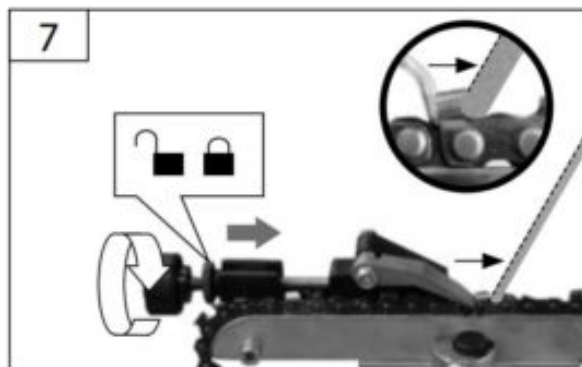

Operation

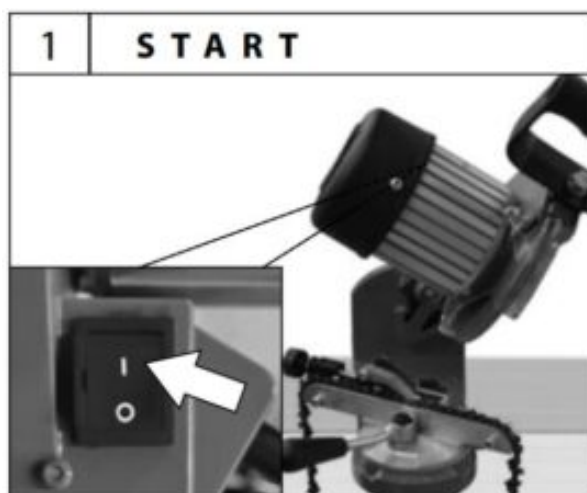

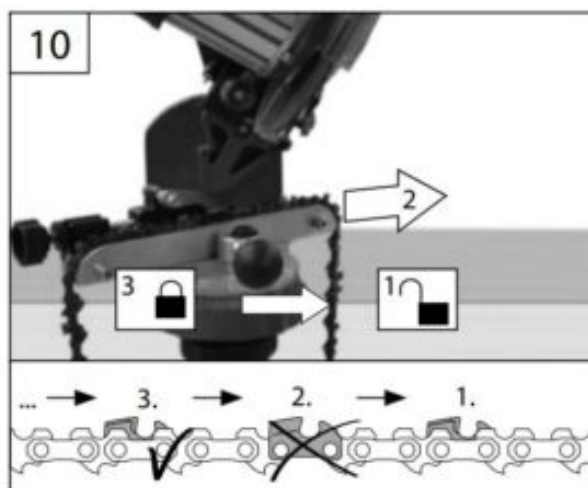
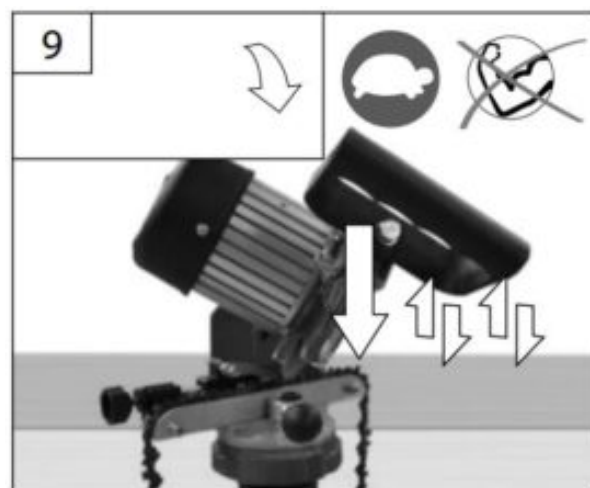
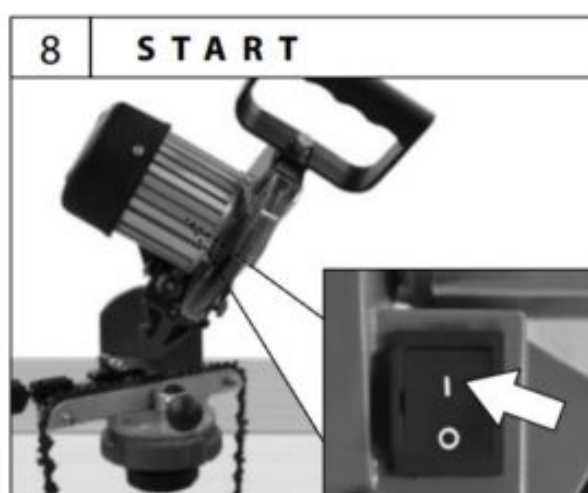
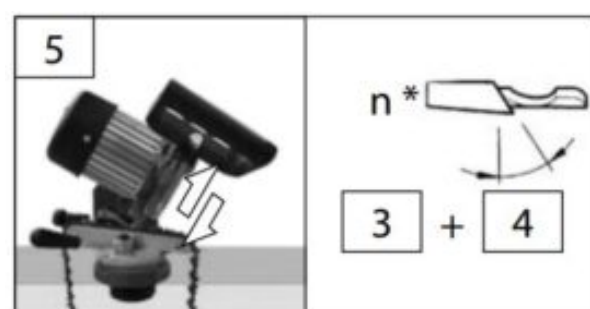
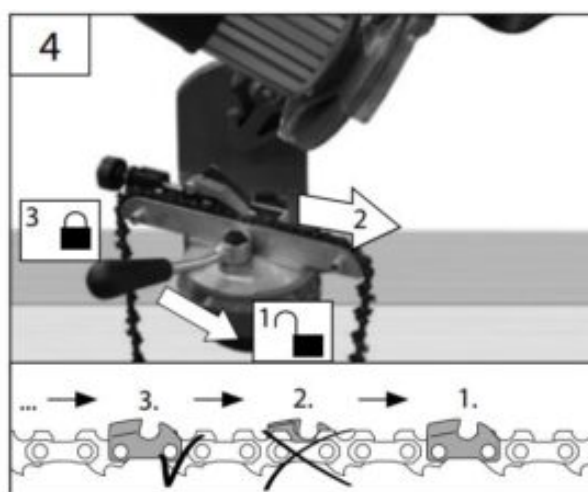

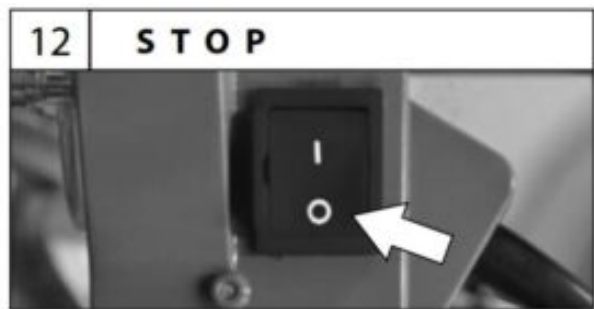
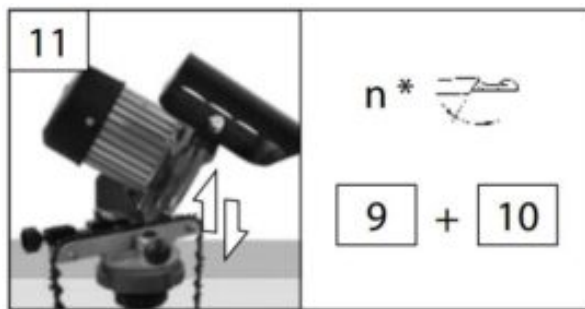



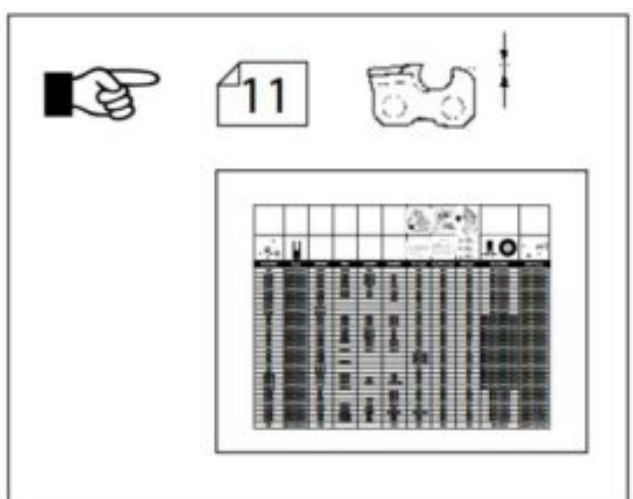
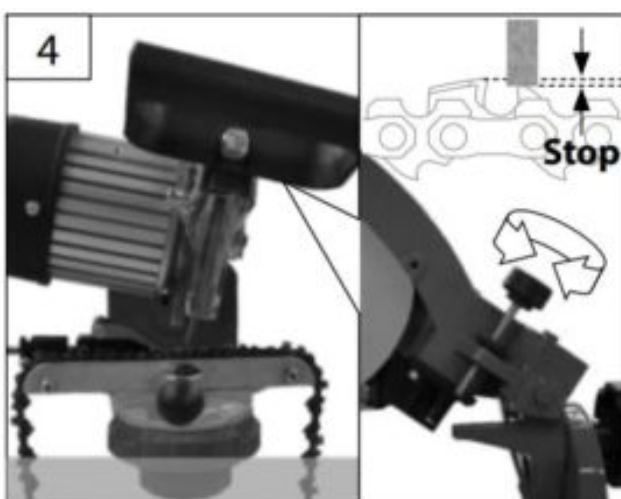
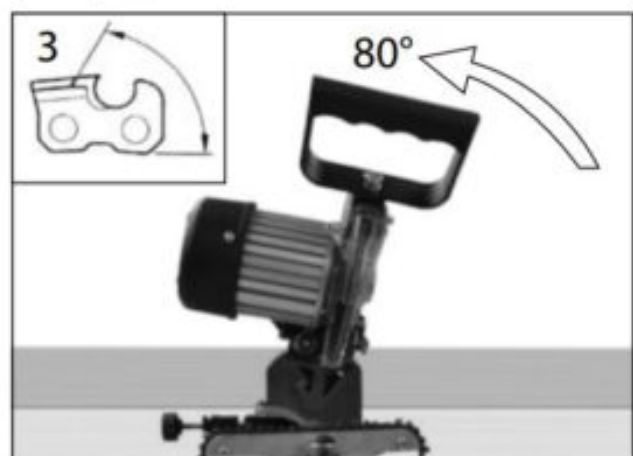
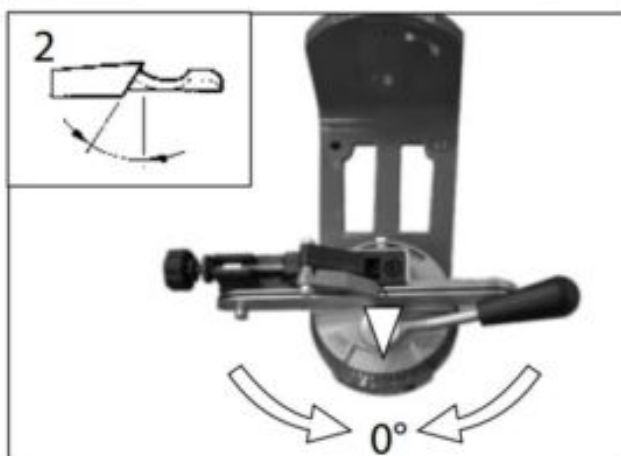
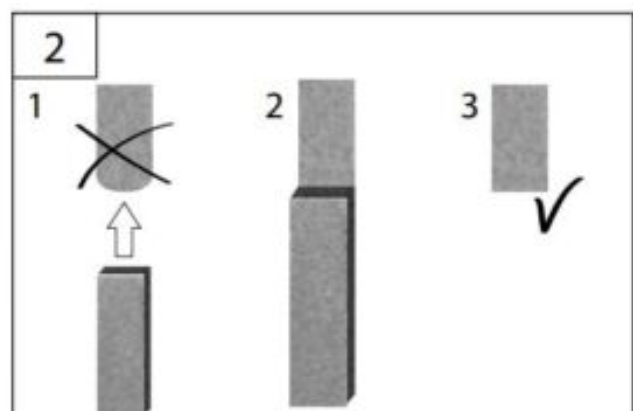
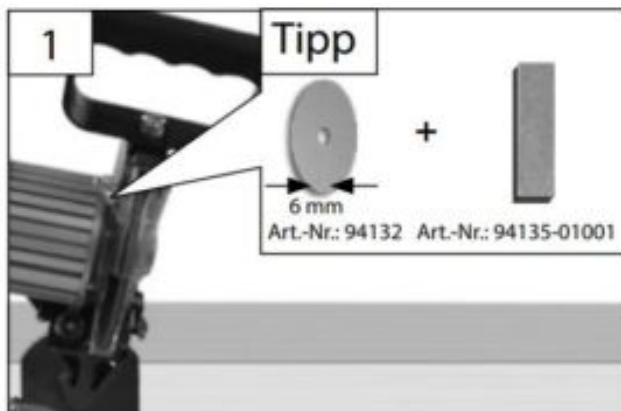

Grinding Depth Delimiter

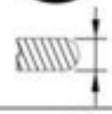

						
Chain Pitch	Gauge	OREGON	STIHL	SANDVIK		
1/4"	0,050"/1,3mm	25AP	13RM	50□		
0,325"	0,050"/1,3mm	20LP	23RS	50□LG		
0,325"	0,058"/1,5mm	21LP	25RS	58□LG		
0,325"	0,063"/1,6mm	22LP	26RS	63□LG		
0,325"	0,050"/1,3mm	20BP	23RM	50□		
0,325"	0,058"/1,5mm	21BP	25RM	58□		
0,325"	0,063"/1,6mm	22BP	26RM	63□		
0,325"	0,050"/1,3mm	95VP				
0,325"	0,050"/1,3mm	95R				
0,325"	0,058"/1,5mm	M21LP				
0,325"	0,063"/1,6mm	M22LP				
3/8"	0,050"/1,3mm	72LG	33RS	50AL		
3/8"	0,058"/1,5mm	73LG	35RS	58AL		
3/8"	0,063"/1,6mm	75LG	36RS	63AL		
3/8"	0,050"/1,3mm	72LP	33RS	50ALG		
3/8"	0,058"/1,5mm	73LP	35RS	58ALG		
3/8"	0,063"/1,6mm	75LP	36RS	63ALG		
3/8"	0,050"/1,3mm	72DP	33RM1	50AG		
3/8"	0,058"/1,5mm	73DP		58AG		
3/8"	0,063"/1,6mm	75DP	36RM1	63AG		
3/8"	0,050"/1,3mm	72RD				
3/8"	0,058"/1,5mm	73RD				
3/8"	0,063"/1,6mm	75RD	36RM□			
3/8"	0,058"/1,5mm	M73LP				
3/8"	0,063"/1,6mm	M75LP				
3/8(90)	0,043"/1,1mm	90SG	63PM□			
3/8(91)	0,050"/1,3mm	91VS	63PM	50R		
3/8(91)	0,050"/1,3mm	91VG	63PM1	50RG		
3/8(91)	0,050"/1,3mm	91R	63PM□			
0,404"	0,058"/1,5mm	58L				
0,404"	0,063"/1,6mm	59L				
0,404"	0,058"/1,5mm	26IP		58B		
0,404"	0,063"/1,6mm	27IP	46RS□	63B		
0,404"	0,063"/1,6mm	59AC	46RM	63BC		
0,404"	0,063"/1,6mm	27R	46RM□	63BR		
0,404"	0,063"/1,6mm	16H	46RMH	HC		
0,404"	0,080"/2,0mm	18H	49RMH	2HC		
3/4"	0,122"/3,1mm	11H				

					
CARLTON	Vise Angle	Top Plate Angle	Wheel Width	Depth Gauge	
	30□	60□	1/8" / 3,2mm	0,025" / 0,63mm	
01L	25□	60□	1/8" / 3,2mm	0,025" / 0,63mm	
02L	25□	60□	1/8" / 3,2mm	0,025" / 0,63mm	
03L	25□	60□	1/8" / 3,2mm	0,025" / 0,63mm	
01C	30□	60□	1/8" / 3,2mm	0,025" / 0,63mm	
02C	30□	60□	1/8" / 3,2mm	0,025" / 0,63mm	
03C	30□	60□	1/8" / 3,2mm	0,025" / 0,63mm	
01□	30□	60□	1/8" / 3,2mm	0,025" / 0,63mm	
	50	50□	1/8" / 3,2mm	0,030" / 0,76mm	
	25□	60□	1/8" / 3,2mm	0,025" / 0,63mm	
	25□	60□	1/8" / 3,2mm	0,025" / 0,63mm	
A1LM	25□	60□	1/8" / 3,2mm [B/16" / 4,7mm	0,025" / 0,63mm	
A2LM	25□	60□	1/8" / 3,2mm [B/16" / 4,7mm	0,025" / 0,63mm	
A3LM	25□	60□	1/8" / 3,2mm [B/16" / 4,7mm	0,025" / 0,63mm	
A1L	25□	60□	1/8" / 3,2mm [B/16" / 4,7mm	0,025" / 0,63mm	
A2L	25□	60□	1/8" / 3,2mm [B/16" / 4,7mm	0,025" / 0,63mm	
A3L	25□	60□	1/8" / 3,2mm [B/16" / 4,7mm	0,025" / 0,63mm	
A1□P	35□	60□	1/8" / 3,2mm [B/16" / 4,7mm	0,025" / 0,63mm	
A2□P	35□	60□	1/8" / 3,2mm [B/16" / 4,7mm	0,025" / 0,63mm	
A3□P	35□	60□	1/8" / 3,2mm [B/16" / 4,7mm	0,025" / 0,63mm	
	10□□15□	50□	1/8" / 3,2mm [B/16" / 4,7mm	0,025" / 0,63mm	
	10□□15□	50□	1/8" / 3,2mm [B/16" / 4,7mm	0,025" / 0,63mm	
	10□□15□	50□	1/8" / 3,2mm [B/16" / 4,7mm	0,025" / 0,63mm	
	25□	60□	1/8" / 3,2mm [B/16" / 4,7mm	0,025" / 0,63mm	
	25□	60□	1/8" / 3,2mm [B/16" / 4,7mm	0,025" / 0,63mm	
04C	30□	50□	1/8" / 3,2mm [B/16" / 4,7mm	0,020" / 0,50mm	
01C	30□	60□	1/8" / 3,2mm [B/16" / 4,7mm	0,025" / 0,63mm	
0□□C□BL	30□	60□	1/8" / 3,2mm [B/16" / 4,7mm	0,025" / 0,63mm	
	50	60□	1/8" / 3,2mm [B/16" / 4,7mm	0,025" / 0,63mm	
B2LM	25□	60□	3/16" / 4,7mm	0,025" / 0,63mm	
B3LM	25□	60□	3/16" / 4,7mm	0,025" / 0,63mm	
B2□P	35□	60□	3/16" / 4,7mm	0,030" / 0,76mm	
B3□P	35□	60□	3/16" / 4,7mm	0,030" / 0,76mm	
B3S	35□	60□	3/16" / 4,7mm	0,030" / 0,76mm	
B3RM10	10□□15□	50□	3/16" / 4,7mm	0,030" / 0,76mm	
B3M	35□	60□	3/16" / 4,7mm	0,050" / 1,27mm	
B5M	35□	60□	3/16" / 4,7mm	0,050" / 1,27mm	
G7S	35□	60□	1/4" / 6mm	0,070" / 1,77mm	

Saw Chain Sharpener

P 1600

Art. No 94151

 Service connection 230V~50Hz

 Motor output P1 160 W

 Idle speed 3000 min⁻¹

 Grinding wheel dimensions 145 x 3,2 mm

 LED 0,5 W

 Weight 4,5 kg

Noise and Vibration Information

Sound power level L_{WA} 82 dB (A)

Sound pressure level L_{pA} ¹⁾ 69 dB (A)

Wear ear protectors!

Vibration emission value a_h ²⁾ 3,53 m/s²

¹⁾ Measured according to EN 61029, Uncertainty K=3 dB (A)

²⁾ Measured according to EN 61029, Uncertainty K=1,5 m/s²

Warning: The vibration emission level will vary because of the ways in which a power tool can be used and may increase above the level given in this information sheet.

The vibration emission level may be used to compare one tool with another.

It may be used for a preliminary assessment of exposure.

An accurate estimate of the vibratory load should also take into account the times when the tool is shut down or when it is running but not actually in use. This may significantly reduce the vibratory load over the total working period.

Identify additional safety measures to protect the operator from the effects of vibration such as maintain the tool and the accessories, keep the hands warm, organisation of work patterns.



Read and understand the operating instructions before using the appliance. Abide by all the safety measures stated in the service manual. Act responsibly toward third parties.

In case of any doubts about connection and operation refer please to our customer center

Specified Conditions Of Use

This machine is only determined for sharpening saw chains. Before commissioning the device must be fixed to a workbench or an other similar surface. Use the chainsaw sharpener only if you fully appreciate all the functions and perform without restrictions or have received appropriate instructions. Respecting technical data and safety precautions.

Do not use this product in any other way as stated for normal use. Not observing general regulations in force and instructions from this manual does not make the manufacturer liable for damages.

Please be sure to know that our appliances have not been designed for industrial use.

Requirements for operating staff

The operating staff must carefully read the Operating Instructions before using the appliance.

Qualification Apart from the detailed instructions by a professional, no special qualification is necessary for appliance using.

Minimum age Persons over 18 years of age can only work on the appliance. An exception includes youngsters trained in order to reach knowledge under supervision of the trainer during occupational education.

Training Using the appliance only requires corresponding training by a professional or the Operating Instructions. No special training is necessary.

The operator is responsible for accidents or risks to third parties.

Observe to keep out of dangerous zone

General Power Tool Safety Warnings

Warning

Read all safety warnings and all instructions. Failure to follow the warnings and instructions may result in electric shock, fire and/or serious injury. Save all warnings and instructions for future reference.

The term „power tool“ in the warnings refers to your mains-operated (corded power tool or battery-operated (cordless) power tool.

1) Work area safety

a) Keep work area clean and well lit. Cluttered or dark areas invite accidents.

b) Do not operate power tools in explosive atmospheres, such as in the presence of flammable liquids, gases or dust. Power tools create sparks which may ignite the dust or fumes.

c) Keep children and bystanders away while operating a power tool. Distractions can cause you to lose control.

2) Electrical safety

Operation is only allowed with a safety switch against stray current (RCD max. stray current of 30mA).

a) Power tool plugs must match the outlet. Never modify the plug in any way. Do not use any adapter plugs with earthed (grounded) power tools. Unmodified plugs and matching outlets will reduce risk of electric shock.

b) Avoid body contact with earthed or grounded surfaces, such as pipes, radiators, ranges and refrigerators.

There is an increased risk of electric shock if your body is earthed or grounded.

c) Do not expose power tools to rain or wet conditions. Water entering a power tool will increase the risk of electric shock.

d) Do not abuse the cord. Never use the cord for carrying, pulling or unplugging the power tool. Keep cord away from heat, oil, sharp edges or moving parts. Damaged or entangled cords increase the risk of electric shock.

e) When operating a power tool outdoors, use an extension cord suitable for outdoor use. Use of a cord suitable for outdoor use reduces the risk of electric shock.

3) Personal safety

a) Stay alert, watch what you are doing and use common sense when operating a power tool. Do not use a power tool while you are tired or under the influence of drugs, alcohol or medication. A moment of inattention while operating power tools may result in serious personal injury.

b) Use personal protective equipment. Always wear eye protection. Protective equipment such as dust mask, non-skid safety shoes, hard hat, or hearing protection used for appropriate conditions will reduce personal injuries.

c) Prevent unintentional starting. Ensure the switch is in the off-position before connecting to power source and/or battery pack, picking up or carrying the tool. Carrying power tools with your finger on the switch or energising power tools that have the switch on invites accidents.

d) Remove any adjusting key or wrench before turning the power tool on. A wrench or a key left attached to a rotating part of the power tool may result in personal injury.

e) Do not overreach. Keep proper footing and balance at all times. This enables better control of the power tool in unexpected situations.

f) Dress properly. Do not wear loose clothing or jewellery. Keep your hair, clothing and gloves away from moving parts. Loose clothes, jewellery or long hair can be caught in moving parts.

g) If devices are provided for the connection of dust extraction and collection facilities, ensure these are connected and properly used. Use of dust collection can reduce dust-related hazards.

4) Power tool use and care

a) Do not force the power tool. Use the correct power tool for your application. Do not use the power tool if the switch does not turn it on and off.

b) Do not use the power tool if the switch does not turn it on and off. Any power tool that cannot be controlled with the switch is dangerous and must be repaired.

c) Disconnect the plug from the power source and/or the battery pack from the power tool before making any adjustments, changing accessories, or storing power tools. Such preventive safety measures reduce the risk of starting the power tool accidentally.

d) Store idle power tools out of the reach of children and do not allow persons unfamiliar with the power tool or these instructions to operate the power tool. Power tools are dangerous in the hands of untrained users.

e) Maintain power tools. Check for misalignment or binding of moving parts, breakage of parts and any other condition that may affect the power tool's operation. If damaged, have the power tool repaired before use. Many

accidents are caused by poorly maintained power tools.

f) Keep cutting tools sharp and clean. Properly maintained cutting tools with sharp cutting edges are less likely to bind and are easier to control.

g) Use the power tool, accessories and tool bits etc. in accordance with these instructions, taking into account the working conditions and the work to be performed. Use of the power tool for operations different from those intended could result in a hazardous situation.

5) Service

a) Have your power tool serviced by a qualified repair person using only identical replacement parts. This will ensure that the safety of the power tool is maintained.

Safety instructions Saw Chain Sharpener

Wear ear protectors. Exposure to noise can cause hearing loss.

Wear personal protective equipment. Depending on application, use face shield, safety goggles or safety glasses. As appropriate, wear dust mask, hearing protectors, gloves and shop apron capable of stopping small abrasive or workpiece fragments.

Do not use damaged wheels. Before each use, inspect the wheels for chips and cracks. If power tool or wheel is dropped, inspect for damage or install an undamaged wheel. After inspecting and installing the wheel, position yourself and bystanders away from the plane of the rotating wheel and run the power tool at maximum no load speed for one minute. Damaged wheels will normally break apart during this test time. Transport and store the tools in a suitable container;

Always use the protective shields on the machine. Do not remove the transparent front guard. If the transparent front guard is damaged or missing, return tool to authorized service station for replacement.

Do not use sawblades.

The adjusting nut must be tightened before starting to work with the machine.

Immediately switch off the machine in case of considerable vibrations or if other malfunctions occur. Check the machine in order to find out the cause.

Before use check machine, cable, and plug for any damages or material fatigue. Repairs should only be carried out by authorised Service Agents.

Sawdust and splinters must not be removed while the machine is running.

Emergency procedure

Conduct a first-aid procedure adequate to the injury and summon qualified medical attendance as quickly as possible. Protect the injured person from further harm and calm them down. For the sake of eventual accident, in accordance with DIN 13164, a workplace has to be fitted with a first-aid kit. It is essential to replace any used material in the first-aid kit immediately after it has been used.

If you seek help, state the following pieces of information

1. Accident site
2. Accident type

3. Number of injured persons
4. Injury type(s)

Maintenance

Before carrying out any work on the machine, disconnect the plug from the socket.

Prior to every use, visually check the machine to rule out any defects, in particular on the power cable and the plug.

The machine must not be used under any circumstances if the machine or the safety devices are damaged.

Use only original accessories and original spare parts. Regularly clean the power tool's air vents. The motor's fan will draw the dust inside the housing and excessive accumulation of powdered metal may cause electrical hazards.

Only a regularly maintained and treated appliance can serve as a satisfactory aid. Insufficient maintenance and care can lead to unforeseen accidents and injuries.

Guarantee

Warranty period of 12 months applies to commercial use and 24 months applies to private use and commences on the day of purchase of the device.

The guarantee solely covers inadequacies caused by material defect or manufacturing defect. Original payment voucher with the sales date needs to be submitted for any claim in the guarantee period.

The guarantee does not cover any unauthorised use such as appliance overloading, use of violence, damage as a result of any unauthorised interference or caused by foreign items. Failing to follow the operating and assembly instructions and common wear are also not included in the guarantee.

Service

Do you have any technical questions? Any claim? Do you need any spare parts or operating instructions? We will quickly help you and without needless bureaucracy at our web pages at www.guede.com in the

Servicing part. Please help us be able to help you. In order to identify your device in case of claim we need the serial No., product No. and year of production. All this data can be found on the type label. Please enter it here for future reference

Serial No.

Art. No

Year of production

Important information for the customer

Please be sure to know that returning the product in or after the warranty period must be made in the original

packaging.

Instructions

The disposal instructions are based on the icons placed on the appliance or on the package. Description of the respective meanings can be found in the section „Marking“.

Transport package disposal

The package protects the appliance against damage during transport. Packing materials are usually chosen depending on their environmental friendliness and disposal method and can therefore be recycled. Returning the package to material circulation saves raw materials and reduces waste disposal costs. Parts of packages (e.g. foils, styropor®) can be dangerous to children. Risk of suffocation! Keep parts of packages away from children and dispose them as soon as possible.

Symbols

	Caution!
	Read the Operating Instructions!
	Before carrying out any work on the machine, disconnect the plug from the socket.
	Wear eye protective goggles ! Wear ear protectors!
	Wear protective gloves !
	Do not touch the rotating tool.
	Cable pulling / transport prohibited

	Protect against humidity Never expose tool to rain.
	Warning against rotating parts
	Keep distance of persons Observe to keep out of dangerous zone
	Warning against thrown-off items
	Any damaged or disposed electric or electronic devices must be delivered to appropriate collection centres.
	Protect against humidity
	This side up

Translation of the EC-Declaration of Conformity

We, hereby declare the conception and construction of the below mentioned appliances correspond – at the type of construction being launched – to appropriate basic safety and hygienic requirements of EC Directives.

In case of any change to the appliance not discussed with us the Declaration expires.

Appropriate EU Directives

- | | |
|---|---|
| <input type="checkbox"/> 2006/95/EC | <input checked="" type="checkbox"/> 2004/108/EC |
| <input type="checkbox"/> 2009/105/EC | <input type="checkbox"/> 1907/2006/EC |
| <input checked="" type="checkbox"/> 2011/65/EC ROHS | <input type="checkbox"/> 2009/142/EC |
| <input type="checkbox"/> 89/686/EEC (PPE) | <input type="checkbox"/> 1935/2004/EC |
| <input checked="" type="checkbox"/> 2006/42/EC | <input type="checkbox"/> |

☐ **Annex IV**

Notified Body: No:

Name:

Address:

Type Ex. Cert.-No.:

☐ 97/68/EC_

Emission No.:

☐ 2000/14/EC_2005/88/EC

Method of compliance assessment



Helmut Arnold

Managing Director

Joachim Bürkle

GÜDE GmbH & Co. KG, Birkichstraße 6, 74549 Wolpertshausen, Germany

Harmonised standards used

EN 61029-1:2009+A11:10

EN ISO 12100:2010

EN 61029-2-10:2010+A11:13

ZEK 01.4-08/11.11 / EK9-BE-88:2014

EN 55014-1:2006+A1+A2

EN 55014-2:1997+A1+A2

EN 61000-3-2:2006+A1+A2 / EN 61000-3-3:2013

Guaranteed sound power level

L_{WA} 82 dB (A)

Measured sound power level

L_{WA} 79 dB (A)

Authorized to compile the technical file

GÜDE GmbH & Co. KG
Birkichstrasse 6
74549 Wolpertshausen
Deutschland
Tel.: +49-(0)7904/700-0
Fax.: +49-(0)7904/700-250
eMail: info@guede.com

Read More About This Manual & Download PDF:

Documents / Resources

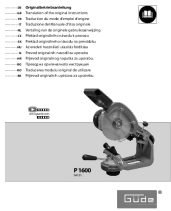

Gude P 1600 Chainsaw Sharpener [pdf] Instruction Manual
94151, P 1600, Chainsaw Sharpener, P 1600 Chainsaw Sharpener

References

- [!\[\]\(79de0df6c6ddd2d4eb74f1cc5f48ec50_img.jpg\) Güde | Maschinen & Werkzeuge für den Hand- & Heimwerker](#)