

## **guardian technologies Table Top Air Purifier Model #AC4100 Use and Care Instructions Manual**

[Home](#) » [guardian technologies](#) » guardian technologies Table Top Air Purifier Model #AC4100 Use and Care Instructions Manual 



**USE & CARE INSTRUCTIONS**

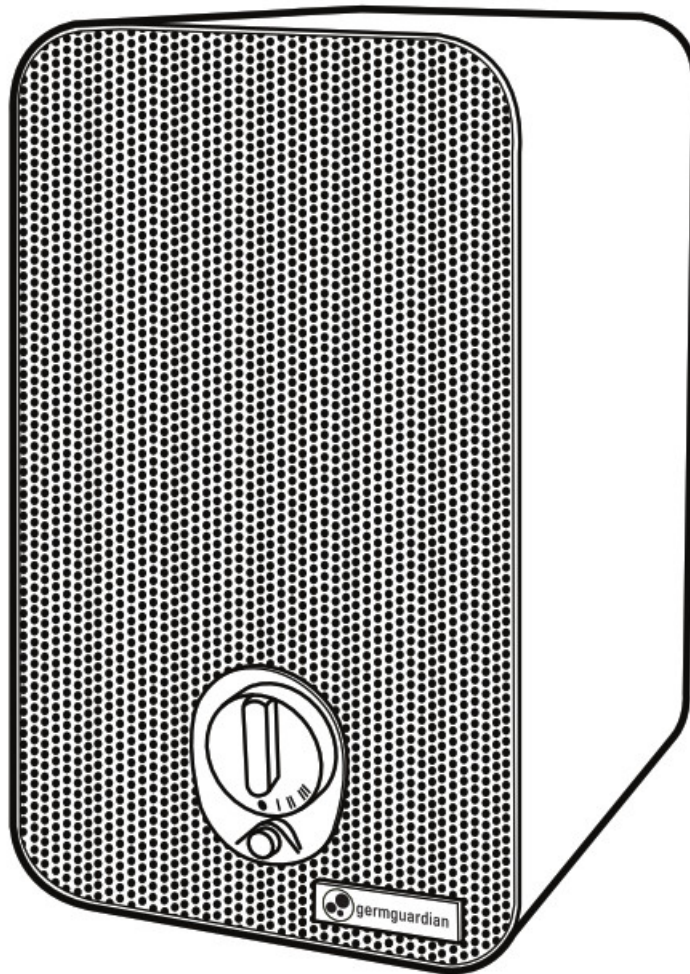

Table Top Air Purifier

**Model No. AC4100**

**1-Year Limited Warranty**

**Customer Service**

**1.866.603.5900**

**[www.guardiantechnologies.com](http://www.guardiantechnologies.com)**

**Date Purchased month \_\_\_\_\_ year \_\_\_\_\_**

**English E – 1 French F – 1 Spanish S – 1**

**Use GENUINE Guardian Technologies replacement parts only.**

**REV0218**

## Contents

<b>1 READ AND SAVE THESE INSTRUCTIONS</b>
<b>2 PRODUCT SPECIFICATIONS AND PARTS</b>
<b>3 REPLACEMENT PARTS</b>
<b>4 DIGITAL AIR CLEANING SYSTEM</b>
<b>5 AIR CLEANING LAYERS</b>
<b>6 OPERATING INSTRUCTIONS</b>
<b>7 FILTER REPLACEMENT</b>
<b>8 UV-C BULB REPLACEMENT</b>
<b>9 CLEANING &amp; MAINTENANCE</b>
<b>10 TROUBLESHOOTING GUIDE</b>
<b>11 LIMITED WARRANTY</b>
<b>12 Related Posts</b>

## READ AND SAVE THESE INSTRUCTIONS

### WARNINGS

Failure to comply with the warnings listed below may result in electric shock or serious injury.



This product should be used only in accordance with the specifications outlined in this manual. Usage other than what has been specified here may result in serious injury.

When using electrical appliances, basic precautions should always be followed to reduce the risk of fire, electric shock and injury to persons, including the following:

- Read all instructions before using appliance.
- **IMPORTANT** – This appliance has a polarized plug (one blade is wider than the other).  
To reduce the risk of electric shock, this plug is intended to fit in a polarized outlet only one way. If the plug does not fit fully in the outlet, reverse the plug. If it still does not fit, contact a qualified electrician. Do not attempt to defeat this safety feature.
- To avoid fire or shock hazard, plug the appliance directly into a 120V AC electrical outlet.
- Keep the cord out of heavy traffic areas. To avoid fire hazard, **NEVER** put the cord under rugs, near heat registers, radiator, stoves or heaters.
- To protect against electrical hazards, **DO NOT** immerse in water or other liquids. Do not use near water.
- Children cannot recognize the hazards associated with the usage of electrical appliances. For this reason, always supervise children when they are near the unit.
- Always unplug the air purifier before moving it, opening the grill, changing filters, cleaning or whenever the air purifier is not in use. Be sure to pull by the plug and not the cord.
- **NEVER** drop or insert any object into any openings.
- **DO NOT** run cord under carpeting.
- **DO NOT** cover cord with throw rugs, runners, or similar coverings.
- **DO NOT** route cord under furniture or appliances. Arrange cord away from traffic area and where it will not be tripped over.
- **DO NOT** operate any appliance with a damaged cord or plug, if motor fan fails to rotate, after the appliance malfunctions, or if it has been dropped or damaged in any manner.  
Call Customer Service at 1.866.603.5900 for assistance.
- Use appliance only for intended household use as described in this manual. Any other use not recommended



by the manufacturer may cause fire, electric shock or injury to persons.

- DO NOT use outdoors.
- DO NOT place anything on top of unit.
- NEVER block the air openings, grills/outlets, or place on a soft surface such as a bed or sofa, as this could cause the unit to tip over, blocking the air intake or outtake opening.
- DO NOT attempt to repair or adjust any electrical or mechanical functions on this unit. Doing so will void your warranty. The inside of the unit contains no user-serviceable parts. All servicing should be performed by qualified personnel only.
- WARNING: To reduce the risk of fire or electric shock, do not use this fan with any solid-state speed control device.
- WARNING: Skin or eye damage may result from directly viewing the light produced by the lamp in this apparatus. Always disconnect power before replacing lamp or servicing.  
Replace Lamp With Lamp Manufactured by Guardian Technologies.
- Always unplug the unit before before cleaning or servicing in any way.
- CAUTION: Do NOT use gasoline, benzene, thinner, harsh cleaners, etc. on and/or in the unit while cleaning as they will damage the product. NEVER use alcohol or other solvents.

The 8 hour TWA Ozone for this product is 0.001 ppmv when tested in a 30 m3 chamber. The product complies with the maximum allowable concentration of ozone of 0.050 parts per million by volume (ppmv) in a 24-hour period. The Health Canada Guideline 2010 recommends that the maximum exposure limit, based on averaging time of 8 hours, is 0.020 ppmv or less when tested in a sealed, controlled room approximately 30 m3.



**WARNING:** This product can expose you to chemicals including lead or lead compounds, which are known to the State of California to cause cancer or birth defects or other reproductive harm. For more information go to [www.P65Warnings.ca.gov](http://www.P65Warnings.ca.gov).

 <b>LAMP CONTAINS MERCURY</b>	
<b>Manage in accordance with Spills, Disposal and Site Cleanup Requirements. In case of breakage, follow clean-up procedures provided by contacts below.</b>	
<b><a href="http://www.epa.gov/cficleanup">www.epa.gov/cficleanup</a> 1-866-284-4010</b>	

## PRODUCT SPECIFICATIONS AND PARTS

## PARTS

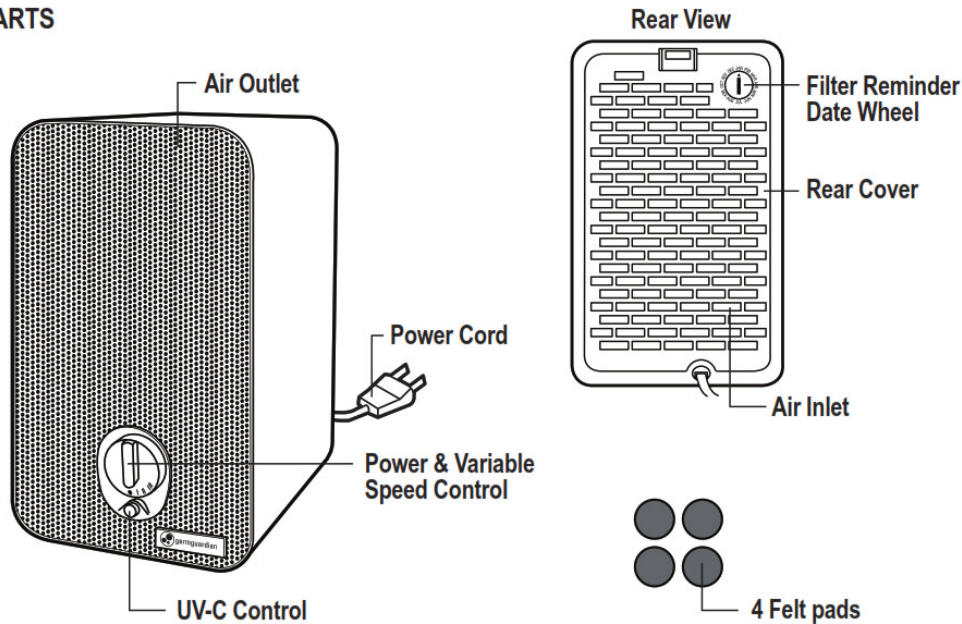

## REPLACEMENT PARTS

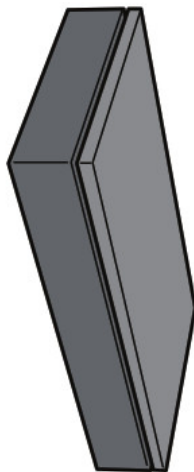

FILTER:  
**Filter E**  
Model No.  
FLT4100



UV-C BULB (2W):  
Model No. LB4100



Check out our  
**AutoShip & Save**  
Filter Replacement Program™  
[www.guardiantechnologies.com](http://www.guardiantechnologies.com)

**IMPORTANT:** Use Guardian Technologies GENUINE Replacement Parts only.  
To Purchase Contact Customer Service

## DIGITAL AIR CLEANING SYSTEM

Improve your indoor air quality with your new 3-in-1 Air Cleaning System. Multiple levels of cleaning work together to capture allergens, kill germs and remove odors.

### COMBINATION FILTER

**Pre-Filter/Charcoal** -This layer serves as a pre-filter for capturing large dust particles; lint and pet hair which helps extend the life of your filter. The activated carbon absorbs household and pet odors.

**HEPA Filter**— Captures 99.97% of dust and allergens.



## UV-C LIGHT

The power of UV-C light kills bacteria and viruses, including: rhinovirus, E. coli, and streptococcus.

## AIR CLEANING LAYERS

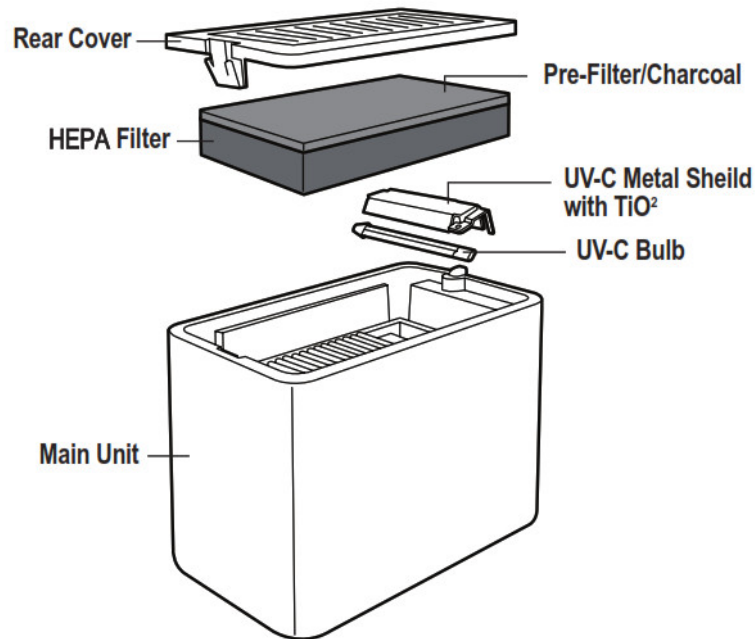

### COMBINATION FILTER:

- 1 Pre-Filter/Charcoal
- 1 HEPA Filter

Filters last approximately 6-8 months depending on use.

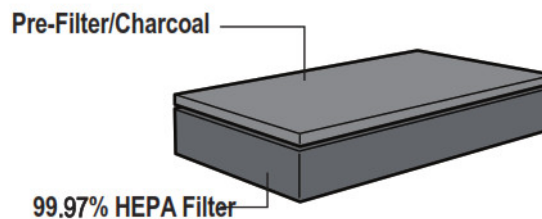

## OPERATING INSTRUCTIONS

### SET UP

1. Select a firm, level, and flat location for the air purifier. For proper airflow, locate the unit at least 1 foot from any wall or furniture. Make sure none of the grills are blocked.
2. Carefully remove your air purifier from box and bag.
3. Determine the preferred position of purifier based on space and preference.

**IMPORTANT:** When moving the air purifier, always lift unit by the carrying handle located on back.

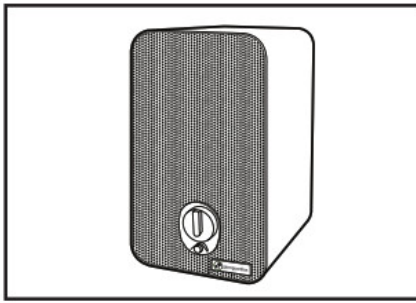

**Vertical Position**

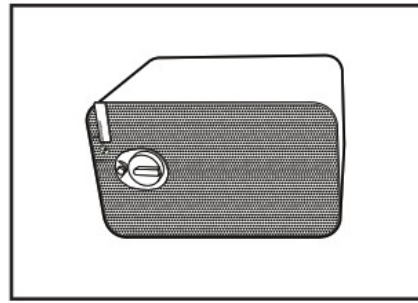

**Horizontal Position**

4. Adhere 4 felt pads to unit base to protect table top surface. Remove adhesive backing and apply one pad to each corner of unit base depending on preferred position in Step 3 (Figure 1).

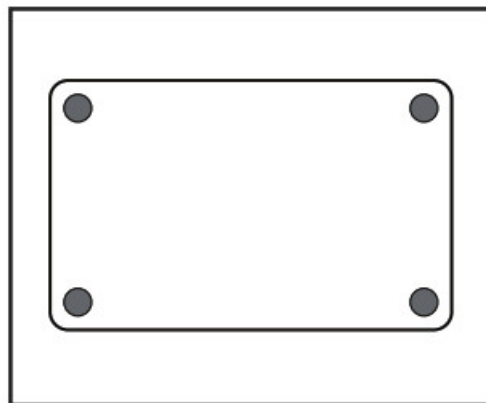

**Figure 1**

## **OPERATING THE AIR PURIFIER**

1. Plug the power cord into a 120V AC outlet.
2. Turn unit power ON.  
Select fan speed MODE 1 – 3  
(I = lowest speed setting;  
III = highest speed setting)
3. Select UV-C ON or OFF using UV-C Power Button (Figure 2).

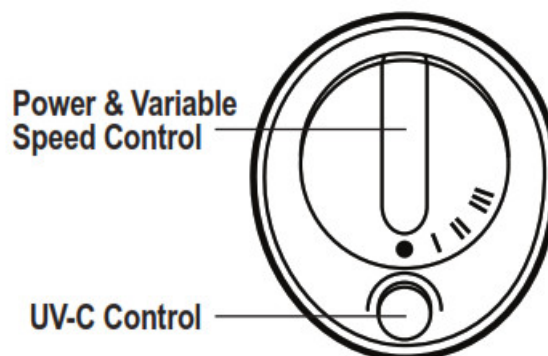

**Figure 2**

## **FILTER REPLACEMENT**

To maintain the performance of the air cleaner, it is recommended that the filter be replaced about every 6 months. The replacement requirements will vary depending on usage and environmental conditions.

1. It's time to replace the filter when the white HEPA cartridge portion has changed from white to grey or black.  
OR
2. A filter date wheel is also built into the rear of the unit to track your filter changes. Simply set the wheel 6 months ahead from when it is replaced as a reminder. The wheel is marked with the months of the year (Figure 3).



Figure 3

## UV-C BULB REPLACEMENT

1. Lift and remove the Rear Cover from the unit.

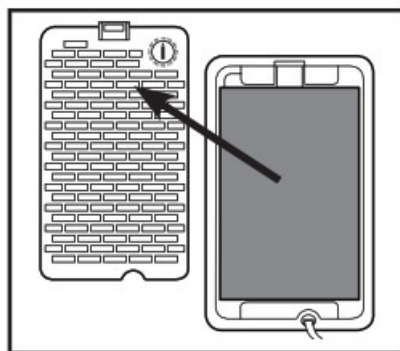

2. After removing the Rear Cover from the unit, remove the Combination Filter.

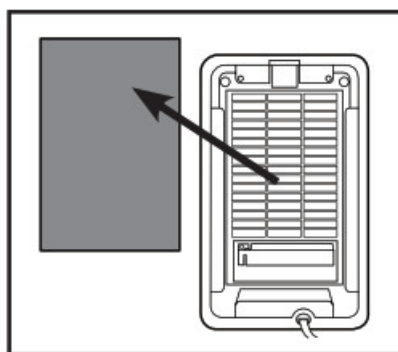

3. After removing the Combination Filter, use a Philips head screwdriver to remove screw and detach the UV-C Shield.

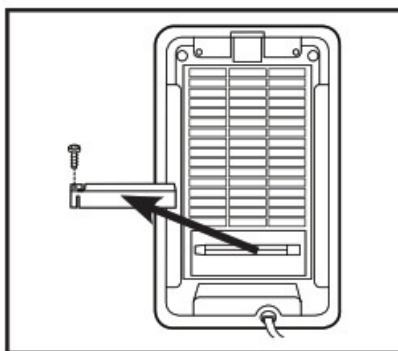



4. The UV-C Bulb is removed by carefully grasping the bulb with a clean cloth or tissue and pulling the bulb straight out of the unit (Figure 4).

**IMPORTANT:** The UV-C Bulb should be replaced every 10-12 months depending on use. Please contact Customer Service at 1.866.603.5900 or visit us at [www.guardiantechnologies.com](http://www.guardiantechnologies.com) to purchase a replacement bulb. Replacement UV-C Bulb: LB4100.

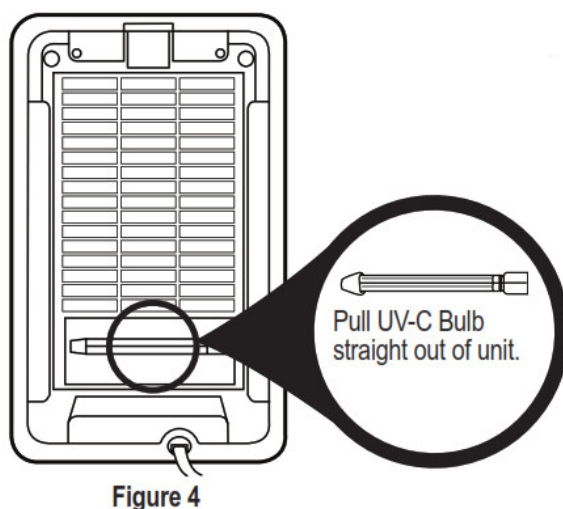

5. The UV-C Bulb is reinstalled by sliding it, horizontally, back into the slots.

## CLEANING & MAINTENANCE

### GENERAL CLEANING

Always unplug the unit before cleaning or servicing in any way.

Caution: Do NOT use gasoline, benzine, thinner, harsh cleaners, etc. on and/or in the unit while cleaning as they will damage the product. NEVER use alcohol or other solvents.

Note: Do NOT stick any foreign objects or your fingers inside the unit.

1. Wipe the surface of the unit with a clean, dry soft cloth as needed.
2. Clean the Filter monthly with the brush of your vacuum cleaner.
3. Remove and Clean (or Replace) Filter.

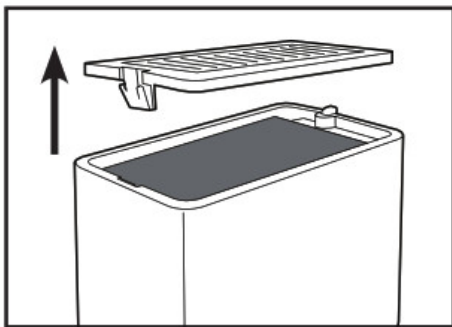

a. Lift and remove the Rear Cover from the unit.

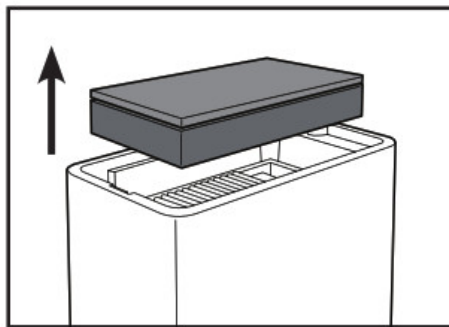

b. Remove Combination Filter from unit.  
Note: Pre-Filter/Charcoal is affixed to HEPA Filter with Velcro.

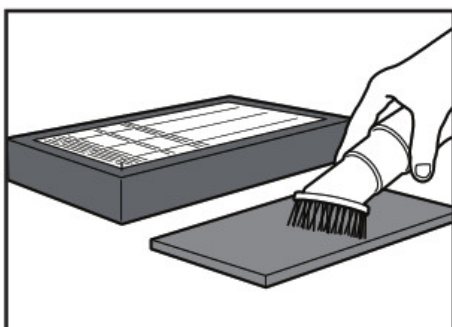

c. Separate and clean both filter layers with the brush attachment of your vacuum cleaner to remove lint and dust.  
**IMPORTANT:** Do NOT try to wash and re-use the Combination Filter.

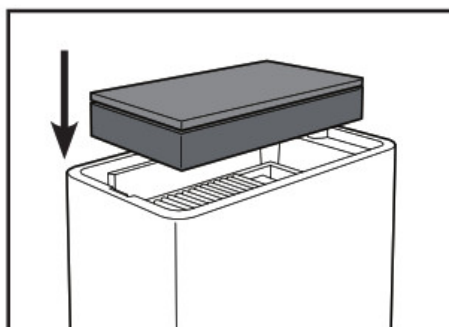

d. Insert Combination Filter into the unit with the HEPA portion facing into the unit. Consult the arrow on the filter for correct installation direction.

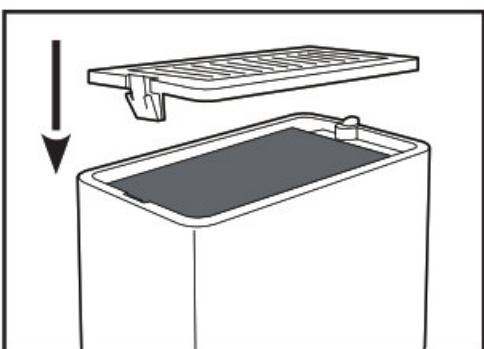

e. Reattach the Rear Cover of the unit and securely latch into place.

**IMPORTANT:** Do NOT try to wash and re-use the Combination Filter. Please contact Customer Service at 1.866.603.5900 or visit us at [www.guardiantechnologies.com](http://www.guardiantechnologies.com) to purchase a replacement filter. Replacement Combination Filter: E (FLT4100)

## TROUBLESHOOTING GUIDE

PROBLEM	SOLUTION
Unit does not operate.	Check that the unit is plugged in.
Unit shuts off unexpectedly.	Check that the unit is plugged into a working electrical outlet. Check that the HEPA Filter is firmly in place. Check that the Front Cover is latched firmly in place. Call Customer Service.
No air circulating from unit.	Unplug unit. Check Pre-Filter/Charcoal and HEPA Filters. Clean Pre-Filter/Charcoal if necessary. Replace HEPA Filter if necessary.
Increase in noise level.	Make sure the filters are clean. Replace if necessary.
An unpleasant odor is emitted from the unit.	Make sure the filters are clean. Replace if necessary.

## LIMITED WARRANTY

To the consumer, Guardian Technologies LLC warrants this product to be free of defects in materials or workmanship commencing upon the date of the original purchase. In order to be eligible for this Limited Warranty, an original sales receipt or comparable substitute proof of purchase bearing the date of original purchase is required. Refer to the original product carton or specific product/model page on the Guardian Technologies website for warranty length for your particular model. This warranty applies only to the original purchaser of this product from the original date of purchase. This warranty covers product purchased from authorized distributors only.

This warranty applies to repair or replacement of product found to be defective in materials or workmanship. This warranty does not apply to damage resulting from unusual wear, commercial, abusive, unreasonable use or supplemental damage. This warranty does not cover damage from unauthorized repairs or from any use not in accordance with the instruction manual. Defects that are the result of normal wear and tear will not be considered manufacturing defects under this warranty.

If this product should become defective within the warranty period, we will repair or replace any defective parts free of charge. All warranty repairs must be completed by Guardian Technologies LLC. This warranty gives you specific legal rights and you may also have other rights (other rights may vary from state to state in the U.S.A.)

To submit product under warranty the complete machine must be delivered pre-paid to GuardianTechnologies LLC. Please include complete information including: the problem, the model number of the product, the day of purchase, and a copy of the original sales receipt along with your name, address, and telephone (email optional). Address returns to the attention of: Customer Service, at the address below. Additional questions or comments can be made toll free to the number listed below.

USA and Canada  
Guardian Technologies LLC  
26251 Bluestone Blvd.  
Euclid, Ohio 44132  
1.866.603.5900

[www.guardiantechnologies.com](http://www.guardiantechnologies.com)

Please go to [www.guardiantechnologies.com](http://www.guardiantechnologies.com) to register your product. We consider the registration process important to ensuring superior service to our customers, however submitting the warranty registration is optional and does not affect your rights to utilize this warranty according to the conditions stated above.

Additional copies of the instruction manual can be obtained by accessing and printing directly from our website or calling customer service.



guardian technologies Table Top Air Purifier Model #AC4100 Use and Care Instructions Manual – [Download \[optimized\]](#)

guardian technologies Table Top Air Purifier Model #AC4100 Use and Care Instructions Manual – [Download](#)

Manuals+.