



Guangzhou Zhiying Technology CTRL1 COLBOR Remote dimming control User Manual

[Home](#) » [Guangzhou Zhiying Technology](#) » Guangzhou Zhiying Technology CTRL1 COLBOR Remote dimming control User Manual 



Zhiying Technology CTRL1 COLBOR Remote dimming control
User Manual

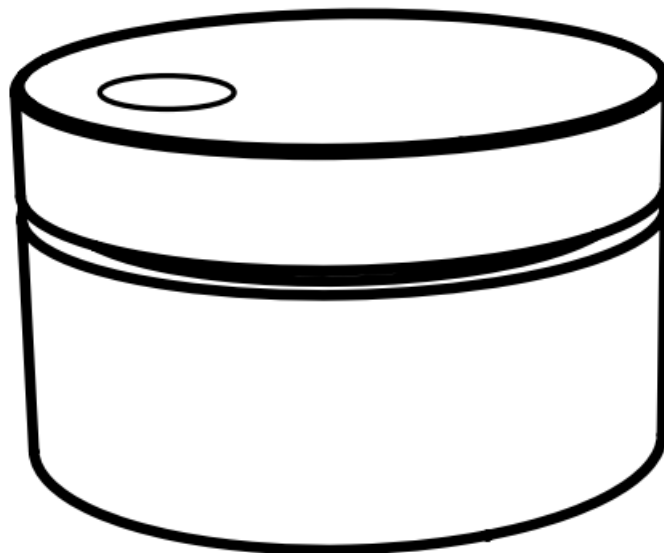

CTRL1 Remote Dimming Control

Thank you for choosing COLBOR product. Please read this manual carefully before use and follow all Instructions mentioned herein.

Contents

- 1 Caring For Your COLBOR Product
- 2 Product Instructions
- 3 Application of the product:
- 4 Operation Instructions
- 5 Specifications
- 6 Package List
- 7 WARRANTY
- 8 WARRANTY CERTIFICATE
- 9 FCC Warning:
- 10 Documents / Resources
- 11 Related Posts

Caring For Your COLBOR Product

- Please read the manual carefully before using this product.
- Keep corrosive chemicals, liquids, heat source away from the product to prevent mechanical damage.
- This product is not waterproof, please do not operate it with wet hands.
- The product is not waterproof. Do not handle with wet hands.
- Do not attempt to disassemble or modify the product Please have the product checked or repaired by authorized technicians If any malfunctions happened.
- Malfunction may be caused by dropping or external force, any man-made damage is not covered by our warranty.
- Our company reserves the right of final interpretation of the product.

Product Instructions

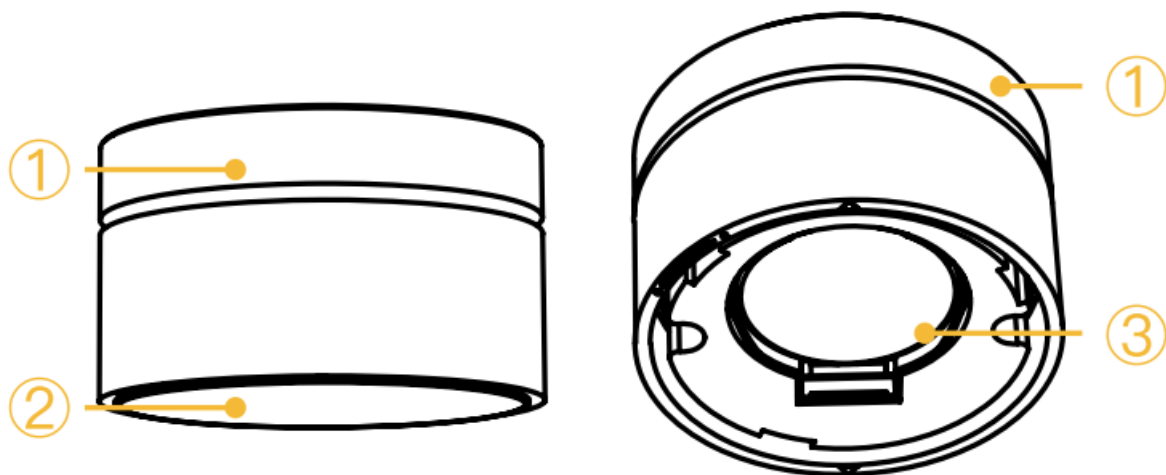

1. Turntable
2. Anti-slip Pad
3. Battery Cell

Application of the product:

Product Model	Hardware Version	Support CTRL 1 or not
CL60	1.0.1	X
	1.0.2 and above	✓
CL60M	1.0.1	X
	1.0.2 and above	✓
CL60R	1.0.1 / 1.0.2 / 1.0.3	X
	1.0A	✓
CL100X	1.0.1 and above	✓
CL100XM	1.0.1 and above	✓
CL220	1.0.1 and above	✓
CL220M	1.0.1 and above	✓

Note: The above products that meet the requirements of the hardware version should be upgraded to the firmware version “1.0.6” through EdgeMax APP before used with CTRL1. You can check the hardware version and firmware version in Product Information under Setting mode.

* The hardware version is the production batch version and the firmware version is the product runtime version.

Operation Instructions

1. Replace the battery

The product uses CR2450 button battery, and users can purchase it if they have additional needs.

When replacing the battery, place the remote control on the desktop. Hold the lower part and press down gently to make the non-slip pad close to the desktop. At the same time, turn it counterclockwise to open the battery compartment.

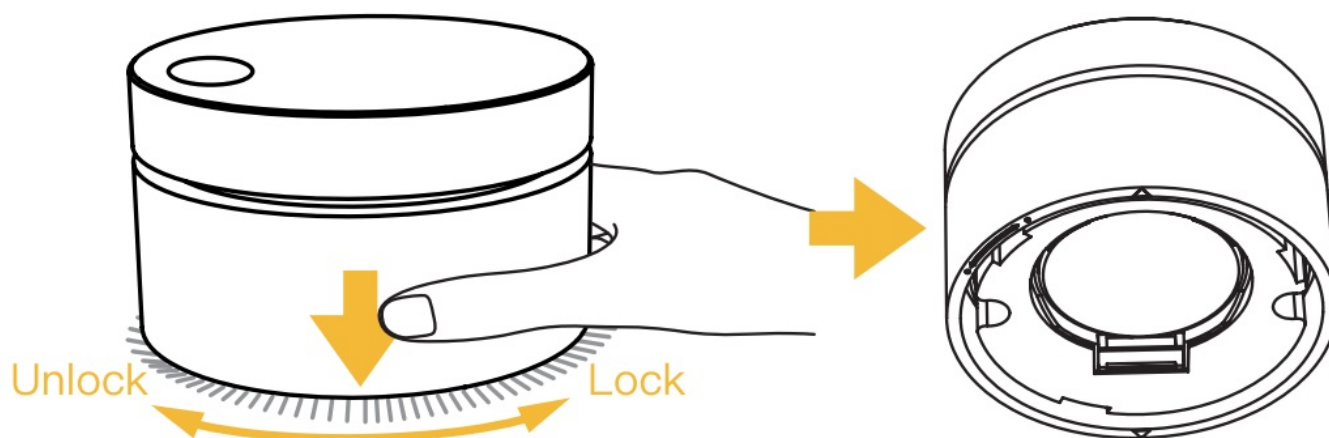

* **Note:**

1. When using this product for the first time, please open the battery cover and pull out the battery insulation strip.
2. The silicone anti-skid pad at the bottom of the product is only used for desktop anti-skid. Do not stick the product vertically to avoid falling and damage. Anti-slip mat will adhere to more dust with the use of time,

resulting in decreased adsorption force. Use wet tissue to clean it and the adsorption force will be improved.

2. Product pairing

1. Setting the lamp and select the wireless connection mode to remote control. Short press the lower dial wheel of the lamp, and the wireless connection status icon in the upper left column of the lamp screen flashes, and the lamp enters the pairing mode.

* **Note:** Only wireless connection options with firmware version “1.0.6” have APP and remote control options.

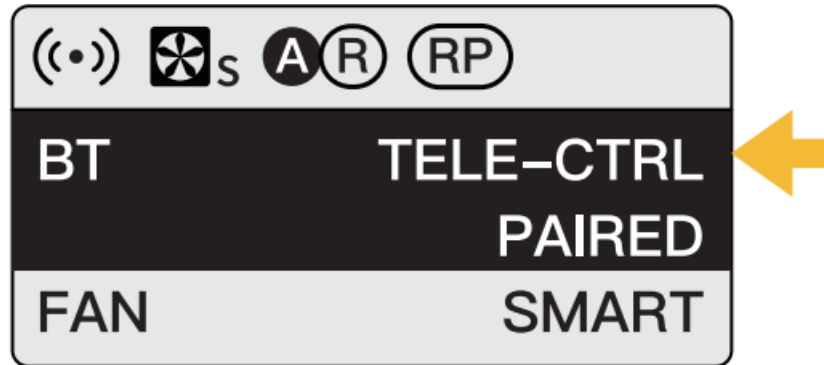

2. Short press a turntable, and then long press 3-4 seconds, the control began to match with the lamp.
3. After the wireless connection on the lamp panel is displayed as “Remote control paired”, release Ctrl 1 and the lamp and remote control have been paired successfully.

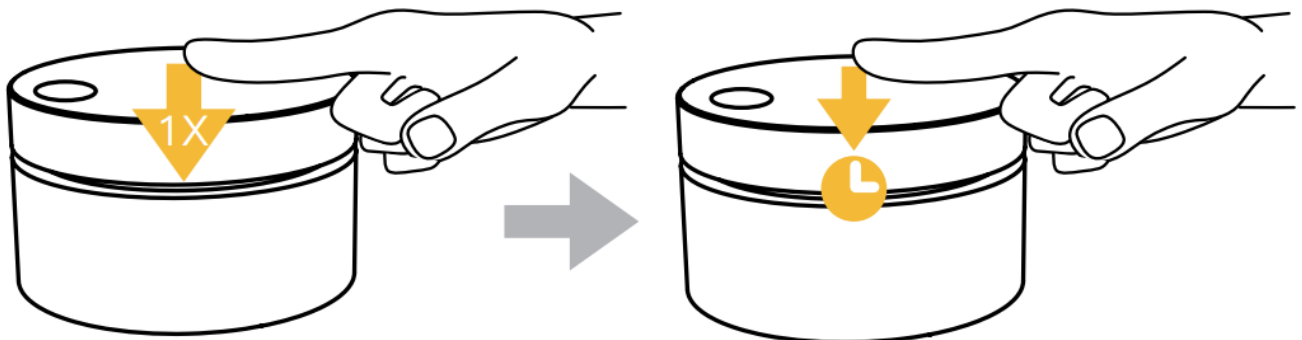

* **Note:** After remote control is selected as the wireless connection mode, the lamp and the mobile phone APP unpaired, and the cannot control with APP. Similarly, if the wireless connection mode is APP, the remote control cannot be used. The lamps that have been paired successfully can be switched back to the remote control from APP without pairing again.

3. Remote control switch on/off

CL60 and CU 00X series: Long press the turntable for 3 seconds to turn on, long press the turntable for 2 seconds to turn off. CL220 series: Long press the turntable 3 seconds light to zero.

* CL220 series uses a physical switch to manage the power supply of the lamps. Therefore, CTRL1 can only be used after be turned on.



* Start up from sleep

The remote control enters the sleep state after no operation for 3 minutes. You need to start it up by rotating, clicking, or double-clicking to continue the operation.

4. Switching options

Press the turntable to rotate the adjustment options.

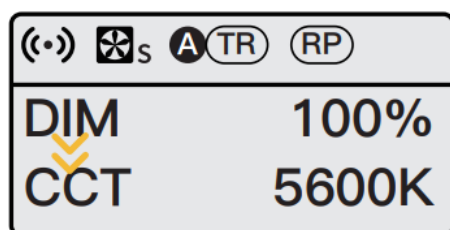

Product	Adjustable option
Monochrome temperature lights: CL60M, CL100X M, CL220M	Brightness
131-color temperature lights: CL60, CL100X, CL220	Brightness → Color temperature → Brightness
RGB full-color lights: CL6OR	INT → Color temperature → Hue → saturation → DIM → INT

* When connecting multiple lights, double click the turntable to unify all product options.

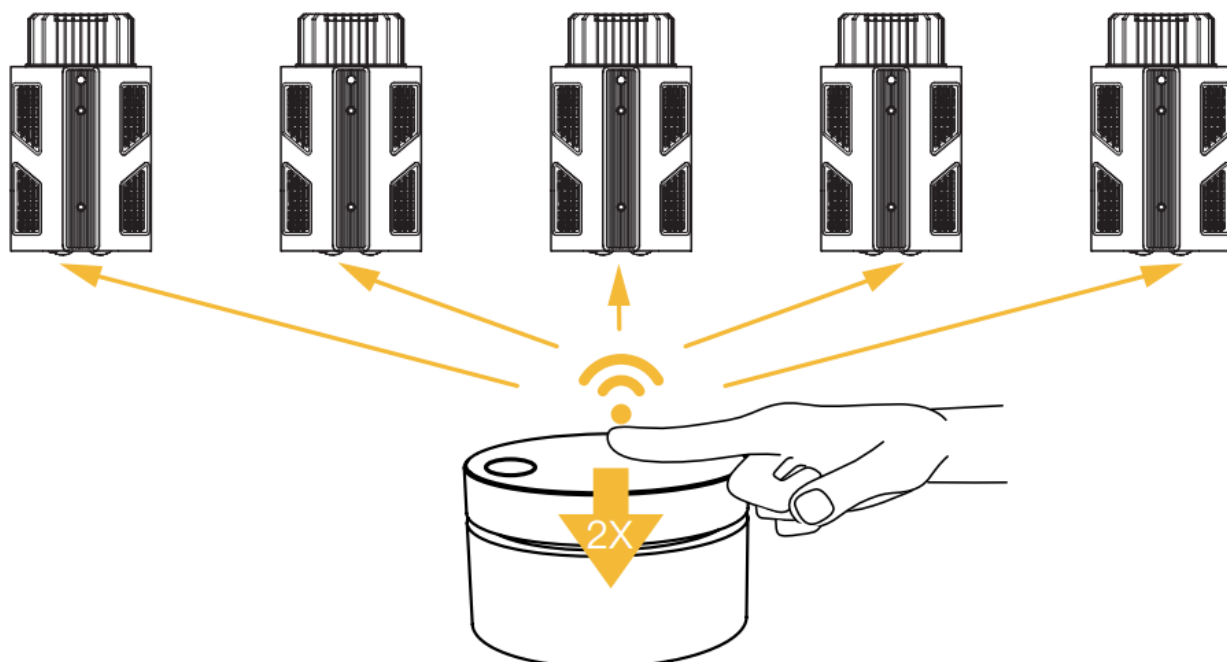

3. Adjust parameters

After selecting the option to adjust, turn the dial adjustment option parameters. Dial the turntable clockwise to increase the parameter and counterclockwise to decrease the parameter.

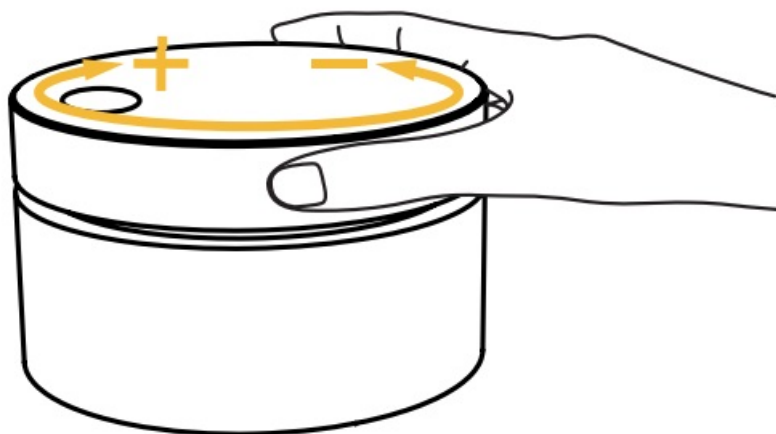

Specifications

Size	444.5mm*27.5mm
Weight	47.6g (Battery not Included)
Battery	Button Battery CR2450
Material	Aluminum alloy +ABS
Transmission	2.40Hz
Remote Control Distance	≈15-20m/ 49-66 ft (LOS area)

Package List

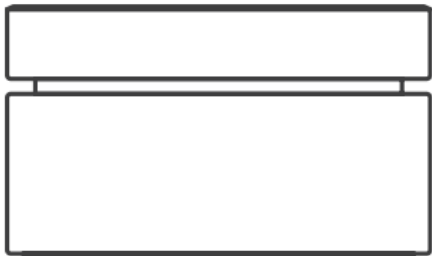

CTRL1 Remote
Dimming Control x1



Button battery x1



User Manual x1

WARRANTY

Warranty Period

Thank you for purchasing COLBOR products.

1. Customers are entitled to free replacement or repair service in case of quality defect(s) found in the product under normal use within 30 days upon receipt of the product.
2. Original COLBOR products are entitled to 12-month limited warranty service. The warranty period begins on the date of purchase of brand new, unused products by the first end-user.

Within the warranty period, if product defect or failure is attributable to material defection or technological problem, the defective product or defective part will be repaired or replaced without charge (service and materials fee).

Warranty Exclusions and Limitations

1. Faults resulted from inappropriate use of a product without following its operation specification
2. Artificial damage, e.g. crash, squeeze, scratch, soaking, exposing to rain or damp
3. Modifications to a product by its user or a third party without prior written consent of COLBOR, e.g. replacement of element or circuit, label alteration
4. The code on product is inconsistent with that of warranty certificate, or the code on the product or warranty certificate is altered or torn off
5. All consumable accessory attached to a product, like cable, Cover
6. Faults as a result of force majeure, such as fire, flood, lightning, etc.

Warranty Claim Procedure

1. If failure or any problem occurs to your product after purchase, please contact a local agent for assistance, or you can always contact COLBOR's customer service through email.
2. Please retain your sales receipt and warranty certificate as proof of purchase. If any of these documents is missing, only sales return or chargeable service will be provided.
3. If the COLBOR product is out of the warranty coverage, the service and the parts cost will be charged.



Room 2401, 24 / F, South Tower, Lisheng Plaza, No. 68 Hued! Avenue, Liwan District, Guangzhou, China, 510000



support@colborlight.com



www.colborlight.com

WARRANTY CERTIFICATE

Please register your warranty. Meanwhile, you are welcomed to contact us via Email.

USER INFORMATION	Customer Name:
	Phone Number:
	Email:
	Address:
SALES INFORMATION	Sales Date:
	Model:
	Product Code:
	Dealer:
REPAIR RECORD	Service Date:
	Technician:
	Issue:
RESULT	Solved
	Unsolved
	Returned
	Replaced

FCC Warning:

This equipment has been tested and found to comply with the limits for a Class B digital device, pursuant to part 15 of the FCC Rules. These limits are designed to provide reasonable protection against harmful interference in a residential installation. This equipment generates, uses and can radiate radio frequency energy and, if not installed and used in accordance with the instructions, may cause harmful interference to radio communications. However, there is no guarantee that interference will not occur in a particular installation. If this equipment does cause harmful interference to radio or television reception, which can be determined by turning the equipment off and on, the user is encouraged to try to correct the interference by one or more of the following measures:

- Reorient or relocate the receiving antenna.
- Increase the separation between the equipment and receiver.
- Connect the equipment into an outlet on a circuit different from that to which the receiver is connected.
- Consult the dealer or an experienced radio/TV technician for help.

Caution:

Any changes or modifications to this device not explicitly approved by manufacturer could void your authority to operate this equipment.

This device complies with part 15 of the FCC Rules. Operation is subject to the following two conditions: (1) This device may not cause harmful interference, and (2) this device must accept any interference received, including interference that may cause undesired operation.

This equipment complies with FCC radiation exposure limits set forth for an uncontrolled environment. This equipment should be installed and operated with minimum distance 0cm between the radiator and your body.

Documents / Resources

	Guangzhou Zhiying Technology CTRL1 COLBOR Remote dimming control [pdf] User Manual 2AXWL-CTRL1, 2AXWLCTRL1, ctrl1
---	--

Manuals+.