



GUANGZHOU AXGLO CLOUD TECHNOLOGY E5 Remote Control Instruction Manual

[Home](#) » [GUANGZHOU AXGLO CLOUD TECHNOLOGY](#) » GUANGZHOU AXGLO CLOUD TECHNOLOGY E5 Remote Control Instruction Manual 

Contents

- [1 GUANGZHOU AXGLO CLOUD TECHNOLOGY E5 Remote Control](#)
- [2 Remote Control](#)
- [3 Functions and Operation of Remote Control](#)
- [4 FCC Caution](#)
- [5 Documents / Resources](#)
- [6 Related Posts](#)

GUANGZHOU AXGLO CLOUD TECHNOLOGY

GUANGZHOU AXGLO CLOUD TECHNOLOGY E5 Remote Control



Remote Control

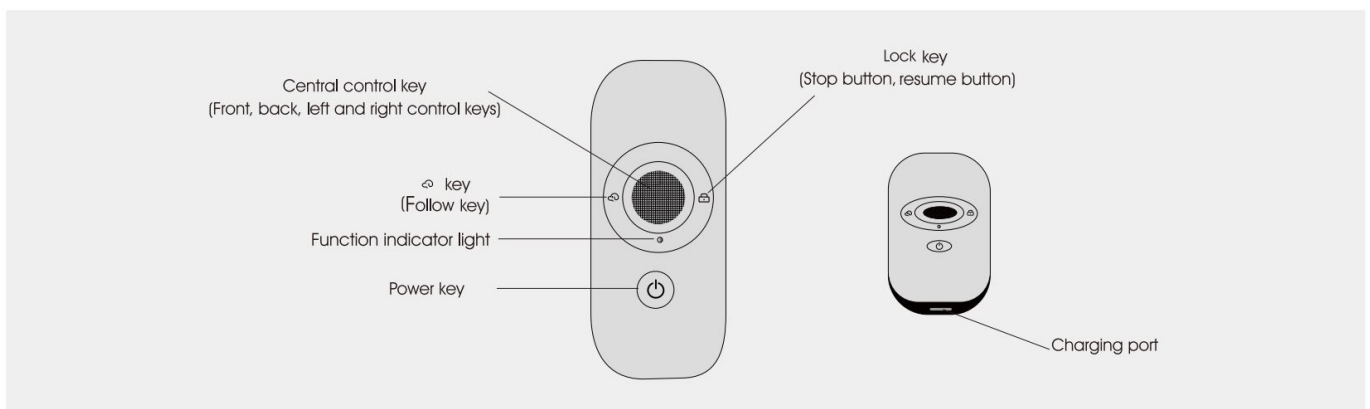

- The remote control contains a rechargeable lithium battery.
- The remote control can be charged through the USB cable, and the charging port is located at the bottom of the remote control.
- The “Power” key above the charging port will change to red during charge, and change to blue when it is fully charged.
- If your remote control runs out of battery during the use of the electric push cart, you can charge the remote control with the USB port on the cart.

Please note that charging the remote control through the USB port will consume the power of the cart and long-term charging will lower the battery level.

Functions and Operation of Remote Control

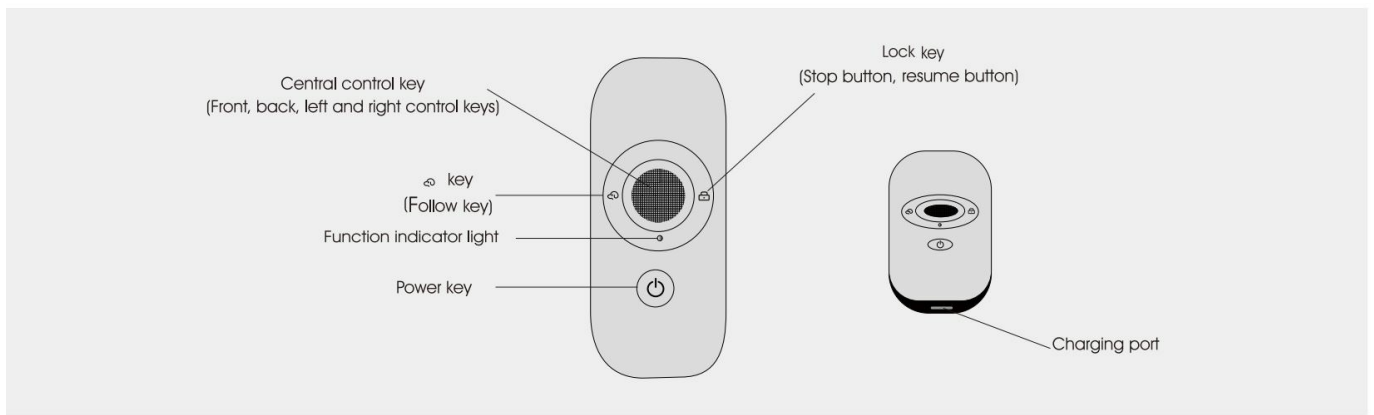

Power key (arrow shape)

When in use, press this key once and the power key will light blue, it means that the remote control has started normal operation; if the power key lights off, it means that the remote control is powered off; if the power key lights red, it means the remote control has low battery and needs to be charged. During the use of the cart, the remote control can be charged through the USB port of the cart. In other scenarios, Insert the USB cable into the (specification) interface of the power adapter and connect the adapter to the power socket.



Central control key ["O" shaped, frosted surface]

- **a. Manual driving mode:** The cart running indicator on the display will be on.



- Gently press and hold the key with your finger, and push it upward to enter manual driving mode; release the key and the cart will immediately stop movement.
- Gently press and hold the key with your finger, and push it upper left to enter "turning left" mode; release the key and the cart will immediately stop movement.
- Gently press and hold the key with your finger, and push it upper right to enter "turning right" mode; release the key and the cart will immediately stop movement.
- Gently press and hold the key with your finger, and push it downward to enter manual reverse mode; release the key and the cart will immediately stop movement.
- In general, it is not recommended to use the reverse mode. If it is used, you should operate the cart at a lower speed.

- **b. Remote cruising Control**

The central control key of the remote control has Remote cruising Control, Quickly push up the toggle 1 twice to

enter Speed 1 Cruise Control (D-4mk/h), and pushed up again to enter Speed 2 Cruise Control (5-7mk/h). When the central control key is pushed up for the third time, the car enter Speed 3 Cruise Control (7-9mk/h), which is the maximum speed of the car. Push the toggle down gently, and the electric car returns to manual mode. Gently press the button with your finger and turn left to enter the "turn left" function; release the key and resume the Remote cruising Control in the direction of the front. Gently press the button with your finger and turn right to enter the "right steering" function. ; release the key and resume the Remote cruising Control driving mode in the direction of the front.

Follow key (key)

Gently press this key once to enable the auto-follow mode and the  pattern on the display will light up. In auto-follow mode, the radar detector at the front of the electric cart (marked on the attached figure of whole cart) will automatically track the remote control at the set distance; there should be no obstacle (including human) between the transceiver on the top of the remote control and radar detector, and the remote control should be kept upright. otherwise, signal may be affected. Press the key again to exit the function.

Lock key

This key is the "lock, unlock and stop" key (after turning on the power switch of electric cart and remote control, the display on the cart shows "The cart is unlock and you can enter manual operation"). Gently press the right key on the remote control, and the display will show the lock sign (at this time, the cart cannot be operated manually) . Gently press the right key and the lock sign on the display will disappear (at this time, the cart can be operated manually or by remote control). When parking on a slope, please do not turn off the power and remember to press this key. At this time, the lock sign on the display will light up. Turning off the power would disable the electric braking system of the cart.

Function indicator light

1. The central control key is pushed up two times quickly and continuously to enter the cruise function. At this time, the color of the remote control function indicator is yellow.
2. The left button ( key) of the remote control is the follow key (also known as the recall key). When pressed to enter the follow function (within 2.5 meters), the color of the indicator light of the remote control function is green.
3. The right button of the remote control is the lock key (also known as the unlock key), and the color of the remote control function indicator is red when entering the lock function.
4. Press to unlock (lock key), the remote control function indicator light color indicator light is blue when standby.

FCC Caution

This device complies with part 15 of the FCC Rules. Operation is subject to the following two conditions: (1) this device may not cause harmful interference, and (2) this device must accept any interference received, including interference that may cause undesired operation. Any changes or modifications not expressly approved by the party responsible for compliance could void the user's authority to operate the equipment.

NOTE: This equipment has been tested and found to comply with the limits for a Class B digital device, pursuant to Part 15 of the FCC Rules. These limits are designed to provide reasonable protection against harmful interference in a residential installation. This equipment generates, uses and can radiate radio frequency energy and, if not installed and used in accordance with the instructions, may cause harmful interference to radio communications. However, there is no guarantee that interference will not occur in a particular installation. If this equipment does cause harmful interference to radio or television reception, which can be determined by turning the equipment off and on, the user is encouraged to try to correct the interference by one or more of the following measures:

- Reorient or relocate the receiving antenna.
- Increase the separation between the equipment and receiver.
- Connect the equipment into an outlet on a circuit different from that to which the receiver is connected.
- Consult the dealer or an experienced radio/TV technician for help.

The device can be used in portable exposure condition without restriction. UWB devices may not be employed for the operation of toys. Operation onboard an aircraft, a ship or a satellite is prohibited per 15.521(a). Antennas mounted on outdoor structures such, as antennas mounted on the outside of a building or on a telephone pole, or any fixed outdoors infrastructure are prohibited for use with this device per 15.519(a).

This device contains licence-exempt transmitter(s)/receiver(s) that comply with Innovation, Science and Economic Development Canada's licence-exempt RSS(s). Operation is subject to the following two conditions:

1. This device may not cause interference.
2. This device must accept any interference, including interference that may cause undesired operation of the device.

Any changes or modifications not expressly approved by the party responsible for compliance could void the user's authority to operate the equipment.

RF exposure statement:

The equipment complies with IC Radiation exposure limit set forth for uncontrolled environment. The device can be used in portable exposure condition without restriction.

Documents / Resources

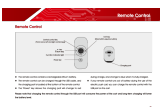
	<p>GUANGZHOU AXGLO CLOUD TECHNOLOGY E5 Remote Control [pdf] Instruction Manual 2BB58-E5, 2BB58E5, E5, E5 Remote Control, Remote Control, Control</p>
---	--