



# GSEICE SY80 110V Ice Maker Machine User Guide

[Home](#) » [GSEICE](#) » GSEICE SY80 110V Ice Maker Machine User Guide 

## Contents

- 1 GSEICE SY80 110V Ice Maker Machine
- 2 IMPORTANT SAFETY INSTRUCTIONS
- 3 PARTS DESCRIPTION
- 4 OPERATION
- 5 UNPACKING AND INSTALLATION
- 6 WATER CONNECTION FOR YOUR ICE MACHINE
- 7 CLEANING AND MAINTENANCE OF YOUR ICE MACHINE
- 8 TROUBLESHOOTING
- 9 WARRANTY
- 10 Documents / Resources
  - 10.1 References

# GSEICE<sup>®</sup>

**GSEICE SY80 110V Ice Maker Machine**



## IMPORTANT SAFETY INSTRUCTIONS

When using your GSEICE Commercial Ice Machine (appliance), basic safety precautions should always be followed to reduce the risk of fire, electrical shock, and/or injury to persons. Incorrect operation due to ignoring instructions may cause harm or damage.

- Use this appliance only for its intended purpose as described in this manual.
- This Ice Machine must be properly installed in accordance with the installation instructions before it is used.
- The appliance must be positioned so that the plug is accessible.
- Connect the plug to properly polarized outlets only. No other appliance should be plugged into the same outlet. Be sure that the plug is fully inserted into the receptacle.
- Do not run the power cord over carpeting or other heat insulators. Do not cover the cord. Keep the cord away from traffic areas, and do not submerge in water or any other liquid.
- We do not recommend the use of an extension cord as it may overheat and cause a risk of fire. If you must use an extension cord, use No.14AWG as a minimum size and rated no less than 1875 watts.
- If the supply cord is damaged, it must be replaced by the service agent, or a similarly qualified person in order to avoid a hazard.
- Disconnect the main plug from the socket when not in use for a long period of time.
- Unplug the appliance before cleaning or making any repairs or services.
- Never unplug your appliance by pulling the power cord. Always grasp the plug firmly and pull straight out from the outlet.
- Do not use your appliance outdoors. Keep the appliance away from direct sunlight and make sure that there are at least 6 inches between the back of your appliance and the wall.
- Do not tip over the appliance. Otherwise, it will generate noises and make the size of each ice cube irregular. It

may also cause water leakage from the appliance.

- If the appliance is brought in from the outside during the winter season, give it a few hours to warm up to room temperature before plugging it in.
- Do not use any other liquids to make ice cubes besides water
- Failure to follow these instructions can result in death, fire, or electrical shock.
- Keep ventilation openings in the appliance enclosure or in the built-in structure clear of obstruction.
- Do not damage the refrigerant circuit.
- This appliance is not intended for use by persons (including children) with reduced physical, sensory or mental capabilities, or a lack of experience and knowledge. This applies unless they have been given supervision or instruction concerning use of the appliance by a person responsible for their safety.
- Children should be supervised to ensure that they do not play with the appliance.
- Do not store explosive substances, such as aerosol cans with a flammable propellant, in this appliance.
- This appliance is intended to be used in indoor and similar applications, such as staff kitchen areas in shops, offices and other working environments, farmhouses and hotels, motels and other residential type environments, bed and breakfast type environments, or catering and similar non-retail applications.
- **IMPORTANT:** The wires in the power cord are colored in accordance with the following code:
  - Green or Green with a strip
  - Yellow: Grounding
  - Bronze: Neutral
  - Blue: Live
- To avoid the appliance falling or tipping over, always place on a flat, sturdy surface. Damage may occur if the appliance falls.
- Do not clean your Ice Machine with flammable fluids. The fumes can create a fire hazard or

## **WARNING**

- To avoid a hazard due to any instability of the appliance, it must be placed on a flat, sturdy surface.
- This appliance **MUST** be earthed. Use the proper power source according to the rating label. Use 110-120V/60Hz earthed power supply.

## **ELECTRICAL SHOCK HAZARD**

- Plug into a grounding wall outlet.
- Never remove the ground prong.
- Use a separate power supply or receptacle.
- Never use an adapter.
- Never use an extension cord.
- Failure to follow these instructions can result in death, fire, or electrical shock.

## **PARTS DESCRIPTION**

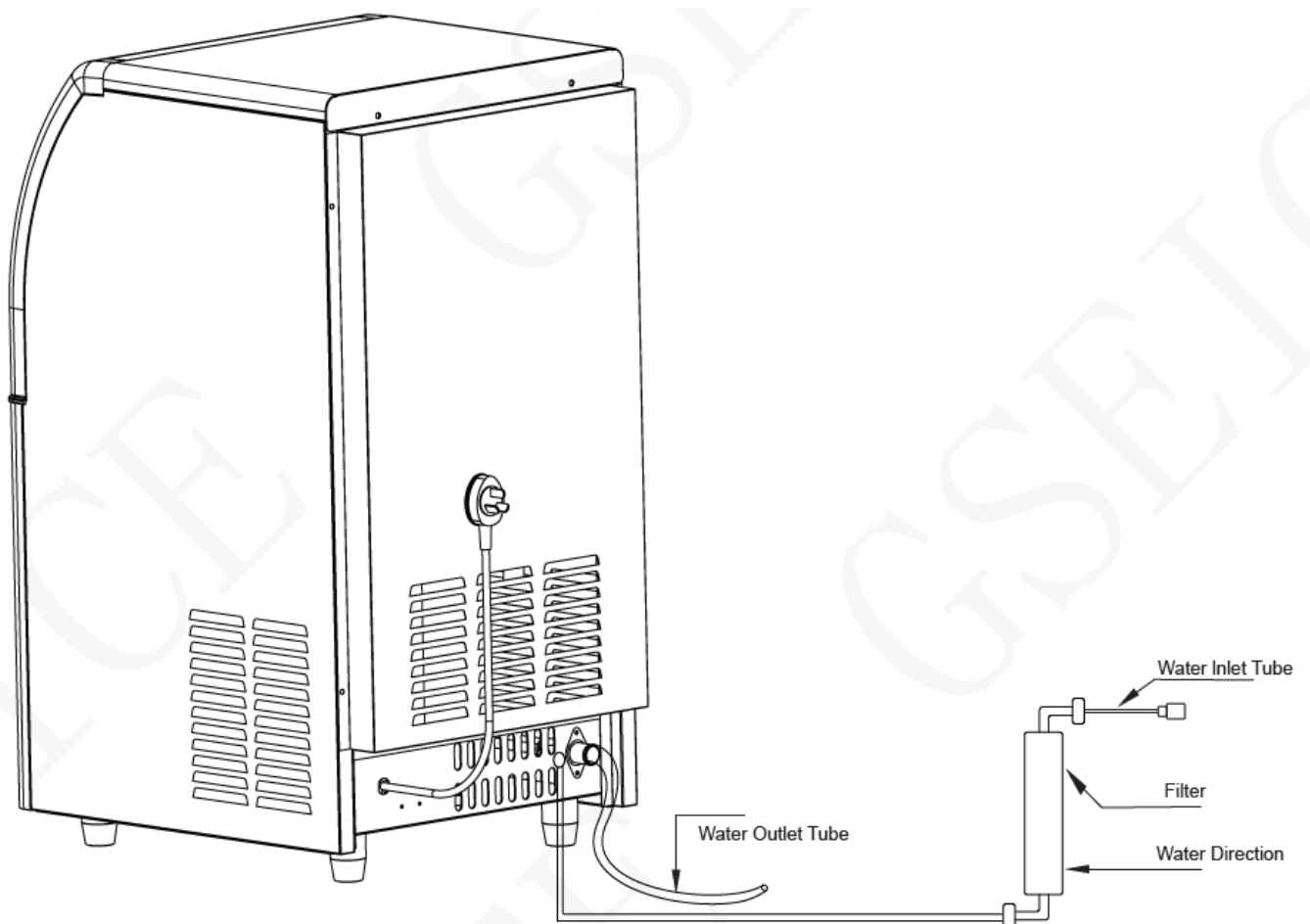
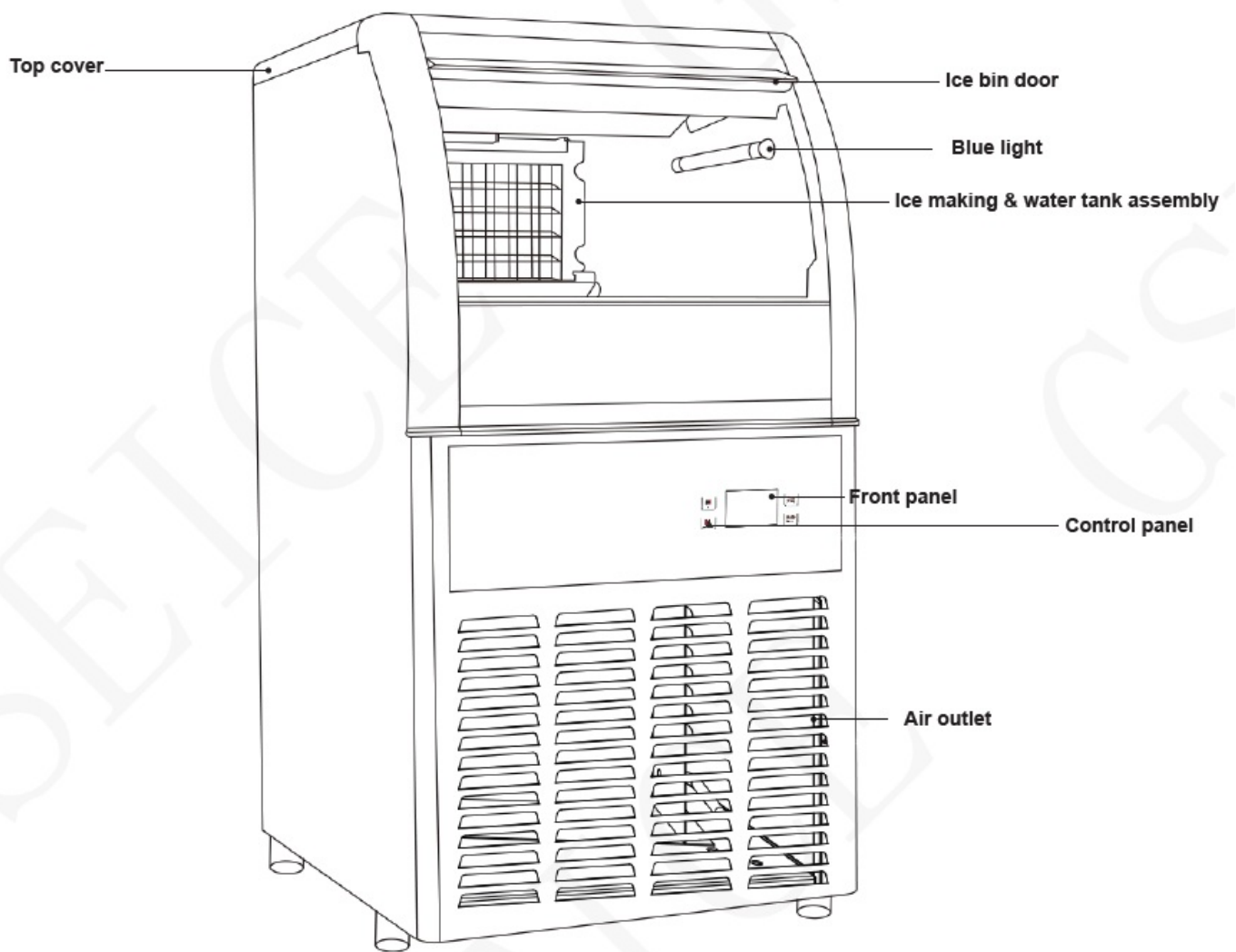

## ACCESSORIES

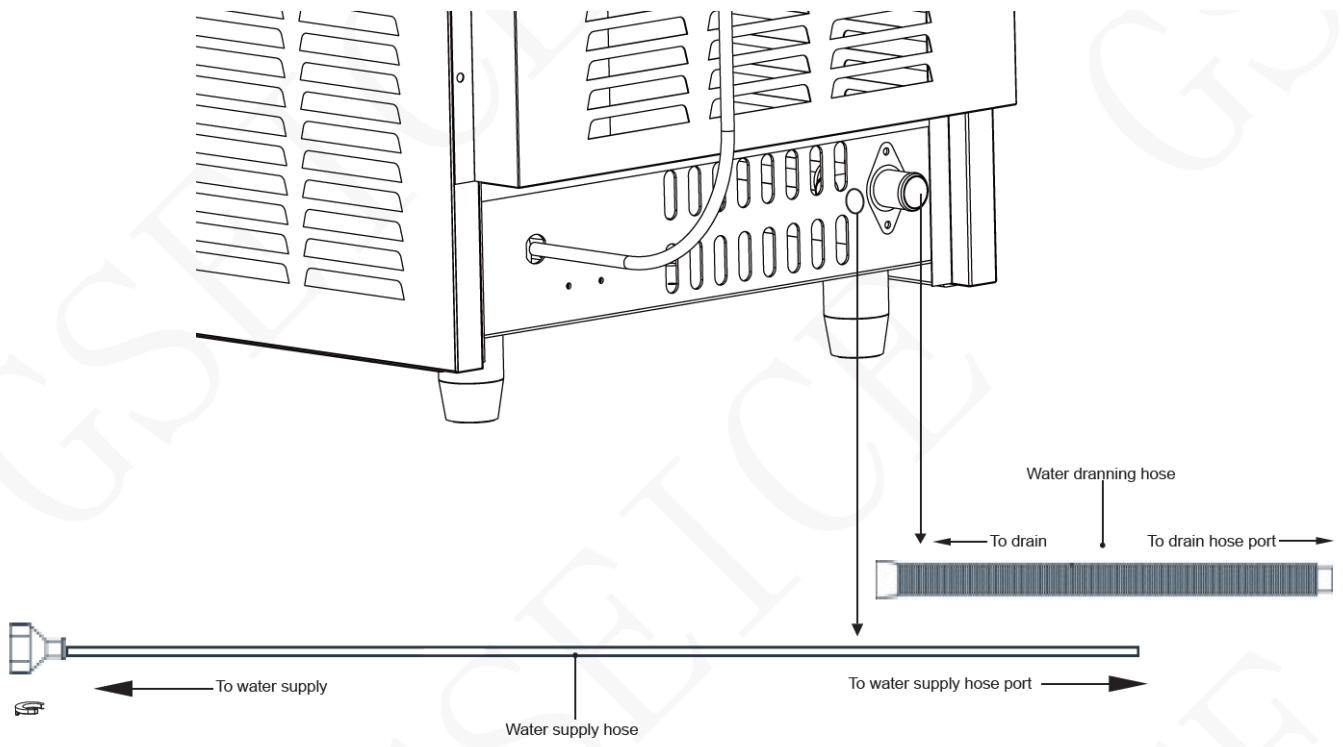

Filter (For SY100 SY150 Model)

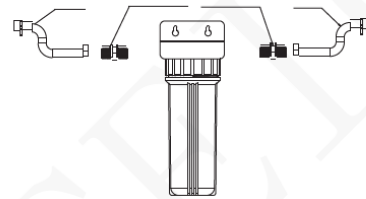

Filter (For SY200 SY300 SY440 Mode)

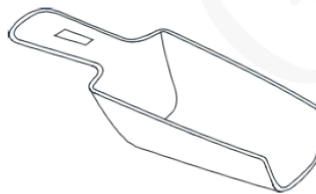

Ice scoop

## OPERATION

### 1. "+ -" button

Press and hold "+" for 3 seconds, then press "+" or "-" to adjust the thickness of the ice. Wait for 5 seconds until finishing setting, it will return to the interface of ice making.

### 2. Power switch and Ice falling button

After the machine power on, press the SWITCH button to start making ice;

During ice-making progress, press it to enter to ice falling progress;

During ice-making or ice falling progress, press and hold the SWITCH button for 3 seconds, it will turn off the machine.

### 3. Cleaning and Timing Button

During the standby mode, press and hold the cleaning button for 3 seconds, it will enter to cleaning mode.

When the machine is power on, press the timing button, it will enter to timing of turning off. And press it again to cancel timing setting

When the machine is during the standby mode, press the timing button, it will enter to timing of turning on. And press it again to cancel timing setting

(The unit of countdown time showed is hour)

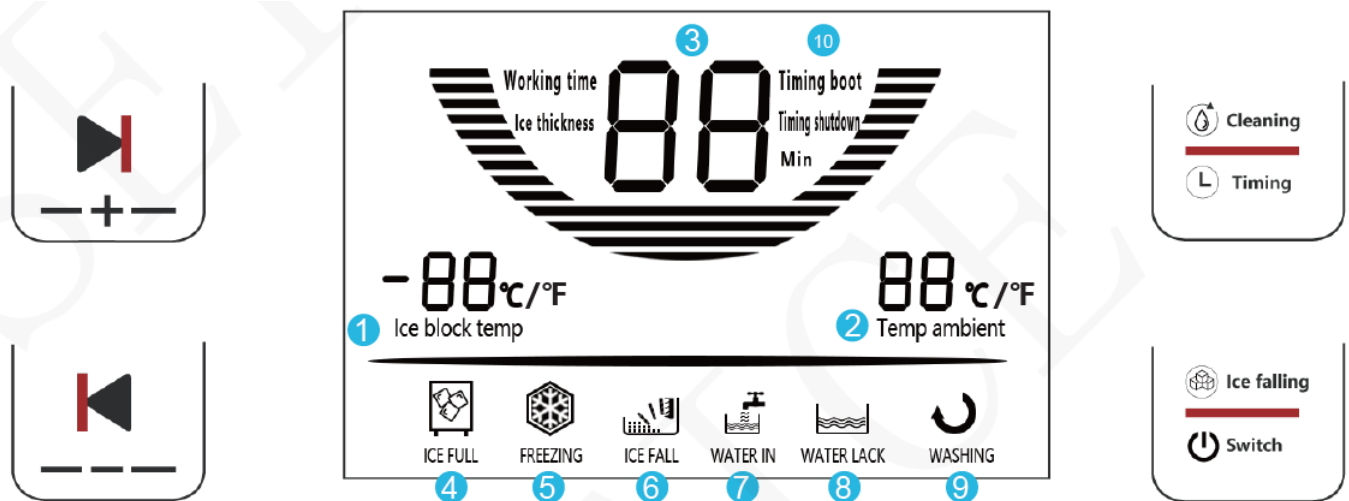

1. Plug in the Ice Machine. Press the “Switch/ice falling” button on the control panel. The Ice Machine will start to make ice cubes. When the water inside reaches the standard level on the water tank through the electromagnetic water valve. The “FREEZING” (5) symbol will lights on. The ice cord temperature will be displayed in the upper left (1) of the display, while the ambient temperature will displayed (2) on the right side. A few minutes later, there will be a number displays in the middle(3): “10” which means the remaining ice making time for the current cycle is 10 minutes.

When each ice making cycle is completed, it will enter the ice falling process, and the ICE FALL symbol(6) will turn on. In the case of a water shortage, the “WATER LACK” will light on(8), please check whether the water tank is blocked and then restart the machine. When the WATER IN symbol(7) flash on. It means the machine is in the adding water progress, the symbol will flash off when the water is full.

**NOTE:** Each ice making cycle takes about 11-20 minutes based on the ambient and water temperature. The first ice making cycle will be longer because of the high water temperature in the water tank. However, it will last for less than 30 minutes.

2. To adjust the ice thickness, press and hold the “+” button for 3 seconds on the control panel. The number at the bottom right of the display screen shows the thickness setting. Press the “+” button once to add one minute at a time, and the ice cubes will be thicker. Press the “-” button once to reduce one minute at a time, and the ice cubes will be thinner.

NOTE: The adjustment only affects the next and subsequent ice making cycles.

3. When the ICE FULL symbol(4) lights up, the appliance stops working. It will work again after you take out the ice.
4. To turn off the appliance during the ice making process, press the “Switch/Ice Falling” button on the control panel to enter the standby mode. If you press and hold “Switch/Ice Falling” for more than 3 seconds during ice making, the appliance enters into the ice falling process.

5. The timing setting range is between 1 to 23 hours. When the appliance is running, you can set up a certain time to turn it off. When the appliance is on standby, you can set up a certain time to turn it on. To set up the timing, press the "TIMEING/Clean-ing" button. The default time displays "1" (means 1 hour). Press the "+" or "-" buttons to adjust to the time that you desire. The "Timing boot"/"Timing shutdown" light(10) indicates that the appliance currently has a timing setting on. Press the "TIMING/CLEANING" button again to cancel the timing setting during the countdown.
6. To start the Self-cleaning program, plug in the main power plug after connecting the water hoses, then press and hold the "TIMING/CLEAN" button for more than 3 seconds. The "WASHING" light (9) will turn on, and the time countdown area will display 30M. This means the default cleaning time is 30 minutes. The "WASHING" symbol will light on during this period. The water pump runs and stops, then recycles. The total duration time is 30 minutes for one self-cleaning cycle. When the water pump stops working, water will flow to the water tank automatically. When the program is completed, the Ice Machine will turn off automatically.  
**NOTE:** You can press the "Switch/Ice Falling" button to cancel the Self-cleaning program immediately.

## UNPACKING AND INSTALLATION

1. Remove the exterior and interior packaging. Check if all the accessories, including the instruction manual, ice scoop, filter and water inlet hose are inside. If any parts are missing, please contact GSEICE customer service at +8618011725089/+8619928402783.
2. Remove the tape that is holding the door, inner cabinet, and ice scoop to the appliance. Clean the inside of the Ice Machine and accessories with water. Let the appliance dry completely.
3. The unit comes with a removable protective film to prevent the unit from getting scratches during transport. Remove the film by peeling off by hand or with the help of adhesive tape to pull the film. Put the appliance on a flat surface without direct sunlight and/or other sources of heat (i.e. stove, furnace, radiator). Make sure there is at least a 20 inches gap between the air outlet and any obstacles, 6 inches between two sides of the machine and at least 8 inches between the back and the wall.
4. The appliance must be positioned so that the plug is accessible.
5. Do not put anything on top of the Ice Machine.
6. When installing the Ice Machine under a counter, follow the recommended spacing dimensions. Place electrical supplies, water supplies, and drain fixtures in the recommended locations as shown in the figure below.
7. Choose a well-ventilated area with the ambient temperature between 41°F and 90°F. This appliance **MUST** be installed in an indoor area without wind, rain, water, spray, or drips.
8. The Ice Machine requires a continuous water supply with the pressure of 0.13-0.55 MPa (19-80 psi). The

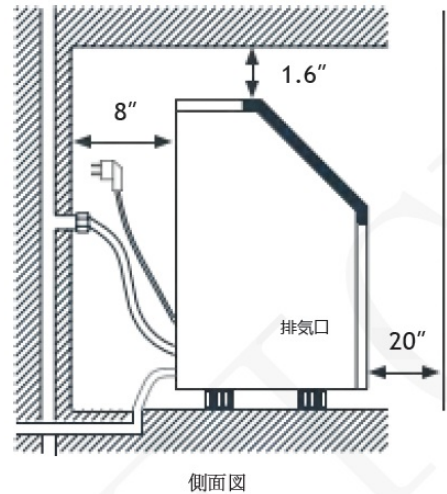
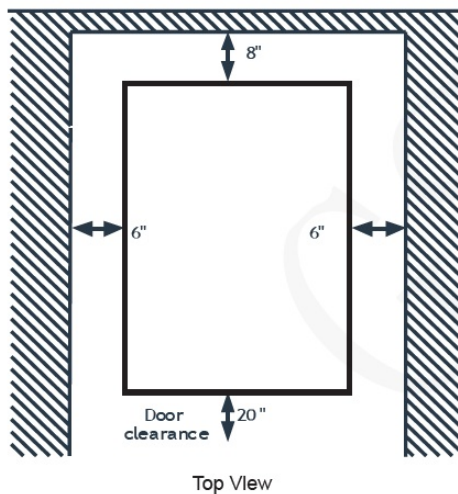

## CONNECTING YOUR ICE MACHINE

**WARNING:** Improper use of the grounded plug can result in the risk of electrical shock. If the power cord is damaged, please contact GSEICE Customer Service at +8618011725089.

1. It is recommended to plug the unit on a dedicated outlet with a circuit breaker of 15A rating capacity. Use receptacles that cannot be turned off by a switch or pull chain. If the supply cord or plug needs to be replaced, it should be done by a certified electrician.
2. Plug your appliance into a secure, properly installed, grounded wall outlet. Under any circumstances, do not cut or remove the third (ground) prong from the power cord. Any questions concerning power and/or grounding should be directed toward a certified electrician.
3. This appliance requires a standard 110-120 volt, 60Hz electrical outlet.

**Before using your appliance, it is strongly recommended to clean it thoroughly.**

4. Open the Door for ice taking.
5. Clean the inside with a special ice maker cleaning fluid (usually based on citric acid), warm water, and a soft cloth.
6. Then use potable water to rinse the inside parts. You can pull the water draining hose to drain out the rinsed water in the water tank.
7. Clean the ice storage cabinet in the same way. Drain out all rinsed water from the water draining hose, which is located at the back of the Ice Machine.
8. You must reinstall the water draining hose of the water tank and the cap of the water draining port. Otherwise, the appliance will not make ice normally. After cleaning, you should discard the ice cubes made from the first ice making cycle.
9. The outside of the Ice Machine should be cleaned regularly with a slightly damp cloth.
10. Dry the interior and exterior with a clean, soft cloth.

## WATER CONNECTION FOR YOUR ICE MACHINE

**NOTE:** The water pressure of the main water supply system should be 0.13-0.55mpa (19-80 psi).

1. Connect the water supply hose to the filter: Insert the short side of the filter into water hose. Then connect the other side of the filter with water supply system.
2. Connect the water draining hose: Connect the end of this draining hose to the main water drainage pipeline.



Keep drain hose below water drainage port “A.”

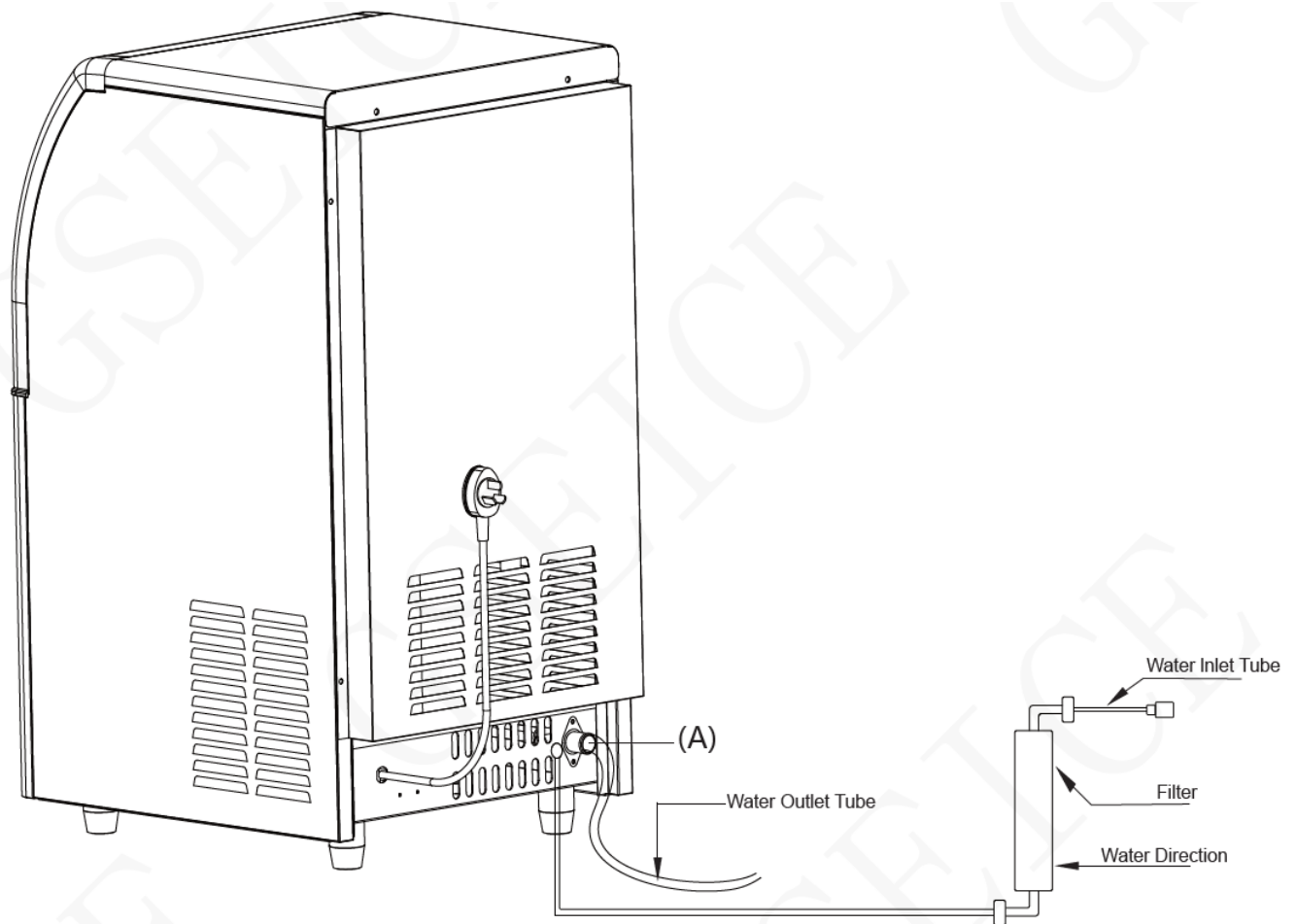

### Connect filter with water supply

For SY100 SY150 Model

Remove the clipper of the filter

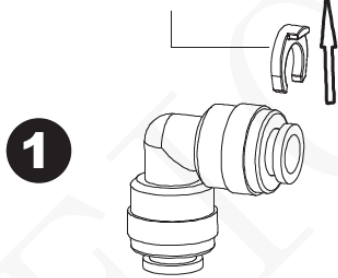

connect the hose with the filter, push inwards completely

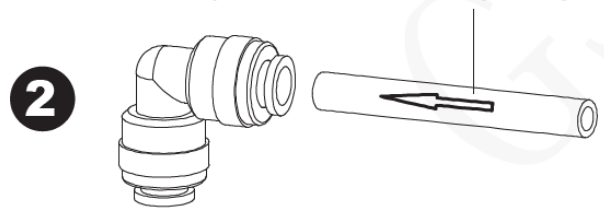

reinstall the clipper

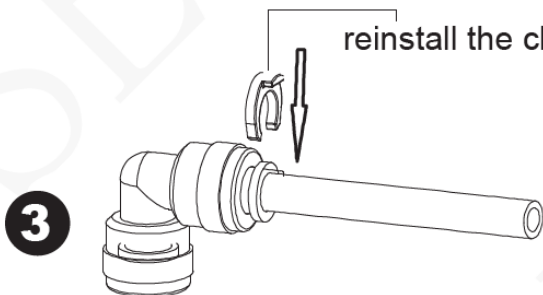

complete installation

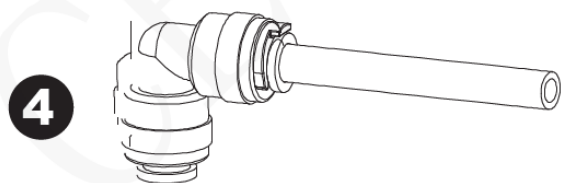

### Remove the connection between filter and water supply hose

For SY100 SY150 Model

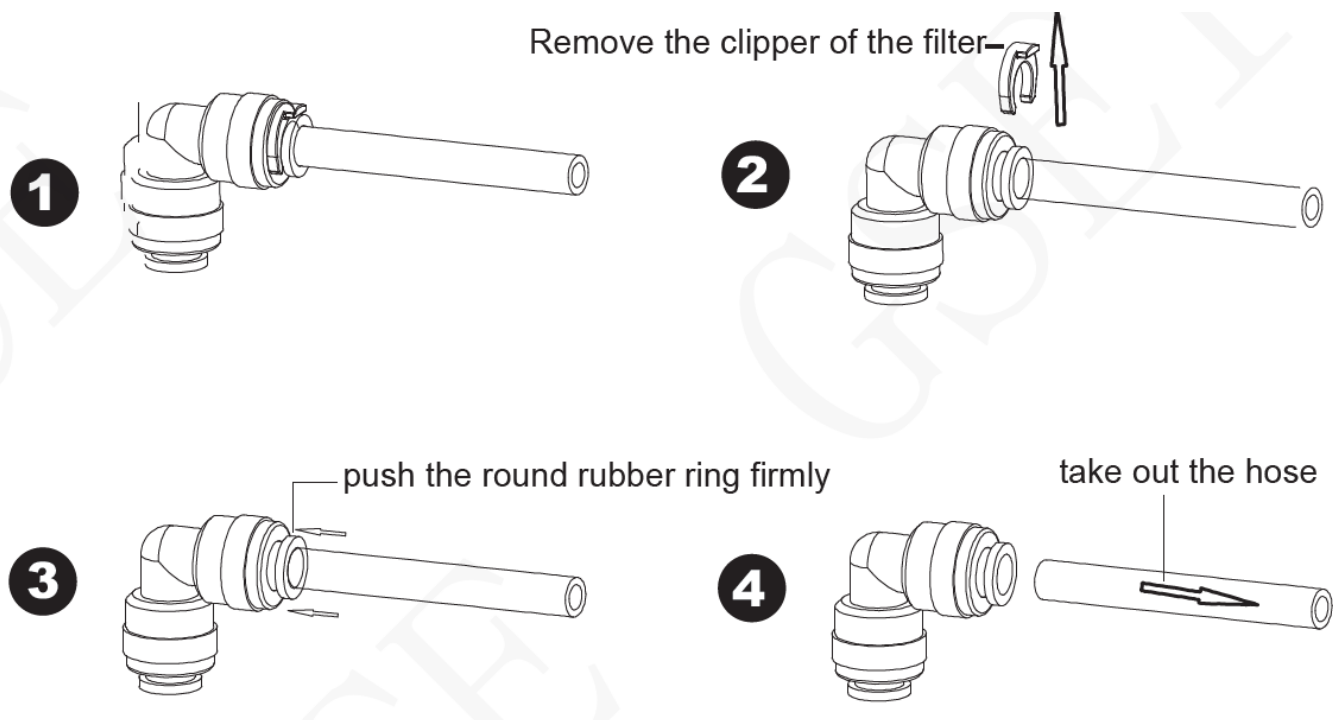

**Display diagram of installing water filter**  
For SY200 SY300 SY440 Model

**1** Install the pipe with filter

1. connect the threaded joint with the inlet water connection of the filter
2. insert the pipe to the threaded joint.

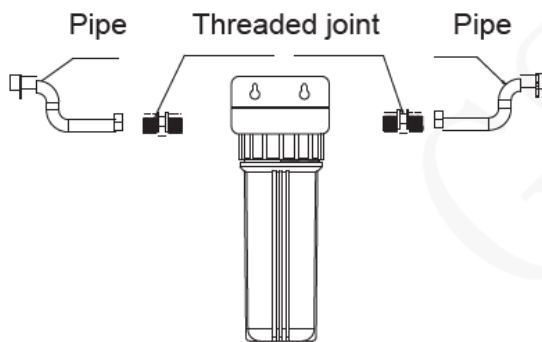

Connect the water supply

Connector of purified water

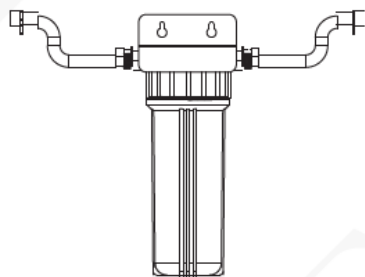

**2** Completed

3. connect the threaded joint with the outlet water connection of the filter
4. insert the pipe to the threaded joint

**Display diagram of replacing filter element**  
For SY200 SY300 SY440 Model

## 1 Remove the filter bowl

Put the spanner on the top of the filter bowl and unscrew it with force.

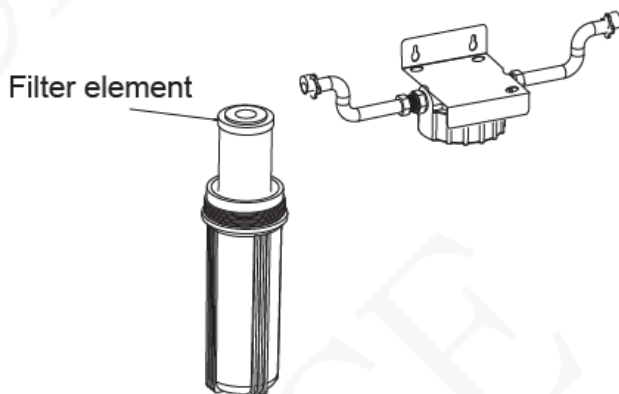
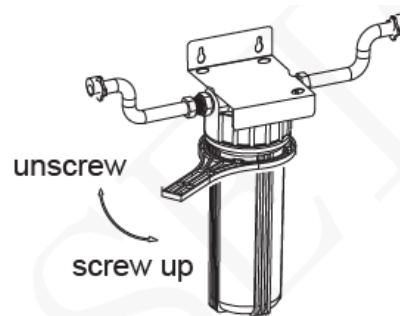

## 2 Replace the filter element

Take the filter element out and replace a new one.

### A. "TIMING/CLEANING" button

Press this button to enter the TIMING setting program. Press and hold this button for more than 3 seconds to enter the CLEAN program.

### B. "SWITCH/ICE FALLING" button

Press this button to enter ICE Making mode after power on.

When the appliance is making ice cubes, press this button to switch to the ice falling process.

Press and hold for 3 seconds to enter Standby mode when the machine running.

### C. LED display

1. Ice making time countdown and thickness level. The unit of Ice making time countdown is Minutes (M).
2. Timing of turning on and timing of turning off.
3. Ice cord temperature and Ambient temperature. The unit of temperature is Celsius(°C).
4. ICE FULL alarm. Take out the ice before the next ice making cycle.
5. Ice making and ice-falling display.
6. Inlet water.
7. Water shortage display. When the WATER LACK symbol lights on, it indicates that there is not enough water in the water tank.
8. Automatic self-cleaning.

#### D E. "+" "-" button

Press and hold the "+" button for 3 seconds to adjust the thickness of ice while Press and hold the "-" button for 3 seconds to turn on/off the inner light. Wait for 5 seconds until finishing setting, it will return to the main interface.

Adjust the ice thickness with the "+" or "-" button. There will be 1 gear added or reduced per each press of the "+" or "-" button.

It is also used to adjust the delay time of the timing. The default setting is zero. There will be 1 hour added or reduced per each press of the "+" or "-" button.

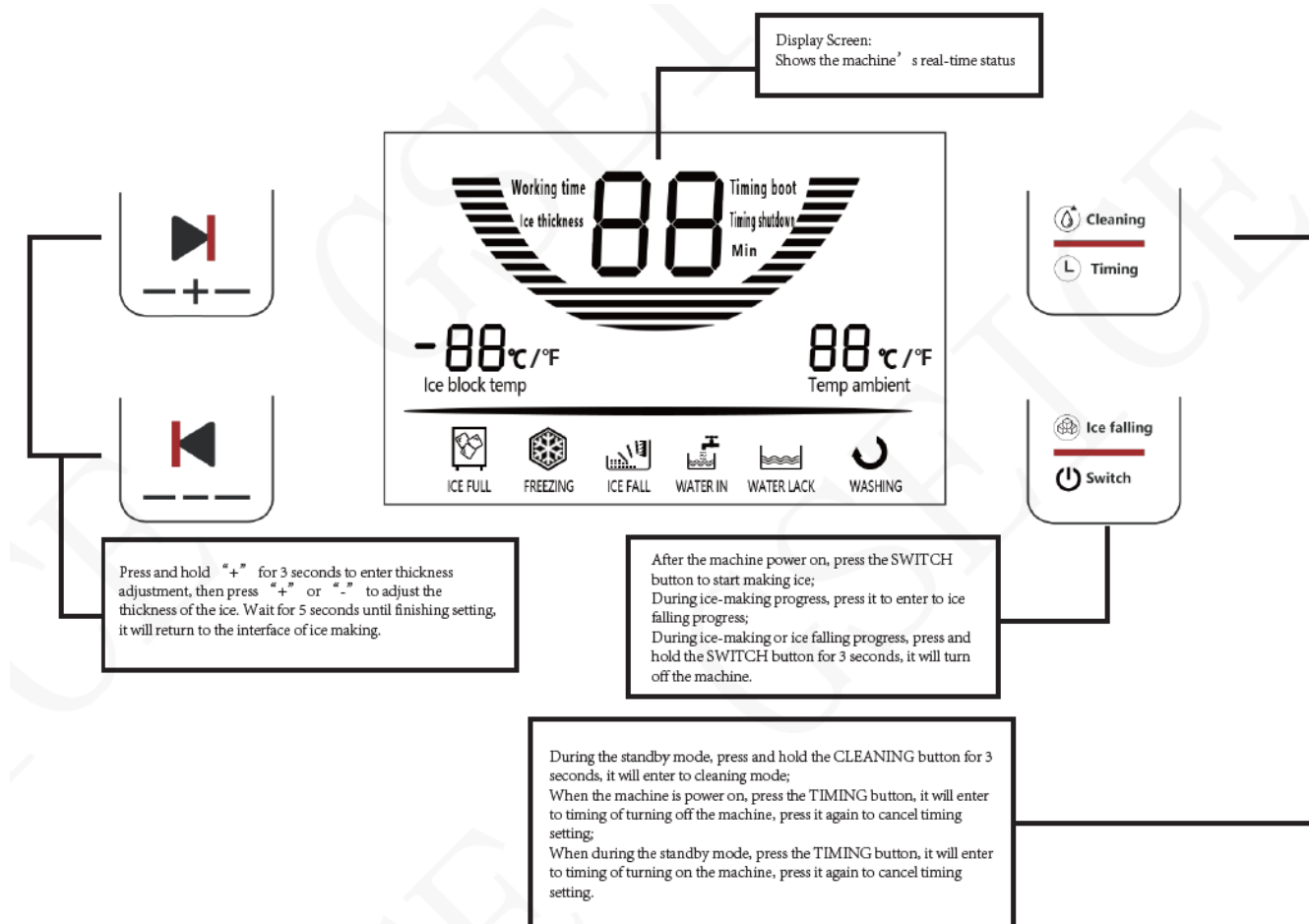

## CLEANING AND MAINTENANCE OF YOUR ICE MACHINE

**WARNING:** Before cleaning or maintenance, unplug the Ice Machine from the main power supply (Exception: Self-cleaning program). Do not use any alcohol or fume for cleaning/sanitization of the Ice Machine. It may cause cracks on the plastic parts. Ask an authorized service engineer to check and clean the condenser at least once a year, in order to keep the appliance working properly.

**CAUTION:** If the Ice Machine has been left unused for a long period of time, it must be thoroughly cleaned before the next use. Follow the cleaning instructions below. Do not leave any solution inside the Ice Machine after cleaning.

Periodic cleaning and proper maintenance will ensure efficiency, performance, hygiene, and duration of the machine. Never keep anything in the ice storage bin. Objects, like wine and beer bottles, are unsanitary and may cause obstruction of the drain pipe.

### Exterior Cleaning

To clean the outside of the Ice Machine, use a slightly damp cloth and wipe down the exterior. DO NOT use direct water or solvent-based or abrasive cleaners.

**NOTE:** Stainless steel products exposed to chlorine gas and moisture, such as in spas or swimming pools, may cause discoloration of stainless steel. Discoloration from chlorine gas is normal.

### Cleaning of Ice Storage

The ice storage cabinet should be sanitized occasionally. Clean the cabinet before the Ice Machine is used for the first time and reused after a long period of time. Follow the steps below:

1. Turn off the Ice Machine and unplug the power cord.

2. Open the Door for ice taking and wipe down the interior with a special ice maker cleaning fluid (usually based on citric acid) and follow the instructions provided by the manufacturer.
3. Rinse thoroughly with potable water. The rinsed water should be drained out via the drain hose.
4. Dry with a clean, soft cloth.

The ice scoop should be washed regularly. Wash it in the same fashion as you would any food container.

### **Cleaning of the Ice Making Parts**

1. Repeat the above steps to clean the water tank and other inner parts of the Ice Machine.
2. When the water flowing from the water dividing pipe on the evaporator is very minor, disassemble the water dividing pipe for cleaning. Clean each small hole on the water dividing pipe, like in the following illustration on Page 14. Make sure all holes are unclogged, then reinstall the water dividing pipe to the original location.  
If the ice cubes on the surface of the evaporator do not fall down easily, do not use mechanical force to remove them. Press and hold the "Switch/Ice Falling" button for more than 3 seconds to switch to the ice falling process. The ice cubes will start to fall down. Turn off the Ice Machine and unplug the power cord to clean the surface of the evaporator.

NOTE: After cleaning the interior parts of your Ice Machine, install the parts to the original position, then plug in and turn on the machine. It is recommended to discard the first batch of ice.

### **Cleaning Suggestion**

1. The Ice scoop, door for ice taking, and water outlet pipe should be cleaned after each use. Rinse the ice scoop and wipe the door with a clean cloth.
2. The Water tank, Ice full detecting board, and the surface of the Evaporator should be cleaned twice every month.
3. All the components and surfaces exposed to water or ice cubes, like the Ice storage bin, water tank, evaporator, water pump, silicone tube, water outlet pipe, etc. should be cleaned by using a nickel safe ice machine cleaner 6 months after the first use. This should be done by a professional service provider.

WARNING: Wear rubber gloves and safety goggles when handling the Ice Machine Cleaner or Sanitizer.

NOTE: Minerals that are removed from water during the ice making cycle will eventually form a hard, scaly deposit in the water system. Clean the system regularly to remove the mineral scale buildup. The frequency of cleaning depends on how hard your water is. With 4 to 5 grains/liter, it is recommended to clean the system every 6 months.

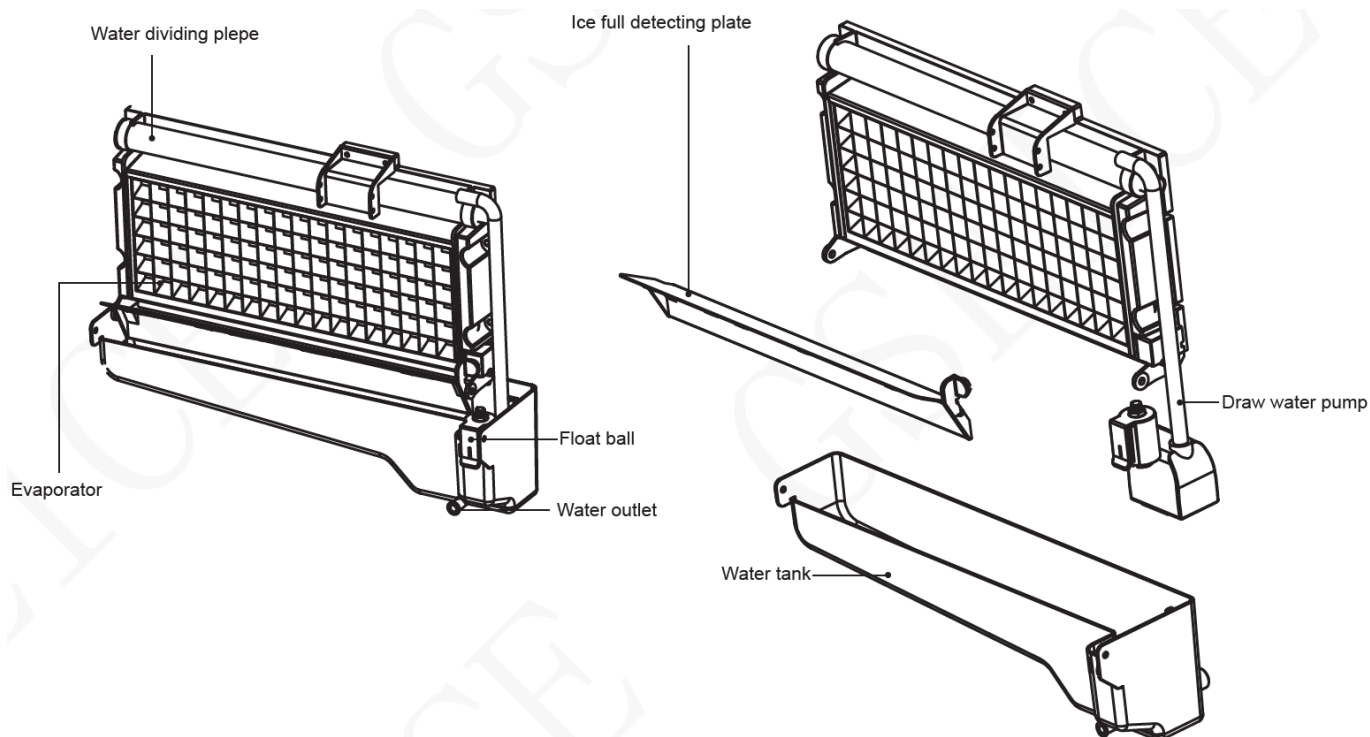

## TROUBLESHOOTING

Problem	Possible Cause	Solution
	The ice maker is not powered on	Check power cord, power switch, power plug, socket, main board and fuse
	There is no water source supply	Check whether the water source switch on or not
	Ice falling baffle is in the open position	Check whether the ice falling baffle can swing freely or not
Automatic shutdown of ice maker every 3 minutes	High pressure protection	Check whether ambient temperature is too high , condenser filter is too dirty or fan motor damage or not
	The water tank level is too high or the water tank is leaking	Adjust the water level sensor switch or change the water tank
	The water inlet valve cannot be closed completely and leaking	Clean or replace the water inlet valve

Ice making is too slow	The space around the ice maker is too small	Make sure that there is at least a 8 inches gap between the air outlet and the obstacles, 10 inches in front to open the door, and at least 6 inches between the back of the appliance and the wall.
	Slight blow by of solenoid valve	Change the solenoid valve
	Slight leakage, lack or too much of refrigerant	Check and repair welding compressor or adjust refrigerant amount
Can only make one tray of ice each time the machine is started	The ice full or ice falling baffle is in the open position	Check whether the ice deicing baffle could open and close freely or not Check whether the ice full switch falls off
“Low Water” lights on.  Or the appliance starts to enter the ice making process, but water flows in and the “Low Water” lights on.	There is no water supply; The water supply hose is blocked or water is flowing in very slowly.	Check the water supply pressure and whether the supply hose is blocked. Add water pressure or clean the hose if needed.  Place the appliance on a flat surface, not on a slope.
The water pump is working, but there is little water flow out from the water dividing pipe.	The floating ball of the water level detecting	Check whether the floating ball is stuck or damaged, adjust or replace it
	switch is blocked and cannot rise.	Clean the water tank and the water level detecting switch.
	Water flows out from the water tank.	Pull out the pipe and install back into the slot of the water tank properly.
	Water flows out from the water draining hose of the water tank.	Clean the water dividing pipe. Make sure all the holes are unclogged
	The small holes on the water dividing pipe are blocked.	

The transparency of the ice cube is not very good.	Water quality is not good or the water tank is dirty.	Change the water supply, or use the water filter to soften or filter the water.
Ice cubes are too thin or irregular	The ambient temperature is too high. Air circulation around the appliance is not good.	Move the appliance to a low temperature space or increase the time of each ice making cycle.
Ice cubes are too thick.	Tank water level is too low	Check the water level and whether there is leakage or not
	Inlet valve does not work	Check the inlet valve
	Water pressure is not enough	Water pressure should be kept at 0.13-0.5 MPa
	Uneven water flow in the flow pipe	Adjust or clean the water flow pipe

Ice cubes are too thick.	The ambient temperature is too low.	Make sure the ambient temperature higher than 41°F reduce the time of each ice making cycle.
There are no ice cubes produced from the normal ice making cycle.	The ambient temperature or water temperature in the water tank is too high.	Move to a place with a temperature lower than 90°F and use low-temperature water.
	There is a refrigerant leak.	Call an authorized technical service engineer to maintain the process.
	The cooling system tube is clogged.	
Ice could not fall off the ice tray	The ice tray is dirty	Cleaning and disinfection the ice tray
	Machine does not placed on a level ground	Make sure the machine placed on a level ground
	Environment temperature is too low	Environment temperature should be higher 41°F
	Solenoid valve in question	Replace the solenoid valve
E1/E2 Error	The environment temperature sensor is damaged/ The return air temperature sensor is damaged	Replace the environment temperature sensor or the return air temperature sensor
E1 E2 Error	Both of two temperature sensor are damaged	Replace the environment/return air temperature sensor; Ensure that there is enough space around the machine



## WARRANTY

RGSEICE offers a limited one-year warranty ("warranty period") on all of our products purchased new and unused from GSEICE , or an authorized reseller, with an original proof of purchase and where a defect has arisen, wholly or substantially, as a result of faulty manufacture, parts or workmanship during the warranty period. The warranty does not apply where damage is caused by other factors, including but without limitation: (a) normal wear and tear; (b) abuse, mishandling, accident, or failure to follow operating instructions; (c) exposure to liquid or infiltration of foreign particles; (d) servicing or modifications of the product other than by GSEICE ; (e) commercial or non-indoor use.

The GSEICE warranty covers all costs related to restoring the proven defective product through repair or replacement of any defective part and necessary labor so that it conforms to its original specifications. A replacement product may be provided instead of repairing a defective product. GSEICE exclusive obligation under this warranty is limited to such repair or replacement.

A receipt indicating the purchase date is required for any claim, so please keep all receipts in a safe place. We recommend that you register your product on our website, [www.gesice.com](http://www.gesice.com). Although greatly appreciated, the product registration is not required to activate any warranty and product registration does not eliminate the need for the original proof of purchase.

The warranty becomes void if attempts at repair are made by non-authorized third parties and/or if spare parts, other than those provided by GSEICE , are used.

We offer lasting after-service, you can also arrange for service after the warranty expires at an additional cost.

These are our general terms for warranty service, but we always urge our customers to reach out to us with any issue, regardless of warranty terms. If you have an issue with a GSEICE product, please contact us at +8618011725089, Or add our Whats APP:+8613928831354/+8619928402783, and we will do our best to resolve it for you.

[service@gseice.com](mailto:service@gseice.com)

---

## Documents / Resources

	<p><a href="#">GSEICE SY80 110V Ice Maker Machine</a> [pdf] User Guide SY80 110V Ice Maker Machine, SY80, 110V Ice Maker Machine, Ice Maker Machine, Maker Machine, Machine</p>
---	---

## References

- [GSEICE Ice Cream Machine, Ice Machine, Slushy Machine Official Store](#)
- [User Manual](#)