

Welcome

This site asks for consent to use your data



Personalised advertising and content, advertising and content measurement, audience research and services development



Store and/or access information on a device



Learn more

Your personal data will be processed and information from your device (cookies, unique identifiers, and other device data) may be stored by, accessed by and shared with [141 TCF vendor\(s\)](#) and [69 ad partner\(s\)](#), or used specifically by this site.

Some vendors may process your personal data on the basis of legitimate interest, which you can object to by managing your options below. Look for a link at the bottom of this page or in the site menu to manage or withdraw consent in privacy and cookie settings.

7.1 References



growplay Compact Monkey Bars

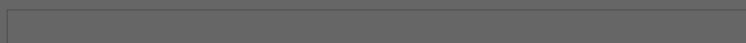

ATTENTION!

READ ALL SAFETY INFORMATION, INSTALLATION AND USAGE INSTRUCTIONS PRIOR TO INSTALLATION AND USAGE. See growplaymonkeybars.com for step-by-step video instructions and any updates to these instructions.

Care & Maintenance

Improper maintenance or lack of care can lead to your system deteriorating earlier than expected and causing injury. Please follow these instructions to ensure that your product lasts for as long as possible.

General care

[The following text is a dense, continuous block of illegible characters and symbols, likely representing a corrupted scan of a document page. It contains no discernible words or structure.]

the 'information' and 'communication' fields. The 'information' field is defined as:

...the study of the nature, structure, and use of information, and the study of the processes of information creation, organisation, storage, retrieval, and communication. (p. 1)

The 'communication' field is defined as:

...the study of the nature, structure, and use of communication, and the study of the processes of communication creation, organisation, storage, retrieval, and communication. (p. 1)

The 'information science' field is defined as:

...the study of the nature, structure, and use of information science, and the study of the processes of information science creation, organisation, storage, retrieval, and communication. (p. 1)

The 'information studies' field is defined as:

...the study of the nature, structure, and use of information studies, and the study of the processes of information studies creation, organisation, storage, retrieval, and communication. (p. 1)

The 'information technology' field is defined as:

...the study of the nature, structure, and use of information technology, and the study of the processes of information technology creation, organisation, storage, retrieval, and communication. (p. 1)

The 'information systems' field is defined as:

...the study of the nature, structure, and use of information systems, and the study of the processes of information systems creation, organisation, storage, retrieval, and communication. (p. 1)

The 'information management' field is defined as:

...the study of the nature, structure, and use of information management, and the study of the processes of information management creation, organisation, storage, retrieval, and communication. (p. 1)

The 'information policy' field is defined as:

...the study of the nature, structure, and use of information policy, and the study of the processes of information policy creation, organisation, storage, retrieval, and communication. (p. 1)

The 'information law' field is defined as:

...the study of the nature, structure, and use of information law, and the study of the processes of information law creation, organisation, storage, retrieval, and communication. (p. 1)

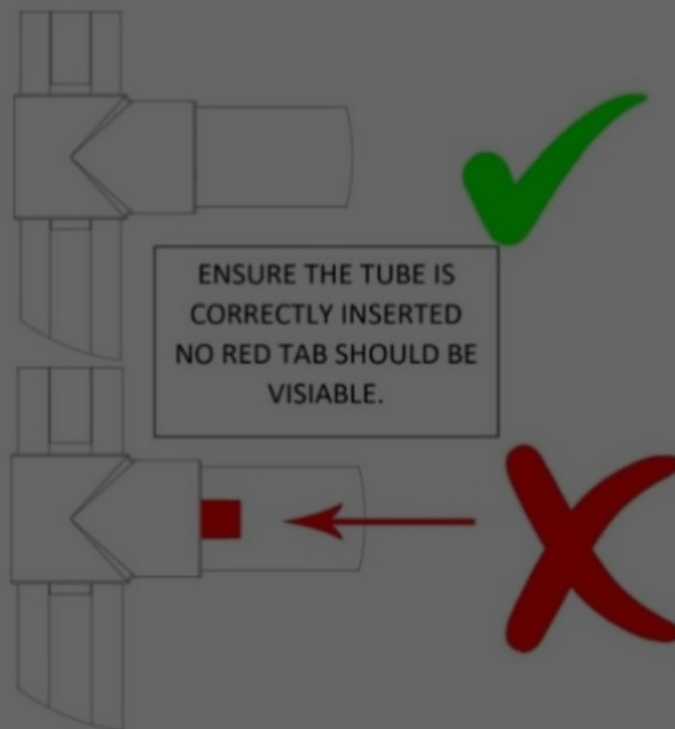

IMPORTANT! ENSURE GROUND IS LEVEL. USE GROUND ANCHOR SCREWS ON 4 OUTSIDE LEGS TO SECURE FRAME BEFORE USE

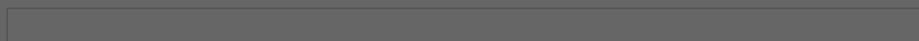

IMPORTANT! ONLY FULLY TIGHTEN BOLTS ONCE FRAME IS ASSEMBLED. FINGER TIGHTEN ONLY DURING ASSEMBLY.

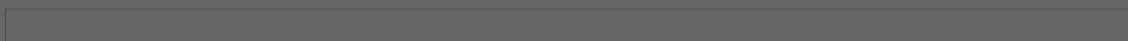

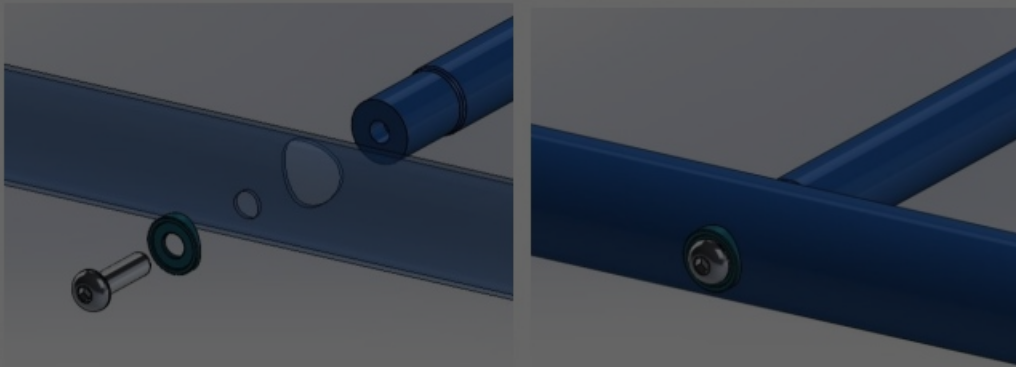

TYPICAL RUNG ASSEMBLY

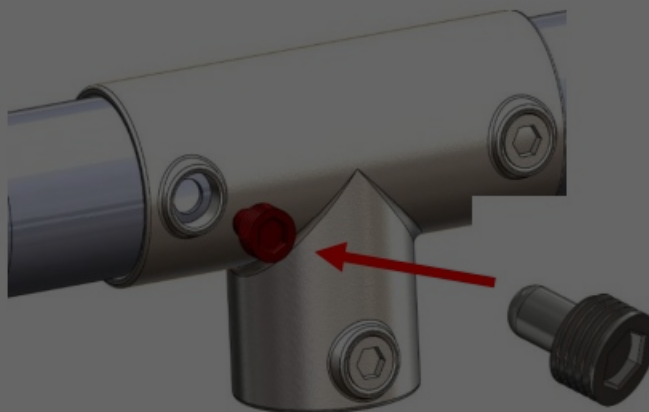

THE SAFETY BOLT IS SHOWN AS RED IN THIS MANUAL TO INDICATE THAT THIS SPECIAL FASTENER IS REQUIRED TO LOCATE POSITION OF TUBE AND PREVENT LOOSENING.

3

#	PART NUMBER	DESCRIPTION	QTY.
1	CP20ZK1H	Rung rail LH male with hole for part 10	1
2	CP20ZK1	Rung rail male RH	1
3	DB2R	Monkey Rung	6
4	20MRCW1	M10 Concave Washer	14
5	B1035BH1	M10 x 35 S/S Bolt	14
6	CP20ZK2H	Rung rail LH female with hole for part 10	1
7	CP20ZK2	Rung Rail	1
8	BC1040F	M10 Chicago Female	4
9	BC1040M	M10 Chicago Male	4
10	CF20CB2	Cross Brace 1	2
12	1101-4234 Tee	42/48 Short tee	2
15	1101-48 Tee	48 Short tee	4

PARTS LIST AND EXPLODED VIEW

NOTE: DO NOT ATTACH CLAMPS 12 & 15. REF. TO LADDER ASSEMBLY INSTRUCTIONS.

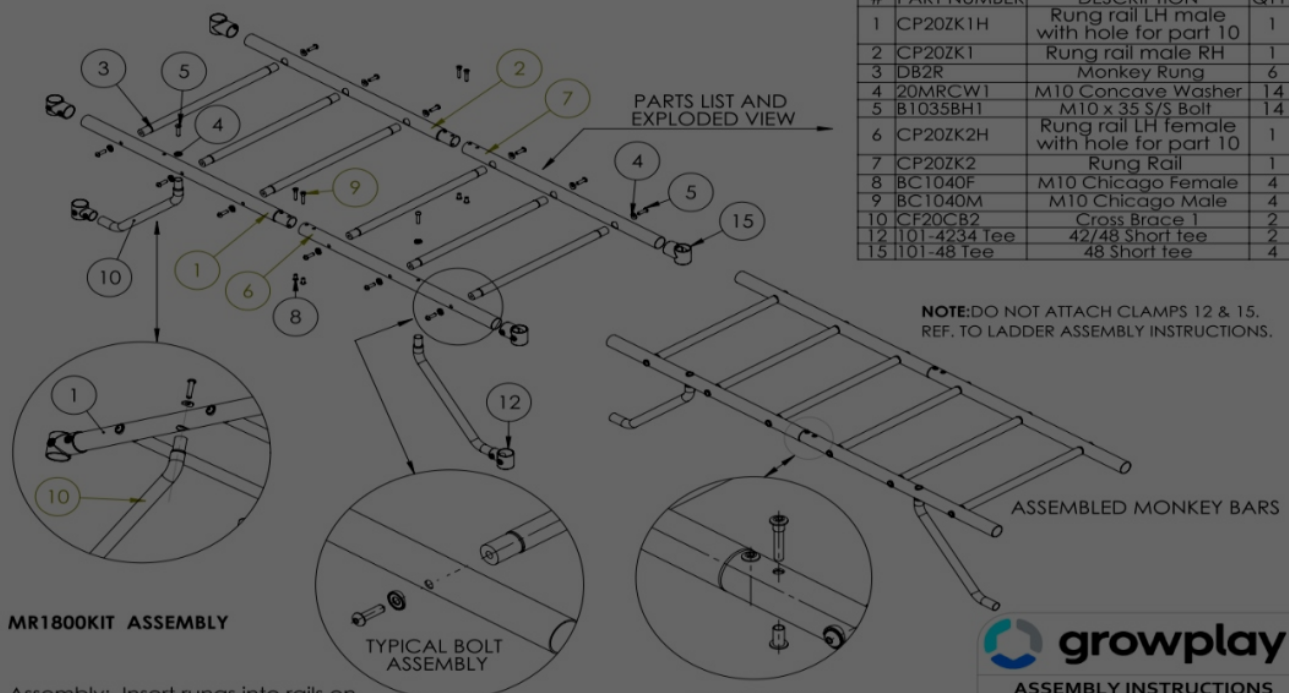

MR1800KIT ASSEMBLY

Assembly: Insert rungs into rails on a flat surface and hand tighten. Check before fully tightening.

TYPICAL BOLT ASSEMBLY

!! ATTENTION !!
CHECK ASSEMBLY BEFORE
TIGHTENING

ASSEMBLED MONKEY BARS

growplay

ASSEMBLY INSTRUCTIONS

TITLE: MONKEY RUNG 1800

PART #: AMR1800KIT REV: A

ASSEMBLE MONKEY RUNG (MR1800KIT) AS SHOWN

3

FRONT LEGS: IMPORTANT! LAY PARTS OUT AS SHOWN.

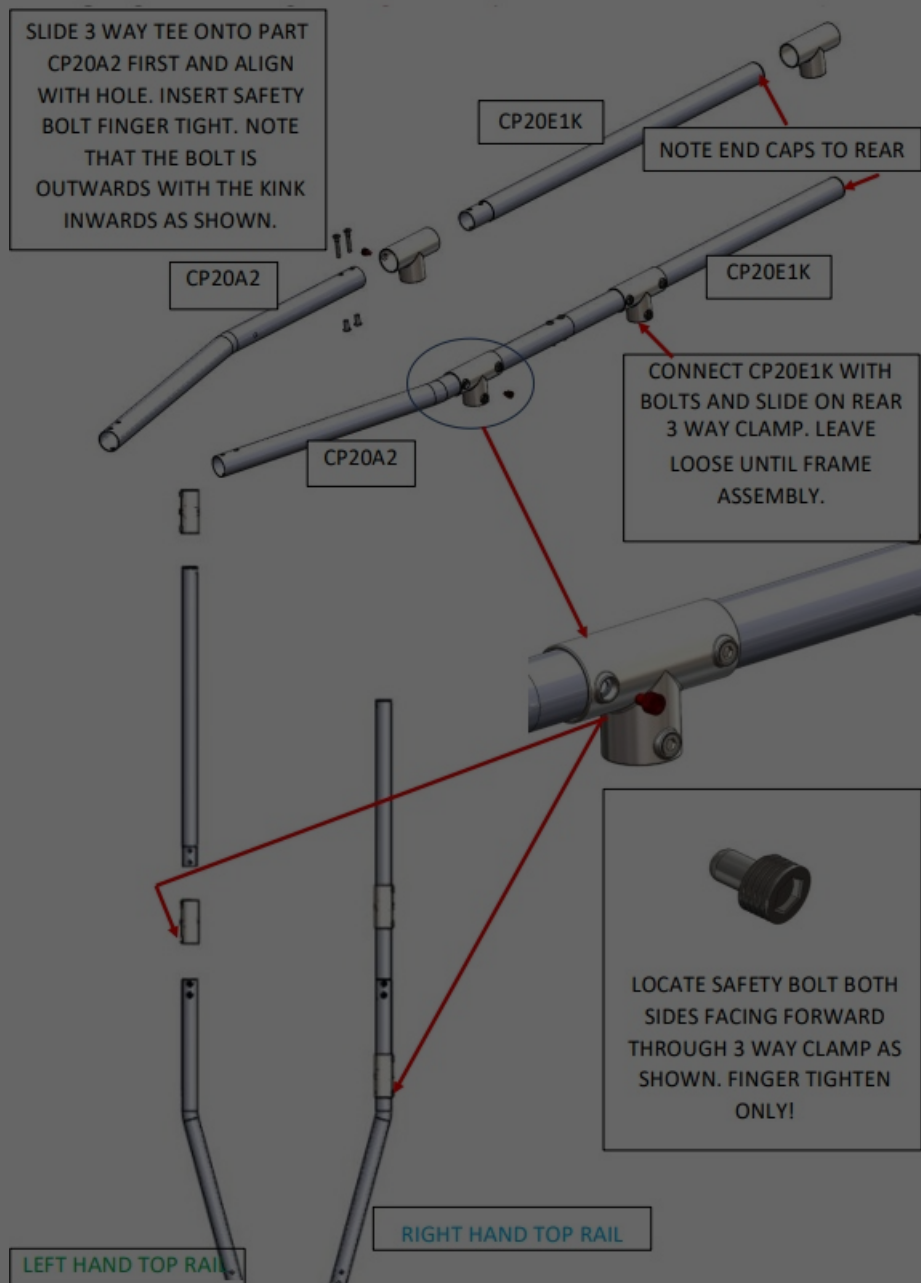

BOTTOM SIDE RAILS: IMPORTANT! LAY PARTS OUT AS SHOWN. PART NUMBERS ARE PRINTED ON TUBULAR PARTS

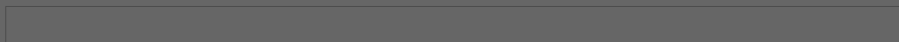

FRONT SUPPORT BAR: IMPORTANT! LAY PARTS OUT AS SHOWN.

[The following text is a dense, continuous block of text, likely a scan of a document page. It contains numerous lines of text, many of which are illegible due to the quality of the scan. The text appears to be a mix of English and possibly some non-English characters, but the overall structure suggests a single paragraph or a series of closely related sentences. The text is too blurry to transcribe accurately.]

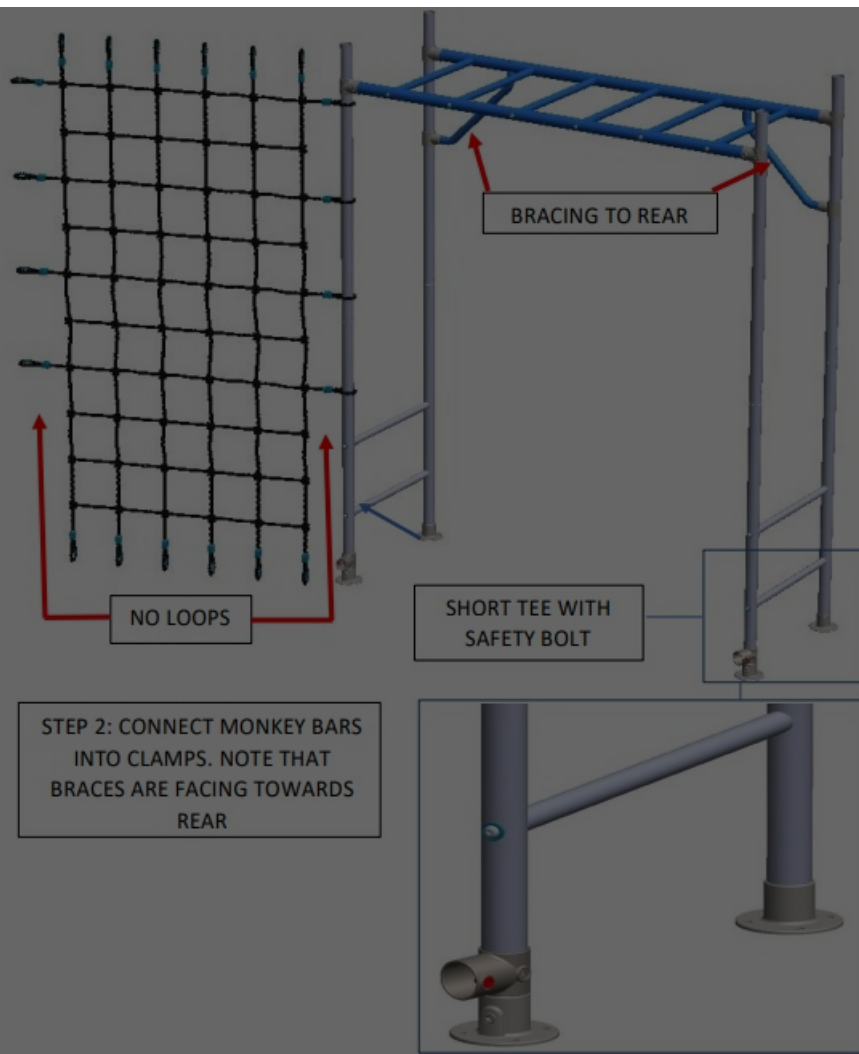

STEP 9: ATTACH **FRONT**
SUPPORT BAR ONE SIDE AT
A TIME. LOOSELY TIGHTEN
WITH ALLEN KEY.

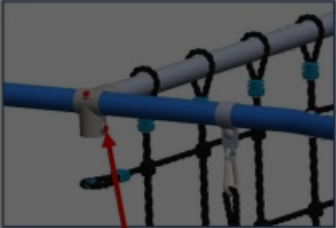
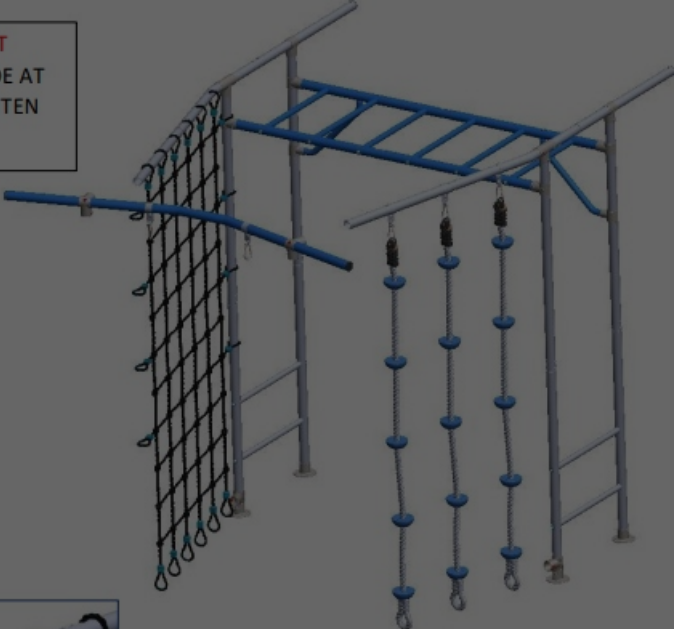

SAFETY BOLT HOLES AS SHOWN
TO INSIDE!!

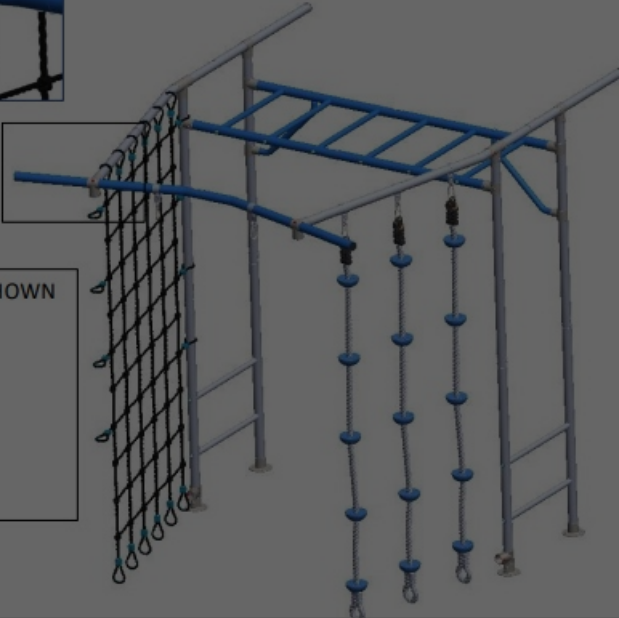

Spiral Anchors:
For use in soft
soil/sand **only**.



Ground Spikes:
For use in **all**
ground types.



**If the anchors break, the ground is too hard.
In that case, use the spikes provided.**

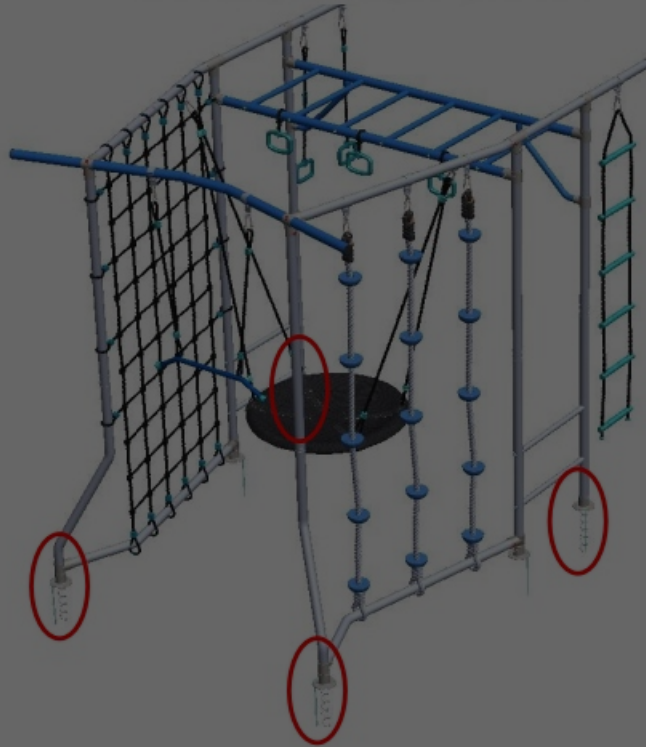

ONCE ALL BOLTS ARE TIGHTENED ON FRAME, MOVE INTO POSITION. INSTALL PEGS TO HOLD BASE PLATE IN PLACE ONE CORNER AT A TIME, LOOSEN AND LIFT FRAME TO ONE SIDE LEAVING BASE PLATE IN PLACE. SCREW GROUND ANCHOR AND WASHER THROUGH BASE PLATE UNTIL FIRMLY SEATED. LIFT FRAME BACK INTO BASE PLATE AND TIGHTEN. REPEAT ALL 4 CORNERS.

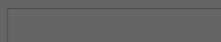

Comment *

Name

Email

Website

☐ Save my name, email, and website in this browser for the next time I comment.

Post Comment

Search:

e.g. whirlpool wrf535swhz

Search

[Manuals+](#) | [Upload](#) | [Deep Search](#) | [About Us](#) | [Privacy Policy](#) | [@manuals.plus](#) | [YouTube](#) | [LinkedIn](#) | [FaceBook](#)

This website is an independent publication and is neither affiliated with nor endorsed by any of the trademark owners. The "Bluetooth®" word mark and logos are registered trademarks owned by Bluetooth SIG, Inc. The "Wi-Fi®" word mark and logos are registered trademarks owned by the Wi-Fi Alliance. Any use of these marks on this website does not imply any affiliation with or endorsement.