

**GROWATT**

AXE 5.0L Battery  
For SPF and WIT  
Inverters



# GROWATT AXE 5.0L Battery For SPF and WIT Inverters Installation Guide

[Home](#) » [Growatt](#) » GROWATT AXE 5.0L Battery For SPF and WIT Inverters Installation Guide 

## Contents





- [1 GROWATT AXE 5.0L Battery For SPF and WIT Inverters](#)
- [2 Floor installation with base](#)
- [3 Installation Procedure](#)
- [4 Wiring](#)
- [5 Key operation](#)
- [6 FAQs](#)
- [7 Documents / Resources](#)
  - [7.1 References](#)

**GROWATT**

**GROWATT AXE 5.0L Battery For SPF and WIT Inverters**

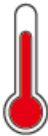

### Installation environment

			
Max. +50°C	Min. 0°C	RH. +5%~+85%	Indoor installation

### Installation tools

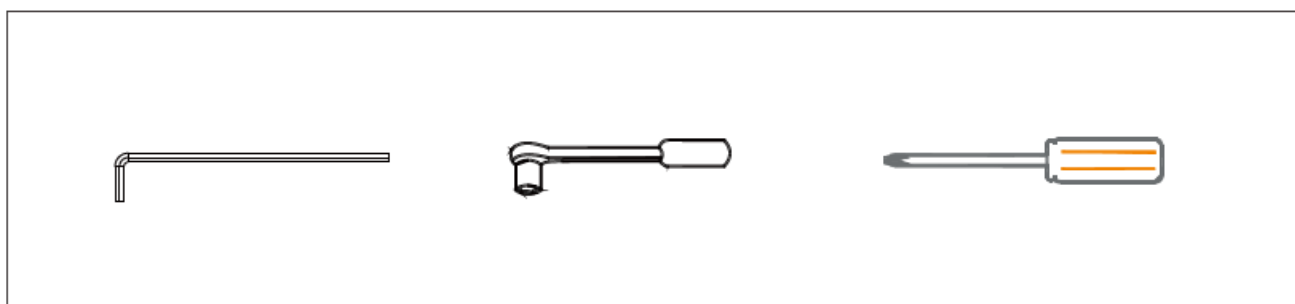

### Battery size

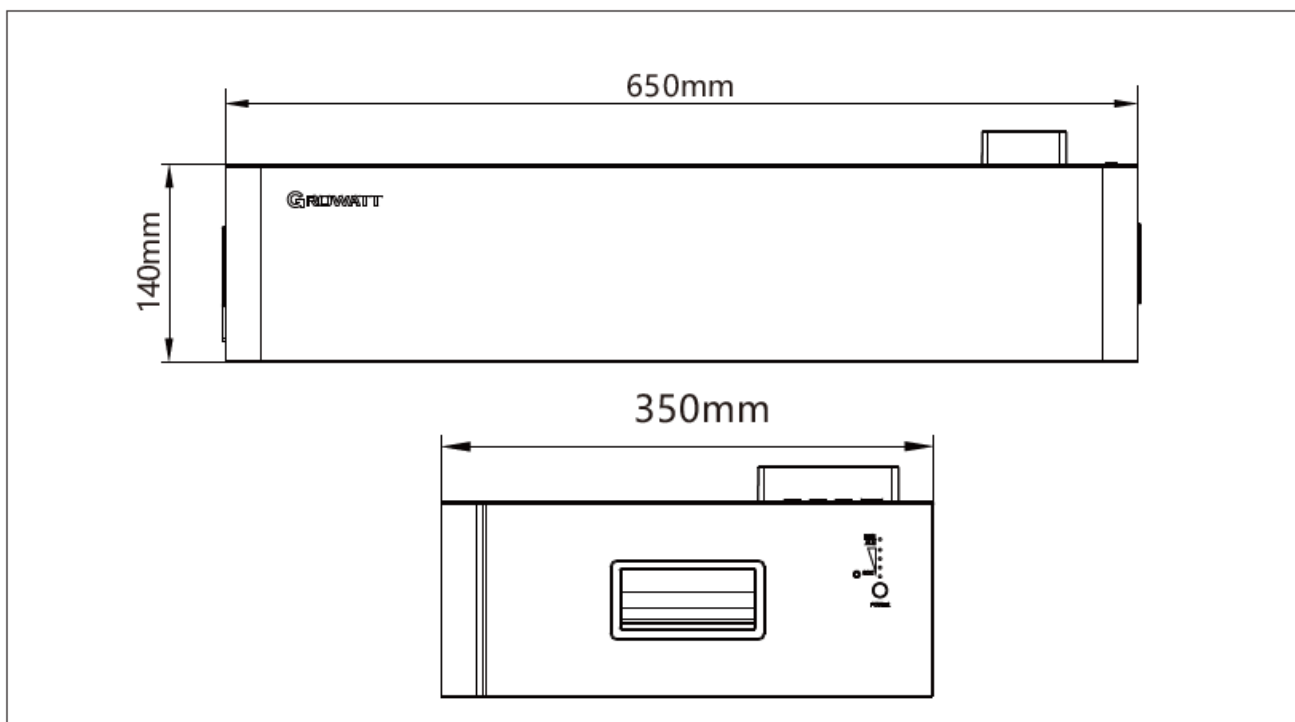

## Check

- Check AXE 5.0L packing list

### 4-1 Check AXE 5.0L packing list

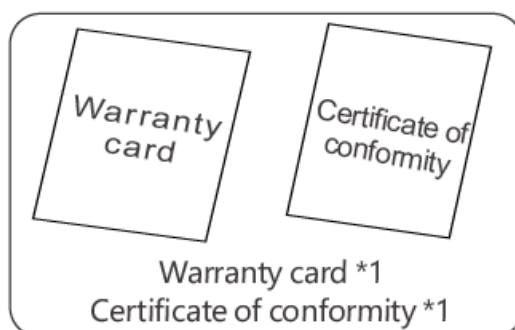
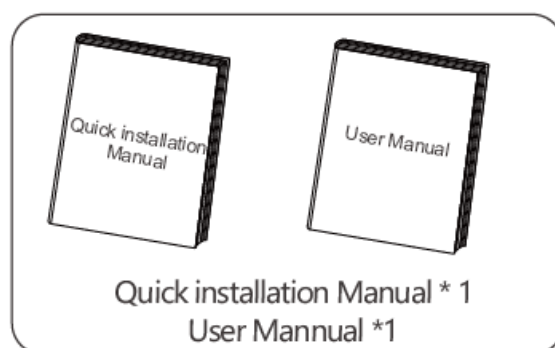
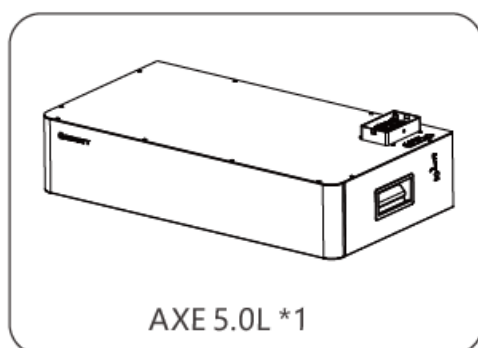

- Check accessories

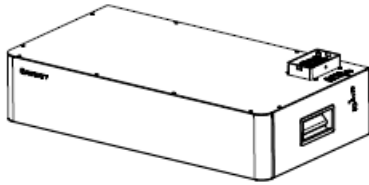

AXE 5.0L

A

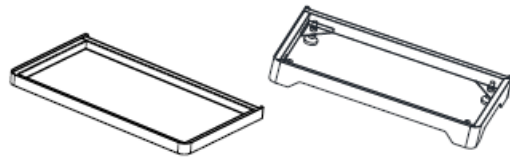

AXE 5.0L Base (Any of them)

B



(2000±25)mm

AXE 5.0L Cable

C



RJ45 dust cover



USB dust cover

- **Installation Method / Compound Mode**
- **Standard floor installation**  $A*M+B+C$
- **Floor installation into N columns**  $A*M+B*N+C*N$
- Note: "M" means the number of batteries, and "N" means the number of clusters.

### Battery operation panel introduction

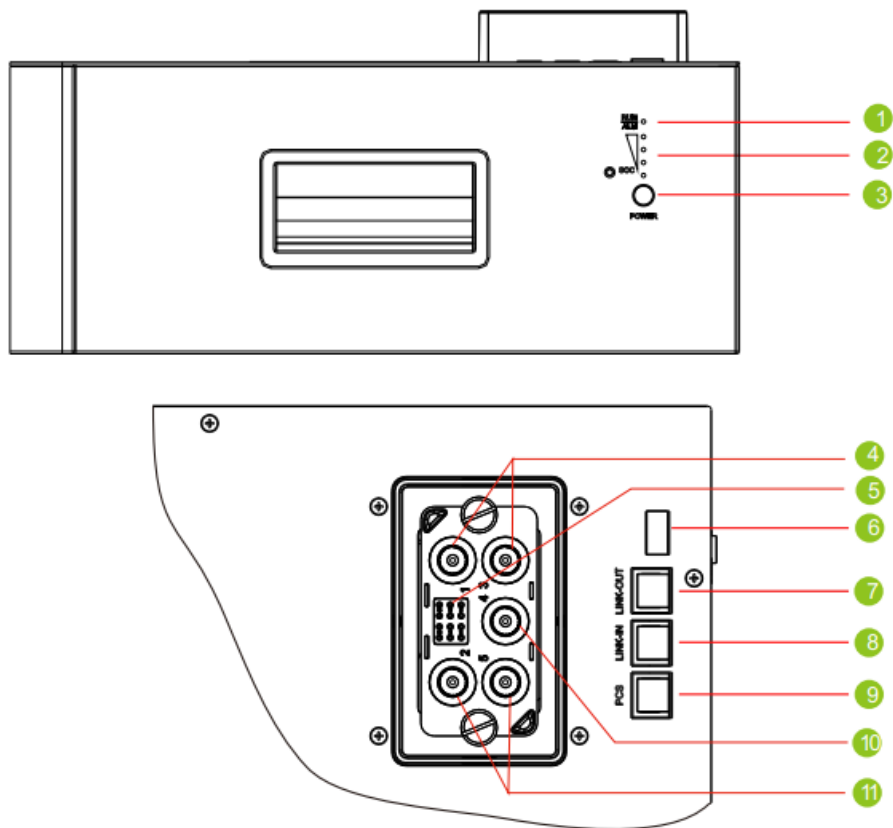

1	Fault light	7	Link-out for multi-cluster in parallel communication
2	SOC light	8	Link-in for multi-cluster in parallel communication
3	Power button	9	PCS CAN communication
4	Positive terminal	10	GND terminal
5	Communication between battery packs of single cluster	11	Negative terminal
6	USB interface		

## Floor installation with base

### Installation Location Requirements

#### Note:

1. The battery base is required while installing the battery system.
2. The maximum quantity of stacking battery packs is 10, if it exceeds 10, please install them by way of multiple clusters in parallel.
3. Please install indoors and ensure the level of the ground.

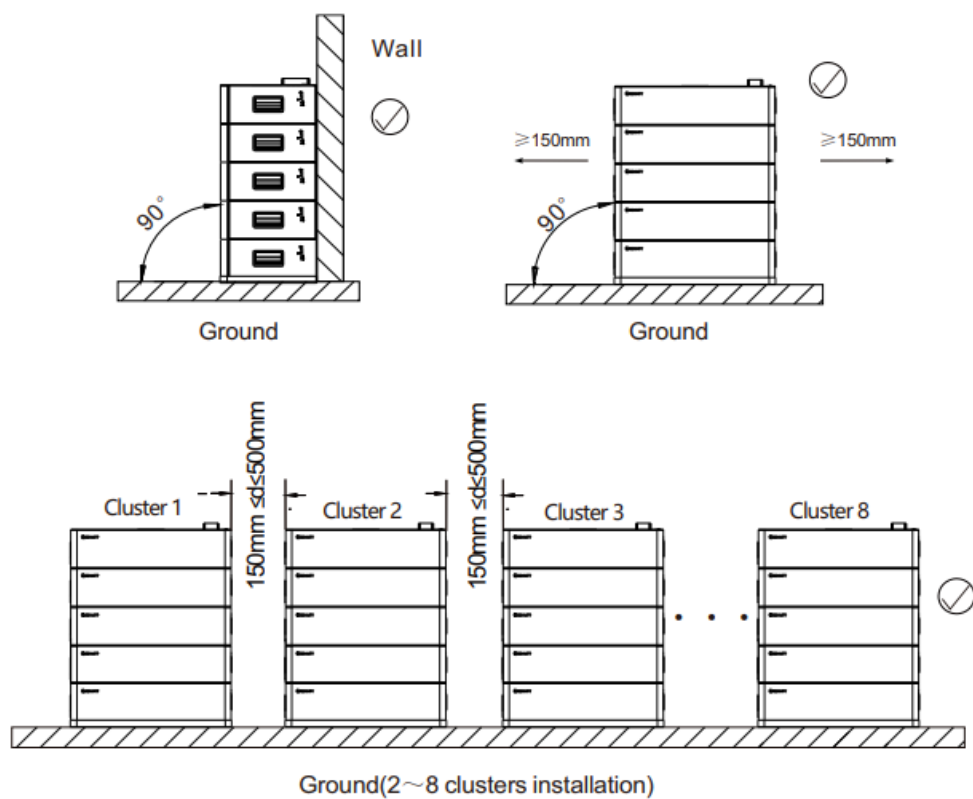

## Installation Procedure

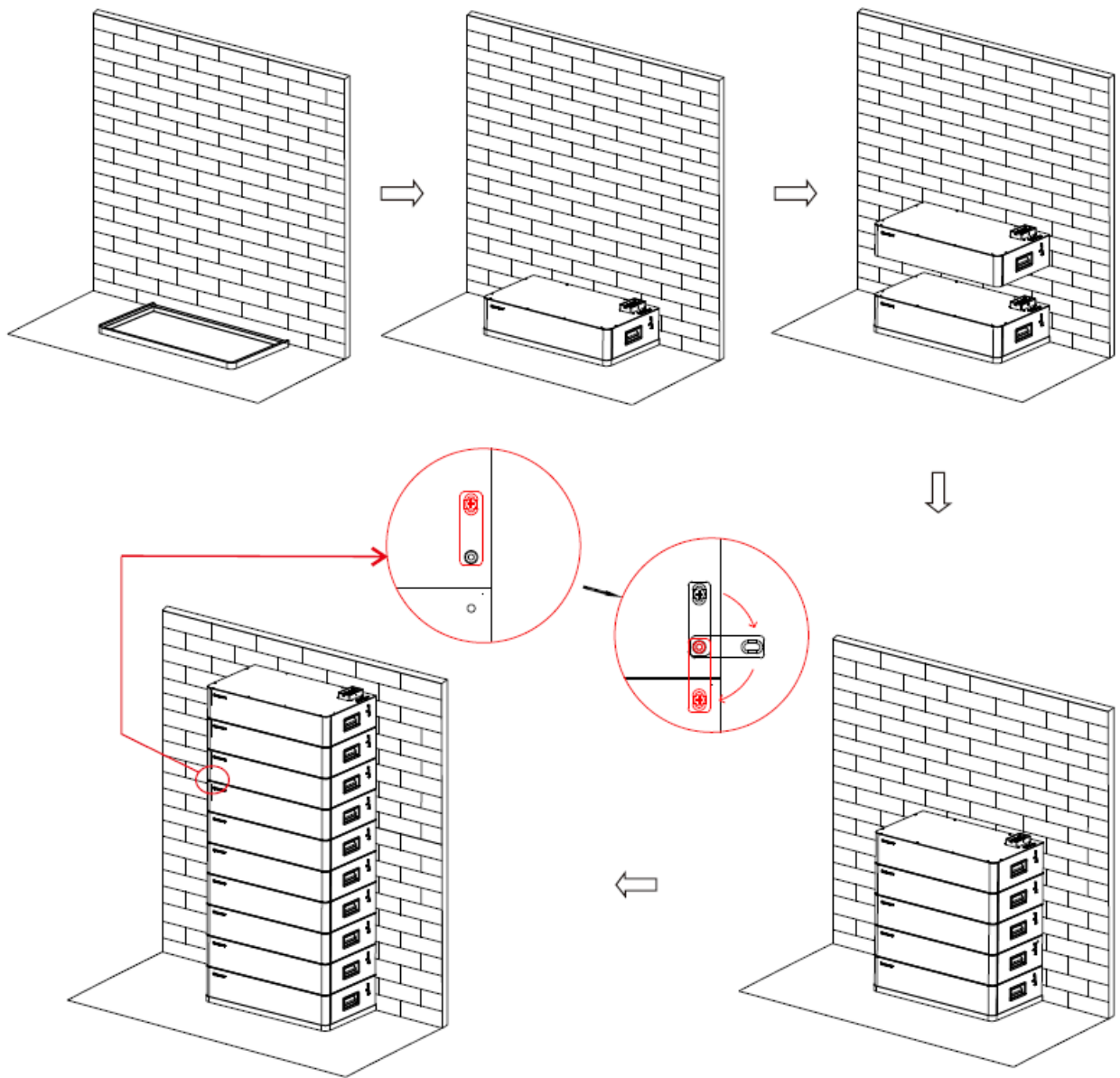

**Note:** When stacking, make sure that all batteries are aligned and lock the safety bolt.

## Wiring

### Single cluster wiring

To PCS

AXE 5.0L Cable

- Battery+
- Battery-
- PE
- CAN communication

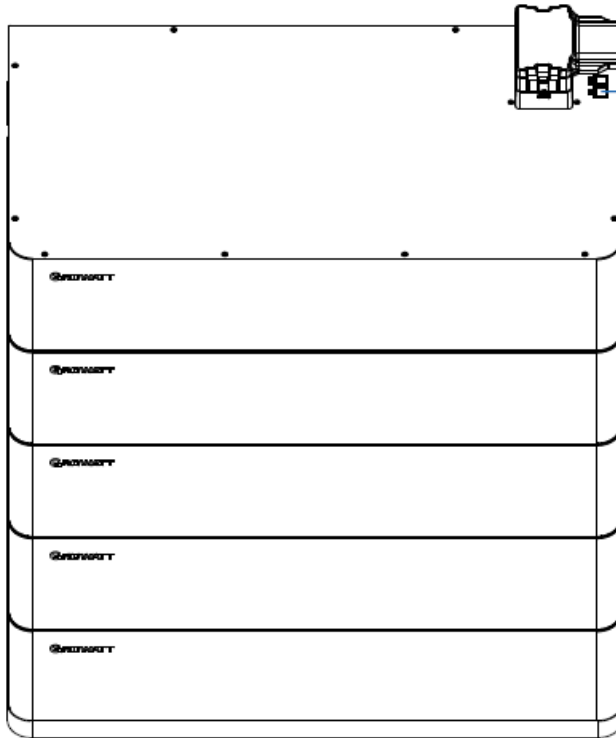

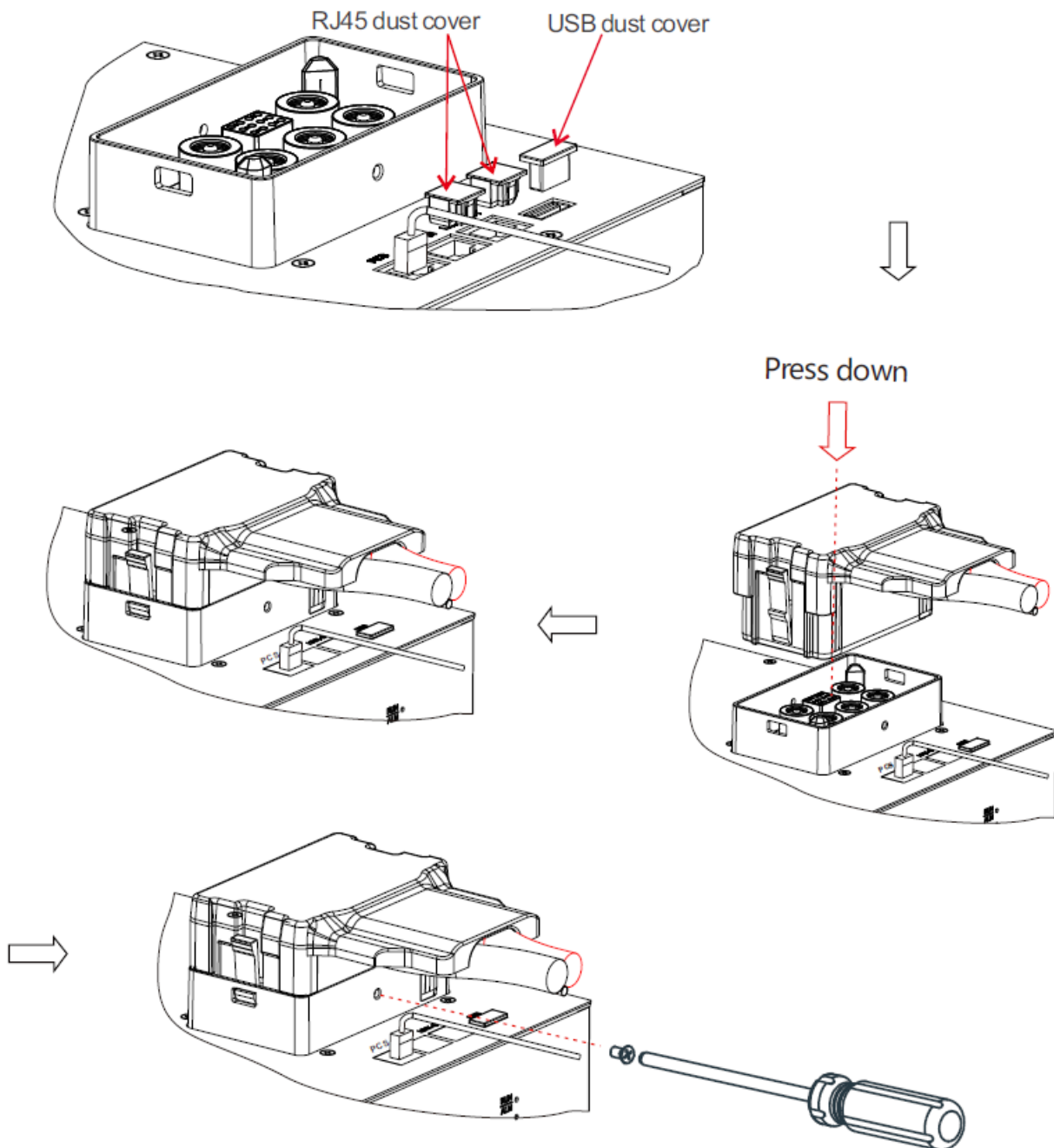

**Note:**

1. Please install the communication line first, then plug the unused RJ45 port and USB port with a dust cover, and finally install the power line.
2. No cable connection is required between battery packs in a single battery cluster.

**Wiring of Multi-clusters battery in parallel**

**Note:**

1. Supports up to 8 clusters in parallel.
2. The power combiner box needs to be prepared by the user.

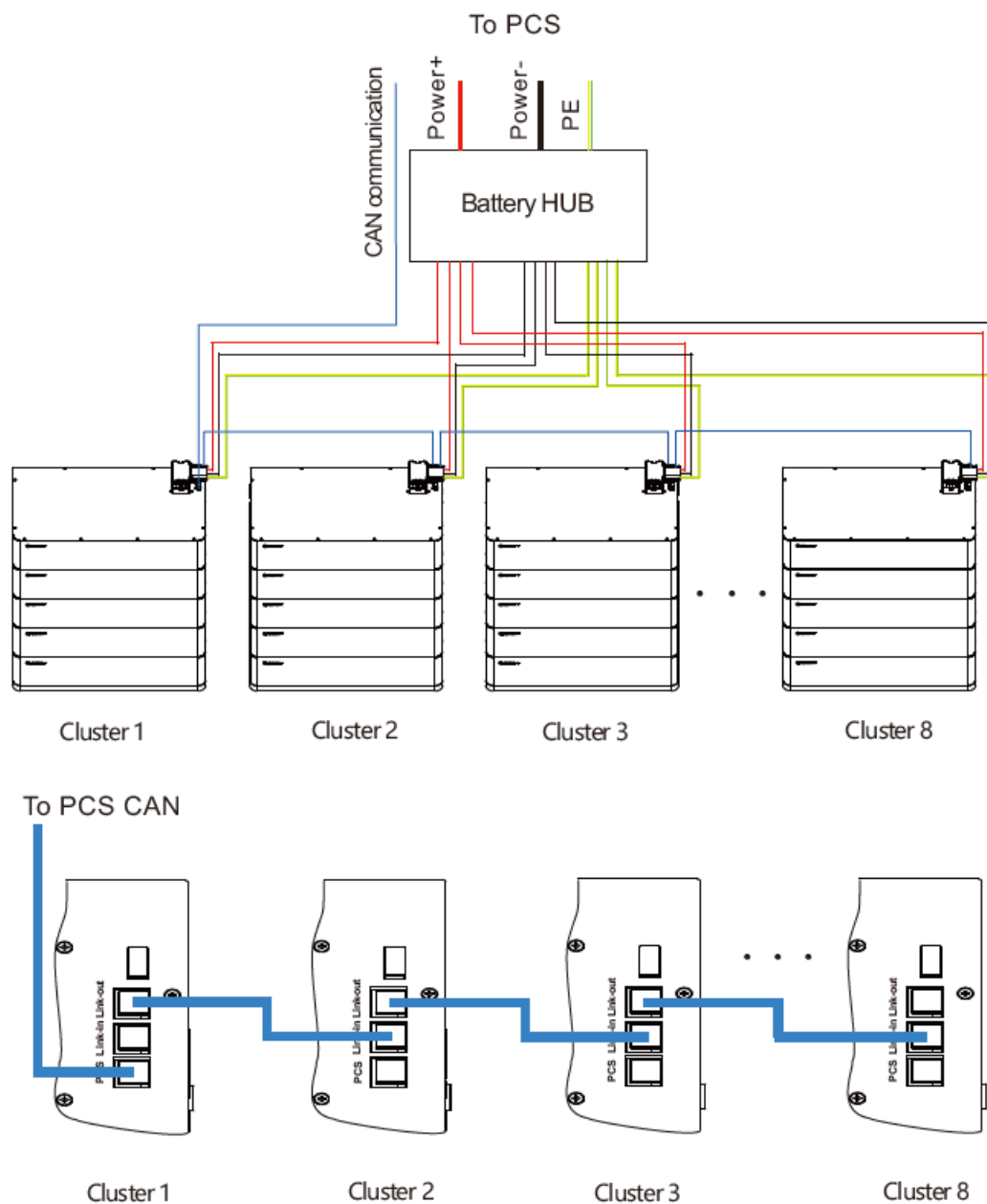

## Key operation

### Power button

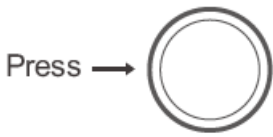
Situation	Touch	Definition	
System off	Press( 2S)	No reaction	
	Press( $\geq 2S$ )	Power on	
System on	Press once	Shut down	

### Note:

When multiple battery systems are used in parallel connection, you only need to press one key of any module to start the system. and also press one key to shut down the battery system

## Service and contact

## Shenzhen Growatt New Energy CO.,Ltd

4-13/F, Building A, Sinto-Germann, Europe, Industrial Park, Hangcheng Ave, Guxing Community, Xixiang Subdistrict, Baoan District, Shenzhen, China.



- 86 0755 2747 1942
- [service@ginverter.com](mailto:service@ginverter.com)
- W:[www.ginverter.com](http://www.ginverter.com)

## FAQs

**Q: How many clusters can be connected in parallel?**

A: The product supports up to 8 clusters in parallel.

**Q: What is the maximum stacking limit for battery packs?**

A: The maximum stacking limit is 10 battery packs. For more than 10 packs, use multiple clusters in parallel.

## Documents / Resources

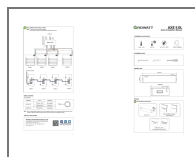

**[GROWATT AXE 5.0L Battery For SPF and WIT Inverters](#)** [pdf] Installation Guide  
AXE 5.0L Battery For SPF and WIT Inverters, AXE 5.0L, Battery For SPF and WIT Inverters, SP  
F and WIT Inverters, WIT Inverters, Inverters

## References

-  [Growatt | Global Leading Distributed Energy Solution Provider](#)
- [User Manual](#)

[Manuals+](#), [Privacy Policy](#)

This website is an independent publication and is neither affiliated with nor endorsed by any of the trademark owners. The "Bluetooth®" word mark and logos are registered trademarks owned by Bluetooth SIG, Inc. The "Wi-Fi®" word mark and logos are registered trademarks owned by the Wi-Fi Alliance. Any use of these marks on this website does not imply any affiliation with or endorsement.