



GROTHE MONTILUX 2154 Push Button User Manual

[Home](#) » [GROTHE](#) » GROTHE MONTILUX 2154 Push Button User Manual 

Contents

- [1 GROTHE MONTILUX 2154 Push Button](#)
- [2 Product Information](#)
- [3 Product Usage Instructions](#)
- [4 Installation](#)
- [5 Technical data](#)
- [6 Grothe GmbH](#)
- [7 Documents / Resources](#)
- [8 Related Posts](#)

GROTHE

GROTHE MONTILUX 2154 Push Button



Product Information

The Klingeltaster/Push button Montilux is an electronic doorbell button. It comes with a nameplate cover that can be easily removed to access the slots for installation. The push button can be connected to a power source and a LED (optional) for illumination. The installation should be performed by a qualified electrician.

Product Usage Instructions

1. Using a flat screwdriver, remove the nameplate cover to access the installation slots.
2. Insert a suitable screwdriver into the two slots and tilt them as described in the illustration.
3. Loosen the screw with a screwdriver and insert the stripped wire under the plate. Tighten the screw again.
4. If you want to connect a LED, follow the connection diagram provided in the manual.
5. The installation must be carried out in a de-energized state by a qualified electrician.

Installation

Opening the housing

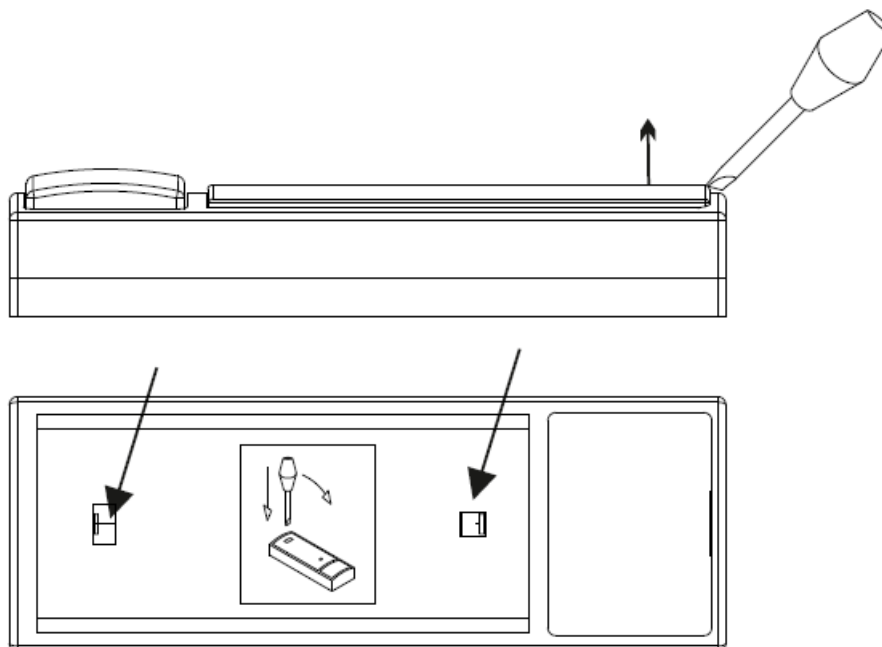

- To open the housing, remove the nameplate cover with a flat screwdriver.
- Two slots appear under the nameplate. Use a suitable screwdriver to pierce these two slots and tilt them as described in the illustration.

Connection of the push button

Connect the wires as follows:

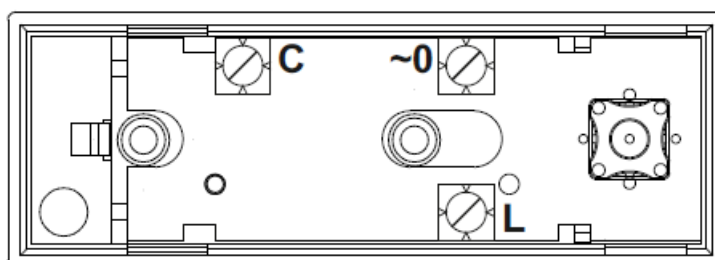

- Loosen the screw with a screwdriver. Insert the stripped wire under the plate and tighten the screw again.

Connection diagram

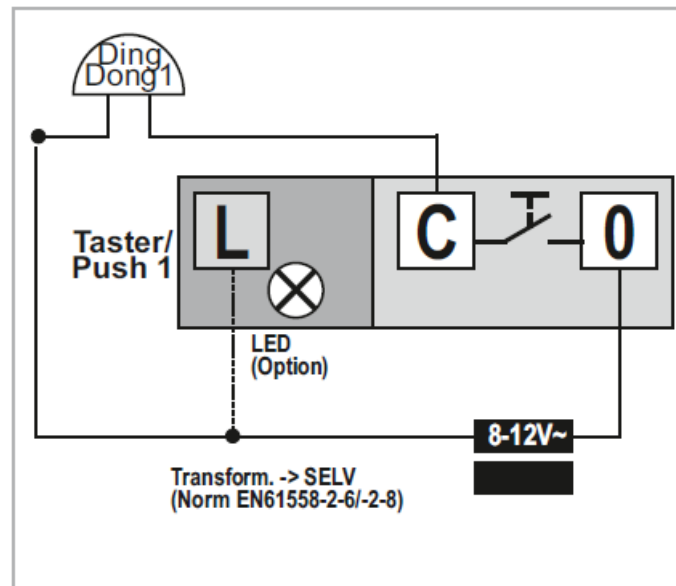

- Installation must be carried out in de-energized condition by an electrical!

Technical data

- **Max:** 12 V ~ (AC/DC 50 mA – 1,5 A)
- **LED:** 8 – 12 V~ (AC/DC 0,01 A)
- Protect. low volt. only!
- Wire 0,6 – 0,8 mm
 - -20°C...50°C
- IP41
- Op. force ca. 6 N

Grothe GmbH

- Löhestraße 22 53773 Hennef
- service@grothe.de



Documents / Resources

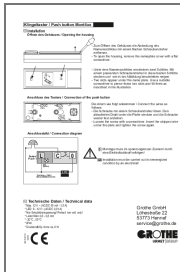

[GROTHE MONTILUX 2154 Push Button](#) [pdf] User Manual
MONTILUX 2154 Push Button, MONTILUX 2154, Push Button, Button