

**GROTHE**  
**urmet**  
**ETA S 100/200**  
**LED Push Button**



# GROTHE ETA S 100/200 LED Push Button Installation Guide

[Home](#) » [GROTHE](#) » GROTHE ETA S 100/200 LED Push Button Installation Guide 

## Contents

- [1 GROTHE ETA S 100/200 LED Push Button](#)
- [2 Product Usage Instructions](#)
- [3 Installation](#)
- [4 General](#)
- [5 TECHNICAL DATA](#)
- [6 FAQ](#)
- [7 Documents / Resources](#)
  - [7.1 References](#)



## GROTHE ETA S 100/200 LED Push Button



## Product Specifications

- **Model:** ETA S 100/200 LED
- **Power:** Max. 12V= $\sim$  (AC/DC)/1.5A (LED: 12V $\sim$ /0.02A)
- **Operating Voltage:** Low voltage only

- **Wire Size:** Rigid 0.6 – 0.8 mm

## Product Usage Instructions

### Installation

1. Ensure the installation is not in the center, following the provided measurements.
2. Mount the push button on the wall bracket securely without a gasket.
3. Attach the LED unit firmly in place.
4. Optimize the position of wires for proper functioning.
5. Secure the gasket on the push button.
6. Fixate the screw at the bottom using an Allen key.

### Installation

#### Installation Instructions

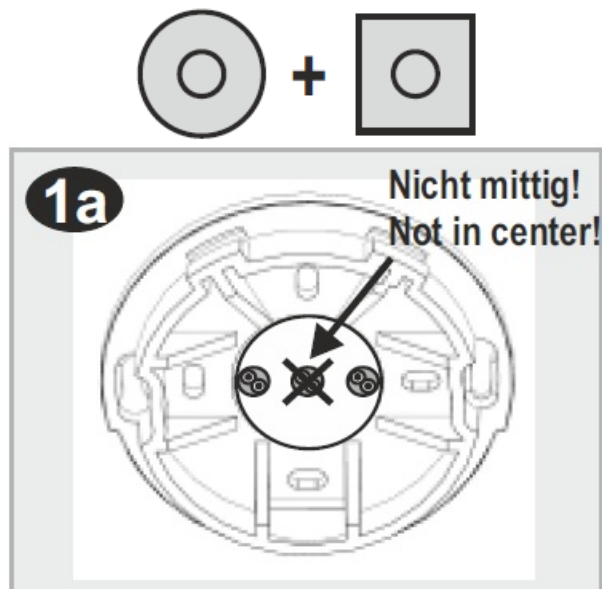

- Positions of wire (at the side!)

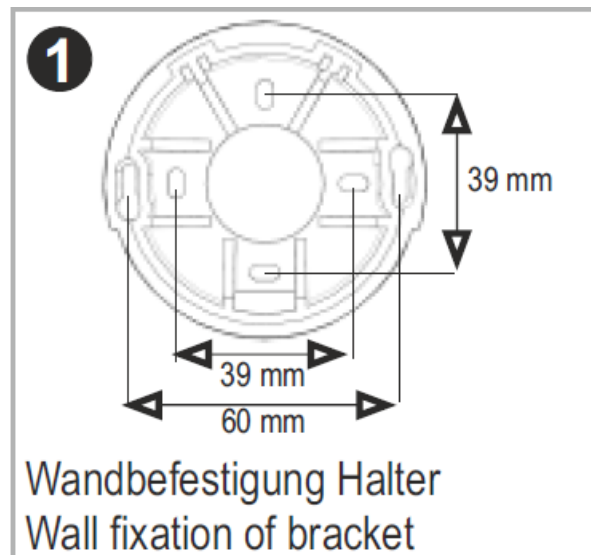

- Wall fixation of bracket

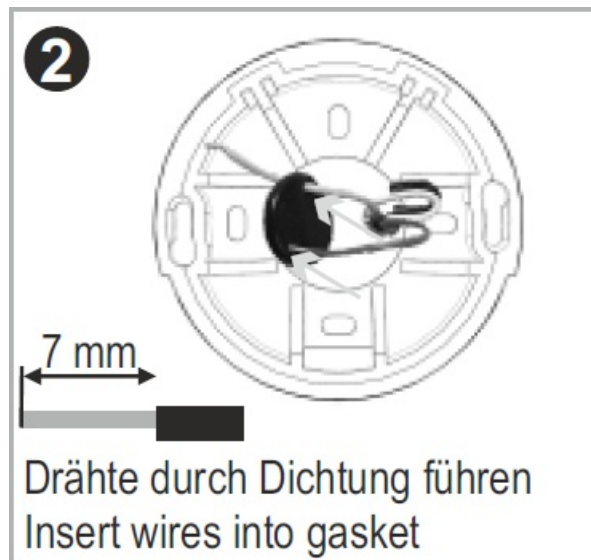

- Insert wires into gasket

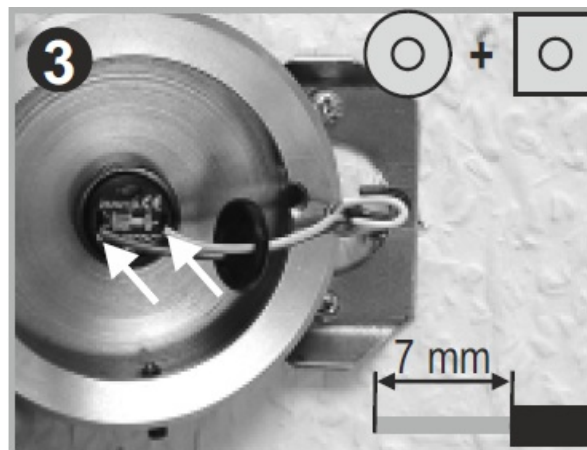

- Connection of push! See 7

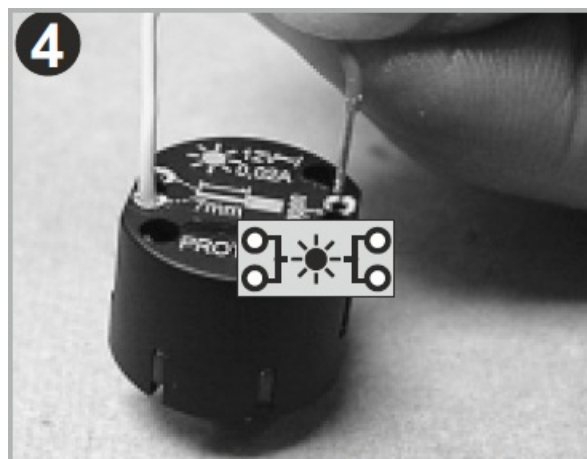

- Connect wire (12V~/AC)

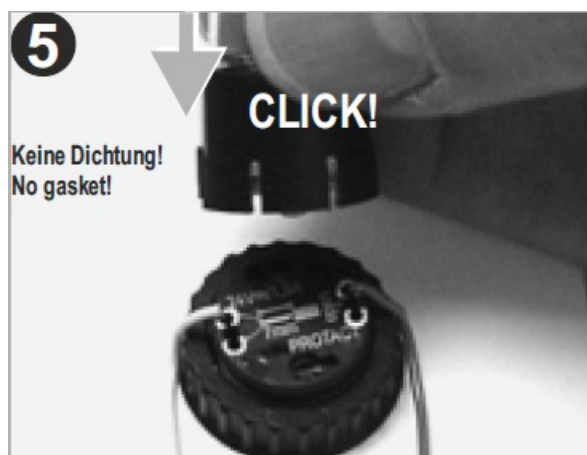

- Fix the LED unit



- LED push incl. wiring

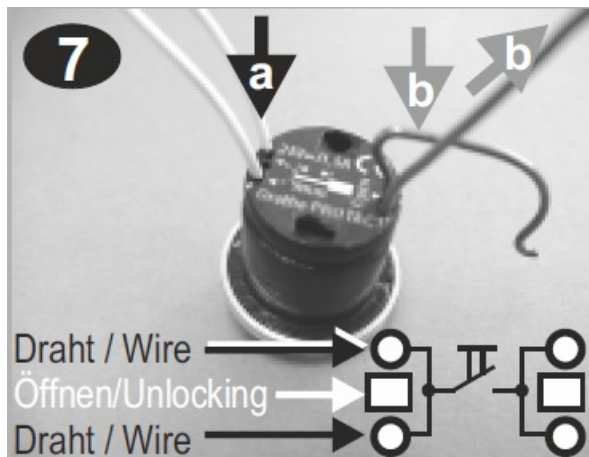

- a) Wiring
- b) Unlocking

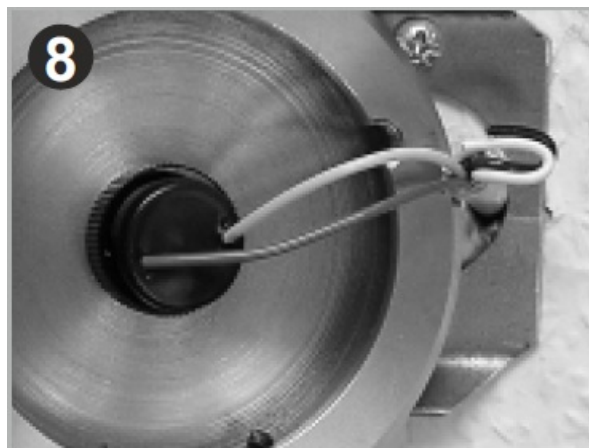

- Fixation of gasket on push

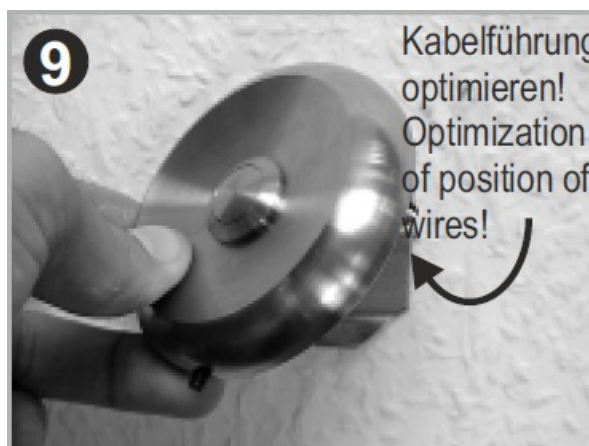

- Fixation of push on bracket

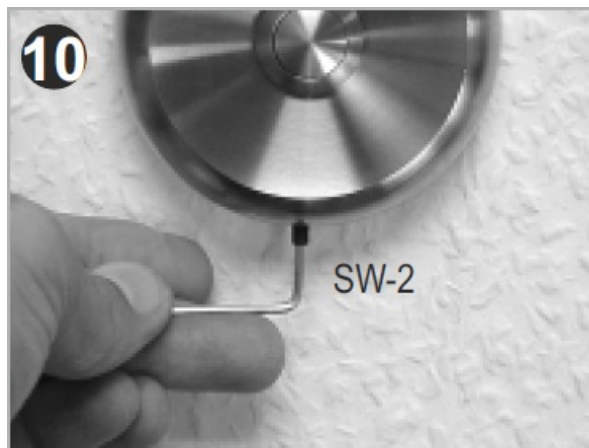

- Fixation of screw (at bottom)

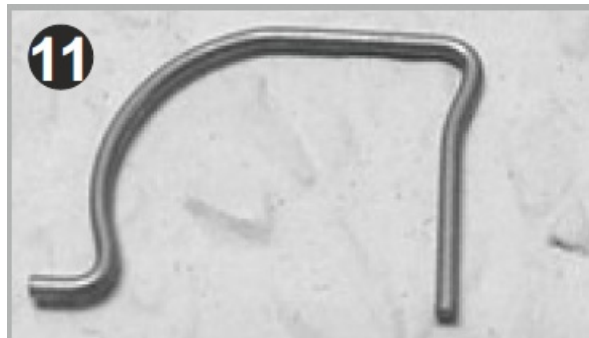

- Stow opening tool separately because of corrosion possibility!

## General

- Please note that installation and assembly of electrical equipment should only be under-taken by a qualified electrician!
- Nationally specific regulations on electrical installation work must be observed
- Before starting installation, ensure that the circuit is isolated from the supply by withdrawing the circuit fuse or circuit breaker!

## TECHNICAL DATA

### Techn. Dat. Taster/push button

- **max.** 12 V= $\sim$  (AC/DC) / 1,5A
- Protective low voltage only!
- **Wire rigid:** 0,6-0,8mm
- **Wire flex:** unlocking first (1.b)
- -20°C...60°C / IP 44

### Techn. Dat. LED

- max. 12V= $\sim$  (AC/DC)/1,5A (LED: 12V $\sim$ /0,02A)
- Protect. low volt. only!
- **Wire rigid:** 0,6 – 0,8 mm
- **Wire flex:** Photo 6.A: Unlock
- -20°C...60°C / IP 54, Druckkraft/Op. force 5 N

- **Telefon:** (0 22 42) 88 90-0
- **Telefax:** (0 22 42) 88 90-36
- **E-mail:** [info@grothe.de](mailto:info@grothe.de)
- **Internet:** [www.grothe.de](http://www.grothe.de)

## FAQ

- **Q: What is the maximum power rating for this LED product?**
  - **A:** The LED operates at a maximum of 12V= $\sim$  (AC/DC) and 1.5A, with the LED itself consuming 0.02A.
- **Q: What type of voltage does this product support?**
  - **A:** This product is designed for use with low voltage only.
- **Q: What is the recommended wire size for installation?**
  - **A:** Use wire sizes ranging from rigid 0.6mm to 0.8mm for proper installation.

## Documents / Resources

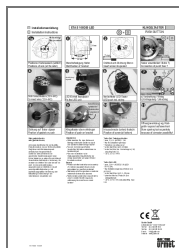

[GROTHE ETA S 100/200 LED Push Button](#) [pdf] Installation Guide  
55542, 55544, ETA S 100 200 LED Push Button, 100 200 LED Push Button, LED Push Button, Push Button, Button

## References

-  [Startseite | Grothe](#)
- [User Manual](#)

### Manuals+. [Privacy Policy](#)

This website is an independent publication and is neither affiliated with nor endorsed by any of the trademark owners. The "Bluetooth®" word mark and logos are registered trademarks owned by Bluetooth SIG, Inc. The "Wi-Fi®" word mark and logos are registered trademarks owned by the Wi-Fi Alliance. Any use of these marks on this website does not imply any affiliation with or endorsement.