



GROTHE ETA Funk Radio Push Button Instruction Manual

[Home](#) » [GROTHE](#) » GROTHE ETA Funk Radio Push Button Instruction Manual 

Contents

- [1 GROTHE ETA Funk Radio Push Button](#)
- [2 instructions for installation and Operation](#)
- [3 Safety instructions](#)
- [4 Intended use](#)
- [5 Short description](#)
- [6 Product Description](#)
- [7 Power supply](#)
- [8 External power supply](#)
- [9 Pairing ETA Funk with receiver](#)
- [10 Installation](#)
- [11 Insert name tag](#)
- [12 Information](#)
- [13 Guarantee and liability](#)
- [14 Declaration of Conformity](#)
- [15 Technical Data](#)
- [16 Documents / Resources](#)
 - [16.1 References](#)
- [17 Related Posts](#)



GROTHE ETA Funk Radio Push Button



Instructions for installation and Operation

Dear Customer,

With this device you have acquired a quality product which we have developed and produced for you with the greatest possible care and to the highest standards. The statutory guarantee period applies. Defects caused by improper handling, misuse or disregard of the installation and operating instructions are excluded from this guarantee.

Safety instructions

Do not expose the ETA Funk to dripping or splashing liquid! Do not place any vessels filled with liquid on it! Do not cover it with objects or blankets, curtains, etc. and protect it from direct sunlight and naked flames!

Intended use

The device described here is solely intended as a radio-controlled bell and signaling system for private use. The function can be impaired by different influences (flat battery, radio interference, etc.). Never use this device in safety-related areas! If failure of the device could cause a hazard for people, or other consequential damage is possible, you MUST prevent this through suitable additional safety measures!

Short description

The ETA Funk combines an appealing look and proven MISTRAL radio technology. This wireless bell button can be used to control wireless gongs from the MISTRAL, ECHO and CALIMA series. The ETA radio is operated with batteries, but can also be operated with an external power supply.

Product Description

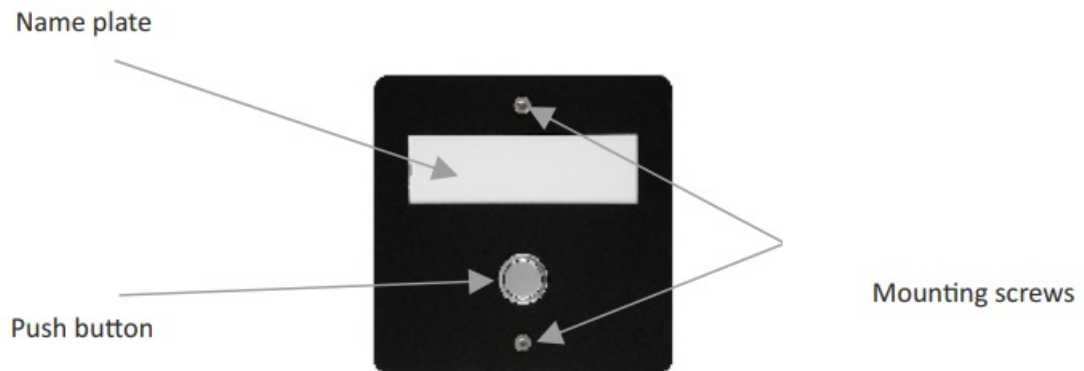

Power supply

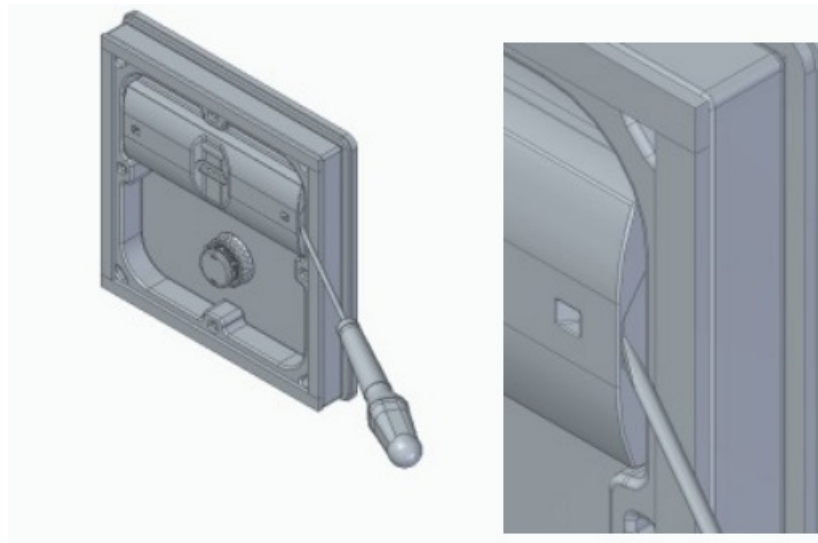

To open the transmitter housing, place a slo ed screwdriver in the groove on the transmit er housing one and the other on the right and le and turn it by 90°.

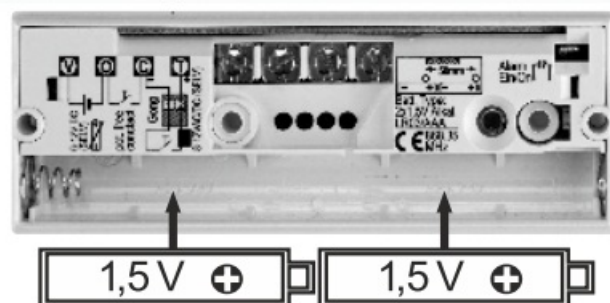

Two 1.5 V ba series (type AAA) are required for operaon. Please note the polarity when inserting the ba series.

External power supply

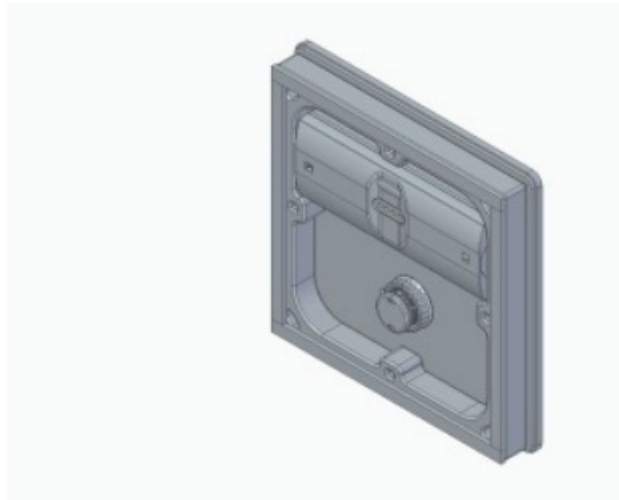
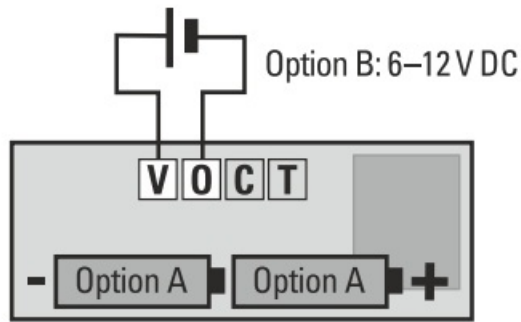

The transmitter can also be supplied with an external voltage (6 – 12 V DC). In this case please remove the batteries.

- **O** => Negative pole
- **V** => Positive pole

Then press the transmitter housing back into the mount.

Pairing ETA Funk with receiver

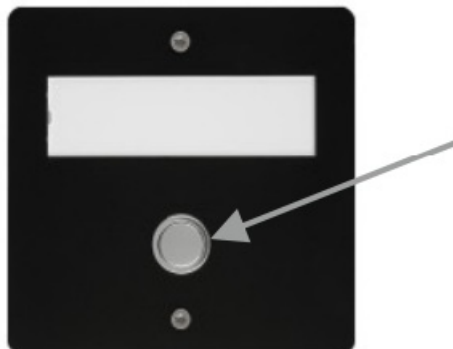

Put the MISTRAL, ECHO or CALIMA receiver into pairing mode. Please refer to the instruction for the relevant recipient. Operate the button on the ETA radio. The ETA is paired with the receiver.

Installation

Surface mounting variant: Align the surface-mounted adapter with the masonry using a spirit level and fasten it with the fastening material supplied.

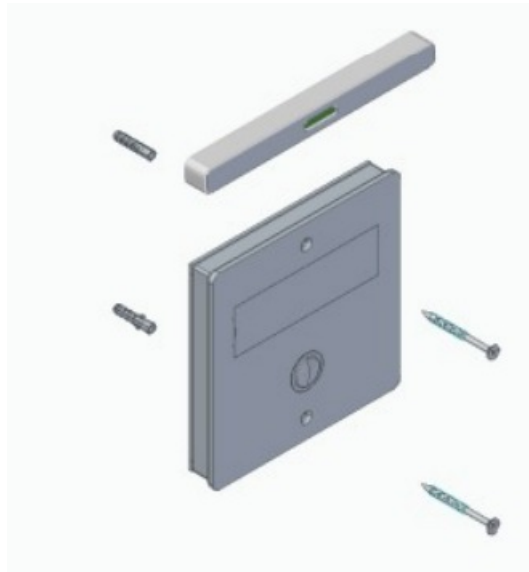

Flush mounting variant: Insert the flush-mounted box into a mortar bed in the masonry using a spirit level and fix the storey plate to the flush-mounted box with the screws supplied.

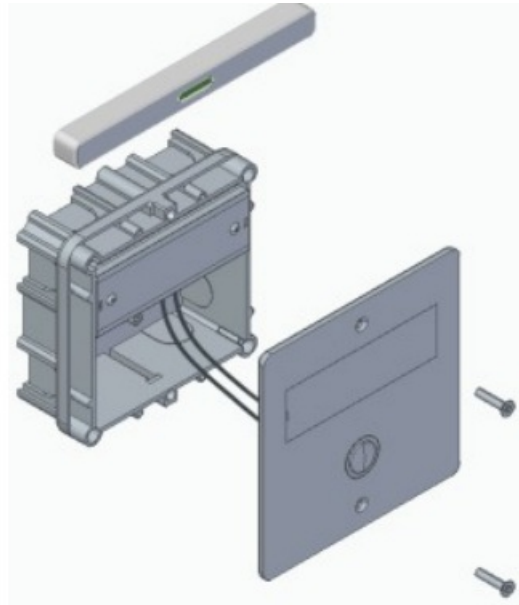

Insert name tag

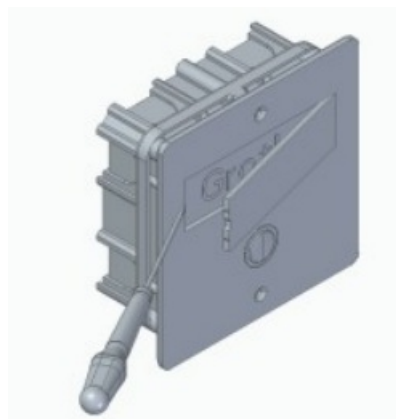

Open the Plexiglas cover with a screwdriver, insert the name tag inlay into the recess provided and carefully insert the Plexiglas cover.

Information

The range of the ETA Funk is approx. 250 m if unobstructed and if the transmitter is installed in accordance with the instructions. Walls, doors, metal components etc. may reduce the range significantly. See the illustration below.

Note: the range can be significantly reduced with flush mounting, depending on the nature of the wall e.g. reinforced concrete.

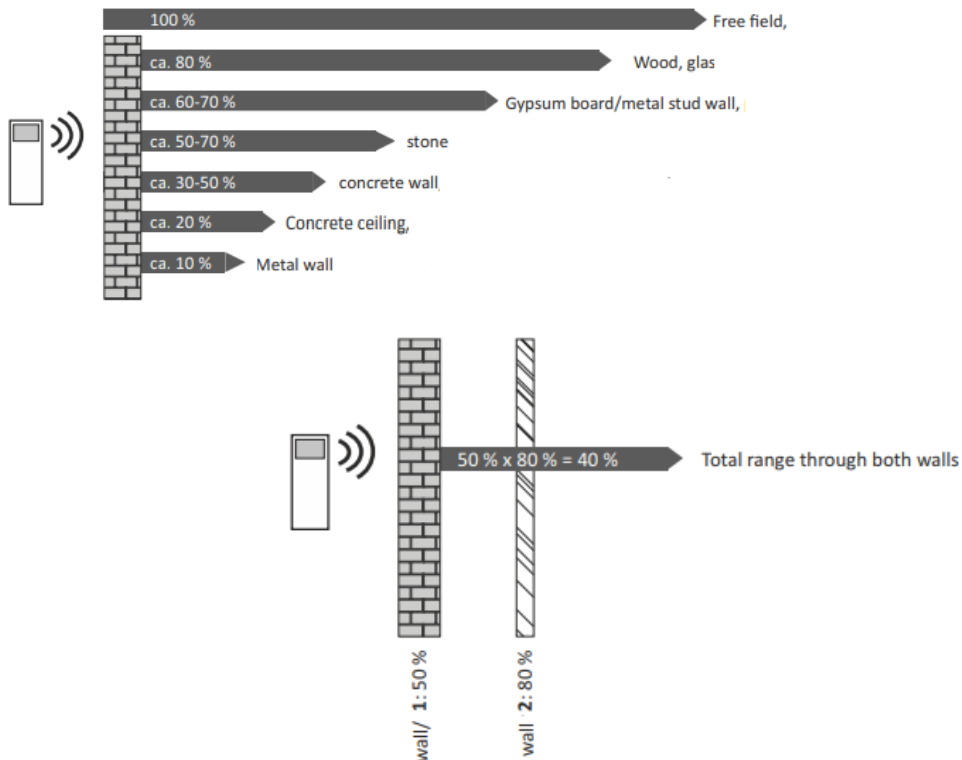

Guarantee and liability

GROTHER GmbH chimes are produced using modern technology and are subjected to one hundred percent quality control.

If a defect nonetheless occurs in your device, GROTHE GmbH provides a guarantee with the following scope.

1. Our guarantee includes subsequent improvement or replacement delivery of a device, if it verifiably has functional or material defects.
2. The guarantee does not cover natural wear and tear or transport damage. It also does not cover damage caused by disregard of the installation instructions or improper installation. The guarantee automatically expires if the device was opened after the fault diagnosis.
3. The guarantee period is 24 months from the purchase of the device by the consumer. Compliance with the claim period must be verified by proof of date of purchase by means of the enclosed invoice, delivery note or similar document.

In case of a defect, please send the device with the enclosed description of the defect to the address of the seller with the above-named documents.

Declaration of Conformity

We hereby declare that this product is in compliance with the essential requirements and the other relevant provisions of Directive 2014/53/EU.

Depending on the device type, tested to the respective relevant standards
EN 3000220-2, EN 301489-1, EN 62368-1:2016, EN 55022, EN 50581

- RED Directive 2014/53/EU
- EMC Directive 2014/30/EU
- RoHS Directive 2011/65/EU
- WEEE Directive 2012/19/EU

EC Declaration of Conformity: visit www.funkgong.de

Countries: for all EU countries Transmission

frequency: 868.35 MHz

E-waste does NOT belong in the domestic waste

Electrical appliances bearing this mark must be collected separately and reused in an environmentally sound manner (in accordance with the European Waste Electrical and Electronic Equipment Directive (WEEE) and its transposition into national law), German Act for Electrical and Electronic Equipment, Act on the Sale, Return and Environmentally Sound Disposal of Electrical Equipment and electronic devices (ElektroG)).

Please dispose of unusable or discarded electrical appliances only via the return and collection systems or via the manufacturer or importer.

Technical Data

Radio frequency	868,35 MHz
Range	250 m in the free field *
Transmission power	> 25 mW
Power supply	2 Batteries 1,5 V (Type AAA)
External power supply	6 – 12 V DC
Degree of protection	IP 44
Use	Protected outdoor area
Temperature range	-10 bis 50 °C
Dimensions surface mounting	127 x 130 x 17 mm
Dimensions flush mounting	127 x 130 x 52 mm

Remarque, Notitie: Walls, doors, metal components etc. may reduce the range significantly!

+49 2242 8890 56
service@grothe.de
www.grothe.de

Documents / Resources

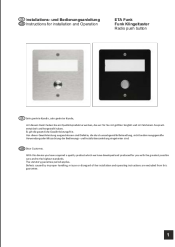
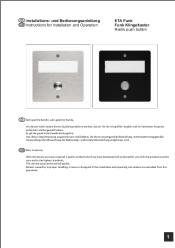
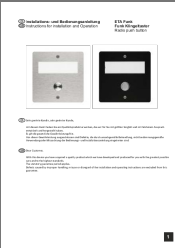
	<p>GROTHE ETA Funk Radio Push Button [pdf] Instruction Manual ETA Funk Radio Push Button, ETA Funk, Radio Push Button, Push Button</p>
	<p>GROTHE ETA Funk Radio Push Button [pdf] Instruction Manual ETA Funk Radio Push Button, ETA Funk, Radio Push Button, Push Button, Button</p>
	<p>GROTHE ETA Funk Radio Push Button [pdf] Instruction Manual ETA Funk Radio Push Button, ETA Funk, Radio Push Button, Push Button, Button</p>

References

-  [Funkgongs](#)
-  [Startseite | Grothe](#)