



Gre PLWPB Pool Lampe Rapid Projector Instruction Manual

[Home](#) » [Gre](#) » Gre PLWPB Pool Lampe Rapid Projector Instruction Manual 



Ref. PLWPB
RAPID PROJECTOR

Contents

- 1 PLWPB Pool Lampe Rapid Projector
- 2 VERIFY THE CONTENTS OF THE PACKING:
- 3 GENERAL CHARACTERISTICS:
- 4 INSTALLATION:
- 5 ASSEMBLY
- 6 MAINTENANCE
- 7 SAFETY AND MAINTENANCE WARNINGS:
- 8 ASSEMBLY AND FUNCTIONING WARNINGS:
- 9 ENVIRONMENTAL INFORMATION
- 10 TECHNICAL CHARACTERISTICS
- 11 Documents / Resources
 - 11.1 References

PLWPB Pool Lampe Rapid Projector



CE INSTALLATION AND MAINTENANCE MANUAL

IMPORTANT: The instruction manual you are holding includes essential information on the safety measures to be implemented for installation and start-up.

Therefore, the installer as well as the user must read the instructions before beginning installation and start-up. Keep this manual for future reference.

To achieve optimum performance of the LED Rapid Projector, follow the instructions provided below:

VERIFY THE CONTENTS OF THE PACKING:

The following accessories are included inside the box:

- Unit projector
- 1" 1/2 adaptor
- Manual for electrical connection
- Encapsulated transformer of 230 VAC–12 VAC and 75 VA.
- Warranty booklet
- Installation and maintenance manual
- Spanner for adaptor
- Nozzle
- Stuffing box hose

GENERAL CHARACTERISTICS:

This projector has been designed to be used totally submerged in water. It is a Class III electric apparatus with very low safety voltage (12V with alternating current). Supplied with an encapsulated transformer with an IP55 rating.

The projector compiles with IPX8 degree of protection (resistance to penetration of dust, solid bodies and humidity) at a nominal immersion depth of 2 m.

This projector complies with international safety standards for lights, especially the EN 60598-2-18 standard. LIGHTS PART 2: SPECIFIC REQUIREMENTS SECTION 18 LIGHTS FOR SWIMMING POOLS AND SIMILAR APPLICATIONS.

The manufacturer is not responsible in any circumstances for assembly, installation or start-up of any electric components which have been inserted or handled at locations other than its own premises.

INSTALLATION:

- To correctly light a swimming pool we recommend you:

Install a projector in the range LED Rapid every 20 m² of water surface.

Note: Recommendation valid for light coloured pools. In darker coloured pools or stainless steel pools we recommend oversizing the proportion of projectors per m².

- In order to prevent glare, the projectors should be installed so that they face away from the residence or usual view of the swimming pool.
- In the event that lighting is used in training or competition pools, the projectors should be installed on the sides to prevent glare on the swimmers.
- The spotlight should not be handled internally under any circumstances as this would lead to losing the guarantee.
- The LED Rapid projector has been designed to be fitted to the bushing or piping; a siphon can be made or the stuffing box kit installed (Fig. 1).
- The projector should be fitted 400–700 mm under the surface of the water on one of the pool walls (Fig. 1). The way the projector is fitted will depend on whether the bushing or piping is used.
- Sealing all sections with resin systems or safety connections that comply with the IP68 rating is recommended to ensure that both cables and cable sheaths are properly sealed. Failure to follow these steps may cause short- or long-term damage to the light and installation cables.

ASSEMBLY

Procedure:

1. Install the bushing as shown in Figure 1; A (siphon), (B (cable gland kit). Choose a suitable bolt according to the thickness of the panel: 01-20 mm (bolt "a" for a steel panel pool)/21-48 mm (bolt "b" for wooden pools / composite).
You must make an 83-mm through hole in your pool wall to fit the spotlight. If you have an in-ground pool made of stainless steel sheeting / composite, this step is not necessary as the 83-mm hole is die cut in the sheeting.
2. Screw the adaptor into the bushing (Fig.3).
3. The projector's cable is supplied unconnected. The cable from the transformer's secondary winding must be directly connected to the projector by threading it through the back of the previously fitted bushing. It is very important to ensure that the projector is fully watertight by using the cable gland on it. The cable outlet at the back of the bushing must also be made watertight using the adapter with cable gland or by siphoning it (Fig. 6).
4. Once connected, ease the projector in and turn 90° clockwise (Fig. 4a).
5. Put the face plate into place with the logo facing the top of the fixture (Fig 4).

Replacing the projector

1. Give a quarter of a turn anti-clockwise, remove the projector until it has come out of the adaptor (Fig. 4b) and place it on the edge of the pool.
2. Loosen the stuffing box assembly and then the wire connector; it is very important to follow the steps as shown (Fig. 5).
3. Reconnect the projector.

MAINTENANCE

This lamp does not require any type of maintenance work. If you notice that the lamp is not working properly, please contact our customer attention service.

THIS PRODUCT DOES NOT CONTAIN ANY ELEMENTS THAT CAN BE HANDLED, DISMANTLED OR REPLACED BY THE USER.

IT IS FORBIDDEN TO ACCESS INSIDE THE PRODUCT, OTHERWISE THE GUARANTEE OF THE PRODUCT WILL BECOME INVALID.

SAFETY AND MAINTENANCE WARNINGS:

- Before any handling ensure that there is NO voltage supplied to the projector.
- People in charge of assembly should be suitably qualified for this type of work.
- Avoid making contact with the electric voltage.
- Comply with the current standards regarding accident prevention.
- In this regard, the IEC 364-7-702 standards must be observed: WIRING IN BUILDINGS SPECIAL WIRING SWIMMING POOLS.
- Do not handle with wet feet.
- Do not clean using abrasive products that could damage the projector.
- The LEDs in this projector are classified as risk group 2.
- Under no circumstances should the luminaire be stared into for one minute or more at distances equal to or less than 20 cm. Doing so could damage eyesight.

ASSEMBLY AND FUNCTIONING WARNINGS:

- Maximum water temperature 40°C.
- It is not recommended the use of sealing putty in this product and, anyway, you should use only products specifically conceived to work with ABS, all those products of universal use remain excluded.
- The projector is designed TO OPERATE ONLY WITH A SAFETY TRANSFORMER.
- The manufacturer is not responsible in any circumstances for assembly, installation or start-up of any electric components which have been inserted or handled at locations other than its own premises.
- It is responsibility of the installer to ensure that no water gets inside the projector by means of the cables.
- This projector is seawater resistant.
- This projector is resistant to pool treatments described below, always that the concentration values do not exceed the following levels:

TYPE OF TREATMENT	CONCENTRATION IN WATER
Chlorine	2 mg/l
Bromine	5 mg/l

Attention : Please note that the Ph of pool water always must be between 7.2 and 7.6.

ENVIRONMENTAL INFORMATION

Processing of electrical and electronic equipment after their period of use (Only applicable in the E.U.)



In order to reduce the amount of waste of electric and electronic apparatus, to reduce the danger of components, to encourage the reuse of apparatus, to assess waste and to set up a suitable waste treatment system, with the aim of improving the efficiency of environmental protection, a set of rules has been established applicable to the manufacture of the product and other rules regarding the correct environmental treatment when these products become waste.

It is also intended to improve the environmental practices of all agents involved in electrical and electronic goods, including manufacturers, distributors, users and particularly those directly involved in the treatment of waste derived from these apparatus.

From 13th August 2005, there are two ways of disposing of this apparatus:

- if you purchase a new equivalent apparatus or which has the same functions as the one you wish to dispose of, you can hand it over, free of charge, to the distributor when making your purchase, or
- you can take it to local collection points.

We shall cover waste treatment costs.

The apparatus are labelled with a symbol of a “crossed-out waste container”. This symbol means that the apparatus is subject to selected waste collection, different from general waste collection.

Our products are designed and manufactured with top-quality, environmental-friendly materials and components, which can be reused and recycled. In spite of this, several parts of this product are not biodegradable and therefore it should not be left in the environment. For the correct recycling of this product, please completely detach the electrical motor from the rest of the filtration equipment.

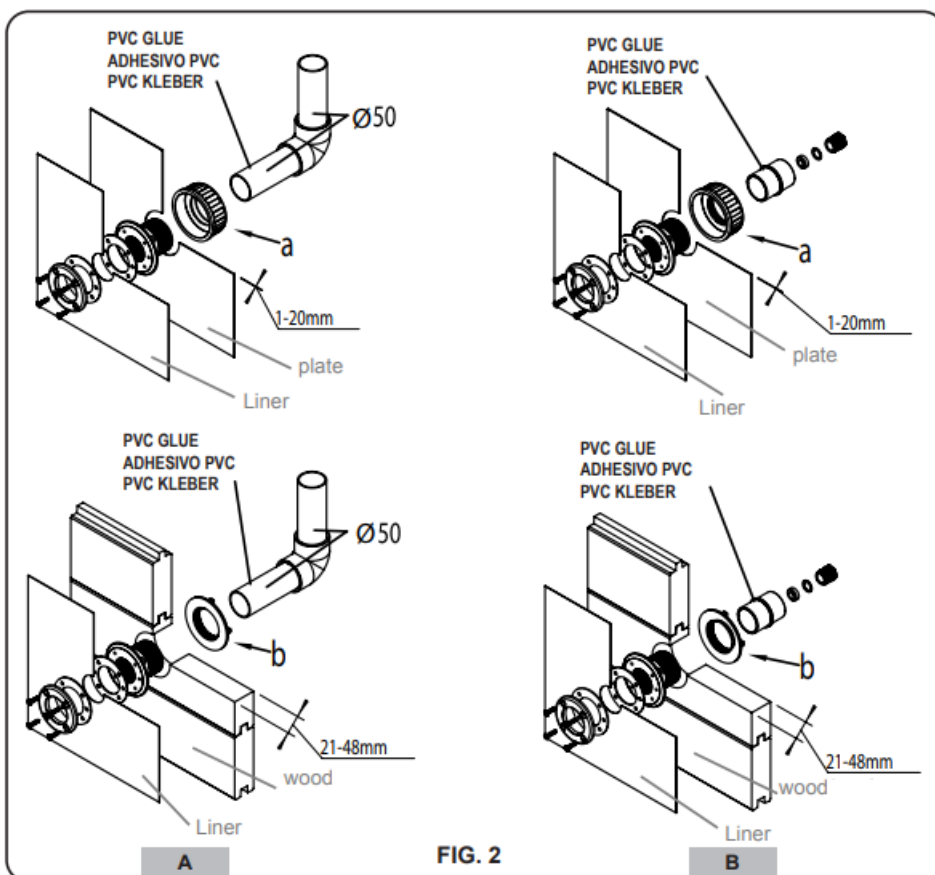
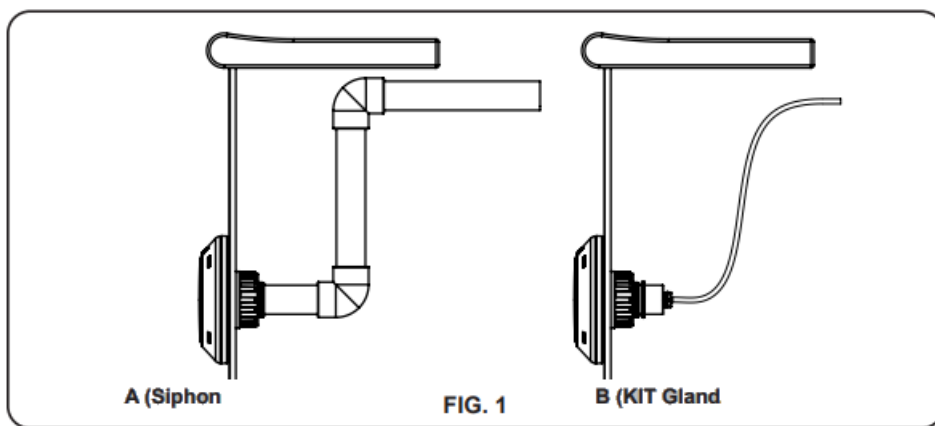

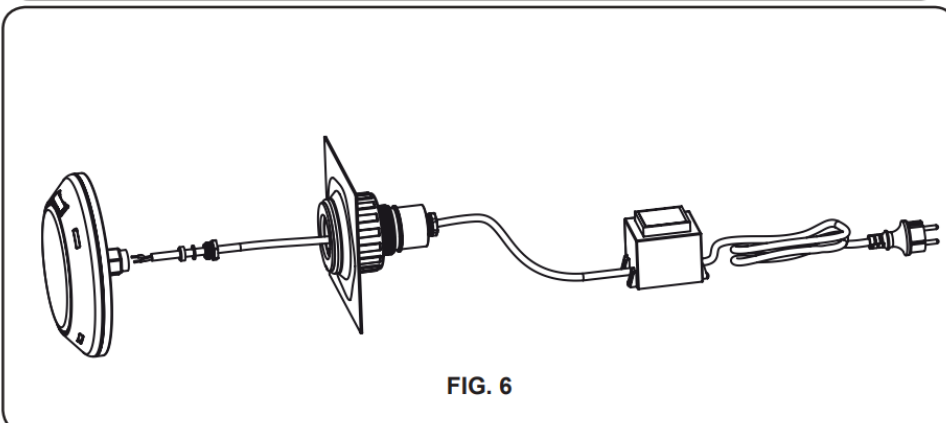
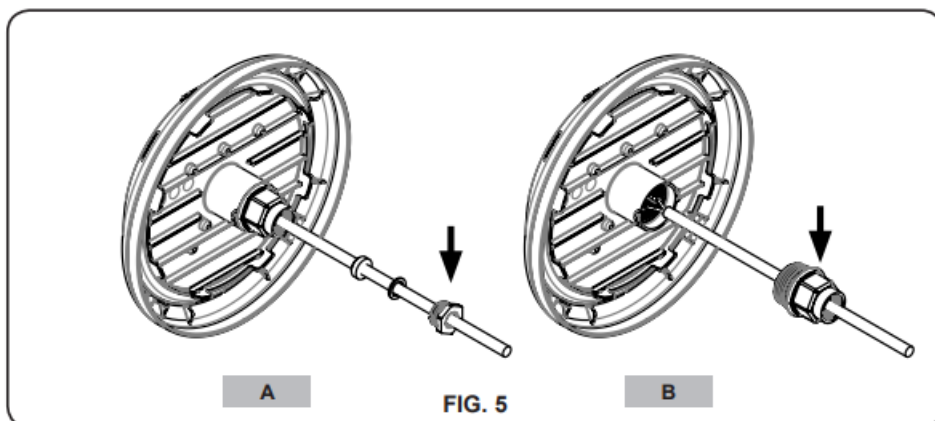
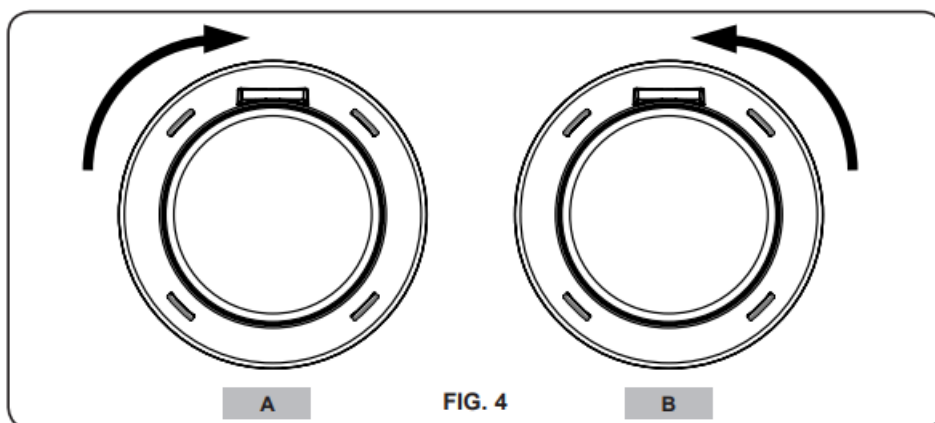
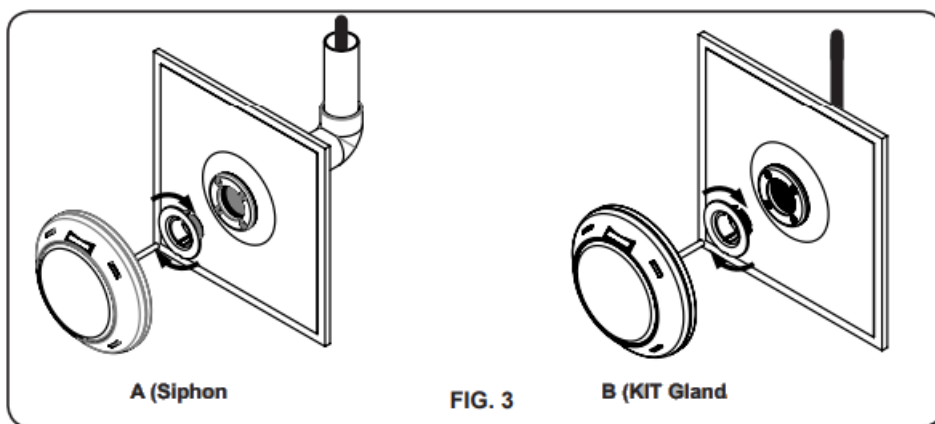

SACOPA, S.A.U.

PRODUCTS: LED RAPID UNDERWATER PROJECTOR (PLWPB)

DECLARATION CE OF CONFORMITY

The products listed above are in compliance with:
Electromagnetic Compatibility Directive 2014/30/UE.

Low Voltage Directive 2014/35/UE.

European Standard EN 60598-1, EN 60598-2-18, and all its modifications.

Directive 2011/65/EU of the European Parliament and of the Council of 8 June 2011 on the restriction of the use of certain hazardous substances in electrical and electronic equipment.

Signature / Qualification:

SACOPA, S.A.U.

Pol. Ind. Poliger Sud – Sector I

17854 SANT JAUME DE LLIERCA

SPAIN

**St. Jaume de Llierca,
15 January of 2019**

A handwritten signature in black ink, appearing to be 'J. Llierca', written over a faint rectangular stamp.

Gerent

If You Have Any Problem, Contact Us!

www.grepool.com/en/after-sales

- We reserve the right to change all or part of the articles or contents of this document, without prior notice

TECHNICAL CHARACTERISTICS

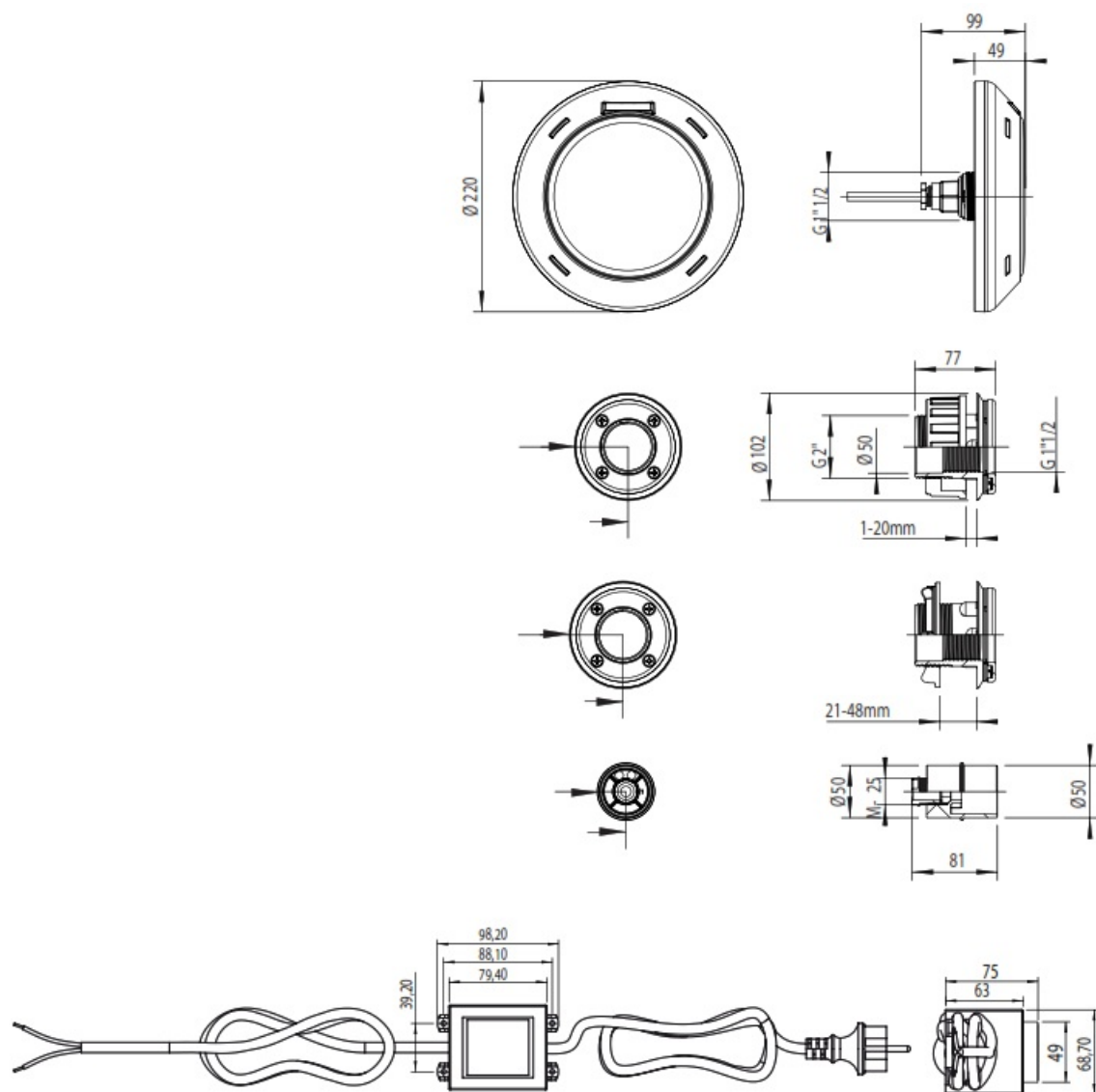

MANUFACTURAS GRE, S.A.
 ARITZ BIDEA Nº 57, BARRIO TROBIKA
 48100 MUNGUÍA (VIZCAYA) ESPAÑA
 Telf: 94 674 11 16 Fax: 94 674 17 08
www.grepool.com
 Made in Spain
 A17092610
 71631E201P10-02

- We reserve to change all or part of the articles or contents of this document, without prior notice.

	<p>Gre PLWPB Pool Lampe Rapid Projector [pdf] Instruction Manual</p> <p>PLWPB Pool Lampe Rapid Projector, PLWPB, Pool Lampe Rapid Projector, Lampe Rapid Projector, Rapid Projector, Projector</p>
---	---

References

- [Adomino Premium Domain Names](#)
- [Gre Pools](#)
- [Formular für den Kundendienst 1 | Gre Pools](#)
- [After Sales Service Form 1 | Gre Pools](#)
- [Formulaire de service après-vente 1 | Piscines Gre](#)
- [Modulo di richiesta post-vendita 1 | Gre Pools](#)
- [Formulario servicio post-ventas 1 | Gre Pools](#)
- [User Manual](#)