



Gre Cartridge Filter with Aqualoon Instruction Manual

[Home](#) » [Gre](#) » Gre Cartridge Filter with Aqualoon Instruction Manual 



www.gre.es

Ref. CFAQ35

Contents

- [1 CARTRIDGE FILTER WITH AQUALOONInstruction Manual](#)
- [2 SAFETY INSTRUCTIONS](#)
- [3 INSTALLATION INSTRUCTIONS](#)
- [4 OPERATING INSTRUCTIONS](#)
- [5 OPERATING INSTRUCTIONS](#)
- [6 Documents / Resources](#)
 - [6.1 References](#)
- [7 Related Posts](#)

CARTRIDGE FILTER WITH AQUALOON



Instruction Manual

We reserve to change all of part of the articles or contents of this document, without prior notice.

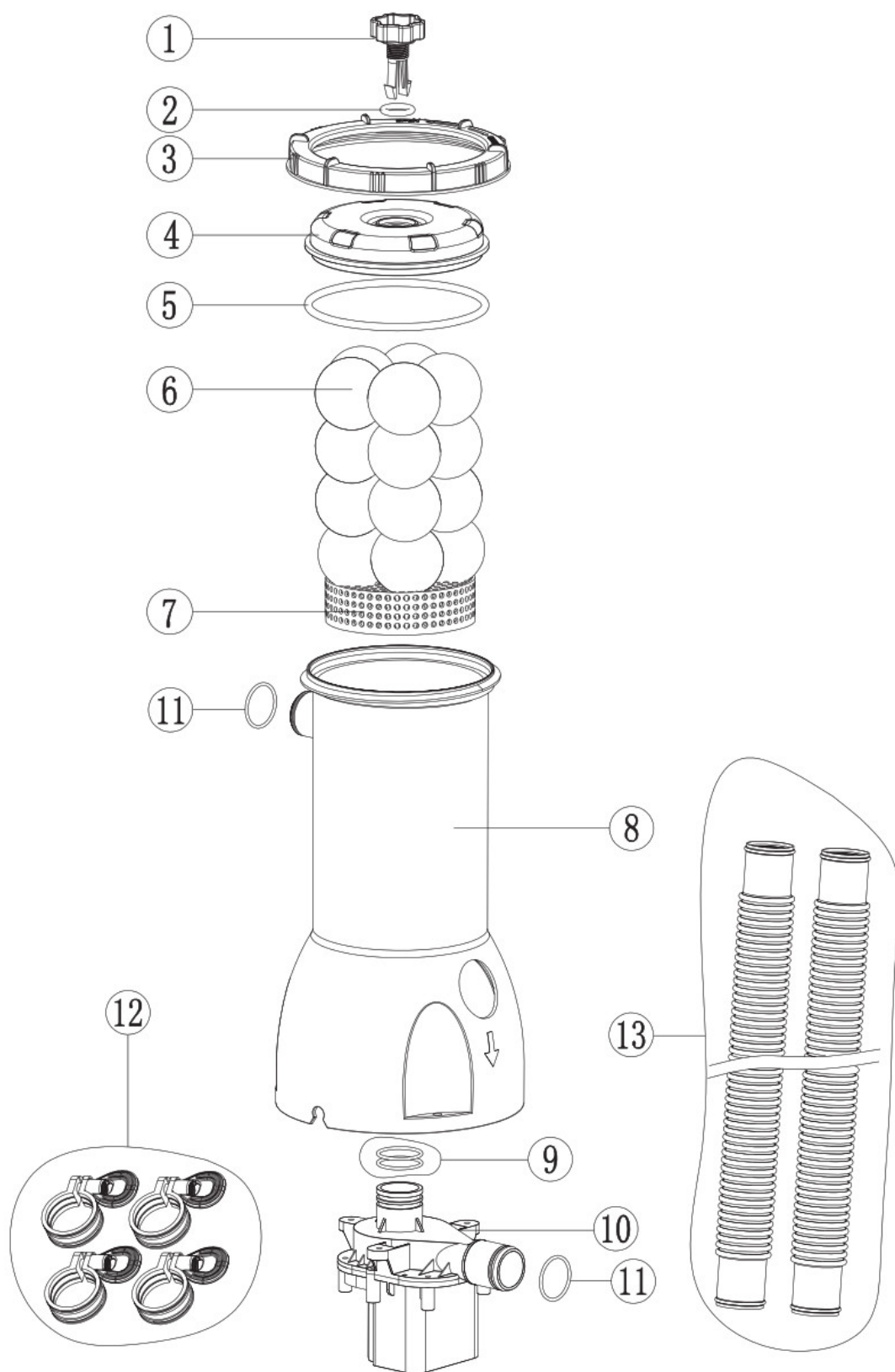

1.	AIR VALVE SCREW	7.	FOAM
2.	AIR VALVE O RING	8.	BODY
3.	PLASTIC NUT	9.	PUMP O RING
4.	TOP COVER	10.	PUMP
5.	TOP COVER O RING	11.	SEAL O RING
6.	AQUALOON	12.	PLASTIC CLAMP
13.	Hose		

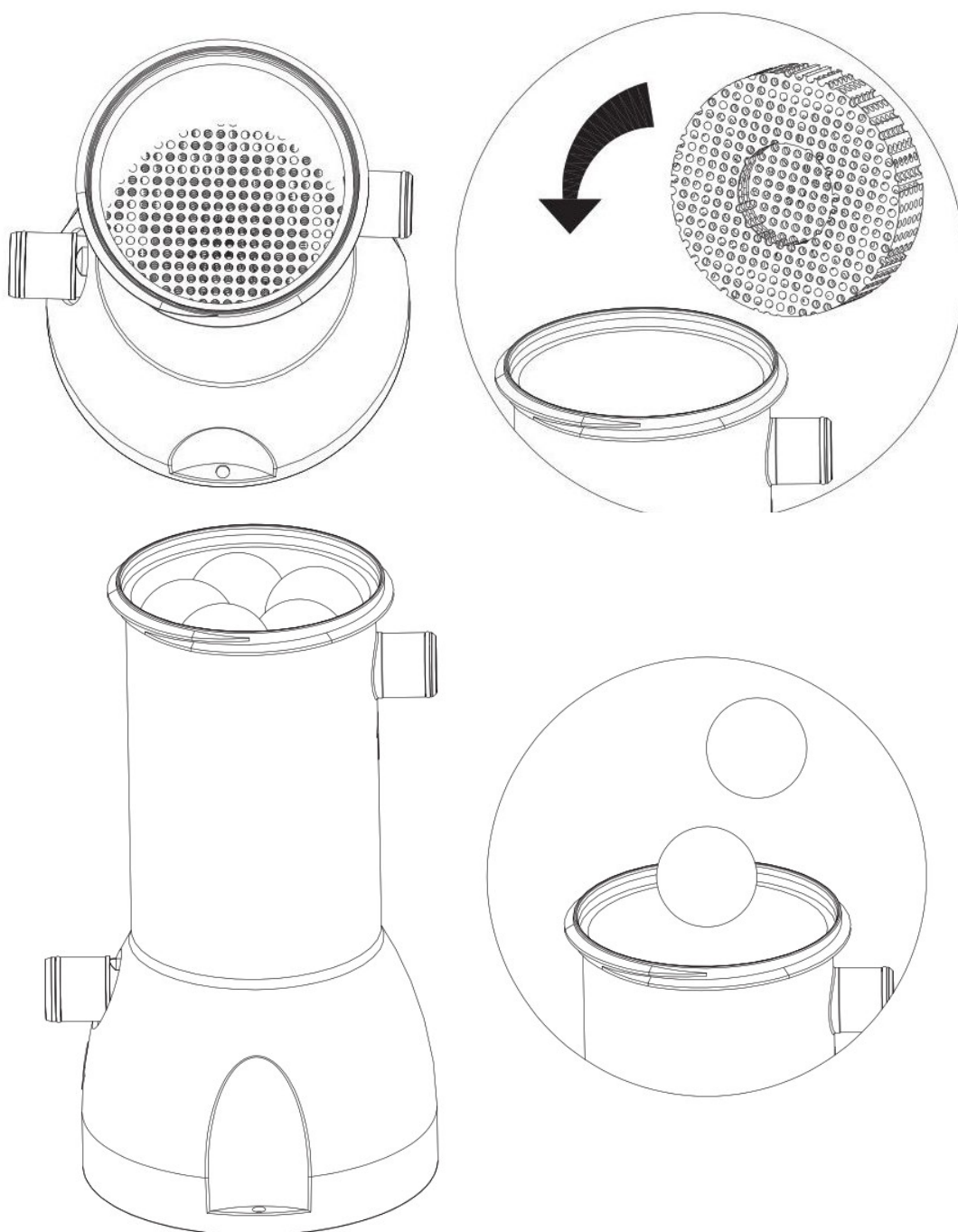

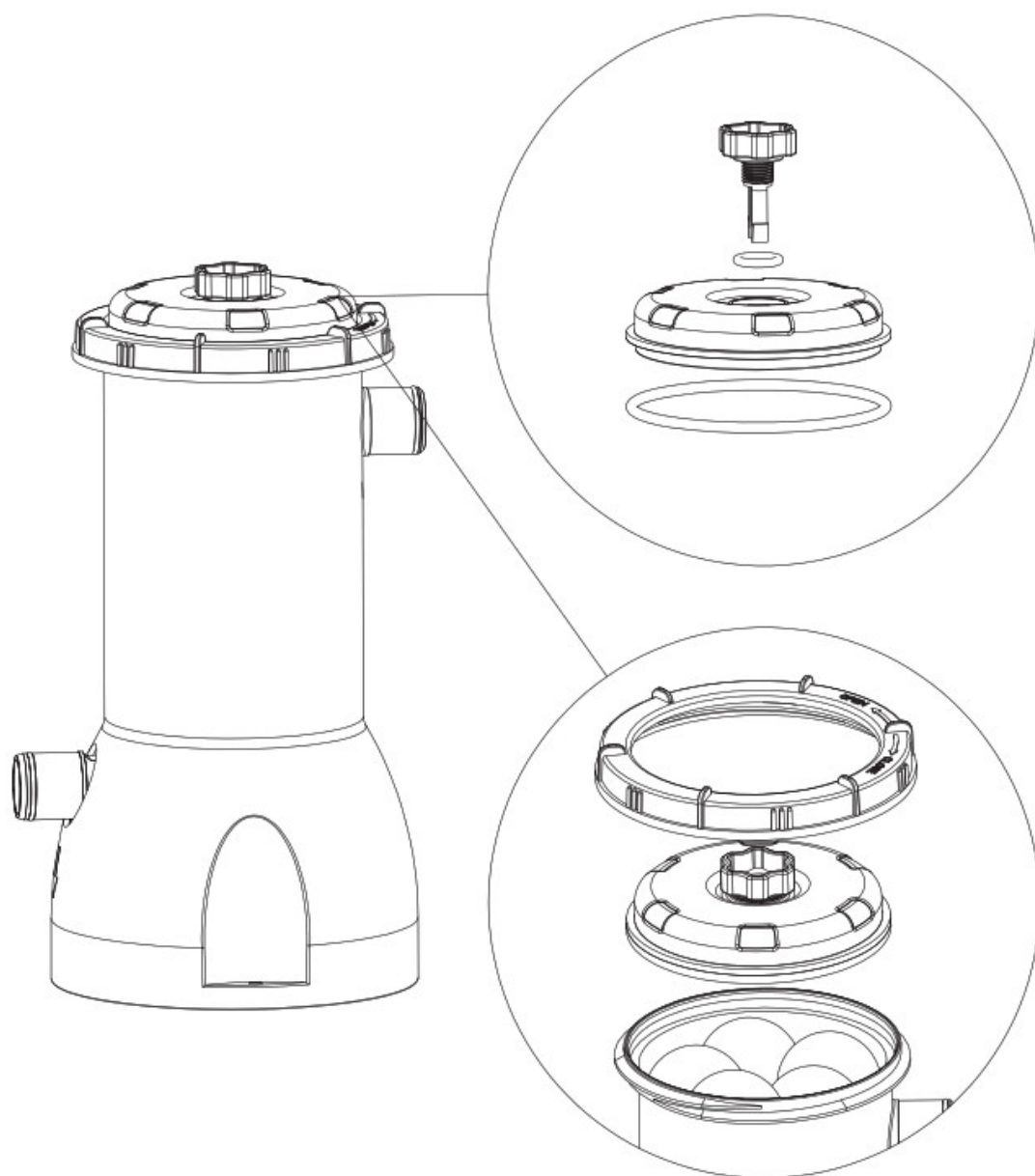

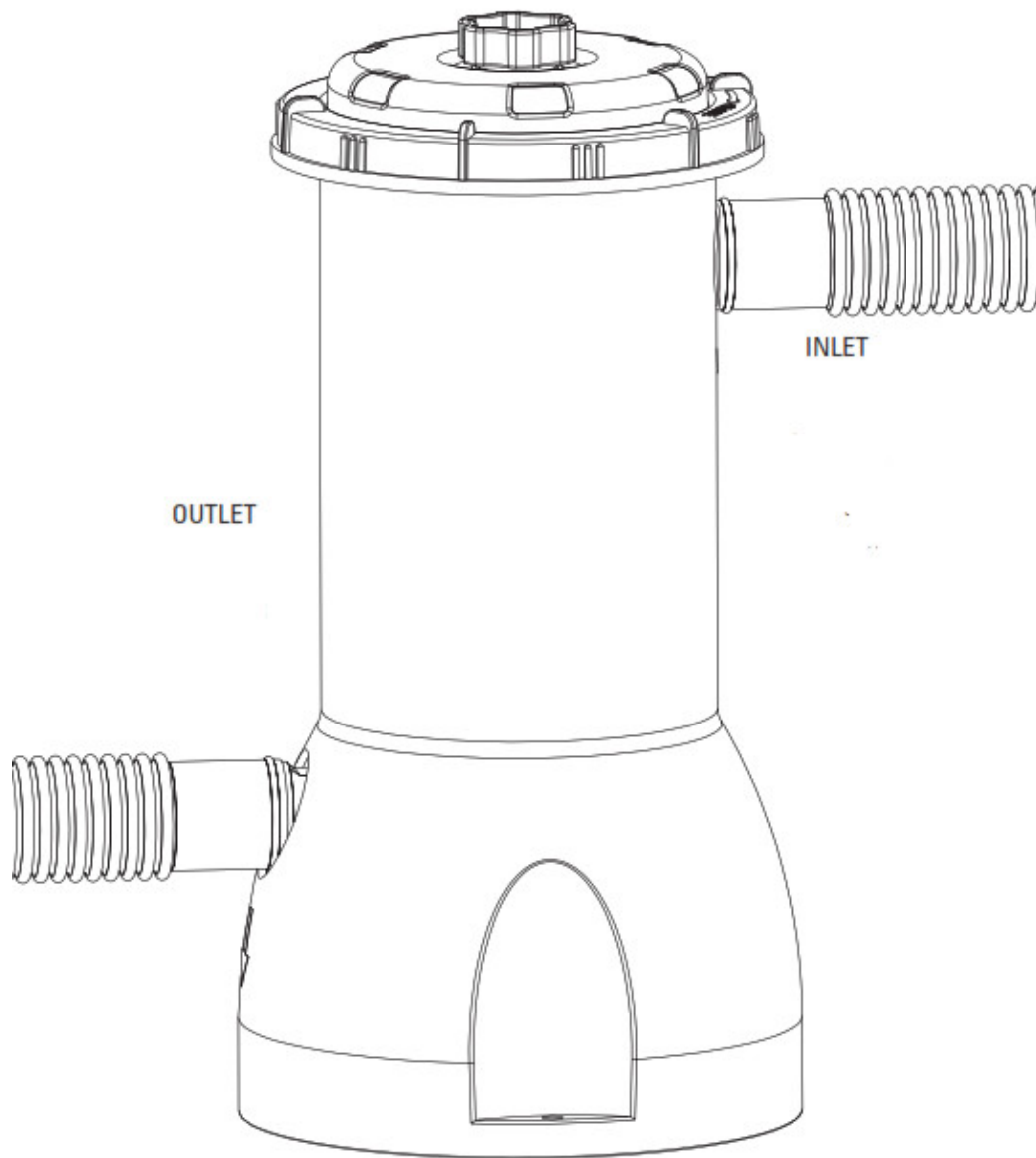

READ CAREFULLY AND SAVE THE FOLLOWING INSTRUCTIONS BEFORE OPERATION

SAFETY INSTRUCTIONS

The following important points should be read and understood prior to use:

1. The maximum head of the pump is 3.7m (for pumps having rated power input exceeding 100W).
Maximum liquid temperature: 35°C
2. Make sure the pump be fixed before using each time with the screws.
3. This appliance can be used by children aged 8 years and above and persons with reduced physical, sensory or mental capabilities or lack of experience and knowledge if they have been given supervision or instruction concerning the use of the appliance in a safe way and understand the hazards involved.
4. Children shall not play with the appliance. Cleaning and user maintenance shall not be made by children without supervision. The supply cord cannot be replaced. If the cord is damaged the appliance should be Scrapped.
5. The pump must not be used when people are in the water. The supply cord cannot be replaced. If the cord is damaged the appliance should be scrapped.
6. **WARNING** The pump is to be supplied by an isolating transformer of supplied through a residual current

device(RCD) with a rated residual operating current not exceeding 30mA

7. **WARNING** To prevent possible electric shock, do not attempt to plug in the power cord with wet hands or while standing in water.
8. **WARNING** Make certain before each use of the pump that all clamps are tightened and that all hoses are connected properly.
9. **WARNING** Do not use this filter pump to vacuum the pool.
10. **WARNING** Never 230 V power adapter near a swimming pool. Transformers and power outlets should be 3.5 meters or more away from the pool. Filter pump and power adapter may not be installed in flooded areas (where no suitable power outlet).

INSTALLATION INSTRUCTIONS

1. Set up your Pool exactly. Fill it completely with water.
2. Position the filter pump unit at least 20 cm below the highest water level in the pool.
3. And keep the filter pump at least 60 cm away from the sidewall of the pool.
4. Place Aqualoon and bottom sponge into the body of the filter pump.
5. Make certain that the filter chamber rubber gasket is placed in the seal groove on the top of the filter pump.
6. Screw on filter chamber cover onto top of the body of filter pump by hand.
7. Connect the hoses same as the Installation illustration, fixture the pump to the wall of the pool. Remember to use hose clamp, tighten it secondly with a screwdriver.
8. Allow time for the filter pump chamber to be full with water. Never operate the filter pump dry.
9. Check the location authorities to determine the appropriate standard and requirements for electronic installation. Connect the electrical power cord into a grounded receptacle protected by a ground-fault circuit interrupter(GFCI). Please contact a qualified electrician for verification purposes and/or installation of a GFCI receptacle if necessary.

Please install your filter pump following the installation illustration below.

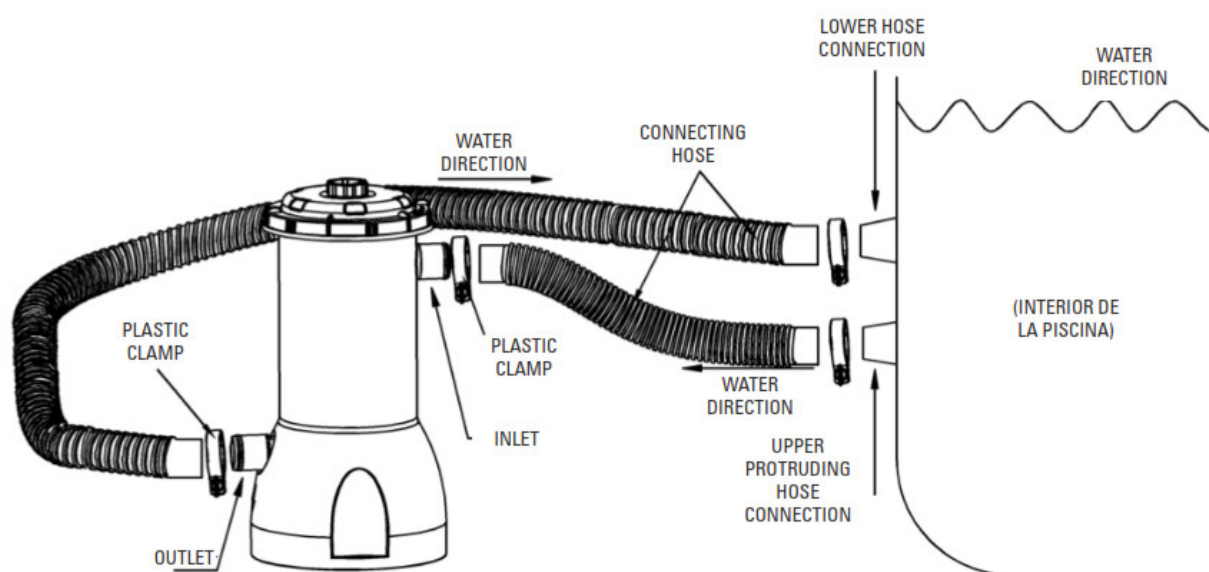

OPERATING INSTRUCTIONS

1. The filter pump will prime itself as long as it is positioned at least 20 cm below the highest water level is a relief valve located on the top of the pump. Simply turn the valve knob counter-clockwise, and when a small number

- of water escapes, close immediately by turning clockwise. The pump will now be completely primed.
2. Never operate the filter pump dry. This can cause damage to seals which may result in leakage and/ or flooding.
 3. Prior to each use, check to ensure that all hose clamps are tightened.
 4. To prevent possible electric shock, do not attempt to plug in an electrical power cord with a wet hand or while standing in water.
 4. The filter pump must operate in the upright, vertical position.
 5. The filter pump must be positioned on level, stable ground. And the use of a riser or elevated platform is not expected.
 6. To preserve the full life of the pump and to keep the pool filtered properly, your pump should be run approximately 4 to 6 hours per day.
 7. Overuse may cause overheating and/or motor burnout. Use good judgment on extremely days and be mindful of running the filter pump continuously for an extended period of time.

OPERATING INSTRUCTIONS

1. The filter pump will prime itself as long as it is positioned at least 20 cm below the highest water level is a relief valve located on the top of the pump. Simply turn the valve knob counter-clockwise, and when a small number of water escapes, close immediately by turning clockwise. The pump will now be completely primed.
2. Never operate the filter pump dry. This can cause damage to seals which may result in leakage and/or flooding.
3. Prior to each use, check to ensure that all hose clamps are tightened.
4. To prevent possible electric shock, do not attempt to plug in an electrical power cord with a wet hand or while standing in water.
5. The filter pump must operate in the upright, vertical position.
6. The filter pump must be positioned on level, stable ground. And the use of a riser or elevated platform is not expected.
7. To preserve the full life of the pump and to keep the pool filtered properly, your pump should be run approximately 4 to 6 hours per day.
8. Overuse may cause overheating and/or motor burnout. Use good judgment on extremely days and be mindful of running the filter pump continuously for an extended period of time.



STARMATRIX GROUP INC.

Address: 261 MENGXI ROAD ZHENJIANG JIANGSU 212004 P.R.CNINA

TEL. +86-511-85982598 FM. +88-511 85985598

E-Mail: mail@starmatrix.cn

DECLARATION OF CONFORMITY

We Starmatrix Group Inc. hereby confirm that our item CARTRIDGE FILTER/EZ CLEAN 100 FILTER which is selling to MANUFACTURAS GRE S.A. based on item No. CFAQ35 is satisfied with

REACH Regulation 1907/2006

RoHS Directive 2011/65/EU

Low Voltage Directive 2014/35/EU

Sign: 

Date:

Position: Sales Manager

Company seal:

Dec. 11th. 2018

IF YOU HAVE ANY PROBLEM, CONTACT US!

www.service-gre.com



DISTRIBUTED BY

MANUFACTURAS GRE, S.A. ARITZ BIDEA Nº 57 BELAKO INDUSTRIALDEA, APARTADO 69 – 48100 MUNGUIA (VIZCAYA) ESPAÑA Nº Reg. Ind. 48-06762

MADE IN CHINA

Documents / Resources

	<p>Gre Cartridge Filter with Aqualoon [pdf] Instruction Manual Cartridge Filter with Aqualoon</p>
---	---

References

- [Adomino Premium Domain Names](#)
- [Gre Pools](#)
- [Service GRE > Inicio](#)