



GRANDSTREAM GXV3380 IP Multimedia Phone for Android Installation Guide

[Home](#) » [GRANDSTREAM](#) » GRANDSTREAM GXV3380 IP Multimedia Phone for Android Installation Guide 

Contents

1 GXV3380

1.1 IP Multimedia Phone for Android™

1.1.1 Quick Installation Guide

1.1.2 PRECAUTIONS:

1.1.3 OVERVIEW:

1.1.4 PACKAGE CONTENTS:

1.1.5 PHONE SETUP:

1.1.5.1 Installing the Phone (Wall Mount *Sold separately):

1.1.5.2 Using the Phone Stand:

1.1.6 CONNECTING THE PHONE:

1.1.6.1 Tips for using the GXV3380 Keys:

1.1.7 PHONE CONFIGURATION:

1.1.7.1 Configuring the GXV3380 using Touch Screen:

1.1.7.2 Configuring the GXV3380 using Web Browser:

2 Documents / Resources

2.1 References

3 Related Posts



GXV3380

IP Multimedia Phone for Android™

Quick Installation Guide

The GXV3380 is not pre-configured to support or carry emergency calls to any type of hospital, law enforcement agency, medical care unit ("Emergency Service(s)") or any other kind of Emergency Service. You must make additional arrangements to access Emergency Services. It is your responsibility to purchase SIP-compliant Internet telephone service, properly configure the GXV3380 to use that service, and periodically test your configuration to confirm that it works as you expect. If you do not do so, it is your responsibility to purchase traditional wireless or landline telephone services to access Emergency Services.

GRANDSTREAM DOES NOT PROVIDE CONNECTIONS TO EMERGENCY SERVICES VIA THE GXV3380. NEITHER GRANDSTREAM NOR ITS OFFICERS, EMPLOYEES OR AFFILIATES MAY BE HELD LIABLE FOR ANY CLAIM, DAMAGE, OR LOSS. YOU HEREBY WAIVE ANY AND ALL SUCH CLAIMS OR CAUSES OF ACTION ARISING FROM OR RELATING TO YOUR INABILITY TO USE THE GXV3380 TO CONTACT EMERGENCY SERVICES, AND YOUR FAILURE TO MAKE ADDITIONAL ARRANGEMENTS TO ACCESS EMERGENCY SERVICES IN ACCORDANCE WITH THE IMMEDIATELY PRECEDING PARAGRAPH.

PRECAUTIONS:

WARNING: Please DO NOT power cycle the GXV3380 during system boot up or firmware upgrade. You may corrupt firmware images and cause the unit to malfunction.

WARNING: Use only the power adapter included in the GXV3380 package. Using an alternative non-qualified power adapter may possibly damage the unit.

OVERVIEW:

The GXV3380 IP Video Phone for Android combines a 16-line IP video phone with a multi-platform video conferencing solution and the functionality of an Android tablet to offer an all-in-one communications solution. The phone features a 8" 1280×800 capacitive touch screen IPS LCD, Mega pixel camera, dual Gigabit ports with PoE/ PoE+, HD audio and video, integrated WiFi (Dual band 802.11ac) & Bluetooth 4.2+EDR, rich peripheral interfaces, and Android 7.1.1. By combining a state-of-the-art IP video phone, an advanced conferencing solution, businesses throughout the world can now use the GXV3380 for all communication and productivity needs.

PACKAGE CONTENTS:

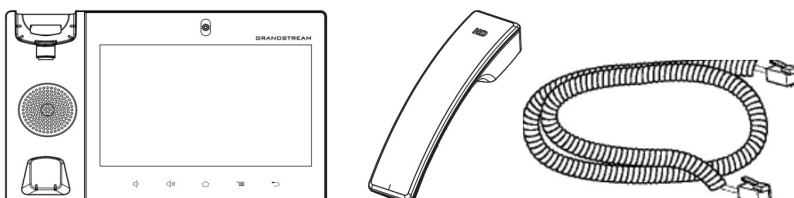

1x GXV3380 Main Case 1x Handset 1x Phone Cord

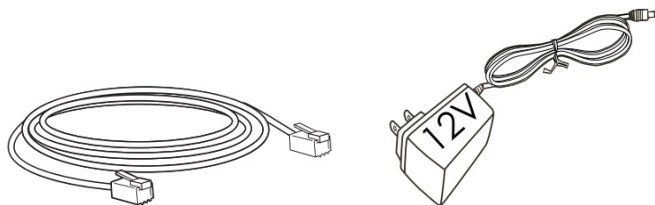

1x Ethernet Cable

1x 12V Power Adapter

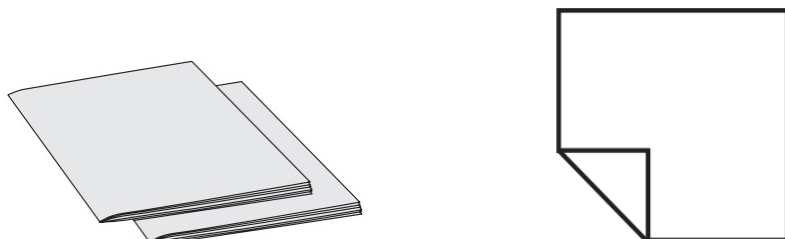

1x Quick Installation Guide/1x GPL License 1x Screen Cleaning Cloth

PHONE SETUP:

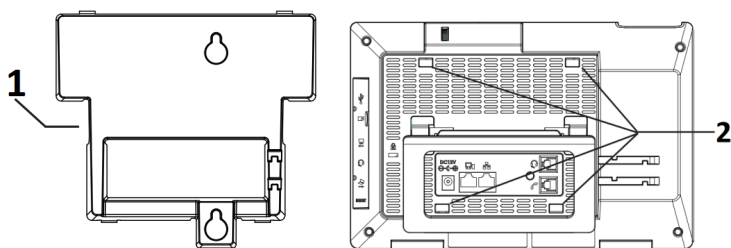

1. Wall mount
2. Slots for wall mount

Installing the Phone (Wall Mount *Sold separately):

1. Attach the wall mount to the slots on the back of the phone.
2. Attach the phone to the wall via the wall mount hole.
3. Pull out the tab from the handset cradle (see figure below).
4. Rotate the tab and plug it back into the slot with the extension up to hold the handset while the phone is mounted on the wall.

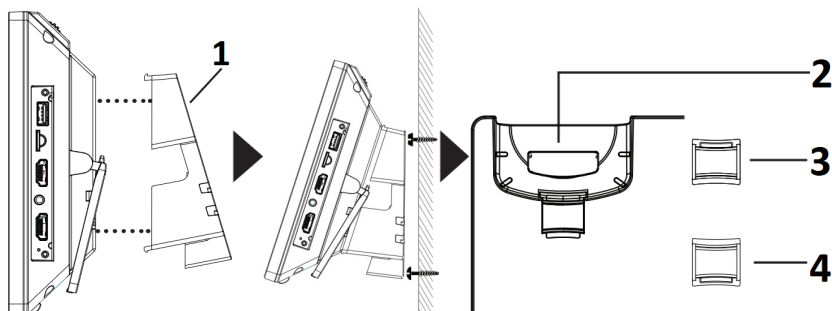

1. Wall mount
2. Handset Rest
3. Tab with extension up
4. Tab with extension down

Using the Phone Stand:

The GXV3380 has a built-in phone stand. To use it, pull out the phone stand handle on the back of the phone. Adjust the angle as preferred and make sure the phone stands still on the desktop.

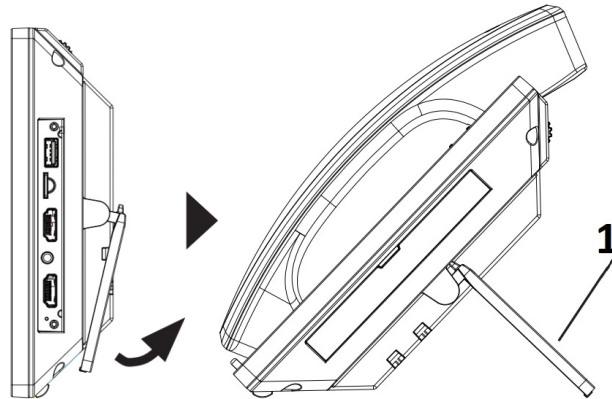

1. Built-in phone stand for desktop

CONNECTING THE PHONE:

1. Connect the handset and main phone case with the phone cord.
2. Connect the LAN port of the phone to the RJ-45 socket of a hub/switch or a router (LAN side of the router) using the Ethernet cable.
3. Connect the 12V DC output plug to the power jack on the phone; plug the power adapter into an electrical outlet. If PoE switch is used in step 2, this step could be skipped.
4. The LCD will display booting up or firmware upgrading information. Before continuing, please wait for the main screen display to show up.
5. Using the web configuration interface or from the menu of the touch screen, you can further configure network connection using static IP, DHCP... etc.

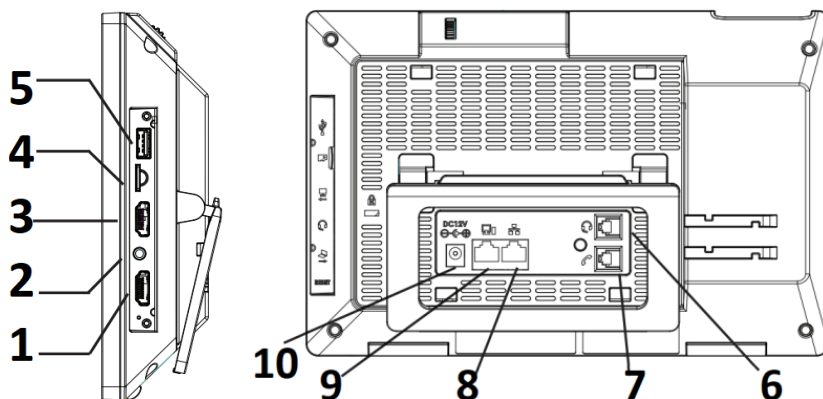

1. HDMI IN Port
2. 3.5mm Headset Port

3. HDMI OUT Port
4. Micro SD Card Port
5. *USB Port
6. RJ9 Headset Port
7. Handset Port
8. LAN Port
9. PC Port
10. Power

*USB enabled only when power supply or PoE+ is used

Tips for using the GXV3380 Keys:

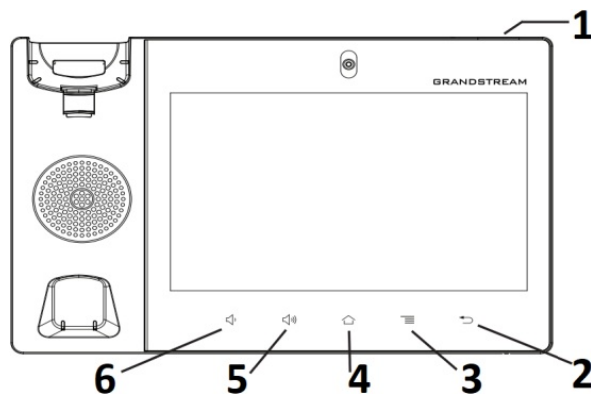

1. MESSAGE WAITING INDICATOR
2. BACK
3. MENU
4. HOME
5. VOLUME UP
6. VOLUME DOWN

- Tap on VOLUME DOWN / UP keys to adjust volume on the phone.
- Tap on HOME key to return to the default idle screen. Or press and hold on the HOME key for 2 seconds to take a screenshot.
- Press MENU key to access phone's display settings, edit widgets and thread manager. Or press and hold on the MENU key for 2 seconds to enter managing application interface directly.
- Press BACK key to go back to the previous menu.

PHONE CONFIGURATION:

Configuring the GXV3380 using Touch Screen:

1. Make sure the phone is properly powered up and in idle screen.
2. Select Settings → Advanced → Account settings. Tap on one of the Account to configure Account name, SIP Server, SIP User ID, SIP Auth ID, SIP Auth Password to register account on the GXV3380. After successfully registered, the dial screen will be shown.

3. Follow the Menu options to configure other settings on the phone. For example, to configure static IP on the GXV3380, set up static IP address via LCD Menu → Settings → Network → Ethernet Settings.
4. Please contact your ITSP (Internet Telephony Service Provider) for additional settings that may be necessary to configure the phone.

Configuring the GXV3380 using Web Browser:

1. Ensure your phone is properly powered up and connected to the Internet.
2. Tap on Settings → Status → Network status, to obtain the IP address of your phone.
3. Type the phone's IP address in your PC's browser.
4. The default username and password for administrator are “admin” and “admin”. The default username and password for user are “user” and “123”.
5. In the web GUI → Account, select Account 1/2/3/.../16 page to configure Account name, SIP Server, SIP User ID, Authenticate ID and Authenticate Password to register the account on the GXV3380.



For the detailed user manual, please download from: <http://www.grandstream.com/support>

This product is covered by one or more of the U.S. patents (and any foreign patent counterparts there to) identified at www.cmspatents.com.

Grandstream Networks, Inc.

126 Brookline Ave, 3rd Floor
Boston, MA 02215. USA
Tel : +1 (617) 566 – 9300
Fax: +1 (617) 249 – 1987

www.grandstream.com

*Android is a Registered Trademark of Google LLC.

HDMI™

HDMI, the HDMI Logo, and High-Definition Multimedia Interface are trademarks or registered trademarks of HDMI Licensing LLC in the United States and other countries.



	BE	BG	CZ	DK	DE	EE	IE	EL
	ES	FR	HR	IT	CY	LV	LT	LU
	HU	MT	NL	AT	PL	PT	RO	SI
	SK	FI	SE	NO	IS	LI	CH	TR

In all EU member states, operation of 5150-5350 MHz is restricted to indoor use only.

For Warranty and RMA information, please visit www.grandstream.com

Documents / Resources

	GRANDSTREAM GXV3380 IP Multimedia Phone for Android [pdf] Installation Guide GXV3380 IP Multimedia Phone for Android, GXV3380, IP Multimedia Phone for Android
--	---

References

- [Grandstream Networks - Networking & Unified Communications](#)
- [Support- Grandstream Networks](#)