

 **GRANDSTREAM**
CONNECTING THE WORLD
GSC3575 HD
Intercom



GRANDSTREAM GSC3575 HD Intercom User Manual

[Home](#) » [GRANDSTREAM](#) » GRANDSTREAM GSC3575 HD Intercom User Manual 

Contents

- 1 [GRANDSTREAM GSC3575 HD Intercom](#)
- 2 [Introduction](#)
- 3 [PRECAUTIONS](#)
- 4 [OVERVIEW](#)
- 5 [PACKAGE CONTENTS](#)
- 6 [DEVICE INSTALLATION](#)
- 7 [CONFIGURATION](#)
- 8 [Common part](#)
- 9 [FCC STATEMENT](#)
- 10 [Documents / Resources](#)
 - 10.1 [References](#)



GRANDSTREAM GSC3575 HD Intercom



Introduction

The GSC3574/3575 is not pre-configured to support or make emergency calls to any type of hospital, law enforcement agency, medical care unit ("Emergency Service(s)"), or any other kind of Emergency Service. You must make additional arrangements to access Emergency Services. It is your responsibility to purchase a SIP-compliant Internet telephone service, properly configure the GSC3574/3575 to use that service, and periodically test your configuration to confirm that it works as you expect. It is also your responsibility to purchase traditional wireless or landline telephone services to access Emergency Services.

GRANDSTREAM DOES NOT PROVIDE CONNECTIONS TO EMERGENCY SERVICES VIA THE GSC3574/3575. NEITHER GRANDSTREAM NOR ITS OFFICES, EMPLOYEES OR AFFILIATES MAY BE HELD LIABLE FOR ANY CLAIM, DAMAGE, OR LOSS, AND YOU HEREBY WAIVE ANY AND ALL SUCH CLAIMS OR CAUSES OF ACTION ARISING FROM OR RELATING TO YOUR INABILITY TO USE THE GSC3574/3575 TO CONTACT EMERGENCY SERVICES, AND YOUR FAILURE TO MAKE ADDITIONAL ARRANGEMENTS TO ACCESS EMERGENCY SERVICES IN ACCORDANCE WITH THE IMMEDIATELY PRECEDING PARAGRAPH.

The GNU GPL license terms are incorporated into the device firmware and can be accessed via the Web user interface of the device at `my_device_ip/gpl_license`. It can also be accessed here:

<https://www.grandstream.com/legal/open-source-software>

To obtain a CD with GPL source code information please submit a written request to info@grandstream.com

PRECAUTIONS

- Do not attempt to open, disassemble, or modify the device.
- Do not expose this device to temperatures outside range of 0 °C to 40 °C in operation and -10 °C to 60 °C in storage.
- Do not expose the GSC3574/3575 to environments outside of the following humidity range: 10-90% RH (non-condensing).
- Do not power cycle your GSC3574/3575 during system boot-up or firmware upgrade. You may corrupt firmware images and cause the unit to malfunction.

OVERVIEW

The GSC3574/3575 is a powerful intercom and facility control station designed to provide businesses with a dedicated device to manage facility communications, door access, physical security, and more. This device can be wall-mounted as a solution for easy door control, intercom, and paging communication, security camera

management, and facility-wide UC integration. The GSC3574/3575 features a 7-inch touchscreen LCD and full duplex 2-way HD audio. It offers flexible network connectivity through a 100Mbps network port with PoE or integrated dual-band Wi-Fi 6 support. This SIP intercom and facility control station is designed to seamlessly integrate with Grandstream's entire range of products, including the GDS series of door access devices, GSC series intercom and paging devices, security cameras, and more. The GSC3574/3575 is ideal for any deployment scenario where facility access, communications, and security need to be centrally monitored and controlled.

PACKAGE CONTENTS

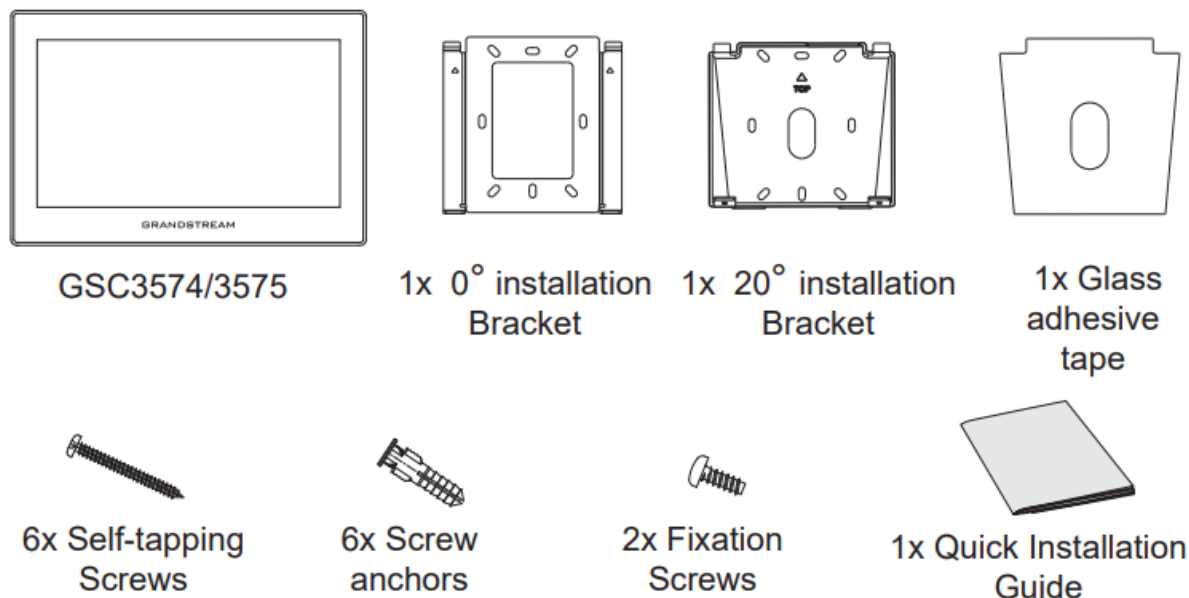

GSC3574/3575 SETUP

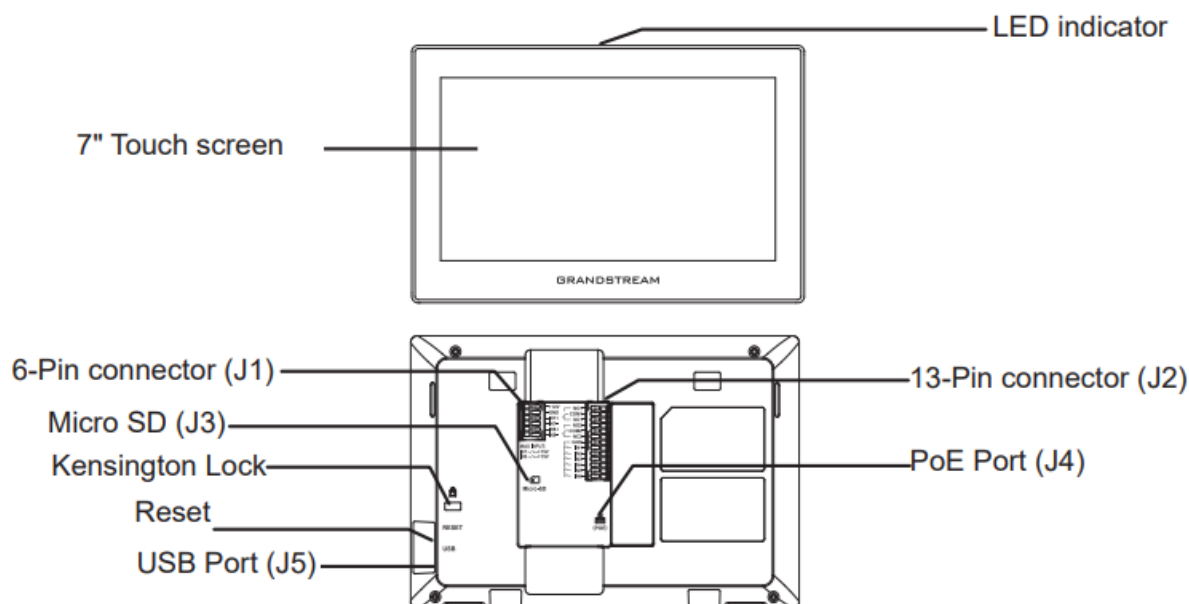

DEVICE INSTALLATION

- The GSC3574/3575 can be mounted on the wall, the glass, or on the desktop using a 20 ° bracket.
- Please refer to the following steps for installation:

On-Wall 0° Mount

1. Drill six holes on the wall referring to the positions of the ones on the 0° installation bracket, then put the screw

anchors on the position of the holes.

2. Fix the 0° installation bracket on the wall with the self-tapping screws on the positions defined.
3. Make sure the 0° installation bracket is installed properly as shown in the illustration.
4. Plug in the cables to the proper GSC3574/3575 ports on the back, and fix the 0° installation bracket with the GSC3575/74 device using the two fixation screws from the bottom of the device.
5. Align the position slots on the device's back with their correct placement on the metal bracket, then fix it by pushing it down.

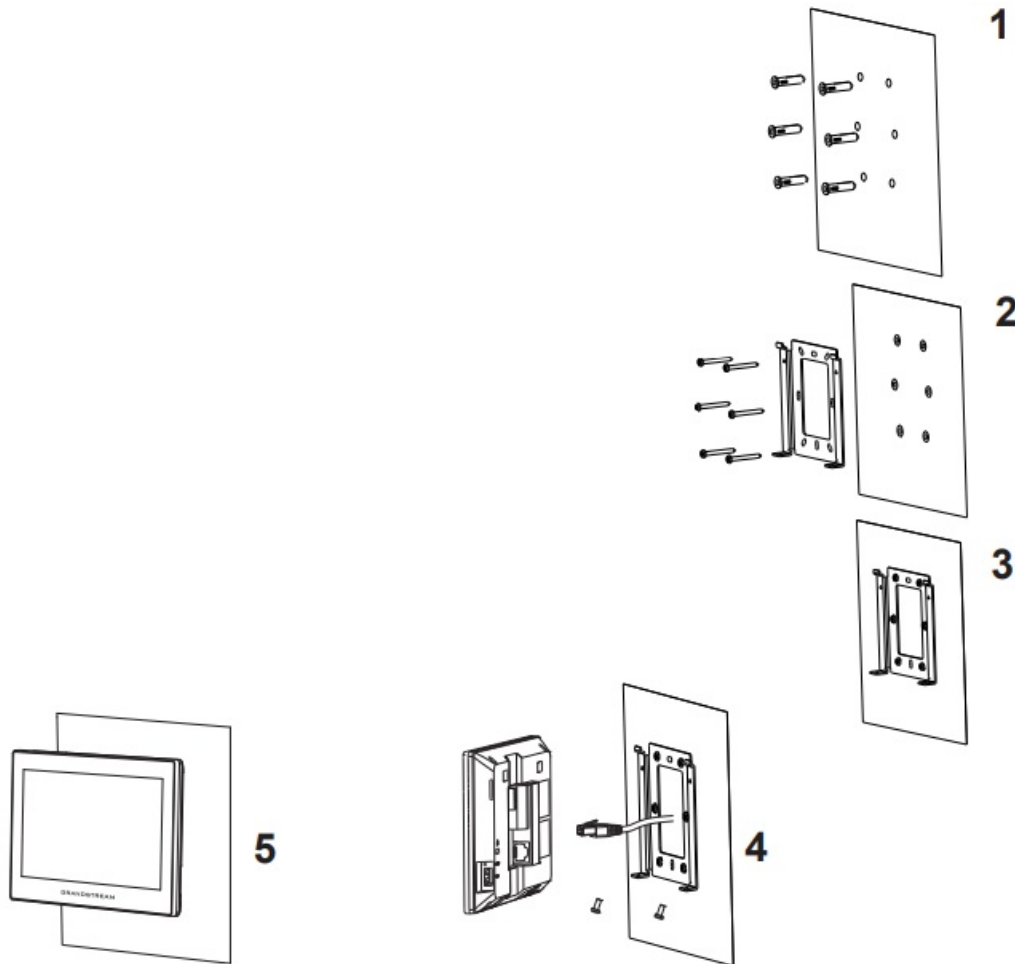

On-Wall 20° Mount

1. Drill six holes on the wall referring to the positions of the ones on the 20° installation bracket, then put the screw anchors on the position of the holes.
2. Fix the 20° installation bracket on the wall with the self-tapping screws on the positions defined.
3. Make sure the 20° installation bracket is installed properly as shown in the illustration.
4. Plug in the cables to the proper GSC3574/75 ports on the back, and fix the 20° installation bracket with the GSC3575/74 device using the two fixation screws from the bottom of the device.
5. Align the position slots on the device's back with their correct placement on the 20° installation bracket, then fix it by pushing down.

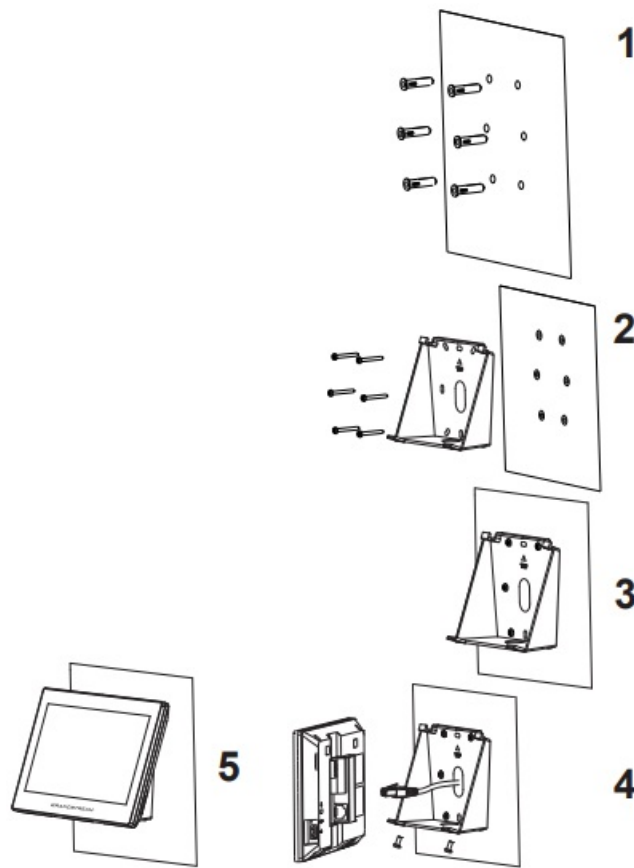

On-Wall Glass Adhesive Mount

1. Clean the glass before installation
2. Stick the Glass Adhesive tape to the 20° installation bracket.
3. Install the 20° installation bracket with its glass adhesive tape on the glass.
4. After installing with double-sided adhesive, please use additional adhesive to fix the equipment.
5. Plug in the cables to the proper GSC3574/75 ports, and fix the 20° installation bracket with the GSC3575/74 device using the two fixation screws.
6. Align the position slots on the device's back with their correct placement on the 20° installation bracket, then fix it by pushing down.

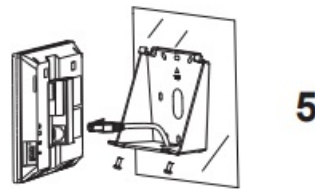
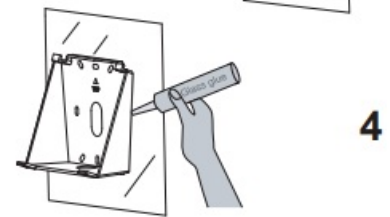
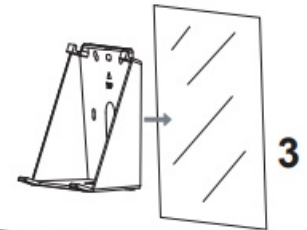
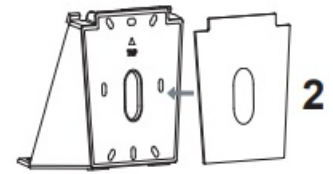
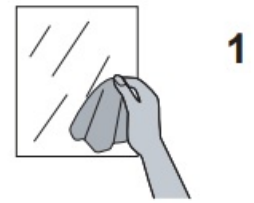

GSC3574/3575 PORTS

Jack	Port		Function	Remark	
	Pin	Signal			
J1	1	IN8-	Alarm IN8(Active)	Isolation type alarm input, used for voltage signal detection, IN+ connected to positive signal output of sensor, IN- connected to negative signal output of sensor or GND of sensor. The active voltage range is 9-15V.	
	2	IN8+			
	3	IN7-	Alarm IN7 (Active)		
	4	IN7+			
	5	GND	Power Supply		DC12V recommend, input voltage rang 11-13V, current at least 1.5A@12V
	6	+12V			
J2	1	NO1	Alarm OUT1	Relay output, normal open or close, max 125VAC/0.5A or max 30VDC/2A	
	2	COM1			
	3	NC1			
	4	NO2	Alarm OUT2		
	5	COM2			
	6	NC2			
	7	GND	Alarm IN GND	Voltage reference for IN (1/2/3/4/5/6)	
	8	IN1	Alarm IN1(Passive)	Alarm input, used to connect devices such as buttons/ switches/ alarm sensors.	
	9	IN2	Alarm IN2(Passive)		
	10	IN3	Alarm IN3(Passive)		
	11	IN4	Alarm IN4(Passive)		
	12	IN5	Alarm IN5(Passive)		
	13	IN6	Alarm IN6(Passive)		
J3	Micro-SD Port		Data Storage	Support microSD/SDHC/SDXC, up to 512G	
J4	Network Port (PoE)		Ethernet & PoE Supply	Single 10/100 Mbps Network port, support 802.3 af POE power supply	
J5	USB Port		Data Exchange (USB 2.0)	The USB port can be connected to USB disk (up to 2TB) / mouse/ keyboard. The default current limit is 460mA, and user can configure it to 1000mA through the web.	

CONFIGURATION

GSC3574/3575 CONFIGURATION

Configure the GSC3574/3575 Using a Web Browser

1. Ensure your device is powered up and connected to the Internet.
2. Press “Settings” on the Home Page.
3. Select “Network Status” to check the IP address.
4. Type the unit’s IP address in your PC browser. (See figure below).
5. Enter the admin’s username and password to access the configuration menu.

(The factory default username is “admin” while the default random password can be found on the sticker at the back of the unit).



Refer to online documents and FAQ for more detailed information: <https://www.grandstream.com/our-products>

- For certification information, please refer to User Manuals: www.grandstream.com

For Certification, Warranty, and RMA information, please visit www.grandstream.com

Common part

- This equipment complies with radiation exposure limits set forth for an uncontrolled environment.
- This transmitter must not be co-located or operating in conjunction with any other antenna or transmitter.
- This equipment should be installed and operated with a minimum distance of 20cm between the radiator& your body.

FCC STATEMENT

U.S. FCC Part 15 Regulatory Information

This device complies with part 15 of the FCC Rules. Operation is subject to the following two conditions:

1. this device may not cause harmful interference, and
2. this device must accept any interference received, including interference that may cause undesired operation.

Any Changes or modifications not expressly approved by the party responsible for compliance could void the user's authority to operate the equipment.

Note: This equipment has been tested and found to comply with the limits for a Class B digital device, according to part 15 of the FCC Rules.

These limits are designed to provide reasonable protection against harmful interference in a residential installation. This equipment generates, uses, and can radiate radio frequency energy and, if not installed and used under the instructions, may cause harmful interference to radio communications. However, there is no guarantee that interference will not occur in a particular installation. If this equipment does cause harmful interference to radio or television reception, which can be determined by turning the equipment off and on, the user is encouraged to try to correct the interference by one or more of the following measures:

- Reorient or relocate the receiving antenna.
- Increase the separation between the equipment and the receiver.
- Connect the equipment to an outlet on a circuit different from that to which the receiver is connected.
- Consult the dealer or an experienced radio/TV technician for help.

The device for operation in the band 5150–5250 MHz is only for indoor use to reduce the potential for harmful interference to co-channel mobile satellite systems

Canada Regulatory Information Radio equipment

Operation of 5150-5250 MHz is restricted to indoor use only.

This device contains license-exempt transmitter(s)/receiver(s) that comply with Innovation, Science, and Economic Development Canada's license-exempt RSS(s). Operation is subject to the following two conditions:

1. This device may not cause interference.
2. This device must accept any interference, including interference that may cause undesired operation of the

device.

EU Regulatory Information

- Operation of 5150-5350 MHz is restricted to indoor use only.
- Support Frequency Bands and Power:
- BT/BLE 2402-2480 MHz < 10 dBm;
- WLAN 2412-2472 MHz < 20 dBm;
- WLAN 5150-5250 MHz < 22 dBm;
- WLAN 5250-5350 MHz < 19 dBm;
- WLAN 5470-5725MHz < 19 dBm;
- WLAN 5725-5850 MHz < 14 dBm;

The simplified EU declaration of conformity referred to in Article 10(9) shall be provided as follows:

- Hereby, [Grandstream Networks, Inc.] declares that the radio equipment type [GSC3574-GSC3575] complies with Directive 2014/53/EU.
- The full text of the EU Declaration of Conformity is available at the following internet address:
www.grandstream.com
- UK Regulatory Information
- Operation of 5150-5350 MHz is restricted to indoor use only.
- Support Frequency Bands and Power:
- BT/BLE 2402-2480 MHz < 10 dBm;
- WLAN 2412-2472 MHz < 20 dBm;
- WLAN 5150-5250 MHz < 22 dBm;
- WLAN 5250-5350 MHz < 19 dBm;
- WLAN 5470-5725MHz < 19 dBm;
- WLAN 5725-5850 MHz < 14 dBm;

The simplified UK declaration of conformity referred to in Regulation 8& 14 shall be provided as follows:

Hereby, [Grandstream Networks, Inc.] declares that the radio equipment type [GSC3574-GSC3575] complies with Directive RER 2017 (S.I.2017/1206).

The full text of the UK Declaration of Conformity is available at the following internet address:

www.grandstream.com

Documents / Resources

	<p>GRANDSTREAM GSC3575 HD Intercom [pdf] User Manual YZZGSC3575, YZZGSC3575, gsc3575, GSC3575 HD Intercom, GSC3575, HD Intercom, Intercom</p>
-------------------------------------------------------------------------------------	-------------------------------------------------------------------------------------------------------------------------------------------------------------------

References

- [User Manual](#)

Manuals+ Privacy Policy

This website is an independent publication and is neither affiliated with nor endorsed by any of the trademark owners. The "Bluetooth®" word mark and logos are registered trademarks owned by Bluetooth SIG, Inc. The "Wi-Fi®" word mark and logos are registered trademarks owned by the Wi-Fi Alliance. Any use of these marks on this website does not imply any affiliation with or endorsement.