



GRANDSTREAM GCC6010,GCC6011 SMB UC Networking Convergence Wired Gateway Installation Guide

[Home](#) » [GRANDSTREAM](#) » GRANDSTREAM GCC6010,GCC6011 SMB UC Networking Convergence Wired Gateway Installation Guide 



GCC6010/GCC6011 SMB UC/Networking Convergence Wired Gateway



Quick Installation Guide

Contents

- 1 PACKAGE CONTENT
- 2 GCC6010/6011 PORTS
- 3 CONNECTING THE GCC6010/6011
- 4 MOUNTING GCC6010/6011 TO THE WALL
- 5 INSTALL ON A 19" STANDARD RACK (GCC6011)
- 6 GROUNDING THE DEVICE
- 7 SSD INSTALLATION (GCC6011)
- 8 Documents / Resources
 - 8.1 References

PACKAGE CONTENT



GCC6010/GCC6011

GCC6011 SSD Installation

 2x Screws

 1x Nut

GCC6011

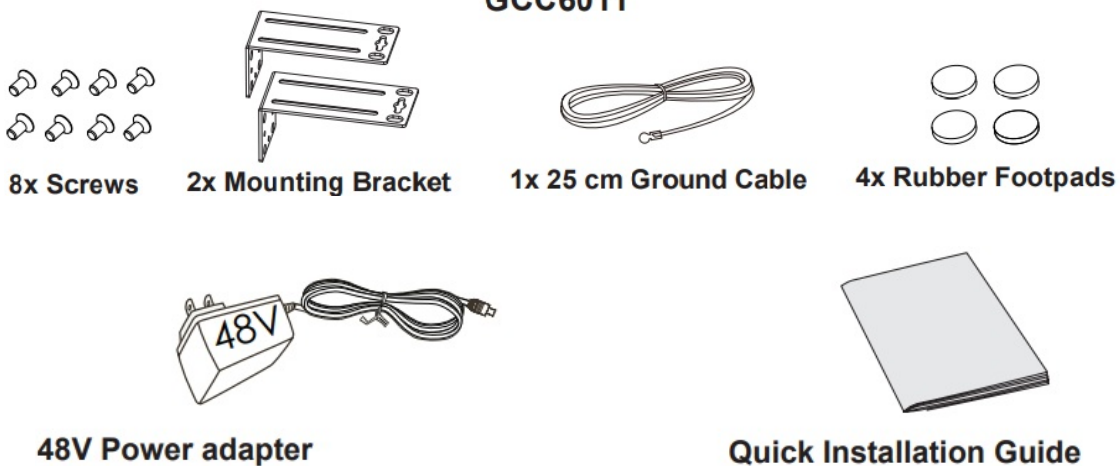

GCC6010/6011 PORTS

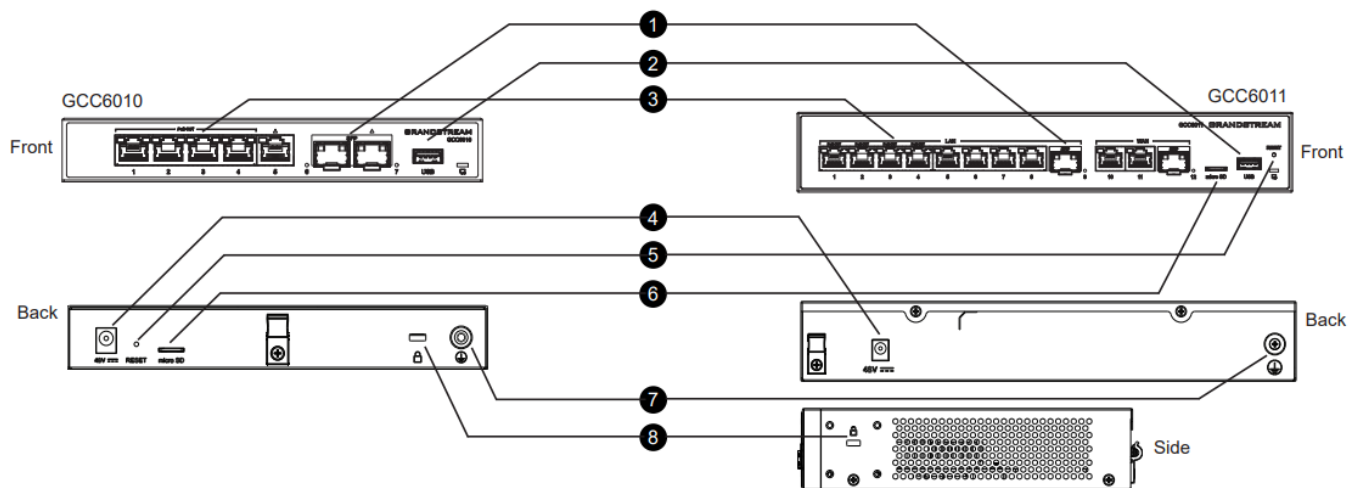

1	2.5G SFP Port
2	USB 3.0 Port
3	Ethernet Port
4	DC48V
5	RESET
6	Micro SD
7	Grounding terminal
8	Kensington Lock

CONNECTING THE GCC6010/6011

GCC6010:

Ports with this symbol are configured to be used as a WAN port by default at the factory.

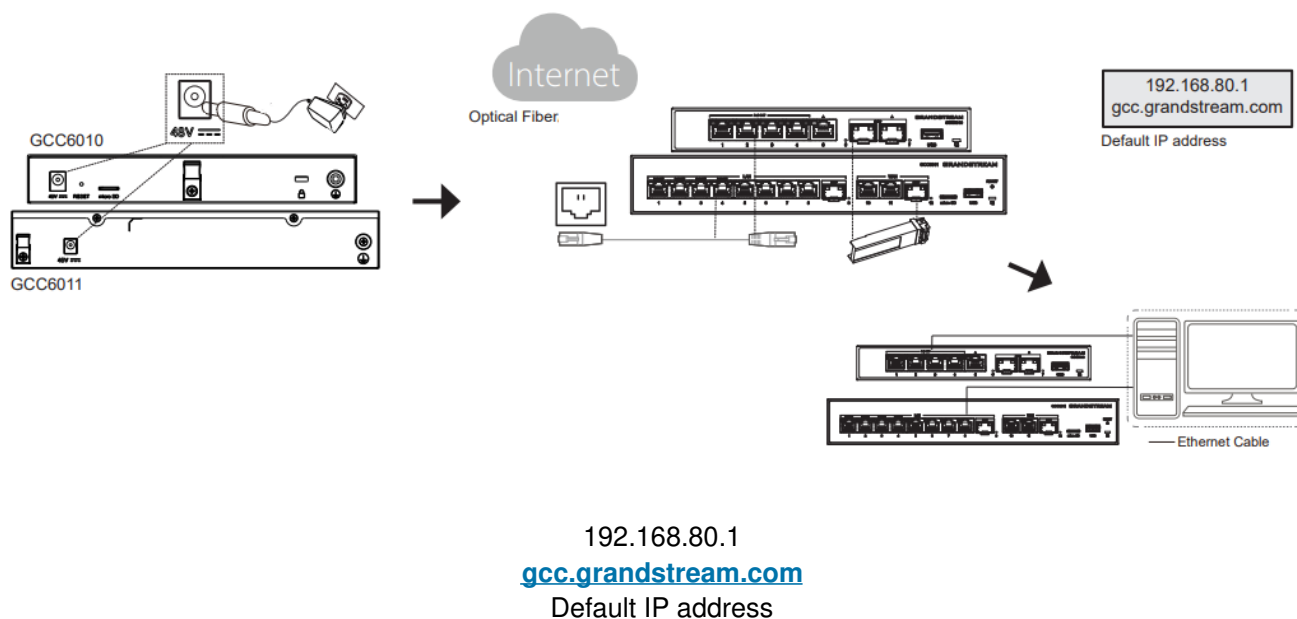

The default password information is printed on the MAC label on the bottom of the unit. The default username is "admin".

MOUNTING GCC6010/6011 TO THE WALL

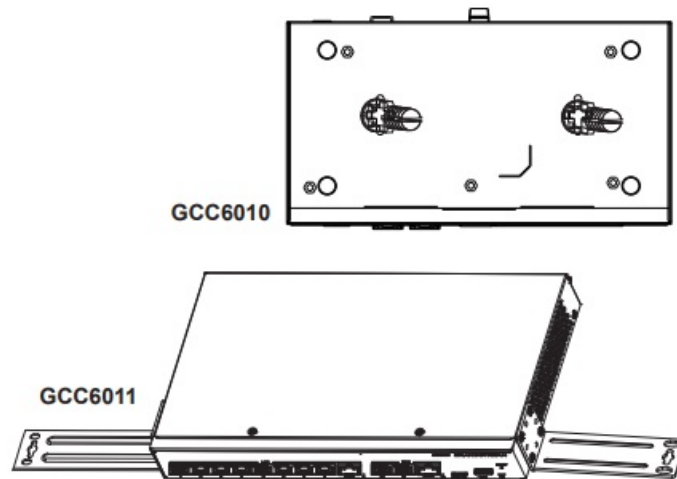

INSTALL ON A 19" STANDARD RACK (GCC6011)

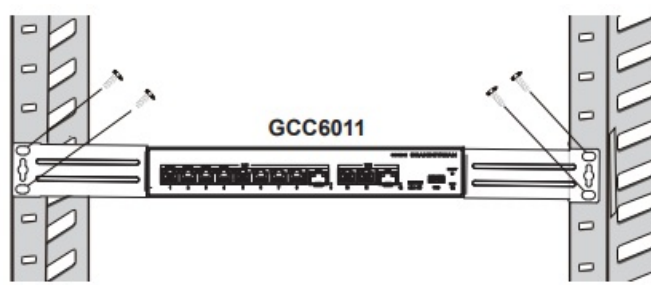

GROUNDING THE DEVICE

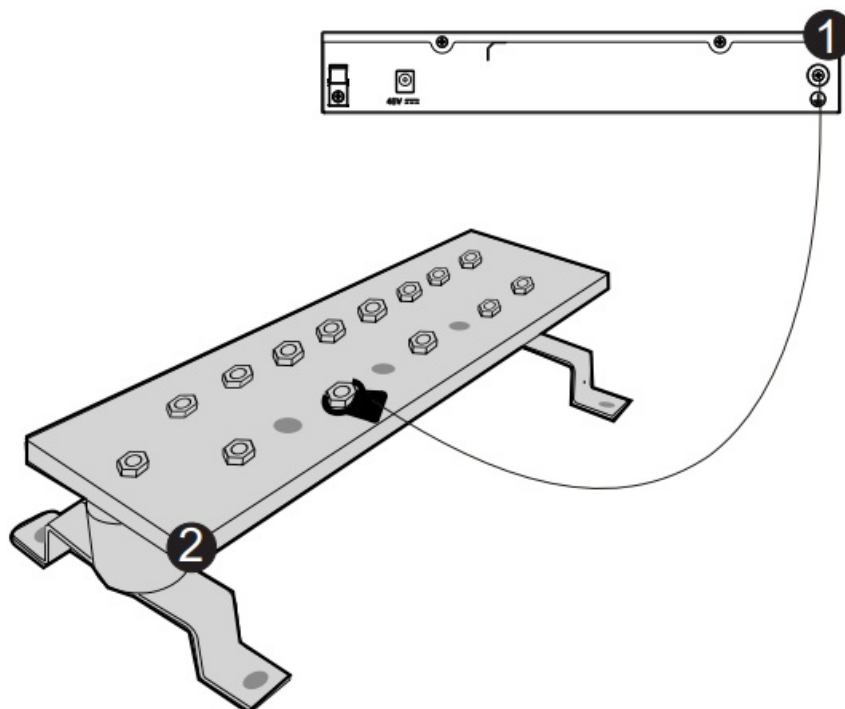

1. Ground Terminal
2. Ground Bar

SSD INSTALLATION (GCC6011)

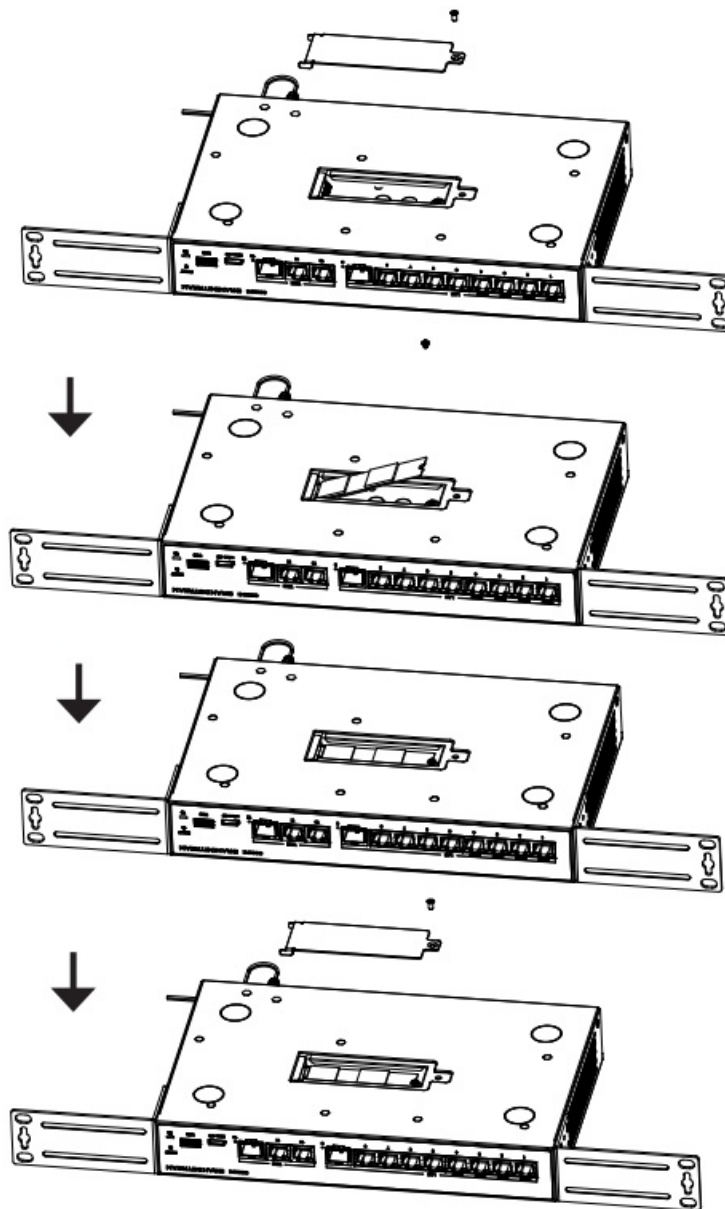

The GCC6010/GCC6011 is not pre-configured to support or make emergency calls to any type of hospital, law enforcement agency, medical care unit ("Emergency Service(s)") or any other kind of Emergency Service. You must make additional arrangements to access Emergency Services. It is your responsibility to purchase SIP-compliant Internet telephone service, properly configure the GCC6010/ GCC6011 to use that service, and periodically test your configuration to confirm that it works as you expect. It is also your responsibility to purchase traditional wireless or landline telephone services to access Emergency Services.

GRANDSTREAM DOES NOT PROVIDE CONNECTIONS TO EMERGENCY SERVICES VIA THE GCC6010/GCC6011. NEITHER GRANDSTREAM NOR ITS OFFICES, EMPLOYEES OR AFFILIATES MAY BE HELD LIABLE FOR ANY CLAIM, DAMAGE, OR LOSS, AND YOU HEREBY WAIVE ANY AND ALL SUCH CLAIMS OR CAUSES OF ACTION ARISING FROM OR RELATING TO YOUR INABILITY TO USE THE GCC6010/GCC6011 TO CONTACT EMERGENCY SERVICES, AND YOUR FAILURE TO MAKE ADDITIONAL ARRANGEMENTS TO ACCESS EMERGENCY SERVICES IN ACCORDANCE WITH THE IMMEDIATELY PRECEDING PARAGRAPH.

The GNU GPL license terms are incorporated into the device firmware and can be accessed via the Web user interface of the device at `my_device_ip/gpl_license`. It can also be accessed here: <https://www.grandstream.com/legal/open-source-software>

To obtain a CD with GPL source code information please submit a written request to info@grandstream.com

Grandstream Networks, Inc.

126 Brookline Ave, 3rd Floor

Boston, MA 02215. USA

Tel : +1 (617) 566 – 9300

www.grandstream.com



Documents / Resources

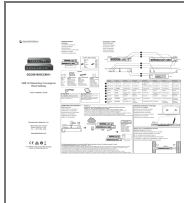

[GRANDSTREAM GCC6010,GCC6011 SMB UC Networking Convergence Wired Gateway](#) [pdf] Installation Guide
GCC6010 GCC6011, GCC6010 GCC6011 SMB UC Networking Convergence Wired Gateway, SMB UC Networking Convergence Wired Gateway, Networking Convergence Wired Gateway, Convergence Wired Gateway, Wired Gateway, Gateway

References

- [Grandstream Networks - Networking & Unified Communications](#)
- [Grandstream Networks - Networking & Unified Communications](#)
- [User Manual](#)

[Manuals+](#), [Privacy Policy](#)

This website is an independent publication and is neither affiliated with nor endorsed by any of the trademark owners. The "Bluetooth®" word mark and logos are registered trademarks owned by Bluetooth SIG, Inc. The "Wi-Fi®" word mark and logos are registered trademarks owned by the Wi-Fi Alliance. Any use of these marks on this website does not imply any affiliation with or endorsement.