



Turn2Me i-Size R129 Child Restraint



GRACO Turn2Me i-Size R129 Child Restraint Owner's Manual

[Home](#) » [Graco](#) » GRACO Turn2Me i-Size R129 Child Restraint Owner's Manual 

Contents

- [1 GRACO Turn2Me i-Size R129 Child Restraint](#)
- [2 Product Specifications](#)
- [3 Product Usage Instructions](#)
- [4 FAQs](#)
- [5 PARTS DESCRIPTION](#)
- [6 Care and Maintenance](#)
- [7 Product Information](#)
- [8 Concerns on Installation](#)
- [9 CONTACT INFORMATION](#)
- [10 Documents / Resources](#)
 - [10.1 References](#)
- [11 Related Posts](#)



GRACO Turn2Me i-Size R129 Child Restraint



Product Specifications

- **Product Name:** Turn2Me™ i-Size R129
- **Regulation:** UN Regulation No. 129
- **Child Height (Rearward Facing):** 40cm – 105cm
- **Child Weight (Rearward Facing):** Up to 19.5kg
- **Child Height (Forward Facing):** 76cm – 105cm
- **Child Weight (Forward Facing):** Up to 19.5kg

Product Usage Instructions

- **Important Safety Instructions:**
 - READ THESE INSTRUCTIONS CAREFULLY BEFORE USE AND KEEP THEM FOR FUTURE REFERENCE. YOUR CHILD'S SAFETY MAY BE AFFECTED IF YOU DO NOT FOLLOW THESE INSTRUCTIONS.
- **Warnings:**
 - BE cautious that the rigid items and plastic parts of the enhanced child restraint system shall be so located and installed that they are not liable to become trapped by a movable seat or in the door of the vehicle.
 - DO NOT use the rearward-facing enhanced child restraint systems in seating positions where there is an

active frontal airbag installed.

- **Child Requirements:**

- Rearward Facing: Child height 40cm -105 cm/max. 19.5kg
- Forward Facing: Child height 76cm 105 cm/max. 19.5kg
- **IMPORTANT** – DO NOT USE FORWARD FACING BEFORE THE CHILD'S AGE EXCEEDS 15 MONTHS (Refer to instructions).

- **Installation and Usage:**

- The enhanced child restraint may not fit in all approved vehicles. Please refer to the fitting list on the product website for more details.
- Any support leg should be in contact with the vehicle floor and any straps restraining the child should be adjusted to the child's body. The straps should not be twisted.
- After your child is placed in this enhanced child restraint, the safety belt must be used correctly. Ensure that any lap strap is worn low down so that the pelvis is firmly engaged, shall be stressed.

- **Maintenance and Replacement:**

- This enhanced child restraint should be replaced when it has been subject to violent stresses in an accident. An accident can cause damage to it that you cannot see.

- **Important Notes:**

- Consider the danger of making any alterations or additions to the device without approval of the adequate authority and the danger of not following closely the installation instructions provided by the enhanced child restraint manufacturer.

FAQs

- **Q: Can I use this child restraint system in all vehicles?**

- **A:** The child restraint may not fit in all approved vehicles. Please refer to the fitting list on the product website for more details.

- **Q: When should I replace the child restraint?**

- **A:** The child restraint should be replaced when it has been subject to violent stresses in an accident.

PARTS DESCRIPTION

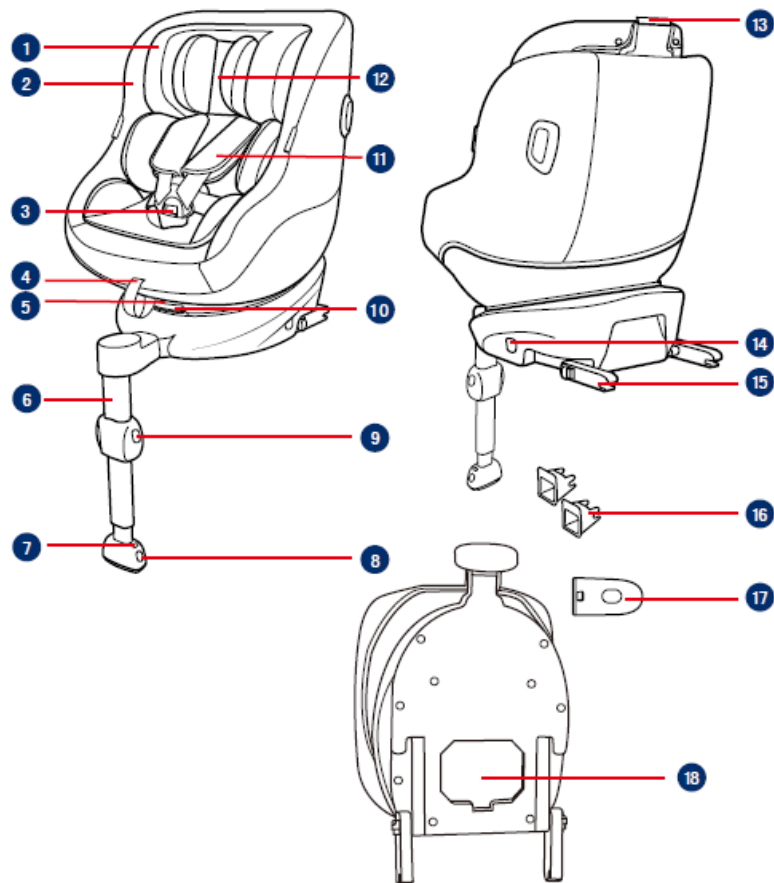

1. Head Support
2. Seat Pad
3. Buckle
4. Adjustment Webbing
5. Recline Adjustment Button
6. Load Leg
7. Load Leg Indicator
8. Load Leg Adjustment Button A
9. Load Leg Adjustment Button B
10. Rotating Button
11. Shoulder Strap Covers
12. Infant Insert
13. Head Support Adjustment Lever
14. ISOFIX Adjuster Button
15. ISOFIX Connector
16. ISOFIX Guides
17. Side Impact Protection
18. Instruction Manual Storage

IMPORTANT SAFETY INSTRUCTIONS

READ THESE INSTRUCTIONS CAREFULLY BEFORE USE AND KEEP THEM FOR FUTURE REFERENCE. YOUR CHILD'S SAFETY MAY BE AFFECTED IF YOU DO NOT FOLLOW THESE INSTRUCTIONS.

WARNING: IMPORTANT, RETAIN FOR FUTURE
REFERENCE: READ CAREFULLY.

- BE cautious that the rigid items and plastic parts of the enhanced child restraint system shall be so located and installed that they are not liable to become trapped by a movable seat or in the door of the vehicle.
- DO NOT use the rearward-facing enhanced child restraint systems in seating positions where there is an active frontal airbag installed.
- To use this enhanced child restraint according to the UN Regulation
- No.129, your child must meet the following requirements.
- **Rearward Facing:** Child height 40cm -105 cm/max. 19.5kg
- **Forward Facing:** Child height 76cm – 105 cm/max. 19.5kg
- **IMPORTANT – DO NOT USE FORWARD FACING BEFORE THE CHILD’S AGE EXCEEDS 15 MONTHS** (Refer to instructions).
- The enhanced child restraint may not fit in all approved vehicles. Please refer to the fitting list on the product website for more details.
- Any support leg should be in contact with the vehicle floor and any straps restraining the child should be adjusted to the child’s body.
- The straps should not be twisted.
- After your child is placed in this enhanced child restraint, the safety belt must be used correctly. Ensure that any lap strap is worn low down so that the pelvis is firmly engaged, and shall be stressed.
- This enhanced child restraint should be replaced when it has been subject to violent stresses in an accident. An accident can cause damage to it that you cannot see.
- Consider the danger of making any alterations or additions to the device without approval of the adequate authority and the danger of not following closely the installation instructions provided by the enhanced child restraint manufacturer.
- Please keep this enhanced child restraint away from sunlight, otherwise it may be too hot for the child’s skin. Always touch the enhanced child restraint before placing a child in it.
- NEVER leave your child unattended with this enhanced child restraint. Any luggage or other objects liable to cause injuries in the event of a collision shall be properly secured.
- The enhanced child restraint system shall NOT BE USED without the soft goods.
- The soft goods should not be replaced with any other than the one recommended by the manufacturer, because the soft goods constitutes an integral part of the restraint performance.
- Please check if this enhanced child restraint can be installed properly in your vehicle before you purchase it.
- NO enhanced child restraint can guarantee full protection from injury in an accident. However, proper use of this enhanced child restraint will reduce the risk of serious injury or death to your child.
- DO NOT install this enhanced child restraint without following the instructions in this manual or you may put your child at serious risk of injury or death. The user shall also be referred to the vehicle manufacturer’s handbook.
- DO NOT use this enhanced child restraint if it has damaged or missing parts.
- DO NOT have your child in large/ oversized clothes because this may prevent your child from being, properly and securely fastened by the shoulder harness straps and the crotch strap between the legs.

Care and Maintenance

- After removing the wedge from the insert please store it somewhere that the child cannot access it.
- Please wash the seat cover and inner padding with cold water under 30°C.
- Do not iron the soft goods.
- Do not bleach or dry clean the soft goods.
- Do not use undiluted detergents gasoline or other organic solvent to wash the child restraint. It may cause damage to the child's restraint.
- Do not wring out the seat cover and inner padding to dry. It may leave the seat cover and inner padding with wrinkles.
- Please hang dry the seat cover and inner padding in the shade.
- Please remove the child restraint and base from the vehicle seat if not in use for a long period. Put the child restraint in a cool, dry place where your child cannot access it.
- Do not tamper with the harness connectors during cleaning.
 - gracobaby.eu.
 - www.gracobaby.pl.

Product Information

1. This is an i-Size Enhanced Child Restraint System. It is approved according to UN Regulation No.129, for use in, i-Size compatible vehicle seating positions as indicated by vehicle manufacturers in the vehicle users' manual.
2. If in doubt, consult either the Enhanced Child Restraint System manufacturer or the retailer.
 - **Materials** Plastics, metal, fabrics
 - **Patent No.** Patents pending

Concerns on Installation

See images 1 – 3



- 1 DO NOT install this child restraint on vehicle seats that face sideways or rearward for the moving direction of the vehicle. It is recommended to install this child restraint on the rear vehicle seat. DO NOT install this child

restraint on vehicle seats movable during installation.

- 2 DO NOT place rear-facing child restraint on the front seat with airbag, because death or serious injury may occur. Please reference the vehicle owner's manual for more information.
- 3 This child restraint is suitable for vehicle seats with ISOFIX anchor points.

Installation with base See images 4 – 13

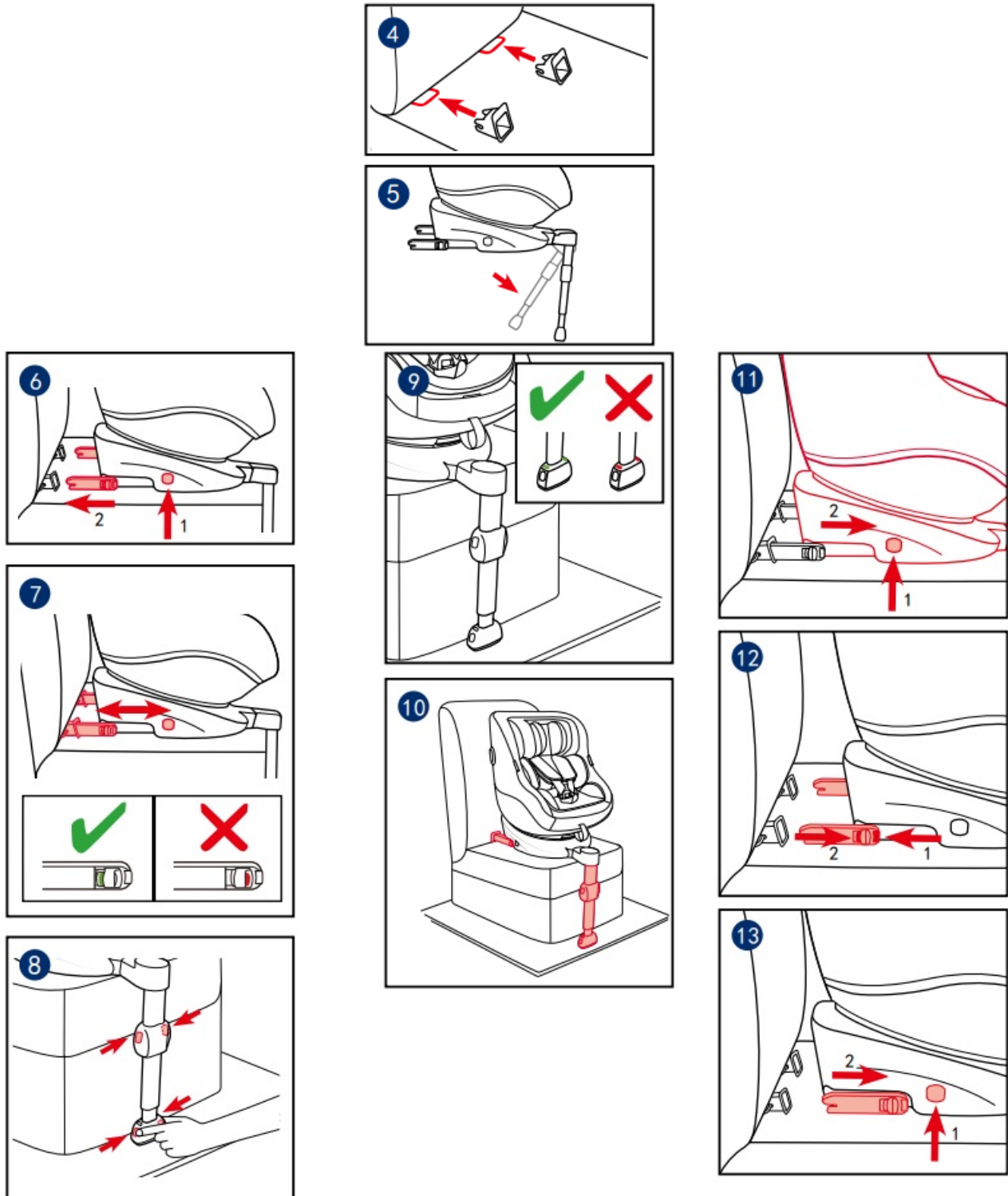

- 4 Fit the ISOFIX guides with the ISOFIX anchor points. The ISOFIX guides can protect the surface of the vehicle seat from being torn. They can also guide the ISOFIX connectors.
- 5 After placing the base on the vehicle seat, pull the load leg downward to the floor.
- 6 There are 10 adjustable positions for ISOFIX. Press the ISOFIX adjuster button to extend the ISOFIX.

- 7 Make sure that both ISOFIX connectors are securely attached to their ISOFIX anchor points. The colors of the indicators on both ISOFIX connectors should be completely green. If a tighter install or increased cabin space is required, then press the ISOFIX adjuster button 6 -1 and push to adjust. 7
- 8 After attaching the ISOFIX, pull the load leg downward to the floor. When the load leg indicator shows green, the load leg is installed correctly. Squeeze the load leg releasing button, then adjust the load leg length. Always make sure the support load leg has direct contact with the floor and is in a locked position even when the child is not in it.
- 9 The load leg has multiple positions. Make sure the load leg is in full contact with the vehicle floor pan. When the load leg indicator shows red this means the load leg is in the wrong position. When the load leg indicator shows green this means the load leg is in the right position.
- 10 Check to make sure the base is securely installed by pulling on both ISOFIX connectors. The ISOFIX connectors must be attached and locked onto the ISOFIX anchor points. The load leg must be installed correctly with green indicator. Please refer to the rear-facing mode and recline positions mode in the section to use the child restraint.
- 11 To remove from the vehicle press the ISOFIX adjuster button and pull the base back from the seat.
- 12 Then press and release the connectors from the vehicle's ISOFIX.
- 13 To prevent damage during transit, press the ISOFIX adjuster button and fold the connector completely.

Recline Adjustment See images 14 15

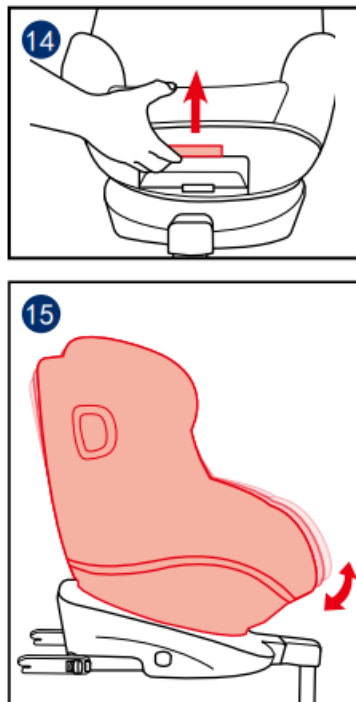

- 14 Squeeze the recline adjustment button, to adjust the child restraint to the proper position. The recline angles are shown as
- 15 . Please recheck the load leg position after reclining. There are 5 recline positions for rear-facing mode and 5 recline positions for forward-facing mode.

Use Side Impact Protection See images 16 17

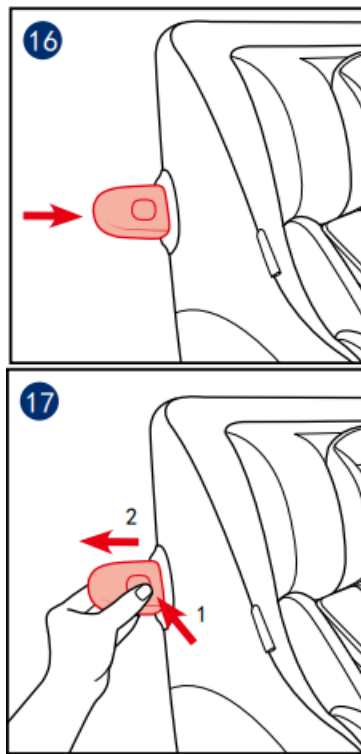

- 16 The enhanced child restraint is delivered with removable side impact protection. This side impact protection must be used on the door side of the vehicle for best protection. Installation is shown in 16.
- 17 Press the release button to remove side impact protection.

Height Adjustment for Head Support and Shoulder Harnesses See images 18 – 20

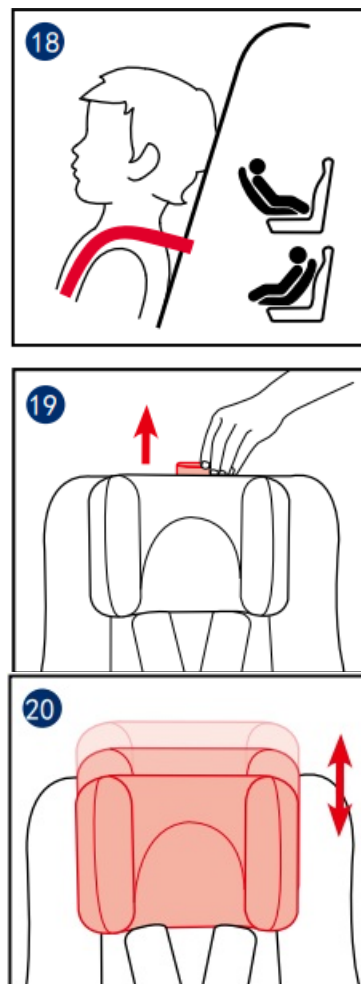

- 18 Please adjust the head support and check if the shoulder harnesses are at the correct height according to 18. When used rear-facing, the shoulder harness height must be even with the child's shoulders. When used forward facing, the shoulder harness height must be even with the child's shoulders.
- 19 Lift up the head support adjustment lever 19, meanwhile pull up or push down on the head support until it snaps into one of the 6 positions.
- 20 The head support positions are shown as 20.

Using in the Rear Facing Mode

(Child height 40cm-105cm/Child weight 19.5kg/infant – 4 years old)

See images 21 – 30

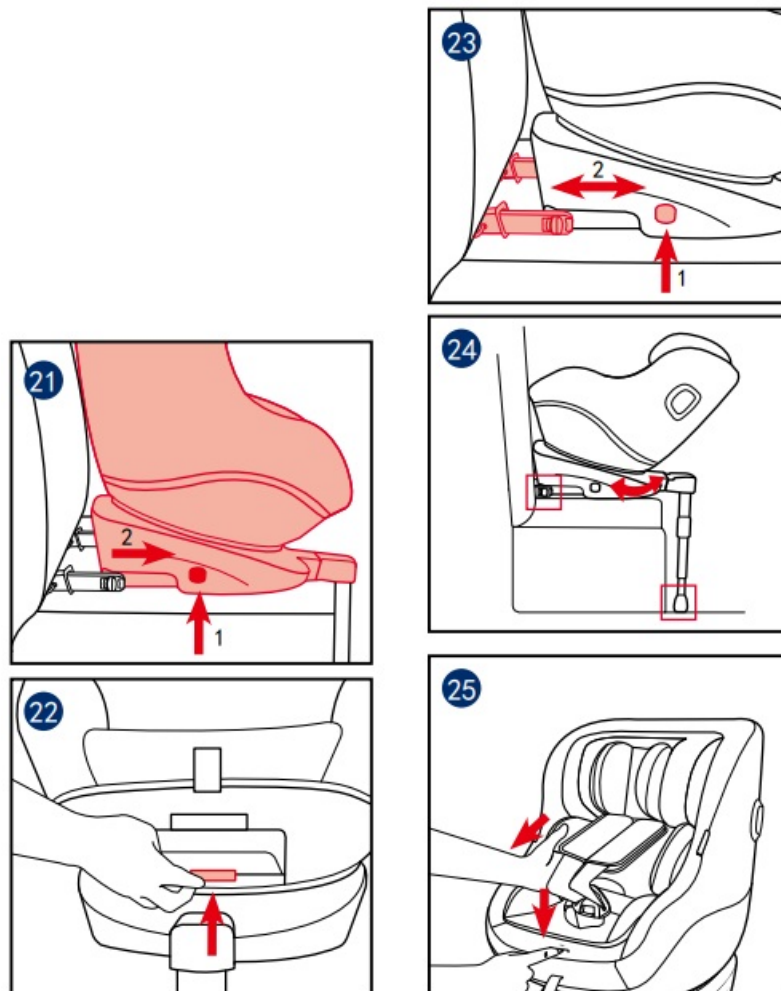

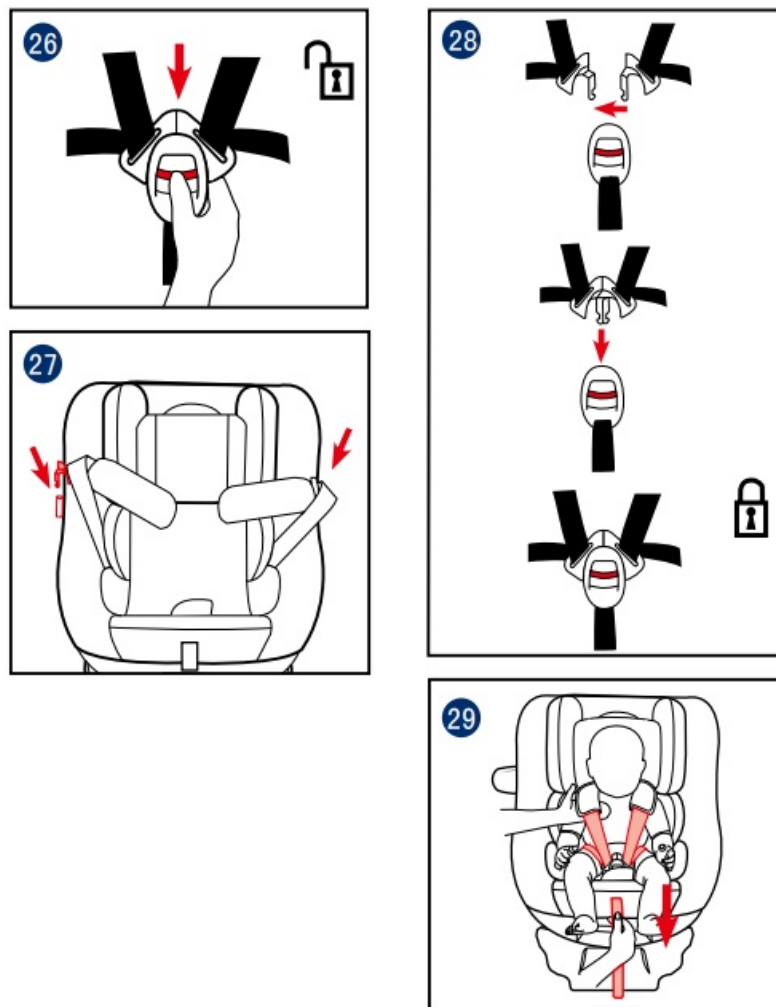

Please install the child restraint on the rear vehicle seat and then put the child in the child restraint.

- 21 Press the ISOFIX adjuster button and pull the base back from the vehicle seat.
- 22 Press the rotating button to rotate for easier side loading/ unloading of the child, then rotate back to the desired direction. Always make sure the seat is in a locked position (rearward facing /forward facing) even when the child is not in it.
- 23 If a tighter install or increased cabin space is required, then press the ISOFIX adjuster button and push to adjust.
- 24 The ISOFIX connectors must be attached and locked onto the ISOFIX anchor points. The load leg must be installed correctly with a green indicator. After the child is placed into the seat, check whether the Shoulder Harness Straps are at proper height.
- 25 Press the webbing adjustment button, while pulling out the shoulder harnesses to the proper length.

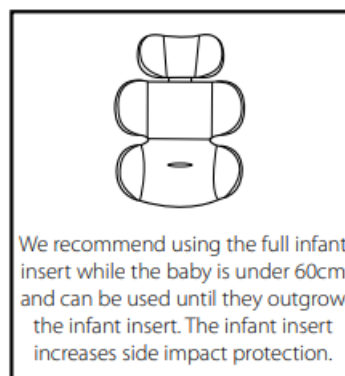

- 26 Unlock the buckle of the harnesses by pressing the red button.
- 27 Fix the buckles on both sides of the seat to make placing the child in rear-facing mode more convenient.

- Use Infant insert is for children's protection.
- Place the child into the child restraint and pass both arms through the harnesses.
- After the child is seated, recheck whether the shoulder harnesses are at the proper height.
- 28 Engage the buckle.
- 29 Pull down the adjustment webbing and adjust it to the proper length to make sure your child is properly secured.
 - Make sure the space between the child and the Shoulder Harness Straps is about the thickness of one hand.
 - If steps 25 26 27 are taken when arriving at your destination whilst removing the child, then the harness will be positioned so that it is out of the way and ready for loading upon your return to the vehicle.

Using in the Forward Facing Mode

(Child height 76cm-105cm/Child weight 19.5kg/ 15 months – 4 years old)

See images 30 – 37

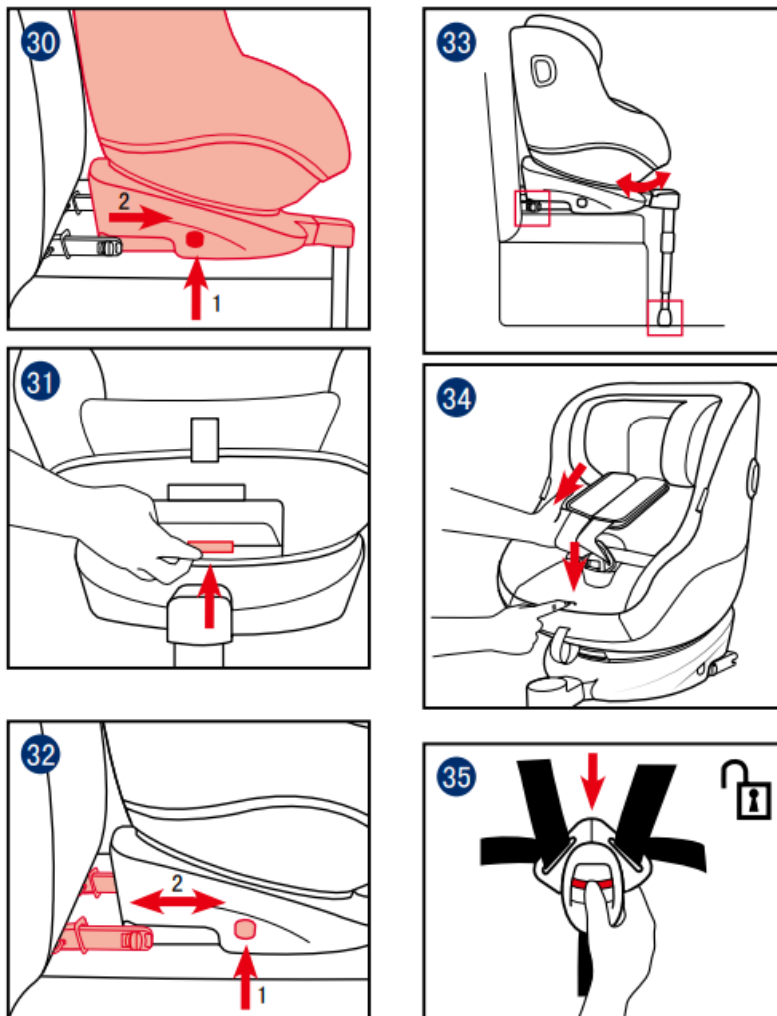



Please install the child restraint on the vehicle seat, and then put the child in the child restraint.

- 30 Press the ISOFIX adjuster button and pull the base back from the vehicle seat.
- 31 Press the rotating button to rotate for easier side loading/ unloading of the child, then rotate forward to the desired direction. Always make sure the seat is in the locked position (rearward facing /forward facing) even when the child is not in it.
- 32 If a tighter install or increased cabin space is required, then press the ISOFIX adjuster button and push to adjust.
- 33 The ISOFIX connectors must be attached and locked onto the ISOFIX anchor points. The load leg must be installed correctly with a green indicator. After the child is placed into the seat, check whether the Shoulder Harness Straps are at proper height.
- 34 Press the webbing adjustment button, while pulling out the shoulder harnesses to the proper length.
- 35 Unlock the buckle of the harnesses by pressing the red button.
- 36 Fix the buckles on both sides of the seat to make placing the child in forward-facing mode more convenient.
 - When installing the child restraint in the forward-facing mode, do not use the infant insert.
 - Place the child into the child restraint and pass both arms through the harnesses. Engage the buckle.
 - After the child is seated, recheck whether the shoulder harnesses are at the proper height.
- 37 Pull down the adjustment webbing and adjust it to the proper length to make sure your child is properly secured.
 - Make sure the space between the child and the Shoulder Harness Straps is about the thickness of one hand.
 - If steps 34 35 36 are taken when arriving at your destination whilst removing the child, then the harness will be positioned so that it is out of the way and ready for loading upon your return to the vehicle.

Detach Soft Goods See images 38 – 45

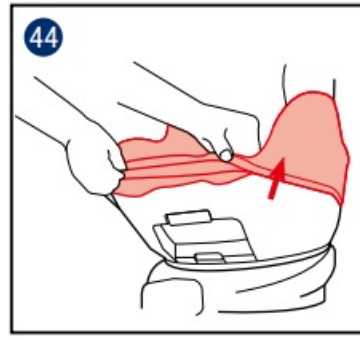
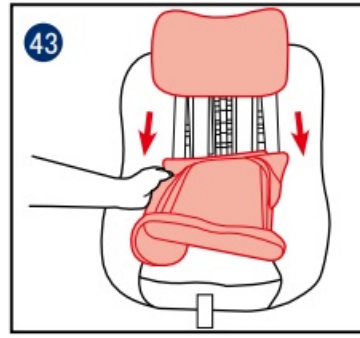
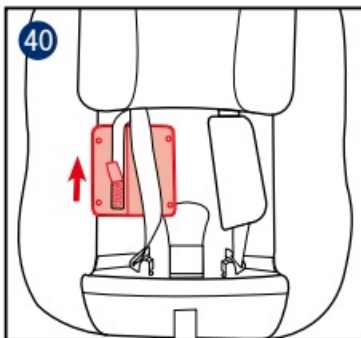
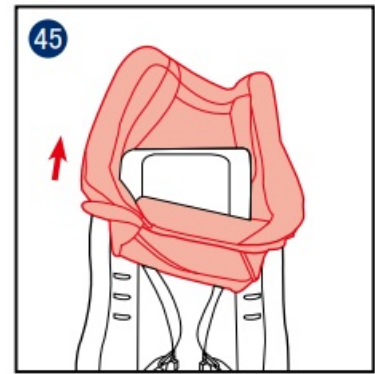
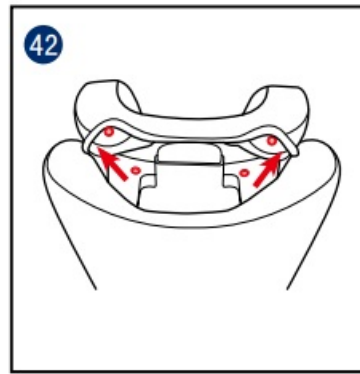
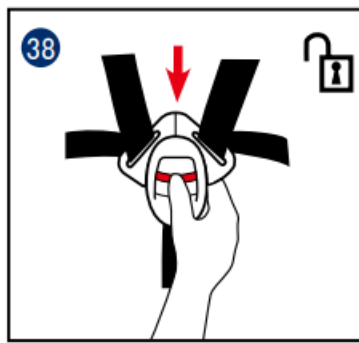

- 38 Press the red button to disengage the buckle.
- Follow steps 39 – 45 to detach soft goods.
- To re-attach the soft goods please repeat the above steps in the reverse step.

IMPORTANT! KEEP FOR FUTURE REFERENCE.

CONTACT INFORMATION

- Allison Baby UK Ltd
- Venture Point, Towers Business Park Rugeley,
- Staffordshire, WS15 1UZ
- NUNA International B.V.
- Van der Valak Boumanweg 178 C,

- 2352 JD Leiderdorp, The Netherlands
- Customer Service
- gracobaby.eu
- www.gracobaby.pl.
- For UK and ROI
- Customerservices.uk@gracobaby.eu
- +44 0800 952 0063

Documents / Resources

	<p>GRACO Turn2Me i-Size R129 Child Restraint [pdf] Owner's Manual IM-001261B, Turn2Me i-Size R129 Child Restraint, Turn2Me, Turn2Me R129 Child Restraint, i-Size R129 Child Restraint, R129 Child Restraint, Restraint, R129 Restraint, Child Restraint</p>
---	---

References

- [G Graco Baby EU: Car Seats, Strollers, & Gear For Your Child | Graco Baby](#)
- [User Manual](#)

Manuals+, Privacy Policy

This website is an independent publication and is neither affiliated with nor endorsed by any of the trademark owners. The "Bluetooth®" word mark and logos are registered trademarks owned by Bluetooth SIG, Inc. The "Wi-Fi®" word mark and logos are registered trademarks owned by the Wi-Fi Alliance. Any use of these marks on this website does not imply any affiliation with or endorsement.