



Govee H6602 AI Sync Box with Monitor Backlight User Manual

[Home](#) » [Govee](#) » Govee H6602 AI Sync Box with Monitor Backlight User Manual 

Contents

- [1 H6602 AI Sync Box with Monitor Backlight](#)
- [2 Safety Instructions](#)
- [3 Installing Your Device](#)
- [4 Specifications](#)
- [5 Troubleshooting](#)
- [6 FCC and ISED Canada Statement](#)
- [7 Documents / Resources](#)
 - [7.1 References](#)
- [8 Related Posts](#)



H6602 AI Sync Box with Monitor Backlight



Safety Instructions

Read and follow all the safety instructions

- This product is not waterproof. Avoid exposing its components to splashes, water drops, or every high-humidity environments.
- Be careful of static electricity during installation and usage and keep away from sharp objects and strong corrosive chemicals.
- When bending the light strip during installation, avoid folding its component as this may affect its service life.
- Should be replace sources cannot be replaced. If they sustain damage, the product
- External dimmers cannot be used with this product.
- Avoid installing the light bars near potentially dangerous sources (e.g., candles, liquid-filled objects.)

Introduction

- Thanks for choosing Govee AI Gaming Sync Box with Backlight. This product adopts the HDMI color picking technique to achieve accurate synchronization of light colors without being affected by ambient lights. It supports a refresh rate up to 60Hz for 4K 144Hz for 2K, and 240Hz for 1080P.

What You Get

Sync Box	1
Light Strip	1
Power Adapter	1
HDMI Cable	2
Mounting Clips	10
User Manual	1
Service Card	1

At a Glance

Front View:

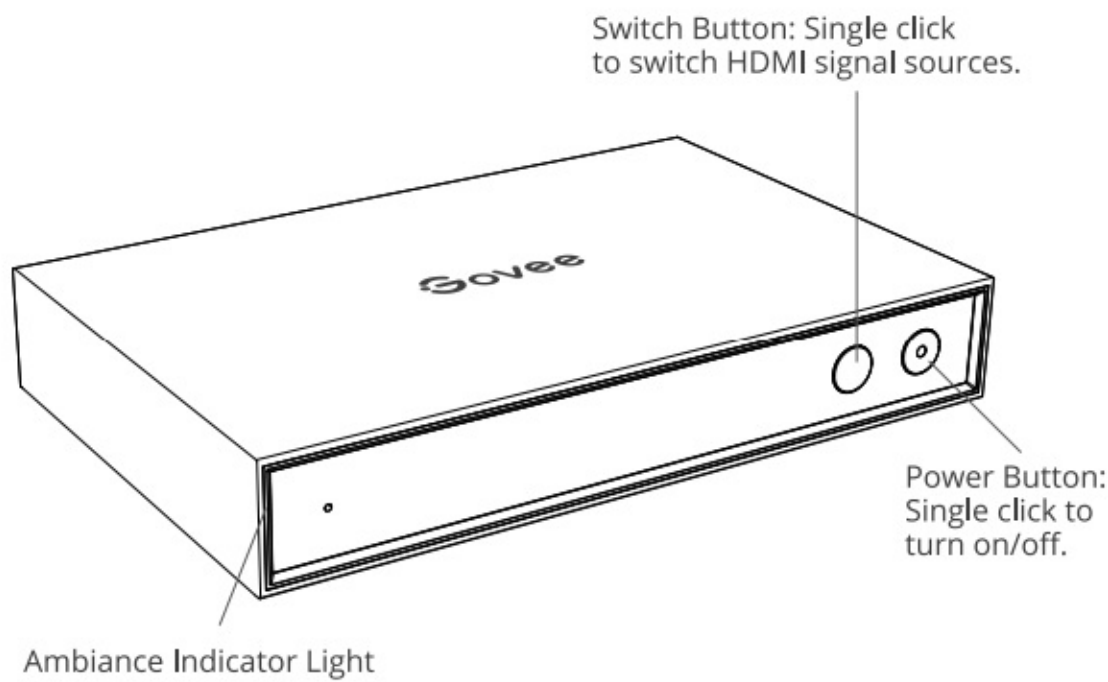

Rear View

Rear View:

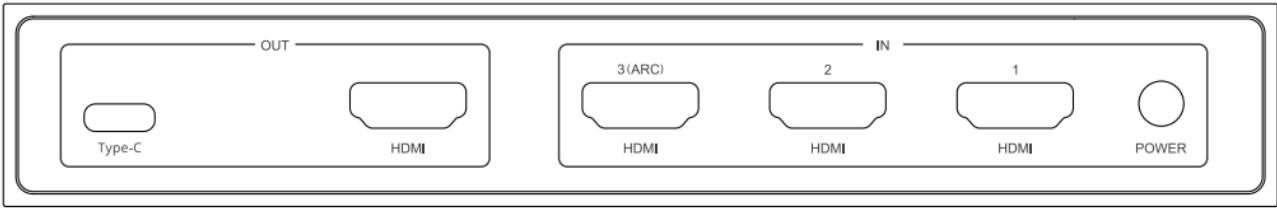

OUT Zone	Type-C	Type-C: Plug in the strip light.
	HDMI	Output signals to the monitor or TV.
IN Zone	HDMI	Connect to HDMI signal sources like PC host, internet TV set-top box, etc.
	POWER	Connect to power.

Installing Your Device

1. Preparation Before Installing

- Unbox the strip lights and check all items listed in the packing list.
- Power on the strip lights and check whether they light up.

2. Installing Steps

- Wipe the installation surface to ensure it is dry and clean.

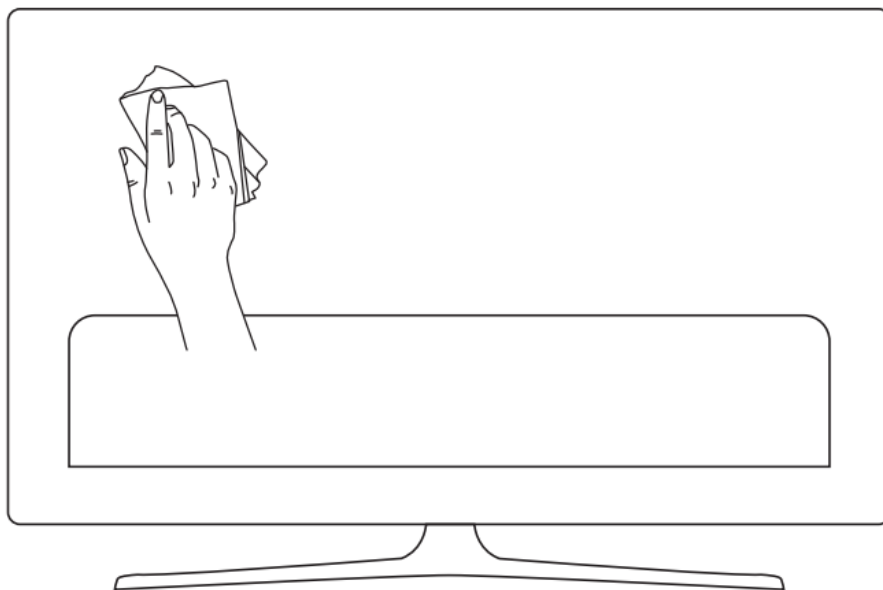

- Stick the strip lights to the back of the TV. Press them firmly and then reinforce them with the provided clips.

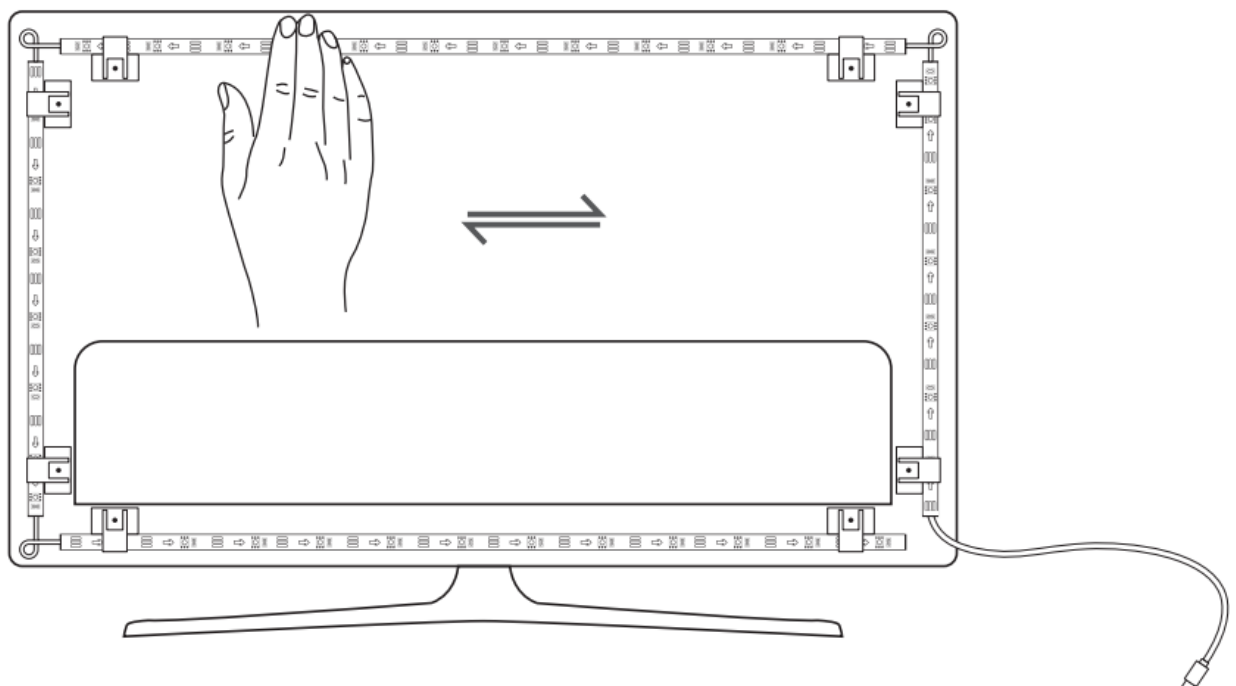

3. Connect the light strip to the Type-C ports on the Govee AI Gaming Sync Box.

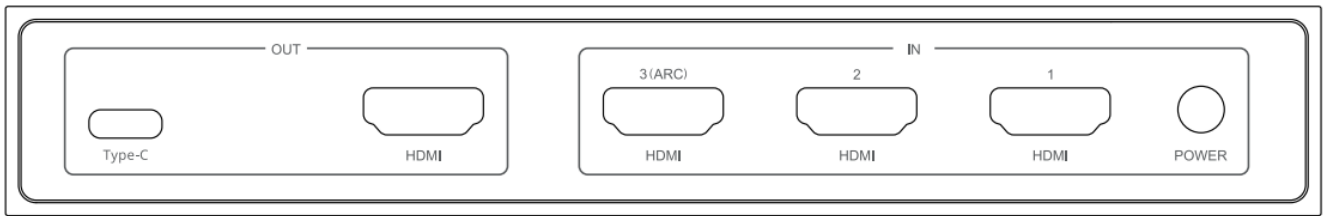

4. Connect one end of an HDMI cable to any port in the IN area, and the other to an HDMI input device (such as your game console, or computer). Only port 3 supports the ARC function
5. Connect one end of an HDMI cable to the HDMI port in the OUT area and the other to your monitor or TV.
6. Connect the adapter to the POWER port, the device will start to work after the power on.

Pairing Your Device with the Govee Home App

What you need

- A Wi-Fi router supporting the 2.4GHz and 802.11 b/g/n bands. 5GHz is not supported.

1. Download the Govee Home app from the App Store (iOS devices) or Google Play (Android devices).



2. Turn on the Bluetooth in your smartphone.
3. Open the app, tap the + icon in the top right corner and search “H6602”.
4. Tap the device icon and follow the onscreen instructions to complete pairing.

Controlling the Device with Your Voice

1. Open the app, then tap the device icon to enter detail page.
2. Tap the setting icon in the top right corner.
3. Select Using Guidance and follow on-screen instructions to control the device using your voice.

Specifications

Power Input (Adapter)	100-240VAC 50/60Hz
Power Input (Control Box)	12VDC 3A(27-34inch)
	12VDC 4A (55-65inch)
	12VDC 5A (75-85inch)
Length	1.8m/5.9ft (27-34inch)
	3.6m/11.8ft (55-65inch)
	5m/16.4ft (75-85inch)
Light Displaying Technology	RGBIC
Control Method	App,Control Box, Voice Control

Troubleshooting

1. The strip lights do not light up.

- Check all wired connections. Unplug and Re-plug the power adapter and the DC port to ensure the control box powers on correctly. The strip lights will light up 1 Os after being powered on.
- Ensure the strip lights are plugged into the LED port before they are powered on.
- If you unplugged the strip lights, reboot the power adapter after the lights are working correctly.

2. The provided adhesives don't stick well.

- Wipe the installation surface to ensure it is dry and clean.
- When attaching the strip lights, ensure you press down firmly.
- Reinforce the strip lights with the provided clips or other strong adhesives.

3. Wi-Fi connection failure

- Do not skip the Wi-Fi connecting step during setup. Ensure you input the correct Wi-Fi name and password according to the app instructions.
- 5GHz Wi-Fi is not supported. Connect the strip lights to a 2.4G Wi-Fi band then reboot your router.
- With your smartphone, check whether the Wi-Fi connection is stable.
- The strip lights are not compatible with the Wi-Fi name or password. Please change the Wi-Fi name and password.
- The strip lights are not compatible with your router. Please try to connect your strip lights to a smartphone hotspot

Customer Service

- **Warranty: 12-Month Limited Warranty**
- **Support:** Lifetime Technical Support
- **Email:** support@govee.com
- **Official Website:** www.govee.com

-  @Govee
-  @govee_official

-  @govee.official
-  @Goveeofficial
-  @Govee.smarthome

For ambiance lighting only.

Not for illumination. This device uses a non-replaceable light source. When the light source reaches the end of its life, the device or separate control gear is not intended for use in other applications. Do not use the device when overfired or recess it not wicking or wound onto a reel; Do not open or cut the rope light. To reduce the risk of strangulation, the flexible wiring connected to this luminaire shall be effectively fixed to the wall if the wiring is within arm's reach.

FCC and ISED Canada Statement

This device complies with Part 15 of the FCC Rules and Industry Canada licence-exempt RSS standard(s).

Operation is subject to the following two conditions

1. This device may not cause harmful interference, and
2. This device must accept any interference received, including interference that may cause undesired operation.
 - **Warning:** Changes or modifications not expressly approved by the party responsible for compliance could void the user's authority to operate the equipment.

NOTE: This equipment has been tested and found to comply with the limits for a Class B digital device, pursuant to Part 15 of the FCC Rules.

These limits are designed to provide reasonable protection against harmful interference in a residential installation. This equipment generates uses and can radiate radio frequency energy and, if not installed and used in accordance with the instructions, may cause harmful interference to radio communications. However, there is no guarantee that interference will not occur in a particular installation. If this equipment does cause harmful interference to radio or television reception, which can be determined by turning the equipment off and on, the user is encouraged to try to correct the interference by one or more of the following measures

1. Reorient or relocate the receiving antenna.
2. Increase the separation between the equipment and receiver.
3. Connect the equipment into an outlet on a circuit different from that to which the receiver is connected.
4. Consult the dealer or an experienced radio/TV technician for help.

FCC and IC Radiation Exposure Statement

- This equipment complies with FCC and IC radiation exposure limits set forth for an uncontrolled environment. This equipment should be installed and operated with minimum distance 20cm between the radiator & your body.
- This Class B digital apparatus complies with Canadian ICES-005.

Responsible party

- **Name:** GOVEE MOMENTS(USJ TRADING LIMITED)
- **Address:** 2501 Chatham Rd Suite R Springfield IL 62704
- **Email:** certification@govee.com
- **Contact information:** <https://www.govee.com/support>

The any set word mars on henne regened meng sea by leror SIG, ne. The trademark Govee has been authorised to Shenzhen Qianyan Technology LTD. Copyright ©2021 Shenzhen Qianyan Technology LTD. All Rights Reserved.

FOR INDOOR USE ONLY



- For FAQs and more information, please visit: www.govee.com

Documents / Resources

 User Manual <small>Model H6602 Govee AI Gaming Sync Box with Backlight</small>	Govee H6602 AI Sync Box with Monitor Backlight [pdf] User Manual H6602 AI Sync Box with Monitor Backlight, H6602, AI Sync Box with Monitor Backlight, Sync B ox with Monitor Backlight, Monitor Backlight, Backlight
--	--

References

- [User Manual](#)