

gosund S6 Wi-Fi Temperature and Humidity Sensor User Manual

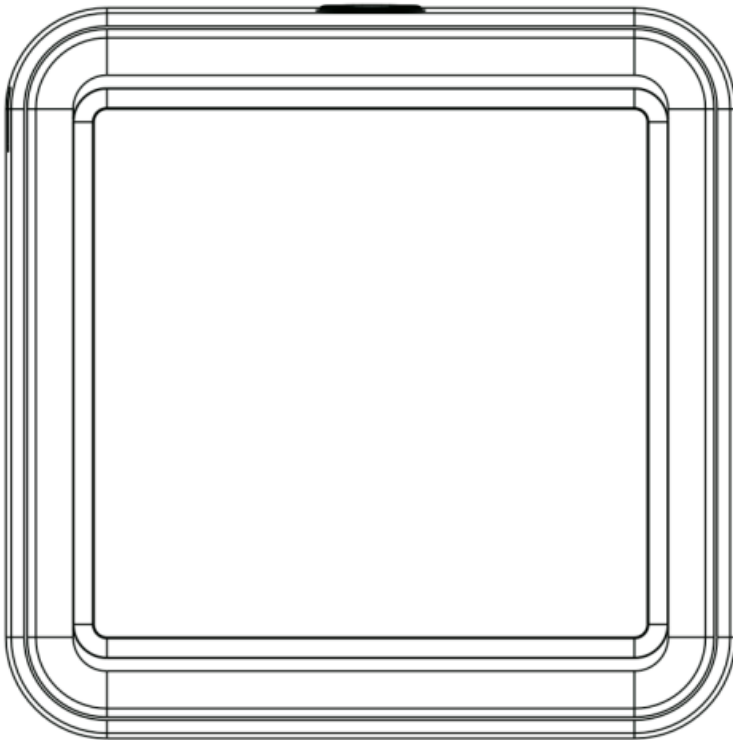

Contents

- 1 Gosund Wi-Fi Temperature & Humidity Sensor**
 - 1.1 User Manual**
 - 1.1.1 Diagram
 - 1.1.2 Specifications
 - 1.1.3 Checklist Before Using the Device
 - 1.1.4 How to Use
 - 1.1.5 How To Set Up
 - 1.1.6 Device Connection Modes
 - 1.1.7 Functions
 - 1.1.8 Frequently Asked Questions
 - 1.1.9 Warranty Conditions
 - 1.1.10 EU Declaration of Conformity
 - 1.1.11 WEEE
- 2 Documents / Resources**
 - 2.1 References

User Manual

Dear customer,

Thank you for purchasing our product. Please read the following instructions carefully before first use and keep this user manual for future reference. Pay particular attention to the safety instructions. If you have any questions or comments about the device, please contact the customer line.



www.alza.co.uk/kontakt



+44 (0)203 514 4411

Importer Alza.cz a.s., Jankovcova 1522/53, Holesovice, 170 00 Prague 7, www.alza.cz

Diagram

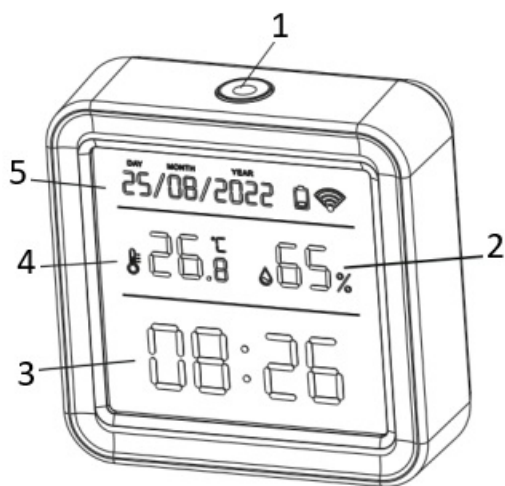

24-Hour System

1. Reset Button (Press to turn on backlight)
2. Indoor Humidity
3. Time
4. Indoor Temperature
5. Date



12-Hours System

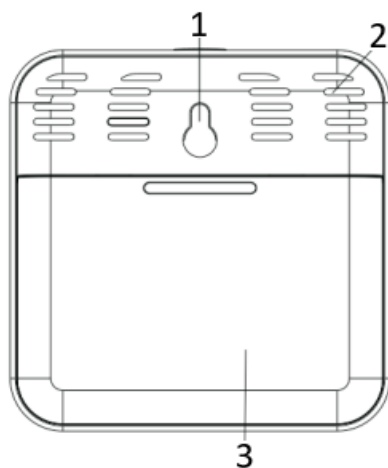

1. Hook Groove
2. LED Indicator
3. Battery Compartment

Specifications

Size	56 × 56 × 23 mm
Battery	LR03-1.5 V / AAA × 3 (Alkaline battery)
Wi-Fi Protocol	2.4 GHz IEEE 802.11b/g/n
Temperature Measurement Range	-9.9°C – 60°C
Temperature Accuracy	±1°C
Humidity Measurement Range	0% RH – 99% RH
Humidity Accuracy	±5% RH

Checklist Before Using the Device

- a. Ensure your smartphone is connected to a 2.4 GHz Wi-Fi network.
- b. Input the correct Wi-Fi password.
- c. Your smartphone should be running Android 4.4 or iOS 8.0 or higher.
- d. If the number of devices connected to your Wi-Fi router reaches the limit, you may need to disconnect a device to free up a channel, or try connecting to another Wi-Fi router.

How to Use

1. Open the battery compartment cover by pushing it downwards.
2. Install 3 AAA Alkaline batteries, ensuring the correct orientation of the positive and negative poles.
3. Align the cover with the slots and push it upwards to close.

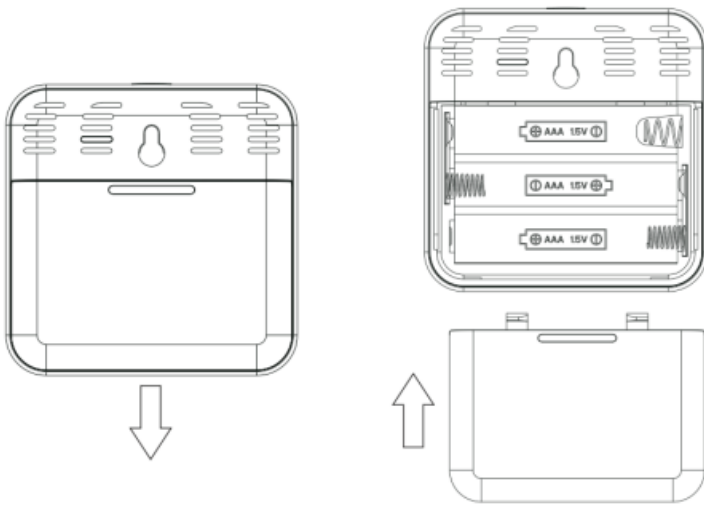

How To Set Up

1. Use your smartphone to scan the QR code, or search for the “Gosund” app in the Google Play Store or App Store to download and install.



2. Create an account using your mobile number and the provided authentication code.
3. In the app, tap the “+” at the upper right corner of the homepage. Then select “Add Device.”

Davis ▾



Overcast

22°C

Outdoor Tem...

Good

Outdoor PM2.5

Good

Outdoor Air Q...

All Devices

Living Room

Master ...

Device Connection Modes

• Bluetooth Mode:

- The app will prompt you to enable Bluetooth on your mobile device.
- Follow the instructions to connect: the app will search for the sensor, and you'll enter the Wi-Fi name and password for automatic connection.

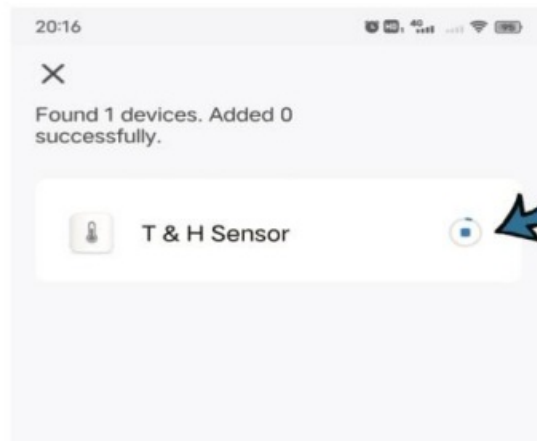
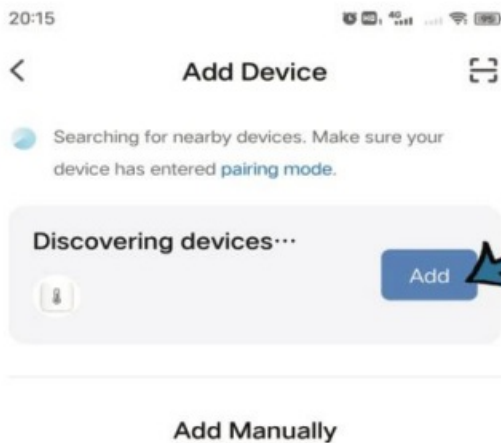

• Wi-Fi Mode:

- In the app, select "Temperature and Humidity Sensor (BLE + Wi-Fi)" from the "Sensors" category.
- If the LED on the sensor blinks quickly, you can proceed with the connection. If not, hold the reset button for about 5 seconds until the LED blinks quickly.

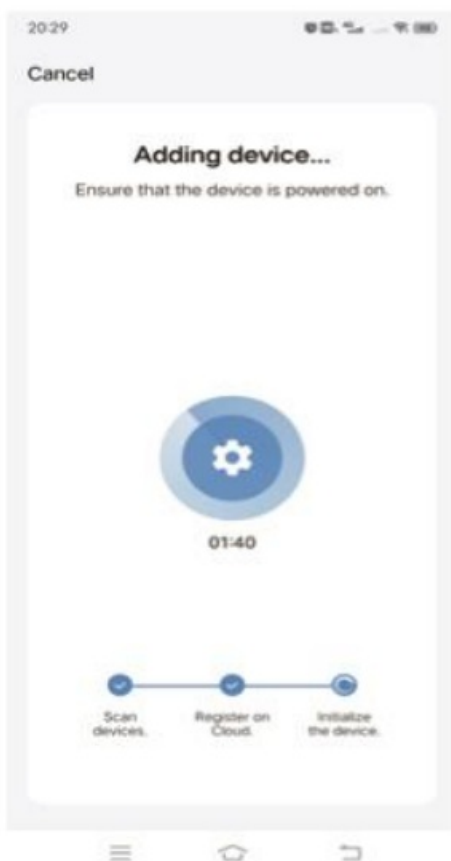
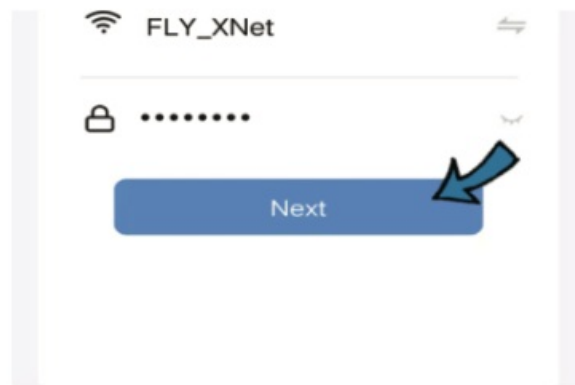
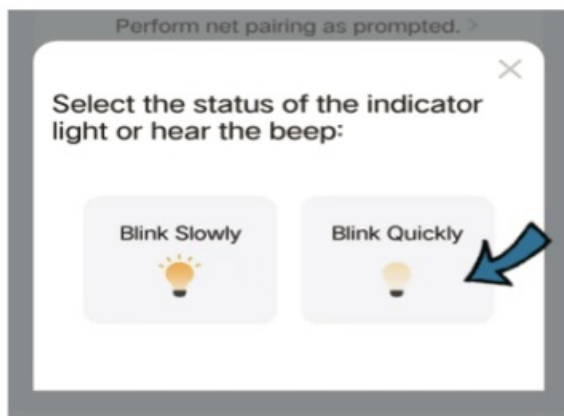
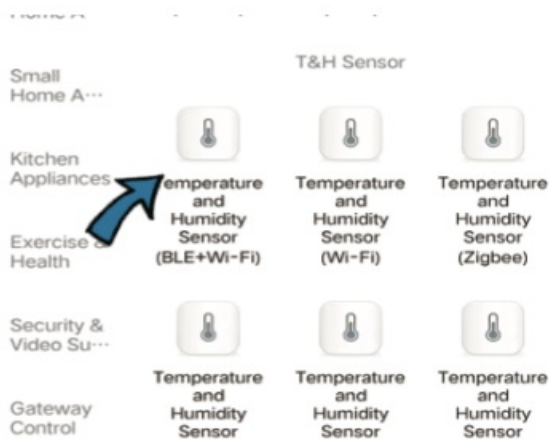

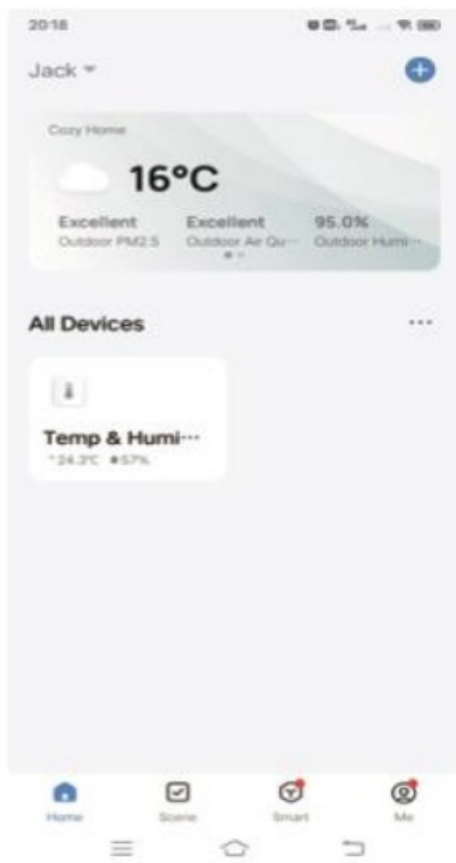

- For a slow blink, ensure the LED blinks slowly, then connect your mobile to the device's hotspot named "SmartLife-XXXX", and return to the app for automatic connection.

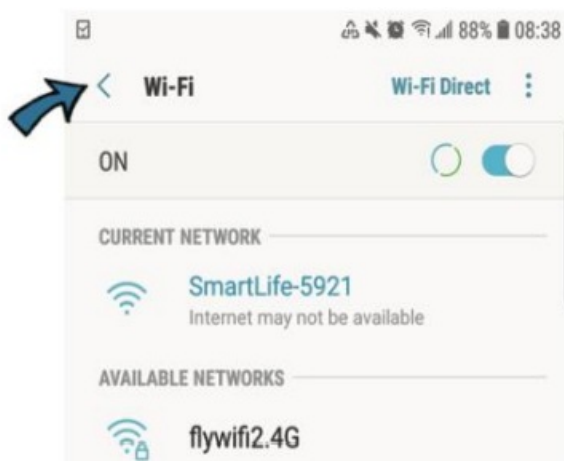
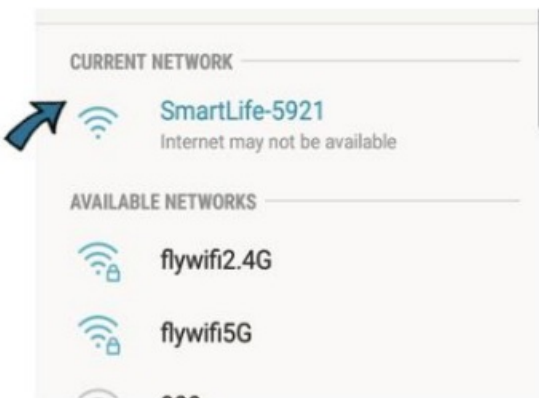
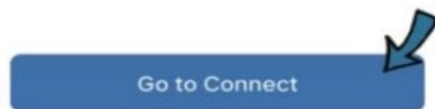
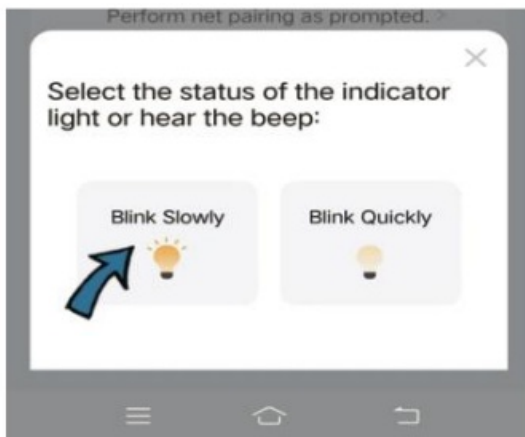

Functions

1. Backlight Display:

- Press the reset button on the top once to activate the backlight for about 10 seconds, which allows you to see the screen clearly in the dark.



2. Smart Linkage:

- Preset conditions and tasks in the “Scene” page. For example, if the room temperature exceeds 30°C, the A/C will turn on automatically.

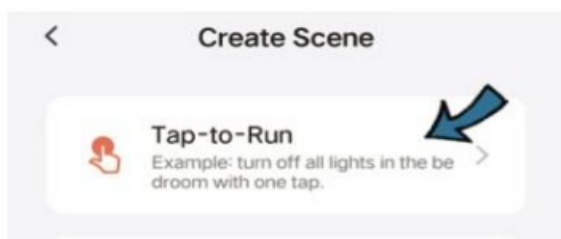
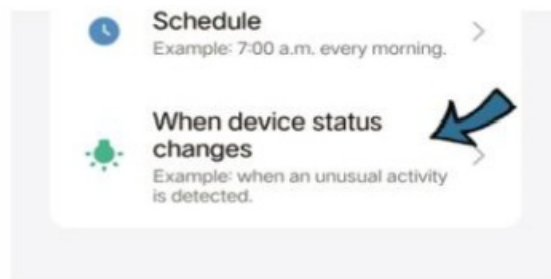
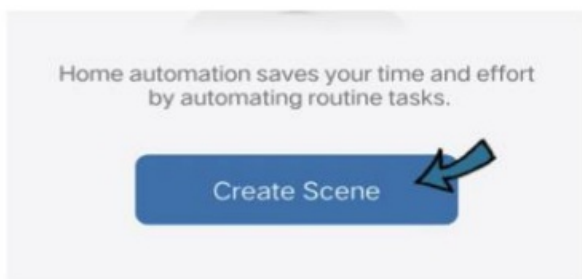

3. Temperature Unit Switch:

- Change the temperature unit between Fahrenheit and Celsius in the settings. After adjusting, press the reset button to synchronize the display with the app.

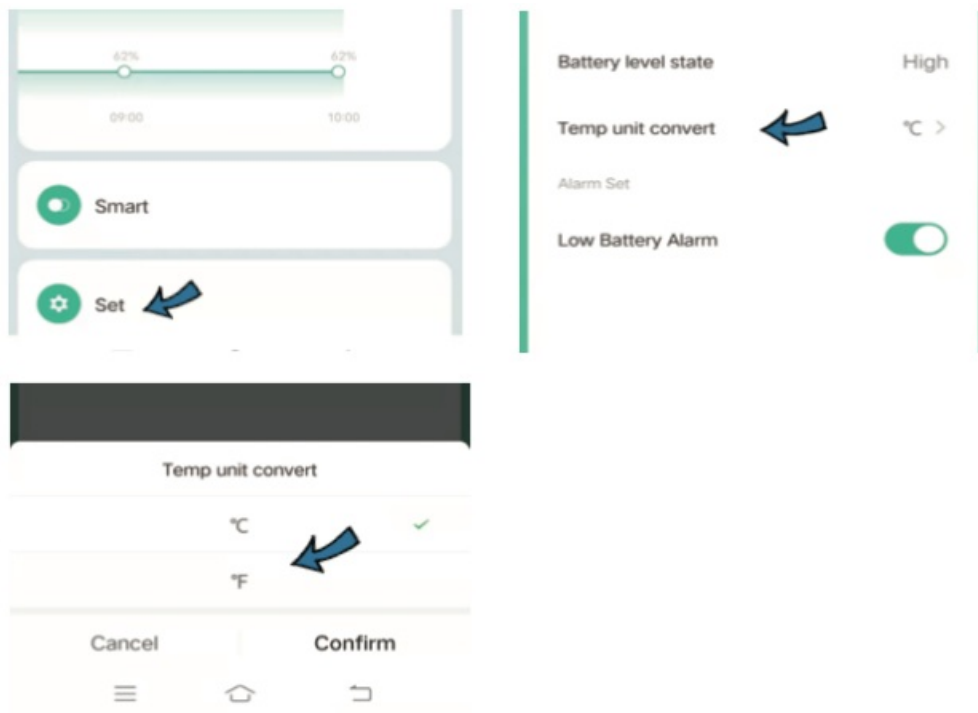

4. Temperature and Humidity Records:

- View the historic data for temperature and humidity. This data can be exported to your email address annually.

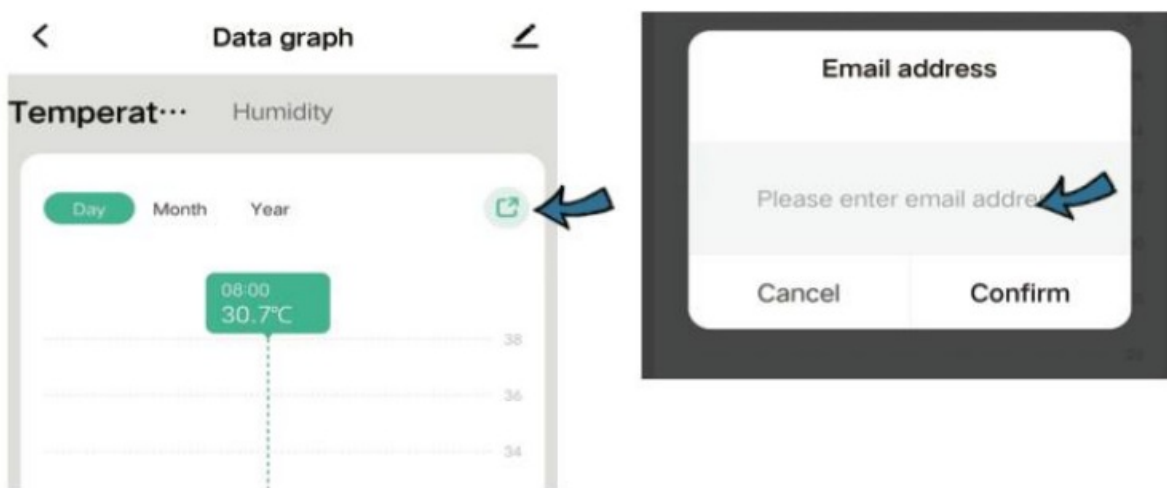

5. Temperature & Humidity Alarm:

- Set a range for temperature and humidity in the scene settings. If the readings reach this range, you will receive a notification through the app.

6. Low Battery Alarm:

- Receive an alert when the battery is low.

7. Third-party Voice Control:

- Use voice commands with Amazon and Google smart speakers to inquire about temperature and humidity.

Frequently Asked Questions

1. Accuracy of Readings: How long after setup do the temperature and humidity readings become accurate?

The sensor's temperature and humidity readings become more accurate and reflect the actual ambient environment about 30 minutes after the setup is complete.

2. Data Synchronization: What should I do if the temperature and humidity on the sensor's screen do not match the app data?

The temperature display on the screen is considered in sync with the app if the deviation is within $\pm 0.5^{\circ}\text{C}$. For humidity, the readings are in sync if the deviation is within $\pm 5\%$.

3. Update Timing: When does the app reflect changes in temperature and humidity?

The app will report changes to the Tuya cloud instantly when: a) The temperature change exceeds 0.5°C or the humidity change exceeds 5%, and the sensor has been active for more than 2 minutes. b) For changes below these thresholds, the app updates the readings within one hour.

4. Sensor Maintenance: What are some tips for maintaining the sensor?

Use Alkaline batteries for optimal performance, and ensure the sensor has a stable network connection after installation. If the sensor is offline, it will attempt to reconnect, which may lead to increased battery consumption.

5. Placement Tips: Where should I avoid placing the sensor?

To prevent inaccurate readings, do not place the sensor near any heat source.

6. Voice Command Instructions: How do I use voice commands with the sensor?

To inquire about the sensor's readings through voice assistants, use the following commands:

- "OK Google, what is the [device's] humidity?"
- "OK Google, what is the [device's] temperature?"
- "Alexa, what is the [device's] humidity?"
- "Alexa, what is the temperature of [device name]?"

Warranty Conditions

A new product purchased in the Alza.cz sales network is guaranteed for 2 years. If you need repair or other services during the warranty period, contact the product seller directly, you must provide the original proof of purchase with the date of purchase.

The following are considered to be a conflict with the warranty conditions, for which the claimed claim may not be recognized:

- Using the product for any purpose other than that for which the product is intended or failing to follow the instructions for maintenance, operation, and service of the product.

- Damage to the product by a natural disaster, the intervention of an unauthorized person or mechanically through the fault of the buyer (e.g., during transport, cleaning by inappropriate means, etc.).
- Natural wear and aging of consumables or components during use (such as batteries, etc.).
- Exposure to adverse external influences, such as sunlight and other radiation or electromagnetic fields, fluid intrusion, object intrusion, mains overvoltage, electrostatic discharge voltage (including lightning), faulty supply or input voltage and inappropriate polarity of this voltage, chemical processes such as used power supplies, etc.
- If anyone has made modifications, modifications, alterations to the design or adaptation to change or extend the functions of the product compared to the purchased design or use of non-original components.

EU Declaration of Conformity

This equipment is in compliance with the essential requirements and other relevant provisions of EU directives.



WEEE

This product must not be disposed of as normal household waste in accordance with the EU Directive on Waste Electrical and Electronic Equipment (WEEE – 2012/19 / EU). Instead, it shall be returned to the place of purchase or handed over to a public collection point for the recyclable waste. By ensuring this product is disposed of correctly, you will help prevent potential negative consequences for the environment and human health, which could otherwise be caused by inappropriate waste handling of this product. Contact your local authority or the nearest collection point for further details. Improper disposal of this type of waste may result in fines in accordance with national regulations.



Documents / Resources

	<p>gosund S6 Wi-Fi Temperature and Humidity Sensor [pdf] User Manual</p> <p>S6 Wi-Fi Temperature and Humidity Sensor, S6, Wi-Fi Temperature and Humidity Sensor, Humidity Sensor</p>
---	--

References

- [!\[\]\(effbd7993c63c039a58fd3395789cf3f_img.jpg\) alza.at](#)
- [!\[\]\(144980d038f2541d7b588a8a9132bd70_img.jpg\) Alza | Alza.co.uk](#)
- [!\[\]\(c4ce2d477989700c971cf3d240ad9283_img.jpg\) Alza.cz – rychlý a pohodlný nákup odkudkoliv | Alza.cz](#)
- [!\[\]\(5013555a72072875cb154b597e002a46_img.jpg\) Alza.cz – rychlý a pohodlný nákup odkudkoliv | Alza.cz](#)
- [!\[\]\(bf2038c114ec21ea58ad011774351c98_img.jpg\) Alza.cz](#)
- [!\[\]\(1ad0c3425edfa4762c2f20e33e3e5bbf_img.jpg\) alza.de](#)
- [!\[\]\(74d2fc5645add84f8511beb934060048_img.jpg\) alza.hu](#)
- [!\[\]\(ddc5533caa0187e636e3d3234e0983a3_img.jpg\) alza.sk](#)
- [User Manual](#)

Manuals+, Privacy Policy

This website is an independent publication and is neither affiliated with nor endorsed by any of the trademark owners. The "Bluetooth®" word mark and logos are registered trademarks owned by Bluetooth SIG, Inc. The "Wi-Fi®" word mark and logos are registered trademarks owned by the Wi-Fi Alliance. Any use of these marks on this website does not imply any affiliation with or endorsement.