



GORILLA GCG-9-COM Dump Cart Instruction Manual

[Home](#) » [Gorilla](#) » GORILLA GCG-9-COM Dump Cart Instruction Manual 

GORILLA GCG-9-COM Dump Cart



Gorilla® products are covered by several issued and pending US and international patents.
For more information, please visit www.gorillamade.com/patents

ASSEMBLY TIPS
CONSEJOS PARA
EL ENSAMBLAJE



Contents

- 1 Parts List
- 2 **HARDWARE**
- 3 TOOLS REQUIRED
- 4 **ASSEMBLY INSTRUCTIONS**
- 5 Customer Support
- 6 Documents / Resources
 - 6.1 References

Parts List

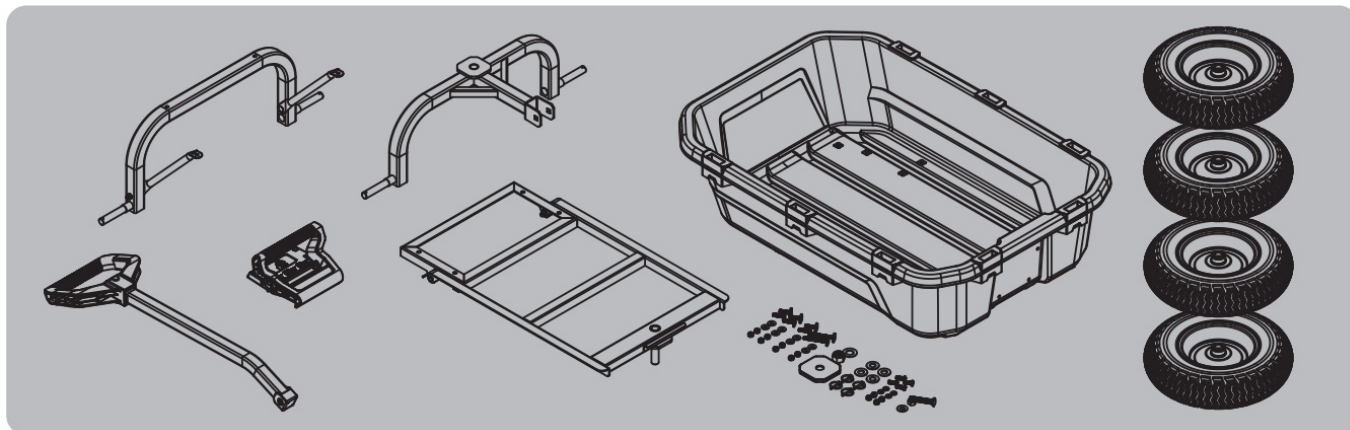

HARDWARE

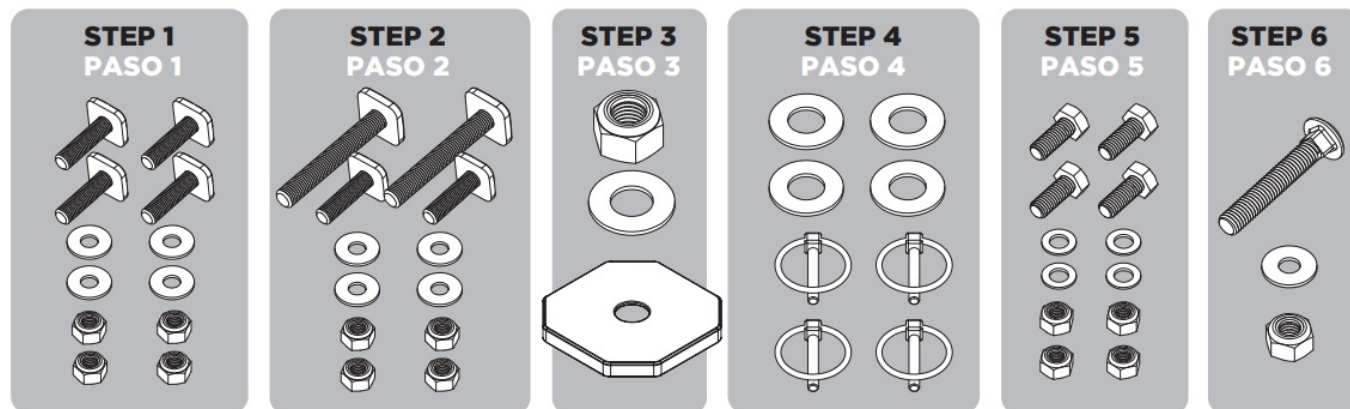

TOOLS REQUIRED

13MM



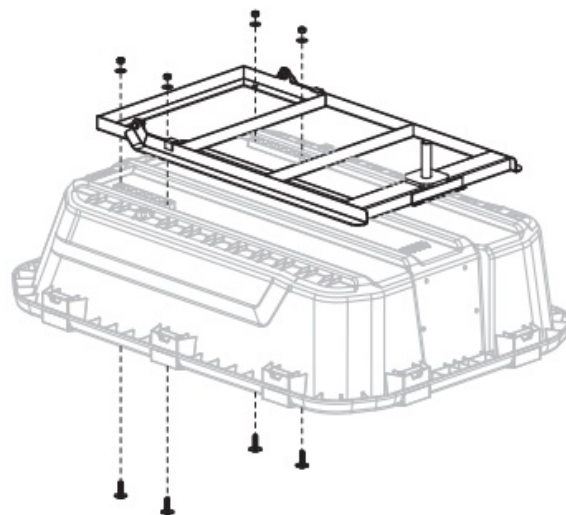

ASSEMBLY INSTRUCTIONS

1  x4  x4  x4

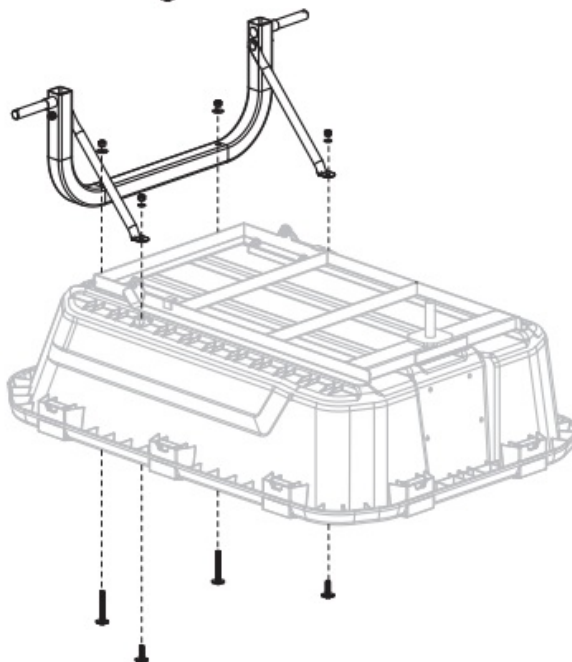

2  x2  x2  x4  x4

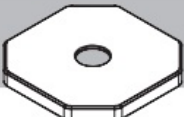

3  x1  x1  x1

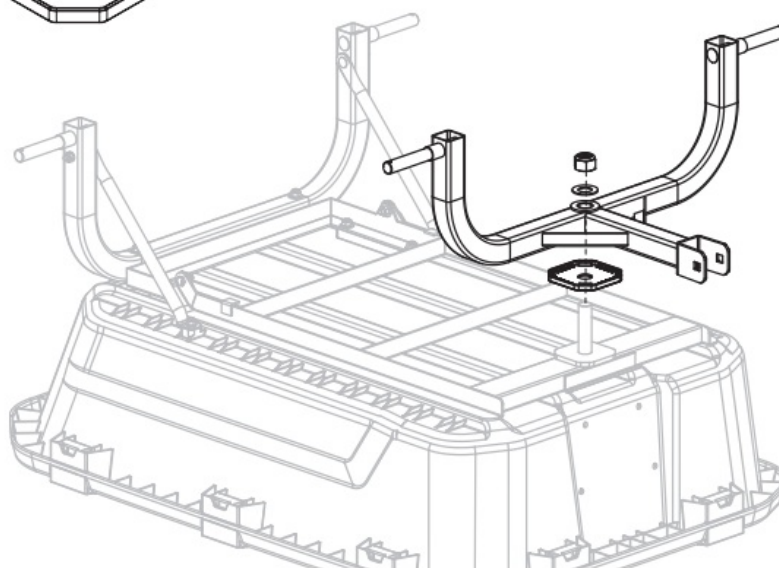

4



x4



x4

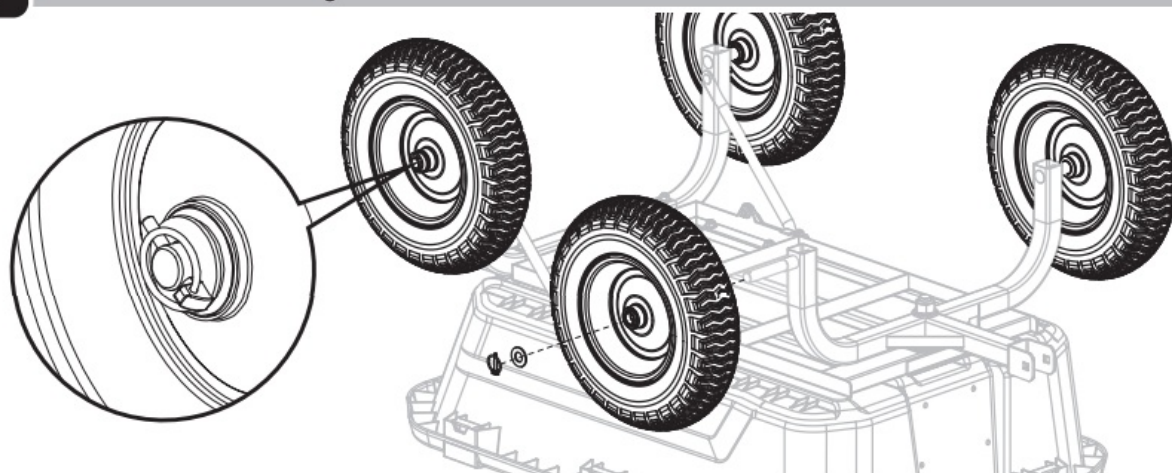

5



x4



x4



x4

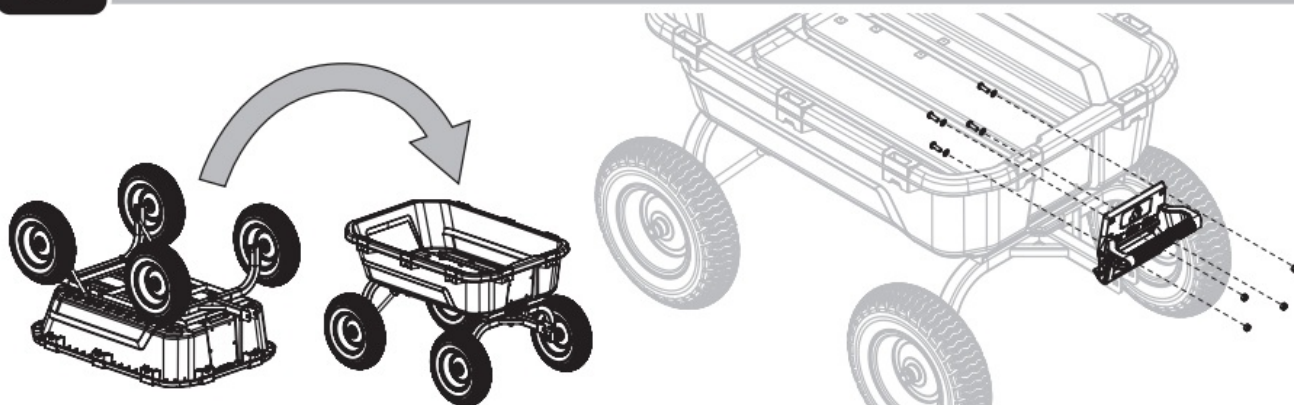

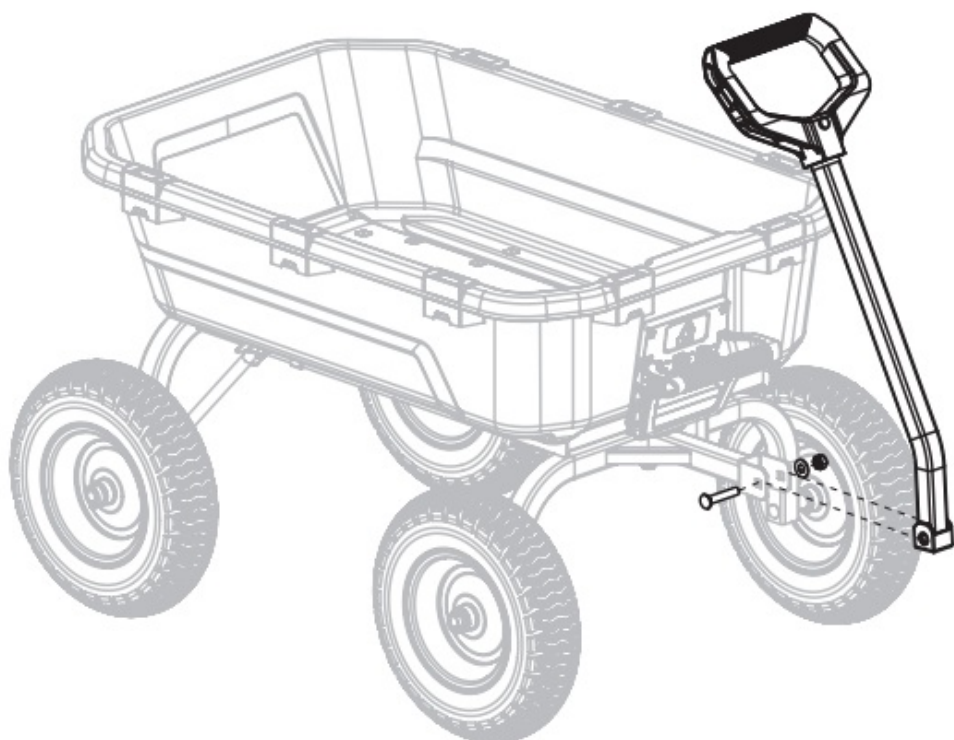
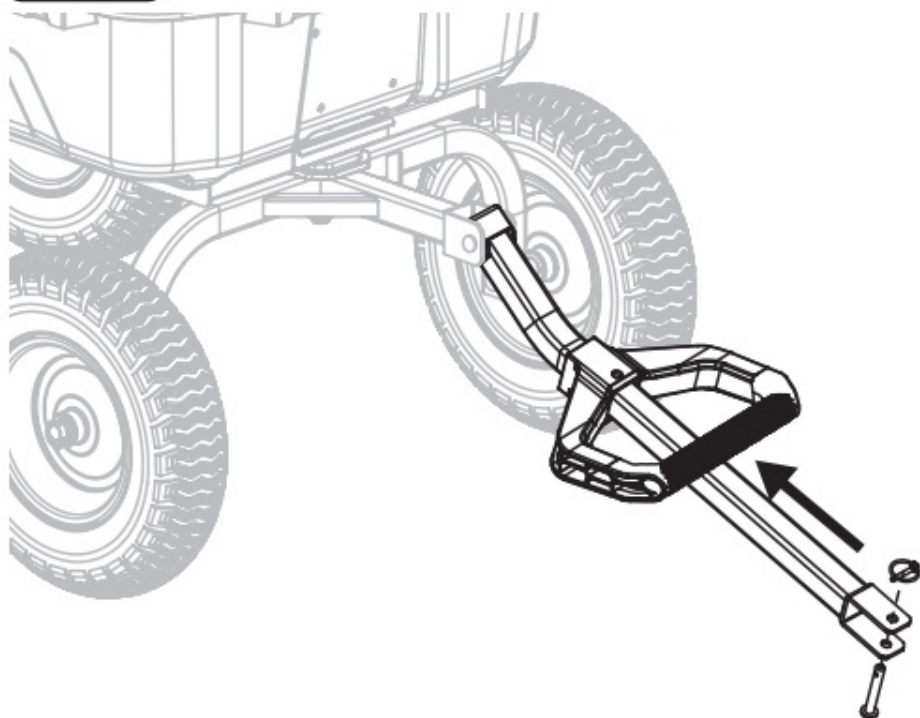
6**x1****x1****x1****7****QUESTIONS, PROBLEMS, OR MISSING PARTS?**

If any parts are missing, damaged, or if you have any questions or need additional instructions, DO NOT RETURN THIS PRODUCT TO THE RETAILER, visit us at www.gorillamade.com to complete the replacement parts

submission form or call our customer service department at 1-800-867-6763. 9 a.m. – 4 p.m., CST, Monday-Friday.

IMPORTANT SAFETY INSTRUCTIONS

1. Read, understand and follow ALL instructions before using this product.
2. Do not exceed the overall maximum load capacity of 1,400 lbs. or the maximum dumping load capacity of 500 lbs. The weight rating is based on an evenly distributed load.
3. Do not allow children to use the cart without supervision. This cart is not a toy.
4. Do not use this cart for transporting passengers.
5. This cart is not intended for highway use.
6. Do not exceed 5 mph.
7. Distribute the load evenly over the surface of the tray.
8. Do not load items on the top edges of the tray.
9. If any parts become damaged, broken or misplaced, do not use the cart until replacement parts have been obtained.
10. Do not use the cart on surfaces or for transporting objects that can cause damage to the pneumatic tires or tubes. DO NOT INFLATE THE TIRES TO MORE THAN 30 PSI (2.07 BAR).
11. It is recommended that the cart be inspected for damage before each use.
12. KEEP THESE INSTRUCTIONS FOR FURTHER REFERENCE.

Customer Support

Tricam Industries Inc.
7677 Equitable Drive
Eden Prairie, MN 55344
1-800-867-6763 • www.gorillamade.com



Documents / Resources



[GORILLA GCG-9-COM Dump Cart](#) [pdf] Instruction Manual
GCG-9-COM Dump Cart, GCG-9-COM, Dump Cart

References

-  [Gorilla Made | Utility & Outdoor Products & Parts](#)

-  [Patents - Gorilla](#)
- [User Manual](#)

[Manuals+](#), [Privacy Policy](#)

This website is an independent publication and is neither affiliated with nor endorsed by any of the trademark owners. The "Bluetooth®" word mark and logos are registered trademarks owned by Bluetooth SIG, Inc. The "Wi-Fi®" word mark and logos are registered trademarks owned by the Wi-Fi Alliance. Any use of these marks on this website does not imply any affiliation with or endorsement.