



## GoPioneer SmartWiFi App for Android User Guide

[Home](#) » [GoPioneer](#) » GoPioneer SmartWiFi App for Android User Guide 

### Contents

- [1 GoPioneer SmartWiFi App for Android](#)
- [2 Quick Start Guide](#)
- [3 Getting started with the App](#)
- [4 Documents / Resources](#)
  - [4.1 References](#)
- [5 Related Posts](#)



**GoPioneer SmartWiFi App for Android**



## Quick Start Guide

### Setting up your WiFi and App

1. Download the app. You can search either the Apple App Store or Google Play Store for: 'GoPioneer SmartWiFi' then install it on your mobile device.



2. Select "SIGN UP" towards the bottom of the screen.



3. Enter your personal information. The password you enter here will be used to access the app.

The image shows the login screen of the GoPioneer SmartWiFi app. At the top, the text "Welcome to GoPioneer SmartWiFi" is displayed. Below this, the word "Login" is written in red. A sub-header reads: "Everything you need to secure and control your home network and connected devices." There are three input fields: "Email Address" with the value "jamie.lee@gmail.com" and a green checkmark; "Password" with the value "CommandIQ1" and an eye icon; and "Location" with a dropdown menu showing "USA". Below these fields is a red "Login" button. At the bottom, there is a link "Forgot Password?" and a link "Don't have an account? Sign Up".

**Note:** Please wait at least 10 minutes after your GigaSpire has been ‘turned up’ before attempting step 4.

4. Tap the QR code that appears within the app. (You will be asked to allow the app to access your camera.)  
Point your camera at the QR Code found on the bottom of your GigaSpire, or on the sticker that came in your box (example shown below).

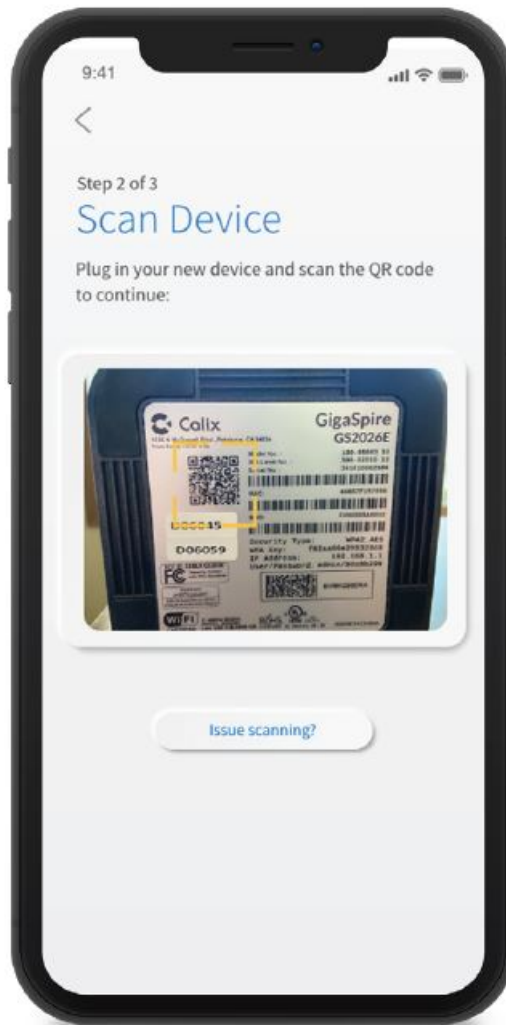
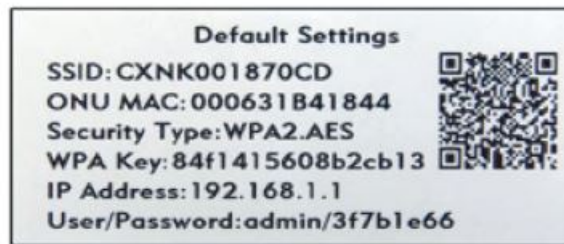

5. Select OK.
6. If you have a SSID already set up for your network. simply hit the red back arrow to complete the set up. OR If you do not have a SSID already set up:
  1. The Router Name will be used throughout the app.
  2. The Network Name (SSID) is what you will use as your wireless connection name.
  3. Select a password for your wireless network. If you do not want to change it on all the devices in your home, use your existing wireless SSID and Password from your current router.

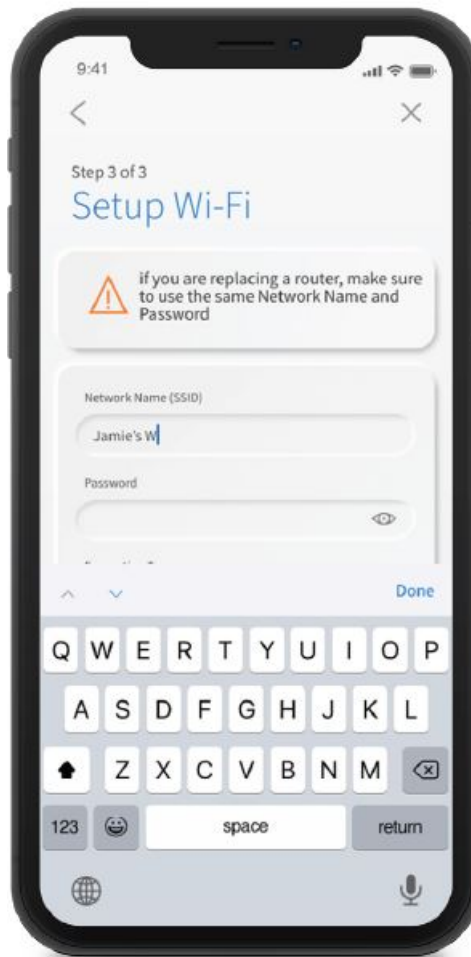

### Need help?

Visit [GoPioneer.com](https://www.gopioneer.com) or call 888.~8°.°66~

### Getting started with the App

The App allows you to manage your home or small business WiFi network. You can self-install and be managing your home or business within a few minutes. Download the app and start managing your home network today! Next: Refer to the Consumer Product Guide for details on how to use

### Documents / Resources

	<p><a href="#">GoPioneer SmartWiFi App for Android</a> [pdf] User Guide SmartWiFi App for Android</p>
---	---

### References

- [GoPioneer.com](https://www.gopioneer.com) - High-Speed/Fiber Internet, Cellular & iVideo